

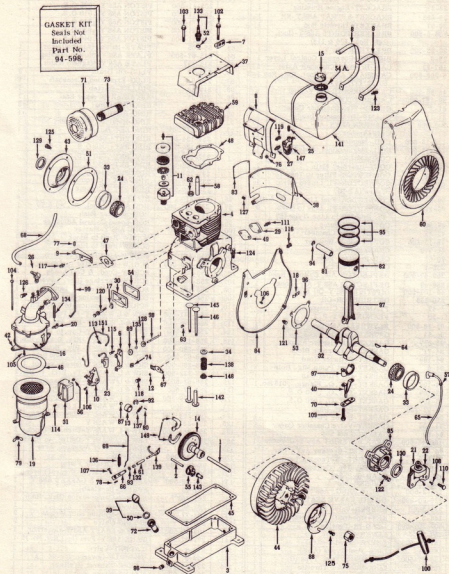

BASIC PARTS LIST 2790-1000

SEC. II, DIVISION
2790-1000
ISSUED MAY, 1959
REVISED AUG., 1966



CLINTON ENGINES CORPORATION

MAQUOKETA, IOWA

Printed in U. S. A.

BASIC PARTS LIST 2790-1000

Ref. No.	Part Number	Description	Qty.	Ref. No.	Part Number	Description	Qty.
1.	6-4	AXLE-Camshaft	1	76.	183-55	NUT-Tank Strap	2
2.	6-10	AXLE-Governor Gear	1	77.	183-63	NUT-Speed Control Adj. Rod	1
3.	18-39-500	BASE ASSY-Engine (Incl. Ref. Nos. 72, 86, 91)	1	78.	183-53	NUT-Square	1
4.	22-517-500	BLOCK ASSY-Cylinder (Incl. Ref. Nos. 2, 58, 61, 62)	1	79.	183-119	NUT-Wing (Air Cleaner)	2
5.	26-13	BRACKET-Breaker Assy	1	80.	205-25	PIN-Camshaft Weight	2
7.	26-27	BRACKET-Engine Hoisting	1	81.	203-67	PIN-Wrist	1
8.	26-643	BRACKET & STRAP ASSY-Kit	1	82.	204-11-500	PISTON ASSY-Standard	1
9.	26-97	BRACKET-Throttle Rod	1	205-11-500	PISTON ASSY-.005 O.S.	1	
10.	135-3-500	BREAKER POINTS ASSY-(Incl. Ref. Nos. 108 & 113)	1	206-11-500	PISTON ASSY-.010 O.S.	1	
11.	29-23-500	BREA KHER ASSY	1	207-11-500	PISTON ASSY-.020 O.S.	1	
12.	28-8	BUSHING-Governor Control Lever	1	208-11-500	PISTON ASSY-.030 O.S.	1	
13.	187-23	CAM-Breaker (Camshaft Axle)	1	209-11-500	PISTON ASSY-.040 O.S.	1	
14.	6-198-500	CAMSHAFT ASSY-(Incl. Ref. Nos. 80, 92, 137, 149, & 150)	1	83.	58-105	PLATE-Name, (Air Deflector)	1
15.	45-95-500	CAP & GASKET ASSY-Fuel	1	84.	215-97-500	PLATE ASSY-Blower Housing	1
16.	39-187-990	CARBURETOR ASSY	1	85.	215-127	PLATE ASSY-Magneto Stator	2
17.	81-3	CLAMP-Viv. Chamber Cover	1	86.	216-22	PLUG-Oil Drain	1
18.	81-11	CLAMP-Hi-Tension Lead	1	87.	216-5	PULLEY-Expansion, Camshaft	1
19.	2-5-990	CLEANER ASSY-Air	1	88.	219-18	PULLY-Start	1
20.	81-17	CLIP-Anchor	1	89.	218-36	RETAINER-Breaker Seal	1
21.	135-15-500	COIL-Magneto	1	92.	232-5	RING-Retaining	2
22.	135-16-500	COIL-Magneto(Incl. Ref. No. 21)	1	93.	232-37	RING-Retaining	1
23.	135-23-500	CONDENSER	1	94.	232-43	RING-Retainer, Wrist Pin	2
24.	20-66	CONE-Bearing, Main	2	95.	233-117-500	RING SET-Standard	1
25.	69-59	CONNECTOR-Filter to Tank	1	234-124-500	RING SET-.005 O.S.	1	
26.	69-24	CONNECTOR-Fl. Line to Carb.	1	235-124-500	RING SET-.010 O.S.	1	
		Types (A & B)		237-124-500	RING SET-.020 O.S.	1	
27.	69-5	CONNECTOR-Fuel Line Ty. (A & B)	1	239-124-500	RING SET-.030 O.S.	1	
69-118	CONNECTOR-Fl. Line to Carb.	2	241-124-500	RING SET-.040 O.S.	1		
	Fl. Shut-Off to Line Type (C)	1	233-140-500	RING SET - Chrome Std.	1		
28.	45-39	COVER-Fuel Pump	1	237-140-500	RING SET - Chrome .020	1	
30.	45-83	COVER-Valve Chamber	1	96.	244-21	RIVET-Tubular	6
31.	45-13-500	COVER ASSY-Breaker	1	97.	240-107-500	ROD ASSY - Incl. No. 40 & 70	1
32.	46-379	CRANKSHAFT	1	98.	245-17	ROD-Breaker Push	1
33.	20-65	CUP-Bearing, Main	2	99.	245-11	ROD-Speed Control Adjusting	1
34.	232-1	CUP-Valve Spring	2	100.	246-13-500	ROPE ASSY-Header	1
37.	289-67-500	DEFLECTOR-Air, Cylinder Head	1	102.	250-90	SCREW-Head to Block	3
38.	259-49	DEFLECTOR ASSY-Air Block	1	103.	250-89	SCREW-Head to Block	6
39.	45-108-500	DIP. VALVE ASSY-Oil Filler	1	104.	250-443	SCREW-Air Cleaner to Carb.	2
40.	220-155	DISTRIBUTOR-Oil	1	105.	258-936-500	SCREW-Carburetor to Adapter	2
42.	1-47	FLANGE-Air Cleaner Adapter	1	106.	258-83	SCREW-Cond. & Coil Leads	2
43.	1-20	FLANGE ASSY-P. T. O.	1	107.	258-65	SCREW-Carriage (Gov. Lever)	1
44.	83-36-500	FLYWHEEL ASSY	1	108.	258-483	SCREW-Coil Ground, Lamination	1
45.	94-53	GASKET-Base to Block	1	109.	258-69	SCREW-Connecting Rod Cap	2
46.	94-217	GASKET-Air Cleaner Adapter	2	110.	258-75	SCREW-Laminations to Stator Pl.	2
47.	94-71	GASKET-Carburetor Block	1	111.	258-241-500	SRW & L/W ASSY - Pl. Pump	1
48.	94-199	GASKET-Cylinder Head	1	113.	258-273-500	SRW & L/W ASSY-Brk. Pins to Brkt.	1
49.	94-81	GASKET-Fuel Pump Mg. Hole	1	114.	258-471-500	SRW & L/W ASSY-Cov. to Brkt.	2
50.	94-109	GASKET-P. T. O. Flange, .015 Std.	1	115.	258-132-500	SRW & L/W ASSY-Brkt. Brkt. to Blk. 2	1
51.	93-109	GASKET-P. T. O. .010 O.S.	1	116.	258-280-500	SRW & L/W ASSY-Blw. Housing	5
93-109	GASKET-P. T. O. .020 O.S.	1	117.	258-82-500	SRW & L/W ASSY-Thr. Rod Brkt.	2	
52.	94-92-990	GASKET-Spark Plug	1	118.	258-280-500	SRW & L/W ASSY-Speed Control	1
53.	94-98	GASKET-Stator Plate	1	119.	258-232-500	SRW & L/W ASSY-Tk. Brkt. to Blk. 2	1
54.	94-104	GASKET-Valve Chamber Cover	1	120.	258-62-500	SRW & L/W ASSY-Viv. Chamber Cov	1
54A.	94-59	GASKET-Fuel Cap	1	121.	258-67-500	SRW & L/W ASSY-Rack Pl. to Brkt.	2
55.	106-43-500	GEAR & WEIGHT ASSY-Governor	1	122.	258-779-500	SRW & L/W ASSY-Tk Strap to Blk. 2	1
56.	70-8	GROMMET-Breaker Ass's Cov.	1	123.	258-9-500	SRW & L/W ASSY-Block to Base	4
57.	70-9	GROMMET-Hi-Tension Lead	1	125.	258-258-500	SRW & L/W ASSY	6
58.	201-21	GUIDE-Valve, Cylinder Block	2	126.	258-281-500	SRW & L/W ASSY-Carb. to Block	2
59.	222-14	HEAD-Cylinder	1	127.	258-198-500	SRW & L/W ASSY-Deflec. to Block 2	1
60.	259-126	HOUSING-Blower	1	128.	84-155	SEAL-Breaker Actuating Arm	1
61.	124-2-500	HSG. & BRNG. ASSY-Gov. Sh.	1	129.	94-184-990	SEAL-Oil	1
62.	136-90-990	INSERT VALVE SEAT-Exhaust	1	130.	94-181-990	SEAL-Oil (Stator Plate)	1
63.	232-3	KEEPEr-Valve Spring	4	132.	304-72	SPACER-Governor Control Lever	1
64.	148-6	KEY-Woodruff, Flywheel	1	133.	267-28-500	SPARK PLUG & GASKET ASSY	1
65.	307-203-500	LEAD-Hi-Tension	1	135.	263-45	SPRING-Backlash	1
66.	137-73	LEVER-Governor	1	136.	263-40	SPRING-Compression (Brk. Rod)	1
67.	137-86-500	LEVER-Speed Control	1	137.	263-40	SPRING-Governor	1
68.	158-25	LINE-Fuel Tyres (A&B)	1	137.	263-77	SPRING-Ignition Shift Weight	2
69.	158-57-500	LINE ASSY-Fuel Type (C)	1	138.	263-88	SPRING-Valve	1
70.	159-34	LINK-Governor Throttle	1	139.	109-10-500	STOP & SHAFT ASSY-Governor	1
70.	148-11	LOCK-Double Conn. Rod Screw	1	141.	277-67-500	TANK ASSY-Fuel (Incl. Ref. No. 15)	1
71.	170-25	MUFFLER-Exhaust	1	142.	278-9	TAPPET-Valve	2
72.	277-7-500	NECK ASSY-Oil Filler	1	143.	109-9	THIMBLE-Governor	1
73.	69-86	NIPPLE-Muffler to Block	1	145.	291-11-990	VALVE-Exhaust (Bellite)	1
74.	183-54	NUT-Brk. Pl. & Cond. to Brk.	1	146.	291-10-990	VALVE-Intake	1
75.	183-59	NUT-Start Pulley	1	147.	293-32-500	VALVE & FILTER ASSY-Fuel Shut-Off	1
				148.	304-188	WASHER-Valve Spring Retaining	2
				149.	305-25	WEIGHT-Kit (Ignition Shift)	1
				151.	307-126-500	WIRE ASSY-Breaker Points	1

CARBURETORS

39-140-500 (UT 2714-S)

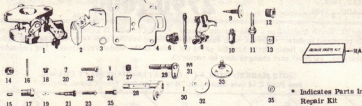

Ref. No.	Part Number	Description	Qty.	Ref. No.	Part Number	Description	Qty.
1.		NOT SERVICED SEPARATELY		19.	*304-110	RETAINER-Air Horn Dust Seal	1
2.	39-586-500	FLOAT & LEVER ASSY	1	20.	216-30	RIVET-Channel Plug	1
3.	*94-79	GASKET-1 Nozzle, 1 Nozzle Bleed	2	21.	*258-183	SCREW-Idle Adj.	1
4.	*94-249	GASKET-Body	1	22.	258-210	SCREW-Throttle Adj.	1
5.	94-78	GASKET-Needle Seal (Not Ilus.)	1	23.	258-213	SCREW-Throttle Lever Clamp	1
6.	*182-5	JET-Idle	1	24.	*258-212	SCREW-Valve Attaching (2 Throttles 2-Choke)	2
7.	*182-2	JET ASSY-Low Speed	1	25.	258-290-500	SCREW & L'WASHER ASSY-Body 4 Attaching	4
8.	137-118-500	LEVER ASSY-Throttle	1	26.	268-211	SCREW-Throttle Valve (Not Ilus.)	1
9.	*181-7-500	NEEDLE ASSY-Hi-Speed Adj.	1	27.	*94-134	SEAL-Dust, Air Horn	2
10.	*181-32-500	NEEDLE & SEAT ASSY-Float Vlv.	1	28.	6-105-500	SHAFT & LEVER ASSY-Choke 1	1
11.	*182-10-500	NOZZLE ASSY	1	29.	6-109-500	SHAFT & LEVER ASSY-Throttle 1	1
12.	183-30	NUT-Hi-Speed Adj. Screw	1	30.	263-19	SPRING-Choke Lever Stop	1
13.	183-44	NUT-Screw, Thr. Lever Clamp	1	31.	263-61	SPRING-Idle Adj. Screw	1
14.	*94-118	PACKING-Hi-Speed Adj. Needle	1	32.	293-55	VALVE-Throttle	1
15.	94-183	PIN-Choke Lever Stop	1	33.	293-24	VALVE ASSY-Choke	1
16.	*203-28	PIN-Float Hinge	1	35.	304-127	WASHER-Hi-Speed Adj. Screw	1
17.	216-9	PLUG-Drain	1				
18.	*216-15	PLUG-Idle Port	1				
18A.	39-882	KIT-Repair	1				

39-187-990 (HEW-4)

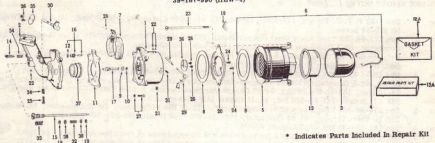

Ref. No.	Part Number	Description	Qty.	Ref. No.	Part Number	Description	Qty.
1.	25-211-500	BODY ASSY-Bowl (Incl. Plugs)	1	21.	216-58	PLUG-Drain	1
2.	39-676-500	BODY ASSY-Thr. (Incl. Plugs)	1	22.	216-46	PLUG-2 Bowl Body, 1-Throttle Body	2
3.	25-35	BOWL-OIL	1	23.	258-443	SCREW-Air Cleaner	2
4.	26-493	BRACKET-Filter Mounting	1	24.	258-755	SCREW-Adapter Plate	2
5.	2-134-500	CLEANER ASSY-Air (Sub Ass'y)	1	25.	258-60	SCREW-Throttle Adjusting	1
6.	2-5-990	CLEANER ASSY-Air	1	26.	258-483	SCREW & L'W ASSY-2 Choke Vlv. 2-Throttle Valve	4
7.	82-11-500	FLOAT-Ass'y	1	27.	258-485-500	SCREW & L'W ASSY-Thr. Body 4 to Bowl Body (Not Ilus.)	4
8.	*94-217	GASKET-Adapter Plate	2	28.	6-195	SHAFT-Filter	1
9.	*94-253	GASKET-Nozzle	1	29.	6-278-500	SHAFT & LEVER ASSY-Choke 1	1
10.	*94-252	GASKET-Nozzle Tip	1	30.	6-171-500	SHAFT & LEVER ASSY-Throttle 1	1
11.	*94-251	GASKET-Thr. Body to Bowl Body	1	31.	263-285	SPRING-Choke Shaft	1
12.	94-229	GASKET-Needle Seat	1	32.	263-186	SPRING-Power Adj. Needle (Lower)	1
	94-580	GASKET KIT	1	33.	263-287	SPRING-Power Adj. Needle (Upper)	1
13.	2-135	HOUSING-Filter	1	34.	263-286	SPRING-1-Idle Needle, 1-Thr. Scr.	1
13A.	39-902	KIT-Repair	1	34A.	293-28	VALVE-Drain (Not Ilus.)	1
14.	181-34	NEEDLE-Idle	1	35.	293-72	VALVE-Throttle	1
15.	*181-68-500	NEEDLE-Power Adj.	1	36.	293-73	VALVE-Choke	1
16.	*293-88-500	NEEDLE & SEAT ASSY	1	37.	39-678	VENTURI	1
17.	182-38-500	NOZZLE ASSY	1	38.	304-672	WASHER-Power Adj. Needle	1
18.	183-119	NUT-Wing	2				
19.	*94-111	"O" RING-Power Adj. Needle	1				
20.	1-47	PLATE ADAPTER	1				

MODEL VARIATIONS

2790-1000



The adaptation of Clinton Engines to a wide variety of uses, results in what is known as Model Variations. Following is a list of Models produced to date. Opposite each Engine Model listed are the Part Numbers required in addition to or in place of standard parts. Refer to Basic Parts List for parts not listed in the Model Variations. For replacement engine to fit special applications, external part changes may be required.

UNITS MARKED WITH A () INDICATES CRANKSHAFT CHANGE.
See Page C of this Manual on "How to Identify Your Clinton Engine."

MODELS	CRANKSHAFT Ref. to Sec. IV Div. B	NOTES	REPL. ENGINE *	SHORT BLOCK	MODELS	CRANKSHAFT Ref. to Sec. IV Div. B	NOTES	REPL. ENGINE *	SHORT BLOCK
2720-1000	46-793	7	Note 11	None	2790-1110	46-379		21495	None
2720-1100	46-793	8,9	Note 11	None	2790-1111	46-380		(21495)	None
2760-1000	46-387	7	21500	None	2790-1112	46-379	4	21495	None
2760-1100	46-791	8	21500	None	2790-1113	46-379	5	Note 11	None
2790-1000	46-379		21495	None	2790-1114	46-379	5	Note 11	None
2790-1100	46-380		(21495)	None	2790-1115	46-379		21495	None
2790-1101	46-381		(21495)	None	2793-1116		Never Built		
2790-1102	46-382		(21495)	None	2790-1117	46-379	6	21495	None
2790-1103	46-384	1	Note 11	None	2790-1118	46-379		21495	None
2790-1104	46-379	3	21497	None	2790-1119	46-379		21495	None
2790-1105	46-384	1,3	Note 11	None	2790-1120	46-379		21495	None
2793-1106		Never Built			2790-1121	46-379	9	21495	None
2790-1107	46-379	10	Note 11	None	2790-1122	46-379	6	21495	None
2790-1108	46-379		21495	None	2790-1123	46-379	4	21495	None
2790-1109	46-379	2	Note 11	None					

2790-1000 SERIES NOTES

- Note 1 Use 1-22 P. T. O. Flange, 148-5 Key (Woodruff), 44-4-990 Clutch Ass'y (Rockford), (4) 304-32 L'Washer, (4) 258-96 Screw.
- Note 2 Use 277-66-500 Tank Ass'y (dual compartment), 122-16 Head (Cylinder), 293-10 Valve (3-way), 69-24 Connector, 69-5 Connector, 69-59 Nipple. This unit uses kerosene.
- Note 3 Refer to Sec. III, Div. N page 9 for parts list and exploded view of 12 volt Starter Generator. See Sec. III, Div. N page 11 for wiring diagram.
- Note 4 Use 169-7 Manifold, 94-33 Gasket (Carb. to Manifold), 39-140-500 Carburetor, (2) 258-227-500 Screw, 69-5 Connector, 159-32 Link, 69-53 Horn (Air), 26-6 Bracket (Air Cleaner), 2-7-500 Air Cleaner, 24-15 Stud, 183-65 Nut (Wing), 94-17 Gasket (Air Horn to Carb.), 81-5 Clamp (Carb. to Air Horn), 258-171 Screw, 183-25-500 Nut, 94-12 Gasket (Air Cleaner to Air Horn).
- Note 5 Use 277-66-500 Tank Ass'y (dual compartment), 122-16 Head (Cylinder), 69-15 Connector, 69-59 Nipple, 293-10 Valve (3-way), 69-11 Rotorcap (Exhaust Valve).
- Note 6 Use 291-20-500 Rotorcap (Exhaust Valve).
- Note 7 Refer to Sec. III, Div. C page 2 for parts list and exploded view of reduction unit. (2:1 6876)(6:1 6840).
- Note 8 Refer to Sec. III, Div. C page 3 for parts list and exploded view of reduction unit. (2:1 200-812) (6:1 200-816).
- Note 9 Refer to Sec. III, Div. Q pages 1 and 2 for exploded view and parts list for Spark Plug Radio Shielding.
- Note 10 Use 39-111-990 Carburetor, 169-7 Manifold (Intake), 94-33 Gasket (Carb. to Manifold), 69-242 Nipple, 69-239 Elbow Pipe, 231-5 Regulator (Secondary), 69-34 Elbow, 69-242 Elbow (Flared Tube), 158-317-500 Line Ass'y (Fuel), 69-36 Connector, 231-3 Regulator (Primary), 258-41-500 Screw (Regulator to Bracket), 259-126-500 Housing (Blower), 69-53 Air Horn, 2-7-500 Air Cleaner, 258-171 Screw, (2) 258-223-500 Screw (Manifold to Carb.), 24-15 Stud (Air Cleaner), 26-6 Bracket (Air Cleaner), 94-17 Gasket (Air Horn to Carb.), 183-65 Nut (Wing), 159-32 Link (Governor), 45-310 Cover (Breaker Points).
- Note 11 Special engine order by complete model number.