

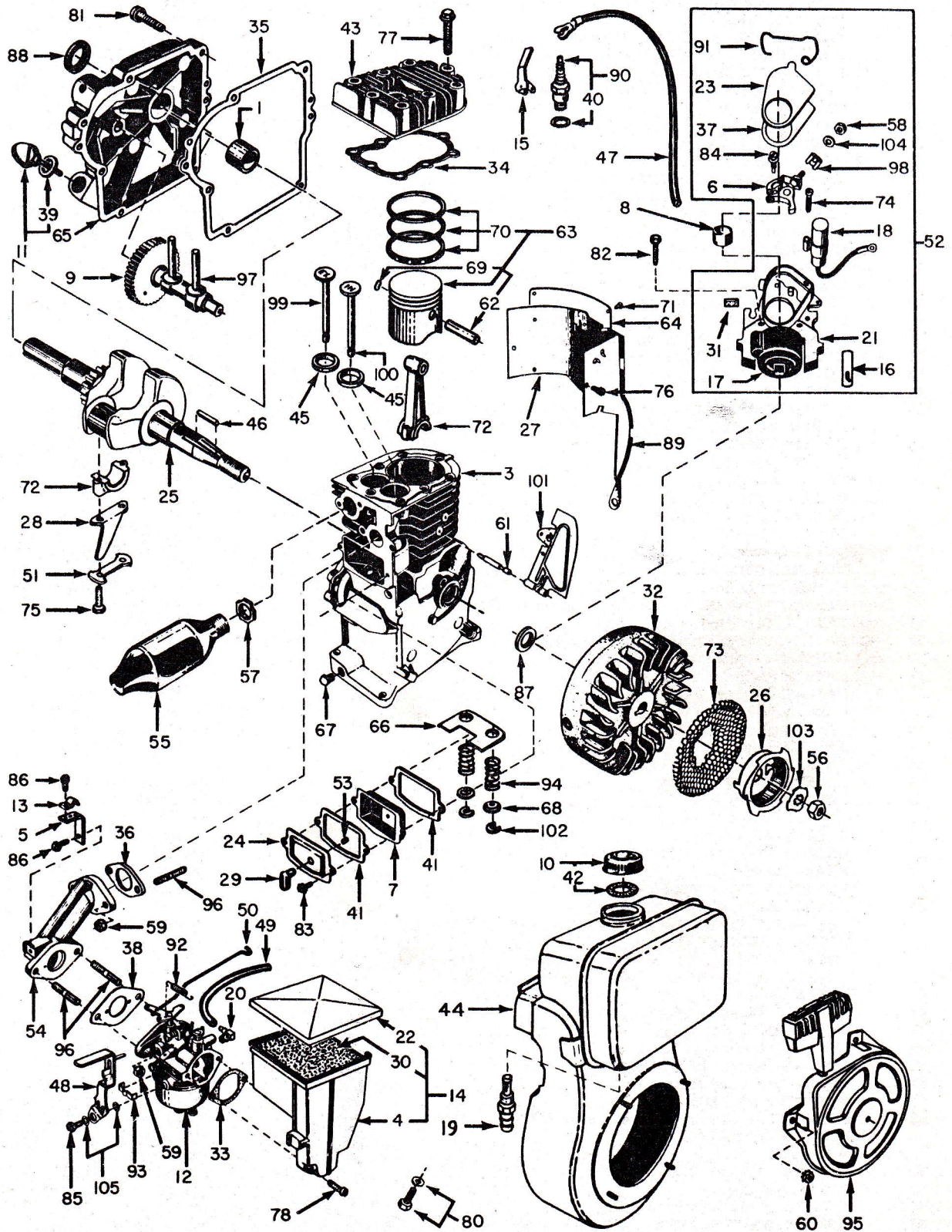

BASIC PARTS LIST

400-0100-000

File- SECTION II DIVISION 1962
400-0100-000-
BASIC PARTS LIST
REVISED APRIL, 1963



CLINTON ENGINES CORPORATION

MAQUOKETA, IOWA

Printed in U.S.A.

There are three (3) types of the 400-0100-000 Series covered by this Basic Parts List. Parts not used on all types are noted. Refer to Serial Number suffix 'A' as Type 'A', etc.

Refer to Page C on "How to Identify Your Clinton Engine."

Ref. No.	Parts Description	IBM No.	Part No.	Qty.
1	BEARING-Sleeve (Plate Assembly).....	20-56	21016	1
	BEARING-Main Sleeve (Cylinder Block) (Service Part).....	20-58	90278	1
3	BLOCK ASSEMBLY-Cylinder.....	22-719-500	92018-A	1
4	BODY-Air Cleaner.....	2-157		1
5	BRACKET-Remote Control Clamp.....	26-602		1
6	BREAKER POINTS ASSEMBLY.....	135-6-500	5735	1
7	BREATHER ASSEMBLY-(Used on Type A).....	260-13	6354	1
	BREATHER ASSEMBLY-(Used on Types B & C).....	29-32-500		1
8	CAM-Magenta Breaker.....	157-29	5751	1
9	CAMSHAFT-(Used on Types A & B).....	6-337	91607	1
	*CAMSHAFT-(Used on Types C).....	6-431		1
10	CAP & GASKET ASSEMBLY-Fuel.....	45-395-500		1
11	CAP & GASKET ASSEMBLY-Oil Filler.....	45-110-500	21075-A	1
12	CARBURETOR ASSEMBLY-Float.....	39-796-500		1
13	CLAMP-Remote Control.....	81-13	31463	1
14	CLEANER ASSEMBLY-Air.....	2-157-500		1
15	CLIP-Ignition Shorting.....	266-28	3499	1
16	CLIP-Coil Holding.....	81-20	5734	1
17	COIL-Magneto (Without Laminations).....	135-13-990	5770	1
18	CONDENSER-Magneto.....	135-29-990	5589-A	1
19	CONNECTOR-Fuel Tank to Fuel Line.....	69-6	5055	1
20	CONNECTOR-Fuel Line to Carburetor.....	69-281		1
21	CORE & BREAKER BOX ASSEMBLY.....	135-37-500	5732	1
22	COVER-Air Cleaner.....	45-386		1
23	COVER-Dust, Magneto Breaker Points.....	45-15	5743	1
24	COVER-Valve Chamber (Used on Type A).....	45-82	10324	1
	COVER-Valve Chamber (Used on Types B & C).....	45-304	91466	1
25	CRANKSHAFT.....	46-353	21100-1	1
26	CUP-Starter.....	265-10	90871	1
	*DECAL-Arrowhead.....	58-450		1
	DECAL-Air Cleaner.....	58-387		1
	DECAL-Throttle Control.....	58-98	3488	1
	*DECAL-EZ Pull.....	58-460		1
27	DEFLECTOR-Air Cylinder.....	259-56	90504	1
28	DISTRIBUTOR-Oil.....	220-146		1
29	ELBOW-Breather.....	69-23	90610	1
30	ELEMENT-Air Cleaner.....	2-156-990		1
31	FELT-Lubrication, Cam Follower.....	94-189	5742	1
32	FLYWHEEL ASSEMBLY-With Magnets.....	83-10-500	5752-A	1
33	GASKET-Air Cleaner to Carburetor.....	94-516		1
34	GASKET-Cylinder Head.....	94-48-990	10253	1
35	GASKET-Bearing Plate, .015 Standard.....	94-107	10254	1
	Available in .010 Size.....	93-107	10254-1	1
36	GASKET-Asbestos (Manifold to Block).....	94-31	6002	1
37	GASKET-Cover, Dust (Breaker Points).....	94-241	5744	1
38	GASKET-Manifold to Carburetor.....	94-515		1
39	GASKET-Oil Filler Cap.....	94-81	3297	1
40	GASKET-Spark Plug.....	94-92-990	3115	1
41	GASKET-Valve Chamber Cover (1-on Type A, 2-on Types B & C).....	94-103	10251	2
42	GASKET-Fuel Cap.....	94-62	4519	1
	GASKET KIT-Engine Overhaul (See Bulletin No. 48 for content).....	149-586		1
43	HEAD-Cylinder.....	122-7	10011	1
44	HOUSING & TANK ASSEMBLY.....	259-409-500		1
45	INSERT VALVE SEAT-(Standard).....	136-19	10379	2
	INSERT VALVE SEAT-(.040 Oversize) Service Insert (Use TL-936).....	136-22	15119	2
	INSERT VALVE SEAT-(Std. Stellite) Service Insert.....	136-33-990	31512	1
	INSERT VALVE SEAT-(Stellite .040 Oversize) Service Insert (TL-936).....	136-108-990		1
	NOTE: Stellite Insert used on Exhaust side only.			
46	KEY-Flywheel.....	148-4	10339	1
47	LEAD-Hi-Tension, Magneto.....	307-194-990	90761	1
48	LEVER-Speed Adjusting.....	157-379-500		1
49	LINE-Flexible Fuel.....	158-25	6316	1
50	LINK-Carburetor to Air Vane.....	159-148		1
51	LOCK-Connecting Rod Screw.....	148-13	31018	1
52	MAGNETO ASSEMBLY.....	268-17-500	91740	1
53	MANDREL-Breather (Used on Types B & C).....	69-69	10353	1
54	MANIFOLD ASSEMBLY.....	169-90-500		1
55	MUFFLER.....	170-136-500		1
56	NUT-Hex. 1/2-20 (Starter Cup).....	183-68-990	5942	1
57	NUT-Lock, Muffler.....	183-37	4425	1
58	NUT-Terminal Condenser Lead.....	183-21	5740	1
59	NUT & L'WASHER ASS'Y-1/4-28 Hex. (Carb. Mounting) (Manifold to Block) ..	183-29-500	3255-A	4
60	NUT & L'WASHER ASS'Y-Recoil Starter.....	183-25-500	4107-A	4
61	PIN-Pivot, Air Vane Governor.....	203-91	90982	1
62	PIN-Wrist.....	203-65	7923	1

Ref. No.	Parts Description	IBM No.	Part No.	Qty.
63	PISTON ASSEMBLY-Standard.....	204-13-500	31001-A	1
	NOTE: Piston Assemblies are available in the following oversizes:			
	IBM Part No. Oversize Listed			
	Order by part no. and specify oversize			
	.010.....	206-13-500	31001-A (.010)	
	.020.....	207-13-500	31001-A (.020)	
64	PLATE-Name.....	58-105	6530	1
65	PLATE ASSEMBLY-Bearing.....	215-52-500	10047-A	1
66	PLATE-Valve Spring Retainer.....	215-136	10013	1
67	PLUG-1/4 N. P. T. (Oil Drain).....	216-19	3289	2
68	RETAINER-Valve Spring.....	304-135	3028	2
69	RING-Retainer, Wrist Pin.....	232-41	6034	2
70	RING SET-Standard.....	149-10	10023	1
	NOTE: Ring Sets are also available in the following oversizes:			
	IBM Part No. Oversize Listed			
	Order by part no. and specify oversize			
	.010.....	149-158	10023 (.010)	
	.020.....	149-159	10023 (.020)	
71	RIVET-Tubular (Name Plate).....	244-21	5460	4
72	ROD ASSEMBLY-Connecting.....	245-56-500	10002-A	1
73	SCREEN-Rotating.....	257-30	90872	1
74	SCREW-R. H. S. T. #8-32 x 4/5 (Condenser to Plate).....	258-299	5741	1
75	SCREW-R. H. C. 1/4-28 x 1-1/4 (Connecting Rod Cap).....	258-9	3235	2
76	SCREW-S. H. S. T. #8-32 x 3/8 (Deflector to Block).....	258-81	5644	2
77	SCREW-H. W. H. 5/16-18 x 1-7/8 (Cylinder Head to Block).....	258-88	5654	8
78	SCREW-R. H. M. #8-32 x 11/16 (Air Cleaner to Carburetor).....	258-105	5677	2
80	SCREW & L'WASHER ASS'Y-H. H. C. 1/4-20 x 1/2 (Blower Housing to Block).....	258-280-500	3205-G	2
81	SCREW & L'WASHER ASS'Y-H. H. C. 1/4-20 x 1-1/4 (Bearing Plate to Block).....	258-254-500	5613-G	7
82	SCREW & L'WASHER ASS'Y-H. H. C. #10-24 x 1 (Laminations to Block).....	258-108-500	5682-A	2
83	SCREW & L'WASHER ASS'Y-S. H. H. C. #10-24 x 1/2 (Valve Chamber Cover).....	258-82-500	5645-A	2
84	SCREW & L'WASHER ASS'Y-R. H. M. #8-32 x 3/8.....	258-82-500	5645-A	2
	(Breaker Points to Breaker Box)			
85	SCREW & L'WASHER ASS'Y-R. H. M. #8-32 x 1/2 (Speed Adj. Lever).....	258-247-500	5443-D	1
86	SCREW & L'WASHER ASS'Y-#8-32 x 3/8 (Remote Control Bracket).....	258-81-500	5644-A	2
87	SEAL-Oil (Block).....	94-178-990	10012	1
88	SEAL-Oil (Bearing Plate).....	94-162-990	3026	1
89	SHEILD-Flywheel.....	259-318	90502	1
90	SPARK PLUG & GASKET ASSEMBLY-(H-10).....	267-28-500	16303-A	1
91	SPRING-Breaker Box Cover.....	263-10	5745	1
92	SPRING-Speed Adj.....	263-343		1
93	SPRING-Positioning.....	263-327	14802	1
94	SPRING-Valve.....	263-92	3068	2
95	STARTER ASSEMBLY-Recoil (Refer to Sec. III, Div. H, Page 12).....	265-28-500	13516	1
96	STUD-Carburetor Mounting (Carburetor to Manifold) (Manifold to Block).....	24-11	5659	4
97	TAPPET-Valve.....	278-5	10009	2
98	TERMINAL-Jamtite Breaker Points.....	307-230	5738	1
99	VALVE-Exhaust.....	291-8-990	10301	1
	VALVE-Exhaust .010 Oversize.....	292-20-990	10321	1
100	VALVE-Intake.....	291-9-990	10302	1
	VALVE-Intake .010 Oversize.....	292-7-990	10322	1
101	VANE-Air Governor.....	107-30	91033	1
102	WASHER-"C" Valve Keeper.....	304-90	3291	2
103	WASHER-Starter Cup.....	304-5	5879	1
104	WASHER-Terminal Condenser Lead.....	304-290	5739	1
105	WASHER-Wave (Speed Adj.).....	304-145	7469	2

*Indicates New Part Nos. Listed For The First Time.

SERVICE INFORMATION 400-0100-000 SERIES

Type of Carburetion	-----	Float
Bore	-----	2-3/8"
Stroke	-----	1-5/8"
Cubic Inch Displacement	-----	7.2
Spark Plug Gap	-----	.025 to .028
Point Setting	-----	.018 to .021
Oil Capacity	-----	1-1/4 Pints
Bearing-Flywheel End	-----	Aluminum
Bearing-PTO End	-----	Bronze
Valve Lash Setting	-----	.009 to .011
RPM-Horsepower Rating	-----	2-3/4 @ 3600
Block Construction	-----	Die-Cast Aluminum with Cast Iron

1. For installation information on Service Bearing (Flywheel End), refer to Sec. VI, Div. C, and to the supplement to Sec. VI, Div. C, Issued September 15, 1961.
2. Chrome "Re-Ring" Set (Refer to Service Bulletin No. 4) 149-603.
3. Replacement Valve insert (.040 Oversize) 15119.
4. Tools required for service of oversize Valve Seat are TL-936 Cutter, TL-951 Driver, and TL-952 Rolling Tool.
5. For Short Block information, refer to Service Bulletin No. 5.

Clinton MODEL VARIATIONS

400-0100-000

SEC. II, DIVISION 1962

Issued April, 1963

Revised May, 1965

The adaptation of Clinton Engines to a wide variety of uses, results in what is known as Model Variations. Following is a list of Models produced to date. Opposite each Engine Model listed are the Part Numbers required in addition to or in place of standard parts. Refer to Basic Parts List for parts not listed in the Model Variations. For replacement engine to fit special applications, external part changes may be required.

UNITS MARKED WITH A () INDICATES CRANKSHAFT CHANGE.
See Page C of this Manual on "How to Identify Your Clinton Engine."

MODELS	CRANKSHAFT Ref. to Sec. IV Div. B	NOTES	REPL. ENGINE #	MODELS	CRANKSHAFT Ref. to Sec. IV Div. B	NOTES	REPL. ENGINE #
400-0100-001	46-352		(21415)	400-0100-049	46-353	6,20	21415
400-0120-002	46-359	1	Note 57	400-0100-050	46-353	6, 9, 11, 46	21415
400-0140-003	46-360	1	Note 57	400-0100-051	46-353	11, 14, 20,	Note 57
400-0160-004	46-510	1	21416			24, 38, 46, 55	
400-0300-005	46-354	2, 45	21417	400-1100-052	46-353	5, 25, 47	Note 57
400-0300-006	46-483	2, 45	21600	400-0100-053	46-362	6	(21415)
400-0300-007	46-481	2, 45	(21417)	400-1300-054	46-354	2, 5, 7, 45,	21417
400-0300-008	46-482	2, 45	(21417)			47	
400-0300-009	46-354	2, 3, 40, 45	21417	400-0100-055	46-353	6	21415
400-0300-010	46-354	2, 4, 40, 45,	21417	400-0300-056	46-354	2, 6, 11, 45,	21417
		46				46	
400-1300-011	46-483	2, 5, 6, 45, 47	21600	400-0300-057	46-354	2, 15, 45	21417
400-1300-012	46-354	2, 5, 6, 7, 45,	21417	400-1300-058	46-354	2, 5, 45, 47	21417
		47		400-1300-059	46-354	2, 4, 5, 45, 49	21417
400-0100-013	46-353	6, 9, 11, 46	21415	400-0300-060	46-481	2, 4, 45, 46	(21417)
400-1300-014	46-354	2, 4, 5, 6, 45,	21417	400-1160-061	46-510	1, 5, 47	21416
		49		400-1300-062	46-354	2, 4, 5, 7, 45,	21417
400-1300-015	46-354	2, 5, 6, 45, 47	21417			49	
400-1100-016	46-353	4, 5, 6, 49	21415	400-0300-063	46-354	2, 3, 6, 11,	21417
400-1100-017	46-353	5, 47	21415			26, 45	
400-1160-018	46-510	1, 4, 5, 6, 49	21416	400-1300-064	46-826	2, 4, 5, 11, 12,	Note 57
400-1160-019	46-510	1, 5, 6, 47	21416			49, 53, 58	
400-0300-020	46-354	2, 6, 9, 11,	21417	400-1300-065	46-354	2, 5, 6, 11,	21417
		45, 46				45, 47	
400-0160-021	46-510	1, 6, 9, 11, 46	21416	400-0300-066	46-354	2, 6, 45	21417
400-1100-022	46-353	5, 6, 10, 49	21415	400-1160-067	46-510	1, 5, 6, 10,	21416
400-1160-023	46-510	1, 5, 6, 10, 49	21416			15, 49	
400-1300-024	46-354	2, 5, 6, 10,	21417	400-0140-068	46-360	1, 3, 20	Note 57
		45, 49		400-1300-069	46-481	2, 5, 6, 25,	Note 57
400-1100-025	46-353	5, 6, 47	21415			45, 49	
400-0300-026	46-483	2, 4, 6, 45,	21600	400-0100-070	46-353	3, 6, 11, 38	21415
		46		400-0300-071	46-354	2, 3, 28, 40,	21417
400-0300-027	46-354	2, 4, 6, 45, 46	21417			45, 54	
400-0300-028	46-354	2, 6, 8, 10, 45,	21417	400-1300-072	46-354	2, 5, 10, 45,	21417
		46				49	
400-0300-029	46-354	2, 4, 45, 46	21417	400-0300-073	46-354	2, 10, 45, 46	21417
400-0300-030	46-354	2, 11, 45	21417	400-1300-074	46-483	2, 5, 6, 25,	Note 57
400-0100-031	46-353	11	21415			45, 49	
400-0160-032	46-510	1, 11	21416	400-0100-075	46-673	10, 11, 29,	21415
400-0100-033	46-353	6, 8	21415			38, 46	
400-0120-034	46-359	1, 4, 46	Note 57	400-0100-076	46-353	6	21415
400-0100-035	46-353	6, 10, 46	21415	400-0300-077	46-354	2, 4, 20,	21417
400-0100-036	46-673	11, 38, 40	(21415)			45, 46	
400-0100-037	46-353		21415	400-1100-078	46-353	5, 47, 48	21415
400-1300-038	46-483	2, 5, 45, 47	21600	400-0160-079	46-510	1, 30, 31, 38,	21416
400-0100-039	46-353	10, 46	21415			54	
400-1300-040	46-826	2, 4, 5, 11,	Note 57	400-1120-080	46-359	1, 5, 47	Note 57
		12, 49, 53, 58		400-1300-081	46-354	2, 5, 45, 47	21417
400-0300-041	46-826	2, 4, 6, 11, 45,	(21417)	400-1300-082	46-483	2, 5, 25, 45,	Note 57
		46				49	
400-1300-042	46-354	2, 5, 7, 10,	21417	400-0100-083	46-673	8, 19, 31, 32,	(21415)
		45, 49				33, 38, 46	
400-1300-043	46-482	2, 5, 11, 12,	(21417)	400-1100-084	46-353	5, 10, 49	21415
		47, 53, 58		400-0300-085	46-354	2, 18, 20, 45	21417
400-0300-044	46-354	2, 3, 6, 14,	21417	400-1300-086	46-483	2, 5, 25, 45,	Note 57
		45, 55				49	
400-0300-045	46-483	2, 6, 45	21600	400-0100-087	46-353	8, 31, 33, 34,	21415
400-0300-046	46-354	2, 12, 13, 14,	Note 57			54	
		16, 17, 56, 58		400-0160-088	46-510	1	21416
400-0100-047	46-353	20, 21, 38	21415	400-0300-089	46-354	2, 3, 8, 30, 35,	21417
400-0300-048	46-354	2, 6, 45	21417			45, 46	

MODELS	CRANKSHAFT Ref. to Sec. IV Div. B	NOTES	REPL. ENGINE #	MODELS	CRANKSHAFT Ref. to Sec. IV Div. B	NOTES	REPL. ENGINE #
400-1300-090	46-354	2, 5, 10, 20, 45, 49	21417	400-1300-140	46-354	2, 5, 8, 30, 35, 45, 47	21417
400-1300-091	46-354	2, 5, 20, 25, 45, 49	Note 57	400-0300-141	46-482	2, 8, 26, 30, 31, 39, 45, 46	(21417)
400-1100-092	46-353	3, 5, 15, 31, 33, 34, 49	21415	400-0100-142	46-353		21415
400-0300-093	46-354	2, 6, 7, 22, 54	21417	400-1300-143	46-354	2, 5, 7, 10, 45, 49	21417
400-0100-094	46-353		21415	400-1120-144	46-359	1, 5, 7, 10, 49	Note 57
400-0120-095	46-359	1, 20	Note 57	400-0100-145	46-353	10, 46, 59	21415
400-0300-096	46-354	2, 9, 11, 36, 45, 46, 55	21417				
400-0100-097	46-353	10, 46	21415				
400-0100-098	46-353	38	21415				
400-1160-099	46-510	1, 5, 25, 49	Note 57				
400-1100-100	46-353	5, 8, 20, 30, 31, 38, 47	21415				
400-0300-101	46-354	2, 30, 31, 32, 45, 46	21417				
400-0100-102	46-353	8, 33, 34, 35	21415				
400-0300-103	46-481	2, 10, 45, 46	(21417)				
400-0160-104	46-510	1, 11, 15, 27, 46, 48	21416				
400-1300-105	46-354	2, 5, 7, 8, 10, 11, 12, 49, 53	Note 57				
400-0100-106	46-353	15	21415				
400-0100-107	46-353	11, 14, 24, 38, 46, 55	21415				
400-0100-108	46-353	6, 11	21415				
400-0300-109	46-354	2, 6, 11, 45	21417				
400-1300-110	46-483	2, 5, 7, 27, 45, 49, 50	21600				
400-0100-111	46-353	6, 11, 38	21415				
400-0300-112	46-354	2, 6, 11, 45	21417				
400-1300-113	46-483	2, 5, 45, 47	21600				
400-0120-114	46-359	1	Note 57				
400-0100-115	46-353		21415				
400-0100-116	46-353	18, 20	21415				
400-0160-117	46-510	1, 6, 10, 11, 38, 46	21416				
400-0300-118	46-483	2, 6, 10, 11, 45, 46	21600				
400-0300-119	46-354	2, 3, 20, 45	21417				
400-0100-121	46-353	6, 38	21415				
400-0300-122	46-486	2, 12, 53, 58	(21417)				
400-1100-123	46-353	5, 7, 47	21415				
400-0300-124	46-354	2, 3, 8, 30, 35, 45	21417				
400-0120-125	46-359	1, 3, 20	Note 57				
400-0100-126	46-673	6, 10, 46	(21415)				
400-1300-127	46-354	2, 5, 7, 45, 47	21417				
400-1100-128	46-353	5, 23, 38, 47	21415				
400-0300-129	46-354	2, 10, 45, 46	21417				
400-1100-131	46-353	5, 47	21415				
400-7300-132	46-354	2, 5, 41, 45, 47	Note 57				
400-0300-133	46-354	2, 30, 32, 35, 45, 46	21417				
400-0100-134	46-673	8, 37, 42, 43, 44	(21415)				
400-0100-135	46-353	8, 37, 42, 43, 44	21415				
400-1100-136	46-353	3, 5, 47	21415				
400-1160-137	46-510	1, 5, 7, 47	21416				
400-0100-138	46-353	8, 18, 20, 23, 43, 52, 63	21415				
400-1300-139	46-354	2, 5, 45, 47	21417				

400 SERIES MODEL VARIATIONS

- Note 1 Use 94-163-990 Seal Oil. Refer to Sec. III, Div. C, Page 1, for exploded view & parts usage for reduction units.
- Note 2 Use 232-30 Retainer, 232-29 Retainer, 232-36 Spacer, 94-166-990 Seal and 20-4 Bearing (Ball), 304-467 Washer, Thrust to Cam Gear.
- Note 3 Use 293-167 Valve (Fuel Shut-Off).
- Note 4 Use 277-69-500 Tank Ass'y (Fuel), 304-134 Washer (Tank Bracket to Block), (2) 183-53 Nut, 26-605-500 Bracket (Tank Mounting), (2) 26-607 Strap, (2) 258-244-500 Screw & L'Washer, and 293-37 Valve (Fuel Shut-Off).
- Note 5 Use 257-25 Screen, 219-17 Pulley (Starting), 304-132 Washer (Flywheel) and 246-13-500 Rope (Starting).
- Note 6 Use 39-942-500 Carburetor, 157-391 Lever (Fixed Speed), 258-247-500 Screw and 26-628 Bracket (Remote Control Clamp).
- Note 7 Use 910-35 Air Horn, 94-11 Gasket (Horn to Cleaner), 2-2-500 Air Cleaner (Oil Bath), 258-163 Screw (Cleaner to Horn) and 183-66 Nut (Wing).
- Note 8 Use 170-18 Muffler (45°), 183-37 Nut (Lock).
- Note 9 Use 69-291 Elbow (to Carb.), 277-396-500 Tank Ass'y (Fuel), (2) 183-53 Nut, 26-605-500 Bracket (Tank Mounting), (2) 26-606 Strap, (2) 258-244-500 Screw & L'Washer, 293-170 Valve (Fuel Shut-Off), 69-287 Connector (to Shut-Off Valve), 158-406 Line (Fuel), and (2) 183-244 Nut & Ferrule Ass'y.
- Note 10 Use 277-396-500 Tank Ass'y (Fuel), (2) 183-53 Nut, 26-605-500 Bracket (Tank Mounting), (2) 26-606 Strap, (2) 258-244-500 Screw & L'Washer, 293-37 Valve (Fuel Shut-Off), 304-134 Washer (Tank Bracket to Block), and 258-238-500 Screw & L'Washer (Bracket to Block).
- Note 11 Use 158-67 Tube (Breather), 69-269 Connector, 69-23 Elbow, 69-69 Mandrel (Hose Retaining).
- Note 12 Use 39-942-500 Carburetor, 6-429-500 Camshaft & Governor Weight Ass'y, 109-7 Collar (Governor), 304-126 Washer (Governor Shaft), 109-14 Yoke (Governor), 6-64 Shaft (Governor Yoke), (2) 258-61-500 Screw & L'Washer, 232-32 Ring, 157-387 Arm (Governor), 107-3 Adjustor (Governor Arm), 304-121 Washer, 258-936-500 Screw & L'Washer, 258-105 Screw, 159-149 Link (Throttle Actuating), 304-559 Spacer (Governor Bracket), 26-557 Bracket (Throttle Adj.), 258-898-500 Screw & L'Washer, 183-63 Nut (Throttle Adjusting), 245-10 Rod (Throttle Adj.), 263-325 Spring (Speed Regulating) and 183-54 Nut.
- Note 13 Use 233-136-500 Chrome Ring Set.
- Note 14 Use 291-13-990 Valve (Exhaust-Stellite). Use standard Exhaust Valve on intake side.
- Note 15 Use 307-31-500 Cable (Remote Control). Cable supplied in 72" length only, cut to length required.
- Note 16 Clinton does not supply Intake Manifold, Carburetor or Air Cleaner for this unit.
- Note 17 Use 307-120-500 Shorting Wire and 69-25 Elbow (Fuel Tank).
- Note 18 Use 45-66 Cover (Spark Plug).
- Note 19 Use 69-55 Air Horn, 69-24 Elbow, 158-69 Tube Breather.
- Note 20 Use 307-120-500 Wire Ass'y (Shorting), 183-26 Nut (Wire to Stator Ass'y), 70-10 Grommet, 183-31 Nut (Insulation), 266-26 Clip (Shorting), 258-83 Screw (Clip to Insulation Nut), and 26-601 Bracket (Shorting Wire).
- Note 21 Use 216-24 Plug (Oil Drain).
- Note 22 Use 215-502 Plate Bearing, 216-41 Plug (Pivot Pin Hole), 258-144 Set Screw.
- Note 23 Use 307-120-500 Wire Ass'y (Shorting), 70-7 Grommet, 258-936-500 Screw and L'Washer Ass'y and 183-26 Nut (Wire to Stator).
- Note 24 Use 39-855-500 Carburetor, 26-641 Bracket (Regulator Mounting), 231-10-500 Regulator, (2) 258-82-500 Screw & L'Washer, 182-57 Jet Ass'y (Discharge), 293-175-500 Valve Ass'y (Inlet Adjusting), 69-294-500 Connector Group (Idle Fuel), (4) 81-7 Clamp (Fuel Line), 69-295-500 Elbow Ass'y.
- Note 25 Use 122-8 Head (Cylinder), 277-64-500 Tank Ass'y (Dual Compartment), 26-55-500 Bracket (Tank Mtg.), (2) 26-159 Strap, (2) 258-254-500 Screw & L'Washer, (2) 183-1 Nut, (2) 69-24 Elbow (Fuel Line), 69-59 Nipple-Pipe, 293-10 Valve (3-Way), 69-5 Connector (Fuel Line), 304-134 Washer (Tank Bracket to Block), 258-238-500 Screw & L'Washer (Bracket to Block), 158-357 Fuel Line, Cut to Length Required.
- Note 26 Use 45-68-500 Cover (Spark Plug Shorting).
- Note 27 Use 277-449-500 Tank Ass'y, 26-605-500 Bracket (Tank Mounting), (2) 26-607 Strap (Fuel Tank), (2) 258-244-500 Screw & L'Washer.
- Note 28 Use 39-194-990 Carburetor, 94-13 Gasket (Air Cleaner to Carb.), 2-144 Body (Air Cleaner), 304-562 Washer, 45-337 Cover (Air Cleaner), 2-175-990 Element, (2) 258-131 Screw (Air Cleaner Body to Carb.), and 159-21 Link (Air Vane), 69-5 Connector (Carburetor to Fuel Line).
- Note 29 Use 69-16 Elbow (Muffler).
- Note 30 Use 39-194-990 Carburetor, 69-54 Air Horn, 159-21 Link (Air Vane), 69-5 Connector (Fuel Line), 157-120-500 Bracket (Speed Adjusting), 258-272-500 Screw & L'Washer, 263-34 Spring, 258-889 Screw, 304-88 Washer, 157-360-500 Lever (Speed Adjusting), 258-205 Screw (Shoulder), 304-565 Washer (Bowed) and 263-73 Spring.
- Note 31 Use 2-9-500 Air Cleaner, 94-11 Gasket (Air Cleaner to Air Horn), 304-136 Washer (Screw to Flat Washer), 258-72 Screw (Air Cleaner to Air Horn), 304-134 Washer (Top of Air Cleaner to Fiber Washer), 304-28 L'Washer (Air Horn to Wing Nut) and 183-66 Nut (Wing).
- Note 32 Use 277-69-500 Tank Ass'y (Fuel), (2) 183-1 Nut, 26-55-500 Bracket (Tank Mounting), (2) 26-159 Strap, (2) 258-254-500 Screw & L'Washer and 293-37 Valve (Fuel Shut-Off).
- Note 33 Use 39-194-990 Carburetor, 159-21 Link (Governor), 69-24 Connector (Fuel), 26-569-500 Bracket, 157-359-500 Lever (Speed Control), 258-107 Screw, 258-205 Screw (Shoulder), and 263-73 Spring.
- Note 34 Use 69-54 Air Horn.
- Note 35 Use 94-11 Gasket (Air Cleaner to Air Horn), 2-2-500 Air Cleaner, 258-163 Screw (Air Cleaner to Air Horn) and 183-66 Wing Nut.
- Note 36 Use 263-89 Spring (Valve-Exhaust), 291-19-500 Roto-Cap, 291-16 Valve (Stellite Exhaust) and 203-58 Pin (Valve). Use standard Exhaust Valve on intake side.
- Note 37 Use 215-514-500 Plate Bearing P. T. O., 216-41 Plug (Pivot Pin Hole) and 258-144 Set Screw.
- Note 38 Use 215-488-500 Plate Bearing P. T. O.
- Note 39 Use 277-396-500 Tank Ass'y, 26-55-500 Bracket, (2) 26-671 Strap, (2) 258-32 Screw, (2) 183-29-500 Nut.
- Note 40 Use 170-70-500 Muffler.
- Note 41 Use 83-106-500 Flywheel, 307-298 Sleeve Insulating, 268-18-500 Magneto. Refer to Sec. III, Div. N for Magneto parts; however use 135-265-500 Condenser.

- Note 42 Use 26-702-500 Slide Ass'y, 31-3 Primer Bulb Kit, 159-21 Link, 39-955-500 Carburetor, 259-727 Shroud, and 263-383 Spring, Speed Regulating.
- Note 43 Use 2-139 Body (Air Cleaner), 304-562 Washer, 2-175-990 Element, and 45-337 Cover.
- Note 44 Use 304-614 Spacer, 69-5 Connector, 69-69 Mandrel, 158-67 Tube and (2) 258-902 Screw.
- Note 45 Use 215-489 Plate Bearing P. T. O.
- Note 46 Use 259-123-500 Housing Blower.
- Note 47 Use 259-646-500 Housing Blower.
- Note 48 Use 293-170 Valve (Fuel Shut Off), 69-287 Connector (Valve Fuel), 158-405 Line (Fuel), (2) 183-244 Nut & Ferrule Ass'y, 69-291 Elbow (Carburetor).
- Note 49 Use 259-119-500 Housing Blower.
- Note 50 Use 122-8 Head.
- Note 51 Use 900-340 Adaptor (Air Cleaner), (2) 258-902 Screw and 158-415 Tube Breather.
- Note 52 Use 39-961-500 Carburetor, 26-702-500 Slide Ass'y, 159-21 Link (Governor), 263-383 Spring Speed Reg., 259-727 Shroud (Carburetor), 81-12 Clamp (Remote Control), (2) 258-957-500 Screw & L'Washer.
- Note 53 Use 215-86 Plate Bearing P. T. O.
- Note 54 Use 259-734-500 Housing Blower.
- Note 55 Use 22-696-500 Block Cylinder.
- Note 56 Use 215-87 Plate Bearing P. T. O.
- Note 57 Special Engine Order, order by complete model number.
- Note 58 Use 22-541-500 Block Cylinder.
- Note 59 Use 307-120-500 Wire (Shorting), 70-10 Grommet, 266-53 Switch Shorting, 215-134 Plate Switch (Mounting) and 183-21 Nut.

Printed in U. S. A.