

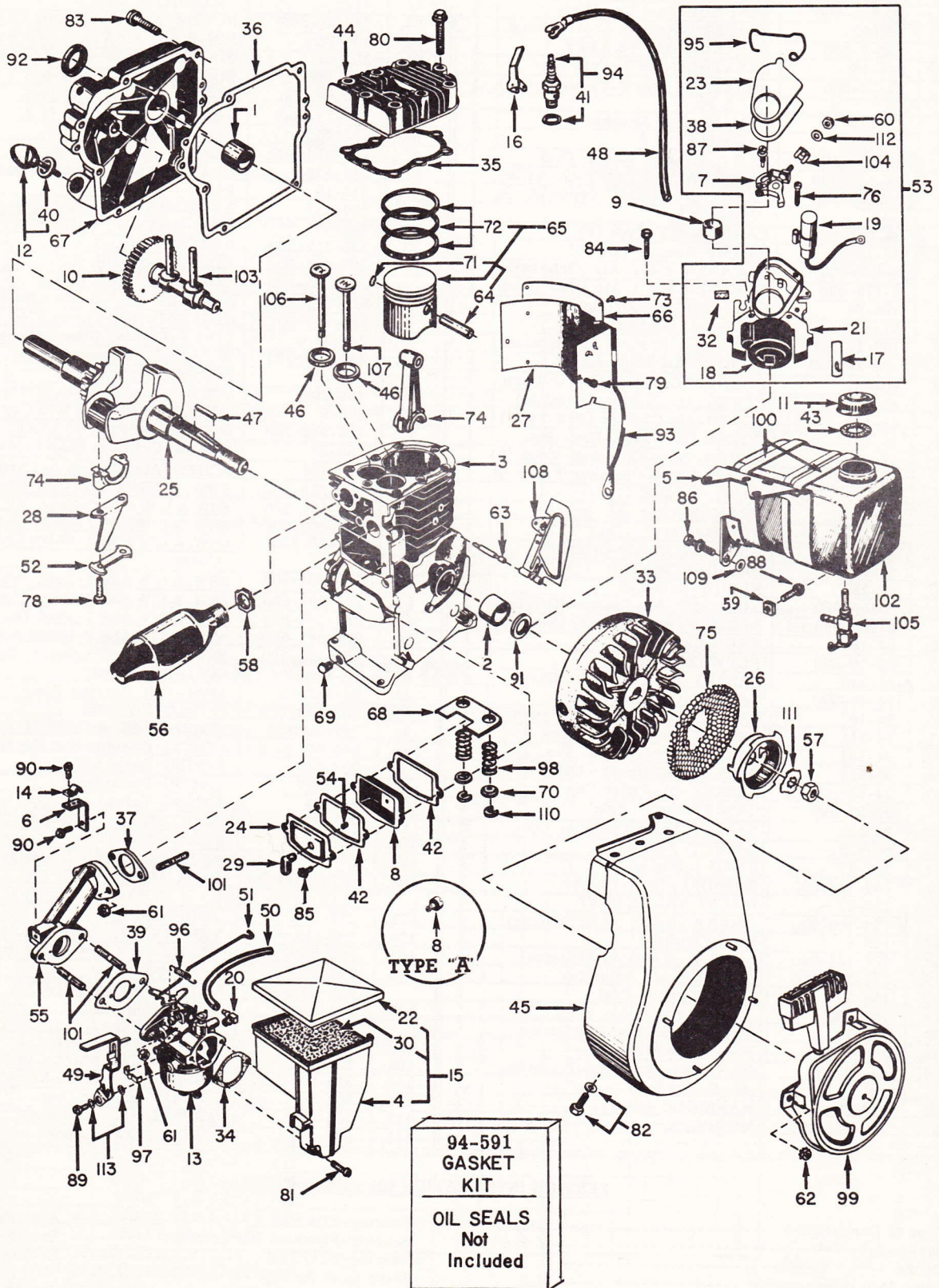

# BASIC PARTS LIST

## 404-0100-000

SEC. II, DIVISION 1962  
404-0100-000  
ISSUED APRIL, 1963  
REVISED JUNE, 1966



**CLINTON ENGINES CORPORATION**  
MAQUOKETA, IOWA

Printed in U. S. A.



404-0100-000 BASIC PARTS LIST

Ref. No.	Part Number	Description	Qty.	Ref. No.	Part Number	Description	Qty.
1.	20-56	BEARING-Sleeve (Plt. Ass'y)	1	57.	183-68-990	NUT-Hex. (Starter Cup)	1
2.	20-58	BEARING-Main Sleeve (Cyl. Blk.)	1	58.	183-37	NUT-Lock, Muffler	1
3.	22-543-500	BLOCK ASS'Y-Cylinder	1	59.	183-53	NUT-Square (Tank Straps)	2
4.	2-157	BODY-Air Cleaner (Original)	1	60.	183-21	NUT-Terminal Cond. Lead	1
	2-137	BODY-Air Cleaner (New Type)	1	61.	183-29-500	NUT & L'W ASS'Y- (Carb. Mtg.)	4
5.	26-605-500	BRACKET-Fuel Tk. Mtg.	1			(Manifold to Block)	
6.	26-602	BRACKET-Remote Cont. Clamp	1	62.	183-25-500	NUT & L'W ASS'Y-Recoil Starter	4
7.	135-7-500	BREAKER POINTS ASS'Y	1	63.	203-91	PIN-Pivot, Air Vane Governor	1
8.	260-13	BREATHER ASS'Y-Type (A)	1	64.	203-65	PIN-Wrist	1
	29-32-500	BREATHER ASS'Y-Types (B, C, D	1	65.	204-13-500	PISTON ASS'Y-Standard	1
		E & F)			206-13-500	PISTON ASS'Y-(.010) O. S.	
9.	157-29	CAM-Magneto Breaker	1		207-13-500	PISTON ASS'Y-(.020) O. S.	
10.	6-432	CAMSHAFT	1	66.	58-105	PLATE-Name	1
11.	45-424-500	CAP & GASKET ASS'Y-Fuel	1	67.	215-514-500	PLATE ASS'Y-Bearing	1
12.	45-110-500	CAP & GASKET ASS'Y-Oil Filler	1	68.	215-136	PLATE-Valve Spring Retainer	1
13.	39-796-500	CARB. ASS'Y-Float Types (A, B,	1	69.	216-19	PLUG-Oil Drain	2
		C, D, & E)		70.	304-135	RETAINER-Valve Spring	2
	39-941-500	CARB. ASS'Y-Type (F)	1	71.	232-41	RING-Retainer, Wrist Pin	2
14.	81-13	CLAMP-Remote Control	1	72.	233-112-500	RING SET-Std.	1
15.	2-157-500	CLEANER ASS'Y-Air (Original)	1		235-121-500	RING SET-(.010) O. S.	
	2-178-500	CLEANER ASS'Y-Air (New Type)	1		237-121-500	RING SET-(.020) O. S.	
16.	266-28	CLIP-Ignition Shorting	1		233-136-500	RING SET-Std. Chrome Re-Ring	
17.	81-20	CLIP-Coil Holding	1		237-136-500	RING SET-.020 Chrome Re-Ring	
18.	135-13-990	COIL-Mag. (Without Laminations)	1	73.	244-21	RIVET-Tubular (Name Plate)	4
19.	135-29-990	CONDENSER-Magneto	1	74.	245-102-500	ROD ASS'Y-Connecting	1
20.	69-281	CONNECTOR-Fuel Line to Carb.	1	75.	257-30	SCREEN-Rotating	1
22.	45-386	COVER-Air Cleaner (Original)	1	76.	258-299	SCREW-Condenser to Plate	1
	45-413	COVER-Air Cleaner (New Type)	1	78.	258-9	SCREW-Connecting Rod Cap	2
23.	45-15	COVER-Dust, Mag. Brk. Pts.	1	79.	258-936-500	SCREW-Deflector to Block	2
24.	45-82	COVER-Valve Chamber Type (A)	1	80.	258-88	SCREW-Cylinder Head to Block	8
	45-304	COVER-Valve Chamber Types (B,	1	81.	258-105	SCREW-Air Cleaner to Carb.	2
		C, D, E, & F)		82.	258-280-500	SRW. & L'W ASS'Y-Biw. Hsg. to Blk 2	
25.	46-403	CRANKSHAFT	1	83.	258-254-500	SRW. & L'W ASS'Y-Brng. Plt. to Blk 7	
26.	265-10	CUP-Starter	1	84.	258-108-500	SRW. & L'W ASS'Y-Lam. to Block 2	
27.	259-56	DEFLECTOR-Air Cylinder	1	85.	258-82-500	SRW. & L'W ASS'Y-Valve Chamber 2	
28.	220-147	DISTRIBUTOR-Oil	1			Cover	
29.	69-23	ELBOW-Breather	1	86.	258-261-500	SRW. & L'W ASS'Y-Tank Bracket	1
30.	2-156-990	ELEMENT-Air Cleaner (Original)	1	87.	258-297-500	SRW. & L'W ASS'Y-Brk. Pts.	1
	2-205-990	ELEMENT-Air Cleaner (New Type)	1	88.	258-244-500	SRW. & L'W ASS'Y-Fuel Tk. Straps 2	
32.	94-189	FELT-Cam	1	89.	258-247-500	SRW. & L'W ASS'Y-Speed Adj.	1
33.	83-10-500	FLYWHEEL ASS'Y	1	90.	258-936-500	SRW. & L'W ASS'Y-Remt. Cont. Brk 2	
34.	94-516	GASKET-Air Cleaner to Carb.	1	91.	94-178-990	SEAL-Oil, Block	1
35.	94-48-990	GASKET-Cylinder Head	1	92.	94-162-990	SEAL-Oil, Bearing Plate	1
36.	94-107	GASKET-Brng. Plt. (.015) Std.	1	93.	259-659-500	SHIELD-Flywheel	1
37.	94-31	GASKET-Manifold to Block	1	94.	267-28-500	SPARK PLUG & GASKET ASS'Y	1
38.	94-241	GASKET-Cover, Brk. Pts.	1	95.	263-10	SPRING-Breaker Box Cover	1
39.	94-515	GASKET-Manifold to Carb.	1	96.	263-372	SPRING-Speed Adj.	1
40.	94-81	GASKET-Oil Filler Cap	1	97.	263-327	SPRING-Positioning	1
41.	94-92-990	GASKET-Spark Plug	1	98.	263-92	SPRING-Valve	2
42.	94-103	GASKET-Valve Chamber Cover	2	99.	265-28-500	STARTER ASS'Y-Recoil	1
43.	94-620	GASKET-Fuel Cap	1	100.	26-606	STRAP-Fuel Tank	2
44.	122-17	HEAD-Cylinder	1	101.	24-11	STUD-Carburetor Mounting	4
45.	259-123-500	HOUSING ASS'Y-Blower	1	102.	277-396-500	TANK ASS'Y-Fuel	1
46.	136-22	INSERT VALVE SEAT	2				
	136-108-990	INSERT VALVE SEAT(Stellite)	1	103.	278-5	TAPPET-Valve	2
47.	148-4	KEY-Flywheel	1	104.	307-230	TERMINAL-Jamite Brk. Pts.	1
48.	307-194-990	LEAD-Hi-Tension, Magneto	1	105.	293-37	VALVE-Fuel Shut-Off, Flex. Line	1
49.	157-379-500	LEVER-Speed Adjusting	1	106.	291-8-990	VALVE-Exhaust	1
50.	158-25	LINE-Flexible Fuel	1		292-20-990	VALVE-Exhaust (.010) O. S.	1
51.	159-162	LINK-Carb. to Air Vane	1	107.	291-9-990	VALVE-Intake	1
52.	148-13	LOCK-Connecting Rod Screw	1		292-7	VALVE-Intake (.010) O. S.	1
53.	268-6-500	MAGNETO ASS'Y	1	108.	107-34	VANE-Air Governor	1
54.	69-69	MANDREL-Breather Types (B,	1	109.	304-134	WASHER-Tk. Bracket to Block	1
		C, D, E, & F)		110.	304-90	WASHER-"C" Valve Keeper	2
55.	169-90-500	MANIFOLD ASS'Y	1	111.	304-5	WASHER-Starter Cup	1
56.	170-136-500	MUFFLER	1	112.	304-290	WASHER-Terminal Cond. Lead	1
				113.	304-145	WASHER-Wave (Speed Adj.)	2

SERVICE INFORMATION 404-0100-000 SERIES

Type of Carburetion ----- Float  
 Bore ----- 2 3/8"  
 Stroke ----- 1 7/8"  
 Cubic Inch Displacement ----- 8.3  
 Spark Plug Gap ----- .025 to .028  
 Pointing Setting ----- .018 to .021  
 Oil Capacity ----- 1 1/4 Pint

Bearing-Flywheel ----- Aluminum  
 Bearing-Flywheel End (Service) ----- Bronze (20-58)  
 Bearing-PTO End ----- Bronze  
 Valve Lash Setting ----- .009 to .011  
 RPM-Horsepower Rating ----- 3 1/4 @ 3600  
 Block Construction ----- Die-Cast Alum.  
 with Cast Iron Sleeve



RECOIL STARTERS 265-28-500			
Ref. No.	Part Number	Description	265-28-500
1.	157-2	ACTUATOR	1
2.	*265-10	CUP-Starter	1
3.	121-6	HANDLE	1
4.	124-6-500	HOUSING-Includes Recoil Spring	1
5.	*183-25-500	NUT & L'WASHER ASSEMBLY	4
6.	157-129-500	PAWL & PIN ASSEMBLY	1
7.	219-28-500	PULLEY ASSEMBLY	1
8.	232-147	RING-Retaining	1
9.	232-35	RING-Retaining	1
10.	246-7	ROPE	1
11.	*257-30	SCREEN (Not Illustrated)	1
12.	*258-191	SCREW-Pan Head	4
13.	263-133	SPRING-Actuator	1
14.	263-79	SPRING-Recoil	1
15.	304-320	WASHER	1

\* Indicates Parts Not Included with Recoil Assembly.

IMPULSE STARTER 265-196-500			
Ref. No.	Part Number	Description	265-196-500
1.	20-208	BALL-Bearing	2
2.	*81-167	CLIP-Handle	1
3.	45-384-500	COVER ASS'Y-Bottom	1
4.	106-259	GEAR	1
5.	124-164-500	HOUSING ASSEMBLY	1
6.	265-216-500	PLUNGER ASSEMBLY	1
7.	265-240	RATCHET & SPRING KIT	1
8.	232-157	RING-Retaining Ball	1
9.	*244-47	RIVET-Clip to Handle	1
10.	258-918-500	SCREW & L'W ASS'Y-Cover	4
11.	263-337-500	SPRING ASS'Y-Power	2

\* Not used on all Impulse Starters; Handle will show evidence of installation if factory applied.

CARBURETOR										
39-188-990, 39-194-990, 39-198-990, 39-796-500, 39-941-500, 39-955-500, 39-961-500 & 39-968-500										
Ref. No.	Part Number	Description	39-188-990	39-194-990	39-198-990	39-796-500	39-941-500	39-955-500	39-961-500	39-968-500
1.	25-41-500	BOWL & DRAIN	1	1	1	1	1	1	1	1
	25-16-500	BOWL & DRAIN	1	1	1	1	1	1	1	1
2.	39-909	DRAIN ASSEMBLY	1	1	1	1	1	1	1	1
3.	82-2-500	FLOAT & LEVER ASSEMBLY	1	1	1	1	1	1	1	1
	82-22-500	FLOAT & LEVER ASSEMBLY	1	1	1	1	1	1	1	1
4.	*39-928	GASKET KIT	1	1	1	1	1	1	1	1
5.	181-2	NEEDLE-Idle Adjustment	1	1	1	1	1	1	1	1
6.	*181-5-500	NEEDLE-Power Adjustment	1	1	1	1	1	1	1	1
7.	*293-30-500	NEEDLE & SEAT INLET	1	1	1	1	1	1	1	1
8.	**182-37	NOZZLE-Service Replace	1	1	1	1	1	1	1	1
9.	39-910	REPAIR KIT	1	1	1	1	1	1	1	1
10.	39-938	PLUG KIT	1	1	1	1	1	1	1	1
11.	263-82	SPRING-Idle Needle & Throttle Stop	2	2	2	2	2	2	2	2
11A.	258-60	SCREW-Throttle Stop	1	1	1	1	1	1	1	1
12.	263-165	SPRING-Choke Return				1	1			
13.	6-447	CHOKE SHAFT KIT	1	1	1				1	
	6-493	CHOKE SHAFT KIT				1	1			
	6-490	CHOKE SHAFT KIT								1
14.	6-445	THROTTLE SHAFT KIT			1					
	6-488	THROTTLE SHAFT KIT						1	1	
	6-453	THROTTLE SHAFT KIT	1							
	6-454	THROTTLE SHAFT KIT		1						
	6-491	THROTTLE SHAFT KIT				1	1		1	1
15.	*6-195	SHAFT-Float Hinge	1	1	1	1	1	1	1	1

Ref. No. 13 not required on Carburetor 39-955-500

\* Indicates parts in Repair Kit

\*\* If original main nozzle was removed replace with service nozzle only

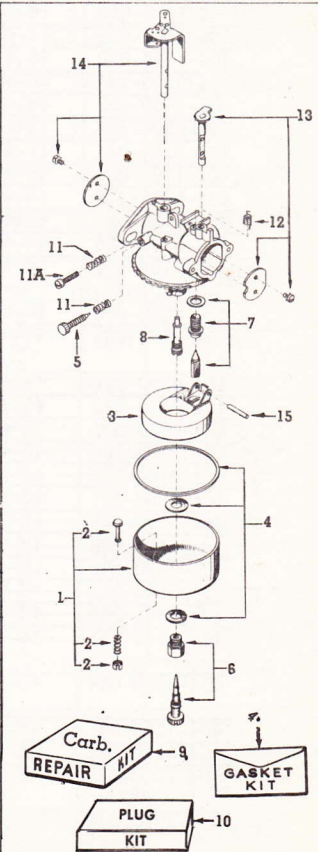



# MODEL VARIATIONS

## 404-0100-000



The adaptation of Clinton Engines to a wide variety of uses, results in what is known as Model Variations. Following is a list of Models produced to date. Opposite each Engine Model listed are the Part Numbers required in addition to or in place of standard parts. Refer to Basic Parts List for parts not listed in the Model Variations. For replacement engine to fit special applications, external part changes may be required.

UNITS MARKED WITH A ( ) INDICATES CRANKSHAFT TO BE CUT OR CHANGED  
See Page C of this Manual on "How to Identify your Clinton Engine."

MODELS	CRANKSHAFT	NOTES	REPL. ENGINE #	SHORT BLOCK	MODELS	CRANKSHAFT	NOTES	REPL. ENGINE #	SHORT BLOCK
404-0100-001	46-402		21421	149-653	404-1300-050	46-473	2, 5, 6, 9, 10, 11, 26, 45, 49	21605	(149-504)
404-0120-002	46-418	1	Note 80	(149-503)	404-1300-051	46-490	2, 5, 6, 9, 10, 11, 26, 45, 49	21603	(149-504)
404-0140-003	46-419	1	Note 80	(149-503)	404-1300-052	46-479	2, 5, 25, 45, 49	(21423)	(149-504)
404-0160-004	46-417	1	21422	(149-503)	404-1300-053	46-404	2, 5, 25, 45, 49	(21423)	149-504
404-0300-005	46-404	2, 45	21423	149-504	404-1300-054	46-404	2, 5, 7, 10, 45, 49	21423	149-504
404-0300-006	46-479	2, 45	(21423)	(149-504)	404-0100-055	46-403	6	21421	149-653
404-0300-007	46-473	2, 45	21605	(149-504)	404-1300-056	46-473	2, 5, 25, 45, 49	21605	(149-504)
404-0300-008	46-480	2, 45	21608	(149-504)	404-0100-057	46-403	11, 37, 65	Note 80	None
404-1300-009	46-479	2, 5, 6, 10, 45, 49	(21423)	(149-504)	404-0300-058	46-404	2, 10, 20, 45	21423	149-504
404-2100-010	46-403	8, 16, 18, 20, 46, 60	21421	149-653	404-9300-059	46-829	2, 45		Short Block
404-1300-011	46-404	2, 5, 6, 7, 10, 45, 49	21423	149-504	404-9100-060	46-830	38		Short Block
404-0140-012	46-419	1, 6	Note 80	(149-503)	404-1300-061	46-495	2, 5, 6, 45, 47	21604	(149-504)
404-0100-013	46-403	6, 9, 11	21421	149-653	404-0300-062	46-495	2, 36, 45, 55	21604	(149-504)
404-1160-014	46-417	1, 5, 6, 10, 49	21422	(149-503)	404-0100-063	46-403	11, 21, 38	21421	149-653
404-1160-015	46-417	1, 5, 6, 47	21422	(149-503)	404-2100-064	46-403	21, 38, 46	21421	149-653
404-1300-016	46-404	2, 5, 6, 10, 45, 49	21423	149-504	404-1300-065	46-404	2, 5, 10, 45, 49	21423	149-504
404-1300-017	46-404	2, 5, 6, 45, 47	21423	149-504	404-0300-066	46-404	2, 20, 45	21423	149-504
404-1100-018	46-403	5, 6, 10, 49	21421	149-653	404-0100-067	46-403	6, 9, 11	21421	149-504
404-1100-019	46-403	5, 47	21421	149-653	404-0300-068	46-404	2, 6, 10, 45	21423	149-504
404-1140-020	46-419	1, 5, 6, 10, 49	Note 80	(149-503)	404-0300-069	46-829	2, 6, 45, 69	(21583)	None
404-0100-021	46-403	10, 38	21421	149-653	404-0300-070	46-829	2, 6, 10, 45	(21423)	149-504
404-0100-022	46-403	20	21421	149-653	404-0100-071	46-403	6, 9, 11, 68	21421	149-653
404-0300-023	46-404	2, 6, 9, 11, 45	21423	149-504	404-0100-072	46-403		21421	149-653
404-0160-024	46-417	1, 6, 9, 11	21422	(149-503)	404-0300-073	46-495	2, 6, 45	21604	(149-504)
404-1100-025	46-403	5, 6, 47	21421	149-653	404-0300-074	46-404	2, 6, 11, 45	21423	149-504
404-0100-026	46-403	6	21421	149-653	404-0100-075	46-403	20, 64	21421	149-653
404-0100-027	46-403	6	21421	149-653	404-0140-076	46-419	1, 20, 64	Note 80	(149-653)
404-0300-028	46-404	2, 6, 10, 45	21423	149-504	404-0100-077	46-403	6, 67	21421	149-653
404-1100-029	46-403	5, 12, 49, 58, 61	Note 80	None	404-0100-078	46-403	10, 20	21421	149-653
404-0300-030	46-404	2, 10, 45	21423	149-504	404-1100-079	46-834	4, 5, 8, 31, 48, 49, 58, 61, 66	(21608)	None
404-0300-031	46-404	2, 7, 11, 12, 36, 53, 58, 62	Note 80	None	404-0100-080	46-403	6, 11, 64	21421	149-653
404-0100-032	46-403	11, 21	21421	149-653	404-0110-081	46-403	11, 20, 69	21583	None
404-0160-033	46-417	1, 11	21422	(149-503)	404-0300-082	46-744	2, 10, 45	(21423)	(149-504)
404-0300-034	46-404	2, 11, 45	21423	149-504	404-0100-083	46-403	6, 10, 38, 70	21421	149-653
404-0100-035	46-403	11	21421	149-653	404-1300-084	46-404	2, 5, 10, 45, 49	21423	149-504
404-0100-036	46-403	6, 11, 54	21421	149-653	404-0100-085	46-403	10, 11, 29, 38	21421	149-653
404-0100-037	46-403	6, 11, 63	21421	149-653	404-0300-086	46-815	2, 9, 10, 11, 12, 53, 58	(21608)	None
404-0100-038	46-403	10, 11, 20, 54	21421	149-653	404-0100-087	46-403	8, 11, 21	21421	149-653
404-0100-039	46-424	64	(21421)	149-503	404-1300-088	46-479	2, 5, 6, 25, 45, 49	(21423)	(149-504)
404-0100-040	46-403	11, 38, 40	21421	149-653	404-0100-089	46-403	8, 19, 30, 31, 32	21421	149-653
404-0160-041	46-417	1, 6, 10	21422	(149-503)	404-1300-090	46-490	2, 4, 5, 8, 9, 19, 26, 30, 35, 45, 49	21603	(149-504)
404-0300-042	46-404	2, 6, 10, 45	21423	149-504	404-1300-091	46-404	2, 4, 5, 8, 9, 19, 26, 30, 35, 45, 49	21423	149-504
404-2100-043	46-403	4, 8, 16, 18, 20, 46, 60	21421	149-653	404-1300-092	46-473	2, 4, 5, 8, 9, 19, 26, 30, 35, 45, 49	21605	(149-504)
404-0100-044	46-403	4, 8, 16, 18, 20, 60	21421	149-653					
404-1300-045	46-479	2, 5, 45, 49	(21423)	(149-504)					
404-0140-046	46-419	1	Note 80	(149-503)					
404-1300-047	46-490	2, 5, 6, 9, 10, 11, 26, 45, 49	21603	(149-504)					
404-1300-048	46-404	2, 5, 6, 9, 10, 11, 26, 45, 49	21423	149-504					
404-1300-049	46-495	2, 5, 6, 9, 10, 11, 26, 45, 49	21604	(149-504)					



UNITS MARKED WITH A ( ) INDICATES CRANKSHAFT TO BE CUT OR CHANGED  
See Page C of this Manual on "How to Identify your Clinton Engine."

MODELS	CRANKSHAFT	NOTES	REPL. ENGINE #	SHORT BLOCK	MODELS	CRANKSHAFT	NOTES	REPL. ENGINE #	SHORT BLOCK
404-1300-093	46-495	2, 4, 5, 8, 9, 19, 26, 30, 35, 45, 49	21604	(149-504)	404-0100-143	46-403	6, 11, 38	21421	149-653
					404-0160-144	46-417	1, 6, 11, 38	21422	(149-503)
404-1100-094	46-403	5, 10, 49	21421	149-653	404-0300-145	46-404	2, 6, 11, 45	21423	149-504
404-0100-095	46-403	8, 19, 31, 32, 33, 38	21421	149-653	404-1300-146	46-479	2, 5, 45, 49	(21423)	(149-504)
404-0100-096	46-403	8, 19, 32, 33, 35	21421	149-653	404-1300-147	46-479	2, 5, 45, 49	(21423)	(149-504)
404-0160-097	46-417	1, 8, 30, 31, 32, 38, 48	21422	(149-503)	404-1300-148	46-479	2, 5, 25, 45, 49	(21423)	(149-504)
404-0100-098	46-403	9, 26, 71, 72	21421	149-653	404-1300-149	46-495	2, 5, 8, 30, 31, 32, 45, 48, 49	21604	(149-504)
404-0100-099	46-403		21421	149-653	404-0300-151	46-404	2, 7, 10, 20, 22, 40, 51	21423	149-504
404-0110-100	46-403	11, 54, 57, 69	21583	None	404-7300-152	46-490	2, 8, 41, 43, 45, 75	Note 80	(149-504)
404-0100-101	46-403	6	21421	149-653	404-0300-153	46-480	2, 19, 32, 35, 51, 53, 58, 79	21608	None
404-1300-102	46-479	2, 5, 25, 45, 49	(21423)	(149-504)	404-0300-154	46-829	2, 23, 39, 50, 56, 58	(21608)	None
404-0100-103	46-403	11, 21, 29	21421	149-653	404-0300-155	46-404	2, 8, 13, 19, 27, 32, 33, 45	21423	149-504
404-1300-104	46-404	2, 5, 6, 28, 45, 49, 74	21423	149-504	404-7300-156	46-404	2, 5, 7, 10, 41, 45, 49	Note 80	149-504
404-1100-105	46-403	5, 6, 7, 10, 49	21421	149-653	404-1300-157	46-404	2, 5, 7, 10, 45, 49	21423	149-504
404-1100-106	46-403	5, 49	21421	149-653	404-1100-158	46-836	5, 8, 13, 19, 27, 33, 38, 49, 50	(21421)	(149-653)
404-1100-107	46-403	5, 7, 10, 49	21421	149-653	404-0300-159	46-490	2, 6, 10, 11, 45	21603	(149-504)
404-1300-108	46-404	2, 5, 7, 10, 45, 49	21423	149-504	404-0300-160	46-404	2, 6, 45	21423	149-504
404-1300-109	46-495	2, 5, 8, 30, 31, 45, 47, 48	21604	(149-504)	404-0300-161	46-404	2, 3, 6, 11, 20, 24, 45, 54	21423	149-504
404-0100-110	46-403	6, 7	21421	149-653	404-1300-162	46-404	2, 5, 7, 45, 49	21423	149-504
404-0100-111	46-403	31, 34, 73	21421	149-653	404-1100-163	46-403	5, 7, 49	21421	149-653
404-1300-112	46-404	2, 5, 7, 45, 49	21423	149-504	404-1300-164	46-495	2, 5, 7, 45, 49	21604	(149-504)
404-0300-113	46-495	2, 45	21604	(149-504)	404-0300-165	46-495	2, 10, 45	21604	(149-504)
404-1100-114	46-403	5, 7, 49	21421	149-653	404-0160-166	46-417	1, 8, 30, 31, 48, 50	21422	(149-503)
404-0100-115	46-403	6, 10	21421	149-653	404-0160-167	46-417	1, 8, 15, 19, 31, 32, 33	21422	(149-503)
404-1160-116	46-417	1, 5, 7, 11, 49	21422	(149-503)	404-1300-168	46-404	2, 5, 7, 10, 45, 49	21423	149-504
404-1300-117	46-404	2, 5, 45, 49	21423	149-504	404-0160-169	46-417	1, 6, 10, 11, 15	21422	(149-503)
404-1300-118	46-404	2, 4, 5, 8, 9, 19, 26, 30, 35, 45, 49	21423	149-504	404-0300-170	46-404	2, 7, 10, 17, 45, 62	21423	149-504
404-0160-119	46-417	1, 6, 9, 11	21422	(149-503)	404-0100-171	46-403	6, 8	21421	149-653
404-0300-120	46-404	2, 8, 32, 33, 35, 45	21423	149-504	404-0300-172	46-829	2, 23, 39, 50, 56, 58	(21608)	None
404-1300-121	46-404	2, 5, 8, 19, 30, 31, 32, 45, 49	21423	149-504	404-0100-173	46-860	8, 37, 42, 43, 44, 64	(21421)	149-503
404-0300-122	46-404	2, 45	21423	149-504	404-0100-174	46-861	8, 37, 42, 43, 44, 64	21421	149-653
404-0160-123	46-417	1, 15	21422	(149-503)	404-1300-175	46-495	2, 5, 6, 45, 49	21604	(149-504)
404-0300-124	46-490	2, 8, 28, 45, 75	21603	(149-504)	404-0100-176	46-403	59	21421	149-653
404-0100-125	46-403	8, 31, 32, 33	21421	149-653	404-0300-177	46-404	2, 6, 8, 13, 19, 27, 32, 33, 45	21423	149-504
404-0300-126	46-404	2, 15, 20, 45	21423	149-504	404-0100-178	46-424	23, 43, 64	(21421)	149-503
404-0100-127	46-403		21421	149-653	404-0300-179	46-404	2, 32, 35, 48, 53, 58, 79	(21608)	None
404-1100-128	46-403	5, 8, 19, 30, 32, 35, 49	21421	149-653	404-1100-180	46-403	5, 7, 49	21421	149-653
404-1160-129	46-417	1, 5, 8, 19, 30, 32, 35, 49	21422	(149-503)	404-1160-181	46-417	1, 5, 49	21422	(149-503)
404-0100-130	46-403	11, 13, 74, 76	21421	149-653	404-0100-182	46-403	6, 11, 54	21421	149-653
404-0300-131	46-490	2, 45	21603	(149-504)	404-0300-183	46-874	2, 21, 29, 41, 43, 45, 75	(21603)	(149-504)
404-0300-132	46-404	2, 8, 19, 30, 32, 35, 45	21423	149-504	404-0300-184	46-829	2, 3, 39, 50, 53, 58	(21608)	None
404-0100-133	46-403	11, 64	21421	149-653	404-0100-185	46-424		(21421)	149-503
404-0300-134	46-404	2, 6, 7, 9, 11, 45	21423	149-504	404-1300-186	46-404	2, 5, 7, 12, 25, 49, 53, 58	(21608)	None
404-0300-135	46-815	2, 8, 19, 32, 35, 53, 58, 77	(21608)	None	404-1300-187	46-404	2, 5, 45, 49	21423	149-504
404-0100-136	46-842	19, 29, 31, 32, 58, 78, 79	21608	None					
404-0100-137	46-403		21421	149-653					
404-1300-138	46-495	2, 5, 7, 45, 49	21604	(149-504)					
404-0100-139	46-403	6, 11	21421	149-653					
404-0160-140	46-417	1, 6, 11	21422	(149-503)					
404-0110-141	46-403	6, 11, 69	21583	None					
404-0300-142	46-404	2, 7, 10, 12, 53, 58	(21608)	None					



UNITS MARKED WITH A ( ) INDICATES CRANKSHAFT TO BE CUT OR CHANGED  
See Page C of this Manual on "How to Identify your Clinton Engine."

MODELS	CRANKSHAFT	NOTES	REPL. ENGINE #	SHORT BLOCK	MODELS	CRANKSHAFT	NOTES	REPL. ENGINE #	SHORT BLOCK
404-0300-188	46-404	2, 45	21423	149-504	404-0300-197	46-404	2, 43, 44, 45	21423	149-504
404-0300-189	46-404	2, 8, 30, 32, 45, 48	21423	149-504	404-0300-198	46-490	2, 13, 23, 39, 50, 56, 58	(21608)	None
404-1300-190	46-404	2, 5, 45, 49	21423	149-504	404-0100-199	46-836	8, 13, 19, 27, 33, 38, 50	(21421)	(149-503)
404-1300-191	46-404	2, 5, 8, 30, 32, 35, 45, 48	21423	149-504	404-1120-200	46-418	1, 5, 7, 49	Note 80	(149-503)
404-0100-192	46-403	20, 37	21421	149-653	404-0100-201	46-403	8, 42, 43, 59, 64, 74	21421	149-653
404-1160-193	46-417	1, 7, 12, 25, 58, 78	Note 80	None	404-0300-202	46-404	2, 10, 12, 26, 29, 36, 43, 44, 53, 58	(21608)	None
404-7100-194	46-403	8, 38, 41, 43, 50, 52	Note 80	149-653	404-9100-203	46-834	38	Short Block	149-653
404-7100-195	46-403	6, 8, 41	Note 80	149-653	404-0100-204	46-424	6, 11, 38	(21421)	149-503
404-0300-196	46-490	2, 6, 7, 10, 15, 45	21603	(149-504)					

404 SERIES NOTES

- Note 1 Use 94-163-990 Seal Oil. Refer to Sec. III, Div. C, Page 1, for exploded view & parts usage for reduction units.
- Note 2 Use 232-30 Retainer, 232-29 Retainer, 232-36 Spacer, 94-166-990 Seal and 20-4 Bearing (Ball), 304-467 Washer, Thrust to Cam Gear.
- Note 3 Use 215-511-500 Plate (Air Cleaner Mtg.), (2) 94-550 Gasket, 2-33 Element, 45-5 Cover, (2) 258-102-500 Screw and 258-47-500 Screw (Cover to Body).
- Note 4 Use 277-69-500 Tank Ass'y, 26-55-500 Bracket (to Block), (2) 183-1 Nut, 258-254-500 Screw & L'Washer, (2) 26-159 Strap (Fuel Tank)
- Note 5 Use 257-25 Screen, 219-17 Pulley (Starting), 304-132 Washer (Flywheel) and 246-13-500 Rope (Starting).
- Note 6 Use 39-968 Carburetor, 157-122-500 Lever (Fixed Speed), 258-247-500 Screw and 26-628 Bracket (Remote Control Clamp).
- Note 7 Use 910-35 Air Horn, 94-11 Gasket (Horn to Cleaner), 2-219-500 Air Cleaner (Oil Bath), 258-163 Screw (Cleaner to Horn) and 183-66 Nut (Wing).
- Note 8 Use 170-18-500 Muffler (45°), 183-37 Nut (Lock).
- Note 9 Use 69-291 Elbow (to Carb.), 293-170 Valve (Fuel Shut-Off), 69-287 Connector (to Shut-Off Valve), 158-405 Line (Fuel), and (2) 183-244 Nut & Ferrule Ass'y.
- Note 10 Use 277-449-500 Tank Ass'y, (2) 26-607 Strap (Fuel Tank).
- Note 11 Use 158-67 Tube (Breather), 69-269 Connector, 69-23 Elbow, 69-69 Mandrel (Hose Retaining).
- Note 12 Use 39-968 Carburetor, 6-430-500 Camshaft & Governor Weight Ass'y, 109-7 Collar (Governor), 304-126 Washer (Governor Shaft), 109-14 Yoke (Governor), 6-64 Shaft (Governor Yoke), (2) 258-61-500 Screw & L'Washer, 232-32 Ring, 157-387 Arm (Governor), 107-3 Adjustor (Governor Arm), 304-121 Washer, 258-936-500 Screw & L'Washer, 258-105 Screw, 159-149 Link (Throttle Actuating), 304-559 Spacer (Governor Bracket), 26-557 Bracket (Throttle Adj.), 258-898-500 Screw & L'Washer, 183-63 Nut (Throttle Adjusting), 245-10 Rod (Throttle Adj.), 263-325 Spring (Speed Regulating) and 183-54 Nut, 263-45 Spring (Back Lash Gov. Link).
- Note 13 Use 233-136-500 Chrome Ring Set
- Note 14 Use 291-13-990 Valve (Exhaust-Stellite). Use standard Exhaust Valve on intake side.
- Note 15 Use 307-31-500 Cable (Remote Control). Cable supplied in 72" length only, cut to length required.
- Note 16 Clinton does not supply Air Cleaner for this unit.
- Note 17 Use 293-32-500 Valve & Filter Ass'y, 69-59 Connector and 69-5 Connector (Fuel Line).
- Note 18 Use 45-66 Cover (Spark Plug).
- Note 19 Use 69-55 Air Horn, 69-24 Elbow, 158-69 Tube Breather, 69-69 Mandrel (Hose Retaining).
- Note 20 Use 307-120-500 Wire Ass'y (Shorting), 183-26 Nut (Wire to Stator Ass'y), 70-10 Grommet, 183-259-500 Nut (Insulation), 266-26 Clip (Shorting), 258-83 Screw (Clip to Insulation Nut), and 26-601 Bracket (Shorting Wire).
- Note 21 Use 216-27 Plug (Oil Drain).
- Note 22 Use 215-502 Plate Bearing, 216-41 Plug (Pivot Pin Hole), 258-144 Set Screw.
- Note 23 Use 307-120-500 Wire Ass'y (Shorting), 70-7 Grommet, 258-936-500 Screw and L'Washer Ass'y and 183-26 Nut (Wire to Stator).
- Note 24 Use 157-359-500 Lever (Speed Control), 28-49 Bushing, 258-247-500 Screw and 263-356 Spring (Governor).
- Note 25 Use 122-18 Head (Cylinder), 277-64-500 Tank Ass'y (Dual Compartment), 26-55-500 Bracket (Tank Mtg.), (2) 26-159 Strap, (2) 258-254-500 Screw & L'Washer, (2) 183-1 Nut, (2) 69-24 Elbow (Fuel Line), 69-59 Nipple-Pipe, 293-10 Valve (3-Way), 69-5 Connector (Fuel Line), 158-357 Fuel Line, Cut to Length Required.
- Note 26 Use 45-68-500 Cover (Spark Plug Shorting).
- Note 27 Use 2-172-500 Air Cleaner Ass'y, 2-173 Body, 2-174 Element, 45-408-500 Cover, 94-11 Gasket, 258-72 Screw and 183-66 Nut (Wing).
- Note 28 Use 94-13 Gasket (Air Cleaner to Carb.), 2-144 Body (Air Cleaner), 304-562 Washer, 45-337 Cover (Air Cleaner) and 2-175-990 Element.
- Note 29 Use 69-16 Elbow (Muffler).
- Note 30 Use 39-194-990 Carburetor, 159-21 Link (Air Vane), 157-120-500 Bracket (Speed Adjusting), 258-272-500 Screw & L'Washer, 263-34 Spring, 258-889 Screw, 304-88 Washer, 157-360-500 Lever (Speed Adjusting), 258-205 Screw (Shoulder), 304-565 Washer (Bowed) and 263-73 Spring.



- Note 31 Use 2-9-500 Air Cleaner, 94-11 Gasket (Air Cleaner to Air Horn), 304-136 Washer (Screw to Flat Washer), 258-72 Screw (Air Cleaner to Air Horn), 304-134 Washer (Top of Air Cleaner to Fiber Washer), 304-28 L'Washer (Air Horn to Wing Nut) and 183-66 Nut (Wing).
- Note 32 Use 277-449-500 Tank Ass'y (Fuel), (2) 183-1 Nut, 26-55-500 Bracket (Tank Mounting), (2) 26-159 Strap, (2) 258-254-500 Screw & L'Washer and 293-37 Valve (Fuel Shut-Off).
- Note 33 Use 39-194-990 Carburetor, 159-21 Link (Governor), 69-24 Connector (Fuel), 26-569-500 Bracket, 157-359-500 Lever (Speed Control), 258-107 Screw, 258-205 Screw (Shoulder), and 263-73 Spring.
- Note 34 Use 910-35 Air Horn.
- Note 35 Use 94-11 Gasket (Air Cleaner to Air Horn), 2-219-500 Air Cleaner, 258-163 Screw (Air Cleaner to Air Horn) and 183-66 Wing Nut.
- Note 36 Use 263-89 Spring (Valve-Exhaust), 291-19-500 Roto-Cap, 291-16 Valve (Stellite Exhaust) and 203-58 Pin (Valve). Use standard Exhaust Valve on intake side.
- Note 37 Use 215-514-500 Plate Bearing P. T. O., 216-41 Plug (Pivot Pin Hole) and 258-144 Set Screw.
- Note 38 Use 215-488-500 Plate Bearing P. T. O.
- Note 39 Same as Note 12 except Clinton does not supply Carburetor or Air Cleaner.
- Note 40 Use 170-70-500 Muffler.
- Note 41 Use 83-103-500 Flywheel, 307-298 Sleeve Insulating, 268-18-500 Magneto. Refer to Sec. III, Div. N Page 7 for Magneto parts; however, use 135-265-500 Condenser.
- Note 42 Use 26-702-500 Slide Ass'y, 31-4 Primer Bulb Kit, 159-21 Link, 39-955-500 Carburetor, 259-727 Shroud, and 263-383 Spring, Speed Regulating.
- Note 43 Use 2-139 Body (Air Cleaner), 304-562 Washer, 2-175-990 Element, and 45-337 Cover.
- Note 44 Use 304-640 Spacer, 69-281 Connector, 69-69 Mandrel, 158-67 Tube and (2) 258-902 Screw.
- Note 45 Use 215-489 Plate Bearing P. T. O.
- Note 46 Use 265-196-500 Starter (Impulse), 265-106-500 Cup (Starting) and 183-32 Nut Flywheel.
- Note 47 Use 259-646-500 Housing Blower.
- Note 48 Use 69-54 Horn (Air).
- Note 49 Use 259-119-500 Housing Blower.
- Note 50 Use 26-55-500 Tank Bracket, (2) 26-671 Strap (Tank), (2) 258-32 Screw, (2) 183-29-500 Nut & L'Washer Ass'y.
- Note 51 Use Radio Shielding. Refer to Section III, Division Q, Page 2 for exploded view and parts usage for Radio Shielding.
- Note 52 Use 39-961-500 Carburetor, 26-702-500 Slide Ass'y, 159-21 Link (Governor), 263-383 Spring Speed Reg., 259-727 Shroud (Carburetor), 81-12 Clamp (Remote Control), (2) 258-957-500 Screw & L'Washer.
- Note 53 Use 215-86 Plate Bearing P. T. O.
- Note 54 Use 259-522-500 Housing Blower.
- Note 55 Use 22-696-500 Block Cylinder.
- Note 56 Use 215-87 Plate Bearing P. T. O.
- Note 57 Use 263-360 Spring (Governor Speed Adjusting), 259-624-500 Housing (Blower).
- Note 58 Use 22-541-500 Block Cylinder.
- Note 59 Use 307-120-500 Wire (Shorting), 70-10 Grommet, 266-53 Switch Shorting, 215-134 Plate Switch(Mounting) and 183-21 Nut.
- Note 60 Use 259-639 Shroud (Snow Blower), (2) 258-930 Screw.
- Note 61 Use 215-85-500 Plate (Bearing P. T. O.).
- Note 62 Use Radio Shielding. Refer to Section III, Division Q, Page 2, for exploded view and parts usage.
- Note 63 Use 259-734-500 Housing & Tank Ass'y, 69-6 Connector(Fuel Line).
- Note 64 Use 259-409-500 Housing & Tank Ass'y, 69-6 Connector (Fuel Line).
- Note 65 Use 170-7-500 Body Ass'y (Muffler), 183-45 Nut (Muffler to Body to Block), 45-54-500 Cover Ass'y (Muffler), 24-7 Bolt (Body to Cover), 183-66 Nut (Wing), (2) 304-138 Spacer Muffler to Block.
- Note 66 Same as Note 12, except use 39-188-990 Carburetor in place of 39-968 and 159-133 Link (Gov) in place of 159-149.
- Note 67 Clinton does not supply Fuel Tank Assembly.
- Note 68 Use 69-18 Elbow (Muffler).
- Note 69 Use 215-452-500 Plate Bearing (P. T. O.), 6-434 Camshaft, 94-170-990 Oil Seal (Plate Bearing), 22-724-500 Block (Cylinder).
- Note 70 Use 45-343-500 Fuel Cap & Gauge Assembly.
- Note 71 Use 259-591-500 Housing (Snow Blower), (4) 183-234 Nut (Barrel), (4) 304-22 Lock Washer (Barrel-Nut), 304-69 Spacer, 259-671 Shroud (Snow Shield), 258-89 Screw (Cylinder Head), (2) 258-42 Screw (Shield to Housing).
- Note 72 Use 277-447-500 Tank Ass'y, and 45-96-500 Cap (Fuel).
- Note 73 Use 277-69-500 Tank Ass'y, 26-57 Bracket (Tank Mounting), (2) 26-167 Strap (Tank), (2) 258-254-500 Screw & L'Washer and (2) 183-1 Nut.
- Note 74 Use 900-340 Spacer (Air Cleaner to Carburetor), (2) 258-902 Screw (Air Cleaner to Carburetor).
- Note 75 Use 39-194-990 Carburetor, 159-21 Link (Governor). Clinton does not supply Tank or Throttle Control Ass'y.
- Note 76 Use 2-215-500 Air Cleaner Ass'y, 2-170 Body, 2-174 Element, 45-408-500 Cover, (2) 258-902 Screw (Air Cleaner to Carburetor).
- Note 77 Use 39-188-990 Carburetor, 6-430-500 Camshaft Ass'y, 109-7 Collar (Gov.), 304-126 Washer (Gov. Shaft), 109-14 Yoke (Gov.), 6-64 Shaft (Gov.), (2) 258-61-500 Screw (Yoke to Shaft), 232-32 Retainer (Shaft), 157-11 Arm (Gov.), 107-3 Adjuster (Gov. Arm), 304-121 Washer, 258-936-500 Screw, 258-105 Screw, 183-54 Nut (Square), 159-133 Link (Gov.), 304-559 Spacer (Gov. Brkt.), 26-557 Bracket (Thr. Adj.), 258-898-500 Screw & L'Washer, 183-63 Nut (Thr. Adj.), 263-325 Spring (Speed Adj.), 245-10 Rod Throttle (Adj.).
- Note 78 Use 215-88-500 Plate Bearing P. T. O.
- Note 79 Same as Note 77 except use 39-198-990 Carburetor in lieu of 39-188-990, 159-160 Throttle Link in lieu of 159-133, and additional 263-364 Spring (Back Lash).
- Note 80 Special Engine, Order by Complete Model Number.



