

# Clinton BASIC PARTS LIST

## 407-0002-000

FILE SEC 11 DIVISION 1962  
407-0002-000  
BASIC PARTS LIST  
ISSUED APRIL 1966

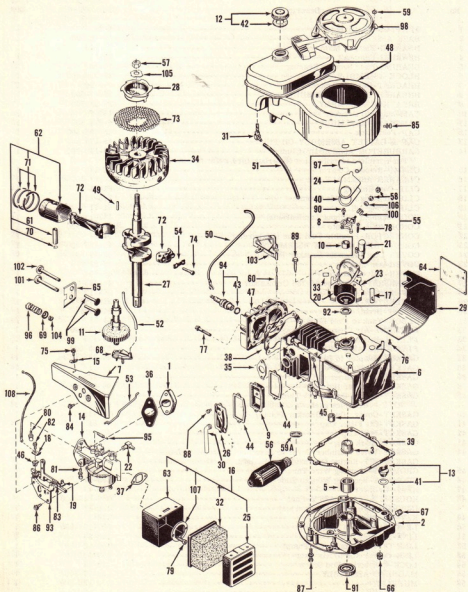

**CLINTON ENGINES CORPORATION**

MAQUOKETA, IOWA

Printed in U.S.A.

## 407-0002-000 BASIC PARTS LIST

See Page C on "How to Identify Your Clinton Engines."

Ref. No.	Description	Part No.	Qty.
1	ADAPTOR-Carburetor -----	1-85	1
2	BASE ASSEMBLY-Engine -----	18-45-500	1
3	BEARING-Flange, Main -----	20-219	1
4	BEARING-Camshaft -----	20-10	1
5	BEARING-Base, Service Bearing -----	20-50	1
6	BLOCK ASSEMBLY-Cylinder-----	22-519-500	1
7	BRACKET-Remote Control -----	259-246	1
8	BREAKER POINTS ASSEMBLY -----	135-7-900	1
9	BREATHER ASSEMBLY -----	29-32-500	1
10	CAM-Magneto Breaker -----	157-29	1
11	CAMSHAFT ASSEMBLY -----	6-424-500	1
12	CAP-Fuel Tank -----	45-395-500	1
13	CAP & GASKET ASSEMBLY-Oil Filler-----	45-179	1
14	CARBURETOR ASSEMBLY-Clinton -----	39-190-990	1
	For complete identification of carburetors, refer to Sec. III, Div. A		
15	CLAMP-Remote Control -----	81-13	1
16	CLEANER ASSEMBLY-Air -----	2-177-500	1
17	CLIP-Coil Holding -----	81-20	1
18	CLIP-Shorting to Slide Grommet -----	266-26	1
19	CLIP-Spring Adj. -----	81-71	1
20	COIL-Magneto (Without Laminations)-----	135-13-890	1
21	CONDENSER-Magneto -----	135-29-990	1
22	CONNECTOR-Flexible Fuel Line (Carburetor) -----	69-24	1
23	CORE & BREAKER BOX ASSEMBLY -----	135-37-500	1
24	COVER-Dust (Magneto Breaker Points) -----	45-15	1
25	COVER-Air Cleaner -----	45-337	1
26	COVER-Valve Chamber -----	45-304	1
27	CRANKSHAFT-Can use 46-788 Crankshaft -----	46-488	1
28	CUP-Starters -----	265-10	1
29	DEFLECTOR-Air -----	259-358	1
30	ELBOW-Breather-----	158-415	1
31	ELBOW-Tank to Fuel Line -----	69-25	1
32	ELEMENT-Air Cleaner -----	2-175-990	1
33	FELT-Lubrication (Cam Follower) -----	94-189	1
34	FLYWHEEL ASSEMBLY -----	83-10-500	1
35	GASKET-Adaptor to Block -----	94-68	1
36	GASKET-Carburetor to Adaptor -----	94-32	1
37	GASKET-Air Cleaner to Carburetor -----	94-458	1
38	GASKET-Cylinder Head -----	94-48-990	1
39	GASKET-Engine Base (.015 Thick) -----	94-107	1
	NOTE: .010 thick gasket available -----	93-107	1
40	GASKET-Cover, Dust (Breaker Points) -----	94-241	1
41	GASKET-Oil Filler Cap -----	94-82	1
42	GASKET-Fuel Cap -----	94-62	1
43	GASKET-Spark Plug -----	94-92-990	1
44	GASKET-Valve Chamber Cover to Breather-Breather to Block -----	94-103	2
	GASKET KIT-Engine Overhaul (See Bulletin No. 48 for content) -----	94-591	1
45	GROMMET-Shorting Wire Thru Block -----	70-10	1
46	GROMMET-Shorting Wire to Slide -----	183-31	1
47	HEAD-Cylinder -----	122-17	1
48	HOUSING & TANK ASS'Y-Fuel -----	259-129-500	1
	INSERT-Valve Seat .040 Oversize -----	136-22	1
49	KEY-Flywheel -----	148-4	1
50	LEAD-Hi-Tension (Magneto) -----	307-194-990	1
51	LINE-Flexible (Fuel) -----	158-25	1
52	LINE-Oil Distributor (Oil Pump) -----	158-53	1
53	LINK-Carburetor to Air Vane -----	159-161	1
54	LOCK-Connecting Rod Screw -----	148-13	1
55	MAGNETO ASSEMBLY -----	268-17-500	1
56	MUFFLER -----	170-136-500	1

Ref. No.	Description	Part No.	Qty.
57	NUT-Hex. 1/2-20 (Starter Cup) -----	183-68-990	1
58	NUT-Terminal Condenser Lead -----	183-21	2
59	NUT & L'WASHER ASS'Y-Recoil Starter-----	183-25-500	4
59 A	NUT-Muffler to Block -----	183-37	1
60	PIN-Pivot (Air Vane Governor)-----	203-91	1
61	PIN-Wrist -----	203-65	1
62	PISTON ASSEMBLY-Standard -----	204-13-500	1
	NOTE: Assemblies are available in the following oversizes:		
		.010 -----	206-13-500
		.020 -----	207-13-500
63	PLATE-Air Cleaner Mounting -----	2-139	1
64	PLATE-Name -----	58-471	1
65	PLATE-Valve Spring Retainer -----	215-136	1
66	PLUG-3/8 N. P. T. (Oil Drain)-----	216-25	1
67	PLUG-Oil Drain-----	216-27	1
68	PUMP ASSEMBLY-Oil -----	220-5-500	1
69	RETAINER-Valve Spring -----	304-135	2
70	RING-Retainer (Wrist Pin)-----	232-41	2
71	RING SET-Standard -----	233-112-500	1
	NOTE: Ring sets are also available in the following oversizes:		
	Refer to S. B. #4 for Chrome Re-Ring Set	.010 -----	235-121-500
	Information	.020 -----	237-121-500
72	ROD ASSEMBLY-Connecting -----	245-102-500	1
73	SCREEN-Revolving -----	257-30	1
74	SCREW-H. H. C. 1/4-28 x 1 1/4 (Connecting Rod Cap)-----	258-9	2
75	SCREW-H. H. Slotted S.T. #8-32 x 3/8 (Clamp to Shroud)-----	258-81	1
76	SCREW-H. H. Slotted S.T. #8-32 x 3/8 (Deflector to Block) -----	258-81	2
77	SCREW-H. W. H. 5/16 x 17/8 (Cylinder Head) -----	258-88	8
78	SCREW-R. H. S. T. #8-32 x 4/5 (Condenser to Plate)-----	258-299	1
79	SCREW-H. H. Slotted #8-32 x 7/16 (Air Cleaner Plate to Carb.)-----	258-131	2
80	SCREW & L'WASHER ASS'Y-H. H. 1/4 - 20 x 1 1/2 (Carb. to Block-Upper) -----	258-238-500	1
81	SCREW & L'WASHER ASS'Y-H. H. 1/4-20 x 1 3/4 (Carb. to Block-Lower) -----	258-275-500	1
82	SCREW-H. H. S. T. #6-32 x 1/2 (Shorting Wire to Grommet)-----	258-83	1
83	SCREW-H. H. S. T. #4-40 x 1/4 (Spring Adj. Clip to Slide) -----	258-374	1
84	SCREW-H. H. S. T. #8-32 x 1/4 (Bracket to Slide Ass'y) -----	258-477	2
85	SCREW & L'WASHER ASS'Y-H. H. C. 1/4-20 x 1/2 (2-Blower Housing to Block) -----	258-280-500	2
86	SCREW & L'WASHER ASS'Y-H. H. C. #8-32 x 3/8 (Slide Ass'y to Carburetor) -----	258-81-500	2
87	SCREW & L'WASHER ASS'Y-H. H. C. 1/4-20 x 1 1/4 (Base to Block) -----	258-254-500	7
88	SCREW & L'WASHER ASS'Y-H. H. C. #10-24 x 1/2 (Valve Chamber Cover) -----	258-82-500	2
89	SCREW & L'WASHER ASS'Y-P. H. S. T. #10-24 x 1 (Lamination to Block)-----	258-108-500	2
90	SCREW & L'WASHER ASS'Y-R. H. M. Slotted #8-32 x 9/16 ----- (Breaker Points to Breaker Box)	258-297-500	1
91	SEAL-Oil (Engine Base)-----	94-176	1
92	SEAL-Oil (Block) -----	94-178-990	1
93	SLIDE ASSEMBLY-Governor Regulating-----	26-857-500	1
94	SPARK PLUG & GASKET ASSEMBLY-H 10-----	267-28-500	1
95	SPRING-Extension (Speed Regulating)-----	263-69	1
96	SPRING-Valve -----	263-92	2
97	SPRING-Breaker Box Cover -----	263-10	1
98	STARTER ASSEMBLY-Recoil See Sec. III, Div. H, Page 12 For Parts	265-28-500	1
99	TAPPET-Valve -----	278-5	2
100	TERMINAL-Jamite Breaker Points-----	307-230	1
101	VALVE-Exhaust-----	291-8-990	1
	VALVE-Exhaust (.010 Oversize)-----	292-20-990	1
102	VALVE-Intake -----	291-9-990	1
	VALVE-Intake (.010 Oversize) -----	292-7	1
103	VANE-Air Governor -----	107-34	1
104	WASHER-"C" (Valve Keeper) -----	304-90	2
105	WASHER-Starter Cup -----	304-5	1
106	WASHER-Terminal Condenser Lead-----	304-290	1
107	WASHER-Air Cleaner -----	304-562	1
108	WIRE ASSEMBLY-Shorting-----	307-120-500	1

### SERVICE INFORMATION

Bore -----	2-3/8"
Stroke-----	1-7/8"
Cubic Inch Displacement -----	8.3
Spark Plug Gap -----	.025 to .028
Point Setting -----	.018 to .021
Oil Capacity -----	1 Pint
Bearing-Flywheel End -----	Bronze
Bearing-PTO End -----	Bronze
Valve Lash Setting -----	.009 to .011
RPM-Horsepower Rating -----	3-1/4 @ 3600
Block Construction -----	Cast Iron

1. Chrome "Re-Ring" set (refer to Service Bulletin No. 4).
2. Replacement Valve Insert 136-16.
3. Tools required for service of replacement Valve insert: 951-61 Cutter (Remove depth Pin to get 3/16 inch deep Bore), 951-52 Driver, and 951-53 Rolling Tool.

# Clinton MODEL VARIATIONS 407-0002-000

SEC. II, DIVISION 1962  
407-0002-000  
MODEL VARIATIONS  
REVISED OCTOBER, 1971  
SUPERSEDES MARCH, 1965

The adaptation of Clinton Engines to a wide variety of uses, results in what is known as Model Variations. Following is a list of Models produced to date. Opposite each Engine Model listed are the Part Numbers required in addition to or in place of standard parts. Refer to Basic Parts List for parts not listed in the Model Variations. For replacement engine to fit special applications, external part change may be required.

ENGINES AND SHORT BLOCKS MARKED WITH A ( ) INDICATES CRANKSHAFT CHANGE  
See Page C of this Manual on "How to Identify Your Clinton Engine."

MODELS	CRANKSHAFT	NOTES	REFL. ENGINE #	SHORT BLOCK	MODELS	CRANKSHAFT	NOTES	REFL. ENGINE #	SHORT BLOCK
407-0002-001	46-825	15	(21580)		407-0012-031	46-813	3, 15	(21594)	
407-0002-002	46-494	15	(21580)		407-2012-032	46-788	3, 12	(21594)	
407-0002-003	46-832	15	(21580)		407-0002-033	46-788	2, 7, 9, 13	(21593)	
407-0002-004	46-788		(21580)		407-0002-034	46-776	2, 7	(21559)	
407-0002-005	46-788	1, 2	(21593)		407-0002-035	46-788	2, 9, 14	(21570)	
407-0002-006	46-497		(21580)		407-2002-036	46-497	12	(21580)	
407-0002-007	46-784		(21559)		407-2002-037	46-825	15, 16	(21580)	
407-0002-008	46-788		(21570)		407-0002-038	46-825	15	(21580)	
407-0002-009	46-497	2	(21593)		407-0002-039	46-788	17, 18	(21580)	
407-1002-010	46-788	4	(21580)		407-0002-040	46-776	9, 19, 20	(21559)	
407-0002-011	46-788	2	(21593)		407-0012-041	46-813	3, 15, 17	(21594)	
407-0002-012	46-776	2	(21559)		407-2012-042	46-813	3, 12, 15, 17	(21594)	
407-0012-013	46-497	1, 3	(21594)						
407-0002-014	46-497	2	(21593)		407-0002-043	46-788	21	(24580)	
407-0002-015	46-788	2	(21593)		407-0002-044	46-784	19, 22	(21559)	
407-0002-016	46-788		(21580)		407-0002-045	46-788	10	(21580)	
407-0002-017	46-497		(21580)		407-0002-046	46-788	23, 24	Note #33	
407-0012-018	46-813	3, 15	(21594)		407-0002-047	46-497	19, 22	Note #33	
407-0002-019	46-497		(21580)		407-0002-048	46-788	17	(21580)	
407-0002-020	46-832	15	(21580)		407-0002-049	46-784	19, 22	Note #33	
407-0002-021	46-788	1, 6	(21580)		407-5002-050	46-788	17, 25, 26, 27	Note #33	
407-0002-022	46-497	2, 5	(21593)						
407-0002-023	46-788	7	(21580)		407-0002-051	46-788	17, 28	(21580)	
407-0002-024	46-788	2	(21570)		407-0002-052	46-889	29, 30, 31	Note #33	
407-0002-025	46-422	8	(21580)		407-0002-053	46-494		(21580)	
407-0002-026	46-788		(21580)		407-0002-054	46-788	28, 32	(21580)	
407-0002-027	46-784	2, 10	(21559)		407-0002-055	46-497	34, 35, 36	(21580)	
407-0002-028	46-788	11	(21580)						
407-0012-029	46-788	3	(21594)						
407-2002-030	46-788	12	(21580)						

## 407 SERIES NOTES

- Note 1 Use 39-747-990 Carburetor, 158-68 Tube Breather, 69-269 Connector (Tube to Elbow), (2) 69-23 Elbow, and 69-69 Mandrel.
- Note 2 Use 259-247 Shroud, 277-84-500 Tank & Blower Housing Ass'y, and 69-6 Connector.
- Note 3 Use 22-520-500 Block, 20-100 Bearing, 6-426-500 Camshaft, 18-44 Base, 20-50 Bearing, 94-170-990 Seal Oil.
- Note 4 Use 277-84-500 Tank & Housing Ass'y, 246-13-500 Rope, 219-17 Pulley, 304-132 Washer, 257-25 Screen.
- Note 5 Use 233-136-500 Chrome Re-Ring Set and 2-215-500 Air Cleaner Ass'y.
- Note 6 Use 239-361-500 Shroud Ass'y and 258-160 Screw.
- Note 7 Use 18-45-500 Base Ass'y.
- Note 8 Use 18-17-500 Base, 20-52 Bearing, 69-18 Elbow (Muffler), 183-37 Nut (Muffler).
- Note 9 Use 121-10 Control Knob, 258-41-500 Screw (Knob to Lever).
- Note 10 Use 307-31-500 Cable & Handle Ass'y.
- Note 11 Use 70-7 Grommet and 258-936-500 Screw.
- Note 12 Use 259-361-500 Housing & Tank Ass'y, 265-250-500 Impulse Starter, 265-246-500 Cup Ass'y, 1-97 Adaptor, 304-618 Spacer, 257-98 Screen, 183-254 Nut Barrel.
- Note 13 Use 2-100 Plate Air Cleaner Mfg., 45-175 Cover Air Cleaner, 2-99-990 Element, 69-18 Elbow Muffler, 183-37 Nut.
- Note 14 Use 170-141 Muffler, 183-45 Nut, 24-7 Bolt (Cover Muffler), and 183-66 Nut Wing.
- Note 15 Use Crankshaft listed, Replacement Engine with ( ) indicates crankshaft change.
- Note 16 Same as Note 12, except use 277-225-500 Tank & Housing Ass'y, 69-6 Connector.
- Note 17 Use 31-4 Primer Bulb Kit, 39-953-500 Carburetor, and 26-681 Slide Ass'y.
- Note 18 Use 45-179 Oil Gauge, 45-424-500 Fuel Cap and Gauge.
- Note 19 Use 39-874-500 Carburetor, 1-63 Adaptor (Carb.), 24-13 Stud (Adaptor), 94-69 Gasket (Carb. to Adaptor), 258-190 Screw (Adaptor to Carburetor), (2) 183-29-500 Nut & L/Washer, 94-31 Gasket (Adaptor to Block), (2) 258-284-500 Screw & L/Washer (Adaptor to Block), 159-73 Link (Carb. to Air Vane), 900-340 Adaptor (Carburetor to Air Cleaner), 2-144 Body (Air Cleaner), (2) 258-902 Screw (Air Cleaner to Carburetor), 259-375 Shroud (Carburetor), 121-10 Control Knob.

- Note 20 Use 259-587-500 Housing Ass'y (Blower), 259-378-500 Shroud Ass'y (Blower Housing), (3) 258-883 Screw (Shroud to Housing), 277-389-500 Tank Ass'y (Fuel), (2) 26-573 Bracket (Fuel Tank), (2) 258-718-500 Screw & L'Washer (Bracket to Tank), 45-357-500 Cap (Fuel Tank).
- Note 21 Same as Note 4, except use 259-391-500 Housing & Tank Ass'y instead of 277-213-500.
- Note 22 Use 259-379-500 Housing (Blower), 277-388-500 Tank Ass'y, (2) 26-351-500 Strap, (2) 183-53 Nut, (2) 258-185-500 Screw & L'Washer Ass'y, 259-378-500 Shroud & Bracket Ass'y, (2) 258-883 Screw.
- Note 23 Same as Note 19, except use 39-956-500 Carburetor Ass'y instead of 39-874-500.
- Note 24 Use 259-379-500 Housing Ass'y, 259-725 Shroud, 31-4 Primer Bulb Kit, 26-681-500 Slide Ass'y, 259-375 Shroud (Carb.), 277-388-500 Tank Ass'y, (2) 26-351-500 Strap, (2) 183-53 Nut, (2) 258-185-500 Screw & L'Washer Ass'y, (2) 258-883 Screw.
- Note 25 Use 22-850 Block Ass'y, 83-117-500 Flywheel Ass'y, 107-38 Air Vane, 259-807 Housing Ass'y, 259-247 Shroud (Carb.), 259-804-500 Shroud (Housing), (4) 183-58 Nut Push Recoil Studs, 134-12-500 Fuel Indicator, (2) 258-1003 Screw, 94-630-990 Gasket, 219-174-500 Cup & Screen, 246-7 Rope.
- Note 26 Use 6-492-500 Camshaft Ass'y.
- Note 27 Use 2-100 Plate (Air Cleaner), 2-99-990 Element, 45-175 Cover, 94-549 Gasket.
- Note 28 Use 277-84-500 Tank Ass'y, 69-6 Connector, 259-247 Shroud (Carb.), 159-18 Link (Gov.).
- Note 29 Same as Note 19, except use 39-966-500 Carburetor instead of 39-874-500.
- Note 30 Use 259-813-500 Tank & Housing Ass'y, 259-788 Shroud (Carb.), 31-4 Primer Bulb Kit.
- Note 31 Use 170-18-500 Muffler Ass'y.
- Note 32 Use 69-306 Air Horn, 900-340 Spacer, (2) 258-947 Screw, 94-11 Gasket, 2-219-500 Air Cleaner Ass'y, 258-73 Screw, 183-66 Nut.
- Note 33 Special Engine Order By Complete Model Number.
- Note 34 Use 39-966-500 Carburetor, 259-788 Shroud (Carb.), 31-4 Primer Bulb Kit, 26-681 Slide Ass'y.
- Note 35 Use 259-779 Housing & Tank Kit with Fuel Indicator, 134-12-500 Fuel Gauge Ass'y, (2) 258-1003 Screw, 94-630-990 Gasket (Gauge).
- Note 36 Use 1-53 Carburetor Adaptor, 24-13 Stud (Adaptor), 94-69 Gasket, 258-190 Screw, (2) 183-29-500 Nut, 94-31 Gasket, (2) 258-284-500 Screw, 159-73 Link (Gov.), (2) 94-13 Gasket, 304-614 Spacer (Air Horn), 69-281 Connector, 2-144 Body (Air Cleaner), (2) 258-922 Screw, 45-304 Cover (Valve Chamber), 69-23 Elbow (Valve Cover), 158-74 Tube (Breather), 69-69 Mandrel Hose Retaining, 69-269 Connector (Breather).