

Clinton BASIC PARTS LIST

409-0000-000

File- SECTION II DIVISION 1962
 409-0000-000
 BASIC PARTS LIST
 REVISED APRIL, 1963

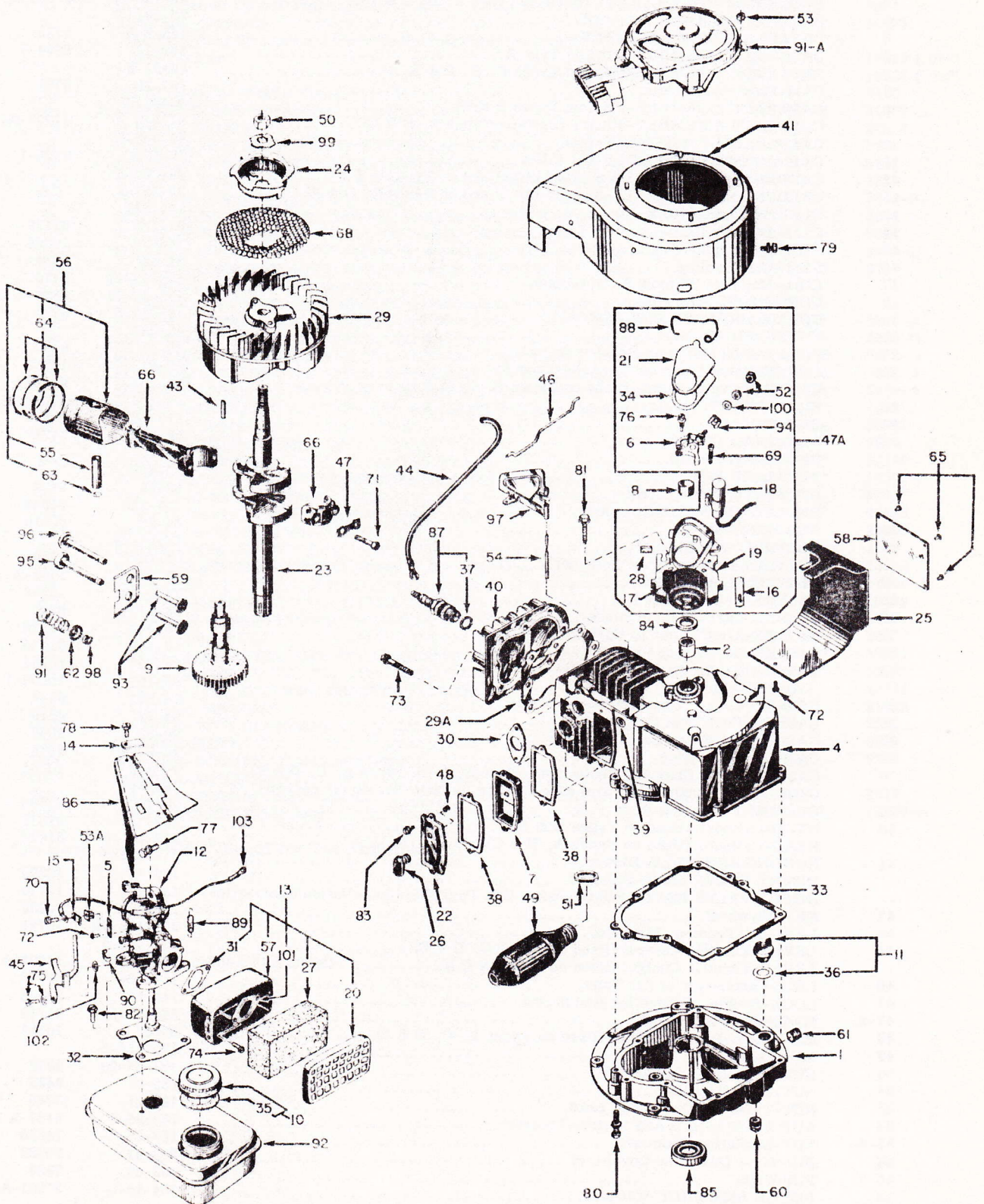

CLINTON ENGINES CORPORATION
 MAQUOKETA, IOWA

Printed in U.S.A.

There are five (5) types of the 409-0000-000 covered by this Basic Parts List. Parts not used on all types are noted. Serial Number suffix "A" is referred to as Type "A", etc.

Ref. No.	Parts Description	IBM No.	Part No.	Qty.
1	BASE ASSEMBLY-Engine.....	18-45	31488	1
2	BEARING-Block (Service Bearing)(Used on Types A, B, C & D, Std.on Type E)	20-58	90278	1
	BEARING-Base (Service Bearing).....	20-50	9016	1
4	*BLOCK ASSEMBLY-Cylinder (Used on Type E).....	22-590-5		1
	BLOCK ASSEMBLY-Cylinder (Used on Types A, B, C & D).....	22-718-5	92017-A	1
5	BRACKET-Insulating Grommet.....	26-571		1
6	BREAKER POINTS ASSEMBLY.....	135-8-5	5735	1
7	BREATHER ASSEMBLY-Used on Type A.....	260-13	6354	1
	BREATHER ASSEMBLY-Used on Types B, C, D & E.....	29-32-5		1
8	CAM-Magneto Breaker.....	157-29	5751	1
9	CAMSHAFT ASSEMBLY-Used on Types D & E).....	6-423-5		1
	CAMSHAFT ASSEMBLY-Slinger (Used on Types A, B & C).....	6-26-5	31497-A	1
10	CAP & GASKET ASSEMBLY-Fuel.....	45-395-5		1
11	CAP & GASKET ASSEMBLY-Oil Filler.....	45-179	5095-1	1
12	CARBURETOR ASSEMBLY-Suction Lift (Used on Types A & B).....	39-820-5		1
	CARBURETOR ASSEMBLY-Suction Lift (Used on Types C, D & E).....	39-857-5		1
13	CLEANER ASSEMBLY-Air.....	149-532		1
14	CLIP-Boden Wire.....	81-165	92179	1
15	CLIP-Ignition Shorting.....	266-26	10364	1
16	CLIP-Coil Holding.....	81-20	5734	1
17	COIL-Magneto, Without Laminations.....	135-13-99	5770	1
18	CONDENSER-Magneto.....	135-29-99	5589-A	1
19	CORE & BREAKER BOX ASSEMBLY.....	135-37-5	5732	1
20	COVER-Air Cleaner.....	45-383		1
21	COVER-Dust (Magneto Breaker Points).....	45-15	5743	1
22	COVER-Valve Chamber (Used on Type A).....	45-81	10323	1
	COVER-Valve Chamber (Used on Types B, C, D & E).....	45-304	91466	1
23	CRANKSHAFT.....	46-488	31328	1
24	CUP-Starter.....	265-10	90871	1
	DECAL-Air Cleaner.....	58-349	91767	1
	*DECAL-Arrowhead.....	58-451		1
	*DECAL-EZ Pull.....	58-460		1
	DECAL-Throttle Control.....	58-95	3462	1
25	DEFLECTOR ASSEMBLY-Air.....	259-358	91043	1
26	ELBOW-Breather.....	69-23	90610	1
27	ELEMENT-Air Cleaner.....	2-154-99		1
28	FELT-Lubrication (Cam Follower).....	94-189	5742	1
29	FLYWHEEL ASSEMBLY.....	83-12-5	5753-A	1
29-A	GASKET-Cylinder Head.....	94-48-99	10253	1
30	GASKET-Carburetor to Block.....	94-31	6002	1
31	GASKET-Air Cleaner to Carburetor.....	94-459	92176	1
32	GASKET-Carburetor to Fuel Tank.....	94-444	91734	1
33	GASKET-Engine Base (.015 Thick).....	94-107	10254	1
	Available in .010 Thickness.....	93-107	10254-1	1
34	GASKET-Cover, Dust (Breaker Points).....	94-241	5744	1
35	GASKET-Fuel Tank Cap.....	94-62	4519	1
36	GASKET-Oil Filler Cap.....	94-82	5097	1
37	GASKET-Spark Plug.....	94-92-99	3115	1
38	GASKET-Valve Chamber Cover (1-On Type A, 2-On Types B, C, D & E).....	94-103	10251	2
	GASKET KIT-Engine Overhaul (See Service Bulletin No. 48 for content).....	149-587		1
39	GROMMET-Shorting Wire.....	70-10	31486	1
40	HEAD-Cylinder (Used on Types D & E).....	122-17	31011	1
	HEAD-Cylinder (Used on Types A, B & C).....	122-19	31477	1
41	HOUSING ASSEMBLY-Blower.....	259-651-5		1
	INSERT VALVE SEAT-Standard.....	136-19	10379	2
	INSERT VALVE SEAT-.040 Oversize (See Page 4 for Installation information).....	136-22	15119	2
43	KEY-Flywheel.....	148-4	10339	1
44	LEAD-Hi-Tension, Magneto.....	307-194-99	90761	1
45	LEVER-Throttle Control (Used on Types C, D & E).....	157-402-5		1
	LEVER-Throttle Control (Used on Types A & B)..... Can use 157-402-5	157-362-5	14801-A	1
46	LINK-Carburetor to Air Vane.....	159-134	92178	1
47	LOCK-Double, Connecting Rod Screw.....	148-13	31018	1
47-A	MAGNETO ASSEMBLY.....	268-17-5	91740	1
48	MANDREL-Breather Hose (Used on Types B, C, D & E).....	69-69	10353	1
49	MUFFLER.....	170-136-5		1
50	NUT-Hex. 1/2-20 (Starter).....	183-68-99	5942	1
51	NUT-Lock (Muffler).....	183-37	4425	1
52	NUT-Terminal Condenser Lead.....	183-21	5740	2
53	NUT & L'WASHER ASS'Y-Recoil Starter.....	183-25-5	4107-A	4
53-A	NUT-Insulation Grommet.....	183-31	14290	1
54	PIN-Pivot (Air Vane Governor).....	203-91	90982	1
55	PIN-Wrist.....	203-65	7923	1
56	PISTON ASSEMBLY-Standard.....	204-13-5	31001-A	1
	NOTE: Assemblies are available in the following oversizes:			
	Service Part	.010.....	206-13-5	31001-A (.010)
		.020.....	207-13-5	31001-A (.020)

Ref. No.	Parts Description	IBM No.	Part No.	Qty.
57	PLATE-Air Cleaner Mounting.....	2-153		1
58	PLATE-Name.....	58-105	6530	1
59	PLATE-Valve Spring Retainer.....	215-136	10013	1
60	PLUG-3/8 N. P. T. (Oil Drain).....	216-25	5655	1
61	PLUG-Pipe Oil Drain.....	216-27	5820	1
62	RETAINER-Valve Spring.....	304-135	3028	2
63	RING-Retainer (Wrist Pin).....	232-41	6034	2
64	RING SET-Standard.....	149-10	10023	1
	NOTE: Ring Sets are available in the following oversizes:			
	Service Part			
	.010.....	149-158	10023 (.010)	
	.020.....	149-159	10023 (.020)	
65	RIVET-Tubular (Name Plate).....	244-21	5460	4
66	ROD ASSEMBLY-Connecting.....	245-102-5	31002-A	1
68	SCREEN-Rotating.....	257-30	90872	1
69	SCREW-R. H. S. T. #8-32 x 13/16 (Condenser to Plate).....	258-299	5741	1
70	SCREW-R. H. S. T. #8-32 x 1/4 (Insulation Grommet).....	258-83	5647	1
71	SCREW-H. H. C. 1/4-28 x 1-1/4 (Connecting Rod Cap).....	258-9	3235	2
72	SCREW-H. H. S. T. #8-32 x 3/8 (2-Deflector to Block)(1-Bracket to Carb.)....	258-81-5	5644-A	3
73	SCREW-H. W. H. 5/16-18 x 1-7/8 (2-Tank Bracket) (6-Cylinder Head).....	258-88	5654	8
74	SCREW-H. H. C. 8-32 x 7/16 Lock Thread(Air Cleaner Plate to Carburetor).....	258-131	5812	2
75	SCREW & L'WASHER ASS'Y-S. H. S. T. #8-32 x 1/2 (Touch 'N Go Lever).....	258-247-5	5443-D	1
76	SCREW & L'WASHER ASS'Y-R. H. M. Slotted #8-32 x 9/16.....	258-297-5	5737	1
	(Breaker Points to Breaker Box)			
77	SCREW & L'WASHER ASS'Y-H. H. C. 1/4-20 x 1 (Carburetor to Block).....	258-913-5		2
78	SCREW & L'WASHER ASS'Y-H. H. C. #8-32 x 3/8 (Shroud to Carburetor).....	258-875-5	5803-A	2
79	SCREW & L'WASHER ASS'Y-H. H. C. 1/4-20 x 1/2 (Blower Housing to Block).....	258-280-5	3205-G	2
80	SCREW & L'WASHER ASS'Y-H. H. C. 1/4-20 x 1-1/4 (Base to Block).....	258-254-5	5613-G	7
81	SCREW & L'WASHER ASS'Y-P. H. S. T. #10-24 x 1 (Laminations to Block).....	258-108-5	5682-A	2
82	SCREW & L'WASHER ASS'Y-S. H. #10-32 x 1/2 (Carburetor to Tank).....	258-161-5	5939-A	3
83	SCREW & L'WASHER ASS'Y-H. H. C. #10-32 x 1/2 (Valve Chamber Cover)....	258-82-5	5645-A	2
84	SEAL-Oil (Block).....	94-178-99	10012	1
85	SEAL-Oil (Engine Base).....	94-176	9029	1
86	SHROUD-Carburetor.....	259-586	92160	1
87	SPARK PLUG & GASKET ASSEMBLY-H10.....	267-28-5	16303-A	1
88	SPRING-Breaker Box Cover.....	263-10	5745	1
89	SPRING-Extension (Speed Regulating).....	263-69	90635	1
90	SPRING-Positioning, Touch 'N Go.....	263-327	14802	1
91	SPRING-Valve.....	263-92	3068	2
91-A	STARTER ASSEMBLY-Recoil (Refer to Sec. III, Div. H, Page 12).....	265-28-5	13516	1
92	TANK-Fuel.....	277-379-5	91746-A	1
93	TAPPET-Valve.....	278-5	10009	2
94	TERMINAL-Jamtitte Breaker Points.....	307-230	5738	1
95	VALVE-Exhaust.....	291-8-99	10301	1
	VALVE-Exhaust, Oversize .010 (Service Part).....	292-20-99	10321	1
96	VALVE-Intake.....	291-9-99	10302	1
	VALVE-Intake, Oversize .010 (Service Part).....	292-7	10322	1
97	VANE-Air Governor.....	107-30	91033	1
98	WASHER-"C" Valve Keeper.....	304-90	3291	2
99	WASHER-Starter.....	304-5	5879	1
100	WASHER-Terminal, Condenser Lead.....	304-290	5739	1
101	WASHER-Air Cleaner.....	215-470		1
102	WASHER-Throttle Control Lever.....	304-141	2077	1
103	WIRE ASSEMBLY-Shorting.....	307-120-5	12409-A	1

* Indicates New Part Nos. Listed For The First Time.

SERVICE INFORMATION 409-0000-000 SERIES

Type of Carburetion	-----	Lift
Bore	-----	2-3/8"
Stroke	-----	1-7/8"
Cubic Inch Displacement	-----	8.3
Spark Plug Gap	-----	.025 to .028
Point Setting	-----	.018 to .021
Oil Capacity	-----	1 Pint
Bearing-Flywheel End (Types A, B, C, D)	-----	Aluminum
Bearing-Flywheel End (Type E)	-----	Bronze (90278)
Bearing-Service PTO End	-----	9016
Valve Lash Setting	-----	.009 to .011
RPM-Horsepower Rating	-----	3 @ 3600
Block Construction	-----	Die-Cast Aluminum with Cast Iron Sleeve

1. For installation information on Service Bearing (Flywheel End), refer to Sec. VI, Div. C, Pages 9 & 10 and to the supplement to Sec. VI, Div. C, Issued September 15, 1961.
2. Chrome "Re-Ring" Set (Refer to Service Bulletin No. 4) 149-603.
3. Replacement Valve insert (.040 Oversize) 15119.
4. Tools required for service of oversize Valve insert are TL-936 Cutter, TL-951 Driver, and TL-952 Rolling Tool.
5. For Short Block information, refer to Service Bulletin No. 5.

Clinton MODEL VARIATIONS 409-0000-000

File- SECTION II DIVISION 1962
409-0000-000
MODEL VARIATIONS
REVISED APRIL, 1963

The adaptation of Clinton Engines to a wide variety of uses, results in what is known as Model Variations. Following is a list of Models produced to date. Opposite each Engine Model listed are the Part Numbers required in addition to or in place of standard parts. Refer to Basic Parts List for parts not listed in the Model Variations.

See Page C of this Manual on "How to Identify your Clinton Engine."

MODELS	CRANKSHAFT Ref. to Sec. IV Div. B	NOTES	MISCELLANEOUS INFORMATION	MODELS	CRANKSHAFT Ref. to Sec. IV Div. B	NOTES	MISCELLANEOUS INFORMATION
409-0000-001	31327 (46-487)			409-0000-033			STANDARD ENGINE REFER TO BASIC PARTS LIST
409-0000-002	31334 (46-494)			409-0000-034		7	
409-0000-003	31332 (46-492)			409-0000-035	31332 (46-492)	2, 3, 9	
409-0000-004	31308 (46-469)			409-0000-036			STANDARD ENGINE REFER TO BASIC PARTS LIST
409-2000-005	31308 (46-469)	5		409-0010-037	31336 (46-496)	6	Use 31210-A (22-175-500) Block
409-0000-006		1		409-0000-038		2, 3	
409-0000-007	31334 (46-494)	2, 3, 4		409-0000-039			STANDARD ENGINE REFER TO BASIC PARTS LIST
409-2010-008	31336 (46-496)	5, 6	Use 91016 (170-71-500) Muffler and 31210-A (22-175-500) Block	409-0000-040	31334 (46-494)	2, 3	
409-2000-009		5		409-2000-041	91371 (46-748)	4, 5, 8	
409-0000-010			Use 91016 (170-71-500) Muffler	409-0000-042	91371 (46-748)	4, 8	
409-0010-011	31336 (46-496)	6	Use 31210-A (22-175-500) Block	409-0010-043	31336 (46-496)	6	Use 31210-A (22-175-500) Block
409-0000-012	46-821	4		409-0000-044	46-821		
409-2000-013	46-821	4, 5		409-0000-045	31327 (46-487)		
409-0000-014	31337 (46-497)	2, 3	Use 18-45-500 Base & 22-590-500 Block	409-0000-046	31308 (46-469)		
409-0000-015			STANDARD ENGINE REFER TO BASIC PARTS LIST	409-0000-047		7	
409-2000-016	31332 (46-492)	5		409-0000-048	31338 (46-498)		
409-0000-017	46-825	10		409-2000-049		1, 11	
409-0000-018	31128 (46-414)			409-0000-050	31327 (46-487)		
409-0000-019	31337 (46-497)			409-0010-051	46-513	6	Use 31210-A (22-175-500) Block
409-0010-020	46-513	6	Use 31210-A (22-175-500) Block	409-0000-052	31333 (46-493)		
409-0000-021	31327 (46-487)			409-2000-053	31333 (46-493)	5	
409-2000-022	31327 (46-487)	5		409-0000-054	31333 (46-493)	2, 3	
409-0000-023			STANDARD ENGINE REFER TO BASIC PARTS LIST	409-0000-055	31308 (46-469)		
409-0000-024			STANDARD ENGINE REFER TO BASIC PARTS LIST	409-0000-058	31308 (46-469)		
409-2000-025		5		409-2000-057	31308 (46-469)	5	
409-2000-026	91371 (46-748)	2, 3, 4, 5		409-0000-058	31163 (46-446)		
409-2000-027		5		409-0000-059	31100-1 (46-409)	12	Use 31492 (18-46) Base.
409-0000-028			STANDARD ENGINE REFER TO BASIC PARTS LIST	409-0000-061	46-825	3, 13	
409-0000-029		2, 3	Use 91016 (170-71-500) Muffler	409-0000-062	31332 (46-492)	3, 8	
409-0000-030		2, 3		409-0000-063	31332 (46-492)	2, 3, 13	
409-0010-031		2, 3, 6	Use 31210-A (22-175-500) Block	409-0000-064			STANDARD ENGINE REFER TO BASIC PARTS LIST
409-2000-032	46-821	5		409-0000-065			Use 18-45-500 Base

409 SERIES NOTES

- Note 1 Use 3855-56 (307-31-500) Cable (Remote Control).
- Note 2 Use 31011 (122-17) Head.
- Note 3 Use 5752-A (83-10-500) Flywheel.
- Note 4 Use 5627 (216-22) Plug (Oil Drain).
- Note 5 Use 91119 (265-106-500) Cup, 5881 (183-32) Nut, 13540 (265-206-500) Impulse Starter, 259-652-500 Housing.
- Note 6 Use 31009-A (6-23-500) Camshaft, 10385-A (220-5-500) Oil Pump, 10390 (158-53) Oil Line, 4555 (94-170-990) Oil Seal (Cam PTO), 31487 (18-46) Base, and 4429 (94-170-990) Seal (Oil).
- Note 7 Use 91332 (45-190-500) Oil Filler Gauge.
- Note 8 Use 3494 (58-8) Decal (Warning).
- Note 9 Use 3499 (266-28) Clip (Shorting).
- Note 10 Use 10320 (121-10) Knob (Speed Control), 5444-A (258-41-500) Screw & L'Washer, and 5481 (304-12) L'Washer.
- Note 11 Use 259-652-500 Housing Ass'y (Blower), 91116 (265-196-500) Starter (Impulse), 91119 (265-106-500) Cup (Starting), and 5881 (183-32) Nut.
- Note 12 Use 4429 (94-172-990) Seal Oil (PTO End).
- Note 13 Use 90610 (69-23) Elbow (Breather), 159-370 Tube (Breather), and 39-865-500 Carburetor.