

# CLINTON

S E R I E S  
4100-2000  
4190-2000  
G E M

BASIC  
TYPE

SEC. II, DIV. 4100-2000  
PARTS CATALOG  
Revised May, 1961  
Supersedes Dec., 1959

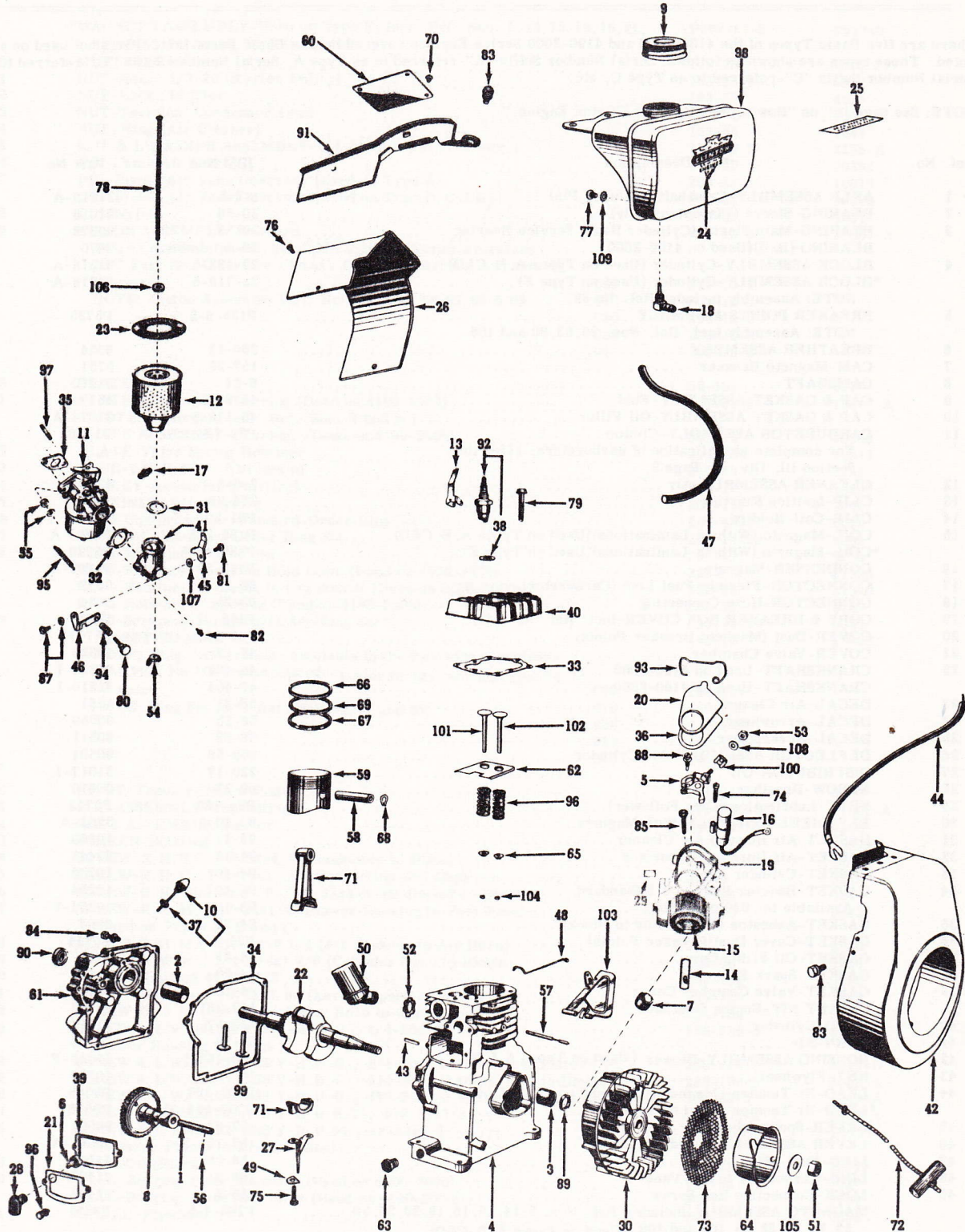



**SEC. II, DIV. 4100-2000  
PARTS CATALOG**  
Revised May, 1961  
Supersedes Dec., 1959



**BASIC  
TYPE**

**CLINTON**

There are five Basic Types of the 4100-2000 and 4190-2000 Series Engines covered by this Basic Parts List. Parts not used on all types are noted. These types are shown as follows: Serial Number Suffix "A"-referred to as Type A, Serial Number Suffix "B"-referred to as Type B, Serial Number Suffix "C"-referred to as Type C, etc.

NOTE: See page "a" on "How to Identify Your Clinton Engine."

Ref. No.	Part Description	IBM No.	Part No.	Quan.
1	AXLE ASSEMBLY-Camshaft (Includes Pin)	6-5-5	21310-A	1
2	BEARING-Sleeve (Plate Assembly)	20-56	21016	1
3	BEARING-Main Sleeve (Cylinder Head) Service Bearing	20-58	90278	1
	BEARING-(Ball)(Used on 4190-2000)	20-4	3670	1
4	BLOCK ASSEMBLY-Cylinder (Used on Types A, B, C&D)	22-183-5	31218-A	1
	*BLOCK ASSEMBLY-Cylinder (Used on Type E)	22-719-5	92018-A	1
	NOTE: Assembly includes Ref. No 89.			
5	BREAKER POINTS ASSEMBLY	P135-6-5	P5735	1
	NOTE: Assembly incl. Ref. Nos. 29, 53, 88 and 108			
6	BREATHER ASSEMBLY	260-13	6354	1
7	CAM-Magneto Breaker	157-29	5751	1
8	CAMSHAFT	6-24	31010	1
9	CAP & GASKET ASSEMBLY-Fuel	45-89-5	4517-A	1
10	CAP & GASKET ASSEMBLY-Oil Filler	45-110-5	21074-A	1
11	CARBURETOR ASSEMBLY-Clinton	P39-194-99	P14362	1
	For complete identification of carburetors, refer to Section III, Div. A, Page 2.			
12	CLEANER ASSEMBLY-Air	2-9-5	4546-A	1
13	CLIP-Ignition Shorting	266-28	3499	1
14	CLIP-Coil-Holding	P81-20	P5734	1
15	COIL-Magneto (Without Laminations)(Used on Types A, B, C&D)	P135-215	P5733-A	1
	*COIL-Magneto (Without Laminations)(Used on Type E)	P135-13-5	P5770	1
16	CONDENSER-Magneto	P135-29-5	P5589-A	1
17	CONNECTOR-Flexible Fuel Line (Carburetor)	69-5	5053	1
18	CONNECTOR-Hose Connecting	69-25	5054	1
19	CORE & BREAKER BOX COVER-Incl. Ref. No. 14	P135-37-5	P5732	1
20	COVER-Dust (Magneto Breaker Points)	P45-15	P5743	1
21	COVER-Valve Chamber	45-82	10324	1
22	CRANKSHAFT-Used on 4100-2000	46-403	31314-1	1
	CRANKSHAFT-Used on 4190-2000	46-404	31310-1	1
23	DECAL-Air Cleaner	58-21	4561	1
24	DECAL-Arrowhead	58-25	90559	2
25	DECAL-Horsepower	58-58	90511	1
26	DEFLECTOR ASSEMBLY-Air Cylinder	259-56	90504	1
27	DISTRIBUTOR-Oil	220-17	31017-1	1
28	ELBOW-Breather	69-23	90610	1
29	FELT-Lubrication (Cam Follower)	P94-189	P5742	1
30	FLYWHEEL ASSEMBLY-With Magnets	83-10-5	5752-A	1
31	GASKET-Air Horn to Air Cleaner	94-11	10259	1
32	GASKET-Air Horn to Carburetor	94-13	31445	1
33	GASKET-Cylinder Head	94-40	10253	1
34	GASKET-Bearing Plate, .015 Standard	94-107	10254	1
	Available in .010 oversize	93-107	10254-1	1
35	GASKET-Asbestos (Carburetor to Block)	94-31	6002	1
36	GASKET-Cover Dust(Breaker Points)	P94-241	P5744	1
37	GASKET-Oil Filler Cap	94-81	3297	1
38	GASKET-Spark Plug	94-90	3115	1
39	GASKET-Valve Chamber Cover	94-103	10251	1
	GASKET KIT-Engine Overhaul	149-361	91562	1
40	HEAD-Cylinder	122-17	31011	1
41	HORN-Air	69-54	21350	1
42	HOUSING ASSEMBLY-Blower (Used on Types A & B)	259-152-5	21013-F	1
43	KEY-Flywheel	148-4	10339	1
44	LEAD-Hi-Tension, Magneto(Used on Type A, B, C&D)	P307-189	P5555	1
	*LEAD-Hi-Tension (Used on Type E)	P307-194-99	P90761	1
45	LEVER-Speed Adjusting	157-83	90584	1
46	LEVER ASSEMBLY-Speed Regulating	157-123-5	90585-A	1
47	LINE-Fuel, Flexible	158-25	6316	1
48	LINK-Carburetor to Air Vane	159-21	31402	1
49	LOCK-Connecting Rod Screw	148-7	31432	2
	MAGNETO ASSEMBLY-Includes Ref. Nos. 5, 14, 15, 16, 19, 20, 26, 36, 53, 74, 85, 88, 93, 100 and 108. (Used on Types A, B, C&D)	P268-4-5	P5731	1

Printed in U. S. A.



# CLINTON

S	E	R	I	E	S
4100-2000					
4190-2000					
G E M					

BASIC  
TYPE

SEC. II, DIV. 4100-2000  
PARTS CATALOG  
Revised May, 1961  
Supersedes Dec., 1959

	*MAGNETO ASSEMBLY-Used on Type E, Incl. Ref. Nos. 5, 14, 15, 16, 19, 20, 26, 36, 53, 74, 85, 88, 93, 100 and 108 .....	P268-17-5	P91740	1
50	MUFFLER-45°Inlet .....	170-18	4500	1
51	NUT-Hex, 1/2-20 (Starter Pulley) .....	183-68-99	5942	1
52	NUT-Lock, Muffler .....	183-37	4425	1
53	NUT-Terminal Condenser Lead .....	P183-21	P5740	1
54	NUT-Wing (Air Cleaner) .....	183-66	7044	1
55	NUT & L'WASHER ASSEMBLY-1/4-28 Hex., (Carb. Mtg.) .....	183-29-5	3255-A	2
56	PIN-Camshaft Axle .....	203-20	10392	1
57	PIN-Pivot, Air Vane Governor (Used on Type A) .....	203-33	10015	1
	PIN-Pivot, Air Vane Governor (Used on Type B, C, D&E) .....	203-91	90982	1
58	PIN-Wrist .....	203-63	6024	1
59	PISTON ASSEMBLY-Standard .....	204-13-5	31001-A	1
	NOTE: Assemblies are available in the following oversizes:			
	IBM Part No. Oversize Listed. Order by part no. and specify			
	oversize. ....	.005	205-13-5	
	NOTE: Piston Assembly incl. Ref. Nos. 58, 66, 67, 68 & 69. ....	.010	206-13-5	
		.020	207-13-5	
		.030	208-13-5	
		.040	209-13-5	
60	PLATE-Name .....	58-105	6530	1
61	PLATE ASSEMBLY-Bearing (Used on 4100-2000) .....	215-52-5	10047-A	1
	NOTE: Assembly incl. Ref. Nos. 2 and 90			
	PLATE ASSEMBLY-Bearing, (Used on 4190-2000) .....	215-54	10049	1
62	PLATE-Valve Spring Retainer .....	215-136	10013	1
63	PLUG-1/4 N. P. T. (Oil Drain) .....	216-19	3289	2
64	PULLEY-Assembly (Starting) .....	219-17	12397	1
65	RETAINER-Valve Spring .....	304-135	3028	2
66	RING-Compression, Standard-Order Ring Set .....	233-4-99	6026	1
67	RING-Oil, Standard-Order Ring Set .....	233-14-99	6006	1
68	RING-Retainer, Wrist Pin .....	232-41	6034	1
	RING-Retainer, Bearing Hold Down (Used on 4190-2000) .....	232-29	21328	1
	RING-Retainer, Bearing to Crankshaft (Used on 4190-2000) .....	232-30	21329	1
	RING-Retainer Snap Ring (Used on 4190-2000) .....	232-36	6189	1
69	RING-Scraper, Standard-Order Ring Set .....	233-19-99	6027	1
	RING SET-Standard .....	149-10	10023	1
	NOTE: Ring Sets are also available in the following oversizes:			
	IBM Part No. Oversize Listed. Order by part no. and specify			
	oversize. ....	.005	149-157	
	NOTE: Ring Set incl. Ref. Nos. 66, 67 and 69. ....	.010	149-158	
		.020	149-159	
		.030	149-160	
		.040	149-161	
70	RIVET-Tubular (Name Plate) .....	244-21	5460	4
71	ROD ASSEMBLY-Connecting .....	245-102-5	31002-A	1
72	ROPE ASSEMBLY-Starter .....	246-13-5	4266	1
73	SCREEN-Rotating .....	257-2-5	90092	1
74	SCREW-R. H. S. T., 8-32x4/5 (Condenser to Plate) .....	P258-299	P5741	1
75	SCREW-H. H. C., 1/4-20x1 1/4 (Connecting Rod Cap) .....	258-9	3235	2
76	SCREW-H. H. Slotted S. T., #8-32x3/8 (Deflector to Block) .....	258-95	5644	2
77	SCREW-R. H. M., #10-24x1/4 (Blower Housing to Fuel Tank) .....	258-80	5643	2
	(Used on Types A, B and C)			
78	SCREW-R. H. M., #10-24x6 1/4 (Air Cleaner to Air Horn) .....	258-72	5636	1
79	SCREW-H. W. H., 5/16-18x1 7/8 (Cylinder Head to Block) .....	258-88	5654	8
80	SCREW-Knurled #8-32x7/8 .....	258-152	5863	1
81	SCREW-Shoulder, 10-32x3/8 (Lever, Speed Adjusting) .....	258-205	4440	1
82	SCREW-R. H. M., #8-32x11/16 (Air Horn to Carburetor) .....	258-105	5677-A	2
83	SCREW & L'WASHER ASS'Y-H. H. C., 1/4-20x1/2 .....	258-280-5	3205-G	2
	(Blower Housing to Block)			
84	SCREW & L'WASHER ASS'Y-H. H. C., 1/4-20x1 1/4 (Bearing Plate to Bl.) .....	258-284-5	5613-G	6
85	SCREW & L'WASHER ASS'Y-H. H. C., #10-24x1 (Laminations to Block) .....	258-108-5	5682-A	2
86	SCREW & L'WASHER ASS'Y-H. H. C., #10-24x1/2 (Valve Chamber Cover) .....	258-82-5	5645-A	2
87	SCREW & L'WASHER ASS'Y-H. H. S. T., #10-32x3/8 .....	258-272-5	5838-A	1
88	SCREW & L'WASHER ASS'Y-R. H. M., #8-32x3/8 .....	P258-297-5	P5737	1
	(Breaker Points to Breaker Box)			
89	SEAL-Oil (Block) .....	94-178	10012	1
90	SEAL-Bearing Plate Assembly(Used on 4100-2000) .....	94-162	3026	1
	SEAL-Bearing Plate Assembly (Used on 4190-2000) .....	94-166	3764	1
91	SHIELD-Flywheel .....	259-318	90502	1



SEC. II. DIV. 4100-2000  
 PARTS CATALOG  
 Revised May, 1961  
 Supersedes Dec., 1959

**S E R I E S**  
**4100-2000**  
**4190-2000**  
**G E M**

BASIC  
 TYPE

**CLINTON**

92	SPARK PLUG & GASKET ASSEMBLY (H-10) .....	K267-28-5	K16303-A	1
93	SPRING-Breaker Box Cover .....	P263-10	P5745	1
94	SPRING-Compression (Knurled Screws) .....	263-34	90586	1
95	SPRING-Air Governor .....	263-73	90842	1
96	SPRING-Valve .....	263-92	3068	2
97	STUD-Carburetor Mounting .....	24-11	5659	2
98	TANK ASSEMBLY-Fuel (Includes Ref. No. 9)(Used on Types A, B) .....	277-74-5	21380-A	1
	*TANK AND HOUSING ASSEMBLY-Used on Type C, D&E .....	259-523-5	21001-B	1
99	TAPPET-Valve .....	278-5	10009	2
100	TERMINAL-Jamtite Breaker Points .....	P307-230	P5738	1
101	VALVE-Exhaust .....	291-8	10301	1
	VALVE-Exhaust, .010 Oversize .....	292-6	10321	1
102	VALVE-Intake .....	291-7	10302	1
	VALVE-Intake, .010 Oversize .....	292-7	10322	1
103	VANE-Air Governor (Used on Type A) .....	107-11	10014	1
	VANE-Air Governor (Used on Type B, C, D&E) .....	107-30	91033	1
104	WASHER-"C" Valve Keeper .....	304-134	3291	2
105	WASHER-Starter Pulley .....	304-132	5941	1
106	WASHER-Rubber (Screw to Air Cleaner) .....	304-136	5906	1
107	WASHER-Speed Adjusting .....	304-88	3279	1
108	WASHER-Terminal Condenser Lead .....	P304-290	P5739	1
109	WASHER-Lock (Blower Housing to Fuel Tank) (Used on Types A & B) .....	304-7	5900	2



# CLINTON

# S E R I E S 4100-2000 G E M

## MODEL VARIATIONS

SEC. II, DIV. 4100-2000  
PARTS CATALOG  
Revised June, 1960  
Supersedes Feb., 1960

## MODEL VARIATIONS OF 4100-2000 SERIES

The adaptation of Clinton Engines to a wide variety of uses results in what is known as "Model Variations." Following is the complete list of all Models produced up to issue date (shown above). Opposite each Engine Model listed are the Part Numbers and/or Assembly Numbers for the Series used IN ADDITION TO or IN PLACE OF the parts illustrated and shown on the Basic Parts List preceding this Model Variations List. Refer to other sections of this Manual when Assembly Numbers are given to find the Parts List for these assemblies.

See page (a) on "How to Identify Your Clinton Engine." Use the preceding Basic Parts List except as shown below.

ENGINE MODEL—See page (a), "How to Identify Your Clinton Engine."	FOOTNOTES (Check bottom of page).	BASE—ENGINE (Part Numbers Shown). Refer to Sec. IV, Div. A for further information.	BLOCK ASSEMBLY — CYLINDER (Part Number Shown). Refer to Illustrated Basic Parts List for corresponding part.	CRANKSHAFT (Part Numbers Shown). Refer to Sec. IV, Div. B for details and further information.	BEARING—MAIN (Part Numbers Shown). Refer to Illustrated Basic Parts List for corresponding part.	CONTROL GROUP (Control Group Illustration Numbers Shown). Refer to Sec. III, Div. D for Parts List.	CONTROL CABLE LENGTH — Replacement cable is furnished in 72" length ONLY, cut to length shown.	PLATE ASSEMBLY — BEARING (Part Numbers Shown). Refer to Illustrated Basic Parts List for corresponding part.	MUFFLER OR MANIFOLD (Part Numbers shown). Refer to Illustrated Basic Parts List for corresponding part.	STARTER—RECOIL OR IMPULSE. Refer to Sec. III, Div. H for Parts List.	HOUSING ASSEMBLY — BLOWER (Part Numbers Shown). Refer to Basic Parts List for corresponding part.	REDUCTION GEAR (Assy. Nos. Shown). Refer to Sec. III, Div. C for Parts List.	MOUNTING POSITION — "Clock" position, shows mounting of reduction unit in relation to Crankshaft.
4100-2101										P90996	21013-F		
4100-2102					SK-560					P90996	21013-F		
4100-2103	Note 3				SK-560					P90996	21013-F		
4100-2104					SK-560					P90996	21013-F		
4100-2105							10048-A			P90996	21001-B		
4100-2106	NO VARIATION—USE BASIC PARTS LIST												
4100-2107	Notes 4, 5, 6									P90996	21013-F		
4100-2108													
4120-2000	Note 2		31302-1									3552	9:00
4160-2000	Note 2		31306-1				10049					3800	9:00
4160-2100	Note 2		31316-1		SK-560					P90996	21001-B	3800	9:00
4190-2000	Note 1		31310-1	3670			10049						
4190-2100	Note 1		31319	3670			10049						
4190-2101	Note 1		31312	3670			10049						
4190-2103	Note 1		31310-1	3670			10049			P90996	21013-F		
4190-2104	Note 1		31310-1	3670			10049			P90996	21013-F		
4190-2105	Note 1		31310-1	3670	SK-560		10049			P90996	21013-F		
4190-2106	Note 1		31318-1	3670			10049						
4190-2107	Note 1		31319	3670			10049			P90996	21013-F		
4190-2109	Note 1		31318-1	3670			10049						
4190-2110	Notes 1, 4, 7, 8		31218-D	31319	3670		10049						

NOTE 1—Use 21328 Ring (Retaining), 21329 Ring (Retaining), 6189 Spacer, 3764 Seal (Oil).

NOTE 2—Use 3136 Seal and 91561 Gasket Kit.

NOTE 3—Use 21351 Horn (Air), 5052 Elbow, 4533 Tube (Breather).

NOTE 4—Use 10080-A Body (Muffler), 10075 Nut (Muffler), 10068-A Cover (Muffler), 5861 Bolt (Muffler), 5868 Nut (Wing).

NOTE 5—Use 4182 Switch, 12409-A Wire Assembly.

NOTE 6—Use K15379-A Spark Plug (Resistor).

NOTE 7—Use 21301 Stellite Exhaust Valve; use standard exhaust valve as intake valve; 31512 Insert (Stellite Exhaust).

NOTE 8—Use 31012 Head (Cylinder), 21000-A Housing Ass'y (Blower), 12368-A Tank Ass'y (Fuel), 5054 Elbow (Hose Connector), 4584 Valve (3-way), 3576 Nipple (Close), 5053 Connector (Hose), 5052 Elbow (Hose Connector), 21352-A Bracket Ass'y, 7943 Strap (Fuel Tank) (2), 5613-G Screw & L'Washer Ass'y (2), 5450 Nut, 4517-E Cap Ass'y (Fuel), 6316 Line (Fuel), 3496 Decal (Gasoline), 3497 Decal (Kerosene).