

# Clinton BASIC PARTS LIST

## 412-0000-000

SEC. II, DIVISION 1962  
 412-0000-000  
 BASIC PARTS LIST  
 ISSUED OCTOBER, 1963

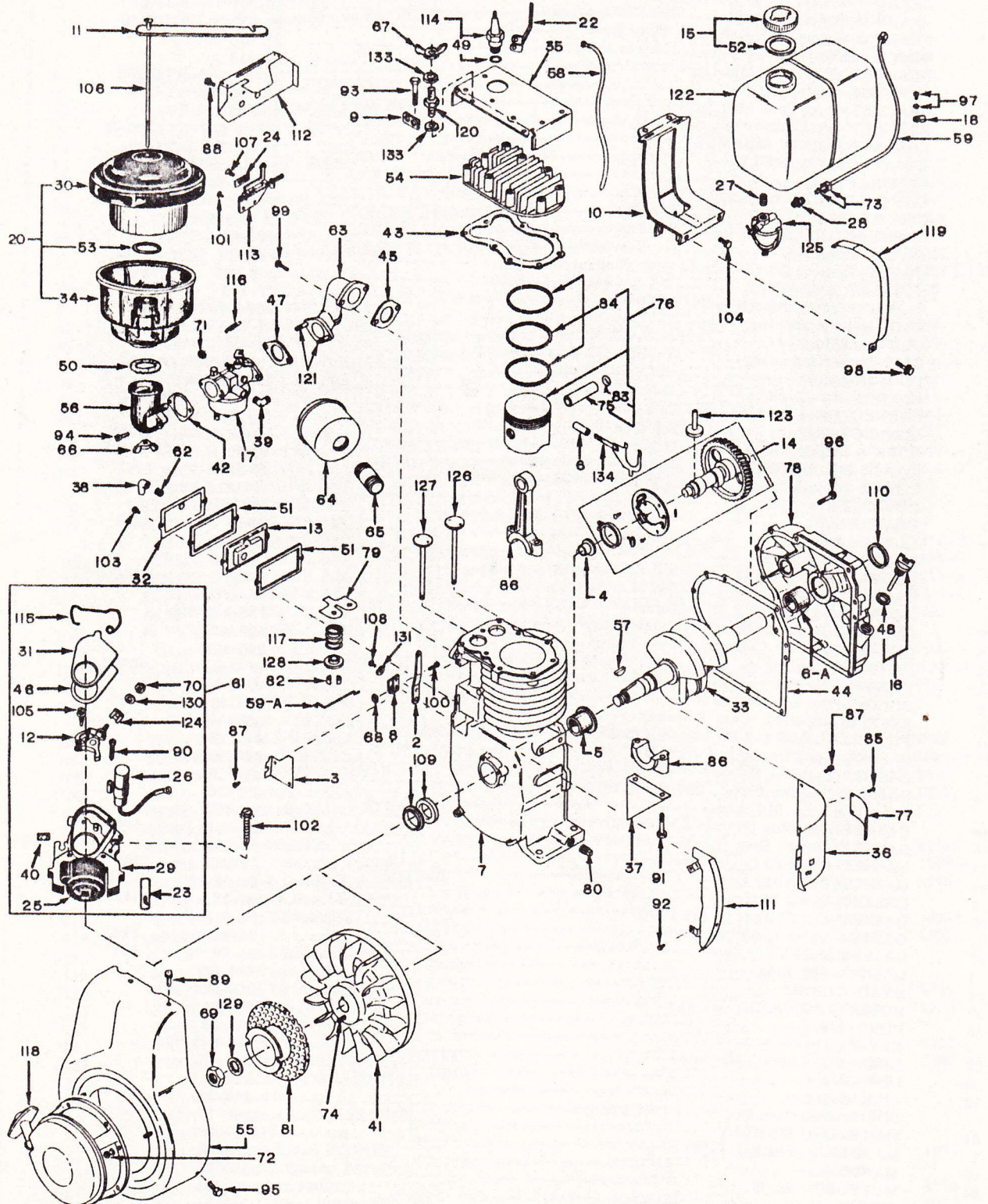

**CLINTON ENGINES CORPORATION**  
 MAQUOKETA, IOWA

Printed in U.S.A.

There are two (2) types 412-0000-000 covered by this Basic Parts List.

Item No.	Parts Description	IBM No.	Part No.	Qty.
1	ADAPTOR-Magneto-----	1-75		1
2	ARM-Governor-----	157-390		1
3	BAFFLE-Cylinder Block-----	17-46		1
4	BEARING-Camshaft-----	20-200		1
5	BEARING-Flange (Cylinder Block)-----	20-105		1
6	BEARING-Governor Shaft-----	20-207		1
6-A	BEARING-Sleeve (PTO) Used on Type B-----	20-27	16430	1
7	BLOCK ASSEMBLY-Cylinder-----	22-630-500		1
8	BRACKET-Governor Adjusting-----	26-613		1
9	BRACKET-Engine Lifting-----	26-27	16360	1
10	BRACKET-Fuel Tank Mounting-----	26-562-500		1
11	BRACKET-Air Cleaner Support-----	26-652		1
12	BREAKER POINTS ASSEMBLY-----	135-7-500	5735-M	1
13	BREATHER ASSEMBLY-----	29-31-500		1
14	CAMSHAFT-----	6-381-500		1
15	CAP & GASKET ASSEMBLY-Fuel-----	45-95-500	3059	1
16	CAP & GASKET ASSEMBLY-Oil Filler-----	45-291	21074-A	1
17	CARBURETOR ASSEMBLY-----	39-811-500		1
18	CLAMP-Fuel Line-----	81-163		1
19	CLAMP-Remote Control Cable (Not Illustrated)-----	81-13	31463	1
20	CLEANER ASSEMBLY-Air-----	2-6-500	6215-A	1
21	CLIP-Cable (Not Illustrated)-----	81-156		1
22	CLIP-Ignition Shorting-----	266-28	3499	1
23	CLIP-Coil Holding-----	81-20	5734	1
24	CLIP-Spring Adjusting-----	81-71		1
25	COIL-Magneto-----	135-13-500	5770	1
26	CONDENSER-Magneto-----	135-29-500	5589-A	1
27	CONNECTOR-1/8 Close-----	69-59	3576	1
28	CONNECTOR-Tank Valve to Fuel Line-----	69-289		1
29	CORE & BREAKER BOX ASSEMBLY-----	135-37-500	5732	1
30	COVER & ELEMENT-Air Cleaner-----	45-33	6215	1
31	COVER-Dust, Magneto Breaker Points-----	45-15	5743	1
32	COVER-Valve Chamber-----	45-311		1
33	CRANKSHAFT-----	46-783		1
34	CUP-Air Cleaner-----	25-5	6216	1
	DECAL-Arrowhead-----	58-456		2
	DECAL-Warning (Oil Level)-----	58-474		1
	DECAL-Throttle Control-----	58-98 <sup>1</sup>	3488	1
	DECAL-Long Life Cast Iron Engine-----	58-475		1
35	DEFLECTOR ASSEMBLY-Cylinder Head-----	259-487-500		1
36	DEFLECTOR-Air Cylinder (Name Plate)-----	259-412		1
37	DISTRIBUTOR-Oil-----	220-122		1
38	ELBOW-Breather-----	69-23	90610	1
39	ELBOW-Fuel Line to Carb.-----	69-290		1
40	FELT-Lubrication, Cam Follower-----	94-189	5742	1
41	FLYWHEEL ASS'Y-With Magnets (Sold as complete Ass'y only)-----	83-71-500		1
42	GASKET-Air Cleaner to Carburetor-----	94-516		1
43	GASKET-Cylinder Head-----	94-250-990		1
44	GASKET-Bearing Plate (.020 Standard)-----	94-379		1
	Available in .015 Size-----	93-379		1
45	GASKET-Asbestos (Manifold to Block)-----	94-462		1
46	GASKET-Cover, Dust (Breaker Points)-----	94-241	5744	1
47	GASKET-Manifold to Carburetor-----	94-539		1
48	GASKET-Oil Filler Cap-----	94-82	5097	1
49	GASKET-Spark Plug-----	94-92-990	3115	1
50	GASKET-Air Cleaner to Air Horn-----	94-17	16258	1
51	GASKET-Valve Chamber Cover-----	94-311		2
52	GASKET-Fuel Tank Cap-----	94-59	3113	1
53	GASKET-"O" Ring-----	94-89	6217	1
54	HEAD-Cylinder-----	122-33		1
55	HOUSING ASSEMBLY-Blower-----	259-594-500		1
56	HORN-Air-----	69-301		1
57	KEY-Flywheel-----	148-38		1
58	LEAD-Hi-Tension, Magneto-----	307-269-990		1
59	LINE-Fuel-----	158-408		1
59-A	LINK-Governor-----	159-151		1
	LOCK-Connecting Rod Screw (Not Illustrated)-----	148-35		1
61	MAGNETO ASSEMBLY-----	268-17-500	91740	1
62	MANDREL-Breather Tube-----	69-69	10353	1
63	MANIFOLD-----	169-88		1
64	MUFFLER ASSEMBLY-----	170-23	16019	1
65	NIPPLE-Muffler (Pipe 1", Diameter by 2-1/2")-----	69-264		1
66	NUT-Wing-----	183-66	7044	1
67	NUT-Wing (Support Bracket Stud)-----	183-65	3262	1
68	NUT-Bracket to Shaft-----	183-53	3253	1
69	NUT-Hex. 5/8-18 (Starter Pulley)-----	183-207		1

Item No.	Parts Description	IBM No.	Part No.	Qty.
70	NUT-Terminal Condenser Lead-----	183-21	5740	1
71	NUT & L'WASHER ASS'Y-1/4-28 Hex. (Carburetor to Manifold)-----	183-29-500	3255-A	2
72	NUT & L'WASHER ASS'Y-Recoil Starter 1/4-20-----	183-1-500	5450-A	4
73	NUT & FERRULE ASS'Y-Fuel Line-----	183-245		2
74	PIN-Drive, Flywheel-----	203-21	12079	1
75	PIN-Wrist-----	203-66	16013	1
76	PISTON ASSEMBLY-Standard-----	204-72-500		1
	NOTE: Piston Assemblies are available in the following oversizes:			
	.010-----	206-72-500		
	.020-----	207-72-500		
77	PLATE-Name-----	58-105	6530	1
78	PLATE-Bearing (Used on Type A)-----	215-445		1
78	PLATE-Bearing (Used on Type B)-----	215-480-500		1
79	PLATE-Valve Spring Retainer-----	232-149		1
80	PLUG-Oil Drain-----	216-22	5627	2
81	PULLEY & SCREEN-Starter-----	219-158-500		1
82	RETAINER-Valve-----	232-3	16320	4
83	RING-Retainer, Wrist Pin-----	232-42	16014	2
	RING-Retaining Governor Shaft(Not Illustrated)-----	232-23	4543	1
84	RING SET-Standard-----	149-288	16023	1
	NOTE: Ring Sets are available in the following oversizes:			
	.010-----	149-173	16023 (.010)	
	.020-----	149-174	16023 (.020)	
85	RIVET-Tubular (Name Plate)-----	244-21	5460	4
86	ROD ASSEMBLY-Connecting-----	245-82-500		1
87	SCREW-H. H. S. T. #8-32 x 3/8 (2-Baffle to Block, 2-Deflector to Block)-----	258-81	5644	4
88	SCREW-H. H. S. T. #8-32 x 1/4 (2-Shroud to Bracket, 1-Clamp to Shroud)-----	258-159	5892	3
89	SCREW-H. H. S. T. #8-18 x 1/4 (Blower Housing to Flywheel Shield)-----	258-160	5934	2
90	SCREW-R. H. S. T. #8-32 x 4/5 (Condenser to Plate)-----	258-299	5741	1
91	SCREW-H. H. C. 5/16-18 x 1-3/4 (Connecting Rod Cap)-----	258-53	5614	2
92	SCREW-H. H. S. T. #8-32 x 3/8 (Shield to Block)-----	258-81	5644	2
93	SCREW-H. H. C. 5/16-18 x 2-1/4 (Cylinder Head to Block)-----	258-115	5691	9
94	SCREW-R. H. M. #8-32 x 11/16 (Air Horn to Carburetor)-----	258-105	5677	2
95	SCREW & L'WASHER ASS'Y-H. H. C. 1/4-20 x 1/2 (Blower Housing to Block)-----	258-280-500	3205-G	3
96	SCREW & L'WASHER ASS'Y-H. H. C. 1/4-20 x 1-3/4 (PTO Brng. Plt. to Block)-----	258-970-500		8
97	SCREW & L'WASHER ASS'Y-H. H. S. T. #10-24 x 3/8----- (Fuel Line Clamp to Bearing Plate)	258-765-500		1
98	SCREW & L'WASHER ASS'Y-H. H. C. 1/4-20 x 1-1/4 (Fuel Tank Straps)-----	258-254-500	5613-G	2
99	SCREW & L'WASHER ASS'Y-H. H. C. 1/4-20 x 7/8 (Manifold to Block)-----	258-284-500	3294-G	2
100	SCREW & L'WASHER ASS'Y-R. H. M. 10-24 x 5/8 (Governor Bracket to Shaft)-----	258-196-500	3211-A	1
101	SCREW & L'WASHER ASS'Y-H. H. C. #8-32 x 3/8 (Slide Ass'y to Carb.)-----	258-81-500	5644-A	2
102	SCREW & L'WASHER ASS'Y-H. H. C. #10-24 x 1 (Self Tapping)----- (Laminations to Block)	258-108-500	5682-A	2
103	SCREW & L'WASHER ASS'Y-H. H. C. #10-24 x 1/2 (Valve Chamber Cover)-----	258-82-500	5645-A	2
104	SCREW & L'WASHER ASS'Y-H. H. C. 1/4-20 x 5/8 (Tank Brkt. to Block)-----	258-232-500	3632-G	1
105	SCREW & L'WASHER ASS'Y-R. H. M. #8-32 x 3/8----- (Breaker Points to Breaker Box)	258-297-500	5737	1
106	SCREW-R. H. M. #10-32 x 7-1/2 (Air Cleaner to Air Horn)-----	258-959		1
107	SCREW-H. H. S. T. 4-40 x 1/4 (Clip to Lever)-----	258-374	5520	1
108	SCREW & L'WASHER ASS'Y-H. H. C. #8-32 x 3/8 (Gov. Bracket to Gov. Arm)-----	258-81-500	5644-A	1
109	SEAL-Oil (Block)-----	94-176-990	9029	1
110	SEAL-Oil (Bearing Plate, PTO)-----	94-182-990	16053	1
111	SHIELD-Flywheel-----	259-551		1
112	SHROUD-Carburetor-----	259-596		1
113	SLIDE ASS'Y-Governor Regulating-----	149-203	91330	1
114	SPARK PLUG & GASKET ASSEMBLY-----	267-5-500	3568-A	1
115	SPRING-Breaker Box Cover-----	263-10	5745	1
116	SPRING-Speed Regulating-----	263-356		1
117	SPRING-Valve-----	263-88	16322	2
118	STARTER ASSEMBLY-Recoil-----	265-92-500	4909	1
119	STRAP-Fuel Tank-----	26-530		2
120	STUD-Support Bracket to Deflector-----	258-928		1
121	STUD-Carburetor to Manifold-----	24-11	5659	2
122	TANK ASSEMBLY-Fuel-----	277-59-500	12051	1
123	TAPPET-Valve-----	278-11		2
124	TERMINAL-Jamtite Breaker Points-----	307-230	5738	1
125	VALVE-Fuel Shut-Off (Flexible Line)-----	293-32-500	3500-A	1
126	VALVE-Exhaust-----	291-27-990		1
	VALVE-Exhaust (.010 Oversize)-----	292-27		1
127	VALVE-Intake-----	291-26-990		1
	VALVE-Intake (.010 Oversize)-----	292-26		1
128	WASHER-Valve Spring Retaining-----	304-168	16321	2
129	WASHER-Starter Pulley-----	304-567		1
130	WASHER-Terminal Condenser Lead-----	304-290	5739	1
131	WASHER-Governor Arm Adjusting-----	304-125	7976	1
	WASHER-Lock (Air Cleaner Screw) (Not Illus.)-----	304-28	3285	1
133	WASHER-Support Bracket Stud to Support Bracket-----	304-26	3277	2
134	YOKE ASS'Y-Governor-----	109-30-500		1

SERVICE INFORMATION 412-0000-000 SERIES

Type of Carburetion	-----	Float
Bore	-----	2-13/16"
Stroke	-----	2-1/2"
Cubic Inch Displacement	-----	15.5
Spark Plug Gap	-----	.025 to .028
Point Setting	-----	.018 to .021
Bearing - Flywheel End	-----	Bronze (Flange)
Bearing - PTO End	-----	Sleeve (Tapered Roller Optional)
Valve Lash Setting	-----	.011 to .012
Block Construction	-----	Cast Iron (Shell Molded)
Gasket Kit (Eng. Overhaul)	-----	149-585



# MODEL VARIATIONS

## 412-0000-000

FILE SEC. II DIVISION 1962  
412-0000-000  
MODEL VARIATIONS  
REVISED APRIL 1964  
SUPERSEDES OCTOBER 1963

The adaptation of Clinton Engines to a wide variety of uses, results in what is known as Model Variations. Following is a list of Models produced to date. Opposite each Engine Model listed are the Part Numbers required in addition to or in place of standard parts. Refer to Basic Parts List for parts not listed in the Model Variations.

See Page C of this Manual on "How to Identify your Clinton Engine."

MODELS	CRANKSHAFT Ref. to Sec. IV Div. B	NOTES	MISCELLANEOUS INFORMATION	MODELS	CRANKSHAFT Ref. to Sec. IV Div. B	NOTES	MISCELLANEOUS INFORMATION
412-0320-002	46-805	1, 2	Use 215-498-500 Plate (Bearing-PTO), 22-738-500 Block, 2:1 Speed Reducer, and 9:00 Mtg. Position	412-0360-020	46-806	1, 2, 10	Use 215-498-500 Plate (Bearing-PTO), 22-738-500 Block, 6:1 Speed Reducer, and 9:00 Mtg. Position
412-0340-003	46-806	1, 2	Use 215-498-500 Plate (Bearing-PTO), 22-738-500 Block, 4:1 Speed Reducer, and 9:00 Mtg. Position	412-0300-021	46-802	2, 10	Use 215-446 Plate (Bearing-PTO), and 22-738-500 Block
412-0360-004	46-806	1, 2	Use 215-498-500 Plate (Bearing-PTO), 22-738-500 Block 6:1 Speed Reducer, and 9:00 Mtg. Position	412-1300-022	46-802	2, 5	Use 215-446 Plate (Bearing-PTO), and 22-738-500 Block
412-0300-005	46-802	2	Use 215-446 Plate (Bearing-PTO), and 22-738-500 Block	412-0000-023		11, 17	Use 22-587-500 Block
412-0300-006	46-801	2	Use 215-446 Plate (Bearing-PTO), and 22-738-500 Block	412-0300-024	46-804	2, 3, 4	Use 215-446 Plate (Bearing-PTO), and 22-738-500 Block
412-0300-007	46-803	2	Use 215-446 Plate (Bearing-PTO), and 22-738-500 Block	412-0300-025	46-802	2, 5, 12	Use 215-446 Plate (Bearing-PTO), and 22-738-500 Block
412-0300-008	46-804	2	Use 215-446 Plate (Bearing-PTO), and 22-738-500 Block	412-0300-026	46-802	2, 3, 4	Use 215-446 Plate (Bearing-PTO), and 22-738-500 Block
412-1360-009	46-806	1, 2, 3, 4, 5	Use 215-498-500 Plate (Bearing-PTO), 22-738-500 Block, 6:1 Speed Reducer, and 9:00 Mtg. Position	412-5100-027		5, 7, 9, 10	Use 22-740-500 Block and 215-462-500 Plate (Bearing-PTO)
412-1300-010	46-802	2, 3, 4, 5	Use 215-446 Plate (Bearing-PTO), and 22-738-500 Block	412-5000-028		7, 9, 13, 14, 24	Use 22-740-500 Block and 215-457 Plate (Bearing-PTO)
412-1000-011		3, 4, 5		412-1360-029	46-806	1, 2, 6, 15, 16	Use 215-498-500 Plate (Bearing-PTO), 22-738-500 Block, 6:1 Speed Reducer, and 9:00 Mtg. Position
412-0000-012		3, 4, 6		412-0300-030	46-802	2, 6	Use 215-446 Plate (Bearing-PTO), and 22-738-500 Block
412-0300-013	46-802	2, 3, 4, 6	Use 215-446 Plate (Bearing-PTO), and 22-738-500 Block	412-1000-031		5	
412-0360-014	46-806	1, 2, 3, 4, 6	Use 215-498-500 Plate (Bearing-PTO), 22-738-500 Block, 6:1 Speed Reducer, and 9:00 Mtg. Position	412-1360-032	46-806	1, 2, 5	Use 215-498-500 Plate (Bearing-PTO), and 22-738-500 Block
412-5300-015	46-802	2, 5, 7, 9	Use 215-463 Plate (Bearing-PTO), and 22-739-500 Block	412-1300-033	46-801	2, 5	Use 215-446 Plate (Bearing-PTO), and 22-738-500 Block
412-7300-016	46-802	2, 8	Use 215-446 Plate (Bearing-PTO), and 22-738-500 Block	412-1300-034		5	
412-1300-017	46-802	2, 3, 4, 5	Use 215-446 Plate (Bearing-PTO), and 22-738-500 Block	412-1300-035	46-802	2, 5	Use 215-446 Plate (Bearing-PTO), and 22-738-500 Block
412-1000-018		5		412-0300-036	46-804	2, 3, 4	Use 215-446 Plate (Bearing-PTO), and 22-738-500 Block
412-5000-019		3, 4, 5, 6, 7, 9	Use 215-457 Plate (Bearing-PTO), and 22-740-500 Block	412-1300-037	46-802	2, 5	Use 215-446 Plate (Bearing-PTO), and 22-738-500 Block
				412-0000-038		18, 19	
				412-0300-039	46-802	2, 12	Use 215-446 Plate (Bearing-PTO), and 22-738-500 Block
				412-1360-040	46-806	1, 5	Use 215-498-500 Plate (Bearing-PTO), and 22-738-500 Block
				412-0000-041		19	
				412-0300-042	46-802	2, 20, 21, 22	Use 215-446 Plate (Bearing-PTO), and 22-738-500 Block
				412-0300-043	46-804	2, 23	Use 215-446 Plate (Bearing-PTO), and 22-738-500 Block

MODELS	CRANKSHAFT Ref. to Sec. IV Div. B	NOTES	MISCELLANEOUS INFORMATION	MODELS	CRANKSHAFT Ref. to Sec. IV Div. B	NOTES	MISCELLANEOUS INFORMATION
412-1300-046	46-802	2, 5	Use 215-446 Plate (Bearing PTO), and 22-738-500 Block.	412-1000-052		5, 26, 27, 28	
412-1300-047	46-801	2, 5, 18	Use 215-446 Plate (Bearing PTO), and 22-738-500 Block.	412-1300-053	46-802	2, 5	Use 215-446 Plate (Bearing PTO) and 22-738-500 Block.
412-1300-048	46-801	2, 5, 18	Use 215-446 Plate (Bearing PTO), and 22-738-500 Block.	412-1300-054	46-802	2, 5, 18	Use 215-446 Plate (Bearing PTO) and 22-738-500 Block.
412-0000-049		18, 25		412-0300-055	46-804	2, 23, 29	Use 215-446 Plate (Bearing PTO) and 22-807 Block.
412-1300-050	46-849	2, 5, 10	Use 215-446 Plate (Bearing PTO), and 22-738-500 Block.				
412-1300-051	46-802	2, 5, 18	Use 215-446 Plate (Bearing PTO), and 22-738-500 Block.				

#### 412-0000-000 SERIES NOTES

- Note 1 This unit equipped with Speed Reducer. Refer to Sec. III, Div. C, Pages 3 & 4.
- Note 2 Use 20-67 Bearing (2), and 20-64 Bearing (Cup) (2)
- Note 3 Use 39-831-500 Carburetor.
- Note 4 Use 157-396-500 Slide Ass'y (Governor Regulating), 203-154 Roll Pin (in Slide Ass'y), and 258-125 Screw (in Slide Mounting Bracket to Lock Governor Regulating Slide).
- Note 5 Use 257-51 Screen (Rotating), 219-122 Pulley (Starting), 258-220-500 Screw & L'Washer (Pulley to Flywheel) (2), 259-439-500 Housing Ass'y (Blower), and 246-13-500 Starter Rope.
- Note 6 Use 69-268 Horn (Air), 69-269 Connector (Tube to Elbow), and 158-167 Tube (Breather).
- Note 7 Use 268-18-500 Magneto Ass'y, 259-558 Shield (Flywheel), 70-10 Grommet (in Shield), 83-99-500 Flywheel Ass'y, 26-546-500 Bracket Ass'y (Starter Mounting), 215-448 Plate (Rectifier Mounting), 135-249 Rectifier, 258-881-500 Screw & L'Washer (Rectifier to Plate), 183-39 Nut (Lock-Rectifier to Plate), 258-882-500 Screw & L'Washer (Plate to Bracket), 258-232-500 Screw & L'Washer (Bracket to Block) (4), 26-565-500 Bracket (Fuel Tank), 258-280-500 Screw & L'Washer (Tank Bracket to Starter Bracket) (2), 264-59-500 Starter (Electric), 258-908-500 Screw & L'Washer (Starter to Bracket) (4), 304-13 L'Washer (Starter to Bracket) (2), 307-296-500 Terminal Strip, 258-132-500 Screw & L'Washer (Strip to Block) (2), 259-582-500 Housing Ass'y (Blower), 277-59-500 Tank Ass'y (Fuel), 26-530 Strap (Fuel Tank) (2), 258-254-500 Screw & L'Washer (Strap to Block) (2), 183-1 Nut (Strap to Bracket) (2), 293-169 Valve (Fuel Shut-Off), 158-408 Line (Fuel), and 69-289 Connector. See Sec. III Div. N.
- Note 8 Use 268-19-500 Magneto Ass'y, 70-10 Grommet (in Flywheel Shield), 83-99-500 Flywheel Ass'y, 307-296-500 Terminal Strip, and 258-132-500 Screw & L'Washer (Strip to Block) (2). See Sec. III, Div. N.
- Note 9 Use 277-442 Neck Ass'y (Oil Filler).
- Note 10 Use 307-344-990 Lead (Magneto-Hi-Tension), 183-31 Nut (Insulation), 266-26 Clip (Shorting), 70-8 Grommet (in Cylinder Block Baffle), 307-124-500 Wire Ass'y (Shorting), 183-26 Nut (Shorting Wire to Stator Ass'y), and 258-83 Screw (to Insulation Nut).
- Note 11 Use 267-27-500 Spark Plug (Resistor).
- Note 12 Use 277-67-500 Tank Ass'y (Fuel), 26-530 Strap (Fuel Tank) (2), 258-254-500 Screw & L'Washer (Straps to Bracket) (2), 69-59 Nipple, 293-32-500 Valve (Fuel Shut-Off), and 69-289 Connector.
- Note 13 Use 307-344-990 Lead (Magneto-Hi-Tension), 258-81 Screw, 70-7 Grommet (Flywheel Shield), 70-8 Grommet (Flywheel Shield), 307-121-500 Wire Ass'y (Shorting), and 183-26 Nut (Wire to Stator Ass'y).
- Note 14 Use 216-25 Plug (Oil Drain).
- Note 15 Use 257-51 Screen (Rotating), 219-122 Pulley (Starting), 258-220-500 Screw & L'Washer (Pulley to Flywheel) (2), 259-689-500 Housing & Cable Ass'y, and 246-13-500 Rope (Starting).
- Note 16 Use 45-68-500 Cover (Spark Plug-Shorting).
- Note 17 Use 124-161-500 Housing & Bearing Ass'y (Governor Shaft).
- Note 18 Use 26-562-500 Bracket Ass'y (Tank Mounting), 26-530 Strap (Tank Mounting) (2), 258-284-500 Screw & L'Washer (2), 69-290 Elbow, 277-66-500 Tank Ass'y (Dual Compartment), 69-59 Connector, 293-10 Valve (3-Way), 69-290 Connector, 158-397 Line (Fuel), 183-245 Nut & Ferrule.
- Note 19 Use 2-137 Body (Air Cleaner), 2-149-990 Element (Air Cleaner), 45-351 Cover (Air Cleaner), and 58-387 Decal.
- Note 20 Clinton does not supply the Air Cleaner for this Unit.
- Note 21 Clinton does not supply the Carburetor for this Unit.
- Note 22 Clinton does not supply Slide Ass'y for this Unit.
- Note 23 This unit is equipped with Ignition Shielding, refer to Sec. III, Div. Q.
- Note 24 Use 257-51 Screen (Rotating), 219-122 Pulley (Starting), 258-220-500 Screw & L'Washer (Pulley to Flywheel) (2), and 246-13-500 Starter Rope.
- Note 25 Use 2-137 Body Air Cleaner, 2-205-990 Element Air Cleaner, and 45-413 Cover Air Cleaner.
- Note 26 Same as Note 6 Except Use 69-304 Horn(Air).
- Note 27 Use 94-553 Gasket Air Horn, 2-169 Element, 2-170 Base, 45-406-500 Cover, (2)232-166 Clip Spring, (2)258-131 Screw.
- Note 28 See S. B. #4 for Chrome Re-Ring Set Information.
- Note 29 Use 124-161 Gov. Shaft Bearing.