

# Clinton BASIC PARTS LIST

## 420-1301-005

FILE SEC. II DIVISION 1962  
420-1301-005  
BASIC PARTS LIST  
ISSUED APRIL 1964

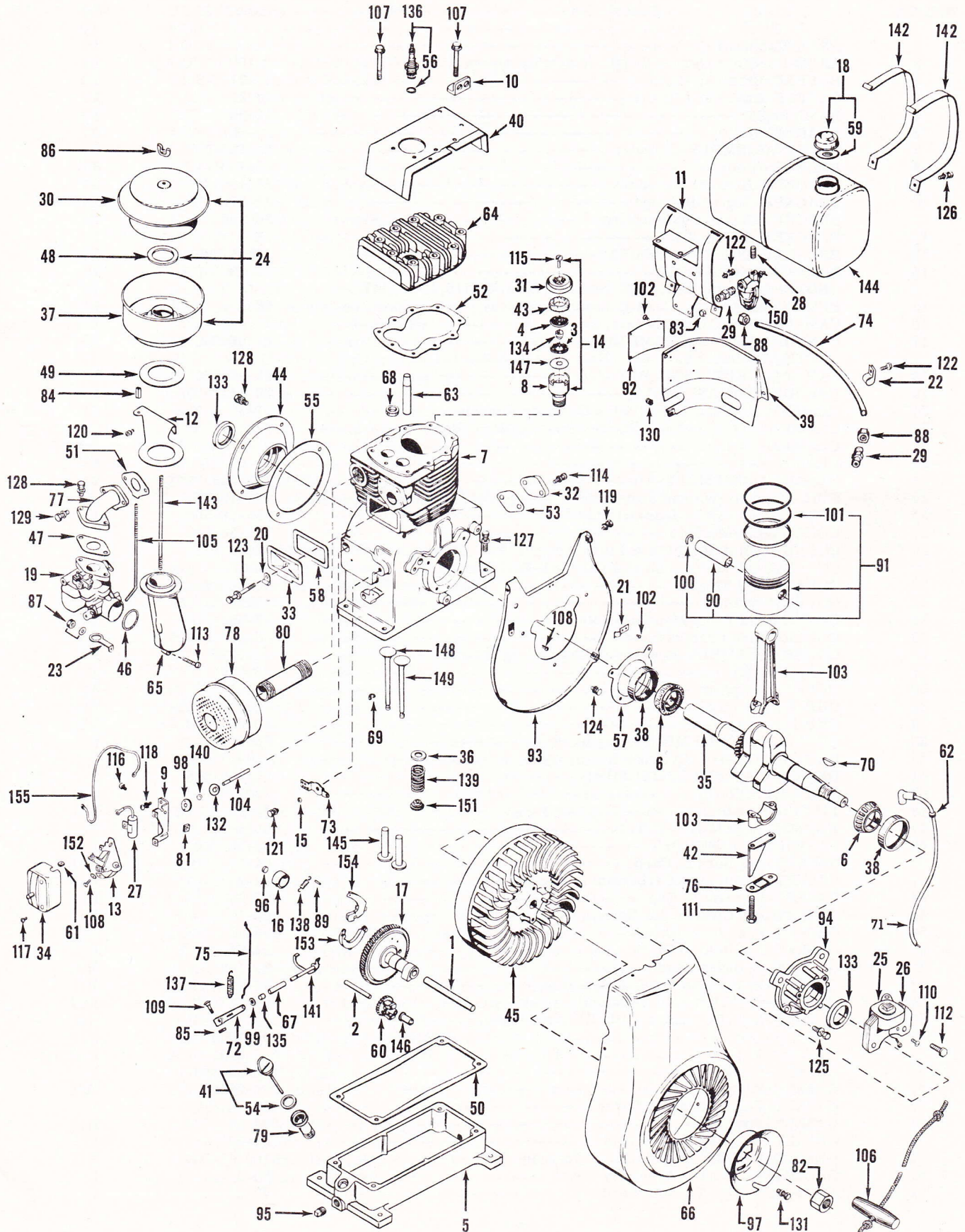

**CLINTON ENGINES CORPORATION**

MAQUOKETA, IOWA

Printed in U.S.A.



## 420-1301-005 BASIC PARTS LIST

Ref. No.	Description	Part No.	Qty.	
1	AXLE-Camshaft -----	6-4	1	
2	AXLE-Governor Gear & Weight Assembly -----	6-10	1	
3	BAFFLE-Breather (Lower) -----	17-21	1	
4	BAFFLE-Breather (Upper) -----	17-20	1	
5	BASE-Engine -----	18-39	1	
6	BEARING-Roller -----	20-66	2	
7	BLOCK ASSEMBLY-Cylinder-----	22-165-500	1	
8	BODY-Breather -----	29-4	1	
9	BRACKET-Breaker Assembly -----	26-13	1	
10	BRACKET-Engine Hoisting -----	26-27	1	
11	BRACKET-Fuel Tank Mounting -----	26-209	1	
12	BRACKET AIR HORN -----	26-6	1	
13	BREAKER POINTS ASSEMBLY-----	135-5-500	1	
14	BREATHER ASSEMBLY -----	29-23-500	1	
	NOTE: Assembly Incl. Ref. Nos. 3, 4, 8, 31, 43, 115, 134 & 147			
15	BUSHING-Governor, Control Lever-----	28-8	1	
16	CAM-Breaker (Camshaft Axle) -----	157-23	1	
17	CAMSHAFT & PIN ASSEMBLY -----	6-396-500	1	
	NOTE: Assembly Incl. Ref. Nos. 89, 138, 153 & 154			
18	CAP & GASKET ASSEMBLY-Fuel -----	45-95-500	1	
19	CARBURETOR ASSEMBLY-----	39-145-500	1	
20	CLAMP-Cable Assembly (Valve Chamber Cover)-----	81-3	1	
21	CLAMP-hi-Tension Lead (Blower Housing Back Plate)-----	81-11	1	
22	CLAMP-Fuel Line -----	81-157	1	
23	CLAMP -----	81-5	1	
24	CLEANER ASSEMBLY-Air -----	2-7-500	1	
25	COIL-Magneto (Without Laminations)-----	135-15-500	1	
26	COIL-Magneto (With Laminations)-----	135-16-500	1	
27	CONDENSER-Magneto -----	135-33-500	1	
28	CONNECTOR-1/8 (Valve & Filter Ass'y to Fuel Tank) -----	69-59	1	
29	CONNECTOR-(1-Fuel Line to Carb.)(1-Fuel Shut-Off)-----	69-289	2	
30	COVER & ELEMENT -----	45-36	1	
31	COVER-Breather -----	45-18	1	
32	COVER-Fuel Pump Mounting Hole-----	45-39	1	
33	COVER-Valve Chamber-----	45-83	1	
34	COVER ASSEMBLY-Breaker (With Shorting Button)-----	45-13-500	1	
35	CRANKSHAFT-----	46-379	1	
36	CUP-Valve Spring-----	232-1	2	
37	CUP-Air Cleaner -----	2-39	1	
38	CUP-Bearing-----	20-65	2	
39	DEFLECTOR ASSEMBLY-Air, Block -----	259-49	1	
40	DEFLECTOR-Air, Cylinder Head -----	259-67-500	1	
41	DIPSTICK ASSEMBLY-Oil Filler -----	45-109-500	1	
42	DISTRIBUTOR-Oil -----	220-141	1	
43	FILTER-Breather -----	29-24	1	
44	FLANGE ASSEMBLY-P. T. O. -----	1-20	1	
45	FLYWHEEL ASSEMBLY-----	83-36-500	1	
46	GASKET-Air Horn to Carb. -----	94-17	1	
47	GASKET-Manifold to Carburetor -----	94-33	1	
48	GASKET-Element to Cup -----	94-14	1	
49	GASKET-Air Cleaner Air Horn -----	94-12	1	
50	GASKET-Base to Block -----	94-53	1	
51	GASKET-Manifold to Block -----	94-71	1	
52	GASKET-Cylinder Head -----	94-199	1	
53	GASKET-Fuel Pump Cover Hole -----	94-6	1	
54	GASKET-Oil Filler Cap (Dipstick)-----	94-81	1	
55	GASKET-P. T. O. lange, .015 Thickness (Std.) -----	94-109	1	
		.010 -----	93-109	1
		.020 -----	-109	1
56	GASKET-Spark Plug -----	94-92-990	1	
57	GASKET-Stator Plate -----	94-98	1	
58	GASKET-Valve Chamber Cover -----	94-104	1	
59	GASKET-Fuel Cap -----	94-59	1	
	GASKET KIT-Engine Overhaul -----	94-598	1	
60	GEAR & WEIGHT ASSEMBLY-Governor -----	106-43-500	1	
61	GROMMET-Breaker Assembly Cover -----	70-8	1	
62	GROMMET-High Tension Lead -----	70-6	1	



Ref. No.	Description	Part No.	Qty.
63	GUIDE-Valve, Cylinder Block -----	291-21	2
64	HEAD-Cylinder -----	122-14	1
65	HORN-Air -----	69-53	1
66	HOUSING-Blower -----	259-126	1
67	HOUSING & BEARING ASSEMBLY-Governor Shaft -----	124-2-500	1
68	INSERT-Valve Seat Exhaust -----	136-24	1
69	KEEPER-Valve Spring -----	232-3	4
70	KEY-Woodruff, Flywheel -----	148-6	1
71	LEAD-Hi-Tension -----	307-203-500	1
72	LEVER-Governor -----	157-73	1
73	LEVER-Speed Control -----	157-86-500	1
74	LINE-Fuel 13 in. Long -----	158-398	1
75	LINK-Governor Throttle -----	159-34	1
76	LOCK-Double Connecting Rod Screw -----	148-11	1
77	MANIFOLD-----	169-7	1
78	MUFFLER-Exhaust -----	170-24	1
79	NECK ASSEMBLY-Oil Filler -----	277-7-500	1
80	NIPPLE-Muffler to Block -----	69-66	1
81	NUT-Breaker Points and Condenser to Bracket -----	183-54	1
82	NUT-Starter Pulley (7/8-14 SAE) -----	183-59	1
83	NUT-Hex. 1/4-28 (Tank Strap) -----	183-1	2
84	NUT-Speed Control Adjusting Rod -----	183-63	1
85	NUT-Square #10-24 (Governor Lever) -----	183-53	1
86	NUT-Air Cleaner -----	183-65	1
87	NUT & L'WASHER ASS'Y-Air Horn to Carb. -----	183-25-500	1
88	NUT-Ferrule Ass'y-Fuel Line -----	183-245	2
89	PIN-Camshaft Weight -----	203-202	2
90	PIN-Wrist -----	203-67	1
91	PISTON ASSEMBLY-Standard -----	204-10-500	1
	NOTE: Piston Assemblies are available in the following oversizes:		
	.010 -----	206-10-500	
	.020 -----	207-10-500	
	NOTE: Assembly Incl. Ref. Nos. 90, 100 & 101		
92	PLATE-Name (Air Deflector) -----	58-471	1
93	PLATE ASSEMBLY-Back, Blower Housing -----	215-97-500	1
94	PLATE ASSEMBLY-Magneto Stator -----	215-127	1
95	PLUG-3/8-18, Oil Drain -----	216-22	2
96	PLUG-Expansion, Camshaft -----	216-5	1
97	PULLEY-Starter -----	219-18	1
98	RETAINER-Breaker Seal -----	218-38	1
99	RING-Retaining (Governor Control Lever) -----	232-37	1
100	RING-Retainer, Wrist Pin -----	232-43	2
101	RING SET-Standard -----	233-117-500	1
	NOTE: Ring Sets are available in the following oversizes:		
	Refer to S. B. # 4 for Chrome Re-Ring Set Information.		
	.010 -----	235-124-500	
	.020 -----	237-124-500	
102	RIVET-Tubular (4-Name Plate, 3-Clamp, Back Plate)-----	244-21	7
103	ROD ASSEMBLY-Connecting -----	245-107-500	1
	Includes Ref. No. 111		
104	ROD-Breaker Push -----	245-17	1
105	ROD-Speed Control Adjusting -----	245-11	1
106	ROPE ASSEMBLY-Starter-----	246-13-500	1
107	SCREW-H. H. C. 5/16-18 x 2 3/8 (Head to Block) -----	258-89	9
108	SCREW-H. H. S. T. 6/32 x 3/8 (1-Condenser & Primary ----- Lead to Points, 1-Coil & Primary Leads to Terminal)	258-83	2
109	SCREW-Carriage #10-24 x 3/4 (Governor Lever) -----	258-65	1
110	SCREW-P. H. S. T. 1/4-20 x 1/4 (Coil Ground, Lamination) -----	258-77	1
111	SCREW-H. H. C. 5/16-18 x 1 3/4 (Connecting Rod Cap)-----	258-88	2
112	SCREW-H. H. S. T. 1/4-20 x 1 1/8 -----	258-75	2
113	SCREW-F. H. 10-32 x 1 1/4 (Air Horn to Carb.)-----	258-171	1
114	SCREW & L'WASHER ASS'Y-H. H. C. 1/4-20 x 3/8 ----- (Fuel Pump Hole Cover)	258-241-500	2
115	SCREW & L'WASHER ASS'Y-R. H. M. #8-32 x 3/4 ----- (Breather Cover)	258-293-500	1
116	SCREW & L'WASHER ASS'Y-R. H. M. #8-32 x 1/2 ----- (Breaker Points to Bracket)	258-273-500	1
117	SCREW & L'WASHER ASS'Y-R. H. M. #8-32 x 3/8 ----- (Breaker Cover to Bracket)	258-41-500	2



Ref. No.	Description	Part No.	Qty.
118	SCREW & L'WASHER ASS'Y-H.H.C. #8-32 x 1/2 ----- (Breaker Bracket to Block)	258-132-500	2
119	SCREW & L'WASHER ASS'Y-H.H.C. 1/4-20 x 1/2 ----- (Blower Housing to Back Plate)	258-280-500	5
120	SCREW & L'WASHER ASS'Y-H.H.C. #10-24 x 1/2 ----- (Throttle Rod Bracket to Block)	258-82-500	2
121	SCREW & L'WASHER ASS'Y-H.H.C. 1/4-20 x 1/2 ----- (Speed Control Lever)	258-287-500	1
122	SCREW & L'WASHER ASS'Y-H.H.C. 1/4-20 x 5/8 ----- (2-Tank Bracket to Block)(1-Fuel Line Clamp)	258-232-500	3
123	SCREW & L'WASHER ASS'Y-H.H.C. 1/4-20 x 2 3/8 ----- (Valve Chamber Cover)	258-62-500	1
124	SCREW & L'WASHER ASS'Y-H.H.C. 1/4-28 x 1/2 ----- (Back Plate to Block)	258-67-500	3
125	SCREW & L'WASHER ASS'Y-H.H.C. 1/4-28 x 5/8 ----- (Stator Plate to Block)	258-282-500	4
126	SCREW & L'WASHER ASS'Y-H.H.C. 1/4-28 x 1 1/4 ----- (Tank Strap to Bracket)	258-254-500	2
127	SCREW & L'WASHER ASS'Y-H.H.C. 3/8-16 x 1 1/4 ----- (Block to Base)	258-258-500	4
128	SCREW & L'WASHER ASS'Y-H.H.C. 5/16-18 x 3/4 ----- (4-P.T.O. Flange to Block)(2-Carburetor to Manifold)	258-277-500	6
129	SCREW & L'WASHER ASS'Y-H.H.C. 5/16-18 x 7/8 ----- (Manifold to Block)	258-281-500	2
130	SCREW & L'WASHER ASS'Y-R.H.M. #10-32 x 3/8 ----- (Deflector to Block)	258-198-500	2
131	SCREW & L'WASHER ASS'Y-H.H.C. 5/16-18 x 5/8 ----- (Pulley to Flywheel)	258-220-500	2
132	SEAL-Breaker Actuating Arm -----	94-155	1
133	SEAL-Oil (1-Stator Plate)-----	94-181-990	1
	SEAL-Oil (1-P.T.O. Flange)-----	94-184-990	1
134	SPACER-Breather -----	304-259	1
135	SPACER-Governor Control Lever -----	304-72	1
136	SPARK PLUG & GASKET ASSEMBLY-----	267-28-500	1
137	SPRING-Governor -----	263-40	1
138	SPRING-Ignition Shift Weight -----	263-77	2
139	SPRING-Valve -----	263-88	2
140	SPRING-Compression (Breaker Rod) -----	263-163	1
141	STOP & SHAFT ASSEMBLY-Governor -----	109-10-500	1
142	STRAP-Fuel Tank -----	26-210	2
143	STUD-Air Cleaner -----	24-15	1
144	TANK ASSEMBLY-Fuel -----	277-67-500	1
145	TAPPET-Valve -----	278-9	2
146	THIMBLE-Governor -----	109-9	1
147	VALVE-Breather -----	293-12	1
148	VALVE-Exhaust -----	291-10-990	1
149	VALVE-Intake -----	291-12-990	1
150	VALVE & FILTER ASSEMBLY-Fuel Shut-Off -----	293-32-500	1
151	WASHER-Valve Spring Retaining -----	304-168	2
152	WASHER-Condenser to Bracket -----	304-121	1
153	WEIGHT-Ignition Shift -----	305-20-500	1
154	WEIGHT-Ignition Shift -----	305-21-500	1
155	WIRE ASSEMBLY-Breaker Points -----	307-126-500	1

#### SPECIFICATIONS

BORE -----	3 1/8"	CARBURETION-----	Float	OIL CAPACITY-----	4 1/2 Pt.
STROKE-----	3 1/4"	FLOAT SETTING-----	1/4"	HORSEPOWER-----	9.6
CU. IN. DISP.-----	25.0	POINT SETTING-----	.028	BLOCK-----	Cast Iron
SPARK PLUG GAP---	.025			BEARINGS-----	Roller



# Clinton MODEL VARIATIONS

## 420-1301-000

SEC. II, DIVISION 1962  
ISSUED MARCH, 1964  
REVISED MAY, 1974

The adaptation of Clinton Engines to a wide variety of uses, results in what is known as Model Variations. Following is a list of Models produced to date. Opposite each Engine Model listed are the Part Numbers required in addition to or in place of standard parts. Refer to Basic Parts List for parts not listed in the Model Variations. For replacement engine to fit special applications, external part changes may be required.

UNITS MARKED WITH A ( ) INDICATES CRANKSHAFT CHANGE.

See Page C of this Manual on "How to Identify your Clinton Engine."

MODELS	CRANKSHAFT	NOTES	REPL. ENGINE #	SHORT BLOCK	MODELS	CRANKSHAFT	NOTES	REPL. ENGINE #	SHORT BLOCK
420-1321-002	46-793	1	Note 16	None	420-1361-033	46-791	1	21493	None
420-1341-003	46-791	1	Note 16		420-3301-034	46-379	2, 7	21494	
420-1361-004	46-791	1	21493		420-1361-035	46-791	1, 5	Note 16	
420-1301-005	46-379		21494		420-1301-036	46-379	11	Note 16	
420-1301-006	46-380		(21494)		420-1321-037	46-793	1	Note 16	
420-1301-007	46-381		(21494)		420-1301-038	46-379	15	21494	
420-1301-008	46-382		(21494)		420-1301-039	46-379	2, 5	Note 16	
420-1301-009	46-379		21494		420-1301-040	46-379	3, 4	21494	
420-1361-010	46-791	1	21493		420-1301-041	46-380		(21494)	
420-1301-011	46-379	2, 3, 4	21494		420-1301-043	46-382	9	(21494)	
420-1301-012	46-379		21494		420-1361-044	46-791	1	21493	
420-1301-013	46-379	5	Note 16		420-1361-045	46-791	1	21493	
420-1301-014	46-379	2, 5	Note 16		420-1301-046	46-379	12	Note 16	
420-1361-015	46-791	1, 2	21493		420-1321-047	46-793	1	Note 16	
420-1301-016	46-380		21494		420-1321-048	46-793	1, 5	Note 16	
420-5301-017	46-379	6	21514		420-3321-049	46-793	1, 2	Note 16	
420-1301-018	46-380	5	Note 16		420-1301-050	46-382	3, 4, 13, 14	Note 16	
420-1301-019	46-379		21494		420-1301-051	46-379	3, 4, 13, 14	Note 16	
420-1301-020	46-379		21494		420-1301-052	46-865	3, 4, 13, 14	Note 16	
420-1301-021	46-379	7, 8	21494		420-1301-053	46-379	7, 12	Note 16	
420-3301-022	46-381	2, 5, 9	Note 16		420-1301-054	46-379	5	Note 16	
420-5301-023	46-379	6, 7	21514		420-1301-055	46-380	5	Note 16	
420-1361-024	46-791	1	21493		420-1341-056	46-791	1, 15	Note 16	
420-1301-025	46-379	2, 5	Note 16		420-1361-057	46-791	1, 15	Note 16	
420-1301-026	46-379		21494		420-1301-058	46-380	17	(21494)	
420-1321-027	46-793	1, 2	Note 16		420-5301-059	46-381	5	(21494)	
420-1301-028	46-379	2	21494		420-5301-060	46-379	3, 6	21514	
420-5301-029	46-379	6	21514		420-1301-061	46-379		21494	
420-1301-030	46-841	9	(21494)		420-1301-062	46-379	5	Note 16	
420-1301-031	46-384	10	Note 16		420-1301-063	46-382	13	Note 16	
420-1301-032	46-380		(21494)		420-1301-064	46-379	12, 15	Note 16	
					420-1361-065	46-791	1, 12, 15	Note 16	

### 420-1301-000 SERIES NOTES

- Note 1 Refer to Section III, Division C, Page 3 for exploded view and parts usage for reduction units.
- Note 2 Use 157-18-500 Hand Crank.
- Note 3 Use 291-20-500 Roto Cap.
- Note 4 Use 22-517-500 Block, 291-11-990 Valve Stellite. Use standard Exhaust Valve in intake side.
- Note 5 Use 122-16 Head, (2) 69-290 Elbow 90°, 277-66-500 Tank, (2) 293-10 Valve, 69-59 Connector, 69-289 Connector, 158-397 Line Fuel, 158-403 Fuel Line, (2) 183-245 Nut Ferule, 81-157 Clamp, 258-232-500 Screw, 45-95-500 Cap Fuel, and 293-26 Drain.
- Note 6 Refer to Sec. III, Div. N, 12-Volt Starter Generator, Page 9.
- Note 7 Use 215-164-500 Plate Ass'y Back, 157-86-500 Lever Ass'y.
- Note 8 Use 257-24-500 Screen.
- Note 9 Refer to Sec. III, Div. Q, for Ignition Shielding.
- Note 10 Use 1-22 Flange, 148-5 Key Woodruff, 44-4-990 Rockford Clutch Ass'y, (4) 304-25 Washer, (4) 24-41 Screw.
- Note 11 Use 39-144-500 Carburetor Ass'y, 220-27 Pump, 69-59 Nipple, 69-19 Elbow, 293-32-500 Valve (Fuel Shut-Off), (2) 258-232-500 Screw & L'Washer, 69-290 Elbow, 158-402 Line Fuel. Refer to Sec. III, Div. O, Page 1 for exploded view and parts usage for fuel pump.
- Note 12 Same as Note 5 except use 122-14 Standard Head.
- Note 13 Use 1-25 Flange P. T. O.
- Note 14 Use 122-37 Head.
- Note 15 Use 183-37-500 Flywheel and 304-623 Spacer (Starter Pulley to Flywheel).
- Note 16 Order Replacement Engine by complete model number.