

Clinton BASIC PARTS LIST

422-1301-005

FILE SEC. II DIVISION 1962
422-1301-005
BASIC PARTS LIST
ISSUED APRIL 1964

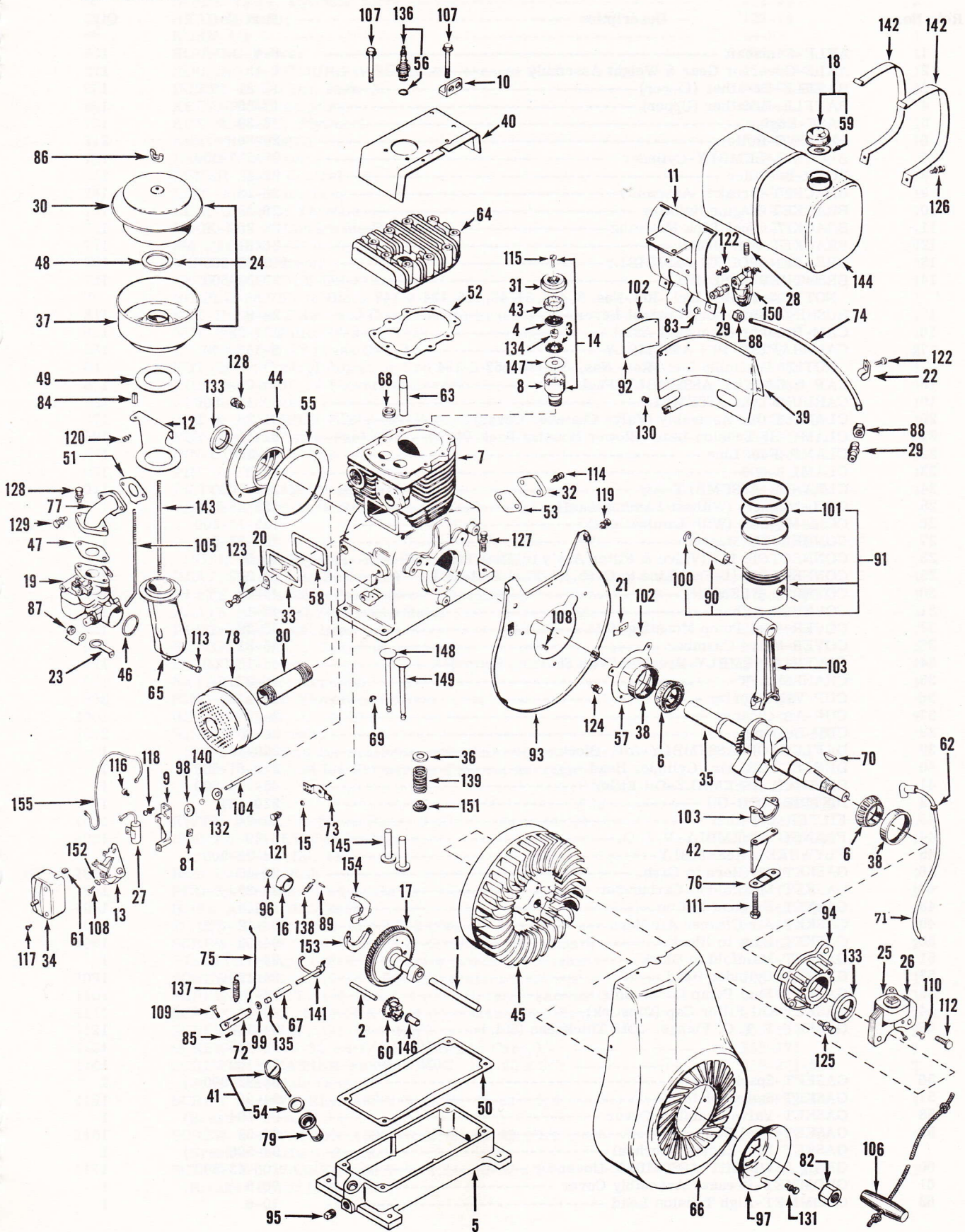

CLINTON ENGINES CORPORATION
MAQUOKETA, IOWA

422-1301-005 BASIC PARTS LIST

Ref. No.	Description	Part No.	Qty.
1	AXLE-Camshaft -----	6-4	1
2	AXLE-Governor Gear & Weight Assembly -----	6-10	1
3	BAFFLE-Breather (Lower) -----	17-21	1
4	BAFFLE-Breather (Upper) -----	17-20	1
5	BASE-Engine -----	18-39	1
6	BEARING-Roller -----	20-66	2
7	BLOCK ASSEMBLY-Cylinder -----	22-517-500	1
8	BODY-Breather -----	29-4	1
9	BRACKET-Breaker Assembly -----	26-13	1
10	BRACKET-Engine Hoisting -----	26-27	1
11	BRACKET-Fuel Tank Mounting -----	26-209	1
12	BRACKET AIR HORN -----	26-6	1
13	BREAKER POINTS ASSEMBLY-----	135-5-500	1
14	BREATHER ASSEMBLY-----	29-23-500	1
	NOTE: Assembly Incl. Ref. Nos. 3, 4, 8, 31, 43, 115, 134 & 147		
15	BUSHING-Governor, Control Lever -----	28-8	1
16	CAM-Breaker (Camshaft Axle) -----	157-23	1
17	CAMSHAFT & PIN ASSEMBLY-----	6-396-500	1
	NOTE: Assembly Incl. Ref. Nos. 89, 138, 153 & 154		
18	CAP & GASKET ASSEMBLY-Fuel -----	45-95-500	1
19	CARBURETOR ASSEMBLY-----	39-145-500	1
20	CLAMP-Cable Assembly (Valve Chamber Cover)-----	81-3	1
21	CLAMP-Hi-Tension Lead (Blower Housing Back Plate)-----	81-11	1
22	CLAMP-Fuel Line -----	81-157	1
23	CLAMP-----	81-5	1
24	CLEANER ASSEMBLY-Air -----	2-7-500	1
25	COIL-Magneto (Without Laminations)-----	135-15-500	1
26	COIL-Magneto (With Laminations) -----	135-16-500	1
27	CONDENSER-Magneto -----	135-33-500	1
28	CONNECTOR-1/8 (Valve & Filter Ass'y to Fuel Tank)-----	69-59	1
29	CONNECTOR-(1-Fuel Line to Carb.)(1-Fuel Shut-Off) -----	69-289	2
30	COVER & ELEMENT-----	45-36	1
31	COVER-Breather -----	45-18	1
32	COVER-Fuel Pump Mounting Hole -----	45-39	1
33	COVER-Valve Chamber -----	45-83	1
34	COVER ASSEMBLY-Breaker (With Shorting Button)-----	45-13-500	1
35	CRANKSHAFT-----	46-379	1
36	CUP-Valve Spring -----	232-1	2
37	CUP-Air Cleaner -----	2-39	1
38	CUP-Bearing -----	20-65	2
39	DEFLECTOR ASSEMBLY-Air, Block -----	259-49	1
40	DEFLECTOR-Air, Cylinder Head -----	259-67-500	1
41	DIPSTICK ASSEMBLY-Oil Filler -----	45-109-500	1
42	DISTRIBUTOR-Oil -----	220-141	1
43	FILTER-Breather -----	29-24	1
44	FLANGE ASSEMBLY-P. T. O. -----	1-20	1
45	FLYWHEEL ASSEMBLY-----	83-36-500	1
46	GASKET-Air Horn to Carb. -----	94-17	1
47	GASKET-Manifold to Carburetor -----	94-33	1
48	GASKET-Element to Cup -----	94-14	1
49	GASKET-Air Cleaner Air Horn -----	94-12	1
50	GASKET-Base to Block -----	94-53	1
51	GASKET-Manifold to Block -----	94-71	1
52	GASKET-Cylinder Head -----	94-199	1
53	GASKET-Fuel Pump Cover Hole -----	94-6	1
54	GASKET-Oil Filler Cap (Dipstick)-----	94-81	1
55	GASKET-P. T. O. Flange, .015 Thickness (Std.)-----	94-109	1
	.010 -----	93-109	1
	.020 -----	95-109	1
56	GASKET-Spark Plug-----	94-92-990	1
57	GASKET-Stator Plate -----	94-98	1
58	GASKET-Valve Chamber Cover -----	94-104	1
59	GASKET-Fuel Cap -----	94-59	1
	GASKET KIT-Engine Overhaul -----	94-598	1
60	GEAR & WEIGHT ASSEMBLY-Governor -----	106-43-500	1
61	GROMMET-Breaker Assembly Cover -----	70-8	1
62	GROMMET-High Tension Lead -----	70-6	1

Ref. No.	Description	Part No.	Qty.
63	GUIDE-Valve, Cylinder Block -----	291-21	2
64	HEAD-Cylinder -----	122-14	1
65	HORN-Air -----	69-53	1
66	HOUSING-Blower -----	259-126	1
67	HOUSING & BEARING ASSEMBLY-Governor Shaft -----	124-2-500	1
68	INSERT-Valve Seat Exhaust -----	136-90-990	1
69	KEEPER-Valve Spring -----	232-3	4
70	KEY-Woodruff, Flywheel -----	148-6	1
71	LEAD-Hi-Tension -----	307-203-500	1
72	LEVER-Governor -----	157-73	1
73	LEVER-Speed Control -----	157-86-500	1
74	LINE-Fuel 13 in. Long -----	158-398	1
75	LINK-Governor Throttle -----	159-34	1
76	LOCK-Double Connecting Rod Screw -----	148-11	1
77	MANIFOLD -----	169-7	1
78	MUFFLER-Exhaust -----	170-24	1
79	NECK ASSEMBLY-Oil Filler -----	277-7-500	1
80	NIPPLE-Muffler to Block -----	69-66	1
81	NUT-Breaker Points and Condenser to Bracket -----	183-54	1
82	NUT-Starter Pulley (7/8-14 SAE) -----	183-59	1
83	NUT-Hex. 1/4-28 (Tank Strap) -----	183-1	2
84	NUT-Speed Control Adjusting Rod -----	183-63	1
85	NUT-Square #10-24 (Governor Lever) -----	183-53	1
86	NUT-Air Cleaner -----	183-65	1
87	NUT & L'WASHER ASS'Y-Air Horn to Carb. -----	183-25-500	1
88	NUT-Ferrule Ass'y-Fuel Line -----	183-245	2
89	PIN-Camshaft Weight -----	203-202	2
90	PIN-Wrist -----	203-67	1
91	PISTON ASSEMBLY-Standard -----	204-11-500	1
	NOTE: Piston Assemblies are available in the following oversizes:		
		.010 -----	206-11-500
		.020 -----	207-11-500
	NOTE: Assembly Incl. Ref. Nos. 90, 100 & 101		
92	PLATE-Name (Air Deflector) -----	58-471	1
93	PLATE ASSEMBLY-Back, Blower Housing -----	215-97-500	1
94	PLATE ASSEMBLY-Magneto Stator -----	215-127	1
95	PLUG-3/8-18, Oil Drain -----	216-22	2
96	PLUG-Expansion, Camshaft -----	216-5	1
97	PULLEY-Starter -----	219-18	1
98	RETAINER-Breaker Seal -----	218-38	1
99	RING-Retaining (Governor Control Lever) -----	232-37	1
100	RING-Retainer, Wrist Pin -----	232-43	2
101	RING SET-Standard -----	233-117-500	1
	NOTE: Ring Sets are available in the following oversizes:		
	Refer to S. B. #4 for Chrome Re-Ring Set Information.		
		.010 -----	235-124-500
		.020 -----	237-124-500
102	RIVET-Tubular (4-Name Plate, 3-Clamp, Back Plate) -----	244-21	7
103	ROD ASSEMBLY-Connecting -----	245-107-500	1
	Includes Ref. No. 111		
104	ROD-Breaker Push -----	245-17	1
105	ROD-Speed Control Adjusting -----	245-11	1
106	ROPE ASSEMBLY-Starter -----	246-13-500	1
107	SCREW-H. H. C. 5/16-18 x 2 3/8 (Head to Block) -----	258-89	9
108	SCREW-H. H. S. T. 6/32 x 3/8 (1-Condenser & Primary ----- Lead to Points, 1-Coil & Primary Leads to Terminal)	258-83	2
109	SCREW-Carriage #10-24 x 3/4 (Governor Lever) -----	258-65	1
110	SCREW-P. H. S. T. 1/4-20 x 1/4 (Coil Ground, Lamination) -----	258-77	1
111	SCREW-H. H. C. 5/16-18 x 1 3/4 (Connecting Rod Cap) -----	258-88	2
112	SCREW-H. H. S. T. 1/4-20 x 1 1/8 -----	258-75	2
113	SCREW-F. H. 10-32 x 1 1/4 (Air Horn to Carb.) -----	258-171	1
114	SCREW & L'WASHER ASS'Y-H. H. C. 1/4-20 x 3/8 ----- (Fuel Pump Hole Cover)	258-241-500	2
115	SCREW & L'WASHER ASS'Y-R. H. M. #8-32 x 3/4 ----- (Breather Cover)	258-293-500	1
116	SCREW & L'WASHER ASS'Y-R. H. M. #8-32 x 1/2 ----- (Breaker Points to Bracket)	258-273-500	1
117	SCREW & L'WASHER ASS'Y-R. H. M. #8-32 x 3/8 ----- (Breaker Cover to Bracket)	258-41-500	2

Ref. No.	Description	Part No.	Qty.
118	SCREW & L'WASHER ASS'Y-H. H. C. #8-32 x 1/2 ----- (Breaker Bracket to Block)	258-132-500	2
119	SCREW & L'WASHER ASS'Y-H. H. C. 1/4-20 x 1/2 ----- (Blower Housing to Back Plate)	258-280-500	5
120	SCREW & L'WASHER ASS'Y-H. H. C. #10-24 x 1/2 ----- (Throttle Rod Bracket to Block)	258-82-500	2
121	SCREW & L'WASHER ASS'Y-H. H. C. 1/4-20 x 1/2 ----- (Speed Control Lever)	258-287-500	1
122	SCREW & L'WASHER ASS'Y-H. H. C. 1/4-20 x 5/8 ----- (2-Tank Bracket to Block)(1-Fuel Line Clamp)	258-232-500	3
123	SCREW & L'WASHER ASS'Y-H. H. C. 1/4-20 x 2 3/8 ----- (Valve Chamber Cover)	258-62-500	1
124	SCREW & L'WASHER ASS'Y-H. H. C. 1/4-28 x 1/2 ----- (Back Plate to Block)	258-67-500	3
125	SCREW & L'WASHER ASS'Y-H. H. C. 1/4-28 x 5/8 ----- (Stator Plate to Block)	258-282-500	4
126	SCREW & L'WASHER ASS'Y-H. H. C. 1/4-28 x 1 1/4 ----- (Tank Strap to Bracket)	258-254-500	2
127	SCREW & L'WASHER ASS'Y-H. H. C. 3/8-16 x 1 1/4 ----- (Block to Base)	258-258-500	4
128	SCREW & L'WASHER ASS'Y-H. H. C. 5/16-18 x 3/4 ----- (4-P. T. O. Flange to Block)(2-Carburetor to Manifold)	258-277-500	6
129	SCREW & L'WASHER ASS'Y-H. H. C. 5/16-18 x 7/8 ----- (Manifold to Block)	258-281-500	2
130	SCREW & L'WASHER ASS'Y-R. H. M. #10-32 x 3/8 ----- (Deflector to Block)	258-198-500	2
131	SCREW & L'WASHER ASS'Y-H. H. C. 5/16-18 x 5/8 ----- (Pulley to Flywheel)	258-220-500	2
132	SEAL-Breaker Actuating Arm -----	94-155	1
133	SEAL-Oil (1-Stator Plate) -----	94-181-990	1
	SEAL-Oil (1-P. T. O. Flange) -----	94-184-990	1
134	SPACER-Breather -----	304-259	1
135	SPACER-Governor Control Lever -----	304-72	1
136	SPARK PLUG & GASKET ASSEMBLY-----	267-28-500	1
137	SPRING-Governor -----	263-40	1
138	SPRING-Ignition Shift Weight -----	263-77	2
139	SPRING-Valve -----	263-88	2
140	SPRING-Compression (Breaker Rod) -----	263-163	1
141	STOP & SHAFT ASSEMBLY-Governor -----	109-10-500	1
142	STRAP-Fuel Tank -----	26-210	2
143	STUD-Air Cleaner -----	24-15	1
144	TANK ASSEMBLY-Fuel -----	277-67-500	1
145	TAPPET-Valve -----	278-9	2
146	THIMBLE-Governor -----	109-9	1
147	VALVE-Breather -----	293-12	1
148	VALVE-Exhaust -----	291-10-990	1
149	VALVE-Intake -----	291-12-990	1
150	VALVE & FILTER ASSEMBLY-Fuel Shut-Off -----	293-32-500	1
151	WASHER-Valve Spring Retaining -----	304-168	2
152	WASHER-Condenser to Bracket -----	304-121	1
153	WEIGHT-Ignition Shift -----	305-20-500	1
154	WEIGHT-Ignition Shift -----	305-21-500	1
155	WIRE ASSEMBLY-Breaker Points -----	307-126-500	1

SPECIFICATIONS

BORE----- 3 1/8"
 STROKE ----- 3 1/4"
 CU. IN. DISP. ----- 25.0
 SPARK PLUG GAP- .025

CARBURETION----- Float
 FLOAT SETTING----- 1/4"
 POINT SETTING----- .028

OIL CAPACITY---- 4 1/2 Pt.
 HORSEPOWER---- 10.3
 BLOCK----- Cast Iron
 BEARINGS----- Roller



MODEL VARIATIONS

422-1301-005

FILE SEC. II DIVISION 1962
422-1301-005
MODEL VARIATIONS
ISSUED APRIL 1964

The adaptation of Clinton Engines to a wide variety of uses, results in what is known as Model Variations. Following is a list of Models produced to date. Opposite each Engine Model listed are the Part Numbers required in addition to or in place of standard parts. Refer to Basic Parts List for parts not listed in the Model Variations.

See Page C of this Manual on "How to Identify your Clinton Engine."

MODELS	CRANKSHAFT Ref. to Sec. IV Div. B	NOTES	MISCELLANEOUS INFORMATION	MODELS	CRANKSHAFT Ref. to Sec. IV Div. B	NOTES	MISCELLANEOUS INFORMATION
422-1321-002	46-793	1	Use 200-812, 2:1 Speed Reducer.	422-1321-027	46-793	1, 2	Use 200-812, 2:1 Speed Reducer
422-1341-003	46-791	1	Use 200-814, 4:1 Speed Reducer.	422-1321-028	46-793	1	Use 200-812, 2:1 Speed Reducer
422-1361-004	46-791	1	Use 200-816, 6:1 Speed Reducer.				
422-1301-005			STANDARD ENGINE.				
422-1301-006	46-380						
422-1301-007	46-381						
422-1301-008	46-382						
422-1301-009		2					
422-1361-010	46-791	1, 2	Use 200, 6:1 Speed Reducer.				
422-1301-011		3, 4					
422-1301-012			STANDARD ENGINE.				
422-1301-013	46-837	5					
422-5301-014		6					
422-1301-013			STANDARD ENGINE.				
422-1301-016	46-837	2, 7, 8					
422-1301-018		2, 3					
422-1301-019			STANDARD ENGINE.				
422-1301-020	46-384	9					
422-1301-021	46-382	10					
422-5301-022	46-384	6, 9					
422-5361-023	46-791	1, 6	Use 200-816, 6:1 Speed Reducer.				
422-1301-024	46-384	9					
422-1301-025	46-38	2					
422-1301-026		3					

422 SERIES NOTES

- Note 1 Refer to Sec. III, Div. C for exploded view. Not sold as a complete ass'y, order individual parts.
- Note 2 Use 122-16 Head, 277-66-500 Tank, (2) 69-290 Elbow, (2) 293-10 Valve, 69-59 Connector, 69-289 Connector, 158-397 Line Fuel, 158-403 Line Fuel, (2) 183-245 Nut Ferrule, 81-157 Clamp, 158-232 Screw, 45-95-500 Cap Fuel, 293-2 Drain.
- Note 3 Use 157-18-500 Crank Ass'y.
- Note 4 Use 291-20-500 Roto Cap.
- Note 5 Use 158-57-500 Line Fuel, 293-32-500 Valve Fuel Shut-Off, and 69-59 Nipple.
- Note 6 Use 83-37-500 Flywheel Ass'y, 219-43 Sheave, (2) 258-226-500 Screw & L'Washer, 26-669-500 Bracket Ass'y, (2) 258-227-500 Screw & L'Washer Ass'y, 26-115 Bracket Starter Adj., (2) 258-281-500 Screw & L'Washer, 264-66-500 Motor Gen. Ass'y, (3) 258-259-500 Screw & L'Washer, (2) 183-24 Nut, 304-100 Washer, 231-7 Voltage Regulator, (2) 183-1-500 Nut & L'Washer Ass'y, (2) 258-4 Screw, 307-94-500 Wire Ass'y, 307-93-500 Wire Ass'y, (2) 21-3 Vee Belt.
- Note 7 Use 215-164-500 Plate Ass'y Back, 157-86-500 Lever Ass'y.
- Note 8 Use 39-578-990 Carburetor, 1-47 Flange, (2) 94-217 Gasket, (2) 258-755 Screw, 2-5-990 Air Cleaner, (2) 258-443 Screw, (2) 183-119 Nut Wing, 69-290 Elbow, and 159-34 Link.
- Note 9 Use 1-22 Flang, 148-5 Key Woodruff, 44-4-990 Rockford Clutch Ass'y, (4) 304-25 Washer, (4) 24-41 Screw.
- Note 10 Use 1-25 Flange PTO.