

Clinton BASIC PARTS LIST

431-0013-000

File Sec. II, Div. 1962
 431-0013-000
 Basic Parts List
 Issued August 1964

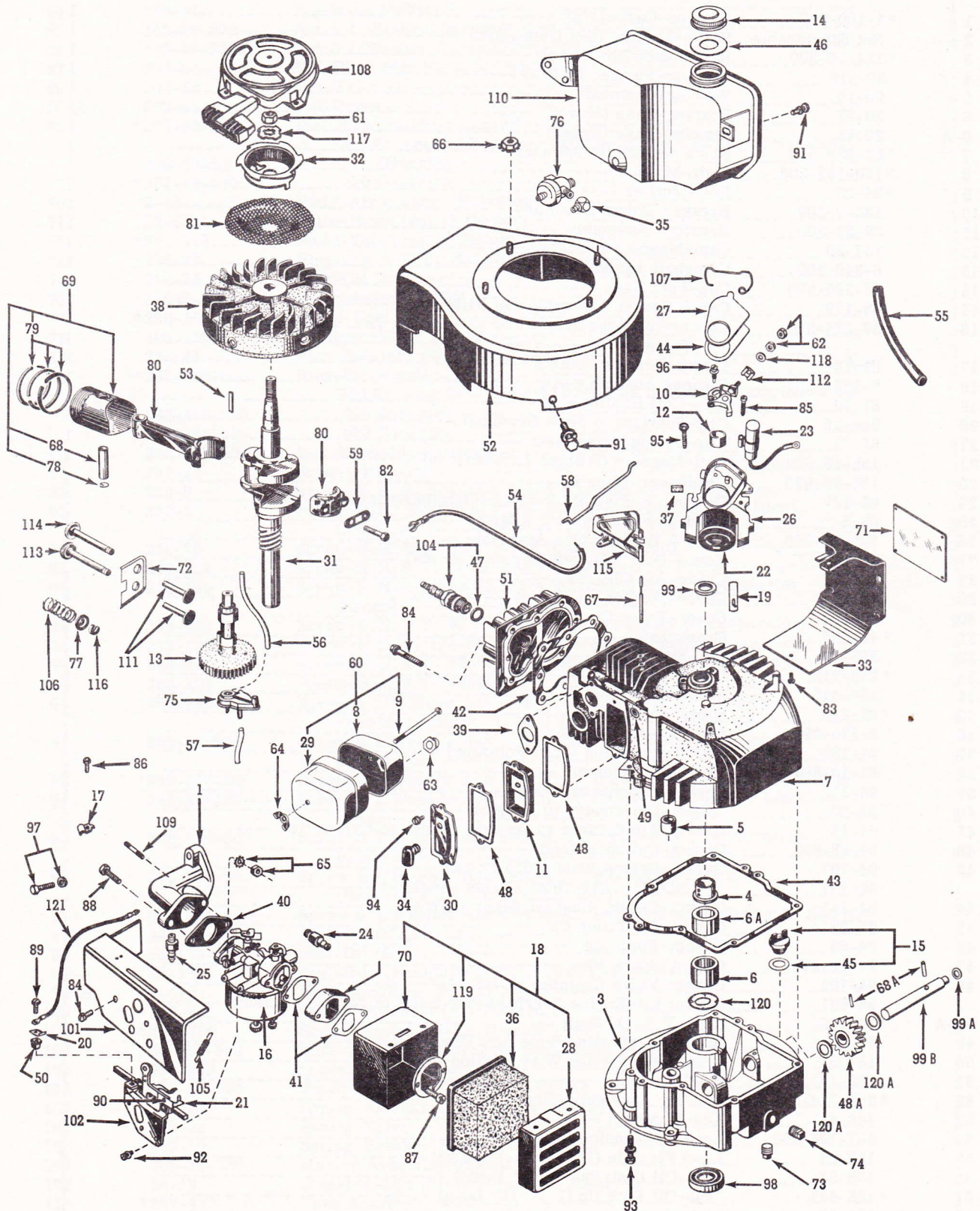

CLINTON ENGINES CORPORATION
 MAQUOKETA, IOWA

Printed in U.S.A.

431-0013-000 BASIC PARTS LIST

NOTE: See Page C on "How to Identify Your Clinton Engine." 431-0013-000 is an 8.50:1 Auxiliary P. T. O. Engine. See Model Variation Page for Parts Other Than Standard.

Ref. No.	Part No.	Description	Qty.
1	*1-100-500	Adaptor-Carburetor -----	1
2	Not Serviceable	Baffle-Muffler (Not Illustrated) -----	1
3	124-16-500	Base Assembly-Engine -----	1
4	20-219	Bearing-Flange, Main -----	1
5	20-10	Bearing-Camshaft -----	1
6	20-53	Bearing-Base (Lower) -----	1
6-A	20-45	Bearing-Base (Upper) -----	1
7	*22-824-500	Block Assembly-Cylinder -----	1
8	*170-153-500	Body-Muffler -----	1
9	*24-99	Bolt-Muffler -----	1
10	135-7-500	Breaker Points Assembly -----	1
11	29-32-500	Breather Assembly -----	1
12	157-29	Cam-Magneto Breaker -----	1
13	6-340-500	Camshaft Assembly -----	1
14	45-395-500	Cap-Fuel Tank -----	1
15	45-179	Cap & Gasket Assembly-Oil Filler -----	1
16	39-874-500	Carburetor Assembly-Refer to Sec. III, Div. A for Individual Parts -----	1
17	81-13	Clamp-Remote Control -----	1
18	2-198	Cleaner Assembly-Air, Complete -----	1
19	81-20	Clip-Coil Holding -----	1
20	266-26	Clip-Shorting to Slide Grommet -----	1
21	81-71	Clip-Spring Adjustment -----	1
22	135-13-990	Coil-Magneto (Without Laminations) -----	1
23	135-29-990	Condenser-Magneto -----	1
24	69-123	Connector-Flexible Fuel Line (Carburetor) -----	1
25	69-5	Connector-Carburetor Adaptor -----	1
26	135-37-500	Core & Breaker Box Assembly -----	1
27	45-15	Cover-Dust (Magneto Breaker Points) -----	1
28	45-337	Cover-Air Cleaner -----	1
29	*45-56	Cover-Muffler -----	1
30	45-304	Cover-Valve Chamber -----	1
31	*46-857	Crankshaft -----	1
32	265-10	Cup-Starter -----	1
33	*259-712	Deflector-Air -----	1
34	158-415	Elbow-Breather -----	1
35	*69-310	Elbow-Fuel Pump -----	1
36	2-175-990	Element-Air Cleaner -----	1
37	94-189	Felt-Lubrication (Cam Follower) -----	1
38	83-10-500	Flywheel Assembly -----	1
39	94-31	Gasket-Adaptor to Block -----	1
40	94-69	Gasket-Carburetor to Adaptor -----	1
41	94-13	Gasket-Air Cleaner to Spacer, Spacer to Carburetor -----	2
42	94-48-990	Gasket-Cylinder Head -----	1
43	94-107	Gasket-Engine Base (.015 Thick) -----	1
	93-107	NOTE: .010 Thick Gasket Available -----	1
44	94-241	Gasket-Cover, Dust (Breaker Points) -----	1
45	94-82	Gasket-Oil Filler Cap -----	1
46	94-62	Gasket-Fuel Cap -----	1
47	94-92-990	Gasket-Spark Plug -----	1
48	94-103	Gasket-Valve Chamber Cover -----	2
	94-591	Gasket Kit-Engine Overhaul (See Bulletin #48 for Content) -----	1
48-A	106-30	Gear-P. T. O. Shaft -----	1
49	70-10	Grommet-Shorting Wire thru Block -----	1
50	183-31	Grommet-Shorting Wire to Slide -----	1
51	122-17	Head-Cylinder -----	1
52	*259-714-500	Housing Assembly-Blower -----	1
53	148-4	Key-Flywheel -----	1
54	307-194-990	Lead-Hi-Tension (Magneto) -----	1
55	158-25	Line-Flexible (1-Fuel, 1-Impulse) -----	2
56	158-53	Line-Oil Distributor (Oil Pump) -----	1
57	*158-425	Line-Oil Pick Up (1-11/16" Long) -----	1
58	159-73	Link-Carburetor to Air Vane -----	1
59	148-13	Lock-Connectiong Rod Screw -----	1
	268-6-500	Magneto Assembly -----	1

Ref. No.	Part No.	Description	Qty.
60	*170-156-500	Muffler Assembly-Complete -----	1
61	183-68-990	Nut-Hex. 1/2-20 (Starter Cup) -----	1
62	183-21	Nut-Terminal Condenser Lead -----	2
63	183-45	Nut-Muffler -----	1
64	183-66	Nut-Wing Muffler -----	1
65	183-29-990	Nut & L'Washer-Carburetor to Adaptor -----	2
66	183-25-500	Nut & L'Washer Assembly-Recoil Starter -----	4
67	203-91	Pin-Pivot (Air Vane Governor) -----	1
68	203-65	Pin-Wrist -----	1
68-A	203-13	Pin-Drive -----	2
69	*204-86-500	Piston Assembly-Standard -----	1
		NOTE: Assemblies are available in the following oversizes:	
	*206-86-500	.010 Oversize -----	
	*207-86-500	.020 Oversize -----	
70	2-144	Plate-Air Cleaner Mounting -----	1
71	58-471	Plate-Name (Air Deflector) -----	1
72	*215-513	Plate-Valve Spring Retainer -----	1
73	216-22	Plug-3/8 N. P. T. (Oil Drain) -----	1
74	216-24	Plug-Oil Drain -----	1
75	220-5-500	Pump Assembly-Oil -----	1
76	*220-159	Pump-Fuel -----	1
77	304-135	Retainer-Valve Spring -----	2
78	232-41	Ring-Retainer (Wrist Pin) -----	2
79	*233-148-500	Ring-Set-Standard -----	1
		NOTE: Ring Sets are also available in the following oversizes:	
	*235-148-500	.010 Oversize -----	
	*237-148-500	.020 Oversize -----	
80	245-102-500	Rod Assembly-Connecting -----	1
81	257-30	Screen-Rotating -----	1
82	258-9	Screw-H. H. C. 1/4-28 x 1-1/4 (Connecting Rod Cap) -----	2
83	258-81	Screw-H. H. Slotted S. T. #8-32 x 3/8 (2-Deflector to Block, 1-Shroud) -----	3
84	258-88	Screw-H. W. H. 5/16 x 1-7/8 (Cylinder Head) -----	8
85	258-299	Screw-R. H. S. T. #8-32 x 4/5 (Condenser to Plate) -----	1
86	258-159	Screw-H. H. S. T. #8-32 x 1/4 (Shroud to Bracket) Clamp to Shroud) -----	3
87	258-902	Screw-H. H. S. T. #8-32 x 1-1/4 (Air Cleaner to Carburetor) -----	2
88	258-190	Screw-H. H. C. 1/4-28 x 1 (Carburetor to Adaptor) -----	1
89	258-83	Screw-H. H. S. T. #6-32 x 1/2 (Shorting Wire to Grommet) -----	1
90	258-374	Screw-H. H. S. T. #4-40 x 1/4 (Spring Adj. Clip to Slide) -----	1
91	258-280-500	Screw & L'Washer Ass'y-H. H. C. 1/4-20 X 1/2 (2-Blower Housing to Block, 1-Fuel Tank) -----	3
92	258-81-500	Screw & L'Washer Ass'y-H. H. C. #8-32 x 3/8 (Bracket to Carburetor) -----	2
93	*258-257-500	Screw & L'Washer Ass'y-H. H. C. 1/4-20 x 2-3/8 (Base to Blk.) --	7
94	258-82-500	Screw & L'Washer Ass'y-H. H. C. #10-24 x 1/2 (Valve Chamber Cover) -----	2
95	258-108-500	Screw & L'Washer Ass'y-P. H. S. T. #10-24 x 1 (Lamination to Block) -----	2
96	258-297-500	Screw & L'Washer Ass'y-R. H. M. Slotted #8-32 x 9/16 (Breaker Points to Breaker Box) -----	1
97	258-284-500	Screw & L'Washer Ass'y-H. H. C. 1/4-20 x 7/8 (Adaptor to Blk.) -	2
98	94-172-990	Seal-Oil (Engine Base) -----	1
99	94-178-990	Seal-Oil (Block) -----	1
99-A	94-179	Seal-Oil (Auxiliary P. T. O. Shaft) -----	1
99-B	6-470	Shaft-Auxiliary P. T. O.) -----	1
100	*259-713	Shield-Flywheel (Not Illustrated) -----	1
101	*259-715	Shroud Assembly-Carburetor -----	1
102	26-657-500	Slide Assembly-Governor Regulating -----	1
103	900-340	Spacer-Air Cleaner -----	1
104	267-28-500	Spark Plug & Gasket Ass'y-(H-10) -----	1
105	263-69	Spring-Extension (Speed Regulating) -----	1
106	263-92	Spring-Valve -----	2
107	263-10	Spring-Breaker Box Cover -----	1
108	265-28-500	Starter Assembly-Recoil -----	1
109	24-13	Stud-1/4-28 x 1 (Carburetor to Adaptor) -----	1
110	*277-477-500	Tank Assembly-Fuel -----	1
111	278-5	Tappet-Valve -----	2
112	307-230	Terminal-Jamtitite Breaker Points -----	1

Ref. No.	Part No.	Description	Qty.
113	291-8-990	Valve-Exhaust, Standard -----	1
	292-20-990	Valve-Exhaust (.010 Oversize) Service Part -----	1
114	291-48	Valve-Intake, Standard -----	1
	292-48	Valve-Intake (.010 Oversize) Service Part -----	1
115	107-34	Vane-Air Governor -----	1
116	304-90	Washer-"C" (Valve Keeper) -----	2
117	304-5	Washer-Starter Cup -----	1
118	304-290	Washer-Terminal Condenser Lead -----	1
119	304-562	Washer-Air Cleaner -----	1
120	304-163	Washer-Thrust, Crankshaft -----	1
120-A	304-164	Washer-Thrust -----	2
121	307-120-500	Wire Assembly-Shorting -----	1

* Indicates New Part Numbers Listed For The First Time.

SERVICE INFORMATION

Type of Carburetion -----	Float
Bore -----	2-1/2"
Stroke -----	1-7/8"
Cubic Inch Displacement -----	9.2
Spark Plug Gap -----	.025 to .028
Point Setting -----	.018 to .021
Oil Capacity -----	1-3/4 Pint
Bearing-Flywheel End -----	Flange Type (Bronze)
Bearing-Camshaft -----	Bronze
Bearing-P. T. O. End -----	Bronze
Valve Lash Setting -----	.009 to .011
Maximum Operating Speed -----	3600 R. P. M.
Block Construction -----	Shell Molded Cast Iron
Auxiliary P. T. O. -----	8.50:1