

Clinton BASIC PARTS LIST

435-0013-000

File Sec. II, Div. 1962
435-0013-000
Basic Parts List
Issued August 1964

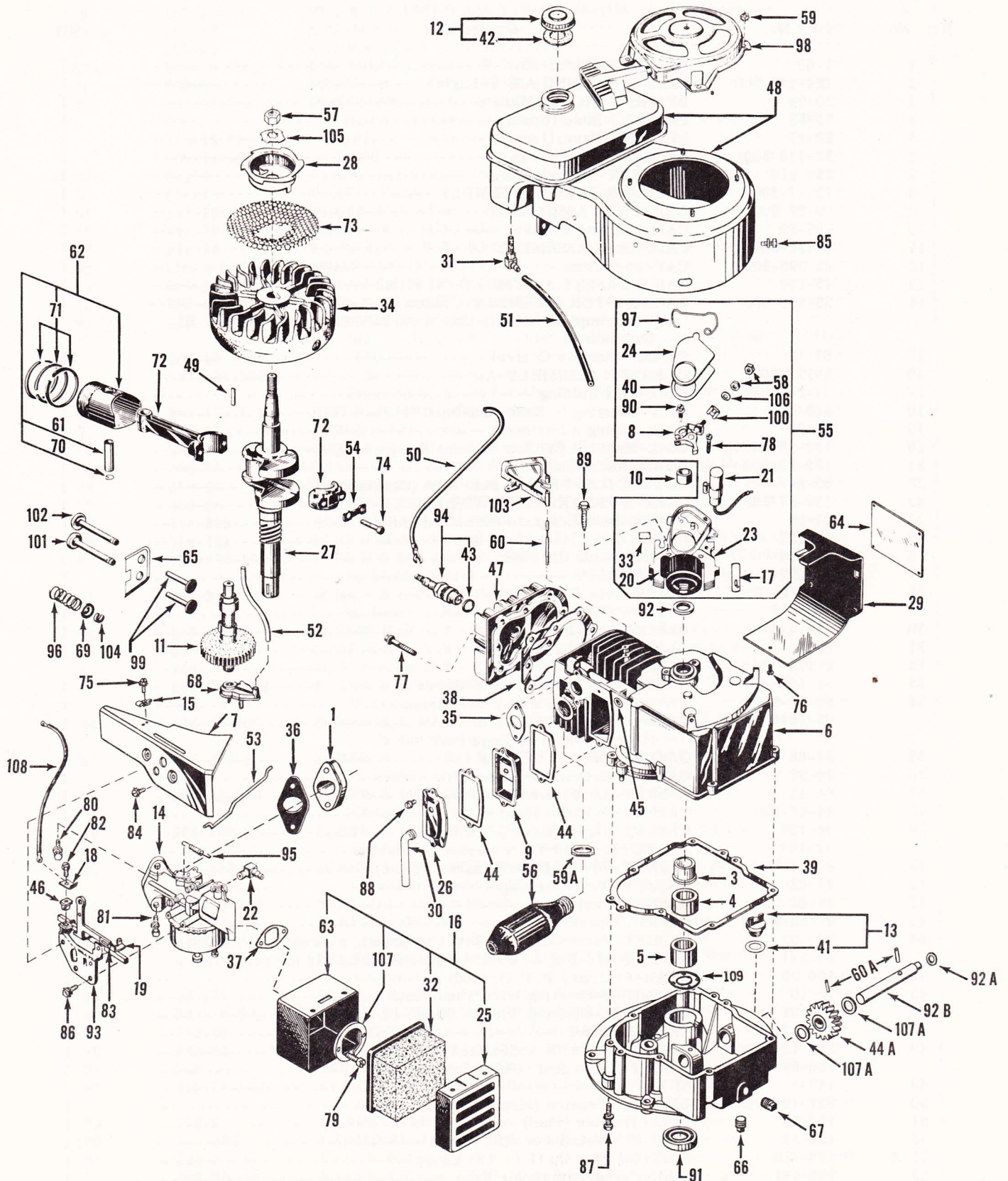

CLINTON ENGINES CORPORATION

MAQUOKETA, IOWA

Printed in U.S.A.

435-0013-000 BASIC PARTS LIST

See Page C on "How to Identify Your Clinton Engines." 435-0013-000 is a 8.50:1 Auxillary P. T. O. Engine. Complete Model Number Stamped on Cylinder Air Deflector. See Model Variation Page for Parts Other than Std.

Ref. No.	Part No.	Description	Qty.
1	1-65	ADAPTOR-Carburetor -----	1
2	124-172-500	BASE & BEARING ASS'Y-Engine -----	1
3	20-54	BEARING-Flange, Main -----	1
4	20-53	BEARING-Base (Upper) -----	1
5	20-45	BEARING-Base, (Lower) -----	1
6	22-718-500	BLOCK ASS'Y-Cylinder -----	1
7	259-246	BRACKET-Remote Control -----	1
8	135-7-500	BREAKER POINTS ASSEMBLY -----	1
9	29-32-500	BREATHER ASSEMBLY -----	1
10	157-29	CAM-Magneto Breaker -----	1
11	6-424-500	CAMSHAFT ASSEMBLY -----	1
12	45-395-500	CAP-Fuel Tank -----	1
13	45-179	CAP & GASKET ASSEMBLY-Oil Filler -----	1
14	39-190-990	CARBURETOR ASSEMBLY-Clinton -----	1
		For complete identification of carburetors, refer to Sec. III, Division A.	
15	81-13	CLAMP-Remote Control -----	1
16	2-177-500	CLEANER ASSEMBLY-Air -----	1
17	81-20	CLIP-Coil Holding -----	1
18	266-26	CLIP-Shorting to Slide Grommet -----	1
19	81-71	CLIP-Spring Adjustment -----	1
20	135-13-990	COIL-Magneto (Without Laminations) -----	1
21	135-29-990	CONDENSER-Magneto -----	1
22	69-24	CONNECTOR-Flexible Fuel Line (Carburetor) -----	1
23	135-37-500	CORE & BREAKER BOX ASSEMBLY -----	1
24	45-15	COVER-Dust (Magneto Breaker Points) -----	1
25	45-337	COVER-Air Cleaner -----	1
26	45-304	COVER-Valve Chamber -----	1
27	46-857	CRANKSHAFT -----	1
28	265-10	CUP-Starter -----	1
29	259-358	DEFLECTOR-Air -----	1
30	158-415	ELBOW-Breather -----	1
31	69-25	ELBOW-Tank to Fuel Line -----	1
32	2-175-990	ELEMENT-Air Cleaner -----	1
33	94-189	FELT-Lubrication (Cam Follower) -----	1
34	83-12-500	FLYWHEEL ASSEMBLY-Aluminum -----	1
	83-10-500	FLYWHEEL ASSEMBLY-Iron -----	1
		(Use Flywheel as Required)	
35	94-68	GASKET-Adaptor to Block -----	1
36	94-32	GASKET-Carburetor to Adaptor -----	1
37	94-13	GASKET-Air Cleaner to Carburetor -----	1
38	94-48-990	GASKET-Cylinder Head -----	1
39	94-107	GASKET-Engine Base (.015 Thick) -----	1
	93-107	NOTE: .010 Thick Gasket Available -----	1
40	94-241	GASKET-Cover, Dust (Breaker Points) -----	1
41	94-82	GASKET-Oil Filler Cap -----	1
42	94-62	GASKET-Fuel Cap -----	1
43	94-92-990	GASKET-Spark Plug -----	1
44	94-103	GASKET-Valve Chamber Cover to Breather-Breather to Block ---	2
	94-591	GASKET KIT-Engine Overhaul (See Bulletin #48 for content) -----	1
44-A	106-30	GEAR-Auxiliary P. T. O. Shaft -----	1
45	70-10	GROMMET-Shorting Wire Thru Block -----	1
46	183-31	GROMMET-Shorting Wire to Slide -----	1
47	122-17	HEAD-Cylinder -----	1
48	259-129-500	HOUSING & TANK ASSEMBLY-Fuel -----	1
	136-22	INSERT-Valve Seat .040 Oversize -----	1
49	148-4	KEY-Flywheel -----	1
50	307-194-990	LEAD-Hi-Tension (Magneto) -----	1
51	158-25	LINE-Flexible (Fuel) -----	1
52	158-53	LINE-Oil Distributor (Oil Pump) -----	1
52-A	158-425	LINE-Oil Pick Up (1 11/16" Long) -----	1
53	159-161	LINK-Carburetor to Air Vane -----	1
54	148-13	LOCK-Connecting Rod Screw -----	1
55	268-17-500	MAGNETO ASSEMBLY -----	1

Ref. No.	Part No.	Description	Qty.
56	170-136-500	MUFFLER -----	1
57	183-68-990	NUT-Hex. 1/2-20 (Starter Cup) -----	1
58	183-21	NUT-Terminal Condenser Lead -----	2
59	183-25-500	NUT & L'WASHER ASS'Y-Recoil Starter -----	4
59-A	183-37	NUT-Muffler to Block -----	1
60	203-91	PIN-Pivot (Air Vane Governor) -----	1
60-A	203-13	PIN ROLL-Auxiliary P. T. O. Shaft -----	2
61	203-65	PIN-Wrist -----	1
62	204-13-500	PISTON ASSEMBLY-Standard -----	1
		NOTE: Assemblies are available in the following oversizes:	
	206-13-500	.010 -----	
	207-13-500	.020 -----	
63	2-139	PLATE-Air Cleaner Mounting -----	1
64	58-471	PLATE-Name -----	1
65	215-136	PLATE-Valve Spring Retainer -----	1
66	216-22	PLUG-3/8 N. P. T. (Oil Drain) -----	1
67	216-24	PLUG-1/4 N. P. T. (Oil Drain) -----	1
68	220-5-500	PUMP ASSEMBLY-Oil -----	1
69	304-135	RETAINER-Valve Spring -----	2
70	232-41	RING-Retainer (Wrist Pin) -----	2
71	233-112-500	RING SET-Standard -----	1
		NOTE: Ring sets are also available in the following oversizes:	
	235-121-500	.010 -----	
	237-121-500	.020 -----	
		Refer to S. B. #4 for Chrome Re-Ring Set Information.	
72	245-102-500	ROD ASSEMBLY-Connecting -----	1
73	257-30	SCREEN-Revolving -----	1
74	258-9	SCREW-H. H. C. 1/4-28 x 1 1/4 (Connecting Rod Cap) -----	2
75	258-81	SCREW-H. H. Slotted S. T. #8-32 x 3/8 (Clamp to Shroud) -----	1
76	258-81	SCREW-H. H. Slotted S. T. #8-32 x 3/8 (Deflector to Block) -----	2
77	258-88	SCREW-H. W. H. 5/16 x 1 7/8 (Cylinder Head) -----	8
78	258-299	SCREW-R. H. S. T. #8-32 x 4/5 (Condenser to Plate) -----	1
79	258-131	SCREW-H. H. Slotted #8-32 x 7/16 (Air Cleaner Plate to Carb.) --	2
80	258-238-500	SCREW & L'WASHER ASS'Y- H. H. 1/4-20 x 1 1/2 (Carburetor to Block-Upper) -----	1
81	258-275-500	SCREW & L'WASHER ASS'Y-H. H. 1/4-20 x 1 3/4 (Carburetor to Block-Lower) -----	1
82	258-83	SCREW-H. H. S. T. #6-32 x 1/2 (Shorting Wire to Grommet) -----	1
83	258-374	SCREW-H. H. S. T. #4-40 x 1/4 (Spring Adj. Clip to Slide) -----	1
84	258-477	SCREW-H. H. S. T. #8-32 x 1/4 (Bracket to Slide Ass'y) -----	2
85	258-280-500	SCREW & L'WASHER ASS'Y-H. H. C. 1/4-20 x 1/2 (2-Blower Housing to Block) -----	2
86	258-81-500	SCREW & L'WASHER ASS'Y-H. H. C. #8-32 x 3/8 (Slide Ass'y to Carburetor) -----	2
87	258-257-500	SCREW & L'WASHER ASS'Y-H. H. C. 1/4-20 x 2 3/8 (Base to Block) -----	7
88	258-82-500	SCREW & L'WASHER ASS'Y-H. H. C. #10-24 x 1/2 (Valve Chamber Cover) -----	2
89	258-108-500	SCREW & L'WASHER ASS'Y-P. H. S. T. #10-24 x 1 (Lamination to Block) -----	2
90	258-297-500	SCREW & L'WASHER ASS'Y-R. H. M. Slotted #8-32 x 9/16 (Breaker Points to Breaker Box) -----	1
91	94-172-990	SEAL-Oil (Engine Base) -----	1
92	94-178-990	SEAL-Oil (Block) -----	1
92-A	94-179	SEAL-Auxiliary P. T. O. Shaft -----	1
92-B	6-470	SHAFT-Auxiliary P. T. O. 2 3/16" Long with #6 Woodruff Key Seat -----	1
93	26-657-500	SLIDE ASSEMBLY-Governor Regulating -----	1
94	267-28-500	SPARK PLUG & GASKET ASSEMBLY-H 10 -----	1
95	263-69	SPRING-Extension (Speed Regulating) -----	1
96	263-92	SPRING-Valve -----	2
97	263-10	SPRING-Breaker Box Cover -----	1
98	265-28-500	STARTER ASSEMBLY-Recoil (See Sec. III, Division H, Page 12 for Parts) -----	1
99	278-5	TAPPET-Valve -----	2
100	307-230	TERMINAL-Jamtite Breaker Points -----	1
101	291-8-990	VALVE-Exhaust -----	1
	292-20-990	VALVE-Exhaust (.010 Oversize) -----	1
102	291-9-990	VALVE-Intake -----	1
	292-7	VALVE-Intake (.010 Oversize) -----	1

Ref. No.	Part No.	Description	Qty.
103	107-34	VANE-Air Governor -----	1
104	304-90	WASHER-"C" (Valve Keeper) -----	2
105	304-5	WASHER-Starter Cup -----	1
106	304-290	WASHER-Terminal Condenser Lead -----	1
107	304-562	WASHER-Air Cleaner -----	1
107-A	304-164	WASHER-Thrust Auxiliary P. T. O. Shaft -----	2
108	307-120-500	WIRE ASSEMBLY- Shorting -----	1
109	304-163	WASHER-Thrust, Crankshaft -----	1

SERVICE INFORMATION

Bore -----	2-3/8"
Stroke -----	1-7/8"
Cubic Inch Displacement -----	8.3
Spark Plug Gap -----	.025 to .028
Point Setting -----	.018 to .021
Oil Capacity -----	1-3/4 Pint
Bearing-Flywheel End -----	Bronze
Bearing-P. T. O. End -----	Bronze
Valve Lash Setting -----	.009 to .011
Operating Speed -----	3600 R. P. M.
Block Construction -----	Aluminum with Cast Iron Cylinder Sleeve

1. Chrome "Re-Ring" set (refer to Service Bulletin No. 4).
2. Replacement Valve Insert 136-16.
3. Tools required for service of replacement Valve Insert: 951-61 Cutter (Remove Depth Pin to get 3/16 inch deep bore), 951-52 Driver, and 951-53 Rolling Tool.



MODEL VARIATIONS

435-0013-000

SEC. II, DIVISION 1962
435-0013-000
MODEL VARIATIONS
ISSUED MARCH, 1965

The adaptation of Clinton Engines to a wide variety of uses, results in what is known as Model Variations. Following is a list of Models produced to date. Opposite each Engine Model listed are the Part Numbers required in addition to or in place of standard parts. Refer to Basic Parts List for parts not listed in the Model Variations.

See Page C of this Manual on "How to Identify your Clinton Engine."

MODELS	CRANKSHAFT Ref. to Sec. IV Div. B	NOTES	MISCELLANEOUS INFORMATION	MODELS	CRANKSHAFT Ref. to Sec. IV Div. B	NOTES	MISCELLANEOUS INFORMATION
435-2013-004		1, 2, 3, 4, 5					
435-0013-005		1, 5, 6					
435-2013-006		1, 3, 4, 5, 7					
435-2013-007		3, 4, 5, 8					
435-1013-008		9					
435-2013-009		3, 10					

- Note 1 Use 6-472 Shaft Aux. P. T. O.
- Note 2 Use 1-53 Adaptor, 94-69 Gasket, 39-874-500 Carburetor, 258-190 Screw (Carb. to Adaptor), (2) 183-29-500 Nut (Carb. to Adaptor), 94-31 Gasket, (2) 258-284-500 Screw & L'Washer, 69-123 Connector, 159-73 Link Carburetor, (2) 94-458 Gasket, 900-340 Adaptor (Air Cleaner), 2-144 Body (Air Cleaner), (2) 258-902 Screw, 304-562 Washer, 263-69 Spring (Governor), 259-588-500 Housing, 259-381-500 Shroud Engine, (2) 258-160 Screw, 277-389-500 Tank, (2) 26-573 Bracket Tank, (2) 258-518 Screw, 259-375 Shroud Carb., and 45-357-500 Cap Fuel. Use 39-910 Carburetor Repair Kit or 39-928 Gasket Kit.
- Note 3 Use 265-250-500 Impulse Starter, 265-246-500 Cup, 1-97 Adaptor, 304-618 Spacer, 257-98 Screen, 183-254 Nut Barrel.
- Note 4 Use 26-668 Bracket Impulse Starter Release, 81-13 Clamp Cable, (3) 258-81-500 Screw & L'Washer.
- Note 5 Use 170-155-500 Muffler Body, 45-55 Cover Muffler, 258-975 Screw, 183-183 Nut (Muffler to Block), 183-45 Nut Wing.
- Note 6 Same as Note 2, except use 259-587-500 Housing Ass'y and 259-376-500 Shroud Engine.
- Note 7 Same as Note 2, except use 259-380-500 Housing, 277-388-500 Tank, (2) 26-351 Strap Tank, (2) 183-53 Nut
- Note 8 Same as Note 2, except use 39-956-500 Carburetor, 259-738-500 Shroud Engine, 31-2 Primer Bulb Kit. Use 39-910 Carburetor Repair Kit or 39-928 Gasket Kit.
- Note 9 Use 259-391-500 Tank & Housing Ass'y, 219-17 Pulley, 257-25 Screen, 246-13-500 Rope, 304-132 Washer Pulley, 183-68-990 Nut Pulley.
- Note 10 Use 259-361-500 Tank & Housing Ass'y.

CLINTON ENGINES CORPORATION

MAQUOKETA, IOWA

PRINTED IN U.S.A.