

# Clinton BASIC PARTS LIST

SEC. II DIV.

500 — 0100 — 000

500-0100-000

REVISED MAY, 1962

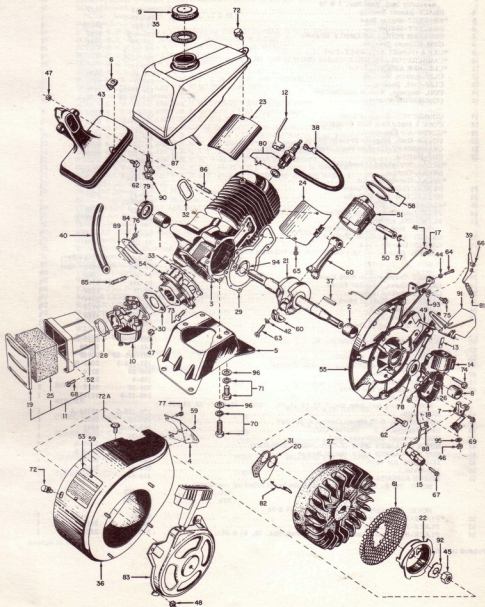

CLINTON ENGINES CORPORATION

MAQUOKETA, IOWA, U.S.A.

Printed in U.S.A.

Page 1

Item No.	Part Description	IBM No.	Part No.	Qty.
1	BEARING-Main (Block Assembly) (Used on Sleeve Bearing Units).....	20-41	2300	1
	BEARING-Ball (Block Assembly) (Used on Ball Bearing Units) Not Illus.....	20-4	3670	1
2	BEARING-Sleeve (Bearing Plate).....	20-40	2059	1
3	*BLOCK ASSEMBLY-Cylinder (Used on Ball Bearing Units).....	22-775		1
	*BLOCK ASSEMBLY-Cylinder (Used on Sleeve Bearing Units).....	22-774-5		1
	Assembly Incl. Item Nos. 1 & 79			
4	BRACE-Blower Housing.....	26-142	2127	1
5	*BRACKET-Engine Base.....	26-598-5		1
6	BRACKET-Muffler.....	26-561	92108	1
7	BREAKER POINTS ASSEMBLY-Magneto.....	135-4-5	5735	1
8	CAM-Magneto Breaker.....	157-29	5751	1
9	*CAP & GASKET ASSEMBLY-Fuel.....	45-395-5		1
10	*CARBURETOR ASSEMBLY-Clinton (Refer to Sec. III, Div. A, Page 29).....	39-783-5		1
11	*CLEANER ASSEMBLY-Air.....	149-540		1
12	CLIP-Ignition Shorting.....	266-28	3499	1
13	CLIP-Coil, Holding.....	81-20	5734	1
14	COIL-Magneto, Without Laminations.....	135-13-99	5770	1
15	CONDENSER-Magneto.....	135-29-99	5589-A	1
17	CONNECTOR-Governor Link.....	69-4	2226	1
18	CORE & BREAKER BOX ASSEMBLY.....	135-37-5	5732	1
19	*COVER-Air Cleaner.....	45-391		1
20	COVER-Dust, Magneto Breaker Points.....	45-15	5743	1
21	CRANKSHAFT-(Used on Basic Sleeve Bearing Unit).....	46-30	2252-1	1
22	CUP-Starting.....	265-10	90871	1
	*DECAL-Arrowhead (Aluminum).....	58-395		1
	DECAL-Caution.....	58-376	92104	1
	*DECAL-Horsepower Kit.....	149-548		1
23	DEFLECTOR-Air, Cylinder.....	25F-6	2037	1
24	DEFLECTOR-Air, Cylinder.....	25F-17	2305	1
25	*ELEMENT-Air Filter.....	2-160-99		1
26	FELT-Lubrication, Cam Follower.....	94-189	5742	1
27	FLYWHEEL ASSEMBLY.....	83-10-5	5752-A	1
	NOTE: Sold as an Assembly only.			
28	GASKET-Air Cleaner to Carburetor.....	94-13	31445	1
29	GASKET-Bearing Plate..... 30 Std.....	94-105	2039	1
	NOTE: Gaskets are also available in the following oversize:			
	.....025.....	93-105	2039 (.025)	
	.....035.....	95-105	2039 (.035)	
30	GASKET-Carburetor to Reed Plate.....	94-30	2096	1
31	GASKET-Cover, Breaker Points.....	94-241	5744	1
32	GASKET-Muffler to Block.....	94-73	2069	1
33	GASKET-Reed Plate to Block.....	94-87	2344	1
34	GASKET-Spark Plug.....	94-92-99	3115	1
35	GASKET-Fuel Cap.....	94-62	4519	1
	GASKET KIT-Engine Overhaul.....	149-590		1
36	HOUSING-Blower (Incl. Item No. 4).....	259-81-5	2345-A	1
37	KEY-Flywheel.....	148-4	10339	1
38	LEAD-High Tension, Magneto.....	307-195-99	90762	1
39	LEVER & SCREW ASSEMBLY-Throttle Control.....	157-126-5	2043-B	1
40	LINE-Fuel, Flexible.....	158-25	6316	1
41	LINK-Air Governor.....	159-4	2301	1
42	LOCK-Connecting Rod Screw.....	304-10	2027	2
	MAGNETO ASSEMBLY.....	268-17-5	91740	1
	NOTE: Ass'y Incl. Item Nos. 7, 13, 14, 15, 18, 26, 46, 67, 82, 88 & 85.			
43	MUFFLER.....	170-128-5	92154-A	1
44	NUT-Hexagon, 8-32 (Speed Control Adjusting).....	183-26	5522	1
45	NUT-Hexagon, 1/2 (Starter Cup).....	183-66-99	5942	1
46	NUT-Terminal Condenser Lead.....	183-21	5740	1
47	NUT & L WASHER ASSY-(2-Carburetor & 2-Muffler).....	183-39-5	3255-A	4
48	NUT & L WASHER ASSY-Recoil Starter.....	183-25-5	4107-A	4
49	PIN-Pivot, Air Vane.....	203-91	90682	1
50	PIN-Wrist.....	203-61	2428	1
51	PISTON ASSEMBLY-Standard.....	149-547		1
	NOTE: Piston Assemblies are available in the following oversizes:			
	.....010.....	149-552		
	.....020.....	149-553		
52	*PLATE-Air Cleaner Mounting.....	2-161		1
53	PLATE-Name.....	58-116	2311	1
54	PLATE-Reed Valve Plate Ass'y, Incl. Item Nos. 76, 84 & 89.....	215-115-5	2322-A	1

Item No.	Part Description	IBM No.	Part No.	Qty.
55	PLATE-Bearing.....	215-23-5	2313-A	1
	NOTE: Bearing Plate Incl. Item Nos. 2 & 78			
56	RETAINER-Bearing (Used on Ball Bearing Units) (Not Illus.).....	232-29	21328	2
57	RETAINER-Wrist Pin.....	232-60	3030	1
58	RING SET-Piston, Standard.....	149-108	2486	1
	NOTE: Ring Sets are available in the following overizes:			
	.....010.....	149-443	2486 (.010)	
	.....020.....	149-444	2486 (.020)	
59	RIVET-Tabular (2-Name Plate) (3-Brace to Blower Housing).....	244-21	5460	5
60	ROD ASSEMBLY-Connecting.....	245-60-5	2422-A	1
	NOTE: Assembly Incl. Item Nos. 42 & 63			
61	SCREW-Revolving.....	257-30	90872	1
62	SCREW-H. H. C. 1/4-20 x 3/4 (6-Bearing Plate to Block) (1-Brit. to Muffler).....	258-43	5446	7
63	SCREW-H. H. C. Slotted, 10-24 x 3/8" (Connecting Rod Cap).....	258-29	5429	2
64	SCREW-R. H. M. 8-32 x 7/8" (Speed Control Adjusting).....	258-199	3240	1
65	SCREW-H. H. C. 8-32 x 3/8" (Deflector).....	258-81	5644	3
66	SCREW-H. H. C. #8-32 x 1/4" (Throttle Lever Nut).....	258-107	5681	1
67	SCREW-R. H. S. T. #8-32 x 4/5" (Condenser to Plate).....	258-299	5741	1
68	SCREW & L'WASHER ASS'Y-H. H. C. 8-32 x 7/16" (Air Cleaner).....	258-131	5812	2
69	SCREW & L'WASHER ASS'Y-R. H. M. Slotted #8-32 x 3/4".....	258-297-5	5737	1
	(Breaker Point to Breaker Box)			
70	SCREW & L'WASHER ASS'Y-H. H. C. 5/16-18 x 3/4" (Engine Base).....	258-277-5	3233-G	3
71	SCREW & L'WASHER ASS'Y-H. H. C. 5/16-18 x 5/8" (Engine Base).....	258-220-5	3204-G	1
72	SCREW & L'WASHER ASS'Y-H. H. C. 1/4-20 x 1/2".....	258-280-5	3206-G	4
	(1-Tank Bracket to Engine Mounting Bracket) (3-Blower Housing to Plate)			
73A	SCREW & L'WASHER ASS'Y-P. S. H. 1/4-20 x 5/8" (Blower Hsg. to Brng. Plate)	258-205-5	5609-B	1
73	SCREW & L'WASHER ASS'Y-H. H. C. 1/4-20 x 7/8" (Reed Plate to Block).....	258-294-5	3294-G	4
74	SCREW & L'WASHER ASS'Y-P. H. S. T. 10-24 x 1" (Magnet to Bearing Plate).....	258-106-5	5682-A	2
75	SCREW & L'WASHER ASS'Y-R. H. M. 8-32 x 1/2" (Throttle Control).....	258-247-5	5442-D	1
76	SCREW & L'WASHER ASS'Y-R. H. S. T. #8-42 x 3/8" (Reed Ass'y to Reed Plt)	258-81-5	5644-A	2
77	SCREW & L'WASHER ASS'Y-R. H. S. T. #8-32 x 1/2" (Blower Housing to Blk.)	258-40-5	5443-A	3
78	SEAL-Oil (Bearing Plate).....	94-175	7254	1
79	SEAL-Oil (Block) Used on Sleeve Bearing Units.....	94-159	2303	1
80	SEAL-Oil (Block) Used on Ball Bearing Units.....	94-160	2337	1
81	SPARK PLUG & GASKET ASSEMBLY-Used on (J-12-J).....	267-18-5	90617-A	1
82	SPRING-Air Governor.....	263-5	2468	1
83	SPRING-Breaker Box Cover.....	263-10	5745	1
84	STARTER ASSEMBLY-Recoil (Refer to Sec. III, Div. H, Page 12).....	265-28-5	13516	1
85	STOP-Reed Valve.....	293-58	2036	1
86	STUD-Carburetor Mounting.....	24-18	90422	2
87	*STUD-Muffler to Block.....	24-81	2	2
88	TANK ASSEMBLY-Fuel.....	277-33-5	2306-E	1
89	TERMINAL-Jamitte Breaker Points.....	307-230	5738	1
90	VALVE-Reed.....	293-50	2035	1
91	VALVE-Fuel Shut-Off (Flexible Line).....	293-37	5051	1
92	VANE & LEVER ASSEMBLY-Air Governor.....	107-28	90983	1
93	WASHER-1/2 (Starter Cup).....	304-5	5879	1
94	WASHER-Spring Tension (Throttle Control).....	304-141	2077	1
95	WASHER-Thrust (Crankshaft).....	304-151	2464	1
96	WASHER-Terminal Condenser Lead.....	304-290	5739	1
	WASHER-Engine Base.....	304-526	709932	4

\* Indicates New Part Nos. Listed For The First Time.

Printed in U. S. A.

SPECIFICATIONS

SPECIFICATIONS

BORE.....	2-1/8"	POINT SETTING.....	.018 .021
STROKE.....	1-5/8"	HORSEPOWER RATING.....	2-1/2
CUBIC INCH DISPLACEMENT.....	5.76	BLOCK CONSTRUCTION.....	Aluminum
SPARK PLUG GAP.....	.028 .033	BEARING FLYWHEEL END.....	Bronze
CARBURETION.....	Floot	BEARING P. T. O. END.....	Bronze or Ball
FLOAT SETTING.....	5/32"		

Printed in U. S. A.



# MODEL VARIATIONS

## 500-0100-000

FILE SEC. II DIVISION 1962  
500-0100-000  
MODEL VARIATIONS  
REVISED APRIL, 1972  
SUPERSEDES OCTOBER, 1969

The adaptation of Clinton Engines to a wide variety of uses, results in what is known as Model Variations. Following is a list of Models produced to date. Opposite each Engine Model listed are the Part Numbers required in addition to or in place of standard parts. Refer to Basic Parts List for parts not listed in the Model Variations.

See Page C of this Manual on "How to Identify your Clinton Engine."

MODELS	CRANKSHAFT Ref. to Sec. IV Div. B	NOTES	MISCELLANEOUS INFORMATION	MODELS	CRANKSHAFT Ref. to Sec. IV Div. B	NOTES	MISCELLANEOUS INFORMATION
500-0100-001	46-29			500-0140-034	46-11	14	Use 22-774-500 Block, & 260-446 Reduction Unit.
500-0120-002	46-34	1	Use 22-774-500 Block, & 260-445 Reduction Unit.	500-0100-035	46-30	21, 22	Use 170-131-500 Muffler.
500-0140-003	46-11	1	Use 22-774-500 Block, & 260-446 Reduction Unit.	500-1300-036	46-27	2, 3	Use 22-775 Block.
500-0160-004	46-31	1	Use 22-774-500 Block, & 260-447 Reduction Unit.	500-0100-037	46-30		STANDARD ENGINE REFER TO BASIC PARTS LIST.
500-0300-005	46-32	2	Use 22-775 Block.	500-0300-038	46-32	2	Use 22-775 Block.
500-0300-006	46-27	2	Use 22-775 Block.	500-0100-039	46-30	14	
500-0300-007	46-26	2	Use 22-775 Block.	500-0300-040	46-32	2	Use 22-775 Block.
500-0300-008	46-28	2	Use 22-775 Block.	500-0100-041	46-30	24	
500-1300-009	46-32	2, 3	Use 22-775 Block.	500-0300-042	46-32	2, 9, 25	Use 22-775 Block.
500-1100-010	46-30	3		500-0100-043	46-30	5, 9, 25	
500-1300-011	46-32	2, 3	Use 22-775 Block.	500-0300-044	46-32	2, 9, 25, 26	Use 22-775 Block.
500-1160-012	46-31	1, 3	Use 22-774-500 Block, 259-136-500 Blower Housing, & 260-447 Reduction Unit.	500-0100-045	46-30	13	
500-0100-013	46-30	4, 5		500-0160-046	46-31	1, 27	Use 22-774-500 Block, & 260-447 Reduction Unit.
500-0300-014	46-32	2, 4, 5, 6, 7, 8, 9	Use 259-82-500 Blower Housing, & 22-775 Block.	500-0300-047	46-851	2, 6, 28, 29, 30	Use 22-819 Block.
500-0300-015	46-32	2, 4, 6, 7, 6, 10	Use 22-775 Block.	500-0100-048	46-858	6, 9, 21, 30, 31	Use 22-830-500 Block.
500-0100-016	46-30	4, 8, 14, 15, 16		500-0300-049	46-32	2, 13, 32	
500-0300-017	46-32	2, 5, 7, 8, 9, 11, 12	Use 22-775 Block.	500-0100-050	46-30	5, 6, 9, 33	
500-0300-018	46-27	2	Use 22-775 Block.	500-0300-051	46-671	2, 7, 34	
500-0100-019	46-30	5		500-0160-052	46-31	1	Use 22-774-500 Block, & 260-447 Reduction Unit.
500-9300-020	46-32	2, 9, 17	Use 22-775 Block, & 215-485-500 Plate Bearing.	500-7300-053	46-32	2, 35	
500-0100-021	46-30	4, 5, 6, 7, 8		500-0300-054	46-32	2, 4, 5, 6, 7, 8, 9	
500-2300-022	46-32	2, 12, 13, 14, 18, 19	Use 39-789-500 Carburetor & 22-775 Block.	500-0300-055	46-32	2, 7, 8, 9, 21, 25	
500-0120-023	46-34	1, 13	Use 22-774-500 Block, & 260-445 Reduction Unit.	500-0100-056	46-30	36, 39	
500-0160-024	46-31	1, 13	Use 22-774-500 Block, & 260-447 Reduction Unit.	500-0300-057	46-32	2, 13, 36, 37, 38, 39	
500-0100-025	46-30		STANDARD ENGINE REFER TO BASIC PARTS LIST.	500-0300-058	46-909	2	
500-0100-026	46-30	13		500-0300-059	46-32	2, 4, 21, 22	Use 170-131-500 Muffler.
500-0100-027	46-30	5, 9, 11, 20, 21		500-0100-060	46-30		STANDARD ENGINE REFER TO BASIC PARTS LIST.
500-0100-028	46-30	21, 22		500-0300-061	46-32	2, 6, 9, 32, 39	
500-0300-029	46-32	2, 5, 8, 16	Use 22-775 Block.	500-0100-062	46-30	4, 8	
500-0100-030	46-30	5, 6, 21, 23		500-0100-063	46-30	4, 8, 35	
500-0100-031	46-30	5, 8, 9, 11, 21	Use 215-485-500 Plate Bearing.	500-7300-064	46-32	2, 21, 22, 40, 41, 42	
500-0100-032	46-30	7		500-0160-065	46-31	1, 8	Use 22-774-500 Block, & 106-415-500 Reduction Unit.
500-0300-033	46-32	2, 13		500-0100-066	46-30		STANDARD ENGINE REFER TO BASIC PARTS LIST.
				500-0100-067	46-30	42	
				500-0100-068	46-924	13, 19	
				500-0100-069	46-924	9, 13, 21, 40, 41, 43	

## 500-0100-000 SERIES NOTES

- Note 1 Use 304-76 Spacer, and 94-163 Oil Seal.
- Note 2 Use 20-4 Ball Bearing, 232-29 Retainer, and 94-160 Oil Seal.
- Note 3 Use 259-138-500 Housing (Blower) 219-17 Pulley (Starting), 257-25 Screen, 304-132 Washer (Plain), and 246-13-500 Starter Rope.
- Note 4 Use 304-586 Washer (Plain) in lieu of 304-141 Wave Washer (Throttle Control to Bearing Plate).
- Note 5 Use 170-15 Muffler, and 258-263-500 Screw & L'Washer (2).
- Note 6 Use 83-12-500 Flywheel.
- Note 7 Use 307-120-500 Shorting Wire, 70-7 Grommet, 258-81 Screw, and 183-26 Nut.
- Note 8 Use 45-68-500 Cover (Spark Plug Shroting).
- Note 9 Use 245-110-500 Rod.
- Note 10 Clinton does not supply the Muffler for this unit.
- Note 11 Use 215-485-500 Plate Ass'y (Bearing), 83-66-500 Flywheel, 265-9 Cup, 257-30 Screen, 304-5 Washer (Flywheel), 259-82-500 Housing Ass'y (Blower), 265-29-500 Starter (Recoil), and 39-843-500 Carburetor. This engine is reverse rotation.
- Note 12 Use 265-106-500 Cup (Starter), 265-198-500 Impulse Starter, and 183-32 Nut (Flywheel).
- Note 13 Use 307-124-500 Wire Ass'y (Shorting), 286-4 Switch (Engine Stop), 26-28 Bracket (Switch) (Engine Stop), 25-29 Bracket (Switch), 258-265-500 Screw & L'Washer, and 183-26 Nut.
- Note 14 Use 2-138 Body (Air Cleaner), 45-338 Cover (Air Cleaner), and 2-141-990 Element.
- Note 15 Use 83-7-500 Flywheel.
- Note 16 Clinton does not supply Mounting Base for this unit.
- Note 17 This is a Short Block consisting of Cylinder Block, Piston, Rod, Bearing Plate, Crank, etc. For further information refer to Service Bulletin No. 5.
- Note 18 Use 45-344-500 Cap & Gauge Ass'y (Fuel).
- Note 19 Use 45-66 Cover (Spark Plug).
- Note 20 This engine is non-governed, refer to Service Bulletin No. 1 for Warranty Policy.
- Note 21 Use 277-33-500 Tank Ass'y (Fuel).
- Note 22 Use 39-210-990 Carburetor, 69-24 Elbow, 69-40 Horn (Air), 258-105 Screw, 94-11 Gasket, 2-9-500 Cleaner (Air), 304-134 Washer (Flat), 304-156 Washer (Rubber), 258-166 Screw, 304-28 Washer (Lock), 183-66 Nut (Wing).
- Note 23 Use 69-25 Elbow.
- Note 24 Use 277-465-500 Tank Ass'y Fuel, 45-401-500 Fuel Cap.
- Note 25 Use 215-22-500 Plate Ass'y Bearing, 83-18-500 Flywheel, 265-29-500 Starter Ass'y Recoil, 39-843-500 Carburetor, Clockwise Rotation Engine as viewed from PTO end.
- Note 26 Use 2-138 Body Air Cleaner, 45-338 Cover Air Cleaner, 2-141-990 Element Air Cleaner, 304-562 Washer Air Cleaner.
- Note 27 Use 215-140-500 Plate Ass'y Air Cleaner, 2-33 Element, 45-5 Cover, (2) 94-550 Gasket, (2) 258-102-500 Screw & L'Washer Ass'y, and 258-47-500 Screw.
- Note 28 Use 215-504-500 Plate Ass'y Bearing, 94-175-990 Seal Oil, 20-198-990 Bearing Roller, 245-118 Rod, 136-73 Linner Connecting Rod, and 20-197-500 Bearing Ass'y.
- Note 29 Use 157-422-500 Lever, 157-391 Lever, 26-603 Bracket, (2) 258-247-500 Screw, 263-371 Spring Governor, 39-943-500 Carburetor, (2) 94-86 Gasket Reed Plate.
- Note 30 Use 107-35-500 Vane Air, 159-163 Link, 263-376 Spring, (2) 94-602 Gaskets are supplied by Generac Corporation, Wales, Wisconsin.
- Note 31 Use 39-943-500 Carburetor Ass'y.
- Note 32 Use 307-186-500 Lead Ass'y, 267-27-500 Spark Plug Ass'y, 259-275-500 Shield (Spark Plug).
- Note 33 Use 39-751-500 Carburetor Ass'y.
- Note 34 Use 267-87-500 Spark Plug Outline.
- Note 35 Use 83-103-500 Flywheel Ass'y, 307-298 Sleeve (Insulating), 268-18-500 Magneto. Refer to Sec. III Div. N for Magneto Parts, however, Use 135-265-500 Condenser.
- Note 36 Use 39-825-500 Carburetor Ass'y, 304-831 Spacer, 159-187 Link.
- Note 37 Use (2) 233-142 Ring Chrome.
- Note 38 Use (2) 258-198-500 Screw & L'Washer (Air Cleaner to Carb.).
- Note 39 Use (2) 24-11 Stud.
- Note 40 Use 215-22-500 Bearing Plate Ass'y.
- Note 41 Use 170-128-500 Muffler Ass'y.
- Note 42 Same as Note 35 Except Use 83-121-500 Flywheel Ass'y Instead of 83-103-500.
- Note 43 Use 39-843-500 Carburetor.