

Clinton BASIC PARTS LIST

503-0308-000

SEC. 11, DIVISION 1962
ISSUED MARCH, 1975

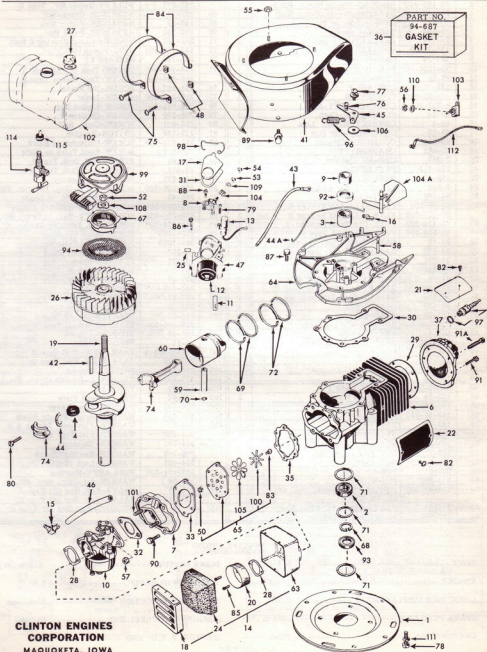

**CLINTON ENGINES
CORPORATION**
MAQUOKETA, IOWA

BASIC PARTS LIST

Ref. No.	Part No.	Description	Qty.	Ref. No.	Part No.	Description	Qty.
1	1-120	ADAPTOR-Engine Mig.	1	65	215-496-500	PLATE ASSY-Reed	1
2	20-4	BEARING-Ball-Block	1	67	265-10	PULLEY-Recoil Str. Type A	1
3	20-199-990	BEARING-Needle (Brng. Pit.)	1		265-277	PULLEY-Recoil Str. Type B	1
4	20-197-500	BEARING-Needle (Conn. Rod)	1	68	232-73	RETAINER-Crankshaft	1
5	20-225	BEARING-Wrist Pin	1	69	148-49	RETAINER-Piston Ring	2
6	22-856	BLOCK-Cylinder	1	70	232-164	RETAINER-Wrist Pin	2
7	26-796	BRACKET-Induction Ass'y	1	71	232-148	RING-Retaining Bearing & Seal	3
8	135-7-500	BREAKER POINTS ASS'Y	1	72	233-160-990	RING-Piston (Std.)	2
9	157-29	CAM-Breaker	1	74	245-120	ROD ASS'Y	1
10	39-1005-500	CARBURETOR ASS'Y	1	75	258-185-500	SCREW-Tank Straps Type A	2
11	81-20	CLIP-Core	1		258-244-500	SCREW-Tank Straps Type B	2
12	135-13-990	COIL ASS'Y	1	76	258-107	SCREW-Nut Swivel	1
13	135-29-990	CONDENSER	1	77	258-247-500	SCREW-Lever	1
14	2-212-500	CLEANER ASS'Y-Air	1	78	258-281-500	SCREW-Engine Mig.	4
15	69-24	CONNECTOR-Carb.	1	79	258-299	SCREW-Condenser	1
16	69-4	CONNECTOR-Gov. Link	1	80	258-901	SCREW-Conn. Rod	2
17	45-15	COVER-Breaker Box	1	81	215-134	SWITCH-Bracket	1
18	45-381	COVER-Air Cleaner	1	82	258-935-500	SCREW-Deflector to Block	4
19	46-921	CRANKSHAFT	1	83	258-516	SCREW-Reed Valve to Plate	1
20	2-233	CUP-Air Cleaner	1	84	26-168	STRAP-Fuel Tank Type A	2
21	259-411	DEFLLECTOR	1		26-351	STRAP-Fuel Tank Type B	2
22	259-17	DEFLLECTOR	1	85	259-974	SCREW-Air Cleaner	2
24	2-225	ELEMENT-Air Cleaner	1	86	258-108-500	SCREW & L'W-Mag. to Brng. Pit.	2
25	94-189	FELT-Cap. Wiper	1	87	258-43	SCREW-Brng. Pit. to Block	6
26	83-85-500	FLYWHEEL ASS'Y-Type A	1	88	258-297-500	SCREW & L'W-Breaker Points	1
	83-121-500	FLYWHEEL ASS'Y-Type B	1	89	258-280-500	SCREW ASS'Y-Hsa. to Brng. Pit.	4
27	45-424-500	FUEL-Cap Tank Type A	1	90	258-973-500	SCREW-Ind. Brckt. to Block	6
	45-504-500	FUEL-Cap Tank Type B	1	91	258-1055	SCREW-Head Cylinder	2
28	94-13	GASKET-Air Clnr. to Carb.	2	91A	258-1056	SCREW-Head Cylinder	4
29	94-670	GASKET-Cylinder Head	1	92	94-257	SEAL-Oil (Brng. Pit.)	1
30	94-671	GASKET-Bearing Plate	1	93	94-301	SEAL-Oil Block	1
31	94-241	GASKET-Breaker Box Cover	1	94	257-30	SCREEN-Type A	1
32	94-30	GASKET-Carb. to Ind. Brckt.	1		257-25	SCREEN-Type B	1
33	94-438	GASKET-Ind. Brckt. to Reed Pit.	1	96	263-408	SPRING-Gov.	1
35	94-360	GASKET-Reed Pit. to Block	1	97	267-87-500	SPARK PLUG	1
36	94-687	GASKET KIT	1	98	263-10	SPRING-Breaker Cover	1
37	122-40	HEAD-Cylinder	1	99	265-28-500	STARTER-Recoil Type A	1
41	259-888-500	HOUSING ASS'Y-Blower	1		265-280-500	STARTER-Recoil Type B	1
42	148-4	KEY-Flywheel	1	100	293-97	STOP-Reed Valve	1
43	307-301-500	LEAD-Magneto Hi Tension	1	101	34-11	STUD-Induction	2
44	136-77	LINER-Conn. Rod	2	102	277-3-500	TANK ASS'Y-Fuel Type A	1
44A	159-159	LINK-Gov.	1		277-526	TANK ASS'Y-Fuel Type B	1
45	157-126-900	LEVER-Gov. Control	1	103	266-53	SWITCH-Shorting	1
46	158-25	LINE-Fuel	1	104	307-230	TERMINAL-Jamtitie (Brkr. Pis.)	1
47	268-6-500	MAGNETO ASS'Y	1	104A	107-39	VANE-Air	1
48	183-53	NUT-Strap Screws	2	105	293-96	VALVE-Reed Plate	1
50	183-141	NUT-Reed Valve	1	106	304-141	WASHER-Wave Lever	2
52	183-68-990	NUT-Flywheel	1	107	304-134	WASHER-Brng. Pit. to Block	12
53	183-21	NUT-Terminal	1	108	304-5	WASHER-Flywheel Type A & B	1
54	183-26	NUT-Shorting Wire	1		304-132	WASHER-Flat Type B	1
55	183-25-500	NUT & L'W-Recoil Str. Mfg.	4	109	304-290	WASHER-Terminal	1
56	183-21	NUT-Shorting Switch	1	110	304-398	WASHER-Shorting Switch	1
57	183-29-500	NUT-Carb.	2	111	304-681	WASHER-Lock (Engine Mig.)	4
58	203-91	PIN-Air Vane	1	112	307-121-500	WIRE ASS'Y-Shorting	1
59	203-257	PIN-Wrist	1	113	304-28	WASHER-Air Clnr. Mfg. Pit.	2
60	204-95-500	PISTON ASS'Y-Incls. Nos. 59, 69, 70, 72	1	114	293-37	VALVE-Fuel Shut Off Type A	1
					293-211-500	VALVE-Fuel Shut Off Type B	1
63	2-144	PLATE ASS'Y-Air Clnr. Body	1	115	28-86	BUSHING-Fuel Shut Off Type B	1
64	215-561	PLATE ASS'Y-Bearing	1				

SPECIFICATIONS

BORE -----	2-3/8"	POINT SETTING -----	.018 to .021
STROKE -----	1-3/4"	HORSEPOWER RATING -----	7.0
CUBIC INCH DISPLACEMENT -----	7.75	BLOCK CONSTRUCTION -----	Aluminum
SPARK PLUG GAP -----	.028 to .033	BEARING FLYWHEEL END -----	Needle
CARBURETION -----	Float	BEARING P. T. O. END -----	Ball

RECOIL STARTER 265-280-500

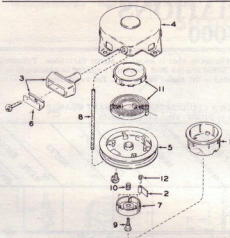

Ref. No.	Part Number	Description	Qty.
1	265-277	CUP- Starter	1
2	157-505	DOG- Starter	1
3	121-6-500	HANDLE- Starting	1
4	124-210-500	HOUSING ASS'Y	1
5	219-186-500	PULLEY ASS'Y	1
6	136-141	REINFORCEMENT	1
7	232-213	RETAINER- Dog	1
8	246-7	ROPE	1
9	258-1103	SCREW	1
10	263-456	SPRING- Brake	1
11	265-278-500	SPRING & CUP ASS'Y	1
12	263-459	SPRING- Dog	3

* Required Length Rope Can Be Cut From Bulk 150' Roll
Part No. 246-38

RECOIL STARTER 265-28-500

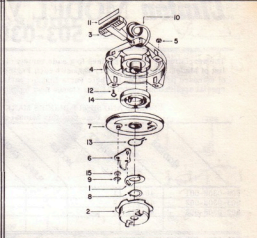

Ref. No.	Part Number	Description	Qty.
1	157-2	ACTUATOR	1
2	265-10	CUP- Starter	1
3	121-6	HANDLE	1
4	124-6-500	HOUSING-Incl. Recoil Spring	1
5	183-25-500	NUT & L'W ASS'Y	4
6	157-129-500	PAWL & PIN ASS'Y	1
7	219-28-500	PULLEY ASS'Y	1
8	232-147	RING-Retaining	1
9	232-35	RING-Retaining	1
10	246-7	ROPE	1
11	136-2	INSERT-Handle	1
12	258-191	SCREW- Pan Head	4
13	263-133	SPRING-Actuator	1
14	263-79	SPRING-Recoil	1
15	304-320	WASHER	1

CARBURETOR 39-1005-500

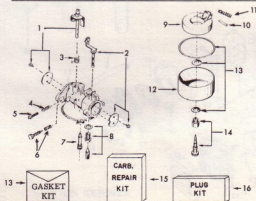

Ref. No.	Part No.	Description	Qty.
1	6-573-500	SHAFT & LEVER ASS'Y-Throttle	1
2	6-572-500	SHAFT & LEVER ASS'Y-Choke	1
3	263-357	SPRING-Throttle Shaft Return	1
4	263-62	SPRING-Adj. Screw -Carb.	1
5	258-60	SCREW-Throttle Stop	1
6	181-106-500	SCREW-Idle Adj. & Spring	1
7	182-37	NOZZLE-Main	1
8	293-30-500	INLET NEEDLE & SEAT ASS'Y	1
9	82-22-500	FLOAT & LEVER ASS'Y	1
10	6-195	PIN-Float Lever	1
11	263-416	SPRING-Float Valve	1
12	25-46	COVER-Float Bowl	1
13	* 39-928	GASKET KIT-Carb.	1
14	181-6-500	POWER ADJ. NEEDLE	1
15	* 39-979	CARBURETOR-Repair Kit	1
16	* 39-936	PLUG KIT	1

* Indicates Parts In Repair Kit

Clinton MODEL VARIATIONS •

503-0308-000

The adaptation of Clinton Engines to a wide variety of uses, results in what is known as Model Variations. Following is a list of Models produced to date. Opposite each Engine Model listed are the Part Numbers required in addition to or in place of standard parts. Refer to Basic Parts List for parts not listed in the Model Variations. For replacement engine to fit special applications, external part change may be required.

ENGINES AND SHORT BLOCKS MARKED WITH A () INDICATES CRANKSHAFT CHANGE
See Page C of this Manual on "How to Identify Your Clinton Engine."

MODELS	CRANKSHAFT	NOTES	REPL. ENGINE #	SHORT BLOCK	MODELS	CRANKSHAFT	NOTES	REPL. ENGINE #	SHORT BLOCK
503-0308-001	46-921	1							
503-0308-002	46-921	2							
503-0308-003	46-921	3							

503-0308-000 SERIES NOTES

- Note 1 Use 259-892-500 Shroud-Decorative, 45-470-500 Cover-Air Cleaner.
 Note 2 Use 259-898 Shroud-Decorative.
 Note 3 Use 259-904-500 Housing-Blower, 277-396-500 Tank Ass'y, 293-37 Valve-Fuel Shut-Off, 45-471-500 Cap-Fuel.

Clinton BASIC PARTS LIST

503-0309-000

SEC. II DIVISION 1962
 Revised Jan. 1978
 Supersedes June, 1975

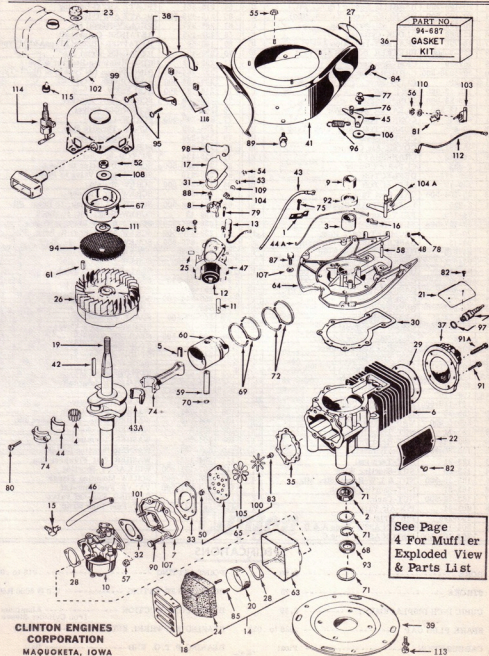

BASIC PARTS LIST

Ref. No.	Part No.	Description	Qty.	Ref. No.	Part No.	Description	Qty.
1	26-714	BRACKET-Gov. Link	1	61	203-21	PIN-Roll Flywheel	1
2	20-6	BEARING-Ball Block	1	63	2-144	PLATE ASS'Y-Air Clnr. Body	1
3	20-198-990	BEARING-Needle (Brng. Pit.)	1	64	215-561	PLATE ASS'Y-Bearing	1
4	20-197-500	BEARING-Needle (Conn. Rod)	1	65	215-496-500	PLATE ASS'Y-Reed	1
5	20-285	BEARING-Wrist Pin	1	67	265-277	PULLEY-Recoll Str.	1
6	22-886	BLOCK-Cylinder	1	68	232-195	RETAINER-Crankshaft	1
7	26-796	BRACKET-Induction Ass'y	1	69	148-57	RETAINER-Piston (2TypeA&B) (TypeC1)	1
8	135-7-500	BREAKER POINTS ASS'Y	1	70	232-40	RETAINER-Wrist Pin	2
9	157-29	CAM-Breaker	1	71	232-148	RING-Retaining Bearing & Seal	3
10	39-1038-500	CARBURETOR ASS'Y	1	72	233-164-990	RING-Piston (3-Type A & B) (1-Type C)	1
11	81-20	CLIP-Core	1		232-166-990	RING-Piston (Type C)	1
12	135-13-990	COIL ASS'Y	1	74	245-133-500	ROD ASS'Y	1
13	135-29-990	CONDENSER	1	75	258-159	SCREW-Gov. Bracket	1
14	2-212-500	CLEANER ASS'Y-Air	1	76	258-107	SCREW-Nut Swivel	1
15	69-24	CONNECTOR-Carb.	1	77	258-247-500	SCREW-Lever	1
16	69-4	CONNECTOR-Gov. Link (Type A)	1	78	258-199	SCREW-Throttle Stop	1
17	45-15	COVER-Breaker Box	1	79	258-299	SCREW-Condenser	1
18	45-381	COVER-Air Cleaner	1	80	258-901	SCREW-Conn. Rod	2
19	46-943	CRANKSHAFT	1	81	215-134	SWITCH-Bracket	1
20	2-223	CUP-Air Cleaner	1	82	258-936-500	SCREW-Deflector to Block	4
21	259-411	DEFLECTOR	1	83	258-516	SCREW-Reed Valve to Plate	1
22	259-17	DEFLECTOR	1	84	258-247-500	SCREW-Housing	2
23	45-504-500	CAP-Fuel Tank	1	85	258-974	SCREW-Air Cleaner	2
24	2-225	ELEMENT-Air Cleaner	1	86	258-108-500	SCREW & L'W-Mag. to Brng. Pit.	2
25	94-189	FELT-Cam Wiper	1	87	258-43	SCREW-Brng. Pit. to Block	6
26	83-127-500	FLYWHEEL ASS'Y	1	88	258-297-500	SCREW & L'W-Breaker Points	1
27	70-28	GROMMET-Spark Plug	1	89	258-280-500	SCREW ASS'Y-Hsg. to Brng. Pit.	4
28	94-13	GASKET-Air Clnr. to Carb.	2	90	258-873-500	SCREW-Ind. Brkt. to Block	6
29	94-870	GASKET-Cylinder Head	1	91	258-1055	SCREW-Head Cylinder	2
30	94-871	GASKET-Bearing Plate	1	91A	258-1056	SCREW-Head Cylinder	4
31	94-241	GASKET-Breaker Box Cover	1	92	94-257	SEAL-Oil (Brng. Pit.)	1
32	94-30	GASKET-Carb. to Ind. Brkt.	1	93	94-773-990	SEAL-Oil Block	1
33	94-438	GASKET-Ind. Brkt. to Reed Pit.	1	94	237-30	SCREEN	1
35	94-360	GASKET-Reed Pit. to Block	1	95	258-244-500	SCREW-Tank Strap	2
36	94-687	GASKET KIT	1	96	263-5	SPRING-Gov.	1
37	122-44	HEAD-Cylinder	1	97	287-87-500	SPARK PLUG-CJ8	1
38	26-351-500	STRAP-Fuel Tank	2	98	263-10	SPRING-Breaker Cover	1
39	1-120	FLANGE-Engine Adaptor	1	99	265-280-500	STARTER-Recoll	1
41	259-888-500	HOUSING ASS'Y-Blower	1	100	293-97	STOP-Reed Valve	1
42	148-4	KEY-Flywheel	1	101	24-18	STUD-Induction	2
43	307-301-500	LEAD-Magneto Hi Tension	1	102	277-526	TANK-Fuel	1
43A	136-147	LINER-Rod Shank	1	103	266-53	SWITCH-Shorting	1
44	136-77	LINER-Rod Cap	1	104	307-230	TERMINAL-Jamite (Brkr. Pts.)	1
44A	159-216	LINK-Gov.	1	104A	107-39	VANE-Air	1
45	157-126-500	LEVER-Gov. Control	1	105	293-96	VALVE-Reed Plate	1
46	158-25	LINE-Fuel	1	106	304-141	WASHER-Wave Lever	1
47	268-6-500	MAGNETO ASS'Y	1	107	304-134	WASHER-Brng. Pit. to Reed Pit.	12
48	183-21	NUT-Throttle Stop Screw	1	108	304-5	WASHER-Flywheel	1
50	183-141	NUT-Reed Valve	1	109	304-290	WASHER-Terminal	1
52	183-68-990	NUT-Flywheel	1	110	304-368	WASHER-Shorting Switch	1
53	183-21	NUT-Terminal	1	111	304-132	WASHER-Flat Flywheel Cup	1
54	183-26	NUT-Shorting Wire	1	112	307-121-500	WIRE ASS'Y-Shorting	1
55	183-25-500	NUT & L'W-Recoll Str. Mtg.	4	113	258-281-500	SCREW-Mounting Flange	4
56	183-21	NUT-Shorting Switch	1	114	293-211-500	VALVE-Fuel Shut-Off	1
57	183-29-500	NUT-Carb.	2	115	28-86	BUSHING-Shut-Off Valve	1
58	203-91	PIN-Air Vane	1	116	183-53	NUT-Fuel Tank Strap	2
59	203-298	PIN-Wrist	1				
60	204-100-500	PISTON ASS'Y-Type A & B	1				
	204-103-500	PISTON ASS'Y-Type C	1				

SPECIFICATIONS

BORE	2.50	POINT SETTING018 to .021
STROKE	1.75	HORSEPOWER RATING	7.0 @ 6000 RPM
CUBIC INCH DISPLACEMENT	8.59	BLOCK CONSTRUCTION	Aluminum Iron Cylinder Sleeve
SPARK PLUG GAP028 to .033	BEARING FLYWHEEL END	Needle
CARBURETION	Floot	BEARING P. T. O. END	Ball

RECOIL STARTER 265-280-500

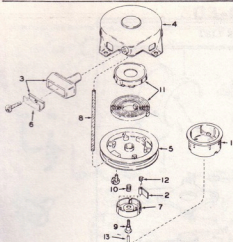

CARBURETOR 39-1038-500

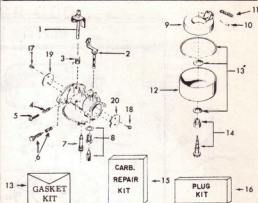

Ref. No.	Part No.	Description	Qty.	Ref. No.	Part No.	Description	Qty.
1	265-277	CUP-Starter	1	1	6-559-500	SHAFT & LEVER ASS'Y-Throttle	1
2	157-505	DOG-Starter	1	2	6-558-500	SHAFT & LEVER ASS'Y-Choke	1
3	121-6-500	HANDLE-Starting	1	3	263-465	SPRING-Throttle Shaft Return	1
4	124-210-500	HOUSING ASS'Y	1	4	263-82	SPRING-Adj. Screw-Carb.	1
5	219-186-500	PULLEY ASS'Y	1	5	258-60	SCREW-Throttle Stop	1
6	136-141	REINFORCEMENT	1	6	181-106-500	SCREW-Idle Adj. & Spring	1
7	232-213	RETAINER-Dog	1	7	182-37	NOZZLE-Main	1
*8	246-7	ROPE	1	8	293-30-500	INLET NEEDLE & SEAT ASS'Y	1
9	258-1103	SCREW	1	9	82-22-500	FLOAT & LEVER ASS'Y	1
10	263-456	SPRING-Brake	1	10	6-195	PIN-Float Lever	1
11	265-278-500	SPRING & CUP ASS'Y	1	11	263-416	SPRING-Float Valve	1
12	263-459	SPRING-Dog	3	12	25-46	COVER-Float Bowl	1
13	203-297	PIN-Alignment	1	13 *	39-928	GASKET KIT-Carb.	1
* Required Length Rope Can Be Cut From Bulk 150' Roll				14	181-5-500	POWER ADJ. NEEDLE	1
Part No. 246-38				15 *	39-979	CARBURETOR-Repair Kit	1
				16 *	39-938	PLUG KIT	1
				17	258-931-500	SCREW-Throttle Valve	2
				18	258-61-500	SCREW-Choke Valve	2
				19	293-191	VALVE-Throttle	1
				20	293-205	VALVE-Choke	1
* Indicates Parts In Repair Kit							



MUFFLER PARTS LIST

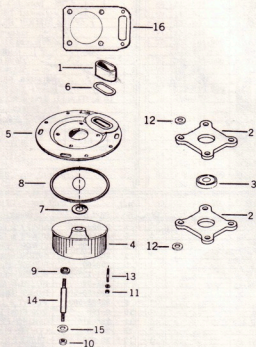

Ref. No.	Part No.	Description	Qty.
1	900-580	ADAPTOR-Muffler	1
2	1-134	ADAPTOR-Bearing	2
3	20-303	BEARING	1
4	170-171-500	BODY-Muffler	1
5	1-125	FLANGE-Muffler	1
6	94-735	GASKET-Adaptor	1
7	94-759	GASKET-Muffler (Small)	1
8	94-758	GASKET-Muffler (Large)	1
9	304-29	LOCKWASHER	4
10	183-253	NUT-Stud	4
11	183-34	NUT-Stud	2
12	304-748	WASHER-Insulation	8
13	24-133	STUD-Adaptor	2
14	24-132	STUD-Flange	4
15	304-526	WASHER-Flat	4
16	94-762	GASKET-Flange to Engine	1