

## 800 series

An exceptionally cool running Engine with superior governing and idling characteristics

### specifications . . . .

- HORSEPOWER:** 2 to 2½—2600 to 3600 R.P.M.
- BORE AND STROKE:** 2¾ x 1¾.
- DISPLACEMENT:** 8.3 cu. inch.
- COMPRESSION RATIO:** 6.2/1.
- WEIGHT:** Approximately 42 lbs.
- TYPE:** 4-cycle, single cylinder, L-Head, air cooled.
- AIR COOLED:** Large capacity integral flywheel scroll type blower flows ample air over fin area on cylinder and head.
- STARTER:** Rope or Kick.
- IGNITION:** High Voltage Magneto. ignition cut-out provided.
- LUBRICATION:** Splash type. Oil level is well below all moving parts to insure non-interference. Oil capacity 1½ pints.
- FUEL:** Float-fed carburetor. Gasoline strainer with shut-off.
- FUEL CAPACITY:** 3 quarts.
- OIL FILLER:** Conveniently located on top of crankcase.
- OIL DRAINAGE:** Crankcase permits oil drainage from either end as specified.
- MUFFLER:** Tubular type, low pressure.
- GOVERNOR:** Pneumatic type.
- CAMSHAFT AND GEAR:** Cast iron—Gear and Cams machined integral.
- CRANKSHAFT:** Arma Steel Induction. Heat-treated. Has counterweights and helical camshaft drive gear integral with shaft.
- CONNECTING ROD:** I-beam aluminum alloy with large bearingized bearing area.
- PISTON RINGS:** Compression, scraper and oil rings.
- PISTON PIN:** Hollow type, hardened and ground.
- VALVES:** Forged steel. Exhaust valve provided with heat-resistant steel head.
- VALVE TAPPETS:** Hardened and ground.
- CYLINDER AND CRANKCASE:** Close grained grey iron, metallurgically controlled in our own foundry.
- CYLINDER HEAD:** Cast aluminum with large cooling area.
- AIR CLEANER:** Oil bath — visible, plastic, downdraft type.
- DRIVE:** Crankshaft extension provided with keyway for pulley or coupling. Machined mounting surface provided for mounting equipment when desired.
- DIRECTION OF ROTATION:** (Viewed from power take-off shaft end) counter-clockwise.

<b>power analysis</b>	<b>power</b>	R. P. M.	2000	2400	2800	3200	3600
	SERIES 800		1.4	1.8	2.2	2.4	2.5

### POWER DATA

Power curves are corrected to standard conditions of sea level barometer and temperature of 60° F. and are developed from test engines equipped with standard air cleaner and muffler. Production engines, when shipped, will develop not less than 85% of rated B.H.P.

Production engines, after run-in to reduce friction will develop not less than 95% of the rated B.H.P.

Engine power will decrease 3% for each 1,000 feet above sea level, and 1% for each 10° F. above standard temperature of 60° F.

Unless otherwise specified, governors are set to operate at 3,000 R.P.M. without load. Complete details of installations requiring continuous operation at other than recommended speeds should be referred to the factory for approval.

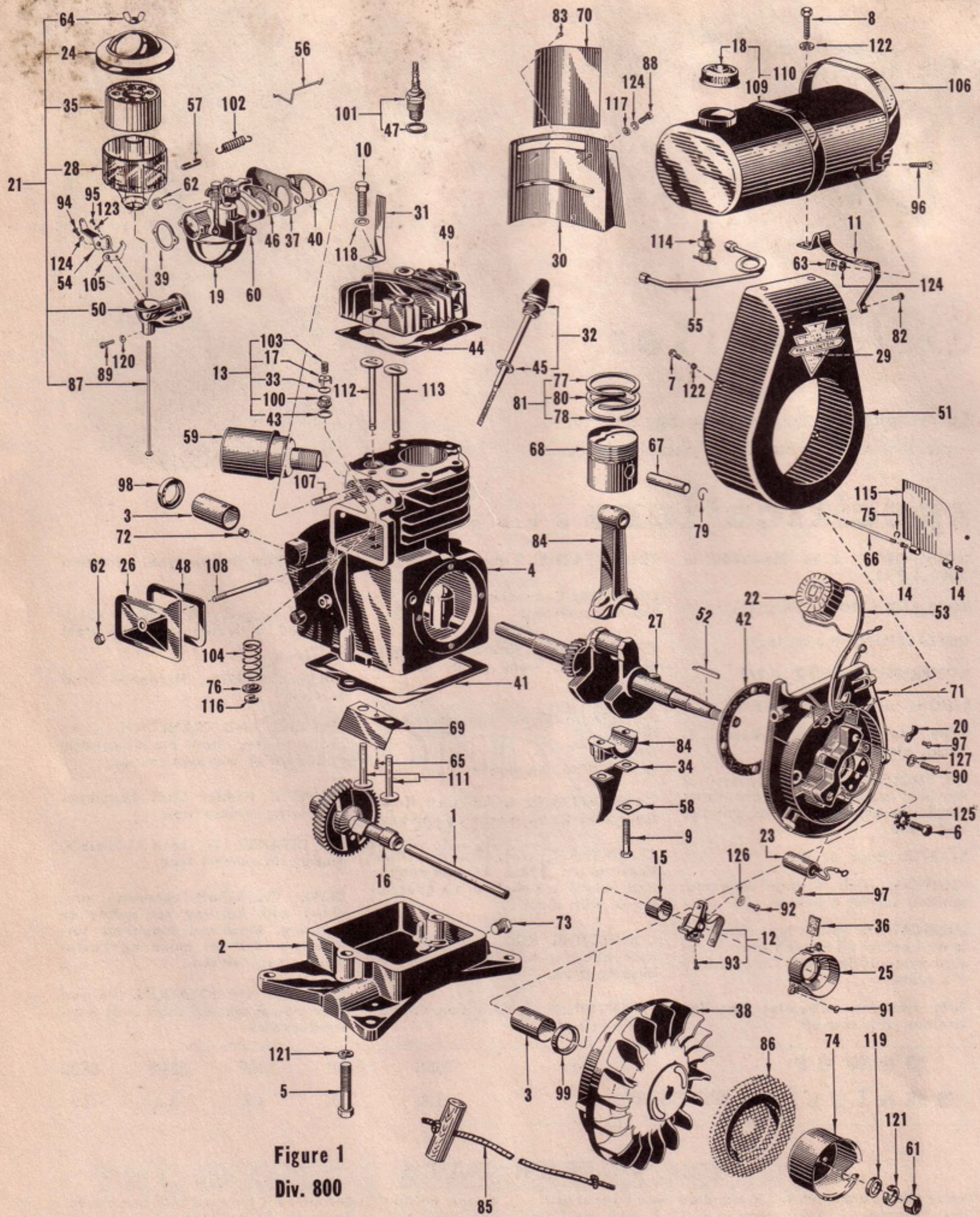
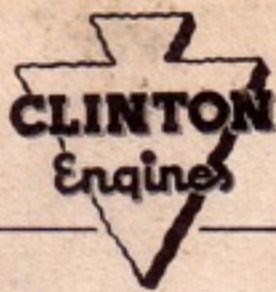

Figure 1  
 Div. 800



# 800 SERIES

## PARTS LIST — ALL TYPES

SEC. II, DIV. 800  
PARTS CATALOG  
Issued January 1952

Figure 1  
Ref. No.

Figure 1 Ref. No.	PART DESCRIPTION	Part No.	Quantity Type "A"
1	AXLE — Camshaft.....	3593-A	1
2	BASE — Engine *(SEE NOTE ON INTERCHANGEABILITY).....	5040	1
3	BEARING — Main.....	3024	2
4	BLOCK ASSEMBLY — Cylinder.....	6040A	1
5	BOLT — Hexagon Head. 7/16 - 20 x 2" (Base to Block).....	3200	2
6	BOLT — Hexagon Head 1/4 - 28 x 3/4" (Bearing Plate to Block).....	3230	4
7	BOLT — Hexagon Head 1/4 - 20 x 3/8" (BlowerHousing).....	5414	4
8	BOLT — HexagonHead 1/4 - 28 x 5/8" (Tank Strap to Head).....	7236	2
9	BOLT — Hexagon Head 1/4 - 28 x 1-1/4" (Connecting Rod Cap).....	3235	2
10	BOLT — Hexagon Head 5/16 - 18 x 1-1/4" (Cylinder Head to Block).....	6055	6
11	BRACKET — Fuel Tank Support.....	4092	2
12	BREAKER POINT ASSEMBLY.....	C-5510	1
13	BREATHER ASSEMBLY.....	7150A	1
14	BUSHING — Air Vane.....	7239	2
15	CAM — Breaker Points.....	5105	1
16	CAMSHAFT.....	6041	1
17	CAP — Breather.....	7151	1
18	CAP & GASKET ASSEMBLY — Fuel.....	3059	1
19	CARBURETOR — Carter Model 705S.....	C-4446	1
20	CLAMP — High Tension Lead.....	3410	1
21	CLEANER ASSEMBLY — Air (Without Airhorn).....	7217A	1
	Note: Breather Assembly includes the following part reference nos. 24, 28 and 35		
	CLEANER ASSEMBLY — Air.....	7217B	1
	Note: Cleaner Assembly includes the following part reference nos.: 24, 28, 35, 50, 64 and 87		
22	COIL — Magneto (Without iron laminations).....	C-5509	1
	COIL — Magneto (With iron laminations).....	C-5502	1
23	CONDENSER.....	C-7219	1
24	COVER — Air Cleaner.....	7217-1	1
25	COVER — Breaker Points.....	5062	1
26	COVER — Valve Chamber.....	3035	1
27	CRANKSHAFT *(SEE NOTE ON INTERCHANGEABILITY).....	6059-1	1
28	CUP — Air Cleaner, Lower.....	7217-2	1
29	DECAL — Arrowhead.....	3579	3
30	DEFLECTOR — Air.....	6032	1
31	DEVICE — Shorting Clip.....	3599	1
32	DIPSTICK ASSEMBLY — Oil.....	3295	1
	Note: Dipstick Assembly 3295 includes the following part reference no.: 45.		
33	DISC — Breather.....	7152	1
34	DISTRIBUTOR — Oil.....	4007	1
35	ELEMENT — Filter, Air Cleaner.....	7217-3	1
36	FELT — Lubrication, Cam Follower.....	5504	1
37	FIN — Cooling.....	3134	3
38	FLYWHEEL ASSEMBLY.....	6222	1
	Note: Flywheel Assembly 6222 sold as assembly only.		
39	GASKET — Air Horn.....	3990	1
40	GASKET — Asbestos (Carburetor to Block).....	7149	1
41	GASKET — Base.....	6031	1
42	GASKET — Bearing Plate (Standard .015 thick).....	3056	1
	Note: Gaskets may also be ordered in following thicknesses: 3056-.010 thick, 3056-.020 thick.		
43	GASKET — Breather.....	7153	1
44	GASKET — Cylinder Head.....	6141	1
	GASKET — Fuel Cap (Not Shown).....	3113	1
45	GASKET — Oil Filler.....	3297	1

# 800 SERIES

## PARTS LIST — ALL TYPES Continued

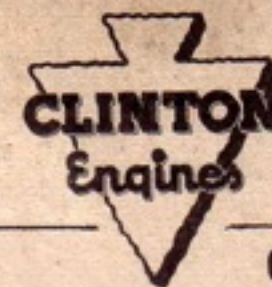

Figure 1  
Ref. No.

PART DESCRIPTION

Part No.      Quantity  
Type A

46	GASKET — Paper (Carburetor to Manifold)	7168	3
47	GASKET — Spark Plug	3115	1
48	GASKET — Valve Chamber Cover	3057	1
	GASKET SET — Engine Overhaul	6031A	1
	NOTE: Gasket Overhaul Kit contains all necessary gaskets and oil seals.		
49	HEAD — Cylinder	6140	1
50	HORN — Air Cleaner	3991	1
51	HOUSING — Blower	6223	1
52	KEY — Flywheel	7244	1
53	LEAD — High Tension	5521	1
54	LEVER — Speed Adjusting <b>*(SEE NOTE ON INTERCHANGEABILITY)</b>	7454	1
55	LINE — Fuel (Tank to Carburetor)	3516	1
56	LINK—Carburetor to Air Vane	7258	1
57	LINK — Governor Spring	7259	1
58	LOCK — Connecting Rod Bolt	3027	2
59	MUFFLER — Tubular	3639	1
60	NIPPLE — Brass (Fuel Line to Carburetor)	3562	1
61	NUT — Hexagon, 7/16 - 20 (Starter Pulley)	3250	1
62	NUT — Hexagon, Gripco. 1/4-28 (1-Valve Cover, 2-Carburetor)	3265	3
63	NUT — Square, 10 - 24 (Tank Straps)	3253	2
64	NUT — Wing (Air Cleaner Cover)	7044	1
65	PIN — Drive (Baffle Plate to Block)	3569	1
66	PIN — Pivot, Air Vane	7184	1
67	PIN — Wrist	6024	1
68	PISTON—Standard	6021	1
	PISTON ASSEMBLY—Standard	6063	1
	NOTE: Piston Assembly includes Ref. Nos. 67, 68, 79, and 81.		
	NOTE: When oversize parts are required, order standard part number and specify oversize desired. Oversizes available are .005, .010, .020, .030, and .040.		
69	PLATE — Baffle	3559	1
70	PLATE — Name	3087	1
71	PLATE ASSEMBLY — Bearing	C-6220A	1
	Note: Plate Assembly includes reference nos.: 3, 66, 71, and 99.		
	PLATE — Bearing Magneto Assembly	C-6220C	1
	Note: — Bearing Plate Magneto Assembly includes reference nos.: 12, 22, 23, 71, 90, 92, 93, 97, 126 and 127.		
72	PLUG — Camshaft Axle	3281	1
73	PLUG — Oil Drain	3289	1
74	PULLEY — Starter	3299	1
75	RETAINER — Air Vane	4430	1
76	RETAINER — Valve Spring	3028	2
77	RING — Compression	6026	1
78	RING — Oil	6028	1
79	RING — Retainer, Wrist Pin	6034	2
80	RING — Scraper, Standard	6027	1
81	RING SET — Standard	6106	1
	Note: Ring Set includes reference nos.: 77, 78, and 80.		
	Note: When oversize parts are required, order standard part number and specify oversize desired. Oversizes available are .005, .010, .020, .030 and .040.		
82	RIVET — 3/16 x 1/4 Tubular (Bracket to Blower Housing)	3619	2
83	RIVET — Name Plate	3660	4
84	ROD ASSEMBLY— Connecting	6107	1
	Note: Connecting Rod Assembly includes reference nos. 9 and 58.		



# 800 SERIES

## PARTS LIST — ALL TYPES Continued

SEC. II, DIV. 800  
PARTS CATALOG  
Issued January 1952

Figure 1  
Ref. No.

Figure 1 Ref. No.	PART DESCRIPTION	Part No.	Quantity Type A
85	ROPE ASSEMBLY — Starter.....	4266	1
86	SCREEN — Revolving.....	6226	1
87	SCREW — Fillister Head, 10 - 24 x 5 - 9/16 (Aircleaner).....	7249	1
88	SCREW — Fillister Head, 10 - 32 x 3/8" (Deflector to Head.).....	3210	2
89	SCREW — Fillister Head, 8 - 32 x 5/8" (Horn to Carburetor).....	3239	2
90	SCREW — Fillister Head, Self-Tapping 1/4 - 20 x 1" (Coil to Bearing Plate).....	5406	2
91	SCREW — Oval Head 6-32 x 3/8" (Breaker Cover to Bearing Plate).....	5416	2
92	SCREW — Round Head, 8 - 32 x 5/16" (Breaker Points to Bearing Plate).....	5407	1
93	SCREW — Round Head, 6 - 32 x 3/8" (Breaker Point Terminal).....	5405	1
94	SCREW — Round Head, 10 - 32 x 3/8 (Speed Adjusting Lever).....	3222	1
95	SCREW — Round Head, 6 - 32 x 1/4" (Stop Lever).....	7143	1
96	SCREW — Round Head, 10 - 24 x 1" (Strap to Bracket).....	5421	2
97	SCREW — Round Head, Self Tapping 8 - 32 x 1/4" (1-Clamp to Bearing Plate, 1-Condenser).....	5415	2
98	SEAL — Oil (Cylinder Block).....	3026	1
99	SEAL — Oil (Flywheel Side).....	3136	1
100	SEAT — Breather.....	7150	1
101	SPARK PLUG & GASKET ASSEMBLY.....	3568	1
102	SPRING — Air Governor.....	7264	1
103	SPRING — Breather Hold Down.....	7154	1
104	SPRING — Valve.....	3068B	2
105	STOP — Lever Speed Control *(SEE NOTE ON INTERCHANGEABILITY).....	7453	1
106	STRAP — Fuel Tank.....	4093	2
107	STUD — 1/4 - 28 x 1-9/32" (Carburetor to Block).....	3096	2
108	STUD — Valve Chamber Cover.....	3042	1
109	TANK — Fuel.....	4090	1
110	TANK ASSEMBLY — Fuel.....	4090A	1
	Note: Tank Assembly includes the following reference nos.: 18 and 109		
111	TAPPET — Valve.....	3034	2
112	VALVE — Exhaust, Standard Stem.....	3031-1	1
	VALVE — Exhaust, Oversize Stem.....	3031-2	
113	VALVE — Intake, Standard Stem.....	3032-1	1
	VALVE — Intake, Oversize Stem.....	3032-2	
114	VALVE AND FILTER ASSEMBLY — Fuel Shut-off.....	5050	1
115	VANE — Air Governor.....	6455	1
116	WASHER — "C" (Valve Keeper).....	3291	2
117	WASHER — Flat, #10 (Air Deflector Screw).....	3279	2
118	WASHER — Flat 5/16 (Cylinder Head).....	3276	6
119	WASHER — Flat, 15/32" (Starter Pulley).....	3268	1
120	WASHER — Lock #8 (Airhorn).....	3280	2
121	WASHER — Lock 7/16" (2 - Base, 1 - Starter Pulley).....	3275	3
122	WASHER — Lock, 1/4" (4 - Blower Housing, 2 - Tank Straps).....	3277	6
123	WASHER — Lock #6 (Speed Adjusting Lever) *(SEE NOTE ON INTERCHANGEABILITY).....	5483	1
124	WASHER — Lock #10 Split (1-Speed Adjusting Lever, 2-Air Deflector 2-Tank Assembly)....	3285	5
125	WASHER — Lock, 1/4 External Tooth (Bearing Plate).....	5484	4
126	WASHER — Lock #8 External Tooth (Breaker Points).....	5481	1
127	WASHER — Lock 1/4" Internal Tooth (Coil to Bearing Plate).....	3273	2

### AVAILABLE OVERHAUL KITS

ENGINE	TYPE	GASKET OVERHAUL KITS
800	ALL TYPES	6031A

**NOTE: \*(SEE NOTE ON INTERCHANGEABILITY)** — Indicates that these parts are not the same on all Engine Models. Refer to the Model Variation List immediately following to obtain the part number when the part is different from the Basic Parts List.

# CLINTON Engines

## VARIATIONS FROM BASIC MODEL 800

The following Engine Models have variations from the Basic Engine and Lists the Parts that are different from basic Parts List.

	Base Engine	Bearing Main	Block Assembly Cylinder	Cable Length	Control Group	Crankshaft	Kickstarter	Oil Seal	Reduction Unit— Speed	Reduction Unit "Clock" Position
	2	3	4	III	III	27	III	98	III	
801-C5B										
	*Note 1									
801-COA										
801-COB				72"						
801-DOB		5041		72"			*6059-5			
861-COB				72"			6049-1		3860	9:00

\*Note 1 — The Standard Fuel Tank and Fuel Line are replaced by the following parts: 1-4105A Fuel Tank; 1-4091 Fuel Line.

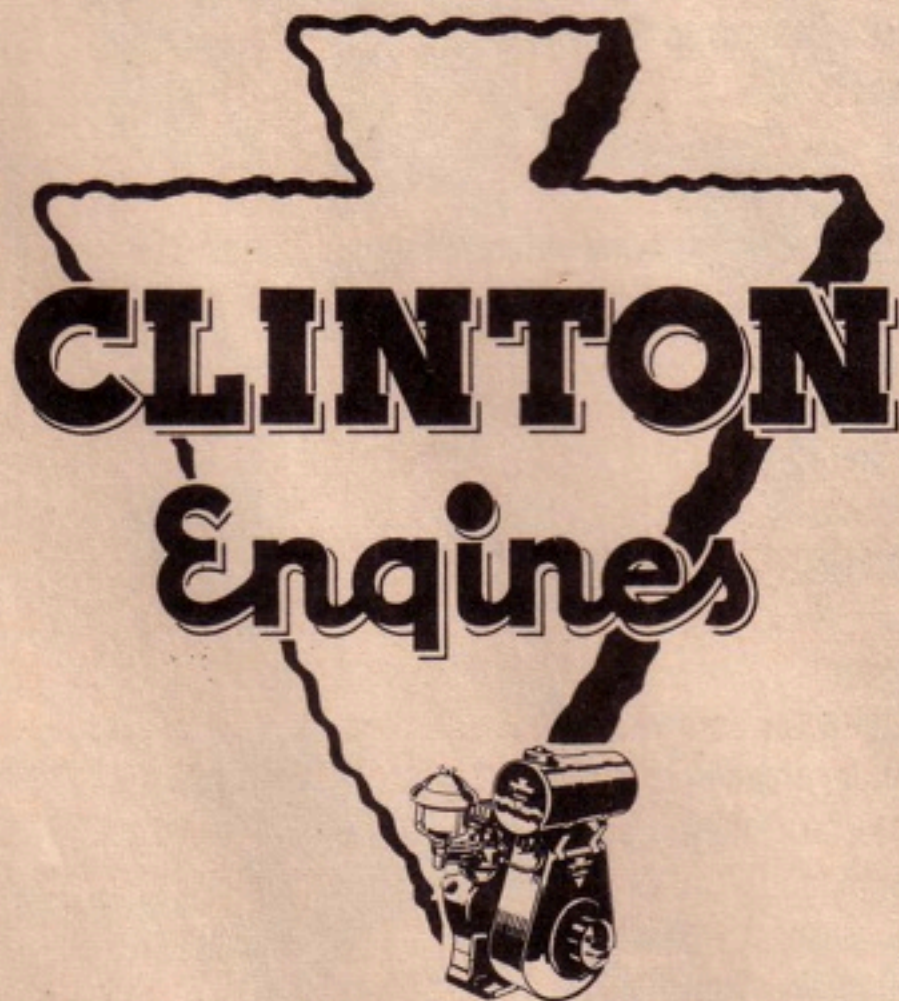

**THE CLINTON MACHINE COMPANY**

Service Division

MAQUOKETA, IOWA., U. S. A.