

SEC. II, DIV. 900-2000  
PARTS CATALOG  
Revised April, 1958  
Supersedes May, 1956

**CLINTON**

**S E R I E S**  
**900-2000**  
**L O N G L I F E**

**BASIC**  
**TYPES**

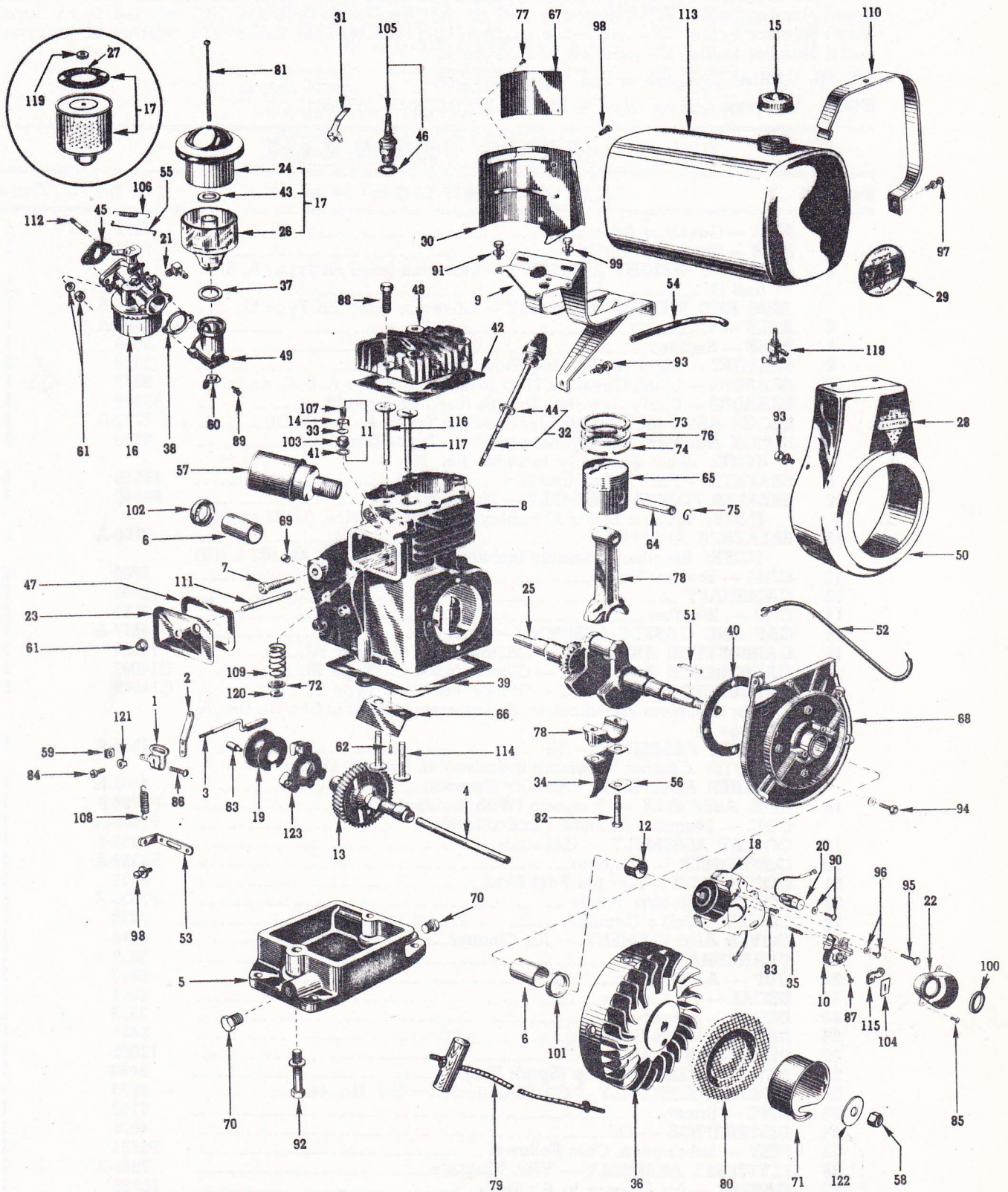

**CLINTON**

S	E	R	I	E	S		
<b>900-2000</b>							
L	O	N	G	L	I	F	E

**BASIC  
TYPES**
**SEC. II, DIV. 900-2000  
PARTS CATALOG**  
 Revised April, 1958  
 Supersedes May, 1956

There are five Basic Types of the 900-2000 Engines covered by this Basic Parts List. These are as follows:  
 Serial Number Suffix "A"—referred to as Type A; Serial Number Suffix "B"—referred to as Type B;  
 Serial Number Suffix "C"—referred to as Type C; Serial Number Suffix "D"—referred to as Type D;  
 Serial Number Suffix "E"—referred to as Type E.

MODEL VARIATIONS follow this Basic Parts List.

**NOTE:** See page "a" on "How to Identify Your Clinton Engine."

## BASIC PARTS LIST

Ref. No.	PART DESCRIPTION	Part No.	Quantity
1	ARM — Governor Adjusting .....	7975	1
2	ARM — Governor Throttle .....	7977	1
3	ARM AND WEIGHT ASSEMBLY — Governor (used on Types A, B, C, and D) .....	4203	1
	ARM AND WEIGHT ASSEMBLY — Governor (used on Type E) .....	12311-A	1
4	AXLE — Camshaft .....	3593-A	1
5	BASE — Engine .....	5040	1
6	BEARING — Main (1—Bearing Plate, 1—Block) .....	3024	2
7	BEARING — Shaft, Governor Throttle (used on Types A, B, C, and D) .....	3073	1
	BEARING — Shaft, Governor Throttle (used on Type E) .....	12310	1
8	BLOCK ASSEMBLY — Cylinder (used on Types A, B, and C) .....	6082-A	1
	BLOCK ASSEMBLY — Cylinder (used on Types D and E) .....	9220	1
	NOTE: Block Assembly includes Ref. No. 6.		
9	BRACKET — Fuel Tank Mounting .....	12059	1
10	BREAKER POINTS ASSEMBLY — Magneto .....	P5543	1
	NOTE: Breaker Points Assembly includes Ref. Nos. 35, 87 and 96.		
11	BREATHER ASSEMBLY .....	7150-A	1
	NOTE: Breather Assembly includes Ref. Nos. 14, 33, 41, 103 & 107)		
12	CAM — Breaker Points .....	5703	1
13	CAMSHAFT .....	12008	1
14	CAP — Breather .....	7151	1
15	CAP AND GASKET ASSEMBLY — Fuel .....	4517-A	1
16	CARBURETOR ASSEMBLY — Clinton (used on Type A) .....	14003	1
	CARBURETOR ASSEMBLY — Clinton (used on Type B) .....	C14085	1
	CARBURETOR ASSEMBLY — Clinton (used on Type C) .....	C14086	1
	(For Complete Identification of Carburetors, Refer to Sec. III, Div. A, Page 2)		
17	CLEANER ASSEMBLY — Air .....	4512-A	1
	NOTE: Cleaner Assembly includes Ref. Nos. 24, 26 and 43.		
	CLEANER ASSEMBLY — Air (Dry Element) .....	4546-A	1
18	COIL ASSEMBLY — Magneto (With Laminations) .....	P5704-B	1
	COIL — Magneto (Without Laminations) .....	P5593-A	1
19	COLLAR ASSEMBLY — Governor .....	3083-1	1
20	CONDENSER — Magneto .....	P5589-A	1
21	CONNECTOR — Flexible Fuel Line .....	5052	1
22	COVER — Breaker Points .....	P5595-A	1
23	COVER — Valve Chamber .....	7938	1
24	COVER AND ELEMENT — Air Cleaner .....	4512	1
25	CRANKSHAFT .....	6059-5	1
26	CUP — Air Cleaner .....	4513	1
27	DECAL — Air Cleaner .....	4561	1
28	DECAL — Arrowhead .....	3579	1
29	DECAL — Horse Power .....	3451	1
30	DEFLECTOR — Air .....	12008	1
31	DEVICE — Shorting Clip (Spark Plug) .....	3499	1
32	DIPSTICK ASSEMBLY — Oil Filler (includes Ref. No. 44) .....	3295	1
33	DISC — Breather .....	7152	1
34	DISTRIBUTOR — Oil .....	4007	1
35	FELT — Lubrication, Cam Follower .....	P5504	1
36	FLYWHEEL ASSEMBLY — With Magnets .....	7999-A	1
37	GASKET — Air Cleaner to Air Horn .....	10259	1
38	GASKET — Air Horn to Carburetor .....	3990	1

**BASIC PARTS LIST (Continued)**

Ref. No.	PART DESCRIPTION	Part No.	Quantity
39	GASKET — Base .....	4465-1	1
40	GASKET — Bearing Plate (Standard, .015 thick).....	3056	1
	NOTE: Gaskets may also be ordered in the following thicknesses: .005, .010 and .020. Order by Part Number and specify thickness.		
41	GASKET — Breather .....	7153	1
42	GASKET — Cylinder Head .....	6141	1
43	GASKET — "O" Ring, Air Cleaner (Element to Cup).....	4515	1
44	GASKET — Dipstick Assembly .....	3297	1
45	GASKET — Asbestos (Carburetor to Block).....	6002	1
46	GASKET — Spark Plug .....	3115	1
47	GASKET — Valve Chamber Cover.....	3057	1
	GASKET KIT — Engine Overhaul .....	6031-A	1
	GASKET KIT — Engine Overhaul (With Speed Reducer Units).....	6031-B	1
	NOTE: Kit contains all necessary Gaskets and Oil Seals.		
48	HEAD — Cylinder.....	6140	1
49	HORN — Air.....	10350-C	1
50	HOUSING — Blower .....	7907-A	1
	HOUSING — Blower (For Recoil Starter).....	7913-A	1
51	KEY — Flywheel.....	10339	1
52	LEAD — High Tension, Magneto.....	P5555	1
53	LEVER — Speed Adjusting.....	3075	1
54	LINE — Fuel, Flexible.....	6316	1
55	LINK — Carburetor to Governor Arm.....	7920	1
56	LOCK — Connecting Rod Screw.....	3027	2
57	MUFFLER — Tubular.....	3639	1
58	NUT — Hexagon, 7/16-20 (Starter Pulley).....	5476	1
59	NUT — Square, #10-24 (Governor Adjusting Arm).....	3253	1
60	NUT — Wing (Air Cleaner Screw).....	7044	1
61	NUT & L'WASHER ASS'Y — Hexagon, 1/4-28 (1—Valve Cover Stud, 2—Carburetor to Block).....	3255-A	3
62	PIN — Drive (Baffle Plate to Block).....	3569	1
63	PIN — Retaining (Governor Yoke) .....	3656	1
64	PIN — Wrist .....	6024	1
65	PISTON — Standard.....	31001	1
	PISTON ASSEMBLY — Standard.....	31001-A	1
	NOTE: Piston Assembly includes Ref. Nos. 64, 65, 73, 74, 75 & 76. Sizes: .005, .010, .020, .030 and .040. Order by Part Num- ber and specify oversize.		
66	PLATE — Baffle, Crankcase .....	3559	1
67	PLATE — Name .....	6530	1
68	PLATE — Bearing .....	12016-A	1
	NOTE: Bearing Plate includes Ref. Nos. 6 and 101.		
69	PLUG — Camshaft Axle .....	3281	1
70	PLUG — Oil Drain .....	3289	2
71	PULLEY — Starter.....	3299	1
72	RETAINER — Valve Spring.....	3028	2
73	RING — Compression, Standard .....	6026	1
74	RING — Oil, Standard .....	6006	1
75	RING — Retainer, Wrist Pin.....	6034	2
76	RING — Scraper, Standard .....	6027	1
	RING SET — Standard.....	10023	1
	NOTE: Ring Sets are also available in the following oversizes: .005, .010, .020, .030 and .040. Order by Part Number and specify oversize.		
	NOTE: Ring Set includes Ref. Nos. 73, 74 and 76.		
77	RIVET — Tubular, Name Plate.....	5469	4
78	ROD ASSEMBLY — Connecting .....	6107	1
	NOTE: Rod Assembly includes Ref. Nos. 56 and 82.		

**CLINTON**

S	E	R	I	E	S
<b>900-2000</b>					
LONG LIFE					

**BASIC  
TYPES**

SEC. II, DIV. 900-2000  
PARTS CATALOG  
Revised April, 1958  
Supersedes May, 1956

**BASIC PARTS LIST (Continued)**

Ref. No.	PART DESCRIPTION	Part No.	Quantity
79	ROPE ASSEMBLY — Starter	4266	1
80	SCREEN — Revolving	6226	1
81	SCREW — R.H.M., #10-24 x 6¼ (Air Cleaner)	5636	1
82	SCREW — H.H.C., ¼-28 x 1¼ (Connecting Rod Cap)	3235	2
83	SCREW — P.H.S.T., #4-40 x ¼ (Coil Ground to Laminations)	5641	1
84	SCREW — H.H. Slotted S.T., #8-32 x ¾ (Governor Arm)	5644	1
85	SCREW — R.H.S.T., #6-32 x ¾ (Breaker Cover to Bearing Plate)	5405	2
86	SCREW — R.H.M., #10-24 x ⅝ (Governor Adjusting Arm)	3211	1
87	SCREW — R.H.M., #6-32 x ¼ (Breaker Points Terminal)	5664	2
88	SCREW — H.H.C., 5/16-18 x 1¼ (Cylinder Head to Block)	5652	6
89	SCREW — F.H.M., #8-32 x 11/16 (Air Horn to Carburetor)	5677	2
90	SCREW & L'WASHER ASS'Y — F.H.M., #8-32 x ⅝ (Condenser to Bearing Plate)	5674-F	1
91	SCREW & L'WASHER ASS'Y — F.H.M., #10-32 x ½ (Tank Bracket to Head)	5412-G	1
92	SCREW & L'WASHER ASS'Y — H.H.C., 7/16-20 x 2 (Base to Block)—used on 1000 Series	3200-A	2
93	SCREW & L'WASHER ASS'Y — H.H.C., ¼-20 x ⅝ (1—Tank Bracket, 6—Blower Housing to Plate)	3632-G	7
94	SCREW & L'WASHER ASS'Y — H.H.C., ¼-28 x ¾ (Bearing Plate to Block)	5448-F	4
95	SCREW & L'WASHER ASS'Y — P.H.S.T., #10-24 x 1 (Lamination to Bearing Plate)	5682-A	2
96	SCREW & L'WASHER ASS'Y — R.H.M., #8-32 x ⅓ (Breaker Points to Bearing Plate)	5409-F	1
97	SCREW & L'WASHER ASS'Y — R.H.M., #10-24 x 1 (Fuel Tank Straps)	5421-A	2
98	SCREW & L'WASHER ASS'Y — R.H.M., #10-32 x ⅝ (1—Speed Adjusting Lever, 2—Deflector to Head)	3222-F	3
99	SCREW & L'WASHER ASS'Y — H.H.C., ¼-28 x ⅝ (Tank Bracket to Head)	7236-G	1
100	SEAL — Breaker Points Cover	5596	1
101	SEAL — Oil (Bearing Plate)	3136	1
102	SEAL — Oil (Cylinder Block)	3026	1
103	SEAT — Breather	7150	1
104	SHIELD — Breaker Points	5714	1
105	SPARK PLUG AND GASKET ASSEMBLY	K3568-A	1
106	SPRING — Backlash, Governor	7979	1
107	SPRING — Breather Hold-Down	7154	1
108	SPRING — Governor	4001	1
109	SPRING — Valve	3068	2
110	STRAP — Fuel Tank Mounting	12060	2
111	STUD — Valve Chamber Cover	3042	1
112	STUD — Carburetor Mounting	6155	2
113	TANK ASSEMBLY — Fuel	12058-A	1
	NOTE: Tank Assembly includes Ref. No. 15.		
114	TAPPET — Valve	3034	2
115	TERMINAL — Breaker Points	5713	1
116	VALVE — Exhaust, Standard Stem	3031-1	1
	VALVE — Exhaust, Oversize Stem (Approx. 9/32 Dia.)	3031-2	1
117	VALVE — Intake, Standard Stem	3032-1	1
	VALVE — Intake, Oversize Stem (Approx. 9/32 Dia.)	3032-2	1
118	VALVE — Fuel, Shut-Off, Flexible Line	5051	1
119	WASHER — Air Cleaner Screw (used with 4546-A Cleaner)	5906	1
120	WASHER — "C," Valve Keeper	3291	2
121	WASHER — Governor Arm Adjusting	7976	1
122	WASHER — Spring Tension (Starter Pulley)	4119	1
123	WEIGHT ASSEMBLY — Governor Yoke (used on Types A, B, C, & D)	3062-A	1
	WEIGHT ASSEMBLY — Governor Yoke (used on Type E)	3062-B	1

SEC. II, DIV. 900-2000  
PARTS CATALOG  
Revised April, 1958  
Supersedes May, 1956

**CLINTON**

**S E R I E S**  
**900-2000**  
**L O N G L I F E**

**TYPES**  
**BASIC**

---

**BASIC PARTS LIST (Continued)**

---

**AVAILABLE OVERHAUL KITS**

<b>Engine Model</b>	<b>Description</b>	<b>Kit No.</b>
900-2000	Gasket Overhaul Kit	6031-A
*900-2000	Gasket Overhaul Kit	6031-B
900-2000	Carburetor Repair Kit (Clinton)	14238

\*With Speed Reducer Units.

# CLINTON

**S E R I E S**  
**900-2000**  
**L O N G L I F E**

**MODEL VARIATIONS**

SEC. II, DIV. 900-2000  
PARTS CATALOG  
Revised January, 1959  
Supersedes Mar., 1958

## MODEL VARIATIONS OF 900-2000 SERIES

The adaptation of Clinton Engines to a wide variety of uses results in what is known as "Model Variations." Following is the complete list of all Models produced up to issue date (shown above). Opposite each Engine Model listed are the Part Numbers and/or Assembly Numbers for the Series used IN ADDITION TO or IN PLACE OF the parts illustrated and shown on the Basic Parts List preceding this Model Variations List. Refer to other sections of this Manual when Assembly Numbers are given to find the Parts List for these assemblies.

See page (a) on "How to Identify Your Clinton Engine." Use the preceding Basic Parts List except as shown below.

ENGINE MODEL — See page (a), "How to Identify Your Clinton Engine."	FOOTNOTES (Check page 5).	BASE — ENGINE (Part Numbers Shown). Refer to Sec. IV, Div. A for further information.	CONTROL GROUP (Control Group Illustration Numbers Shown). Refer to Sec. III, Div. D for Parts List.	CONTROL CABLE LENGTH — Replacement cable is furnished in 72" length ONLY, cut to length shown.	CRANKSHAFT (Part Numbers Shown). Refer to Sec. IV, Div. B for details and further information.	BEARING — MAIN (Part Numbers Shown). Refer to Illustrated Basic Parts List for location of corresponding part.	BLOCK ASSEMBLY — CYLINDER (Part Numbers Shown). Refer to Illustrated Basic Parts List for corresponding part.	STARTER — RECOIL. Refer to Sec. III, Div. H for proper identification and Parts List.	HOUSING ASSEMBLY — BLOWER (Part Numbers Shown). Refer to Illustrated Basic Parts List for corresponding part.	REDUCTION GEAR (Assy. Nos. Shown). Refer to Sec. III, Div. C for Parts List.	MOUNTING POSITION
900-2101		No Variation—Use Basic Parts List									
900-2102								Yes		7913-A	
900-2104			SK555	72"	6059-1						
900-2105			SK558	72"	6059-1			Yes		7913-A	
900-2106	Note 10		SK557								
900-2110	Note 33										
900-2112					6059-1						
900-2114			SK555	72"	6059-1						
900-2115			SK555	72"	6059-1			Yes		7913-A	
900-2116		No Variations—Use Basic Parts List									
900-2118			SK555	60"							
900-2119		6025									
900-2120			SK557	72"	6059-5						
900-2122			SK558	72"							
900-2124		6093	SK558								
900-2125		6025	SK555	72"				Yes		7913-A	
900-2126	Note 2	6025									
900-2127					6059-5						
900-2133			SK555	72"							
900-2136			SK555		6059-1						
900-2141			SK555	36"	6235	9223					
900-2145		6025						Yes		7913-A	
900-2146	Notes 10 & 25		SK555								
900-2153		6093	SK555								
900-2154		6025	SK555	72"							
900-2155	Note 2	6025	SK555	72"				Yes		7913-A	
900-2156	Notes 17 & 24		SK555					Yes		7914	
900-2158	Note 10		SK557								
900-2159		6025	SK555	72"	6059-1						
900-2160										7913-A	
900-2161			SK555					Yes		7913-A	
900-2162			SK555	72"				Yes		7913-A	
900-2163								Yes		7913-A	

**CLINTON**

**S E R I E S**  
**900-2000**  
**L O N G L I F E**

**MODEL  
VARIATIONS**

**MODEL VARIATIONS OF 900-2000 SERIES (Cont.)**

ENGINE MODEL	FOOTNOTES	BASE—ENGINE	CONTROL GROUP	CONTROL CABLE LENGTH	CRANKSHAFT	BEARING—MAIN	BLOCK ASSEMBLY—CYLINDER	STARTER—RECOL.	HOUSING ASSEMBLY—BLOWER	REDUCTION GEAR	MOUNTING POSITION
900-2164			SK558	72"				Yes	7913-A		
900-2165	Note 31										
900-2166	No Variation—Use Basic Parts List										
900-2167	Note 2							Yes	7913-A		
900-2168		6025						Yes	7913-A		
900-2169	Notes 2, 10, 15		SK555				9222				
900-2170	Notes 10 & 20		SK555				9225				
900-2172		6025									
900-2173	Note 10		SK557								
900-2174	No Variation—Use Basic Parts List										
900-2175		6025			6059-1			Yes	7913-A		
900-2176			SK558	72"				Yes	7913-A		
900-2177	Note 24		SK557		6059-1						
900-2178								Yes	7913-A		
900-2179	Note 26		SK555					Yes	7913-A		
900-2180		6025	SK555	72"				Yes	7913-A		
900-2181			SK555		6059-5						
900-2182	Note 1		SK555	72"	6059-1						
900-2183	Notes 2, 10, 15, 16		SK558				9222				
900-2184	Note 10		SK557								
900-2185			SK555					Yes	7913-A		
900-2186			SK555		6059-1			Yes	7913-A		
900-2187	Note 10		SK555	38 <sup>3</sup> / <sub>4</sub> "				Yes	7913-A		
900-2188			SK555	72"				Yes	7913-A		
900-2189	Note 29				6013		9226				
900-2190	Note 30										
900-2191	Note 2		SK555	72"							
900-2192	Note 2		SK555	72"				Yes	7913-A		
900-2193	Note 10		SK558								
900-2194			SK555								
900-2196	No Variation—Use Basic Parts List										
900-2197			SK555	72"	6059-5			Yes	7913-A		
900-2198	Note 1		SK555	72"	6059-1			Yes	7913-A		
900-2199	Note 10		SK555					Yes	7913-A		
900-2200	Notes 10 & 21		SK556								
900-2201	Note 24										
900-2202	No Variation—Use Basic Parts List										
900-2203			SK555		6015						
900-2204		6025	SK555	72"	6059-1			Yes	7913-A		
900-2205	Note 2	6025	SK555								
900-2206	Note 10		SK556		6059-1			Yes	7913-A		
900-2207			SK558	72"							
900-2208	Note 10		SK556					Yes	7913-A		
900-2209	Note 2		SK555	72"				Yes	7913-A		
900-2210	Note 10		SK555	72"				Yes	7913-A		

**CLINTON**

S	E	R	I	E	S	
<b>900-2000</b>						
L	O	N	G	L	I	F

**MODEL VARIATIONS**
**SEC. II, DIV. 900-2000**  
**PARTS CATALOG**  
 Revised January, 1959  
 Supersedes Mar., 1958

---

**MODEL VARIATIONS OF 900-2000 SERIES (Cont.)**

---

ENGINE MODEL	FOOTNOTES	BASE—ENGINE	CONTROL GROUP	CONTROL CABLE LENGTH	CRANKSHAFT	BEARING—MAIN	BLOCK ASSEMBLY—CYLINDER	STARTER—RECOIL	HOUSING ASSEMBLY—BLOWER	REDUCTION GEAR	MOUNTING POSITION
900-2211	No Variation—Use Basic Parts List										
900-2212		6025	SK555					Yes	7913-A		
900-2213			SK561								
900-2214	Note 10		SK555					Yes	7913-A		
900-2215								Yes	7913-A		
900-2216			SK561								
900-2217	Note 10		SK555					Yes	7913-A		
900-2218	No Variation—Use Basic Parts List										
900-2219			SK555		6059-1						
900-2220			SK555		6059-1			Yes	7913-A		
900-2221		6025	SK555		6059-1						
900-2222	Notes 17 & 34										
900-2223			SK555	72"							
900-2224			SK555	72"	6059-1			Yes	7913-A		
900-2225	Note 24		SK555	72"				Yes	7913-A		
900-2226	Notes 2 & 38		SK555					Yes	7913-A		
900-2227			SK555	72"				Yes	7913-A		
900-2228	Note 34							Yes	7913-A		
900-2500	No Variation—Use Basic Parts List										
900-2503	Note 31										
900-2507	No Variation—Use Basic Parts List										
920-2000	Note 19				6091-1					3552	6:00
920-2101	Note 19				6091-1			Yes	7913-A	3552	6:00
920-2103	Note 19				6091-1					3552	9:00
920-2104	Note 19				6091-1					3552	6:00
920-2105	Notes 19 & 31				6091-1					3552	6:00
940-2000	Note 19				6089-1					3554	6:00
940-2103	Note 31				6089-1					3554	6:00
940-2104	Note 19				6089-1			Yes	7913-A	3554	6:00
960-2000	Note 19				6049-1					3800	6:00
960-2100	Note 19				6049-1			Yes	7913-A	3800	6:00
960-2101	Note 19		SK555	72"	6049-1					3800	6:00
960-2103	Note 19				6049-1					3800	6:00
960-2104	Note 19				6049-1			Yes	7913-A	3800	6:00
960-2107	Note 19				6049-1			Yes	7913-A	3800	6:00
960-2108	Note 19		SK555	72"	6049-1					3800	6:00
960-2109	Note 19		SK555	72"	6049-1			Yes	7913-A	3800	6:00
960-2114	Note 19	6025	SK555	72"	6049-1					3800	12:00
960-2115	Notes 19 & 31				6049-1					3800	6:00
960-2116	Notes 10 & 19		SK558	54"	6049-1					3800	6:00
960-2117	Notes 10 & 19		SK558	54"	6049-1					3800	6:00
960-2118	Note 19		SK555		6049-1					3800	12:00
960-2119	Note 19				6049-1					3800	12:00
960-2120	Note 19		SK555	72"	6049-1			Yes	7913-A	3800	9:00
960-2121	Note 19	6025			6049-1					3800	6:00
960-2122	Notes 19 & 24		SK555	72"	6049-1			Yes	7913-A	3800	6:00



**MODEL VARIATIONS OF 900-2000 SERIES (Cont.)**

ENGINE MODEL	FOOTNOTES	BASE—ENGINE	CONTROL GROUP	CONTROL CABLE LENGTH	CRANKSHAFT	BEARING—MAIN	BLOCK ASSEMBLY—CYLINDER	STARTER—RECOIL	HOUSING ASSEMBLY—BLOWER	REDUCTION GEAR	MOUNTING POSITION
960-2123	Note 19				6049-1					3800	9:00
960-2124	Note 19		SK555		6049-1					3800	6:00
960-2125	Note 19		SK555		6049-1			Yes	7913-A	3800	6:00
960-2500	Note 19				6049-1					3800	6:00
960-2501	Notes 19 & 31				6049-1					3800	6:00
990-2109	Note 5				7928	3670	9224				
990-2111	Note 5		SK561		7929	3670	6961-A	Yes	7913-A		
990-2112	Notes 5 & 33				7924	3670	6961-A				
990-2115	Notes 5 & 7		SK561		7927	3670	6961-A				
990-2116	Note 5				7924	3670	9224				
990-2117	Note 5		SK561		7929	3670	9224				
990-2118	Note 5	6025			7924	3670	9224				
990-2119	Note 23				7929	3670	9224				
990-2120	Note 5				7924	3670	9224				
990-2121	Notes 5 & 33	6025			7927	3670	6961-A				
990-2122	Note 5				7924	3670	9221	Yes	7913-A		
990-2123	Notes 5, 21, 22		SK561		7929	3670	9224				
990-2124	Notes 5, 7, 33				8001	3670	6963-A				
990-2125	Notes 5 & 24		SK561		7929	3670	9224				
990-2126	Note 5		SK561		7927	3670	9224				
990-2127	Note 5				7929	3670	9224				
990-2128	Notes 5 & 31				7924	3670	9224				
990-2129	Notes 5 & 31		SK561		7927	3670	9224				
990-2130	Note 5				7928	3670	9224				
990-2131	Note 5				7924	3670	9224				
990-2132	Notes 5 & 28		SK561		7929	3670	9224				
990-2133	Notes 5 & 32	6025	SK556		8001	3670	9227				
990-2134	Notes 5 & 27		SK561		7929	3670	9224				
990-2135	Notes 5, 10, 24		SK556		7929	3670	9224				
990-2136	Note 5				7929	3670	9224	Yes	7913-A		
990-2137	Note 5		SK555		7924	3670	9224				
990-2138	Notes 5, 27, 28		SK561		7929	3670	9224				
990-2139	Notes 5, 12, 34, 35, 39		SK561		7928	3670	9229	Yes	7913-A		
990-2140	Notes 3, 30, 39		SK561		7928	3670	9224	Yes	7913-A		
990-2141	Notes 5, 24, 35		SK561		7929	3670	9229				
990-2142	Note 5		SK561		8000	3670	9224				
990-2143	Note 5		SK555	72"	7924	3670	9224	Yes			
990-2144	Note 5		SK561		8004	3670	9224				
990-2145	Notes 5, 21, 24, 36, 37		SK561		8000	3670	9230	Yes	7913-A		
990-2146	Note 5		SK561		7929	3670	9224				
990-2147	Note 5				7924	3670	9224				
990-2148	Note 5				7924	3670		Yes	7913-A		
990-2149	Notes 5 & 28		SK561		7929	3670	9224	Yes	7913-A		
990-2150			SK561		7927	3670	9224	Yes	7913-A		

**CLINTON**

S	E	R	I	E	S		
<b>900-2000</b>							
L	O	N	G	L	I	F	E

**MODEL  
VARIATIONS**
**SEC. II, DIV. 900-2000  
PARTS CATALOG**  
 Revised January, 1959  
 Supersedes Mar., 1958
**MODEL VARIATIONS OF 900-2000 SERIES (Cont.)**

ENGINE MODEL	FOOTNOTES	BASE—ENGINE	CONTROL GROUP	CONTROL CABLE LENGTH	CRANKSHAFT	BEARING—MAIN	BLOCK ASSEMBLY—CYLINDER	STARTER—RECOIL	HOUSING ASSEMBLY—BLOWER	REDUCTION GEAR	MOUNTING POSITION
990-2151	Notes 1, 5, 37		SK561		7929	3670					
990-2500	Note 5				7924	3670	9221				
990-2501	Notes 5 & 33		SK561		7927	3670	6961-A				
990-2502	Notes 5 & 33				7924	3670	6960-A				
990-2503	Notes 5 & 31		SK561		7927	3670	9224				
990-2504	Notes 5 & 31				7924	3670	9221				
990-2509	Note 5		SK561		7927	3670	9224				

- NOTE 1—Air Cleaner Assembly #2000-A to be used in lieu of #4512-A.
- NOTE 2—Muffler #4500 and Lock Nut #4425 to be used in lieu of #3639.
- NOTE 3—Bearing Plate Assembly #7952-D must be used in lieu of #7960-B on this model.
- NOTE 4—Clip #6426 and Cover (Spark Plug) #4181 are used on this model.
- NOTE 5—Oil Seal #3669 must be used in lieu of #3026 on this model.
- NOTE 6—Oil Seal #6152, Washer (felt) #6156, Washer (Steel) #6157, and Ring #6158 are used.
- NOTE 7—Spacer #7954 and two (2) Screw #5657 are used in mounting cylinder head on this model.
- NOTE 8—Elbow #4419, Nut (Lock) #4425, Spacer (Fuel Tank Bracket) #7946, and Screw #5646 used as additional parts.
- NOTE 9—#7961 Bearing Plate used in lieu of #7960-B.
- NOTE 10—Use #6453 Horn—Air, #7938 Cover—Valve Chamber, #4554 Tube—Breather, and #10353 Sleeve.
- NOTE 11—#3149-A Arm and Weight Assembly, (2) #6155 Stud, #6002 Gasket and #14003 Carburetor Assembly, #4521 Muffler, #12005 Deflector, #12051 Tank Assembly used on this model.
- NOTE 12—#C-3500-A Valve and Filter Assembly—Fuel Shut-Off, #5052 Connector—Fuel Line, and #3576 Connector—Fuel Line used on this model.
- NOTE 13—#12051 Tank Assembly, #12052 Bracket—Fuel Tank, (2) #16343 Strap—Fuel Tank, (2) #3235-A Screw and L'Washer Assembly used on this model.
- NOTE 14—#4090 Tank Assembly, #7909-A Bracket and Strap, and #7910-A Bracket and Strap Assembly, #3991 Horn—Air, #7249 Screw, #7952-D Plate—Bearing, #P-5568-A Wire Assembly—Ignition Shorting, #P-5566 Grommet and #5443 Screw used on this model.
- NOTE 15—#7948 Bracket—Fuel Tank, (2) #7949 Strap—Fuel Tank and #7946 Spacer—Tank Bracket used on this model.
- NOTE 16—#4546-A Cleaner Assembly—Air used in lieu of #4512-A.
- NOTE 17—#4090 Tank Assembly, #7909-A Bracket and Strap and #7910-A Bracket and Strap used on this model.
- NOTE 18—#7956-A Plate—Bearing, #P-5568-A Wire Assembly—Ignition, #P-5573 Lead—Hi-Tension Magneto and #5577 Clamp—Hi-Tension Lead used on this model.
- NOTE 19—Use #3136 Oil Seal in place of #3026.
- NOTE 20—Use #4429 Oil Seal in place of #3026.
- NOTE 21—Use #7919-A Bearing Plate with Shorting Wire.
- NOTE 22—Use #4521 Muffler.
- NOTE 23—Use #4205 Yoke and Weight Assembly.
- NOTE 24—Use #7963-A Bearing Plate, #5715-A Wire Assembly (Ignition Shorting), #P-5566 Grommet, and #5644 Screw.
- NOTE 25—Use #4017 Guard (Belt) and #3221-G Screw.
- NOTE 26—Use #5053 Connector.
- NOTE 27—Use #16336 Governor Spring.
- NOTE 28—Use #7964-A Bearing Plate, #P-5573-A High Tension Lead, #P-5575-A Spark Plug Cup Assembly, #P-5576 Spark Plug Cover and #5647 Screw.
- NOTE 29—Use Fuel Pump Parts List, Sec. III.
- NOTE 30—Refer to L/P Gas Parts List, Sec. III.
- NOTE 31—Kerosene Conversion: Use #6190 Cylinder Head, #3576 Nipple, #4584 Valve (3-way), and #4585 Priming Cup.
- NOTE 32—Use #6190 Cylinder Head (stocked by factory only).
- NOTE 33—Use Kerosene Parts: #6190 Head, #3576 Nipple, #4525 Tee, #4527 Cup.
- NOTE 34—Use #6014 Bracket.
- NOTE 35—Use #3031-3 Valve—Exhaust (Stellite) and #3994 Insert Valve Seat. Use Std. Exhaust Valve in Intake.
- NOTE 36—Use #12089 Cover—Fuel Pump Pad, #12250 Gasket, #3205-G Screw & Lockwasher Assembly (2), #3221-G Screw and Lockwasher (2).
- NOTE 37—Use #12313-A Housing Ass'y, #12315 Spacer for Needle Bearing Governor.
- NOTE 38—Use #4500 Muffler.
- NOTE 39—Use #12062-A Muffler.