

S E R I E S  
**A-2100-2000**  
 G E M

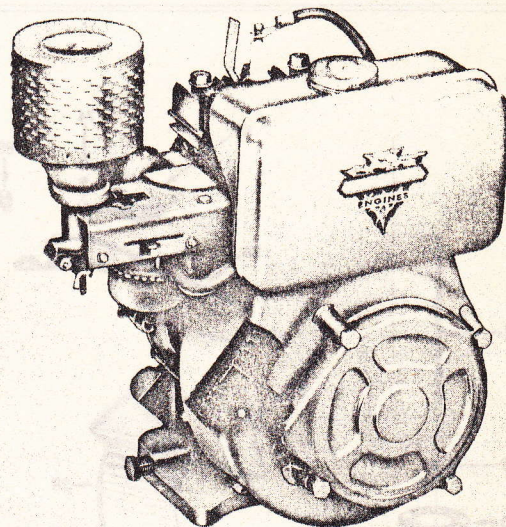
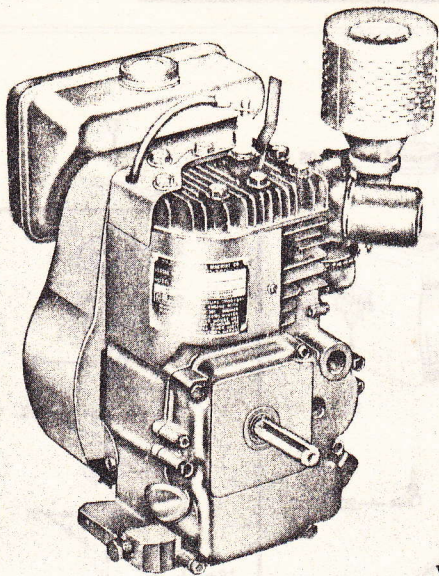

A Wide Range of Models are Made By

**CLINTON**

For Farm, Home and Industrial Use

**ENGINES**

A-2100-2000

H.P.	R.P.M.	H.P.	R.P.M.
1.05	1800	2.07	3000
1.65	2400	2.25	3600

## GENERAL SPECIFICATIONS

Model	Type	Description	Starter	Weight
A-2100-2000	Air-Cooled	Horizontal Shaft	Rope	21½ lbs.
A-2100-2000	Air-Cooled	Horizontal Shaft	Recoil	23 lbs.

**BORE:** 2⅝"

**STROKE:** 1⅝"

**TYPE:** Single cylinder, L-Head, air-cooled, horizontal shaft.

**AIR COOLING:** Large capacity, curved vane blower cast integral with flywheel. Air passes through deep fins to maintain correct operating temperature, rotating blower screen.

**PISTON DISPLACEMENT:** 7.2 cu. inches.

**IGNITION:** Very high voltage, built-in flywheel magneto for faster starting. Moisture and dust-proof with fully enclosed ignition points. Positive safety ON-OFF device on spark plug.

**SPARK PLUG:** 14 mm.

**LUBRICATION:** Splash type. Oil drainage permitted from either side of the base.

**CARBURETOR:** Full float feed with idle and high speed adjustment.

**GOVERNOR:** Adjustable pneumatic type. Available with Carburetor Shroud with variable speed control.

**MAIN BEARINGS:** Bronze.

**CRANKSHAFT:** Ductile iron. Counterweights and cam drive gear integral with shaft.

**CONNECTING ROD:** I-Beam, aluminum alloy with extra large bearings.

**PISTON:** Aluminum alloy, Clinton-engineered for efficient combustion.

**PISTON RINGS:** Two compression and one oil control. Treated surfaces.

**VALVES:** Steel. Exhaust valve provided with heat-resistant alloy head.

**VALVE SEATS:** Alloy inserts.

**VALVE TAPPETS:** Hardened and ground.

**CYLINDER AND CRANKCASE:** Die cast cylinder block and crankcase with large amount of cooling area for cool operation. A close-grained cast iron liner is die cast in block.

**CYLINDER HEAD:** Aluminum, with extra deep cooling fins, removable.

**VACUUM BREATHER:** Maintains vacuum in crankcase and prevents oil leaks.

**OIL FILLER:** Conveniently located for easy check of oil level and for filling.

**AIR CLEANER:** Heavy duty, automotive, dry type.

**FUEL TANK:** One-quart capacity, with gasoline strainer.

**OIL RESERVOIR:** 1¼ pints capacity.

**DIRECTION OF ROTATION:** Counterclockwise, viewed from power take-off shaft side.

**FINISH:** Red heat-resisting enamel. Other colors available upon special order.

### STANDARD EQUIPMENT

Standard equipment includes: Muffler, splash-proof fuel tank cap and starting rope.

### SPECIAL EQUIPMENT

Special equipment includes: Remote throttle cable and controls, recoil starter, Touch 'N' Go throttle control, shorting terminal for remote stop hookup, commercial ignition shielding, deluxe mufflers, special paint finishes, oil bath air cleaner, resistor spark plug, valve guide inserts, Stellite valves, impulse starter. (Quotations available on request.)



WORLD'S LARGEST MANUFACTURER OF A COMPLETE LINE OF AIR-COOLED GASOLINE ENGINES

**CLINTON ENGINES PROVIDE POWER**

FOR FARM • HOME • INDUSTRIAL EQUIPMENT

PRINTED IN U.S.A.

# CLINTON

S E R I E S  
**A-2100-2000**  
**A-2190-2000**  
G E M

BASIC  
TYPE

SEC. II. DIV. A-2100-2000  
PARTS CATALOG  
Revised May, 1961  
Supersedes Dec., 1959

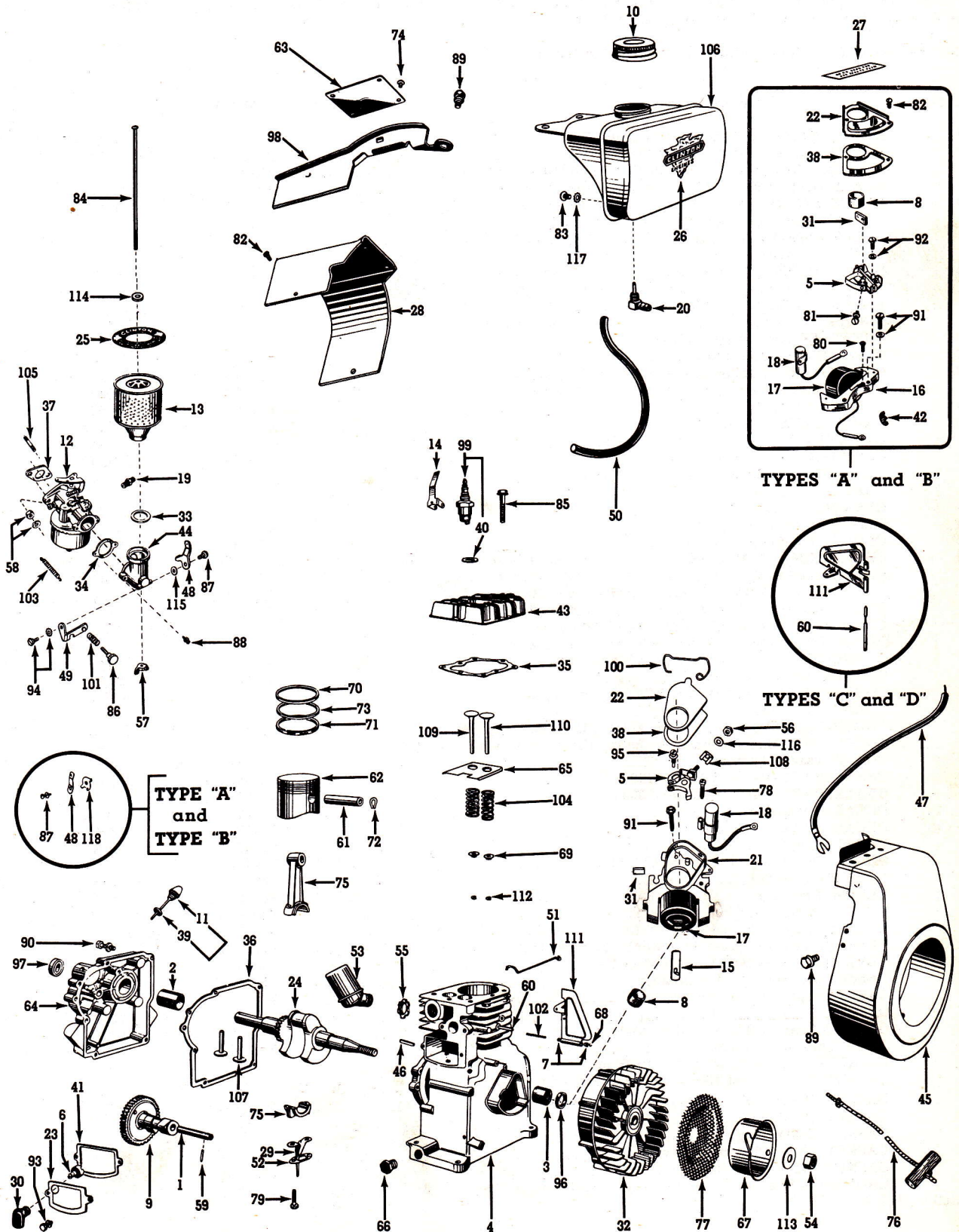

SEC. II, DIV. A-2100-2000  
PARTS CATALOG  
Revised May, 1961  
Supersedes Dec., 1959

**S E R I E S**  
**A-2100-2000**  
**A-2190-2000**  
**G E M**

**BASIC**  
**TYPE**      **CLINTON**

There are Six Basic Types of the A2100-2000 and A2190-2000 Series Engines covered by this Basic Parts List. Parts not used on all types are noted. These types are shown as follows: Serial Number Suffix "A"-referred to as Type A, Serial Number Suffix "B"-referred to as Type B, Serial Number Suffix "C"-referred to as Type C, etc.

NOTE: See page "a" on "How to Identify Your Clinton Engine."

Ref. No.	Part Description	IBM NO.	Part No.	Quan.
1	AXLE ASSEMBLY-Camshaft (Includes Pin) .....	6-5-5	21310-A	1
2	BEARING-Sleeve (Plate Assembly) .....	20-56	21016	1
	BEARING-Ball (Not Illustrated)(Used on A2190-2000) .....	20-4	3670	1
3	BEARING-Main Sleeve (Cylinder Block-Service) .....	20-58	90278	1
4	BLOCK-ASSEMBLY-Cylinder (Used on Types A&B) .....	22-167-5	31201-A	1
	NOTE: Assembly incl. Ref. Nos. 3 and 96 .....			
	*BLOCK ASSEMBLY-Cylinder (Used on Types C, D, E&F) .....	22-719-5	92018-A	1
	NOTE: Assembly incl. Ref. No. 96 .....			
5	BREAKER POINTS ASSEMBLY-Used on Types A&B .....	P135-130-5	P5543	1
	NOTE: Assembly incl. Ref. Nos. 31, 81 and 92. ....			
	BREAKER POINTS ASSEMBLY-Used on Types C, D, E&F .....	P135-6-5	P5735	1
	NOTE: Assembly incl. Ref. Nos. 30, 55, 94 and 115. ....			
6	BREATHER ASSEMBLY .....	260-13	6354	1
7	BUSHING-Air Vane (Used on Types A and B) .....	28-1	7239	2
8	CAM-Magneto Braaker (Used on Types A & B) .....	157-26	5707	1
	CAM-Magneto Breaker (Used on Types C, D, E&F) .....	157-29	5751	1
9	CAMSHAFT .....	6-17	21008	1
10	CAP & GASKET ASSEMBLY-Fuel .....	45-89-5	4517-A	1
11	CAP & GASKET ASSEMBLY-Oil Filler .....	45-110-5	21074-A	1
12	CARBURETOR ASSEMBLY-Clinton .....	P39-194-99	P14362	1
	For Complete Identification of Carburetors, Refer to Sec III, Div. A, Page 2.			
13	CLEANER ASSEMBLY-Air .....	2-9-5	4546-A	1
14	CLIP-Ignition Shorting .....	266-28	3499	1
15	CLIP-Coil Holding (Used on Types C and D) .....	P81-20	P5743	1
16	COIL ASSEMBLY-Magneto (With Laminations) (Used on Types A&B) .....	P135-20-5	P5593-B	1
17	COIL-Magneto (Without Laminations)(Used on Types A&B) .....	P135-23-5	P5593-A	1
	COIL-Magneto (Without Laminations)(Used on Types C, D&E) .....	P135-215	P5733-A	1
	*COIL-Magneto (Without Laminations)(Used on Type F) .....	P135-13-5	P5770	1
18	CONDENSER-Magneto (Used on Types A and B) .....	P135-30-5	P5599-A	1
	CONDENSER-Magneto (Used on Types C, D, E & F) .....	P135-29-5	P5589-A	1
19	CONNECTOR-Flexible Fuel Line (Carburetor) .....	69-5	5053	1
20	CONNECTOR-Hose Connecting .....	69-25	5054	1
21	CORE & BREAKER BOX COVER-Used on Types C, D, E&F .....	P135-37-5	P5732	1
	NOTE: Includes Ref. No. 15			
22	COVER-Dust (Magneto Breaker Points)(Used on Types A&B) .....	45-17	10382	1
	COVER-Dust (Magneto Breaker Points)(Used on Types C, D, E&F) .....	P45-15	P5743	1
23	COVER-Valve Chamber .....	45-82	10324	1
24	CRANKSHAFT-Used on A2100-2000 .....	46-353	21100-1	1
	CRANKSHAFT Used on A2190-2000 .....	46-354	21110-1	1
25	DECAL-Air Cleaner .....	58-21	4561	1
26	DECAL-Arrowhead .....	58-25	90559	2
27	DECAL-Horsepower .....	58-56	90493	1
28	DEFLECTOR ASSEMBLY-Air Cylinder .....	259-56	90504	1
29	DISTRIBUTOR-Oil .....	220-16	21383	1
30	ELBOW-Breather .....	69-23	90610	1
31	FELT-Lubrication (Cam Follower) .....	P135-41	P5504	1
	(Used on Types A and B)			
	FELT-Lubrication (Cam Follower) (Used on Types C, D, E&F) .....	P94-189	P5742	1
32	FLYWHEEL ASSEMBLY-With Magnets .....	83-10-5	5752-A	1
33	GASKET-Air Horn to Air Cleaner .....	94-11	10259	1
34	GASKET-Air Horn to Carburetor .....	94-13	31445	1
35	GASKET-Cylinder Head .....	94-40	10253	1
36	GASKET-Bearing Plate .015 Standard .....	94-107	10254	1
	Available in .010 size .....	93-107	10254-1	1
37	GASKET-Asbestos (Carburetor to Block) .....	94-31	6002	1
38	GASKET-Cover, Dust (Breaker Points) (Used on Types A and B) .....	94-29	10250	1
	GASKET-Cover, Dust (Breaker Points)(Used on Types C, D, E&F) .....	P94-241	P5744	1
39	GASKET-Oil Filler Cap .....	94-81	3297	1
40	GASKET-Spark Plug .....	94-90	3115	1
41	GASKET-Valve Chamber Cover .....	94-103	10251	1
	GASKET KIT-Engine Overhaul .....	149-361	91562	1
42	GROMMET-Magneto (Breaker Lead Wire)(Used on Types A&B) .....	70-13	10367	1

# CLINTON

S	E	R	I	E	S
<b>A-2100-2000</b>					
<b>A-2190-2000</b>					
<b>G E M</b>					

**BASIC  
TYPE**

**SEC. II. DIV. A-2100-2000  
PARTS CATALOG**  
Revised May, 1961  
Supersedes Dec., 1959

43	HEAD-Cylinder .....	122-7	10011	1
44	HORN-Air .....	69-54	21350	1
45	HOUSING ASSEMBLY-Blower (Used on Types A, B, C&D) .....	259-152	21013-F	1
46	KEY-Flywheel .....	148-4	10339	1
47	LEAD-Hi-Tension, Magneto (Used on Types A&B) .....	P307-187	P2055	1
	LEAD-Hi-Tension, Magneto (Used on Types C, D,E&F).....	P307-190	P5555	1
	*LEAD-Hi-Tension, Magneto (Used on Type F).....	P307-194-99	P90761	1
48	LEVER-Speed Adjusting (Used on Types A&B) .....	157-79	4441	1
	LEVER-Speed Adjusting (Used on Types C, D, E&F) .....	157-83	90584	1
49	LEVER ASSEMBLY-Speed Regulating (Used on Types C, D, E&F).....	157-120-5	90585-A	1
50	LINE-Fuel, Flexible .....	158-25	6316	1
51	LINK-Carburetor to Air Vane (Used on Type A) .....	159-16	21020	1
	LINK-Air Vane (Used on Types B, C, D, E&F) .....	159-21	31402	1
52	LOCK-Connecting Rod Screw .....	148-13	31018	1
	MAGNETO ASSEMBLY-Used on Types C, D&E) .....	P258-4-5	P5731	1
	NOTE: Assembly incl. Ref. Nos. 5, 15, 17, 18, 21, 22, 31, 38, 56, 78, 91, 95, 100, 108 and 116.			
	*MAGNETO ASSEMBLY-Used on Type F.....	P258-17-5	P91740	1
	NOTE: Assembly incl. Ref. Nos. 5, 15, 17, 18, 21, 22, 31, 38, 56, 78, 91, 95, 100, 108 and 116.			
53	MUFFLER-45° Inlet .....	170-18	4500	1
54	NUT-Hex. 1/2-20 (Starter Pulley).....	183-68-99	5942	1
55	NUT-Lock, Muffler .....	183-37	4425	1
56	NUT-Terminal Condenser Lead (Used on Types C, D, E&F).....	P183-21	P5740	1
57	NUT-Wing (Air Cleaner) .....	183-66	7044	1
58	NUT & L'WASHER ASS'Y-1/4-28 Hex. (Carburetor Mounting).....	183-29-5	3255-A	2
59	PIN-Camshaft Axle .....	203-20	10392	1
60	PIN-Pivot, Air Vane Governor (Used on Types A&B).....	203-32	7238	1
	PIN-Governor Vane Pivot (Used on Type C).....	203-33	10015	1
	PIN-Governor Vane Pivot (Used on Types D, E&F) .....	203-91	90982	1
61	PIN-Wrist .....	203-63	6024	1
62	PISTON ASSEMBLY-Standard .....	204-13-5	31001-A	1
	NOTE: Piston Assemblies are available in the following oversizes: IBM Part Number Oversize Listed	.005...	205-13-5	31001-A (.005)
	Order by Part No. and specify oversize.	.010...	206-13-5	31001-A (.010)
		.020...	207-13-5	31001-A (.020)
		.030...	208-13-5	31001-A (.030)
		.040...	209-13-5	31001-A (.040)
	NOTE: Piston Assembly includes Ref. Nos. 61, 70, 71, 72 and 73.			
63	PLATE-Name .....	58-105	6530	1
64	PLATE ASSEMBLY-Bearing (Used on A2100-2000) .....	215-52-5	10047-A	1
	NOTE: Assembly includes Ref. Nos. 2			
	PLATE ASSEMBLY-Bearing (Used on A2190-2000).....	215-54	10049	1
65	PLATE-Valve Spring Retainer .....	215-136	10013	1
66	PLUG-1/4 N. P. T. (Oil Drain).....	216-19	3289	2
67	PULLEY ASSEMBLY-Starting .....	219-17	12397	1
68	RETAINER-Air Vane (Used on Types A&B) .....	232-5	4430	1
69	RETAINER-Valve Spring .....	304-135	3028	2
70	RING-Compression, Standard (Order Ring Set) .....	233-4-99	6026	1
71	RING-Oil, Standard (Order Ring Set).....	233-14-99	6006	1
72	RING-Retainer, Wrist Pin .....	232-41	6034	2
	RING-Retainer Bearing Hold Down (Not Illustrated)(Used on A2190-2000) ..	232-29	21328	1
	RING-Ball Bearing to Crankshaft (Not Illustrated)(Used on A2190-2000) ..	232-30	21329	1
73	RING-Scraper, Standard (Order Ring Set) .....	233-19-99	6027	1
	RING SET-Standard .....	149-10	10023	1
	NOTE: Ring Sets are also available in the following oversizes: IBM Part No. Oversize Listed	.005 ..	149-157	10023 (.005)
	Order by Part No. and specify oversize.	.010 ..	149-158	10023 (.010)
		.020 ..	149-159	10023 (.020)
		.030 ..	149-160	10023 (.030)
		.040 ..	149-161	10023 (.040)
	NOTE: Ring Set includes Ref. Nos. 70, 71 and 73.			
74	RIVET-Tubular (Name Plate) .....	244-21	5460	4
75	ROD ASSEMBLY-Connecting (Includes Ref. Nos. 52 and 79).....	149-121	10002-A	1
76	ROPE ASSEMBLY-Starter .....	246-13-5	4266	1
77	SCREEN-Rotating .....	257-2-5	90092	1
78	SCREW-R. H. S. T., 8-32x4/5(Condenser to Plate) .....	P258-299	P5741	1
	(Used on Types C, D, E and F)			
79	SCREW-H. H. C., 1/4-20x1 1/4 (Connecting Rod Cap).....	258-9	3235	2
80	SCREW-P. H. S. T., #6-32x1/4(Coil to Laminations)(Used on Types A&B)	258-71	5641	1

**SEC. II. DIV. A-2100-2000**  
**PARTS CATALOG**  
 Revised May, 1961  
 Supersedes Dec., 1959

**S E R I E S**  
**A-2100-2000**  
**A-2190-2000**  
**G E M**

**BASIC**  
**TYPE**      **CLINTON**

81	SCREW-R. H. M. , #6-32x1/4 (Breaker Points Terminal)(Used on Types A&B) .	258-95	5664	1
82	SCREW-H. H. Slotted S. T. , #8-32x3/8(2-Deflector to Block)(2-Breaker . . . . . Points Cover)(Used on Types A & B)	258-81	5644	4
83	SCREW-R. H. M. , #10-24x1/4(Blower Housing to Fuel Tank)(Used on Types. . . A, B, C&D)	258-80	5643	2
84	SCREW-R. H. M. , #10-23x6 1/4(Air Cleaner to Air Horn) . . . . .	258-72	5636	1
85	SCREW-H. W. H. , 5/16-18x1 7/8(Cylinder Head to Block) . . . . .	258-88	5654	8
86	SCREW-Knurled#8-32x7/8(Speed Regulating) . . . . .	258-152	5863	1
87	SCREW-Shoulder, 10-32x3/8"(Lever, Speed Adjusting) . . . . .	258-205	4440	1
88	SCREW-R. H. M. , #8-32x11/16 (Air Horn to Carb.) . . . . .	258-105	5677	2
89	SCREW & L'WASHER ASS'Y-H. H. C. , 1/4-20x1/2 (Blower Hsg. to Block) . . .	258-280-5	3205-G	2
90	SCREW & L'WASHER ASS'Y-H. H. C. , 1.4-20x1 1/4 . . . . . (Bearing Plate to Block)	258-284-5	5613-G	7
91	SCREW & L'WASHER ASS'Y-H. H. C. , #10-24x1 (Laminations to Block) . . . . .	258-108-5	5682-A	2
92	SCREW & L'WASHER ASS'Y-R. H. M. , #6-32x5/16(Breaker Points to Block) . . (Used on Types A & B)	258-41-5	5444-F	1
93	SCREW & L'WASHER ASS'Y-H. H. C. , #10-24x1/2 (Valve Chamber Cover) . . . .	258-82-5	5645-A	2
94	SCREW & L'WASHER ASS'Y-H. H. S. T. , #10-32x3/8 (Speed Regulators) . . . . . (Used on Types C and D)	258-272-5	5838-A	1
95	SCREW & L'WASHER ASS'Y-R. H. M. , #8-32x3/8 (Breaker Points to . . . . . Breaker Box) (Used on Types C, D, E&F)	P258-297-5	P5737	1
96	SEAL-Oil (Block) . . . . .	94-178	10012	1
97	SEAL-Bearing Plate Assembly (Used on A2100-2000) . . . . .	94-162	3026	1
98	SEAL-Oil (Used on A2190-2000) . . . . .	94-166	3764	1
98	SHIELD-Flywheel . . . . .	259-318	90502	1
99	SPACER-Oil Seal(Not Illustrated)(Used on A2190-2000) . . . . .	232-36	6189	1
99	SPARK PLUG AND GASKET ASSEMBLY (H-10 ) . . . . .	K267-28-5	K16303-A	1
100	SPRING-Breaker Box Cover (Used on Types C, D, E&F) . . . . .	P263-10	P5745	1
101	SPRING-Compression (Knurled Screw) (Used on Types C, D, E&F) . . . . .	263-34	90586	1
102	SPRING-Compression (Air Vane)(Used on Types A and B) . . . . .	263-28	10005	1
103	SPRING-Air Governor (Used on Type A) . . . . .	263-48	10336	1
103	SPRING-Air Governor (Used on Types B, C, D, E&F) . . . . .	263-73	90842	1
104	SPRING-Valve . . . . .	263-92	3068	2
105	STUD-Carburetor Mounting . . . . .	24-11	5659	2
106	TANK ASSEMBLY-Fuel (Used on Types A, B, C&D) . . . . . (Used on Type A, B, C&D)	277-74-5	21380-A	1
107	*TANK & BLOWER HOUSING ASSEMBLY(Used on Types E&F)(Incl. Ref. No. 10)	259-523-5	21001-B	1
107	TAPPET-Valve . . . . .	278-5	10009	2
108	TERMINAL-Jamtite Breaker Points (Used on Types B, C, D, E&F) . . . . .	P307-230	P5738	1
109	VALVE-Exhaust . . . . .	291-8	10301	1
109	VALVE-Exhaust .010 Oversize . . . . .	292-6	10321	1
110	VALVE-Intake . . . . .	291-7	10302	1
110	VALVE-Intake, .010 Oversize . . . . .	292-7	10322	1
111	VANE-Air Governor (Used on Types A and B) . . . . .	107-12	10393	1
111	VANE-Air Governor (Used on Type C) . . . . .	107-11	10014	1
111	VANE-Air Governor (Used on Types D, E&F) . . . . .	107-30	91033	1
112	WASHER-"C" Valve Keeper . . . . .	304-9	3291	2
113	WASHER-Starter Pulley . . . . .	304-132	5941	1
114	WASHER-Rubber (Screw to Air Cleaner) . . . . .	304-136	5906	1
115	WASHER-Speed Adjusting (Used on Types C, D, E&F) . . . . .	304-88	3279	1
116	WASHER-Terminal Condenser Lead (Used on Types C, D, E&F) . . . . .	P304-290	P5739	1
117	WASHER-Lock (Blower Housing to Fuel Tank)(Used on Types A, B, C&D) . . .	304-7	5900	2
118	WASHER-Lock, Spring Tension, Speed Regulating(Used on Types A & B) . . .	304-147	21305	1

\* Indicates New Parts Listed For The First Time.

# CLINTON

# S E R I E S A-2100-2000 G E M

## MODEL VARIATIONS

SEC. II, DIV. A-2100-2000  
PARTS CATALOG  
Revised June, 1960  
Supersedes Feb., 1960

## MODEL VARIATIONS OF A-2100-2000 SERIES

The adaptation of Clinton Engines to a wide variety of uses results in what is known as "Model Variations." Following is the complete list of all Models produced up to issue date (shown above). Opposite each Engine Model listed are the Part Numbers and/or Assembly Numbers for the Series used IN ADDITION TO or IN PLACE OF the parts illustrated and shown on the Basic Parts List preceding this Model Variations List. Refer to other sections of this Manual when Assembly Numbers are given to find the Parts List for these assemblies.

See page (a) on "How to Identify Your Clinton Engine." Use the preceding Basic Parts List except as shown below.

**ENGINE MODEL**—See page (a), "How to Identify Your Clinton Engine."

**FOOTNOTES** (Check page two).

**BASE—ENGINE** (Part Numbers Shown). Refer to Sec. IV, Div. A for further information.

**BLOCK ASSEMBLY — CYLINDER** (Part Number Shown). Refer to Illustrated Basic Parts List for corresponding part.

**CRANKSHAFT** (Part Numbers Shown). Refer to Sec. IV, Div. B for details and further information.

**BEARING—MAIN** (Part Numbers Shown). Refer to Illustrated Basic Parts List for corresponding part.

**CONTROL GROUP** (Control Group Illustration Numbers Shown). Refer to Sec. III, Div. D for Parts List.

**CONTROL CABLE LENGTH** — Replace ment cable is furnished in 72" length ONLY, cut to length shown.

**PLATE ASSEMBLY — BEARING** (Part Numbers Shown). Refer to Illustrated Basic Parts List for corresponding part.

**MUFFLER OR MANIFOLD** (Part Numbers Shown). Refer to Illustrated Basic Parts List for corresponding part.

**STARTER — RECOIL**. Refer to Sec. III, Div. H for Parts List.

**HOUSING ASSEMBLY — BLOWER** (Part Numbers Shown). Refer to Basic Parts List for corresponding part.

**REDUCTION GEAR** (Assy. Nos. Shown). Refer to Sec. III, Div. C for Parts List.

**MOUNTING POSITION** — "Clock" position shows mounting of reduction unit in relation to Crankshaft.

A-2100-2000	NO VARIATION—USE BASIC PARTS LIST								
A-2100-2100		21117							
A-2100-2101	NO VARIATION—USE BASIC PARTS LIST								
A-2100-2102							P90996	21013-F	
A-2100-2103		21102-1	21016	SK-560	72"	10048-A	P90996	21013-F	
A-2100-2104	Note 11					10048-A	P90996	21013-F	
A-2100-2105			21016	SK-560	72"	10048-A			
A-2100-2106	Note 1		21016			10048-A			
A-2100-2107			21016			10048-A	P90996	21013-F	
A-2100-2109			21016	SK-560	72"	10048-A	P90996	21013-F	
A-2100-2110							P90996	21013-F	
A-2100-2111		21102-1					P90996	21013-F	
A-2100-2112				SK-560			P90996	21013-F	
A-2100-2113				SK-560	72"		P90996	21013-F	
A-2100-2114							P90996	21013-F	
A-2100-2115			21016			10048-A			
A-2100-2116	Note 3		21016	SK-560	72"	10048-A			
A-2100-2117				SK-560	58"				
A-2100-2118							P90996	21013-F	
A-2100-2119	NO VARIATION—USE BASIC PARTS LIST								
A-2100-2120	NO VARIATION—USE BASIC PARTS LIST								
A-2100-2121	NO VARIATION—USE BASIC PARTS LIST								
A-2100-2122							P90996	21013-F	
A-2100-2123	Note 3						P90996	21013-F	
A-2100-2124	Note 5					10048-A	P90996	21013-F	
A-2100-2125	Note 6						P90996	21013-F	
A-2100-2126	Note 8								
A-2100-2127		21102-1					P90996	21013-F	
A-2100-2128	Note 5			SK-560	72"				
A-2100-2129						10048-A	P90996	21013-F	
A-2100-2131							6343		
A-2100-2132		21102-1		SK-560			P90996	21013-F	
A-2100-2133	Note 3					10048-A			
A-2100-2134	Note 12	21302					C6362	21001-B	
A-2100-2135				SK-560			P90996	21013-F	
A-2100-2136	Notes 1 & 13								
A-2100-2137						10048-A	P90996	21001-B	
A-2100-2138	Note 13			SK-560		10048-A	P90996	21001-B	
A-2100-2139	Notes 3, 13, 15			SK-560			P90996	21013-F	
A-2120-2000	Note 2	21111-1						3552	9:00
A-2120-2100	Notes 1 & 2	21111-1					P90996	21013-F	3552 9:00

**MODEL VARIATIONS OF A-2100-2000 SERIES (Cont.)**

ENGINE MODEL	FOOTNOTES	BASE—ENGINE	BLOCK ASSEMBLY—CYLINDER	CRANKSHAFT	BEARING—MAIN	CONTROL GROUP	CONTROL CABLE LENGTH	PLATE ASSEMBLY—BEARING	MUFFLER OR MANIFOLD	STARTER—RECOIL	HOUSING ASSEMBLY—BLOWER	REDUCTION GEAR	MOUNTING POSITION
A-2140-2000	Note 2			21104-1								3554	9:00
A-2160-2000	Note 2			21106-1								3800	9:00
A-2160-2100	Note 2			21106-1						P90996	21013-F	3800	9:00
A-2160-2101	Note 2			21106-1								3800	9:00
A-2160-2102	Notes 2 & 5			21106-1			72"			P90996	21013-F	3800	9:00
A-2160-2103	Note 2			21106-1								3800	12:00
A-2160-2104	Note 2			21106-1		SK-560	72"			P90996	21013-F	3800	6:00
A-2160-2105	Note 2			21106-1		SK-560				P90996	21013-F	3800	9:00
A-2160-2106	Note 2			21106-1		SK-560						3800	9:00
A-2160-2107	Note 2			21106-1		SK-560	72"			P90996	21001-B	3800	3:00
A-2190-2000	Note 4			21110-1	3670			10049					
A-2190-2100	Note 4			21107-1	3670			10049					
A-2190-2101	Note 4			21112-1	3670			10049					
A-2190-2102	Note 4			21109-1	3670			10049					
A-2190-2103	Note 4			21110-1	3670			10049		P90996	21013-F		
A-2190-2104	Notes 4 & 7			21107-1	3670			10059			21000-A		
A-2190-2105	Note 4			21110-1	3670			10059					
A-2190-2106	Note 4			21107-1	3670			10049					
A-2190-2108	Note 4			21107-1	3670			10049		P90996	21013-F		
A-2190-2109	Notes 4, 9, 10			21107-1	3670			10049			21000-A		
A-2190-2110	Notes 1, 4, 14			21110-1	3670			10049		P90996	21001-B		
A-2190-2111	Note 4			21112-1	3670			10049		P90996	21013-F		
A-2190-2112	Note 4			21110-1	3670			10049					
A-2190-2113	Notes 4, 8, 10			21115-1	3670			10049		P90996	21013-F		
A-2190-2114	Notes 4 & 14		31218-A	21115-1	3670			10049					
A-2190-2115	Notes 4 & 8			21110-1	3670			10049					
A-2190-2116	Notes 4 & 13			21110-1	3670			10049		P90996	21013-F		
A-2190-2118	Note 4			21110-1	3670			10049					
A-2190-2119	Note 4			21110-1	3670	SK-560		10049		P90996	21001-B		
A-2190-2120	Note 4			21107-1	3670			10049					
A-2190-2122	Notes 1, 4, 13			21110-1	3670			10049					
A-2190-2123	Notes 4, 8, 14		31218-A	21110-1	3670			10049					
A-2190-2124	Notes 1, 4, 13			21110-1	3670			10049		P90996	21013-F		
A-2190-2125	Notes 1 & 4			21110-1	3670	SK-560	72"	10049					
A-2190-2128	Notes 1, 4, 6			21107-1	3670	SK-560		10049					
A-2190-2129	Note 4			21110-1	3670	SK-560		10049		P90996	21001-B		
A-2190-2130	Note 4			21110-1	3670			10049					
A-2190-2132	Notes 1, 4, 6			21110-1	3670			10049		P90996	21001-B		
A-2190-2133	Notes 4 & 11			21110-1	3670	SK-560	72"	10049					
A-2190-2134	Note 4			21110-1	3670	SK-560	72"	10049		P90996	21001-B		

- NOTE 1—Use 4512-A Air Cleaner in lieu of 4546.  
 NOTE 2—Use 3136 Seal (Oil) in lieu of 3026, 91561 Gasket Kit.  
 NOTE 3—Use 12409-A Wire Assembly (Shorting), 5566 Grommet, 5644 Screw, 5522 Nut (Additional Parts).  
 NOTE 4—Use 21328 Ring (Retainer), 6189 Spacer (Oil Seal), 21329 Ring Retainer, and 3764 Seal (Oil).  
 NOTE 5—Use 21376-A Bracket (Remote Control), 5909 L'Washer, 4448 Stop (Throttle Lever), 21375-A Lever Ass'y., 5681 Screw.  
 NOTE 6—Use 5051 Valve (Fuel Shut-Off).  
 NOTE 7—Use 31512 Insert (Exhaust only), 21301 Valve (Exhaust, Stellite), 12368-A Tank Ass'y, 21352 Bracket, 7943 Strap (2), 4584 Valve, 5051 Valve (Fuel Shut-Off), 5052 Connector (2), 5053 Connector, 3576 Nipple, 10312 Head. This unit uses kerosene.  
 NOTE 8—Use 6452 Horn (Air), 4441 Lever (Speed Adj.), 21305 Washer (Spring Tension), 4557-A Cleaner Ass'y (Air).  
 NOTE 9—Use 12368-A Tank Ass'y (Fuel), 21352 Bracket (Fuel Tank), 4584 Valve, 5051 Valve, 5053 Connector, 5052 Connector, 3576 Nipple, 10312 Head. This unit uses kerosene.  
 NOTE 10—Use 31512 Insert (Valve Seat Exhaust Side Only), 21301 Valve (Exhaust, Stellite). The standard exhaust valve is to be used as the intake valve.  
 NOTE 11—Use 21351 Horn (Air), 5052 Connector, 4533 Tube (Breather).  
 NOTE 12—Use 4954-A Pulley & Screen Assembly.  
 NOTE 13—Use 10080-A Body Assembly (Muffler), 10075 Nut (Muffler to Block), 10068-A Cover Assembly (Muffler), 5861 Stud (Muffler), 5869 Nut (Wing).  
 NOTE 14—Use 31499 Insert (Valve Seat, Intake), 31512 Insert (Valve Seat, Exhaust).  
 NOTE 15—Use 90788-A Cover (Spark Plug).