

CLINTON

S E R I E S
AV-3100-1000
AV-3100-2000
CLINTALLOY

BASIC
TYPE

SEC. II, DIV. AV-3100-1000
AV-3100-2000
PARTS CATALOG
Revised May, 1961
Supersedes Dec., 1959

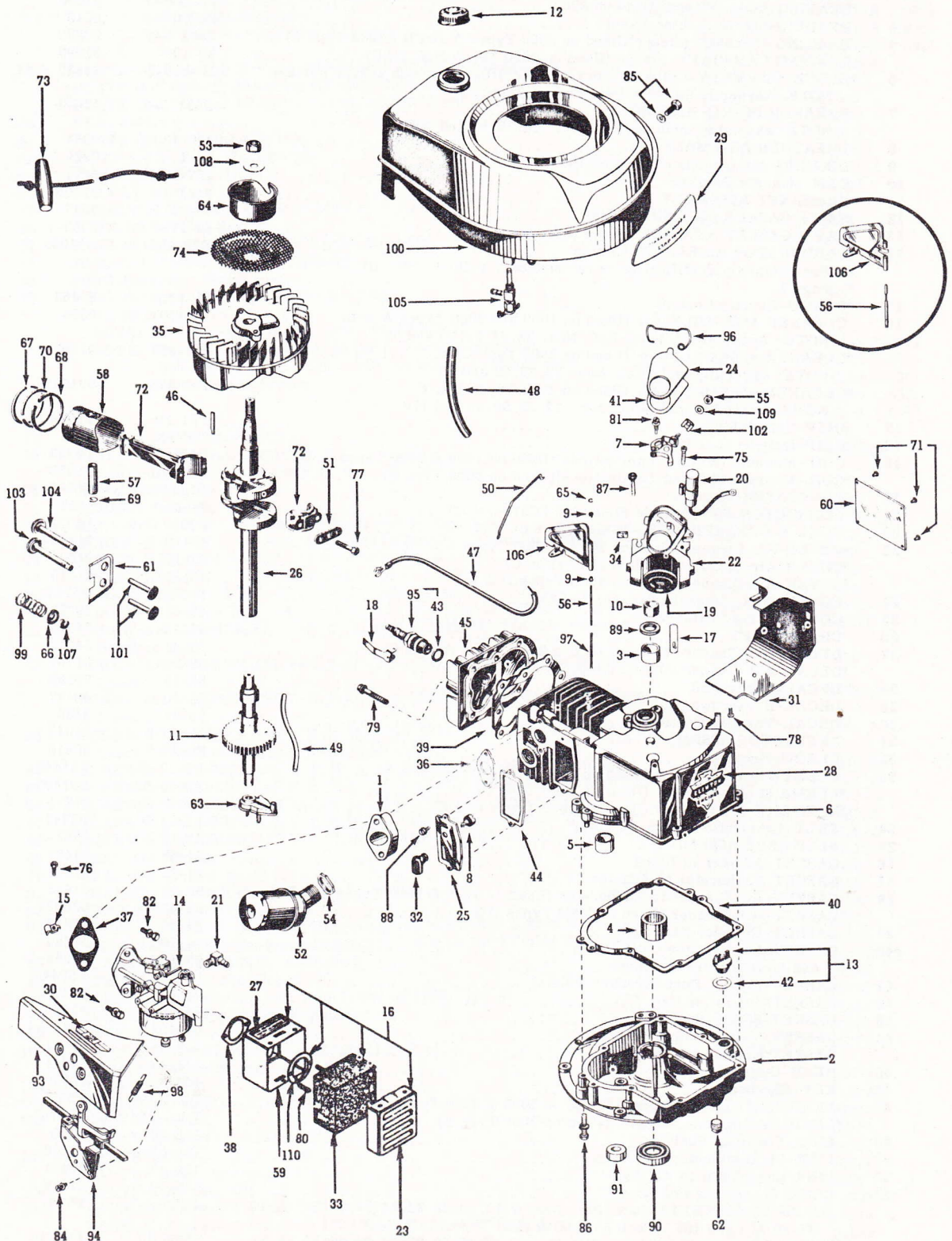

CLINTON ENGINES CORPORATION

MAQUOKETA, IOWA

PRINTED IN U.S.A.

There are five Basic Types of the AV3100-1000 and AV3100-2000 Series Engine covered by this Basic Parts List. Parts not used on all types are noted. These types are shown as follows: Serial Number Suffix "A"-referred to as Type A; and Serial Number Suffix "B"-referred to as Type B, etc.

NOTE: See page "a" on "How to Identify Your Clinton Engine."

Ref. No.	Part Description	IBM No.	Part No.	Quan.
1	ADAPTER-Carburetor	1-65	12367	1
2	BASE ASSEMBLY-Engine	18-44	31487	1
3	BEARING-Main (Sleeve)(Used on 1000)	20-58	90278	1
	BEARING-Main (Flange)(Used on 2000)	20-206	91098	1
4	BEARING-Sleeve (Engine Base)	20-50	9016	1
5	BEARING-Camshaft (Sleeve)(Used on 1000 Types A and B & 2000 Type A)	20-9	90280	1
	BEARING CAMSHAFT-Flange (Used on 2000 Types B, C, D & E)	20-100	91099	1
6	*BLOCK ASSEMBLY-Cylinder (Service Block)(Used on 1000 & 2000 Series)	22-520-5	91235-A	1
	NOTE: Assembly includes Ref. Nos. 3, 5 and 89.			
7	BREAKER POINTS ASSEMBLY	P135-5-5	P5735	1
	NOTE: Assembly includes Ref. Nos. 34, 55, 81 and 109.			
8	BREATHER ASSEMBLY	260-13	6354	1
9	BUSHING-Air Governor (Used on 1000 Type A)	28-1	7239	1
10	CAM-Magneto Breaker	157-29	5751	1
11	CAMSHAFT ASSEMBLY	6-23	31009	1
12	CAP & GASKET ASSEMBLY-Fuel	45-89-5	4517-A	1
13	CAP & GASKET ASSEMBLY-Oil Filler	45-179	5095-1	1
14	CARBURETOR ASSEMBLY-Clinton	P39-190-99	P14055	1
	For complete identification of carburetors, refer to Sec. III, Div. A, Page 2.			
15	CLAMP-Remote Control	81-13	31463	1
16	CLEANER ASSEMBLY-Air (Used on 1000 and 2000 Types A & B)	149-102	6394	1
	NOTE: Assembly includes Ref. Nos. 22, 33, 59, 80 and 83.			
	*CLEANER ASSEMBLY-Air (Used on 2000 Type C)	149-397	91665	1
	NOTE: Assembly incl. Ref. Nos. 22, 33, 59 and 80.			
	*CLEANER ASSEMBLY-Air (Used on 2000 Types D & E)	149-478	92103	1
	NOTE: Assembly incl. Ref. Nos. 22, 33, 59, 80 and 110.			
17	CLIP-Coil Holding	P81-20	P5734	1
18	CLIP-Ignition Shorting	266-28	3499	1
19	COIL-Magneto (Without Laminations)(Used on 1000 & 2000 Types A, B, C & D)	P135-215	P5733-A	1
	*COIL-Magneto (Without Laminations)(Used on 2000 Type E)	P135-13-5	P5770	1
20	CONDENSER-Magneto	P135-29-5	P5589-A	1
21	CONNECTOR-90° Flexible Fuel Line (Carburetor)	69-24	5052	1
22	CORE & BREAKER BOX ASSEMBLY-Incl. Ref. No. 17	P135-37-5	P5732	1
23	COVER-Air Cleaner (Used on 1000 & 2000 Types A & B)	45-10-5	31446-A	1
	*COVER-Air Cleaner (Used on 2000 Type C)	45-175	91004	1
	*COVER-Air Cleaner (Used on 2000 Types D & E)	45-337	91815	1
24	COVER-Dust, Magneto Breaker Points	P45-15	P5743	1
25	COVER-Valve Chamber	45-81	10323	1
26	CRANKSHAFT	46-484	31324	1
27	DECAL-Air Cleaner (Used on 1000 & 2000 Types A, B & C)	58-20	3461	1
	*DECAL-Air Cleaner (Used on 2000 Types D & E)	58-349	91767	1
28	DECAL-Arrowhead	58-25	90559	1
29	DECAL-Horsepower	58-30	90497	1
30	DECAL-Throttle Control	58-98	3488	1
31	DEFLECTOR ASSEMBLY-Air	258-358	91043	1
32	ELBOW-Breather	69-23	90610	1
33	ELEMENT-Air Cleaner (Used on 1000 & 2000 Types A & B)	P2-17-5	P31442	1
	*ELEMENT-Air Cleaner (Used on 2000 Type C)	P2-99-99	P91100	1
	*ELEMENT-Air Cleaner (Used on 2000 Types D & E)	2-140-99	91791	1
34	FELT-Lubrication, Cam Follower	P94-189	P5742	1
35	FLYWHEEL ASSEMBLY	83-10-5	5752-A	1
36	GASKET-Adapter to Block	94-68	7149	1
37	GASKET-Carburetor to Adapter	94-32	31461	1
38	GASKET-Air Cleaner to Carburetor (Used on 1000 & 2000 Types A, B & C)	94-13	31445	1
	*GASKET-Air Cleaner (Used on 2000 Types D & E)	94-458	92098	1
39	GASKET-Cylinder Head	94-40	10253	1
40	GASKET-Engine Base (.015 thick)	94-107	10254	1
	Available in .010 thickness	93-107	10254-1	1
41	GASKET-Cover, Dust (Breaker Points)	P94-241	P5744	1
42	GASKET-Oil Filler Cap	94-82	5097	1
43	GASKET-Spark Plug	94-90	3115	1
44	GASKET-Valve Chamber Cover	94-103	10251	1
	GASKET KIT-Engine Overhaul	149-361	91562	1
45	HEAD-Cylinder	122-17	31011	1
46	KEY-Flywheel	148-4	10339	1
47	LEAD-Hi-Tension, Magneto (Used on 1000 & 2000 Types A, B, C & D)	P307-190	P5555	1
	*LEAD-Hi-Tension, Magneto (Used on 2000 Type E)	P307-194-99	P90761	1
48	LINE-Flexible, Fuel	158-25	6316	1
49	LINE-Oil Distributor (Oil Pump)	158-53	10390	1
50	LINK-Carburetor to Air Vane	159-18	31491	1
51	LOCK-Connecting Rod Screw	148-12	21318	1
	MAGNETO ASSEMBLY-Incl. Ref. Nos. 7, 17, 19, 20, 22, 24, 34, 41, 55, 75, 81, 87, 96, 102 and 109. (Used on 1000 & 2000 Types A, B, C & D)	P268-4-5	P5731	1
	*MAGNETO ASSEMBLY-Incl. Ref. Nos. 7, 17, 19, 20, 22, 24, 34, 41, 55, 75, 81, 87, 96, 102 and 109. (Used on 2000 Type E)	P268-17-5	P91740	1

52	MUFFLER.....	170-36-5	3639	1
53	NUT-Hex, 1/2-20 (Starter Pulley).....	183-68-99	5942	1
54	NUT-Lock, (Muffler).....	183-37	4425	1
55	NUT-Terminal Condenser Lead.....	P183-21	P5740	1
56	PIN-Pivot, Air Vane Governor (Used on 1000 Type A).....	203-32	7238	1
	PIN-Pivot, Air Vane Governor (Used on 1000 Type B and 2000 Type A)....	203-33	10015	1
	PIN-Pivot, Air Vane Governor (Used on 2000 Types B, C, D&E).....	203-91	90982	1
57	PIN-Wrist.....	203-63	6024	1
58	PISTON ASSEMBLY-Standard.....	204-13-5	31001-A	1
	NOTE: Piston Assembly includes Ref. Nos. 57, 67, 68, 69 & 70.			
	NOTE: Piston Assemblies are available in the following oversizes:	.005	205-13-5	31001-A (.005)
	.005, .010, .020, .030, and .040. Order by Part Number	.010	206-13-5	31001-A (.010)
	and specify oversize.	.020	207-13-5	31001-A (.020)
	IBM Part No. Oversize Listed.	.030	208-13-5	31001-A (.030)
		.040	209-13-5	31001-A (.040)
59	PLATE-Air Cleaner Mounting (Used on 1000 & 2000 Types A & B).....	2-17-5	31444-A	1
	*PLATE-Air Cleaner Mounting (Used on 2000 Type C).....	2-100	91102	1
	*PLATE-Air Cleaner Mounting (Used on 2000 Types D & E).....	2-139	91803	1
60	PLATE-Name.....	58-105	6530	1
61	PLATE-Valve Spring Retainer.....	215-316	10013	1
62	PLUG-3/8 N. P. T. (Oil Drain).....	216-22	5627	1
63	PUMP ASSEMBLY-Oil.....	220-5-5	10385-A	1
64	PULLEY-Starter.....	219-17	12397	1
65	RETAINER-Air Vane (Used on 1000 Type A).....	232-5	4430	1
66	RETAINER-Valve Spring.....	304-135	3028	2
67	RING-Compression, Standard (Order Ring Set).....		6026	1
68	RING-Oil, Standard (Order Ring Set).....		6006	1
69	RING-Retainer, Wrist Pin.....	232-41	6034	2
70	RING-Scraper, Standard (Order Ring Set).....		6027	1
	RING SET-Standard.....	149-10	10023	1
	NOTE: Ring Set includes Ref. Nos. 67, 68 and 70.			
	NOTE: Ring Sets are available in the following oversizes:	.005	149-157	10023 (.005)
	.005, .010, .020, .030, .040. Order by Part Number	.010	149-158	10023 (.010)
	and specify oversize.	.020	149-159	10023 (.020)
		.030	149-160	10023 (.030)
		.040	149-161	10023 (.040)
71	RIVET-Tubular (Name Plate).....	244-21	5460	4
72	ROD ASSEMBLY-Connecting.....	245-102-5	31002-A	1
	NOTE: Assembly includes Ref. Nos. 51 and 77			
73	ROPE ASSEMBLY-Starter.....	246-13-5	4266	1
74	SCREEN-Rotating.....	257-25	90092	1
75	SCREW-R. H. S. T., #8-32x4/5 (Condenser to Plate).....	P258-299	P5741	1
76	SCREW-H. H. S. T., #8-32x1/4 (Shroud to Bracket) (Clamp to Shroud).....	258-477	5892	3
77	SCREW-H. H. C., 1/4-28x1 1/4 (Connecting Rod Cap).....	258-9	3235	2
78	SCREW-H. H. S. T., #8-32x3/4 (Deflector to Block).....	258-81	5644	2
79	SCREW-H. W. H., 5/16-18x1 7/8 (Cylinder Head).....	258-88	5654	8
80	SCREW-H. H. C., 8-32x7/16, Lock Thread (Air Cleaner Plate to Carburetor)	258-131	5812	2
81	SCREW & L'WASHER ASS'Y-O. H. Slotted 8-32x9/16 (Breaker Points to ... Breaker Box)	P258-297-5	P5737	1
82	SCREW & L'WASHER ASS'Y-H. H. C., 1/4-20x1 1/2 (Carburetor to Block, ... Upper)	258-238-5	5410-G	1
	SCREW & L'WASHER ASS'Y-H. H. C., 1/4-20x1 3/4 (Carburetor to Block, ... Lower)	258-275-5	5878-G	1
83	SCREW & L'WASHER ASS'Y-R. H. M., #10-32x3/8 (Air Cleaner Cover to ... Bracket)(Used on 1000 and 2000 Types A&B)	258-6-5	3216-A	1
84	SCREW & L'WASHER ASS'Y-H. H. C., 8-32x3/8(Bracket to Carburetor) . .	258-81-5	5644-A	2
85	SCREW & L'WASHER ASS'Y-H. H. C., 1/4-20x5/8 (Tank Assembly to Block)....	258-280-5	3205-G	2
86	SCREW & L'WASHER ASS'Y-H. H. C., 1/4-20x1 1/4 (Base to Block).....	258-254-5	5613-G	7
87	SCREW & L'WASHER ASS'Y-P. H. S. T., #10-24x1(Lamination to Block).....	258-108-5	5682-A	2
88	SCREW & L'WASHER ASS'Y-H. H. S. T., #10-32x3/8(Valve Chamber Cover) .	258-272-5	5838-A	2
89	SEAL-Oil (Block).....	94-178	10012	1
90	SEAL-Oil (Engine Base).....	94-176	9029	1
91	SEAL-Oil (Power Take-Off).....	94-170	4555	1
93	SHROUD-Carburetor.....	259-247	31438	1
94	SLIDE ASSEMBLY-Governor Regulating (Used on 1000 & 2000 Type A).....	149-203	6398	1
	SLIDE ASSEMBLY-Governor Regulating (Used on 2000 Types B, C, D&E)....	26-236-5	91330	1
95	SPARK PLUG & GASKET ASSEMBLY.....	K267-28-5	K16303-A	1
96	SPRING-Breaker Box Cover.....	P263-10	P5745	1
97	SPRING-Compression, Air Vane (Used on 1000 Type A).....	263-28	10005	1
98	SPRING-Extension, Speed Regulating.....	263-70	90636	1
99	*SPRING-Valve.....	263-92	3068	1
100	TANK & BLOWER HOUSING ASSEMBLY-Fuel.....	277-214-5	10370-D	1
	NOTE: Assembly incl. Ref. No. 12.			
101	TAPPET-Valve.....	278-5	10009	2
102	TERMINAL-Jamtite Breaker Points.....	P307-230	P5738	1
103	VALVE-Exhaust.....	291-8	10301	1
	VALVE-Exhaust, Oversize .010.....	292-6	10321	1
104	VALVE-Intake.....	291-7	10302	1
	VALVE-Intake, Oversize .010.....	292-7	10322	1
105	VALVE-Fuel Shut-Off.....	293-37	5051	1
106	VANE-Air Governor (Used on 1000 Type A).....	107-12	10393	1
	VANE-Air Governor (Used on 1000 Type B and 2000 Type A).....	107-11	10014	1
	VANE-Air Governor (Used on 2000 Types B, C, D&E).....	107-30	91033	1
107	WASHER-"C" (Valve Keeper).....	304-9	3291	2

SEC. II, DIV. AV-3100-1000
AV-3100-2000
PARTS CATALOG
Revised May, 1961
Supersedes Dec., 1959

S E R I E S
AV-3100-1000
AV-3100-2000
CLINTALLOY

BASIC
TYPE

CLINTON

108	WASHER-Lock (Starter Pulley)	304-132	5941	1
109	WASHER-Terminal, Condenser Lead	P304-290	P5739	1
*110	WASHER-Air Cleaner (Used on 2000 Types D & E)	304-562	92024	1

* Indicates New Part Nos. Listed For The First Time.

CLINTON

S E R I E S
AV-3100-1000
AV-3100-2000
CLINTALLOY

MODEL
VARIATIONS

SEC. II, DIV. AV-3100-1000
AV-3100-2000
PARTS CATALOG
Revised April, 1961
Supersedes Feb., 1960

MODEL VARIATIONS OF AV-3100-1000 and AV-3100-2000 SERIES

The adaptation of Clinton Engines to a wide variety of uses results in what is known as "Model Variations." Following is the complete list of all Models produced up to issue date (shown above). Opposite each Engine Model listed are the Part Numbers and/or Assembly Numbers for the Series used IN ADDITION TO or IN PLACE OF the parts illustrated and shown on the Basic Parts List preceding this Model Variations List. Refer to other sections of this Manual when Assembly Numbers are given to find the Parts List for these assemblies.

See page (a) on "How to Identify Your Clinton Engine." Use the preceding Basic Parts List except as shown below.

ENGINE MODEL—See page (a), "How to Identify Your Clinton Engine."	FOOTNOTES (Check bottom of page).	BASE—ENGINE (Part Numbers Shown). Refer to Sec. IV, Div. A for further information.	BLOCK ASSEMBLY — CYLINDER (Part Number Shown). Refer to Illustrated Basic Parts List for corresponding part.	CRANKSHAFT (Part Numbers Shown). Refer to Sec. IV, Div. B for details and further information.	BEARING—MAIN (Part Numbers Shown). Refer to Illustrated Basic Parts List for corresponding part.	CONTROL GROUP (Control Group Illustration Numbers Shown). Refer to Sec. III, Div. D for Parts List.	CONTROL CABLE LENGTH — Replace-ment cable is furnished in 72" length ONLY, cut to length shown.	PLATE ASSEMBLY — BEARING (Part Numbers Shown). Refer to Illustrated Basic Parts List for corresponding part.	MUFFLER OR MANIFOLD (Part Num-bers Shown). Refer to Illustrated Basic Parts List for corresponding part.	STARTER—RECOIL OR IMPULSE. Refer to Sec. III, Div. H for Parts List.	HOUSING AND TANK ASSEMBLY — BLOWER (Part Nos. Shown). Refer to Basic Parts List for corresponding part.	REDUCTION GEAR (Assy. Nos. Shown). Refer to Sec. III, Div. C for Parts List.	MOUNTING POSITION — "Clock" posi-tion shows mounting of reduction unit in relation to Crankshaft.
AV-3100-1101				31328						P90996	10313-B		
AV-3100-1102	Notes 1 & 2			31128						P90996	10313-B		
AV-3100-1103	Note 1									P90996	10313-B		
AV-3100-1104	Note 2									P90996	10313-B		
AV-3100-1105	Notes 1 & 2									P90996	10313-B		
AV-3100-1107	Notes 2 & 3			31328						P90996	10313-B		
AV-3100-1109	Note 2			31328						P90996	10313-B		
AV-3100-1110				31328			72"			P90996	10313-B		
AV-3100-1111	Note 2			31128							10313-B		
AV-3100-2101	Note 2			31128							10313-B		
AV-3100-2102				31328						P90996	10313-B		
AV-3100-2103	Notes 2 & 4			31128						C91116	31479-G		
AV-3100-2105				31336						P90996	10313-B		
AV-3100-2106	Notes 2 & 5			31336						P90996	10313-B		
AV-3100-2107	Note 2									P90996	31413-A		
AV-3100-2109	Notes 4, 5, 6			31336						C91116	31479-G		
AV-3100-2111	Note 2			31328						P90996	31413-A		
AV-3100-2115				31165						P90996	10313-B		
AV-3100-2116	Notes 2, 3, 4, 7, 8			31328						C91116	31479-G		

NOTE 1—Use 12376 Cover (Recoil Starter).

NOTE 2—Use 14290 Nut, 10364 Clip (Shorting), 31486 Grommet, 12409-A Wire Ass'y (Shorting), 5522 Nut, 5647 Screw.

NOTE 3—Use 7274 Elbow (Additional Part).

NOTE 4—Use C91116 Impulse Starter, C91119 Cup, 90872 Screen, 4107-A Nut (4). These parts are available in Kit MC91537.

NOTE 5—Use 91332 Visual Oil Minder Gauge.

NOTE 6—Use 10070-A Body (Muffler), 10075 Nut (Muffler), 10068-A Cover, 5861 Bolt (Muffler), 7044 Nut (Wing).

NOTE 7—Use 10320 Knob, 5444-A Screw and L'Washer, and 5481 Washer.

NOTE 8—Use 90788-A Spark Plug Cover.