

**CLINTON**

**S E R I E S**  
**AVS-4100-1000**  
**AVS-4100-2000**  
**G E M**

**BASIC**  
**TYPE**

SEC. II, DIV. AVS-4100-1000  
**PARTS CATALOG**  
Revised May, 1961  
Supersedes May, 1959

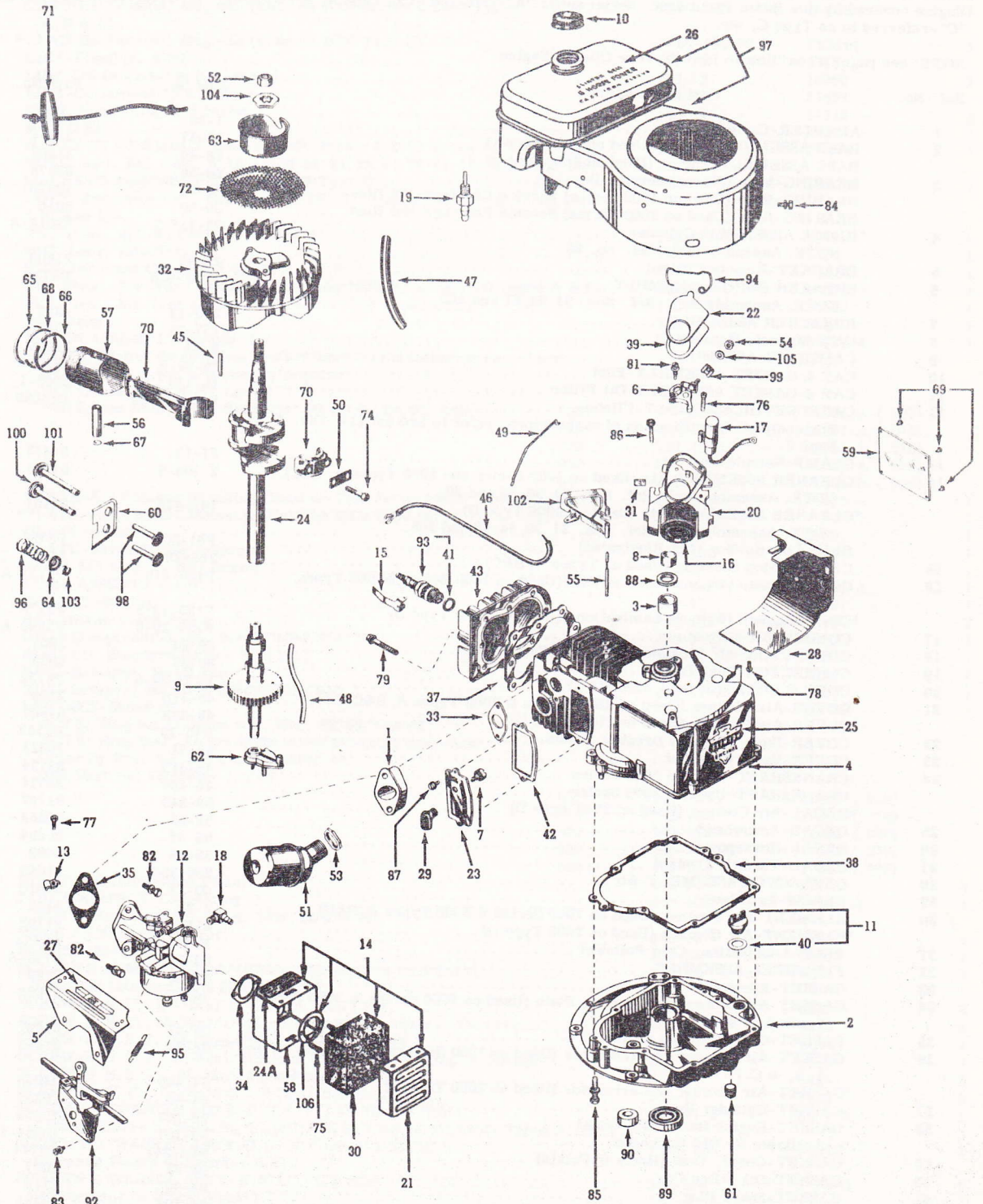

**CLINTON ENGINES CORPORATION**

MAQUCKETA, IOWA

PRINTED IN U.S.A.

SEC. II DIV. AVS-4100-1000  
PARTS CATALOG  
Revised May, 1961  
Supersedes May, 1959



BASIC  
TYPE

**CLINTON**

There is one Basic Type of the AVS4100-1000 Engine covered by this Basic Parts List. There are 4 Basic Types of the AVS4100-2000 Engine covered by this Basic Parts List. Serial suffix "A"-referred to as Type A, Serial suffix "B"-referred to as Type B, Serial suffix "C"-referred to as Type C, etc.

NOTE: See page "a" on "How to Identify Your Clinton Engine."

Ref. No.	Part Description	IBM No.	Part No.	Quan.
1	ADAPTER-Carburetor.....	1-65	12367	1
2	BASE ASSEMBLY-Engine (Used on 1000 Series).....	18-47	31494	1
	BASE ASSEMBLY-Engine (Used on 2000 Series).....	18-44	31487	1
3	BEARING-Main (Sleeve) Service Bearing.....	20-58	90278	1
	BEARING-Base (Used on 1000 Series) Service Bearings-Not Illus. ....	20-52	10016	1
	BEARING-Base (Used on 2000 Series) Service Bearings-Not Illus. ....	20-50	9016	1
4	*BLOCK ASSEMBLY-Cylinder.....	22-717-5	92016-A	1
	NOTE: Assembly incl. Ref. No. 88			
5	BRACKET-Remote Control.....	26-95	21400	1
6	BREAKER POINTS ASSEMBLY.....	P135-6-5	P5735	1
	NOTE: Assembly incl. Ref. Nos. 31, 54, 81 and 105.			
7	BREATHER ASSEMBLY.....	260-13	6354	1
8	CAM-Magneto Breaker.....	157-29	5751	1
9	CAMSHAFT ASSEMBLY.....	6-23	31009	1
10	CAP & GASKET ASSEMBLY-Fuel.....	45-89-5	4517-A	1
11	CAP & GASKET ASSEMBLY-Oil Filler.....	45-179	5095-1	1
12	CARBURETOR ASSEMBLY-Clinton.....	P39-190-99	P14055	1
	For complete identification of carburetors, refer to Section 111, Div. A Page 2.			
13	CLAMP-Remote Control.....	81-13	31463	1
14	CLEANER ASSEMBLY-Air (Used on 1000 Series and 2000 Types A, B&C)...	2-103-5	91195	1
	NOTE: Assembly incl. Ref. Nos. 21, 30, 58 and 80.			
	*CLEANER ASSEMBLY-Air (Used on 2000 Type D).....	149-476	92101	1
	NOTE: Assembly incl. Ref. Nos. 21, 30, 34, 58 and 105.			
	CLIP-Coil Holding (Not Illustrated).....	P81-20	P5734	1
15	CLIP-Ignition Shorting (Used on Types A, B&C).....	266-28	3499	1
16	COIL-Magneto (Without Laminations)(Used on 1000 Series &2000 Types A, B & C)	P135-215	P5733-A	1
	*COIL-Magneto (Without Laminations)(Used on 2000 Type D).....	P135-13-5	P5770	1
17	CONDENSER-Magneto.....	P135-29-5	P5589-A	1
18	CONNECTOR-90° Flexible Fuel Line (Carburetor).....	69-24	5052	1
19	CONNECTOR-Fuel Tank.....	69-25	5054	1
20	CORE & BREAKER BOX ASSEMBLY.....	P135-37-5	P5732	1
21	COVER-Air Cleaner (Used on 1000 Series & 2000 Types A, B&C).....	45-116	2130	1
	COVER-Air Cleaner (Used on 2000 Type D).....	45-338	91807	1
22	COVER-Dust, Magneto Breaker Points.....	P45-15	P5743	1
23	COVER-Valve Chamber.....	45-81	10323	1
24	CRANKSHAFT-Used on 1000 Series.....	46-410	31124	1
	CRANKSHAFT-Used on 2000 Series.....	46-484	31324	1
	*DECAL-Air Cleaner (Used on 2000 Type D).....	58-349	91767	1
25	DECAL-Arrowhead.....	58-25	90559	1
26	DECAL-Horsepower.....	58-57	90494	1
27	DECAL-Throttle Control.....	58-98	3488	1
28	DEFLECTOR ASSEMBLY-Air.....	259-358	91043	1
29	ELBOW-Breather.....	69-23	90610	1
30	ELEMENT-Air Cleaner (Used on 1000 Series & 2000 Types A, B&C).....	2-33	2132	1
	*ELEMENT-Air Cleaner (Used on 2000 Type D).....	2-141	91792	1
31	FELT-Lubrication, Cam Follower.....	P94-189	P5742	1
32	FLYWHEEL ASSEMBLY.....	83-12-5	5753-A	1
33	GASKET-Adaptor to Block.....	94-68	7149	1
34	GASKET-Air Cleaner to Mounting Plate (Used on 1000 Series, & 2000 Series Types A, B & C)	94-10	21056	1
35	GASKET-Carburetor to Adapter.....	94-32	31461	1
36	GASKET-Air Cleaner to Carburetor (Used on 1000 Series&2000 Series Types A, B, & C.)	94-13	31445	1
	*GASKET-Air Cleaner to Carburetor (Used on 2000 Type D).....	94-458	92098	1
37	GASKET-Cylinder Head.....	94-40	10253	1
38	GASKET-Engine Base (.015 thick).....	94-107	10254	1
	Available in .010 thickness.....	93-107	10254-1	1
39	GASKET-Cover, Dust (Breaker Points).....	P94-241	P5744	1
40	GASKET-Oil Filler Cap.....	94-82	5097	1
41	GASKET-Spark Plug.....	94-90	3115	1
42	GASKET-Valve Chamber Cover.....	94-103	10251	1
	GASKET-Engine Overhaul.....	149-361	91562	1

# CLINTON

## S E R I E S AVS-4100-1000 AVS-4100-2000 G E M

BASIC  
TYPE

SEC. II, DIV. AVS-4100-1000  
PARTS CATALOG  
Revised May, 1961  
Supersedes May, 1959

43	HEAD-Cylinder .....	122-19	31477	1
44	HOUSING ASSEMBLY-Blower (Used on 1000 Series & 2000 Type A) .....	259-124-5	21015-A	1
45	KEY-Flywheel .....	148-4	10339	1
46	LEAD-Hi-Tension, Magneto (Used on 1000 Series & 2000 Types A, B & C) .....	P307-190	P5555	1
	*LEAD-Hi-Tension, Magneto (Used on 2000 Type D) .....	P307-194-99	P90761	1
47	LINE-Flexible, Fuel .....	158-25	6316	1
48	LINE-Oil Distributor (Oil Pump) .....	158-53	10390	1
49	LINK-Carburetor to Air Vane .....	159-18	31491	1
50	LOCK-Connecting Rod Screw .....	148-12	21318	1
51	MUFFLER .....	170-36-5	3639	1
	MAGNETO ASSEMBLY-Used on 1000 Series & 2000 Types A, B & C .....	P268-4-5	P5731	1
	NOTE: Incl. Ref. Nos. 6, 16, 17, 20, 22, 31, 39, 54, 76, 81, 86, 94, 99 and 105.			
	MAGNETO ASSEMBLY-Used on 2000 Type D .....	P268-17-5	P91740	1
	NOTE: Assembly incl. Ref. Nos. 6, 16, 17, 20, 22, 31, 39, 54, 76, 81, 86, 94, 99 and 105.			
52	NUT-Hex., 1/2-20 (Starter Pulley) .....	183-68-99	5942	1
53	NUT-Lock, (Muffler) .....	183-37	4425	1
54	NUT-Terminal Condenser Lead .....	P183-21	P5740	1
55	PIN-Pivot, Air Vane Governor (Used on 1000 Series & 2000 Types A & B) ..	203-33	10015	1
	PIN-Pivot, Air Vane Governor (Used on 2000 Types C&D) .....	203-91	90982	1
56	PIN-Wrist .....	203-63	6024	1
57	PISTON ASSEMBLY-Standard .....	204-13-5	31001-A	1
	NOTE: Piston Assemblies are available in the following oversizes: Order by Part No. and specify oversize. IBM Oversize Part No. Listed			
	NOTE: Assembly incl. Ref. Nos. 55, 57, 65, 66, 67, & 68.	.005 ...	205-13-5	31001-A (.005)
		.010 ...	206-13-5	31001-A (.010)
		.020 ...	207-13-5	31001-A (.020)
		.030 ...	208-13-5	31001-A (.030)
		.040 ...	209-13-5	31001-A (.040)
58	PLATE-Air Cleaner Mounting (Used on 1000 Series&2000 Types A, B&C) ..	215-7-5	21055-A	1
	*PLATE-Air Cleaner Mounting (Used on 2000 Type D) .....	2-138	91806	1
59	PLATE-Name .....	58-105	6530	1
60	PLATE-Valve Spring Retainer .....	215-136	10013	1
61	PLUG-3/8 N. P. T. (Oil Drain) .....	216-22	5627	1
62	PUMP ASSEMBLY-Oil .....	220-5-5	10385-A	1
63	PULLEY-Starter .....	219-17	12397	1
64	RETAINER-Valve Spring .....	304-135	3028	2
65	RING-Compression, Standard (Order Ring Set) .....	233-4-99	6026	1
66	RING-Oil, Standard (Order Ring Set) .....	233-14-99	6006	1
67	RING-Retainer, Wrist Pin .....	232-41	6034	2
68	RING-Scraper, Standard (Order Ring Set) .....	233-19-99	6027	1
	RING SET-Standard .....	149-10	10023	1
	NOTE: Ring Set includes Ref. Nos. 65, 66, and 68. NOTE: Ring Sets are available in the following oversizes: Order by Part No. and specify oversize. IBM Part No. Oversize Listed	.005 ...	149-157	10023 (.005)
		.010 ...	149-158	10023 (.010)
		.020 ...	149-159	10023 (.020)
		.030 ...	149-160	10023 (.030)
		.040 ...	149-161	10023 (.040)
69	RIVET-Tubular (Name Plate) .....	244-21	5460	4
70	ROD ASSEMBLY-Connecting .....	245-102-5	31002-A	1
	NOTE: Assembly incl. Ref. Nos. 50 and 74.			
71	ROPE ASSEMBLY-Starter .....	246-13-5	4266	1
72	SCREEN-Rotating .....	257-25	90092	1
73	SCREW-R. H. M., #10-24x1/4(Blower Housing to Fuel Tank) .....	258-80	5643	2
	(Used on 1000 Series & 2000 Type A)			
74	SCREW-H. H. C., 1/4-28x1 1/4 (Conn. Rod Cap) .....	258-9	3235	2
75	SCREW-H. H. C., #8-32x7/16 (Air Cleaner Mtg. Plate to Carburetor) .....	258-131	5812	2
76	SCREW-R. H. S. T., #8-32x4/5(Condenser to Plate) .....	P258-299	P5741	1
77	SCREW-H. H. S. T., #8-32x1/4(Shroud to Bracket) (Clamp to Shroud) .....	258-477	5892	3
78	SCREW-H. H. S. T., #8-32x3/4 (Deflector to Block) .....	258-81	5644	2
79	SCREW-H. W. H., 5/16-18x1 7/8 (Cylinder Head) .....	258-88	5654	8
80	SCREW & L'WASHER ASS'Y-P. H. S. T., #8-18x3/8 (Air Cleaner Cover to Mounting Plate)(Used on 1000 Series & 2000 Types A, B&C)	258-47-5	5457-A	1
81	SCREW & L'WASHER ASS'Y-O. H. Slotted #8-32x9/16 .....	P258-297	P5737	1
	(Breaker Points to Breaker Box)			
82	SCREW & L'WASHER ASS'Y-H. H. C., 1/4-20x1 1/2 .....	258-238	5410-G	1
	(Carburetor to Block)(Upper)			

SEC. II. DIV. AVS-4100-1000  
 PARTS CATALOG  
 Revised May, 1961  
 Supersedes May, 1959

**S E R I E S**  
**AVS-4100-1000**  
**AVS-4100-2000**  
**G E M**

BASIC  
 TYPE

**CLINTON**

83	SCREW & L'WASHER ASS'Y-H. H. C., #8-32x3/8 (Bracket to Carb.).....	258-81-5	5644-A	2
84	SCREW & L'WASHER ASS'Y-H. H. C., 1/4-20x1/2 (Blower Housing to Block)	258-280-5	3205-G	2
85	SCREW & L'WASHER ASS'Y-H. H. C., 1/4-20x1 1/4 (Base to Block).....	258-254-5	5613-G	7
86	SCREW & L'WASHER ASS'Y-P. H. S. T., #10-24x1 (Lamination to Block)....	258-108-5	5682-A	2
87	SCREW & L'WASHER ASS'Y-H. H. C., #10-24x1/2 (Valve Chamber Cover)...	258-82-5	5645-A	2
88	SEAL-Oil (Block) .....	94-178	10012	1
89	SEAL-Oil (Engine Base)(Used on 1000 Series) .....	94-172	4429	1
	SEAL-Oil (Engine Base)(Used on 2000 Series).....	94-176	9029	1
90	SEAL-Oil (Power Take-Off) .....	94-170	4555	1
92	SLIDE ASSEMBLY-Governor Regulating (Used on 1000 Series and 2000 Types A & B)	149-203	6398	1
	SLIDE ASSEMBLY-Governor Regulating (Used on 2000 Types C&D).....	26-236	91330	1
93	SPARK PLUG & GASKET ASSEMBLY (H-10) .....	K267-28-5	K16303-A	1
94	SPRING-Breaker Box Cover .....	P263-10	P5745	1
95	SPRING-Extension, Speed Regulating .....	263-70	90636	1
96	SPRING-Valve .....	263-92	3068	2
97	TANK-Fuel (Used on 1000 Series and 2000 Types A)	277-211-5	21371-D	1
	NOTE: Incl. Ref. No. 10			
	*TANK AND BLOWER HOUSING ASS'Y-Used on 2000 Types B, C&D) .....	259-129-5	31413-A	1
	NOTE: Assembly incl. Ref. Nos. 10			
98	TAPPET-Valve .....	278-5	10009	2
99	TERMINAL-Jamtitite Breaker Points .....	P307-230	P5738	1
100	VALVE-Exhaust .....	291-8	10301	1
	VALVE-Exhaust, Oversize .010 .....	292-6	10321	1
101	VALVE-Intake .....	291-7	10302	1
	VALVE-Intake, Oversize .010 .....	292-7	10322	1
102	VANE-Air Governor (Used on 1000 Series & 2000 Types A&B).....	107-11	10014	1
	VANE-Air Governor (Used on 2000 Types C&D).....	170-30	91033	1
103	WASHER-"C"(Valve Keeper) .....	304-9	3291	2
104	WASHER-Lock (Starter Pulley) .....	304-132	5941	1
105	WASHER-Terminal, Condenser Lead .....	P304-290	P5739	1
106	*WASHER-Air Cleaner (Used on 2000 Type D) .....	304-562	92024	1

\* Indicates New Part Nos. Listed For The First Time.

# CLINTON

S E R I E S  
**AVS-4100-1000**  
**AVS-4100-2000**  
 G E M

SEC. II, DIV. AVS-4100-1000  
 AVS-4100-2000  
**MODEL PARTS CATALOG**  
 VARIATIONS Issued April, 1961

## MODEL VARIATIONS OF AVS-4100-1000 and AVS-4100-2000 SERIES

The adaptation of Clinton Engines to a wide variety of uses results in what is known as "Model Variations." Following is the complete list of all Models produced up to issue date (shown above). Opposite each Engine Model listed are the Part Numbers and/or Assembly Numbers for the Series used IN ADDITION TO or IN PLACE OF the parts illustrated and shown on the Basic Parts List preceding this Model Variations List. Refer to other sections of this Manual when Assembly Numbers are given to find the Parts List for these assemblies.

See page (a) on "How to Identify Your Clinton Engine." Use the preceding Basic Parts List except as shown below.

ENGINE MODEL—See page (a), "How to Identify Your Clinton Engine."	FOOTNOTES (Check bottom of page).	BASE—ENGINE (Part Numbers Shown). Refer to Sec. IV, Div. A for further information.	BLOCK ASSEMBLY — CYLINDER (Part Number Shown). Refer to Illustrated Basic Parts List for corresponding part.	CRANKSHAFT (Part Numbers Shown). Refer to Sec. IV, Div. B for details and further information.	BEARING—MAIN (Part Numbers Shown). Refer to Illustrated Basic Parts List for corresponding part.	CONTROL GROUP (Control Group Illustration Numbers Shown). Refer to Sec. III, Div. D for Parts List.	CONTROL CABLE LENGTH — Replacement cable is furnished in 72" length ONLY, cut to length shown.	PLATE ASSEMBLY — BEARING (Part Numbers Shown). Refer to Illustrated Basic Parts List for corresponding part.	MUFFLER OR MANIFOLD (Part Numbers Shown). Refer to Illustrated Basic Parts List for corresponding part.	STARTER—RECOIL OR IMPULSE. Refer to Sec. III, Div. H for Parts List.	HOUSING ASSEMBLY — BLOWER (Part Numbers Shown). Refer to Basic Parts List for corresponding part.	REDUCTION GEAR (Assy. Nos. Shown). Refer to Sec. III, Div. C for Parts List.	MOUNTING POSITION — "Clock" position shows mounting of reduction unit in relation to Crankshaft.
AVS-4100-1103	Notes 1 & 4	31487		31324						P90996	31413-A		
AVS-4100-2101	Note 1	31487		31336						P90996	31413-A		
AVS-4100-2102	Notes 1 & 2	31487		31338						C91116	91112-A		
AVS-4100-2103	Note 3	31487		31336						P90996	31413-A		
AVS-4100-2104	Notes 1 & 3	31487		31324						P90996	31413-A		
AVS-4100-2105	Note 1	31487		31324						P90996	31413-A		
AVS-4100-2106	Notes 1 & 2	31487		31324						C91116	91112-A		
AVS-4100-2108	Notes 1, 2, 3	31487		31324						C91116	91112-A		
AVS-4100-2109	Notes 1, 2, 3	31487		31324						C91116	91112-A		
AVS-4100-2110	Note 1	31487		31324						P90996	31413-A		
AVS-4100-2112	Notes 2 & 5	31487		31328						C91116	91112-A		
AVS-4100-2113	Note 6	31487		31328						P90996	31413-A		
AVS-4100-2114	Note 6	31487		31328						P90996	31413-A		
AVS-4100-2115	Notes 1, 2, 6	31487		31336						C91116	91112-A		

NOTE 1—Use 14290 Nut, 10364 Clip (Shorting), 31486 Grommet, 12409-A Wire Assembly (Shorting), 5522 Nut.

NOTE 2—Use C91119 Cup (Impulse Starter), 90872 Screen, 4107-A Nut (4). If original Impulse Starter Mounting Position is required, use the 91112-A Housing & Tank Assembly, however, if original position is not required use 31413-A.

NOTE 3—Use 31448-A Shroud Assembly (Engine).

NOTE 4—Use 9016 Bearing Sleeve, 9029 Seal.

NOTE 5—Use 31011 Head and 5752-A Flywheel.

NOTE 6—USE 91974-A Cap and Gauge Assembly (Fuel).