

CLINTON **SERIES**
C-700
4 - C Y C L E

BASIC
TYPES

Specifications and Dimensions are subject to change without notice.

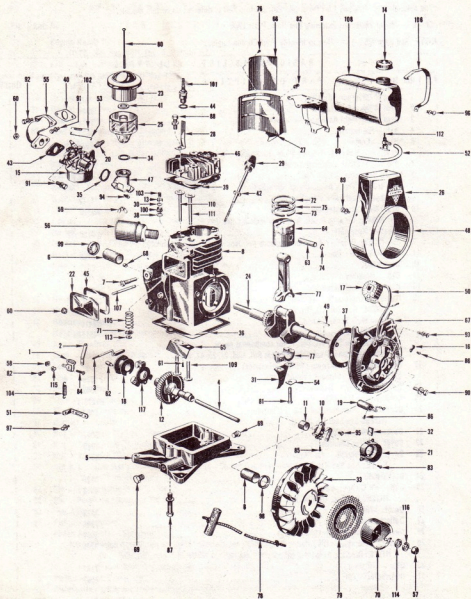

CLINTON

S E R I E S
C-700
4 - C Y C L E

BASIC
TYPESSEC. II, DIV. C-700
PARTS CATALOG
Issued Oct., 1954

There is one Basic Type of the C-700 Engines covered by this Basic Parts List. This "TYPE" is shown as follows: SERIAL NUMBER SUFFIX "A"—referred to as "TYPE A."

*The asterisk preceding any Part Description means this Part is different on certain Models.

Check for Model Variations following this Basic Parts List.

NOTE: See page no. (a) on "How to Identify Your Clinton Engine."

BASIC PARTS LIST — ALL TYPES

Fig. 1 Ref. No.	PART DESCRIPTION	Part No.	Quantity
1	Arm — Governor Adjusting	7975	1
2	Arm — Governor Throttle	7944	1
3	Arm and Weight Assembly — Governor	7932-A	1
4	Axle — Camshaft	3593-A	1
5	*Base — Engine	8025	1
6	*Bearing — Main (1—Bearing Plate, 1—Block)	3024	2
7	Bearing — Shaft, Governor Throttle	3073	1
8	*Block Assembly — Cylinder	4170-A	1
	NOTE: Block Assembly includes Ref. No. 5		
9	Bracket — Fuel Tank Mounting	7942	1
10	Breaker Points Assembly — Magneto	P5510	1
	NOTE: Breaker Points Assembly includes Ref. No. 85.		
	Breather Assembly	7150-A2	1
	NOTE: Breather Assembly includes Ref. Nos. 13, 30, 38, 100 and 103.		
11	Cam — Breaker Points	5105	1
12	Camshaft	6041	1
13	Cap — Breather	7151	1
14	Cap and Gasket Assembly — Fuel	3059	1
15	Carburetor Assembly — (Carter)	C4446-2	1
	NOTE: See Sec. III, Div. A.		
16	Clamp — High Tension Lead	C3410	1
	Cleaner Assembly — Air	4512-A	1
	NOTE: See Sec. III, Div. F, for component parts.		
	NOTE: Cleaner Assembly includes Ref. Nos. 23, 25, 41, & 59.		
17	Coil Assembly — Magneto (With Laminations)	P5502	1
	Coil — Magneto (Without Laminations)	P5509	1
18	Collar Assembly — Governor	3063-1	1
19	Condenser — Magneto	P7219-1	1
20	Connector — Flexible Fuel Line (Carburetor)	5053	1
	NOTE: See Sec. III, Div. G.		
21	Cover — Breaker Points	5062	1
22	Cover — Valve Chamber	3035	1
23	Cover and Element — Air Cleaner	4512	1
	NOTE: See Sec. III, Div. F.		
24	*Crankshaft	5129	1
25	Cup — Air Cleaner, Lower	4513	1
	NOTE: See Sec. III, Div. F.		
26	Decal — Arrowhead	3579	2
27	Deflector — Air	7906	1
28	Device — Shorting Clip (Spark Plug)	3599	1
29	Dipstick Assembly — Oil Filler	3295	1
	NOTE: Dipstick Assembly includes Ref. No. 42.		
30	Disc — Breather	7152	1
31	Distributor — Oil	4007	1

BASIC PARTS LIST — ALL TYPES (CONTINUED)

Fig. 1 Ref. No.	PART DESCRIPTION	Part No.	Quantity
	Engine Repair Kit	6304	1
	NOTE: See Sec. VIII, Div. A, Bulletin 57.		
32	Felt — Lubrication, Cam Follower	P5504	1
33	Flywheel Assembly — With Magnets	6222	1
	NOTE: Sold as an Assembly only.		
34	Gasket — Air Cleaner to Air Horn	10259	1
35	Gasket — Air Horn	3990	1
36	Gasket — Base	6031	1
37	Gasket — Bearing Plate (Standard, .015 thick)	3056	1
	NOTE: Gaskets are also available in the following thicknesses: .005, .010 and .020. Order by Part No. and specify thickness.		
38	Gasket — Breather	7153	1
39	Gasket — Cylinder Head	3055	1
40	Gasket — Manifold, Asbestos (Manifold to Block)	7149	1
41	Gasket — "O" Ring, Air Cleaner (Element to Cup)	4515	1
42	Gasket — Oil Filler Cap, Dipstick	3297	1
43	Gasket — Paper (Manifold to Carburetor)	7168	3
44	Gasket — Spark Plug	3115	1
45	Gasket — Valve Chamber Cover	3057	1
	Gasket Kit — Engine Overhaul	3055-A	1
	Gasket Kit — Engine Overhaul (With Speed Reducer Units)	3055-B	1
	NOTE: See Sec. VIII, Div. A, Bulletin 48.		
	NOTE: Kit contains all necessary Gaskets and Oil Seals.		
46	Head — Cylinder	7911	1
47	Horn — Air Cleaner	10350-C	1
48	Housing — Blower	7907-A	1
	Housing — Blower (For Recoil Starter)	7913-A	1
49	Key — Flywheel	7244	1
50	Lead — High Tension, Magneto	P5555	1
51	Lever — Speed Adjusting	3075	1
52	Line — Fuel, Flexible	6316	1
53	Link — Governor	7920	1
54	Lock — Connecting Rod Screw	3027	2
55	Manifold — Carburetor	7930	1
56	Muffler — Tubular	3639	1
57	Nut — Hexagon, 7/16-20 (Starter Pulley)	3250	1
58	Nut — Square, #10-24 (Governor Adjusting Arm)	3253	1
59	Nut — Wing (Air Cleaner Screw)	7044	1
60	Nut & L'washer Ass'y — Hexagon, 1/4-28 (1—Carburetor to Manifold, 1—Valve Chamber Cover)	3255-A	2
61	Pin — Drive (Baffle Plate to Block)	3569	1
62	Pin — Retaining (Governor Yoke)	3656	1
63	Pin — Wrist	3033	1
64	Piston — Standard	3021	1
	Piston Assembly — Standard	3021-A	1
	NOTE: Piston Assemblies are also available in the following oversizes: .005, .010, .020, .030, and .040. Order by Part No. and specify oversize. Piston Assembly includes Ref. Nos. 63, 64, 69, 72, 73, 74 & 75.		
65	Plate — Baffle, Crankcase	3559	1
66	Plate — Name, Clinton Engines	6530	1

BASIC PARTS LIST — ALL TYPES (CONTINUED)

Fig. 1 Ref. No.	PART DESCRIPTION	Part No.	Quantity
67	Plate — Bearing	7960-A	1
	NOTE: Bearing Plate includes Ref. Nos. 6 and 98.		
	Plate Assembly — Bearing & Magneto	C7960-B	1
	NOTE: Bearing & Magneto Plate Assembly includes Ref. Nos. 10, 17, 19, 50, 67, 86, 93 and 95.		
68	Plug — Camshaft Axle	3281	1
69	Plug — Oil Drain	3289	2
70	Pulley — Starter	3299	1
71	Retainer — Valve Spring	3028	2
72	Ring — Compression, Standard	3572	1
73	Ring — Oil, 3/16, Standard	3574-1	1
74	Ring — Retainer, Wrist Pin	3030	2
75	Ring — Scraper, Standard	3573	1
	Ring Set — Standard (3/16 Oil Ring)	3048-1	1
	NOTE: Ring Sets are also available in the following oversizes: .005, .010, .020, .030, and .040. Order by Part No. and specify oversize.		
	NOTE: Ring Set includes Ref. Nos. 72, 73 & 75.		
76	Rivet — Tubular, Name Plate	5460	4
77	Rod Assembly — Connecting	3022-B	1
	NOTE: Rod Assembly includes Ref. Nos. 54 & 81		
78	Rope Assembly — Starter	4266	1
79	Screen — Revolving	6226	1
80	Screw — R.H.M., #10-24 x 6-1/4 (Air Cleaner)	5636	1
81	Screw — H.H.C., 1/4-28 x 1-1/4 (Connecting Rod Cap)	5433	2
82	Screw — H.H., Slotted S.T., #8-32 x 3/8" (1—Governor Arm Adjuster) (1—Deflector to Cylinder Head)	5644	2
83	Screw — O.H.S.T., #6-32 x 3/8 (Breaker Cover to Bearing Plate)	5416	2
84	Screw — R.H.M., #10-24 x 5/8 (Governor Adjusting Arm)	3211	1
85	Screw — R.H.S.T., #6-32 x 3/8 (Breaker Points Terminal)	5405	1
86	Screw — R.H.S.T., #8-32 x 1/4 (1—Clamp to Bearing Plate, 1—Condenser to Bearing Plate)	5415	2
87	Screw & L'washer Ass'y — H.H.C., 7/16-20 x 2 (Base to Block)	6076-G	2
88	Screw & L'washer Ass'y — H.H.C., 5/16-18 x 1 (Cylinder Head to Block)	3201-D	6
89	Screw & L'washer Ass'y — H.H.C., 1/4-20 x 5/8 (6—Blower Housing to Bearing Plate, 1—Tank Bracket to Block)	3632-G	7
90	Screw & L'washer Ass'y — H.H.C., 1/4-28 x 3/4 (Bearing Plate to Block)	5448-F	4
91	Screw & L'washer Ass'y — H.H.C., 1/4-28 x 3/4 (2—Carburetor to Manifold) (1—Manifold to Block)	3230-G	3
92	Screw & L'washer Ass'y — H.H.C., 1/4-28 x 1-1/2 (1—Manifold to Block)	3209-G	1
93	Screw & L'washer Ass'y — P.H.S.T., 1/4-20 x 7/8 (Coil to Bearing Plate)	5618-B	2
94	Screw & L'washer Ass'y — R.H.M., #8-32 x 3/4 (Air Horn to Carburetor)	7113-A	2
95	Screw & L'washer Ass'y — R.H.M., #8-32 x 5/16 (Breaker Points to Bearing Plate)	5407-F	1
96	Screw & L'washer Ass'y — R.H.M., #10-24 x 1-1/4 (Fuel Tank Straps)	5422-A	2
97	Screw & L'washer Ass'y — R.H.M., #10-32 x 3/8 (Speed Adjusting Lever)	3222-F	1
98	Seal — Oil (Bearing Plate)	3136	1
99	*Seal — Oil (Cylinder Block)	3026	1
100	Seat — Breather	7150	1
101	Spark Plug and Gasket Assembly	3568-A	1
102	Spring — Backlash, Governor	7997	1
103	Spring — Breather Hold Down	7154	1

BASIC PARTS LIST - ALL TYPES (CONTINUED)

Fig. 1 Ref. No.	PART DESCRIPTION	Part No.	Quantity
104	Spring - Governor	4001	1
105	Spring - Valve	3068	2
106	Strap - Fuel Tank	7943	2
107	Stud - Valve Chamber Cover	3042	1
108	Tank Assembly - Fuel	7941	1
NOTE: Tank Assembly includes Ref. No. 14.			
109	Tappet - Valve	3034	2
110	Valve - Exhaust, Standard Stem	3031-1	1
	Valve - Exhaust, Oversize Stem (Approx. 9 32 Dia.)	3031-2	1
111	Valve - Intake, Standard Stem	3032-1	1
	Valve - Intake, Oversize Stem (Approx. 9 32 Dia.)	3032-2	1
112	Valve - Fuel, Shut-Off, Flexible Line	5051	1
NOTE: See Sec. III, Div. G.			
113	Washer - "C", Valve Keeper	3291	2
114	Washer - Flat, 7 16 (Starter Pulley)	5482	1
115	Washer - Governor Arm Adjusting	7976	1
116	Washer - Lock, 7 16 (Starter Pulley)	3275	1
117	Weight Assembly - Governor Yoke	4205	1

AVAILABLE OVERHAUL KITS

Engine Model	Description	Kit No.
C-700	Gasket Overhaul Kit	3055-A
*C-700	Gasket Overhaul Kit	3055-B
C-700	Engine Repair Kit	6304
C-700	Carburetor Repair Kit	C3964

*With Speed Reducer Units.

CLINTON

S E R I E S C-700 4 - C Y C L E

MODEL VARIATIONS

SEC. II, DIV. C-700
PARTS CATALOG
Revised December, 1955
Supersedes March, 1955

MODEL VARIATIONS OF C-700 SERIES

ENGINE MODEL —See Page 44, "How to Identify Your Clinton Engine."						
FOOTNOTES (Check page two).						
BASE ENGINE (Part Numbers Shown). Refer to Sec. IV, Div. A for further information.						
CONTROL GROUP (Control Group Illustration Numbers Shown). Refer to Sec. III, Div. D for Parts List.						
CONTROL CABLE LENGTH , option—Refer to "72" length ONLY, cut to length shown.						
CRANKSHAFT (Part Numbers Shown). Refer to Sec. IV, Div. B for details and further information.						
BEARING—MAIN (Part Numbers Shown). Refer to Illustrated Basic Parts List for corresponding part.						
BLUOTE ASSEMBLY—CYLINDER (Part Numbers Shown). Refer to Illustrated Basic Parts List for corresponding part.						
STARTER—RECOIL (Assembly Numbers Shown). Refer to Sec. III, Div. H for Parts Lists.						
HOUSING ASSEMBLY—BLOWER (Part Numbers Shown). Refer to Basic Parts List for corresponding part.						
REDUCTION GEAR (Assembly Nos. Shown). Refer to Sec. III, Div. C for Parts List.						
MOUNTING POSITION						
C-700-100					C6333	7913-A
C-700-101					C6333	7913-A
C-700-102					C6333	7913-A
C-700-103		5040				
C-700-104		5040			C6333	7913-A
C-700-105			SK555	72"		
C-700-106			SK555		C6333	7913-A
C-700-107		5040	SK555	72"		
C-700-108		5040	SK555	72"	C6333	7913-A
C-700-110		6093	SK556			
C-700-111		6161	SK555	36"	5143	4166
C-700-112	RELEASED FOR EXPORT ONLY					
C-700-113	RELEASED FOR EXPORT ONLY					
C-700-114	RELEASED FOR EXPORT ONLY					
C-700-115	No Variation, use Basic Parts List					
C-700-116		5040				
C-700-117					C6333	7913-A
C-700-118		5040			C6333	7913-A
C-700-119			SK555	72"		
C-700-120		5040	SK555	72"		
C-700-121			SK555		C6333	7913-A
C-700-122		5040	SK555	72"	C6333	7913-A
C-700-123	RELEASED FOR EXPORT ONLY					
C-700-124		5040	SK556			
C-700-125		5040	SK557			
C-700-126		6093	SK556			
C-700-127		5040	SK558			
C-700-128		5040	SK558			
C-700-129	Note 4					
C-700-130		5040	SK555			
C-700-131		5040	SK556	72"		
C-700-132	Note 1					
C-700-133	Note 1					
C-700-134	Note 1					
C-700-135		5040	SK555		C6333	7913-A
C-700-136	Note 1					
C-700-137	No Variation, use Basic Parts List					
C-700-138		5040			4166	
C-700-139		5040	SK555			
C-700-140	Note 6					
C-700-141	Note 6					
C-700-142		5040	SK555		4172-A	
C-700-143		5040	SK555		C6333	7913-A
C-720					C6333	7913-A
				5132		3552 6:00

MODEL VARIATIONS OF C-700 SERIES (Continued)

ENGINE MODEL	FOOTNOTES	BASE—ENGINE	CONTROL GROUP	CONTROL CABLE LENGTH	CRANKSHAFT	BEARING—MAIN	BLOCK ASSEMBLY—CYLINDER	STARTER—RECORD	HOUSING ASSEMBLY—BLOWER	REDUCTION GEAR	MOUNTING POSITION
C-720-100					5132					3552	12-00
C-720-101					5132					3552	6-00
C-740					5131					3554	6-00
C-740-100	RELEASED FOR EXPORT ONLY										
C-740-101					5131					3554	6-00
C-760					5130					3800	6-00
C-760-100					5130					3800	6-00
C-760-101					5130					3800	6-00
C-760-102		5040	SK555	72"	5130		C6333	7913-A		3800	6-00
C-760-103					5130		C6333	7913-A		3800	6-00
C-760-104		5040			5130					3800	6-00
C-760-105		5040			5130		C6333	7913-A		3800	6-00
C-760-106			SK555	72"	5130					3800	6-00
C-760-107			SK555	72"	5130		C6333	7913-A		3800	9-00
C-760-108		5040	SK555	72"	5130					3800	6-00
C-760-109					5130					3800	6-00
C-760-110		5040			5130					3800	6-00
C-760-111					5130		C6333	7913-A		3800	6-00
C-760-112		5040			5130		C6333	7913-A		3800	6-00
C-760-113			SK555	72"	5130					3800	6-00
C-760-114		5040	SK555	72"	5130					3800	6-00
C-760-115			SK555	72"	5130		C6333	7913-A		3800	9-00
C-760-116		5040	SK555	72"	5130		C6333	7913-A		3800	6-00
C-760-117		5040	SK558	54"	5130					3800	6-00
C-760-118		5040	SK558	54"	5130					3800	6-00
C-760-119			SK555		5130					3800	6-00
C-760-120		5040	SK555		5130		C6333	7913-A		3800	12-00
C-760-121					5130					3800	6-00
C-760-122		5040	SK555		5130					3800	12-00
C-760-123	Note 7				5130		C6333	7913-A		3800	6-00
C-790	Note 2				5133	3670	4165				
C-790-100	Notes 2 & 5				5139	3670	4164				
C-790-101	RELEASED FOR EXPORT ONLY										
C-790-102	Note 2		SK555	72"	5139	3670	4165				
C-790-103	Note 2	5040			5154	3670	4165	C6333	7913-A		
C-790-104	RELEASED FOR EXPORT ONLY										
C-790-105	Note 2	5040			5139	3670	4165				
C-790-106					5148	3670	4167	C6333	7913-A		
C-790-107	Note 2	6093			5152	3670	4165				
C-790-108	Note 2				5133	3670	4165				
C-790-109	Note 2	5040			5139	3670	4165				
C-790-110	Notes 2 & 3	5040			5139	3670	4171				
C-790-111	Note 2	6093			5133	3670	4165				

NOTE 1—Muffler #4550 to be used in lieu of #3639, Lock Nut #4425 used as additional part.

NOTE 2—Oil Seal #2668 must be used in lieu of #3026.

NOTE 3—Two #7954 Spacers and Two #5625-D Screw and Lockwasher Assemblies must be used on cylinder head mounting on this model.

NOTE 4—Connector #3576, Valve #3505-A, and Connector #5052 must be used as additional parts on this model.

NOTE 5—Air Cleaner Assembly #2000-A to be used in lieu of #4512-A.

NOTE 6—Use #4419 Connector and #4425 Nut. #7947 Spacer and #5648 Screw used as additional parts. #7945 Bracket used in lieu of #7942.

NOTE 7—Purge—Bearing #7903-A, Wire Assy. #5069-A, Grommet #5066, Screw #5443 used as additional parts. Use #4521 Muffler in lieu of #3629.