

SEC. II, DIV. D-700-2000
PARTS CATALOG
Revised April, 1958
Supersedes Feb., 1957

CLINTON

S E R I E S
D-700-2000
L O N G L I F E

BASIC
TYPES

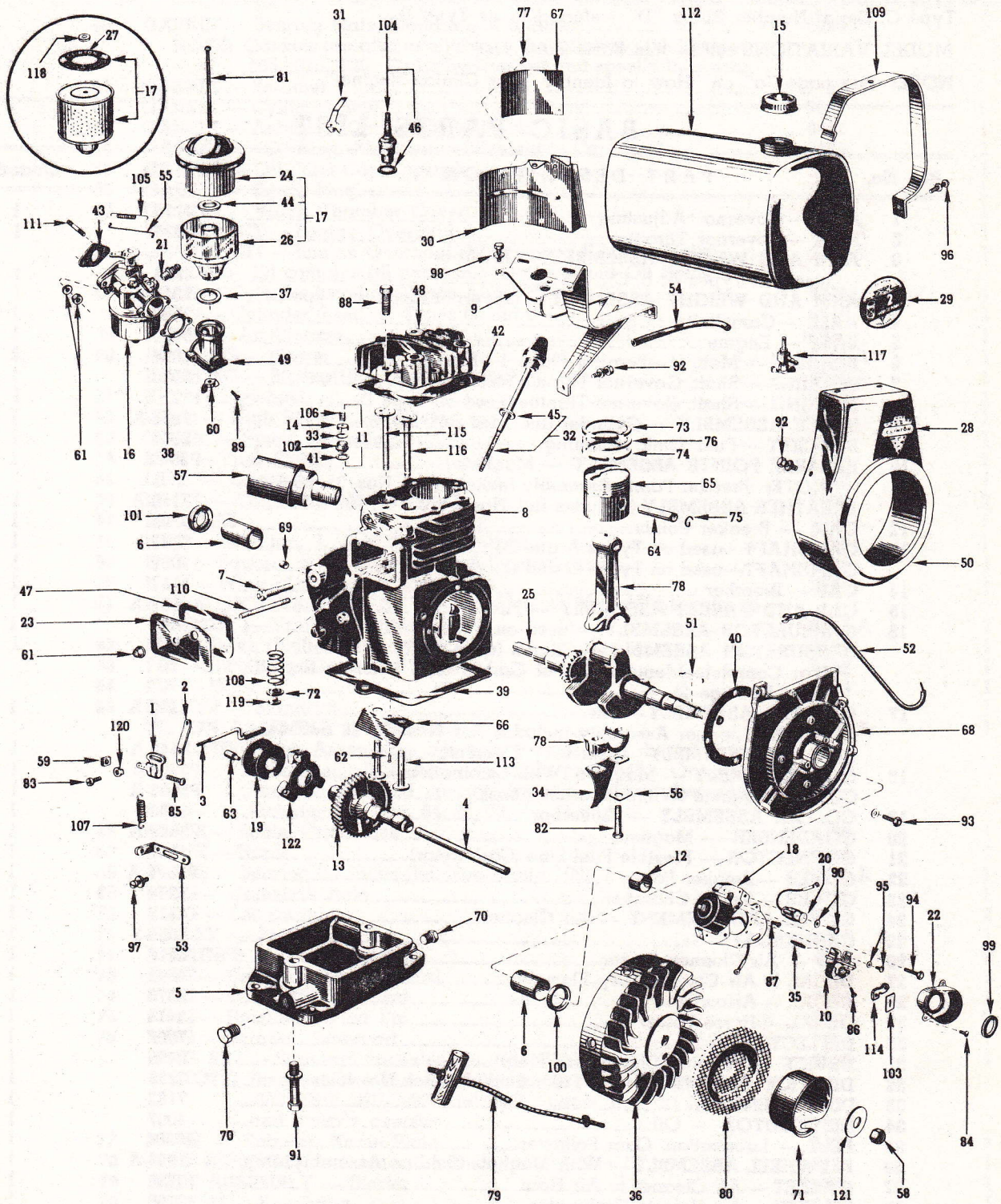

CLINTON

S E R I E S
D-700-2000
L O N G L I F E

**BASIC
TYPES**

**SEC. II. DIV. D-700-2000
PARTS CATALOG**
Revised April, 1958
Supersedes Feb., 1957

There are four Basic Types of the D-700-2000 Engine covered by this Basic Parts List. Parts not used on all types are noted. These types are shown as follows: Serial Number Suffix "A"—referred to as Type A; Serial Number Suffix "B"—referred to as Type B; Serial Number Suffix "C"—referred to as Type C; Serial Number Suffix "D"—referred to as Type D.

MODEL VARIATIONS follow this Basic Parts List.

NOTE: See page "a" on "How to Identify Your Clinton Engine."

BASIC PARTS LIST

Ref. No.	PART DESCRIPTION	Part No.	Quantity
1	ARM — Governor Adjusting -----	7975	1
2	ARM — Governor Throttle -----	7977	1
3	ARM AND WEIGHT ASSEMBLY — Governor (used on Types A, B, C) -----	4203	1
	ARM AND WEIGHT ASSEMBLY — Governor (used on Type D) -----	12311-A	1
4	AXLE — Camshaft -----	3593-A	1
5	BASE — Engine -----	5040	1
6	BEARING — Main (1—Bearing Plate, 1—Block) -----	3024	2
7	BEARING — Shaft, Governor Throttle (used on Types A, B, C) -----	3073	1
	BEARING — Shaft, Governor Throttle (used on Type D) -----	12310	1
8	BLOCK ASSEMBLY — Cylinder (Includes Ref. No. 6) -----	7985-A	1
9	BRACKET — Fuel Tank Mounting -----	12059	1
10	BREAKER POINTS ASSEMBLY — Magneto ----- NOTE: Breaker Points Assembly includes Ref. Nos. 35, 86 & 95.	P5543	1
11	BREATHER ASSEMBLY (includes Ref. Nos. 14, 33, 41, 102 & 106) -----	7150-A	1
12	CAM — Breaker Points -----	5703	1
13	CAMSHAFT—used on Types A and B -----	6041-1	1
	CAMSHAFT—used on Types C and D -----	12008	1
14	CAP — Breather -----	7151	1
15	CAP AND GASKET ASSEMBLY — Fuel -----	4517-A	1
16	CARBURETOR ASSEMBLY — (used on Type A) -----	C14088	1
	CARBURETOR ASSEMBLY — Clinton (used on Type B) ----- (For Complete Identification of Carburetors, Refer to Sec. III, Div. A, Page 2)	14002	1
17	CLEANER ASSEMBLY — Air ----- NOTE: Cleaner Assembly includes Ref. Nos. 24, 26 and 44.	4512-A	1
	CLEANER ASSEMBLY — Air (Dry Element) -----	4546-A	1
18	COIL ASSEMBLY — Magneto (With Laminations) -----	P5704-B	1
	COIL — Magneto (Without Laminations) -----	P5593-A	1
19	COLLAR ASSEMBLY — Governor -----	3083-1	1
20	CONDENSER — Magneto -----	P5589-A	1
21	CONNECTOR — Flexible Fuel Line (Carburetor) -----	5052	1
22	COVER — Breaker Points -----	P5595-A	1
23	COVER — Valve Chamber -----	7938	1
24	COVER AND ELEMENT — Air Cleaner -----	4512	1
25	CRANKSHAFT -----	6059-3	1
26	CUP — Air Cleaner, Lower -----	4513	1
27	DECAL — Air Cleaner (Dry Element) -----	4561	1
28	DECAL — Arrowhead -----	3579	1
29	DECAL — Horse Power -----	3454	1
30	DEFLECTOR — Air -----	7906	1
31	DEVICE — Shorting Clip (Spark Plug) -----	3499	1
32	DIPSTICK ASSEMBLY — Oil Filler (includes Ref. No. 45) -----	3295	1
33	DISC — Breather -----	7152	1
34	DISTRIBUTOR — Oil -----	4007	1
35	FELT — Lubrication, Cam Follower -----	P5504	1
36	FLYWHEEL ASSEMBLY — With Magnets (Sold as Assembly only) -----	7999-A	1
37	GASKET — Air Cleaner to Air Horn -----	10259	1
38	GASKET — Air Horn to Carburetor -----	3990	1
39	GASKET — Base -----	4465-1	1

BASIC PARTS LIST (Continued)

Ref. No.	PART DESCRIPTION	Part No.	Quantity
40	GASKET — Bearing Plate (Standard, .015 thick)..... NOTE: Gaskets are also available in the following thicknesses: .005, .010, .020. Order by Number and specify thickness.	3056	1
41	GASKET — Breather	7153	1
42	GASKET — Cylinder Head	7955	1
43	GASKET — Asbestos (Carburetor to Block).....	6002	1
44	GASKET — "O" Ring, Air Cleaner (Element to Cup).....	4515	1
45	GASKET — Oil Filler Cap, Dipstick.....	3297	1
46	GASKET — Spark Plug	3115	1
47	GASKET — Valve Chamber Cover..... GASKET KIT — Engine Overhaul	3057 7955-A	1 1
	GASKET KIT — Engine Overhaul (With Speed Reducer Units)..... NOTE: Kit contains all necessary Gaskets and Oil Seals.	7955-B	1
48	HEAD — Cylinder (used on Types A and B).....	7911	1
	HEAD — Cylinder (used on Types C and D).....	7917	1
49	HORN — Air Cleaner.....	10350-C	1
50	HOUSING — Blower	7907-A	1
	HOUSING — Blower (For Recoil Starter).....	7913-A	1
51	KEY — Flywheel.....	10339	1
52	LEAD — High Tension, Magneto.....	P5555	1
53	LEVER — Speed Adjusting.....	3075	1
54	LINE — Fuel, Flexible.....	6316	1
55	LINK — Governor.....	7920	1
56	LOCK — Connecting Rod Screw.....	3027	2
57	MUFFLER	3639	1
58	NUT — Hexagon, 7/16-20 (Starter Pulley).....	5476	1
59	NUT — Square, #10-24 (Governor Adjusting Arm).....	3253	1
60	NUT — Wing (Air Cleaner Screw).....	7044	1
61	NUT & LOCKWASHER ASS'Y — Hexagon, 1/4-28 (2—Carburetor to Block, 1—Valve Chamber Cover).....	3255-A	3
62	PIN — Drive (Baffle Plate to Block).....	3569	1
63	PIN — Retaining (Governor Yoke).....	3856	1
64	PIN — Wrist	7923	1
65	PISTON — Standard..... PISTON ASSEMBLY — Standard.....	7900 7900-A	1 1
	NOTE: Piston Assemblies are also available in the following oversizes: .005, .010, .020, .030, and .040. Order by Part Number and specify oversize. Piston Assembly includes Ref. Nos. 64, 65, 73, 74, 75 and 76.		
66	PLATE — Baffle, Crankcase	3559	1
67	PLATE — Name	6530	1
68	PLATE — Bearing (includes Ref. Nos. 6 and 100).....	12016-A	1
69	PLUG — Camshaft Axle	3281	1
70	PLUG — Oil Drain	3289	2
71	PULLEY — Starter.....	3299	1
72	RETAINER — Valve Spring.....	3028	2
73	RING — Compression, Standard	7980	1
74	RING — Oil, 3/16, Standard.....	7982	1
75	RING — Retainer, Wrist Pin.....	6034	2
76	RING — Scraper, Standard	7981	1
	RING SET — Standard (includes Ref. Nos. 73, 74 and 76)..... NOTE: Ring Sets are also available in the following oversizes: .005, .010, .020, .030, and .040. Order by Part Number and specify oversize.	7998	1
77	RIVET — Tubular, Name Plate.....	5469	4
78	ROD ASSEMBLY — Connecting (includes Ref. Nos. 56 and 82).....	6107	1
79	ROPE ASSEMBLY — Starter.....	4266	1
80	SCREEN — Revolving.....	6226	1
81	SCREW — R.H.M., #10-24 x 6 1/4 (Air Cleaner).....	5636	1
82	SCREW — H.H.C., 1/4-28 x 1 1/4 (Connecting Rod Cap).....	3235	2

CLINTON

S	E	R	I	E	S		
D-700-2000							
L	O	N	G	L	I	F	E

**BASIC
TYPES**
**SEC. II. DIV. D-700-2000
PARTS CATALOG**
 Revised April, 1958
 Supersedes Feb., 1957
BASIC PARTS LIST (Continued)

Ref. No.	PART DESCRIPTION	Part No.	Quantity
83	SCREW — H.H., Slotted S.T., #8-32 x 3/8" (Governor Arm Adjuster)	5644	1
84	SCREW — R.H.S.T., #6-32 x 3/8 (Breaker Cover to Bearing Plate)---	5405	2
85	SCREW — R.H.M., #10-24 x 5/8 (Governor Adjusting Arm)-----	3211	1
86	SCREW — R.H.M., #6-32 x 1/4 (Breaker Points Terminal)-----	5664	2
87	SCREW — P.H.S.T., #4-40 x 1/4 (Coil Ground to Laminations)-----	5641	1
88	SCREW — H.W.H., 5/16-18 x 1 (Cylinder Head to Block)-----	5653	6
89	SCREW — F.H.M., #8-32 x 11/16 (Air Horn to Carburetor)-----	5677	2
90	SCREW & LOCKWASHER — F.H.M., #8-32 x 5/8 (Condenser to Bearing Plate)	5674-F	1
91	SCREW & L'WASHER ASS'Y—H.H.C., 7/16-20 x 2 (Base to Block)	3200-A	2
92	SCREW & L'WASHER ASS'Y—H.H.C., 1/4-20 x 5/8 (6—Blower Housing to Bearing Plate, 1—Tank Bracket to Block)-----	3632-G	7
93	SCREW & L'WASHER ASS'Y—H.H.C., 1/4-28 x 3/4 (Bearing Plate to Block)	5448-F	4
94	SCREW & L'WASHER ASS'Y—P.H.S.T., #10-24 x 1 (Lamination to Bearing Plate)	5682-A	2
95	SCREW & L'WASHER ASS'Y—R.H.M., #8-32 x 1/3 (Breaker Points to Bearing Plate)	5409-F	1
96	SCREW & L'WASHER ASS'Y—R.H.M., #10-24 x 1 (Fuel Tank Straps)	5421-A	2
97	SCREW & L'WASHER ASS'Y—R.H.M., #10-32 x 3/8 (Speed Adjusting Lever)	3222-F	1
98	SCREW & L'WASHER ASS'Y—F.H.M., #10-32 x 1/2 (Tank Bracket to Cylinder Head)	5412-G	2
99	SEAL — Breaker Points	5596	1
100	SEAL — Oil (Bearing Plate)	3136	1
101	SEAL — Oil (Cylinder Block)	3026	1
102	SEAT — Breather	7150	1
103	SHIELD — Breaker Points	5714	1
104	SPARK PLUG AND GASKET ASSEMBLY	K3468-A	1
105	SPRING — Backlash, Governor	7979	1
106	SPRING — Breather Hold-Down	7154	1
107	SPRING — Governor	4001	1
108	SPRING — Valve	3068	2
109	STRAP — Fuel Tank	12080	2
110	STUD — Valve Chamber Cover	3042	1
111	STUD — Carburetor Mounting	6155	2
112	TANK ASSEMBLY — Fuel	12058-A	1
	NOTE: Tank Assembly includes Ref. No. 15.		
113	TAPPET — Valve	3034	2
114	TERMINAL — Breaker Points	5713	1
115	VALVE — Exhaust, Standard Stem	3031-1	1
	VALVE — Exhaust, Oversize Stem (Approx. 9/32 Dia.)	3031-2	1
116	VALVE — Intake, Standard Stem	3032-1	1
	VALVE — Intake, Oversize Stem (Approx. 9/32 Dia.)	3032-2	1
117	VALVE — Fuel, Shut-Off, Flexible Line	5051	1
118	WASHER — Air Cleaner Stud (used with 4546-A Cleaner)	5906	1
119	WASHER — "C," Valve Keeper	3291	2
120	WASHER — Governor Arm Adjusting	7976	1
121	WASHER — Spring Tension (Starter Pulley)	4119	1
122	WEIGHT ASSEMBLY — Governor Yoke (used on Types A, B, & C)	3062-A	1
	WEIGHT ASSEMBLY — Governor Yoke (used on Type D)	3062-B	1

AVAILABLE OVERHAUL KITS

Engine Model	Description	Kit No.
D-700-2000	Gasket Overhaul Kit	7955-A
*D-700-2000	Gasket Overhaul Kit	7955-B
D-700-2000	Carburetor Repair Kit (Clinton)	14238

*With Speed Reducer Unit

CLINTON

S	E	R	I	E	S		
D-700-2000							
L	O	N	G	L	I	F	E

MODEL VARIATIONS

SEC. II, DIV. D-700-2000
PARTS CATALOG
 Revised January, 1959
 Supersedes March, 1958

MODEL VARIATIONS OF D-700-2000 SERIES

The adaptation of Clinton Engines to a wide variety of uses results in what is known as "Model Variations." Following is the complete list of all Models produced up to issue date (shown above). Opposite each Engine Model listed are the Part Numbers and/or Assembly Numbers for the Series used IN ADDITION TO or IN PLACE OF the parts illustrated and shown on the Basic Parts List preceding this Model Variations List. Refer to other sections of this Manual when Assembly Numbers are given to find the Parts List for these assemblies.

See page (a) on "How to Identify Your Clinton Engine." Use the preceding Basic Parts List except as shown below.

ENGINE MODEL — See page (a), "How to Identify Your Clinton Engine."	FOOTNOTES (Check page 4).	BASE—ENGINE (Part Numbers Shown). Refer to Sec. IV, Div. A for further information.	CONTROL GROUP (Control Group Illustration Numbers Shown). Refer to Sec. III, Div. D for Parts List.	CONTROL CABLE LENGTH — Replacement cable is furnished in 72" length ONLY, cut to length shown.	CRANKSHAFT (Part Numbers Shown). Refer to Sec. IV, Div. B for details and further information.	BEARING—MAIN (Part Numbers Shown). Refer to Illustrated Basic Parts List for corresponding part.	BLOCK ASSEMBLY — CYLINDER (Part Numbers Shown). Refer to Illustrated Basic Parts List for corresponding Part.	STARTER—RECOIL. Refer to Sec. III, Div. H for proper identification and Parts List.	HOUSING ASSEMBLY — BLOWER (Part Numbers Shown). Refer to Basic Parts List for corresponding part.	REDUCTION GEAR (Assy. Nos. Shown). Refer to Sec. III, Div. C for Parts List.	MOUNTING POSITION
D-700-2101		6025									
D-700-2102	No Variation—Use Basic Parts List										
D-700-2103								Yes	7913-A		
D-700-2104		6025						Yes	7913-A		
D-700-2105	No Variation—Use Basic Parts List										
D-700-2106								Yes	7913-A		
D-700-2107		6025	SK555	72"							
D-700-2108			SK555	72"							
D-700-2109		6025									
D-700-2110		6025						Yes	7913-A		
D-700-2111								Yes	7913-A		
D-700-2112		6025	SK555	72"							
D-700-2113			SK555	72"							
D-700-2114			SK555	72"				Yes	7913-A		
D-700-2116			SK557	72"							
D-700-2117	Note 2	6025									
D-700-2120		6025	SK558	72"				Yes	7913-A		
D-700-2129	Note 23										
D-700-2130	Note 13	6025									
D-700-2134			SK558	72"	6235		7969-A				
D-700-2136			SK558					Yes	7913-A		
D-700-2138	Note 14		SK555	72"							
D-700-2139	Note 2		SK555	72"				Yes	7913-A		
D-700-2140		6025	SK555	72"				Yes	7913-A		
D-700-2141	No Variation—Use Basic Parts List										
D-700-2142	Note 2		SK555				7968-A				
D-700-2143					6059-1						
D-700-2144	Note 2							Yes	7913-A		
D-700-2145			SK558								
D-700-2146	Note 21				6013	7972	7907				
D-700-2147	Note 22										
D-700-2148	Note 18										
D-700-2149	Note 18							Yes	7913-A		
D-700-2150	No Variation—Use Basic Parts List										

CLINTON

S E R I E S
D-700-2000
L O N G L I F E

MODEL VARIATIONS

MODEL VARIATIONS OF D-700-2000 SERIES (Cont.)

ENGINE MODEL	FOOTNOTES	BASE—ENGINE	CONTROL GROUP	CONTROL CABLE LENGTH	CRANKSHAFT	BEARING—MAIN	BLOCK ASSEMBLY—CYLINDER	STARTER—RECOIL	HOUSING ASSEMBLY—BLOWER	REDUCTION GEAR	MOUNTING POSITION
D-700-2151			SK561								
D-700-2152	Note 26								7908-E		
D-700-2153	Note 26							Yes	7914-F		
D-700-2154			SK557								
D-700-2155	Note 2		SK555	72"				Yes	7913-A		
D-700-2156	Note 29	6025									
D-700-2157		6025	SK555					Yes	7913-A		
D-700-2158			SK555					Yes	7913-A		
D-700-2159	No Variation—Use Basic Parts List										
D-700-2160		6025	SK555								
D-700-2162		6025									
D-700-2163	Note 28										
D-700-2500	No Variation—Use Basic Parts List										
D-700-2503	Note 23										
D-700-2507	No Variation—Use Basic Parts List										
D-720-2000	Note 11				6091-1					3552	6:00
D-720-2101	Note 11	6025			6091-1					3552	6:00
D-720-2103	Note 11	6025			6091-1					3552	12:00
D-720-2104	Notes 11, 23				6091-1					3552	6:00
D-720-2105	Note 11				6091-1					3552	6:00
D-740-2000	Note 11				6089-1					3554	6:00
D-740-2101	Notes 11, 23				6089-1					3554	6:00
D-740-2102	Note 11	6025			6089-1					3554	6:00
D-760-2000	Note 11				6049-1					3800	6:00
D-760-2100	Note 11	6025			6049-1					3800	6:00
D-760-2101	Note 11				6049-1			Yes	7913-A	3800	6:00
D-760-2102	Note 11	6025	SK555	72"	6049-1					3800	6:00
D-760-2103	Note 11		SK555	72"	6049-1			Yes	7913-A	3800	6:00
D-760-2104	Notes 3, 11		SK558	54"	6049-1			Yes	7913-A		
D-760-2109	Note 11		SK558	72"	6049-1					3800	6:00
D-760-2110	Note 11				6049-1					3800	6:00
D-760-2111	Note 11				6049-1			Yes	7913-A	3800	6:00
D-760-2112	Note 11				6049-1					3800	9:00
D-760-2113	Note 11	6025	SK555	72"	6049-1			Yes	7913-A	3800	9:00
D-760-2114	Note 11	6025	SK555	72"	6049-1					3800	6:00
D-760-2115	Notes 11, 23				6049-1					3800	6:00
D-760-2116	Notes 3, 11		SK558	54"	6049-1					3800	6:00
D-760-2117	Note 11				6049-1			Yes	7913-A	3800	6:00
D-760-2118	Note 11		SK555		6049-1			Yes	7913-A	3800	12:00
D-760-2119	Note 11				6049-1			Yes	7913-A	3800	9:00
D-760-2121	Note 11				6049-1					3800	6:00
D-760-2122	Note 11		SK555	72"	6049-1			Yes	7913-A	3800	9:00
D-760-2123	Notes 11, 27				6049-1					3800	9:00
D-760-2124	Note 11				6049-1					3800	6:00
D-760-2125	Note 11		SK555		6049-1					3800	12:00
D-760-2126	Note 11	6025	SK555		6049-1					3800	6:00

CLINTON

S E R I E S
D-700-2000
L O N G L I F E

**MODEL
VARIATIONS**
**SEC. II DIV. D-700-2000
PARTS CATALOG**
 Revised January, 1959
 Supersedes March, 1958

MODEL VARIATIONS OF D-700-2000 SERIES (Cont.)

ENGINE MODEL	FOOTNOTES	BASE— ENGINE	CONTROL GROUP	CONTROL CABLE LENGTH	CRANKSHAFT	BEARING— MAIN	BLOCK ASSEMBLY— CYLINDER	STARTER— RECOIL	HOUSING ASSEMBLY— BLOWER	REDUCTION GEAR	MOUNTING POSITION
D-760-2127	Note 11		SK555		6049-1			Yes	7913-A	3800	6:00
D-760-2128	Note 11		SK555		6049-1					3800	6:00
D-760-2500	Note 11				6049-1					3800	6:00
D-760-2501	Notes 11, 23				6049-1					3800	6:00
D-790-2000	Note 7				7924	3670	7966-A				
D-790-2102	Note 7	6025			7924	3670	7970-A				
D-790-2103	Notes 7, 12	7922			7926	3670	7967-A				
D-790-2105	Note 7	6025	SK555	72"	7924	3670	7966-A	Yes	7913-A		
D-790-2107	Note 7		SK555	72"	7924	3670	7966-A	Yes	7913-A		
D-790-2108	Notes 7, 8		SK561		7927	3670	7970-A				
D-790-2109	Notes 7, 23	6025	SK561	72"	7927	3670	7970-A				
D-790-2111	Notes 7, 28				7924	3670	7970-A				
D-790-2112	Note 7		SK561		7927	3670	7970-A				
D-790-2113	Note 7		SK561		7927	3670	7970-A				
D-790-2114	Notes 7, 20	6025	SK561		7927	3670	7966-A				
D-790-2115	Notes 7, 14		SK561		7929	3670	7970-A	Yes	7913-A		
D-790-2117	Notes 7, 28	6025	SK561		7927	3670	7970-A				
D-790-2118	Notes 7, 23				7924	3670	7970-A				
D-790-2119	Notes 7, 15		SK561		7929	3670	7970-A				
D-790-2120	Note 7				7924	3670	7970-A				
D-790-2121	Note 7		SK561		7927	3670	7970-A	Yes	7913-A		
D-790-2122	Note 7		SK561		8000	3670	7970-A				
D-790-2123		6025			8002	3670	7971-A	Yes	7913-A		
D-790-2124	Notes 7, 14		SK561		7929	3670	7970-A				
D-790-2125	Notes 7, 23		SK561		7927	3670	7970-A				
D-790-2126	Note 7		SK561		7929	3670	7970-A				
D-790-2127	Notes 7, 18, 19		SK555		7924	3670	7966-A	Yes	7913-A		
D-790-2128	Note 7		SK561		7929	3670	7970-A				
D-790-2129	Note 7				7924	3670	7970-A				
D-790-2130	Notes 7, 24		SK561		7929	3670	7970-A				
D-790-2131	Notes 7, 25		SK561		8001	3670	7973-A				
D-790-2132	Notes 7, 14, 27		SK561		7929	3670	7970-A				
D-790-2133	Notes 7, 9		SK561		7929	3670	7970-A				
D-790-2134	Notes 7, 9, 23		SK561		7929	3670	7970-A				
D-790-2135	Notes 7, 17, 21 30, 31		SK555		8003	3670	7974-A	Yes	7913-A		
D-790-2136	Note 7				7924	3670	7966-A				
D-790-2137	Notes 7, 14		SK561		7929	3670	8010				
D-790-2138	Note 7				7924	3670	7970-A				
D-790-2139	Note 7				7924	3670	7970-A	Yes	7913-A		
D-790-2140	Notes 7, 24		SK561		7929	3670	7970-A	Yes	7913-A		
D-790-2500	Note 7				7924	3670	7966-A				
D-790-2501	Notes 7, 28		SK561		7927	3670	7970-A				
D-790-2504	Notes 7, 23		SK561		7927	3670	7970-A				
D-790-2507	Note 7				7924	3670	7966-A				
D-790-2509	Note 7		SK561		7927	3670	7970-A				
D-790-2510	Note 7		SK561		7929	3670	7970-A				

MODEL VARIATIONS OF D-700-2000 SERIES (Cont.)

- NOTE 1—#3576 Connector, #C3500-A Valve and Filter Assembly—Shut-Off and #5052 Connector—Fuel Line used on this model.
- NOTE 2—Muffler #4500 and Nut #4425 used on this model in lieu of #3639.
- NOTE 3—#7950-A Horn—Air, #7951 Tube—Breather and #10353 Sleeve—Connector—Breather Line used on this model.
- NOTE 4—#4419 Elbow (90°) and #4425 Nut—Lock used as additional parts.
- NOTE 5—#7940 Bracket—Fuel Tank, #7947 Spacer—Fuel Tank Bracket and #5656 Screw used on this model.
- NOTE 6—#7956-A Plate Assembly—Bearing and #P-5573 Lead—Hi-Tension—Magneto used on this model.
- NOTE 7—#3669 Seal—Oil used in lieu of #3026.
- NOTE 8—#7954 Spacer—Cylinder Head Bolt and (2) #5656 Screws used as additional parts.
- NOTE 9—#2000-A Cleaner Assembly—Air used in lieu of #4512-A.
- NOTE 10—#7952-D Plate Assembly—Bearing, #P-5568-A Wire Assembly—Ignition, Shorting, #P-5566 Grommet and #5443 Screw used as additional parts.
- NOTE 11—Use #3136 Oil Seal in lieu of #3026.
- NOTE 12—Use #5095-1 Cap Assembly in lieu of #3295.
- NOTE 13—Use #4521 Muffler.
- NOTE 14—Use #5715-A Shorting Wire Assembly, #7963-A Bearing Plate Assembly, #P-5566 Grommet and #5644 Screw.
- NOTE 15—Use #4205 Yoke and Weight Assembly.
- NOTE 16—Use #16336 Spring Governor.
- NOTE 17—Use #12062-A Muffler and #12061 Nipple.
- NOTE 18—Use #4546-A Air Cleaner.
- NOTE 19—Use #5715-A Shorting Wire Assy., #7919-A Bearing Plate, #P-5573-A Hi-Tension Lead, and #P-5575-A Cover Assy.
- NOTE 20—Use #2129-A Air Cleaner.
- NOTE 21—Refer to Fuel Pump Parts List—Sec. III.
- NOTE 22—Refer to L/P Gas Parts List—Sec. III.
- NOTE 23—Use Kerosene Parts: #3390 Cylinder Head, #3576 Nipple, #4584 Valve (3-way), and #4585 Priming Cup.
(Parts stocked by factory only.)
- NOTE 24—Use Radio Shielding Parts: #7964-A Bearing Plate, #P-5573-A Hi-Tension Lead, and #P-5575-A Cover Assembly.
and #5647 Screw.
- NOTE 25—Use #3390 Cylinder Head, #7954 Spacer, #5691 Screw, and #3232-G Screw & L'Washer.
- NOTE 26—Use #7905 Head (cylinder), #4092-A Strap and Bracket Assembly (2), #4105 Tank, #5051 Valve, #5421-A Screw & L'Washer Assembly (2), #3059-1 Cup, #7178 Spacer (2), #7205-A Screw & L'Washer (2).
- NOTE 27—Use #6453 Horn, #7938 Cover, #10352 Line, Flexible, #10353 Sleeve, Connector.
- NOTE 28—Use Kerosene Parts: #3390 Head, #3576 Nipple, #4525 Tee, #4527 Priming Cup, #5652 Screw.
- NOTE 29—Use #4882-A Pulley Assembly—Starter.
- NOTE 30—Use #7919-A Plate Bearing, #4186-A Wire Assembly, #P-5566 Grommet, #5644 Screw, #P-5573-A Lead Assembly, #P-5575-A Cover Assembly, and #5647 Screw.
- NOTE 31—Use #7905 Head, #6014 Bracket, #7236-G Screw and L'Washer (2), and 3632-G Screw and L'Washer.