

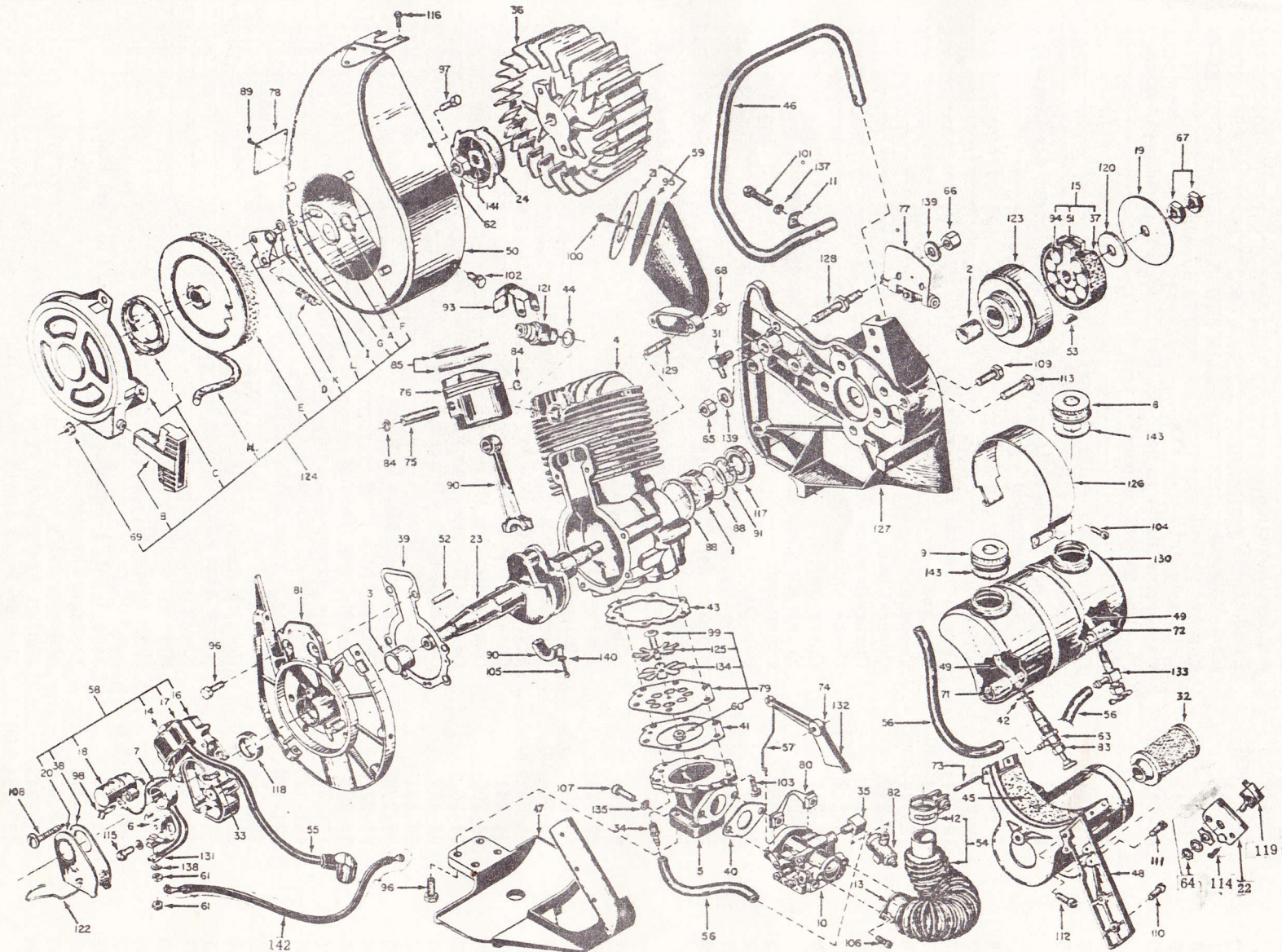

CHAINSAW BASIC PARTS LIST D25-1000

Sec. II, Div. D-25-1000
Basic Parts List
Supersedes Oct. 1962
Revised July 1964



Printed in U.S.A.

D-25-1000 BASIC PARTS LIST

Ref. No.	Part No.	Description	Qty.
1	20-4	Bearing-Ball, Main -----	1
2	20-234	B earing-Sprocket, Pre-sized -----	1
3	20-221	B earing-Sleeve, Bearing Plate -----	1
4	22-622	Block-Cylinder -----	1
5	26-545	Bracket-Induction -----	1
6	135-7-500	Breaker A ss'y -----	1
7	157-31	Cam- M agneto -----	1
8	45-197-500	Cap Ass'y-Fuel -----	1
9	45-197-500	Cap Ass'y-Oil -----	1
10	39-772-500	Carburetor-Refer to Sec. III, Div. A for Ill. parts break down. Use 39-913 carburetor repair kit. -----	1
11	81-87	Clamp-Handle -----	2
12	81-162	Clamp-Hose Air Filter (Upper) -----	1
13	81-159	Clamp-Hose Air Filter (Lower) -----	1
	81-139	C lamp-Air Cleaner Cover (Used with Wire Screen Air Cleaner) Not Illustrated -----	1
14	81-20	Clip-Core -----	1
15	44- 90-500	Clutch Ass'y -----	1
16	135- 37-500	Core & Breaker Box Ass'y (Incl. Ref. No. 17) -----	1
17	135- 13-990	Coil Ass'y -----	1
18	135- 29-990	Condenser -----	1
19	45- 279	Cover-Clutch -----	1
20	45-15	Cover-Breaker Box -----	1
21	45-342	Cover-Muffler (Horn Type) -----	1
22	45-259	Cover-Switch -----	1
	45-257	Cover-Air Cleaner (Used with Wire Screen Element) Not Ill. -----	1
23	46-833	Crankshaft -----	1
24	265-9	Cup-Starter -----	1
31	69-24	Elbow-Bayonet (Main Strut) -----	1
32	2-167	Element-Air Cleaner & Cover (Paper Type) -----	1
	2-128-500	Element-Wire Screen ----- Note: When using wire screen element, 45-257 cover must be used.	1
33	94-189	F elt-Cam Wiper -----	1
34	69-123	F itting-Bayonet (Impulse Hose) -----	1
35	69-278	F itting-Elbow (Carburetor) -----	1
36	83-62-500	F lywheel Ass'y -----	1
37	44-85-500	F riction & Steel Ban Ass'y -----	1
38	94-241	Gasket-Dust Cover -----	1
39	94-105	Gasket-Bearing Plate -----	1
40	94-30	Gasket-Carburetor to Induction Bracket -----	1
41	94-438	Gasket-Induction Bracket to Reed Plate -----	1
42	94-281	Gasket-Oil P ump -----	1
43	94-360	Gasket-Reed P late to Block -----	1
44	94-92-990	Gasket-Spark P lug -----	1
45	94-296	G asket-Tank (S addle) -----	1
46	121-203	Handle-Frame (Ca n Use 121-197) -----	1
47	121-190	Handle & L. Mounting Casting -----	1
48	121-189	Handle & Tank Saddle Casting -----	1
49	158-274	Hose-(1) Fuel & (1) Oil -----	2
50	259-668-500	Housing Ass'y-Blower -----	1
51	44-88-500	Hub & Arm Ass'y-Clutch -----	1
52	148-4	Key-Flywheel -----	1
53	148-24	Key-Woodruff -----	1
54	158-421	Hose Ass'y-Air -----	1
55	307-348-500	Lead-Wire -----	1
56	158-25	Line-1-Oil, 1-Impulse & 1-Fuel Shut-Off to Fuel Pump -----	3
57	159-112	Linkage-Throttle -----	1
58	268-6-500	Magneto Ass'y -----	1
59	170-149	Muffler Ass'y-Horn Type -----	1
	170-154-500	Muffler-Delux Low Tone (Not Ill.) ----- Muffler consists of following parts: 900-355 cover, 81-121 tab lock, 258-811 screw, (2) 183-176 nut, (2) 263- 379 spring, 257-99-500 screen ass'y, (2) 24-77 stud, 170-110 body-muffler, 215-512 plate baffle, 17-61 baffle, 170-154 center piece.	1
60	183-141	Nut- R eed Plate -----	1

Ref. No.	Part No.	Description	Qty.
61	183-21	Nut-Hex. #8-32 (Term.) -----	2
62	183-68-990	Nut-Hex. (Flywheel) -----	1
63	183-12	Nut-Oil Pump -----	1
64	183-60	Nut-Hex. Shorting Switch -----	2
65	183-195	Nut-Stud to Main Casting -----	2
66	183-190	Nut-Guide Bar Stud -----	2
67	183-131	Nut-Jam -----	2
68	183-29-500	Nut & L'Washer Ass'y-(Muffler Stud) (Horn Type) -----	2
69	183-25-500	Nut & L'Washer Ass'y-(Recoil Starter) -----	4
71	25-28	Pick-up with Screen-Oil -----	1
72	25-38	Pick-up with Screen-Fuel -----	1
73	203-137	Pin-Roll (Tank Saddle) -----	1
74	203-107	Pin-Roll (Trigger Throttle) -----	1
75	203-157	Pin-Wrist -----	1
76	204-87-500	Piston Ass'y-Std. -----	1
	206-87-500	.010 Oversize -----	
	207-87-500	.020 Oversize -----	
77	215-368-500	Plate-Guide Bar Mounting Chain Tension -----	1
78	137-387	Plate-Identification -----	1
79	215-444-500	Plate Ass'y-Reed -----	1
80	215-332-500	Plate Ass'y-Retaining, Carburetor -----	1
81	215-491-500	Plate-Bearing Ass'y -----	1
82	220-122-500	Pump-Fuel -----	1
83	220-144-500	Pump Ass'y-Oil -----	1
84	232-40	Ring-Lock, Wrist Pin -----	2
85	233-115-500	Ring Set-Standard -----	1
	235-127-500	Ring Set-Oversize (.010) -----	1
	237-127-500	Ring Set-Oversize (.020) -----	1
	233-144-500	Chrome Re-Ring Set, Std. -----	1
	237-144-500	Chrome Re-Ring Set, .020 -----	1
88	232-83	Ring-Retaining (Bearing) -----	2
89	244-21	Rivet-Name Plate -----	4
90	245-110-500	Rod & Cap Ass'y-(Incl. Ref. Nos. 105 & 140) -----	1
91	232-73	Retainer-Tru Arc -----	1
	232-160	Retainer-Air Cleaner (Paper Type) Not Ill. -----	1
93	232-162	Retainer-Ignition Cable (To Spark Plug) -----	1
94	44-46	Roller-Clutch -----	8
95	257-92	Screen-Muffler (Horn Type) -----	1
96	258-43	Screw-(6) Bearing Plate to Block-(4) Handle to Ind. Brkt. -----	10
97	258-602	Screw-Blower Housing to Bearing Plate -----	1
98	258-299	Screw-Condenser -----	1
99	258-516	Screw-Reed Plate -----	1
100	258-40-500	Screw-Muffler Cover -----	2
101	258-569	Screw-H. H. 1/4-20 x 1/2 (Handle) -----	2
102	258-280-500	Screw & L'Washer Ass'y-Blower Housing to Block -----	3
103	258-586-500	Screw & Nylock Ass'y-Induction Bracket -----	6
104	258-592-500	Screw & L'Washer Ass'y-Tank Strap -----	2
105	258-29	Screw-Cap to Rod -----	2
106	258-198-500	Screw-Clamp to Carburetor -----	2
107	258-263-500	Screw & L'Washer-1-20 x 7/8 (Carb. to Induction Bracket) -----	2
108	258-108-500	Screw-Magneto to Bearing Plate -----	2
109	258-281-500	Screw-H. H. 5/16-18 x 7.8 (Main Strut to Block) -----	4
110	258-677-500	Screw & Nylock Ass'y-Handle -----	2
111	258-681-500	Screw & Nylock Ass'y-Tank Saddle to L. Handle -----	1
112	258-751	Screw-H. H. 5/16-18 x 1-1/4 (Main Cast. to Saddle) -----	2
113	258-692-500	Screw & Nylock Ass'y-Tank Saddle to Main Casting -----	1
114	258-680	Screw-Switch Cover to Saddle Casting -----	2
115	258-297-500	Screw & L'Washer Ass'y-Breaker Points -----	1
116	258-40-500	Screw & L'Washer Ass'y-Blower Housing to Head -----	3
117	94-301	Seal-Oil (Cylinder Block) -----	1
118	94-257	Seal-Oil (Bearing Plate) -----	1
119	266-53-500	Shorting Ass'y-Ignition -----	1
120	304-373	Spacer-Clutch Cover -----	1
121	267-81-500	Spark Plug & Gasket Ass'y -----	1
122	263-10	Spring-Breaker Box Cover -----	1
123	106-241-500	Sprocket-Clutch Cup & Bearing (404 Pitch 7 Tooth-Open Spur) -----	1
124	265-215-500	Starter Ass'y -----	1
125	293-97	Stop-Reed -----	1
126	26-445	Strap-Tank Retainer (For Round Tank) -----	1
	26-446	Strap-Tank Retainer (For Teardrop Tank) -----	1

Ref. No.	Part No.	Description	Qty.
127	26-477	Strut- Main -----	1
128	24-70	Stud- Guide Bar -----	2
129	24-11	Stud- Muffler to Block (Horn Type) -----	2
130	277-406-500	Tank Ass'y- Fuel (Round Type) -----	1
	277-285-500	Tank Ass'y- Fuel (Teardrop Type) -----	1
131	307-230	Terminal-Jamtite -----	1
132	157-296	Trigger-Throttle -----	1
133	293-122	Valve-Fuel Shut-Off -----	1
134	293-96	Valve-Reed -----	1
137	304-26	Washer-Lock (Handle) -----	2
138	304-290	Washer-Terminal -----	1
139	304-337	Washer-(2) Plate Chain Tension -----	2
140	304-10	Washer-Connecting Rod Screw -----	2
141	304-5	Washer-Lock (Flywheel) -----	1
142	307-120-500	Wire Ass'y-(Ignition Shorting) -- -----	1
143	94-275	Gasket Cork -Fuel Cap & Oil Cap -----	2

RECOIL STARTER PARTS-(For Recoil **265-215-500**)

A	157-1	Actuator -----	1
B	121-6	Handle -----	1
C	124-8-500	Housing-Incl. Recoil Spring -----	1
D	157-352-500	Pawl & Pin Assembly -----	1
E	219-154-500	Pulley Assembly -----	1
		Latest pulley has been redesigned and now used 258-272-500 screw & l'washer ass'y and 304-624 spacer to retain pawl & pin ass'y to pulley. These parts replace the 304-320 washer and 232-35 ring retainer.	
F	232-147	Ring-Retaining -----	1
G	232-35	Ring-Retaining -----	1
H	246-7	Rope -----	1
I	263-133	Spring-Actuator -----	1
J	263-79	Spring-Recoil -----	1
K	263-322	Spring -----	1
L	304-320	Washer -----	1

* Below is a list of D-25-1000 model variations. Refer to name plate on chainsaw for model number then to model variation listing for parts other than standard. If the part you are looking for is not listed in the model variation listing, refer to D-25-1000 parts list for correct part.

D-25-1103	Refer to Standard D-25-1000 Series Chainsaw Parts List.
D-25-1105	Refer to Standard D-25-1000 Series Chainsaw Parts List.
D-25-1107	Refer to Standard D-25-1000 Series C hainsaw Parts List.
D-25-1113	Refer to Standard D-25-1000 Series C hainsaw Parts List.
D-25-1114	Refer to Standard D-25-1000 Series C hainsaw Parts List.
D-25-1115	Short Block Assembly for D-25-1000 Series Chainsaws (Part No. 194-648).
D-25-1116	Refer to Standard D-25-1000 Series Chainsaw Parts List.
D-25-1117	Refer to Standard D-25-1000 Series Chainsaw Parts List.
D-25-1118	Refer to Standard D-25-1000 Series Chainsaw Parts List.
D-25-1119	Refer to Standard D-25-1000 Series Chainsaw P arts List.
D-25-1120	Use Delux Low-Tone Muffler Listed in Standard D-25-1000 Parts List.

*NOTE: Use 26-550 Spike Bumper, (2) 258-904-500 Screws where applicable.