

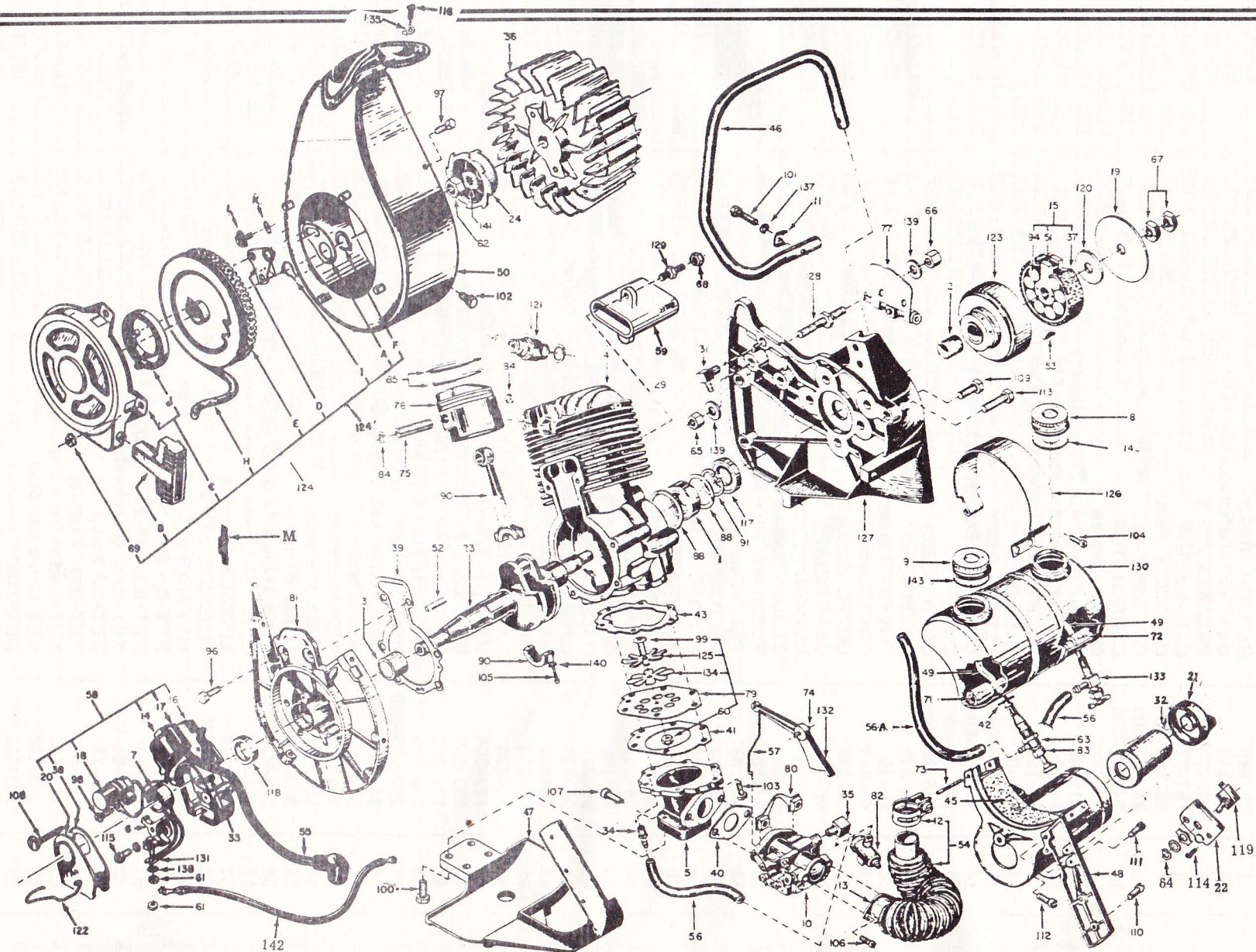

# CHAINSAW BASIC PARTS LIST D25-3000

SEC. II, DIV. D-25-3000  
BASIC PARTS LIST  
ISSUED JANUARY 1, 1972



Printed in U. S. A.

Ref. No.	Part No.	Description	Qty.
1	20-4	BEARING-Ball, Main	1
2	20-234	BEARING-Sprocket, Pre-Sized	1
3	20-256	BEARING-Sleeve, Bearing Plate	1
4	22-846	BLOCK-Cylinder	1
5	26-545	BRACKET-Induction	1
6	135-7-500	BREAKER ASS'Y	1
7	157-31	CAM-Magneto	1
8	45-197-500	CAP ASS'Y-Fuel	1
9	45-197-500	CAP ASS'Y-Oil	1
10	39-772-500	CARBURETOR	1
11	81-87	CLAMP-Handle	2
12	81-162	CLAMP-Hose Air Filter (Upper)	1
13	81-159	CLAMP-Hose Air Filter (Lower)	1
	81-139	CLAMP-Air Cleaner Cover (Not Illustrated)	1
	81-20	CLIP-Core	1
15	44-90-500	CLUTCH ASS'Y	1
16	135-37-500	CORE & BREAKER BOX ASS'Y-(Incl. Ref. No. 17)	1
17	135-13-990	COIL ASS'Y	1
18	135-29-990	CONDENSER	1
19	45-279	COVER-Clutch	1
20	45-15	COVER-Breaker Box	1
21	45-257	COVER-Air Cleaner	1
22	45-259	COVER-Switch	1
23	46-833	CRANKSHAFT	1
24	265-9	CUP-Starter	1
31	69-24	ELBOW-Bayonet (Main Strut)	1
32	2-128-500	ELEMENT-Wire Screen	1
33	94-189	FELT-Cam Wiper	1
34	69-123	FITTING-Bayonet (Impulse Hose)	1
35	69-278	FITTING-Elbow (Carburetor)	1
36	83-62-500	FLYWHEEL ASS'Y	1
37	44-85-500	FRICITION & STEEL BAND ASS'Y	1
38	94-241	GASKET-Dust Cover	1
39	94-105	GASKET-Bearing Plate	1
40	94-30	GASKET-Carburetor to Induction Bracket	1
41	94-438	GASKET-Induction Bracket to Reed Plate	1
42	94-281	GASKET-Oil Pump	1
43	94-360	GASKET-Reed Plate to Block	1
45	94-296	GASKET-Tank (Saddle)	1
46	121-204	HANDLE-Frame	1
47	121-190	HANDLE & L. MOUNTING CASTING	1
48	121-189	HANDLE & TANK SADDLE CASTING	1
49	158-467	HOSE-(1) Fuel & (1) Oil	2
50	259-705-500	HOUSING ASS'Y-Blower	1
51	44-88-500	HUB & ARM ASS'Y-Clutch	1
52	148-4	KEY-Flywheel	1
53	148-24	KEY-Woodruff	1
54	158-421	HOSE ASS'Y-Air	1
55	307-299-500	LEAD-Wire	1
56	158-25	LINE-1-Impulse & 1-Fuel Shut-Off to Fuel Pump	2
56A	158-374	LINE-Oil	1
57	159-112	LINKAGE-Throttle	1
58	268-6-500	MAGNETO ASS'Y	1
59	900-400	MUFFLER ASS'Y-Horn Type	1
60	183-141	NUT-Reed Plate	1
61	183-21	NUT-Hex. #8-32 (Term.)	2
62	183-68-990	NUT-Hex. (Flywheel)	1
63	183-12	NUT-Oil Pump	1
64	183-60	NUT-Hex. Shorting Switch	2
65	183-195	NUT-Stud to Main Casting	2
66	183-190	NUT-Guide Bar Stud	2
67	183-131	NUT-Jam	2
68	183-29-500	NUT & L'WASHER ASS'Y-(Muffler Stud) (Horn Type)	2
69	183-25-500	NUT & L'WASHER ASS'Y-Recoil Starter	4
71	25-38	PICK-UP WITH SCREEN-Oil	1
72	25-38	PICK-UP WITH SCREEN-Fuel	1

Ref. No.	Part No.	Description	Qty.
73	203-137	PIN-Roll (Tank Saddle) -----	1
74	203-107	PIN-Roll (Trigger Throttle) -----	1
75	203-61	PIN-Wrist -----	1
76	204-83	PISTON ASS'Y-Std. (Incl. Nos. 75, 84, 85) -----	1
	206-80	PISTON ASS'Y-.010 Oversize -----	
	207-73	PISTON ASS'Y-.020 Oversize -----	
77	215-368-500	PLATE-Guide Bar Mounting Chain Tension -----	1
79	215-444-500	PLATE ASS'Y-Reed -----	1
80	215-332-500	PLATE ASS'Y-Retaining, Carburetor -----	1
81	215-491-500	PLATE-Bearing Ass'y -----	1
82	220-122-500	PUMP-Fuel -----	1
83	220-144-500	PUMP ASS'Y-Oil -----	1
84	232-40	RING-Lock, Wrist Pin -----	2
85	233-114-500	RING SET-Std. -----	1
	235-128-500	RING SET-Oversize (.010) -----	1
	237-128-500	RING SET-Oversize (.020) -----	1
	233-142-500	CHROME RE-RING SET-Std. -----	1
	237-142-500	CHROME RE-RING SET-(.020) -----	1
88	232-148	RING-Retaining (Bearing) -----	2
90	245-110-500	ROD & CAP ASS'Y-(Incl. Ref. Nos. 105 & 140) -----	1
91	232-73	RETAINER-Tru-Arc -----	1
94	44-46	ROLLER-Clutch -----	1
96	258-43	SCREW-Bearing Plate to Block -----	6
97	258-602	SCREW-Blower Housing to Bearing Plate -----	1
98	258-299	SCREW-Condenser -----	1
99	258-516	SCREW-Reed Plate -----	1
100	258-864	SCREW-Handle to Induction Bracket -----	4
101	258-569-500	SCREW-H.H. 1/4-20 x 1/2 (Handle) -----	2
102	258-280-500	SCREW & L'WASHER ASS'Y-Blower Housing to Block -----	3
103	258-834	SCREW & NYLOCK ASS'Y-Induction Bracket -----	6
104	258-592-500	SCREW & L'WASHER ASS'Y-Tank Strap -----	2
105	258-29	SCREW-Cap to Rod -----	2
106	258-198-500	SCREW-Clamp to Carburetor -----	2
107	258-284-500	SCREW & L'WASHER-1-20 x 7/8 (Carb. to Induction Bracket) -----	2
108	258-108-500	SCREW-Magneto to Bearing Plate -----	2
109	258-281-500	SCREW-H.H. 5/16-18 x 7/8 (Main Strut to Block) -----	4
110	258-677-500	SCREW & NYLOCK ASS'Y-Handle -----	2
111	258-681-500	SCREW & NYLOCK ASS'Y-Tank Saddle to L. Handle -----	1
112	258-751	SCREW-H.H. 5/16-18 x 1-1/4 (Main Cast. to Saddle) -----	2
113	258-692-500	SCREW & NYLOCK ASS'Y-Tank Saddle to Main Casting -----	1
114	258-680	SCREW-Switch Cover to Saddle Casting -----	2
115	258-297-500	SCREW & L'WASHER ASS'Y-Breaker Points -----	1
116	258-120	SCREW & L'WASHER ASS'Y-Blower Housing to Head -----	2
117	94-301	SEAL-Oil (Cylinder Block) -----	1
118	94-257	SEAL-Oil (Bearing Plate) -----	1
119	266-53-500	SHORTING ASS'Y-Ignition Switch -----	1
120	304-373	SPACER-Clutch Cover -----	1
121	267-73-990	SPARK PLUG & GASKET ASS'Y -----	1
122	263-10	SPRING-Breaker Box Cover -----	1
123	106-241-500	SPROCKET-Clutch Cup & Bearing (404 Pitch 7 Tooth-Open Spur) -----	1
124	265-215-500	STARTER ASS'Y -----	1
125	293-97	STOP-Reed -----	1
126	26-445	STRAP-Tank Retainer (For Round Tank) -----	1
127	26-477	STRUT-Main -----	1
128	24-70	STUD-Guide Bar -----	2
129	24-11	STUD-Muffler to Block (Horn Type) -----	2
130	277-406-500	TANK ASS'Y-Fuel (Round Type) -----	1
131	307-230	TERMINAL-Jamtite -----	1
132	157-296	TRIGGER-Throttle -----	1
133	293-122	VALVE-Fuel Shut-Off -----	1
134	293-96	VALVE-Reed -----	1
135	304-88	WASHER-Tie Strap -----	2
138	304-290	WASHER-Terminal -----	1
139	304-337	WASHER-(2) Plate Chain Tension (2) Main Strut -----	4
140	304-10	WASHER-Connecting Rod Screw -----	2
141	304-622	WASHER-Lock (Flywheel) -----	1
142	307-120-500	WIRE ASS'Y-Ignition Shorting -----	1
143	94-275	GASKET CORK-Fuel Cap & Oil Cap -----	2

RECOIL STARTER PARTS-(For Recoil 265-215-500)

A	157-1	ACTUATOR -----	1
B	121-6-500	HANDLE -----	1
C	124-8-500	HOUSING-Incl. Recoil Spring -----	1
D	157-352-500	PAWL & PIN ASS'Y -----	1
E	219-28-500	PULLEY ASS'Y -----	1
F	232-147	RING-Retaining -----	1
H	246-7	ROPE -----	1
I	263-133	SPRING-Actuator -----	1
J	263-79	SPRING-Recoil -----	1
K	304-624	SPACER -----	1
L	258-985	SCREW -----	1
M	136-128	INSERT-Recoil Handle -----	1

**C39-772-500 CARBURETOR**

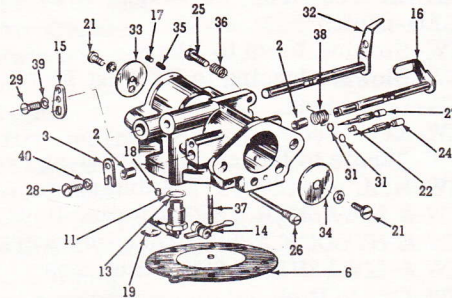

Basic Parts List

Ref. No.	Part No.	Description	Qty.	Ref. No.	Part No.	Description	Qty.
2	28-28	BUSHING-Throttle Shaft.	2	27	258-900-500	*SCREW-Main Adjustment	1
3	81-103	CLIP-Throttle Shaft	1	28	258-652	SCREW-Throttle Shaft Retaining	1
6	39-629	DIAPHRAGM-Fuel Pump	1	29	258-651	*SCREW-Throttle Lever Retaining	1
11	94-358	GASKET-Inlet Seat	1	30	258-647-500	SCREW & L'WASHER ASS'Y-Cover to Body	6
13	181-63-500	*INLET NEEDLE SEAT & GASKET	1	31	94-279	SEAL-Ring (1-Idle Adj. Screw) (1-Main Adj. Screw)	2
	39-913	KIT-Repair Parts NOTE: Parts With (*) Comprise Kit.		32	6-268-500	SHAFT & LEVER ASS'Y Choke	1
14	157-282-500	*LEVER-Inlet Control	1	33	39-241	SHUTTER-Choke	1
15	157-283	LEVER THROTTLE	1	34	293-102	SHUTTER-Throttle	1
16	6-269-500	LEVER-Throttle Shaft & Stop	1	35	263-239	SPRING-Choke Friction	1
17	216-63	PIN-Choke Friction	1	36	263-102	*SPRING-Idle Speed Screw	1
18	216-68	*PLUG-Body Channel, Cup	1	37	263-241	SPRING-Inlet Tension	1
19	216-31	*PLUG-Body Channel, Welch	1	38	263-240	*SPRING-Throttle Shaft Return	1
21	258-61-500	SCREW-(1-Choke Shutter, 1-Throttle Shutter)	2	39	304-390	*WASHER-Throttle Lever Retaining Lock	1
22	258-553	*SCREW-Diaphragm Chamber, Drain	1	40	304-353	WASHER-Throttle Shaft Clip Lock	1
24	258-899-500	*SCREW-Idle Adjustment	1				
25	258-654	*SCREW-Idle Speed Reg.	1				
26	258-653	*SCREW-Inlet Control Lever Pinion Screw	1				