

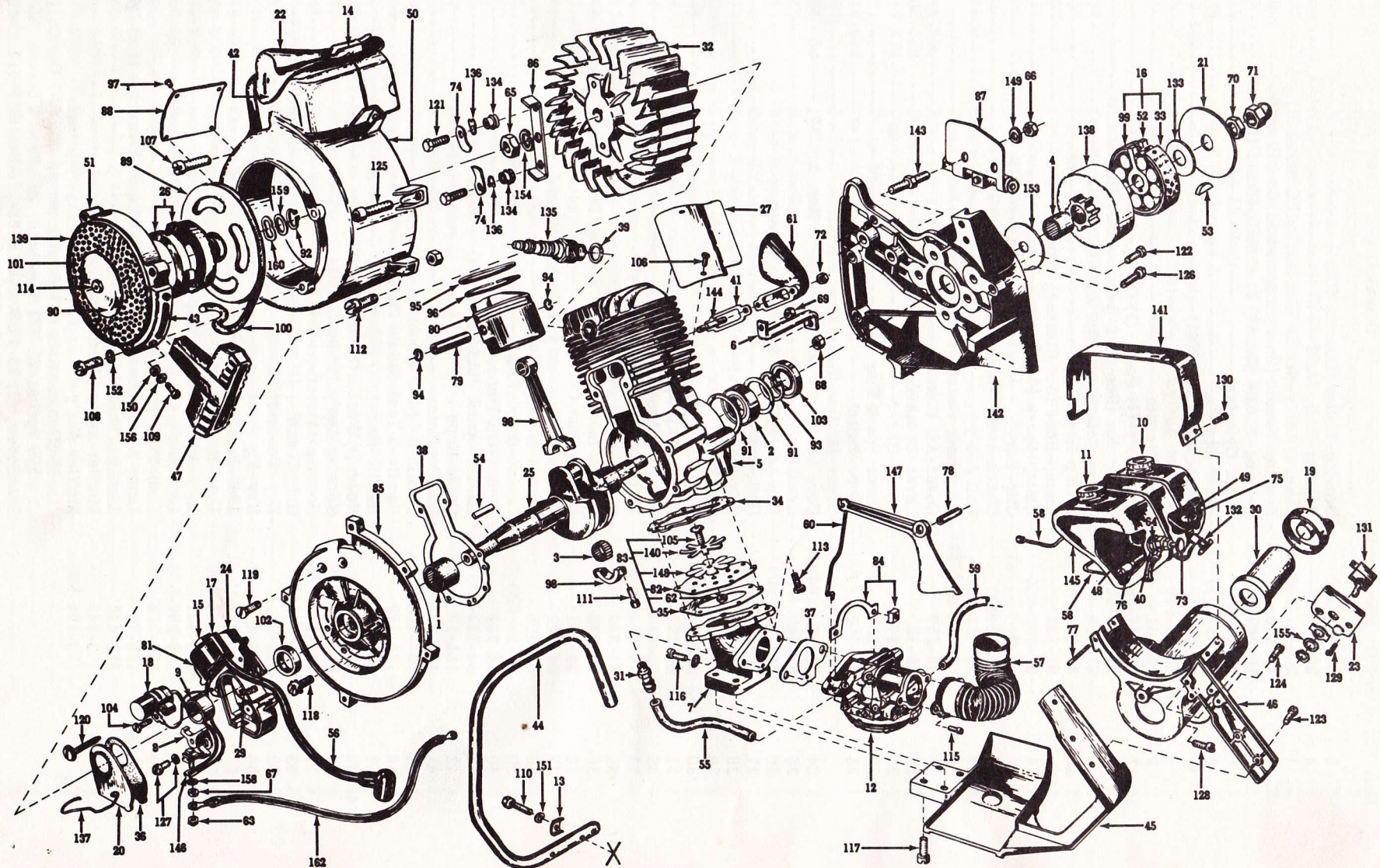

# CHAINSAW BASIC PARTS LIST D 55-1000

Sec. II, Div. D-55-1000  
Basic Parts List  
Revised July 1964  
Supersedes Oct. 1962



D-55-1000 BASIC PARTS LIST

Ref. No.	Part No.	Description	Qty.
1	20-198-990	Bearing-Roller (Bearing Plate) -----	1
2	20-4	Bearing-Ball, Main -----	1
3	20-197-500	Bearing Ass'y-Needle Wax-Bonded (Crankshaft) -----	1
4	20-153	Bearing-Needle (Used on Sprocket 106-239-500) -----	1
	20-202-500	Bearing-Needle (Set 34) Used on Sprocket 106-408 -----	1
5	22-805	Block-Cylinder -----	1
6	26-459	Brace-Strut -----	1
7	26-545	Bracket-Induction -----	1
8	135-7-500	Breaker Ass'y -----	1
9	157-31	Cam-Magneto -----	1
10-11	45-197-500	Cap Ass'y-(1) Fuel - (1) Oil -----	2
12	39-730-990	Carburetor (Use 39-913 Carburetor Repair Kit) -----	1
	81-139	Clamp-Hose (Air Filter Cover) Not Ill. -----	1
13	81-87	Clamp-Handle -----	5
	81-162	Clamp-Hose (Air Cleaner) Upper -----	1
14	81-132-500	Clamp-Spark Plug Cover -----	1
15	81-2	Clip-Core -----	1
16	44-90-990	Clutch Ass'y -----	1
17	135-13-500	Coil Ass'y -----	1
18	135-29-990	Condenser -----	1
19	45-257	Cover-Air Cleaner -----	1
20	45-15	Cover-Breaker Box -----	1
21	45-279	Cover-Clutch -----	1
22	45-256	Cover-Spark Plug -----	1
23	45-259	Cover-Switch -----	1
	45-342	Cover-Muffler (Horn Type) Not Ill. -----	1
24	135-37-500	Core & Breaker Box Ass'y (Incl. Ref. No. 17) -----	1
25	46-767	Crankshaft -----	1
26	263-251-500	Cup Ass'y-Recoil Spring -----	1
27	259-499	Deflector-Air -----	1
28	69-189	Elbow-Check Valve (Not Ill.) -----	1
29	94-189	Felt-Cam Wiper -----	1
30	2-128-500	Filter Ass'y-Air -----	1
31	69-123	Fitting-Bayonet -----	1
32	83-62-500	Flywheel Ass'y -----	1
33	44-85-500	Friction & Steel Band Ass'y -----	1
34	94-360	Gasket-Reed Plate to Block -----	1
35	94-438	Gasket-Induction Bracket to Reed Plate -----	1
36	94-241	Gasket-Dust Cover -----	1
37	94-242	Gasket-Carburetor to Induction Bracket -----	1
38	94-105	Gasket-Bearing Plate -----	1
39	94-92-990	Gasket-Spark Plug -----	1
40	94-281	Gasket-Oil Pump -----	1
42	94-362	Gasket-Spark Plug Cover -----	1
43	111-13	Guide-Rope -----	1
44	121-204	Handle-Frame -----	1
45	121-190	Handle & Lower Mounting Casting -----	1
46	121-189	Handle & Tank Saddle Casting -----	1
47	121-6	Handle-Starter -----	1
48-49	158-274	Hose-(1) Fuel - (1) Oil (Snake) -----	2
50	259-488-500	Housing Ass'y-Blower -----	1
51	124-119	Housing-Starter -----	1
52	44-88-500	Hub-Clutch -----	1
53	148-24	Key-Woodruff (Clutch) -----	1
54	148-4	Key-Flywheel -----	1
55	158-249	Line-Impulse -----	1
56	307-266-500	Lead-Hi-Tension -----	1
57	158-421	Line-Air Cleaner (Complete) -----	1
58	158-257-500	Line Ass'y-Oil -----	1
59	158-252	Line-Fuel -----	1
59-A	136-77	Liner Ass'y-Connecting Rod (Used with Aluminum Rod) Not Ill. --	2
60	159-112	Linkage-Throttle -----	1
61	170-149	Muffler Ass'y (Horn Type) -----	1
	170-154-500	Muffler Ass'y-Delux Low-Tone -----	1

Muffler consists of following parts: 900-355 Cover, (2) 263-379 Spring, 81-121 Tab Lock, 257-99-500 Screen, 258-811 Screw, (2) 24-77 Stud, (2) 183-176 Nut, 215-512 Plate Baffle, 17-61 Baffle, 170-154 Center Piece.

Ref. No.	Part No.	Description	Qty.
62	183-141	Nut-Reed Plate -----	1
63	183-21	Nut-(1) Shorting Wire - (1) Terminal -----	2
64	183-12	Nut-Oil Pump -----	1
65	183-158	Nut-Flywheel, H.H. 7/16-20 -----	1
66	183-195	Nut-Chain Tension -----	2
68	183-190	Nut-Stud to Main Casting -----	2
69	183-33	Nut-1/2-20, Brace to Bearing Plate -----	1
70	183-131	Nut-7/16-20, Jam -----	1
71	183-175	Nut-7/16, Acorn -----	1
72	183-29-500	Nut & L'Washer Ass'y-Muffler to Block -----	2
73	220-28	Oil Pump Ass'y (Button No. 101-201) -----	1
74	157-239	Pawl-Starter -----	2
75	25-38	Pickup-Fuel -----	1
76	25-28	Pickup-Oil -----	1
77	203-137	Pin-Roll, 1/8" x 1-1/2" (Tank Saddle) -----	1
78	203-107	Pin-Roll (Trigger) -----	1
79	203-157	Pin-Wrist -----	1
80	204-64	Piston-Standard -----	1
	206-64	.010 Oversize -----	1
	207-64	.020 Oversize -----	1
81	268-6-500	Magneto Ass'y -----	1
82		Plate-Reed-Not Serviced Separately (Order 215-444-500) -----	
83	215-444-500	Rlate Ass'y-Reed -----	1
84	215-332-500	Plate Ass'y-Retaining -----	1
85	215-416-500	Plate Ass'y-Bearing -----	1
86	215-437	Plate-Base Pawl -----	1
87	215-368-500	Plate Ass'y-Chain Tension -----	1
88	137-387	Plate-Identification -----	1
89	219-131-500	Pullery-Starter -----	1
90	232-113	Retainer-Screen -----	1
91	232-83	Ring-Retaining Bearing -----	2
92	232-109	Ring-Retaining Starter -----	1
93	232-73	Ring-Retaining Crank -----	1
94	232-40	Ring-Lock, Wrist Pin -----	2
95	232-118	Ring-Piston Lock -----	3
96	233-44	Ring-Piston Compression, Standard -----	3
	235-44	.010 Oversize -----	3
	237-44	.020 Oversize -----	3
	233-143-500	Chrome Re-Ring Set-Standard -----	
	237-143-500	Chrome Re-Ring Set-.020 -----	
97	244-75	Rivet-Cherry -----	4
98	245-118	Rod & Cap Ass'y (Includes Liner, Crankshaft Bearing) -----	1
99	44-46	Roller-Clutch -----	8
100	246-7	Rope-Starter -----	1
101	257-81	Screen-Starter -----	1
	257-92	Screwn-Muffler (Horn Type) Not Ill. -----	1
102	94-257	Seal-Oil (Bearing Plate) -----	1
103	94-301	Seal-Oil (Block) -----	1
104	258-299	Screw-Condenser -----	1
105	258-516	Screw-Reed Plate -----	1
106	258-81	Screw-R.H.S.T. 8-32 x 3/8 (Deflector) -----	2
107	258-643	Screw & Nylock Ass'y-1/4-20 x 1-1/2 (Blower Hsg. to Strut) -----	1
108	258-861	Screw-12-24 x 1, Pan Head (Starter) -----	4
109	258-845	Screw-10-24 x 1/2 (Pull Guide) -----	2
	258-40-500	Screw-Muffler to Cover (Not Ill.) Horn Type -----	2
110	258-569	Screw-H.H. 1/4-20 x 1-1/2 (Handle) -----	5
111	258-901	Screw-Cap to Rod -----	2
112	258-678-500	Screw & Nylock Ass'y (Blower Housing to Bearing Plate) -----	3
113	258-586-500	Screw & Nylock Ass'y-Induction Bracket -----	6
114	258-723-500	Screw-Oil Cup Ass'y -----	1
115	258-198-500	Screw-Clamp to Carburetor -----	2
116	258-106	Screw-1/4-20 x 7/8, Carburetor to Induction Bracket -----	2
117	258-692-500	Screw-Handle to Induction Bracket -----	4
118	258-588-500	Screw & Nylock Ass'y-Bearing Plate to Block -----	4
119	258-692-500	Screw-Bearing Plate to Block -----	2
120	258-108-500	Screw-Magneto to Bearing Plate -----	2
121	258-851-500	Screw & Nylock Ass'y-Pawl Plate to Flywheel -----	2
122	258-281-500	Screw-H.H. 5/16-18 x 7/8 (Main Casting to Block) -----	4
123	258-677-500	Screw & Nylock Ass'y-Tank Saddle to L. Handle -----	2
124	258-681-500	Screw & Nylock Ass'y-Tank Saddle to L. Handel -----	1

Ref. No.	Part No.	Description	Qty.
125	258-737	Screw-S.H.C. 1/4-20 x 1-1/2 (Blower Housing to Bearing Plate to Saddle) -----	1
126	258-751	Screw-H.H. 5/16-18 x 1-1/4 (Main Casting to Saddle) -----	2
127	258-297	Screw & L'Washer Ass'y-Breaker -----	1
128	258-673-500	Screw & Nylock Ass'y-Tank Saddle to Main Casting -----	1
129	258-680	Screw-Switch Cover to Saddle Casting -----	2
130	258-592-500	Screw & L'Washer Ass'y-Tank Straps -----	2
	258-904-500	Screw & L'Washer Ass'y-Spike Bumper (Not Ill.) -----	2
131	266-53	Shorting Ass'y-Ignition Switch -----	1
132	293-122	Shut-off Valve -----	1
133	304-373	Spacer-Clutch Cover -----	1
134	304-524	Spacer-Starter -----	2
135	267-73-500	Spark Plug (Used on Type B & C) -----	1
	267-66-500	Spark Plug (Used on Type A) -----	1
136	263-171	Spring-Starter Pawl -----	2
137	263-10	Spring-Breaker Box Cover -----	1
	26-550	Spike-Bumper (Not Ill.) -----	1
138	106-408	Sprocket Ass'y-.404" Pitch (Open Spur) -----	
	106-239-500	Sprocket Ass'y-1/2" Pitch (Open Spur) ----- (Use Sprocket as Required)	
139	265-160-500	Starter Ass'y-Recoil -----	1
140	293-97	Stop-Reed -----	1
141	26-446	Strap-Tank Retainer -----	1
142	26-477	Strut-Main -----	1
143	24-70	Stud-Guide Bar -----	2
144	24-11	Stud-Muffler to Block (Horn Type) -----	2
145	277-285-500	Tank Ass'y-Fuel -----	1
146	307-230	Terminal-Jamtite -----	1
147	157-296	Trigger-Throttle -----	1
148	293-96	Valve-Reed -----	1
149	304-337	Washer-Plate Chain Tension -----	3
150	304-318	Washer-#10 Lock (Starter) -----	2
151	304-26	Washer-Lock, Handle -----	5
152	304-532	Washer-Lock, Starter -----	4
153	304-430	Washer-Chain Guide -----	1
154	304-25	Washer-Lock (Flywheel) -----	1
155	304-368	Washer-Lock Shorting Switch -----	1
156	304-26	Washer-Lock, Internal Lock-1/4 (Starter) -----	2
157	304-134	Washer-Bearing Plate to Block, 1/2 Flat (Not Ill.) -----	4
158	304-290	Washer-Terminal -----	1
159	304-412	Washer-Retaining (Starter) -----	1
160	304-411	Washer-Wave (Starter) -----	1
161	304-525	Washer-Lead (Starter Rope) -----	1
162	307-265-500	Wire-Shorting -----	1

Below is a list of D-55-1000 model variations. Refer to name plate on chainsaw for model number then to model variation listing for parts other than standard. If the part you are looking for is not listed in the model variation listing, refer to D-55-1000 parts list for correct part.

D-55-1101	Use 277-274-500 Tank, 45-249-500 Cap Ass'y-Oil, 45-270-500 Cap Ass'y-Fuel, 26-445 Strap Tank, 106-239-500 Sprocket Ass'y.
D-55-1103	Refer to Standard D-55-1000 Parts List.
D-55-1105	Refer to Standard D-55-1000 Parts List.
D-55-1107	Use 106-239-500 Sprocket Ass'y.
D-55-1108	Refer to Standard D-55-1000 Parts List.
D-55-1110	Refer to Standard D-55-1000 Parts List.
D-55-1111	Refer to Standard D-55-1000 Parts List.
D-55-1112	Use 121-197 Handle.
D-55-1113	Refer to Standard D-55-1000 Parts List.
D-55-1114	Refer to Standard D-55-1000 Parts List.
D-55-1115	Refer to Standard D-55-1000 Parts List for Delux Low-Tone Muffler.