

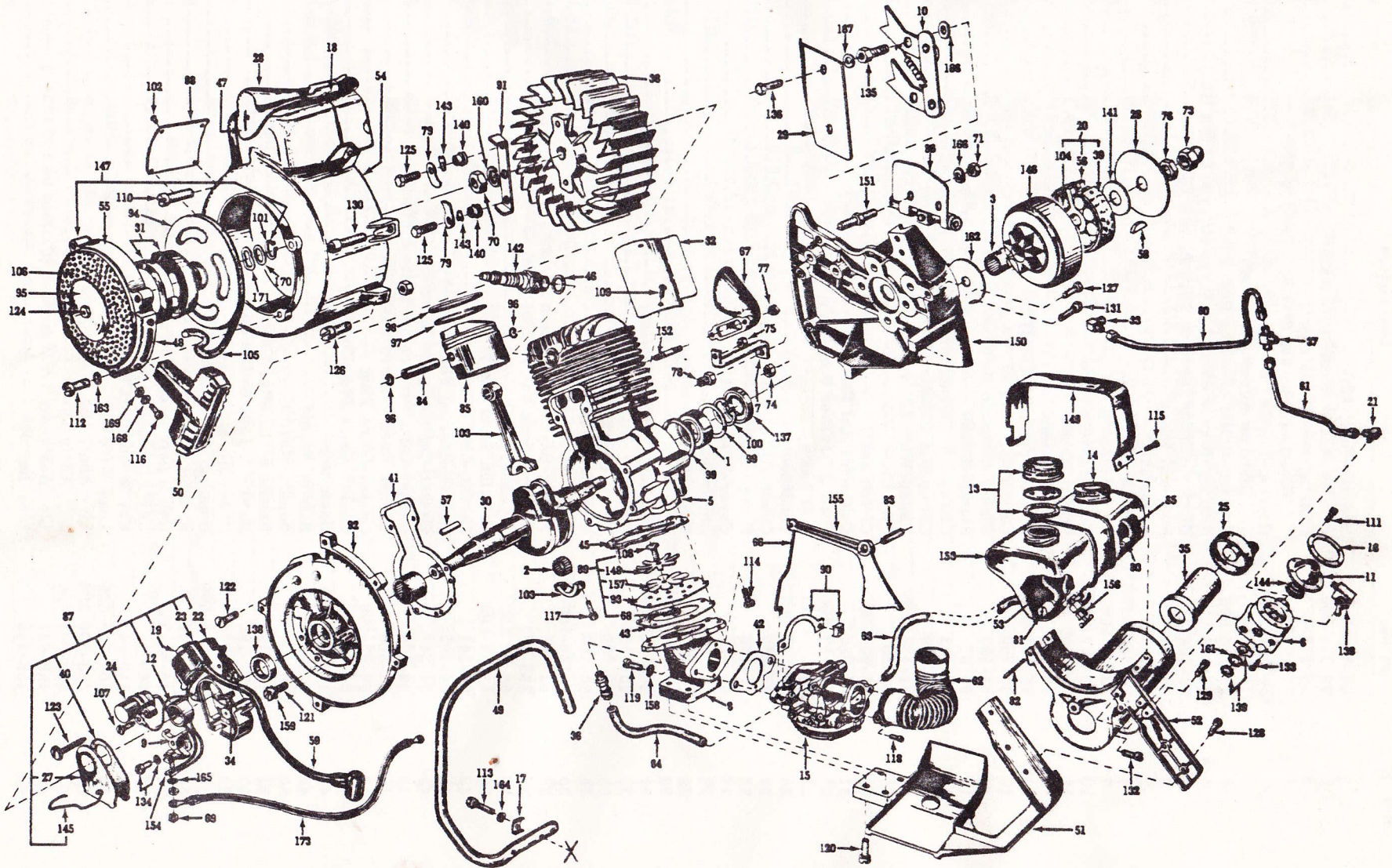

CHAINSAW BASIC PARTS LIST D 65-1000

Sec. II, Div. D-65-1000
Basic Parts List
Revised July 1964
Supersedes October 1962



D-65-1000 BASIC PARTS LIST

Ref. No.	Part No.	Description	Qty.
1	20-4	Bearing-Ball, Main -----	1
2	20-197-500	Bearing Ass'y-Needle (Crankshaft) -----	1
3	20-153	Bearing-Needle (Sprocket) -----	1
		(Used on Sprocket Part No. 106-239-500)	
	*20-202-500	Bearing-Needle (Set 34) -----	
		(Used on Sprocket 106-406) -	
4	20-198-990	Bearing-Roller (Bearing Plate) -----	1
4-A	*20-226	Bearing-Needle Wrist Pin (Used on Type C) Not Ill. -----	1
5	22-804	Block-Cylinder (Used on Type A, B & C) -----	1
6	220-114	Body-Oil Pump -----	1
7	26-459	Brace-Strut -----	1
8	26-545	Bracket-Induction -----	1
9	135-7-500	Breaker Ass'y -----	1
10	26-417-500	Bumper Ass'y-Spike -----	1
11	220-102-990	Button-Rubber -----	1
12	157-31	Cam-Magneto -----	1
13 - 14	45-197-500	Cap Ass'y-(1) Fuel - (1) Oil -----	2
15	39-730-990	Carburetor (Use 39-913 Repair Kit) -----	1
16	81-125	Clamp-Button to Body -----	1
17	81-87	Clamp-Handle -----	5
	81-162	Clamp-Air Cleaner Hose (Not Ill.) (Upper) -----	1
	81-139	Clamp-Air Cleaner Cover (Not Ill.) -----	1
18	81-132-500	Clamp-Wire Ass'y -----	1
19	81-20	Clip-Core -----	1
20	44-90-500	Clutch Ass'y -----	1
21	69-225	Connector-Oil Pump -----	1
22	135-37-500	Core & Breaker Box Ass'y -----	1
23	135-13-990	Coil Ass'y -----	1
24	135-29-990	Condenser -----	1
25	45-257	Cover-Air Cleaner -----	1
26	45-279	Cover-Clutch -----	1
27	45-15	Cover-Breaker Box -----	1
28	45-256	Cover-Spark Plug -----	1
29	45-20	Cover-Spike Bumper -----	1
30	46-767	Crankshaft -----	1
31	263-251-500	Cup Ass'y-(Recoil Spring) -----	1
32	259-499	Deflector-Air -----	1
33	69-206	Elbow-Check Valve -----	1
34	94-189	Felt-Cam Wiper -----	1
35	2-128-500	Filter Ass'y-Air -----	1
36	69-123	Fitting-Bayonet (Induction Bracket) -----	1
37	293-132	Fitting-Check Valve (Fuel Line) -----	1
38	83-62-500	Flywheel Ass'y -----	1
39	44-85-500	Friction Band Ass'y -----	1
40	94-241	Gasket-Dust Cover -----	1
41	94-105	Gasket-Bearing Plate -----	1
42	94-242	Gasket-Carburetor to Induction -----	1
43	94-438	Gasket-Induction Bracket to Reed Plate -----	1
45	94-360	Gasket-Reed Plate to Block -----	1
46	94-92-990	Gasket-Spark Plug -----	1
47	94-362	Gasket-Spark Plug Cover -----	1
48	111-13	Guide Rope -----	1
49	121-204	Handle-Frame -----	1
50	121-6	Handle-Starter -----	1
51	121-190	Handle & L. Mtg. Casting -----	1
52	121-189	Handle & Tank Saddle Casting -----	1
53	158-274	Hose-Oil, Snake -----	1
54	259-488-500	Housing Ass'y-Blower -----	1
55	124-119	Housing-Starter -----	1
56	44-88-500	Hub & Arm Ass'y-Clutch -----	1
57	148-4	Key-Flywheel -----	1
58	148-24	Key-Woodruff (Clutch) -----	1
59	307-266-500	Lead-Wire -----	1
60	158-306-500	Line Ass'y-Oil -----	1
61	158-309-500	Line Ass'y-Oil -----	1
62	158-421	Line Ass'y-Air Cleaner Hose (Clamps on Both Ends) -----	1
63	158-249	Line-Impulse -----	1

Ref. No.	Part No.	Description	Qty.
64	158-308	Line-Fuel -----	1
	158-25	Line-Fuel Bulk -----	1
64-A	136-77	Liner-Connector Rod (Not used with Steel Rod) Not Ill. -----	2
65	158-274	Line-Oil Tank -----	1
66	159-112	Linkage-Throttle -----	1
67	170-149	Muffler Ass'y-Horn Type -----	
	*170-154-500	Muffler Ass'y-Delux Low-Tone (Not Ill.) -----	
		Muffler consists of following parts:	
		900-355 Cover, 258-811 Screw, 263-379 Spring (2), 215-512	
		Plate Baffle, 257-99-500 Screen Ass'y, 81-121 Tab Lock 183-	
		176 Nut (2), 24-77 Stud (2), 17-61 Baffle, 170-154 Center Piece.	
68	183-141	Nut-Reed Plate -----	1
69	183-21	Nut-Hex. #8-32 (Term.) -----	2
70	183-158	Nut-Hex. 7/16-20 (Flywheel) -----	1
71	183-195	Nut-Plate Chain Tension -----	2
73	183-175	Nut-Acorn -----	1
74	183-190	Nut-Stud to Main Casting -----	2
75	183-33	Nut-Brace to Bearing Plate -----	1
76	183-131	Nut-Jam -----	1
77	183-29-500	Nut & L'Washer Ass'y (Muffler-Horn Type) -----	2
78	183-171	Nut-Stud Cap -----	1
79	157-239	Pawl-Starter -----	2
80	25-28	Pickup with Screen-Oil -----	1
81	25-38	Pickup with Screen-Fuel -----	1
82	203-137	Pin-Roll (Tank Saddle Casting) -----	1
83	203-107	Pin-Roll (Trigger) -----	1
84	203-61	Pin-Wrist (Used on Type A & B) -----	1
	*203-212	Pin-Wrist (Used on Type C) -----	
85	204-66	Piston (Used on Type A & B) -----	1
	206-54	.010 Oversize (Used on Type A & B) -----	
	207-54	.020 Oversize (Used on Type A & B) -----	
	*204-85-500	Piston Ass'y (Used on Type C) Includes Rings, Locks and	
		Wrist Pin -----	1
	*206-85-500	.010 Oversize (Used on Type C) Includes Rings, Locks,	
		Wrist Pin -----	
	*207-85-500	.020 Oversize (Used on Type C) Includes Rings, Locks,	
		Wrist Pin -----	
86	215-368-500	Plate Ass'y-Chain Tension -----	1
87	268-6-500	Magneto Ass'y -----	1
88	137-387	Plate-Identification -----	1
89	215-444-500	Plate Ass'y-Reed -----	1
90	215-332-500	Plate Ass'y-Retaining -----	1
91	215-437	Plate-Base Pawl -----	1
92	215-416-500	Plate-Bearing -----	1
93		Plate-Reed (Not Serviced Separately) -----	
94	219-131-500	Pulley-Starter -----	1
95	232-113	Retainer-Screen (Starter) -----	1
96	232-40	Ring-Lock, Wrist Pin (Used on Type A & B) -----	2
	*232-164	Ring-Lock, Wrist Pin (Used on Type C) -----	2
97	233-45	Ring-Piston Compression, Standard -----	3
	235-45	.010 Oversize -----	
	237-45	.020 Oversize -----	
	*233-141-500	Chrome Re-Ring Set-Standard -----	
	*237-141-500	Chrome Re-Ring Set-.020 -----	
98	148-31	Ring-Piston Lock -----	3
99	232-83	Ring-Retainer (Bearing) -----	2
100	232-73	Ring-Retainer (Crank) -----	1
101	232-109	Ring-Retainer (Starter) -----	1
102	244-75	Rivet-Name Plate -----	4
103	245-118	Rod & Cap Ass'y (Used on Type A & B) Forged Aluminum, Includes	
		Bearing & Liner -----	1
	*245-120	Rod & Cap Ass'y (Used on Type C) Forged Aluminum, Includes	
		Bearing, Liner & Needle Wrist Pin Bearing -----	
104	44-46	Roller (Clutch) -----	8
105	246-7	Rope Starter -----	1
106	257-81	Screen-Starter -----	1
	257-92	Screen-Muffler (Horn Type-Not Ill.) -----	1
107	258-299	Screw-Condenser -----	1
108	258-516	Screw-Reed Plate -----	1

Ref. No.	Part No.	Description	Qty.
109	258-81	Screw-R. H. S. T. 8-32 x 3/8 (Deflector) -----	2
110	258-643	Screw & Nylock Ass'y-1/4-20 x 1-1/2 (Housing to Strut) -----	1
111	258-720	Screw-F. H. #4-40 x 3/8 (Oil Pump) -----	6
112	258-861	Screw-#12-24 x 1 Pan Head (Starter) -----	4
113	258-569	Screw-H. H. 1/4-20 x 1-1/2 (Handle) -----	5
114	258-586-500	Screw & Nylock Ass'y (Induction Bracket) -----	6
115	258-592-500	Screw & L'Washer Ass'y (Tank Strap) -----	2
116	258-845	Screw-#10-24 x 1/2 (Pull Guide) -----	2
117	258-901	Screw-Cap to Rod -----	2
118	258-198-500	Screw-Clamp to Carburetor -----	2
119	258-106	Screw-1/4-20 x 7/8 (Carburetor to Induction Bracket) -----	2
	258-40-500	Screw-Cover & Muffler (Not Ill.) Horn Type -----	2
120	258-692-500	Screw-Handle to Induction Bracket -----	4
121	258-588-500	Screw & Nylock Ass'y (Bearing Plate to Block) -----	4
122	258-692-500	Screw-Bearing Plate Block -----	2
123	258-108-500	Screw-Magneto to Bearing Plate -----	2
124	258-723-500	Screw-Oil Cup Ass'y -----	1
125	258-851-500	Screw & Nylock Ass'y-Pawl Plate to Flywheel -----	2
126	258-678-500	Screw & Nylock Ass'y-Blower Housing to Bearing Plate -----	3
127	258-281-500	Screw- H. H. 5/16-18 x 7/8 (Main Casting to Block) -----	4
128	258-677-500	Screw & Nylock Ass'y-Tank Saddle to L. Handle -----	2
129	258-681-500	Screw & Nylock Ass'y-Tank Saddle to L. Handle -----	1
130	258-737	Screw-S. H. C. 1/4-20 x 1-1/2 (Blower Housing to Bearing Plate to Saddle) -----	1
131	258-751	Screw-H. H. 5/16-18 x 1-1/4 (Main Casting to Saddle) -----	2
132	258-673-500	Screw & Nylock Ass'y-Tank Saddle to Main Casting -----	1
133	258-680	Screw-Switch Cover to Saddle Casting -----	2
134	258-297-500	Screw & L'Washer Ass'y-Breaker -----	1
135	258-622	Screw-Spike Bumper to Main Casting -----	2
136	258-741	Screw-Spike Cover to Spike Bumper -----	2
137	94-301	Seal-Oil (Cylinder Block) -----	1
138	94-257	Seal-Oil (Bearing Plate) -----	1
139	266-53	Shorting Ass'y-Ignition Switch -----	1
140	304-524	Spacer-Starter -----	2
141	304-373	Spacer-Clutch Cover -----	1
142	267-73-500	Spark Plug -----	1
143	263-171	Spring-Starter Pawl -----	2
144	263-269	Spring-Oil Pump -----	1
145	263-10	Spring-Breaker Box Cover -----	1
146	106-239-500	Sprocket Ass'y-1/2" Pitch (Open Spur) -----	1
	*106-408	Sprocket Ass'y-.404" Pitch (Open Spur) -----	
		NOTE: Sprockets include roller bearings. Use sprocket as required.	
147	265-160-500	Starter Assembly -----	1
148	293-97	Stop-Reed -----	1
149	26-446	Strap-Tank Retainer -----	1
150	26-477	Strut-Main -----	1
151	24-70	Stud-Guide Bar -----	2
152	24-11	Stud-Muffler to Block (Horn Type) -----	2
153	277-322-500	Tank Ass'y-Fuel -----	1
154	307-230	Terminal-Jamtite -----	1
155	157-296	Trigger-Throttle -----	1
156	293-122	Valve-Fuel Shut-off -----	1
157	293-96	Valve-Reed -----	1
158	304-26	Washer-(2) Internal Lock (5) Lock (Handle) -----	7
159	304-134	Washer-Bearing Plate to Block -----	4
160	304-25	Washer-Lock (Flywheel) -----	1
161	304-368	Washer-Shorting Switch -----	1
162	304-430	Washer-Chain Guide -----	1
163	304-532	Washer-Lock (Starter) -----	4
164	304-26	Washer-Handle Clamp -----	5
165	304-290	Washer-Terminal -----	1
166	304-337	Washer-(2) Plate Chain Tension (2) Spike Bumper to Main Casting (2) Bumper Cover -----	6
167	304-66	Washer-Lock, Bumper Cover -----	2
168	304-318	Washer-#10-Lock (Starter) -----	2
169	304-377	Washer-Plain (Starter) -----	2
170	304-412	Washer-Retaining (Starter) -----	1
171	304-411	Washer-Wave (Starter) -----	1
172	304-525	Washer-Lead (Starter Rope-Not Ill.) -----	1
173	307-265-500	Wire-Shorting -----	1

*Indicates New Parts Listed for the First Time.

Below is a list of D-65-1000 model variations. Refer to name plate on chainsaw for model number then to model variation listing for parts other than standard. If the part you are looking for is not listed in the model variation listing, refer to D-65-1000 parts list for correct part.

- D-65-1101 Use 277-302-500 Tank-Fuel, 45-249-500 Cap-Oil, 45-270 Cap-Fuel, 26-445 Strap-Tank, 69-224 Fitting-Oil Pump, 158-292-500 Oil Line Ass'y, 158-290-500 Oil Line Ass'y, 94-291 Fuel & Oil Gaskets.
- D-65-1103 Refer to Standard D-65-1000 Series Parts List.
- D-65-1105 Refer to Standard D-65-1000 Series Parts List.
- D-65-1107 Same as D-65-1101.
- D-65-1109 Use 106-408 .404 " Pitch 7 Tooth Sprocket.
- D-65-1110 Use 277-285-500 Tank Ass'y, 94-281 Gasket-Oil Pump, 183-12 Nut, 220-28 Pump-Oil, 45-259 Cover Switch, 158-257-500 Line-Oil 69-189 Elbow.
- D-65-1112 Use 106-408 .404" Pitch 7 Tooth Sprocket.
- D-65-1113 Use 106-408 .404" Pitch 7 Tooth Sprocket.
- D-65-1114 Refer to Standard D-65-1000 Series Parts List.
- D-65-1115 Use 106-408 .404" Pitch 7 Tooth Sprocket.
- D-65-1116 Refer to Standard D-65-1000 Series Parts List.
- D-65-1117 Use 106-408 .404" Pitch 7 Tooth Sprocket.
- D-65-1120 Refer to Standard D-65-1000 Series Parts List. Clinton does not supply Sprocket for this unit.
- D-65-1121 Use 106-408 .404" Pitch 7 Tooth Sprocket. Refer to Standard D-65-1000 Series Parts List for Delux Low-Tone Muffler 170-154-500.