

CLINTON

S E R I E S
V-3100-2000
CLINTALLOY

BASIC
TYPE

SEC. II. DIV. V-3100-2000
PARTS CATALOG
Revised March, 1961
Supersedes Dec., 1959

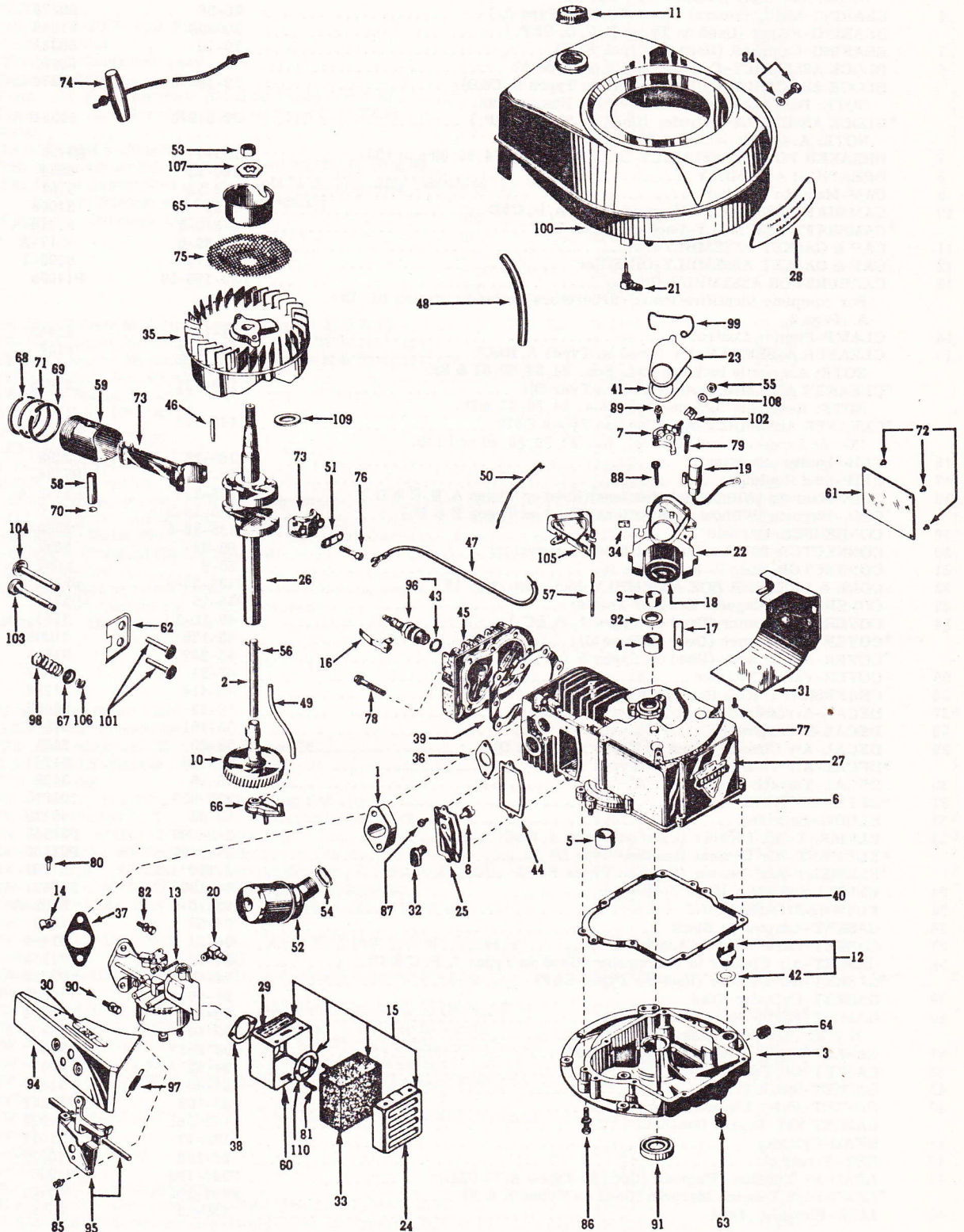

CLINTON ENGINES CORPORATION
MAQUOKETA, IOWA

PRINTED IN U.S.A.

There are six Basic Types of the V3100-2000 Series Engine covered by this Basic Parts List. Parts not used on all types are noted. These types are shown as follows: Serial Number Suffix "A"-referred to as type A; Serial Number Suffix "B"-referred to as type B, etc.

NOTE: See page "a" on "How to Identify Your Clinton Engine."

Ref. No.	Part Description	IBM No.	Part No.	Quan.
1	ADAPTOR-Carburetor	1-65	12367	1
2	AXLE ASSEMBLY-Camshaft (Used on Types A, B, C&D.)	6-3-5	10310-A	1
3	BASE ASSEMBLY-Engine NOTE: Assembly includes Ref. No. 91.	18-45	31488	1
4	BEARING-Main, (Sleeve) Block (Used on Type A.)	20-58	90278	1
	BEARING-Flange (Used on Types B, C, D, E&F.)	20-206	91098	1
5	BEARING-Camshaft (Used on Types E&F.)	20-10	90281	1
6	BLOCK ASSEMBLY-Cylinder (Used on Type A)		90981	1
	BLOCK ASSEMBLY-Cylinder (Used on Types B, C&D)	22-195-5	90274-A	1
	NOTE: Both assemblies include Ref. Nos. 4 & 92.			
	*BLOCK ASSEMBLY-Cylinder (Used on Types E&F.)	22-519-5	91231-A	1
	NOTE: Assembly includes Ref. Nos. 4, 5, & 92.			
7	BREAKER POINTS ASSEMBLY-Incl. Ref. Nos. 34, 55, 89 and 108.	135-7-5	P5735	1
8	BREATHER ASSEMBLY	260-13	6354	1
9	CAM-Magneto Breaker	157-29	5751	1
10	CAMSHAFT ASSEMBLY-Used on Types A, B, C&D	6-22	31008	1
	*CAMSHAFT ASSEMBLY-Used on Types E&F	6-340-5	91610-A	1
11	CAP & GASKET ASSEMBLY-Fuel	45-89-5	4517-A	1
12	CAP & GASKET ASSEMBLY-Oil Filler	45-179	5095-1	1
13	CARBURETOR ASSEMBLY-Clinton For complete identification of carburetors, refer to Section III, Div. A, Page 2.	P39-190-99	P14055	1
14	CLAMP-Remote Control	81-13	31463	1
15	CLEANER ASSEMBLY-Air (Used on Types A, B&C) NOTE: Assembly includes Ref. Nos. 24, 33, 60, 81 & 83.	149-102	6394	1
	*CLEANER ASSEMBLY-Air (Used on Type D) NOTE: Assembly includes Ref. Nos. 24, 29, 33, & 60.	149-397	91665	1
	*CLEANER ASSEMBLY-Air (Used on Types E&F) NOTE: Assembly includes Ref. No. 24, 29, 33, 60 and 110.	149-479	92103	1
16	CLIP-Ignition Shorting	266-28	3499	1
17	CLIP-Coil Holding	P81-20	P5734	1
18	COIL-Magneto (Without Laminations)(Used on Types A, B, C & D.)	P135-215	P5733-A	1
	*COIL-Magneto (Without Laminations)(Used on Types E & F.)	P135-13-5	P5770	1
19	CONDENSER-Magneto	P135-29-5	P5589-A	1
20	CONNECTOR-90°Flexible Fuel Line (Carburetor)	69-24	5052	1
21	CONNECTOR-Hose to Fuel Tank	69-6	5055	1
22	CORE & BREAKER BOX ASSEMBLY-Incl. Ref. No. 17	P135-37-5	P5732	1
23	COVER-Dust (Magneto Breaker Points)	P45-15	P5743	1
24	COVER-Air Cleaner (Used on Types A, B, & C.)	45-10-5	31446-A	1
	*COVER-Air Cleaner (Used on Type D)	45-175	91004	1
	*COVER-Air Cleaner (Used on Types E & F)	45-337	91815	1
25	COVER-Valve Chamber	45-81	10323	1
26	CRANKSHAFT (Can Use 91926 Crankshaft)	46-414	31128	1
27	DECAL-Arrowhead	58-25	90559	1
28	DECAL-Horsepower	58-151	91201	1
29	DECAL-Air Cleaner (Used on Types A, B, C & D)	58-20	3461	1
	*DECAL-Air Cleaner (Used on Types E & F)	58-349	91767	1
30	DECAL-Throttle Control	58-98	3488	1
31	*DEFLECTOR-Air	259-358	91043	1
32	ELBOW-Breather	69-23	90610	1
33	ELEMENT-Air Cleaner (Used on Types A, B&C)	2-28-99	P31442	1
	*ELEMENT-Air Cleaner (Used on Type D)	P2-99-99	P91100	1
	*ELEMENT-Air Cleaner (Used on Types E&F)	2-140	91791	1
34	FELT-Lubrication (Cam Follower)	94-189	P5742	1
35	FLYWHEEL ASSEMBLY	83-10-5	5752-A	1
36	GASKET-Adaptor to Block	94-68	7149	1
37	GASKET-Carburetor to Adaptor	94-32	31461	1
38	GASKET-Air Cleaner to Carburetor (Used on Types A, B, C & D)	94-13	31445	1
	*GASKET-Air Cleaner (Used on Types E&F)	94-458	92098	1
39	GASKET-Cylinder Head	94-40	10253	1
40	GASKET-Engine Base (.015 Thick) NOTE: .010 thick gasket available	94-107	10254	1
		93-107	10254-1	1
41	GASKET-Cover, Dust (Breaker Points)	P94-241	P5744	1
42	GASKET-Oil Filler Cap	94-82	5097	1
43	GASKET-Spark Plug	94-90	3115	1
44	GASKET-Valve Chamber Cover	94-103	10251	1
	GASKET KIT-Engine Overhaul	149-361	91562	1
45	HEAD-Cylinder	122-17	31011	1
46	KEY-Flywheel	26-106	10339	1
47	LEAD-Hi-Tension, Magneto (Used on Types A, B, C&D)	P307-190	P5555	1
	*LEAD-High Tension Magneto (Used on Types E & F)	P307-194-5	P90761	1
48	LINE-Flexible, Fuel	158-25	6316	1

Ref. No.	Part Description	IBM No.	Part No.	Quan.
49	LINE-Oil Distributor (Oil Pump)	158-53	10390	1
50	LINK-Carburetor to Air Vane	159-18	31491	1
51	LOCK-Connecting Rod Screw	148-12	21318	1
	MAGNETO ASSEMBLY-Used on Types A, B, C & D	P268-4-5	P5731	1
	NOTE: Assembly includes Ref. Nos. 7, 17, 18, 19, 22, 23, 34, 41, 55, 79, 88, 99, 102 and 108.			
	*MAGNETO ASSEMBLY-Used on Types E & F	P268-17-5	P91740	1
	NOTE: Assembly includes Ref. Nos. 7, 17, 18, 19, 22, 23, 34, 41, 55, 79, 88, 99, 102 and 108.			
52	MUFFLER	170-36-5	3639	1
53	NUT-Hex., 1/2-20(Starter Pulley).....	183-68-99	5942	1
54	NUT-Lock, Muffler	183-37	4425	1
55	NUT-Terminal Condenser Lead	183-21	P5740	1
56	PIN-Camshaft Axle	203-20	10392	1
57	PIN-Pivot, Air Vane Governor (Used on Types A and B)	203-33	10015	1
	PIN-Pivot, Air Vane Governor (Used on Type C, D, E&F).....	203-91	90982	1
58	PIN-Wrist	203-63	6024	1
59	PISTON ASSEMBLY-Standard	204-13-5	31001-A	1
	NOTE: Assembly includes Ref. Nos. 58, 59, 68, 69, 70 & 71.			
	NOTE: Piston Assemblies are available in the following oversizes: Order by Part Number and specify oversize;			
	IBM Part No. Oversize Listed.	.005.....	205-13-5	
		.010.....	206-13-5	
		.020.....	207-13-5	
		.030.....	208-13-5	
		.040.....	209-13-5	
60	PLATE-Air Cleaner Mounting (Used on Types A, B & C)	2-17-5	31444-A	1
	*PLATE-Air Cleaner Mounting (Used on Type D).....	2-100	91102	1
	*PLATE-Air Cleaner Mounting (Used on Types E & F)	2-13E	91803	1
61	PLATE-Name (Air Deflector).....	58-105	6530	1
62	PLATE-Valve Spring Retainer	215-136	10013	1
63	PLUG-3/8 N. P. T. (Oil Drain)	216-24	5649	1
64	PLUG-Oil Drain	216-25	5655	1
65	PULLEY-Starter	219-17	12397	1
66	PUMP ASSEMBLY-Oil	220-5-5	10385-A	1
67	RETAINER-Valve Spring	304-135	3028	2
68	RING-Compression, Standard (Order Ring Set).....		6026	1
69	RING-Oil, Standard (Order Ring Set)		6006	1
70	RING-Retainer, Wrist Pin	232-41	6034	2
71	RING-Scraper, Standard (Order Ring Set)		6027	1
	RING SET-Standard	149-10	10023	1
	NOTE: Ring Sets are also available in the following oversizes: Order by Part Number and specify oversize;			
	IBM Part No. Oversize Listed	.005.....	149-157	
		.010.....	149-158	
		.020.....	149-159	
		.030.....	149-160	
		.040.....	149-161	
72	RIVET-Tubular (Name Plate)	244-21	5460	4
73	ROD ASSEMBLY-Connecting	245-102-5	31002-A	1
	NOTE: Assembly incl. Ref. Nos. 51 and 76.....			
74	ROPE ASSEMBLY-Starter	246-13-5	4266	1
75	*SCREEN-Rotating	257-25	90092	1
76	SCREW-H. H. C., 1/4-28x1-1/4 (Connecting Rod Cap).....	258-9	3235	2
77	SCREW-H. H. Slotted S. T., #8-32x3/8 (Deflector to Block).....	258-81	5644	2
78	SCREW-H. W. H. 5/16x1-7/8 (Cylinder Head).....	258-88	5654	8
79	SCREW-R. H. S. T., #8-32x4/5 (Condenser to Plate)	P258-299	P5741	1
80	SCREW-H. H. S. T., #8-32x1/4 (Shroud to Bracket) (Clamp to Shroud).....	258-477	5892	3
81	SCREW-H. H. C., #8-32x7/16 (Air Cleaner to Carburetor)	258-131	5812	2
82	SCREW & L'WASHER ASS'Y-H. H. C., 1/4-20x1-1/2(Carburetor to Block)	258-238-5	5410-G	1
	Upper.			
83	SCREW & L'WASHER ASS'Y-P. H. S., #10-24x3/8 (Air Cleaner Cover to Bracket.)(Used on Types A, B, & C)	258-6-5	3216-A	1
84	SCREW & L'WASHER ASS'Y-H. H. C., 1/4-20x1/2 (Blower Housing to Block)	258-280-5	3205-G	2
85	SCREW & L'WASHER ASS'Y-H. H. C., #8-32x3/8 (Bracket to Carburetor).....	258-81-5	5644-A	2
86	SCREW & L'WASHER ASS'Y-H. H. C., 1/4-20x1-1/4 (Base to Block)	258-254-5	5613-G	7
87	SCREW & L'WASHER ASS'Y-H. H. C., #10-24x1/2 (Valve Chamber Cover).....	258-82-5	5645-A	2
88	SCREW & L'WASHER ASS'Y-P. H. S. T., #10-24x1 (Lamination to Block)	258-108-5	5682-A	2
89	SCREW & L'WASHER ASS'Y-O. H. Slotted #8-32x9/16 (Breaker Points to Breaker Box)	P258-297-5	P5737	1
90	SCREW & L'WASHER ASS'Y-H. H. C., 1/4-20x1-3/4 (Carburetor to Block)....	258-275-5	5878-G	1
	(Lower)			
91	SEAL-Oil (Engine Base).....	94-176	9029	1
92	SEAL-Oil (Block)	94-178	10012	1
94	SHROUD ASSEMBLY-Carburetor	259-247	31438	1
95	SLIDE ASSEMBLY-Governor Regulating (Used on Types A & B).....	149-203	6398	1
	SLIDE ASSEMBLY-Governor Regulating (Used on Types C, D, E & F)	26-236-5	91330	1
96	SPARK PLUG AND GASKET ASSEMBLY	K267-28-5	K16303-A	1

S E R I E S
V-3100-2000
C L I N T A L L O Y

BASIC
 TYPE

CLINTON

Ref. No.	Part Description	IBM No.	Part No.	Quan.
97	SPRING-Extension (Speed Regulating).....	263-69	90635	1
98	SPRING-Valve	263-92	3068	2
99	SPRING-Breaker Box Cover.....	P263-10	P5745	1
100	TANK ASSEMBLY-Fuel.....	277-214-5	10370-D	1
	NOTE: Assembly includes Ref. No. 11			
101	TAPPET-Valve	278-5	10009	2
102	TERMINAL-Jamite Breaker Points	P304-290	P5739	1
103	VALVE-Exhaust.....	291-8-99	10301	1
	VALVE-Exhaust (.010 Oversize)	292-6	10321	1
104	VALVE-Intake	291-7	10302	1
	VALVE-Intake (.010 Oversize)	292-7	10322	1
105	VANE-Air Governor (Used on Types A & B).....	107-11	10014	1
	VANE-Air Governor (Used on Types C, D, E & F).....	107-30	91033	1
106	WASHER- "C" (Valve Keeper).....	304-9	3291	2
107	WASHER- Starter Pulley	304-132	5941	1
108	WASHER-Terminal Condenser Lead.....	P304-290	P5739	1
109	WASHER-Thrust (Used on Type A).....	304-151	2464	1
110	*WASHER-Air Cleaner (Used on Types E & F)	304-562	92024	1

* Indicates New Parts Listed For the First Time.

SERVICE NOTES

1. Service Tools Available, Refer to Service Bulletin #54 for complete description and Parts Price List for Price.

- TL910 Bearing Driver for P. T. O. Side 7/8" #10015 Bearing.
 - TL934 Bearing Driver for Magneto Side, 90278 Bearing also P. T. O. Side 1" #9016 Bearing.
 - TL981 Oil Seal Loader Magneto Side.
 - TL954 Oil Seal Loader P. T. O. Side.
 - TL955 Oil Seal Loader P. T. O. Side 1" Crankshaft.
 - TL962 Oil Seal Loader Magneto Side.
 - TL953 Oil Seal Drive P. T. O. Side 7/8" Crankshaft.
 - TL932 Valve Seat Cutter.
 - TL957-A Valve Pilot Assembly.
 - TL936 Cutter for .040 Oversize Valve Insert #15119.
 - TL951 Driver Valve Seat.
 - TL952 Rolling Tool Valve Insert.
 - TL977 Reamer Valve Guide Std.
 - TL939 Reamer Valve Guide .010 for Valves with .019 oversize stem.
 - TL974 Valve Spring Compressor
 - TL978 Valve Lapping Tool
 - TL968 Impact Nut 1/2" Crankshaft Thread.
 - TL916 Impact Nut 1/2" Crankshaft Thread.
 - TL969 Flywheel Puller
 - TL938 Flywheel Holder
 - TL929 Piston Ring Compressor
 - TL941 Crank for turning crankshaft with flywheel removed.
 - TL976 Tru-Arc Pliers for Recoil Service
 - TL946 Reamer Guides.
 - TL960 Line Reamer for Block Bearing #90278
 - TL940 Reamer for Base Sleeve Bearing 7/8" to install 10016 Bearing.
 - TL964 Line Reamer for Base Sleeve Bearing 7/8" to install 10016 Bearing.
- TL980 Rough Reamer for Base Sleeve Bearing 1" to install 9016 Bearing.
 - TL979 Finish Reamer for Base Sleeve Bearing 1" to install 9016 Bearing.
 - TL959 Line Reamer for Base Sleeve Bearing 1" for installed 9016 Bearing.
 - TL-967 Engine Repair or Display Stand.

CLINTON

S	E	R	I	E	S
V-3100-2000					
CLINTALLOY					

MODEL VARIATIONS
SEC. II, DIV. V-3100-2000
PARTS CATALOG
 Revised April, 1961
 Supersedes June, 1960

MODEL VARIATIONS OF V-3100-2000 SERIES

The adaptation of Clinton Engines to a wide variety of uses results in what is known as "Model Variations." Following is the complete list of all Models produced up to issue date (shown above). Opposite each Engine Model listed are the Part Numbers and/or Assembly Numbers for the Series used IN ADDITION TO or IN PLACE OF the parts illustrated and shown on the Basic Parts List preceding this Model Variations List. Refer to other sections of this Manual when Assembly Numbers are given to find the Parts List for these assemblies.

See page (a) on "How to Identify Your Clinton Engine." Use the preceding Basic Parts List except as shown below.

ENGINE MODEL—See page (a), "How to Identify Your Clinton Engine."

FOOTNOTES (Check page two)

BASE—ENGINE (Part Numbers Shown). Refer to Sec. IV, Div. A for further information.

BLOCK ASSEMBLY — CYLINDER (Part Number Shown). Refer to Illustrated Basic Parts List for corresponding part.

CRANKSHAFT (Part Numbers Shown). Refer to Sec. IV, Div. B for details and further information.

BEARING—MAIN (Part Numbers Shown). Refer to Illustrated Basic Parts List for corresponding part.

CONTROL GROUP (Control Group Illustration Numbers Shown). Refer to Sec. III, Div. D for Parts List.

CONTROL CABLE LENGTH — Replace-ment cable is furnished in 72" length ONLY, cut to length shown.

PLATE ASSEMBLY — BEARING (Part Numbers Shown). Refer to Illustrated Basic Parts List for corresponding part.

MUFFLER OR MANIFOLD (Part Numbers shown). Refer to Illustrated Basic Parts List for corresponding part.

STARTER—RECOIL OR IMPULSE. Refer to Sec. III, Div. H for Parts List.

HOUSING AND TANK ASSEMBLY — BLOWER (Part Nos. Shown). Refer to Basic Parts List for corresponding part.

REDUCTION GEAR (Assy. Nos. Shown). Refer to Sec. III, Div. C for Parts List.

MOUNTING POSITION — "Clock" position shows mounting of reduction unit in relation to Crankshaft.

V-3100-2103	Note 5					P90996	10313-B
V-3100-2104	Note 4			31332		P90996	10313-B
V-3100-2105	Note 4			31332		P90996	10313-B
V-3100-2106				31328		P90996	10313-B
V-3100-2107	Notes 1, 2, 6	91348	90286	16127		P90996	10313-B
V-3100-2108	Note 1					P90996	10313-B
V-3100-2109	Note 1			31337		P90996	10313-B
V-3100-2110	Notes 1, 3			31337		C91116	31479-G
V-3100-2111	Notes 1, 7, 10			31179	72"	C6362	10370-K
V-3100-2112	Notes 1, 10				72"	P90996	10313-B
V-3100-2113	Notes 5, 10					P90996	10313-B
V-3100-2114						P90996	10313-B
V-3100-2115	Notes 1, 5, 8			31339		P90996	10313-B
V-3100-2116	Notes 1, 10			31180		P90996	10313-B
V-3100-2117	Notes 1, 3, 5, 8			31339		C91116	31479-G
V-3100-2118	Notes 1, 5, 9, 10			91371		P90996	10313-B
V-3100-2119				31308		P90996	10313-B
V-3100-2120					72"	P90996	10313-B
V-3100-2121	Notes 1, 3, 4			91371		C91116	31479-G
V-3100-2122	Note 3			31328		C91116	31479-G
V-3100-2123	Note 3					C91116	31479-G
V-3100-2124	Note 1			31328		P90996	10313-B
V-3100-2125	Note 1					P90996	10313-B
V-3100-2126	Note 1					P90996	10313-B
V-3100-2127	Notes 1, 10			31328		P90996	10313-B
V-3100-2128	Notes 1, 5	91528-A		21307		P90996	10313-B
V-3100-2129	Notes 1, 11			31328		P90996	10313-B
V-3100-2130	Notes 1, 3, 11			31328		C91116	31479-G
V-3100-2131	Notes 3, 11			31328	72"	C91116	31479-G
V-3100-2132	Notes 9, 11			31328	72"	P90996	10313-B
V-3100-2133	Note 1			91371		P90996	10313-B
V-3100-2134	Notes 1, 7, 12	10053-B		31169		6342	C6362 10313-B
V-3100-2135	Notes 1, 3, 9			31328		C91116	31479-G
V-3100-2136	Notes 1, 9			31328		P90996	10313-B
V-3100-2137	Notes 5, 13			31332		P90996	10313-B
V-3100-2138	Notes 1, 5	91528-A		31307		P90996	10313-B
V-3100-2139	Note 1			31338		P90996	10313-B
V-3100-2140	Note 11					P90996	10313-B
V-3100-2141	Notes 1, 3	10053-B		31169		6342	C91116 31479-G
V-3100-2142	Notes 1, 3					C91116	31479-G

MODEL VARIATIONS OF V-3100-2000 SERIES (Cont.)

ENGINE MODEL	FOOTNOTES	BASE—ENGINE	BLOCK ASSEMBLY—CYLINDER	CRANKSHAFT	BEARING—MAIN	CONTROL GROUP	CONTROL CABLE LENGTH	PLATE ASSEMBLY—BEARING	MUFFLER OR MANIFOLD	STARTER—RECOIL	HOUSING ASSEMBLY—BLOWER	REDUCTION GEAR	MOUNTING POSITION
V-3100-2143	Note 1			31327						P90996	10313-B		
V-3100-2144	Notes 1, 3, 4			91371						C91116	31479-G		
V-3100-2145	Notes 1, 5, 10			91371						P90996	10313-B		
V-3100-2146	Notes 1, 5, 8			31307						P90996	10313-B		
V-3100-2147	Notes 1, 3			31305						C91116	31479-G		
V-3100-2148	Notes 7, 11, 14								91016	C6362	10313-B		
V-3100-2149	Notes 4, 6, 7, 10, 11		91262-A							C6362	10313-B		
V-3100-2150	Note 10			31332						P90996	10313-B		
V-3100-2151				31328			72"						
V-3100-2152				31337						P90996	31413-A		
V-3100-2154				31337						P90996	10313-B		
V-3100-2155	Note 3			31337						C91116	31479-G		
V-3100-2156	Note 1									P90996	31413-A		
V-3100-2157	Notes 1, 3			31337						C91116	31479-G		
V-3100-2158	Note 1			31337						P90996	10313-B		
V-3100-2159	Notes 1, 3, 15			91371					91017	C91116	31479-G		
V-3100-2160	Notes 1, 15, 16			91371						P90996	10313-B		
V-3100-2161	Notes 1, 3			91371						C91116	31479-G		
V-3100-2162	Notes 3, 10, 11									C91116	31479-G		
V-3100-2163				31337									
V-3100-2164	Note 3			91371					91016	C91116	31479-G		
V-3100-2166	Notes 1, 8			31181					91016				
V-3100-2167	Notes 1, 8			31181					91016	P90996	10313-B		
V-3100-2168	Notes 2, 11, 17, 18								91016	P13516	10313-B		
V-3100-2169	Notes 1, 3, 8, 9			31336						C91116	31479-G		

- NOTE 1—Use 14290 Grommet, 10364 Clip (Shorting), 31486 Grommet, 12409-A Wire Ass'y, 5522 Nut, 5647 Screw, 3462 Decal.
- NOTE 2—Use 90722 Spring (Exhaust Valve), 12363-A Rotocap, 90723 Valve (Exhaust, Stellite), 12362 Pin (Valve).
- NOTE 3—Use C91116 Impulse Starter, C91119 Cup, 90872 Screen, 4107-A Nut (4). These parts are included in Kit No. MC91537. If original position is not required, use 10313-B as listed.
- NOTE 4—Use 90795 Element (Precleaner).
- NOTE 5—Use 10320 Knob, 5444-A Screw & L'Washer Ass'y, 5481 L'Washer.
- NOTE 6—Use 31512 Insert (Valve Seat, Exhaust).
- NOTE 7—Use 4954-A Pulley & Screen Assembly.
- NOTE 8—Use 7274 Elbow.
- NOTE 9—Use 4181 Cover (Spark Plug).
- NOTE 10—Use 10070-A Body Muffler, 10075 Nut, 10022-A Cover, 5861 Stud, 7044 Nut (Wing).
- NOTE 11—Use 91332 Oil Gauge.
- NOTE 12—Use 4429 Seal (Oil).
- NOTE 13—Use 12382-A Wire Assembly (Ignition Shorting).
- NOTE 14—Use 3991-1 Air Horn, 6215-A Air Cleaner Assembly.
- NOTE 15—Use 3493 Garden Mark decal.
- NOTE 16—Use 3494 Warning decal.
- NOTE 17—Use 10350 Air Horn, 6215-A Air Cleaner, 5677 Screw Air Horn to Carburetor (2), 5637 Stud, 7044 Wing Nut, 31445 Gasket (Air Horn to Block), 10353 Mandrel (Breather Tube to Air Horn), 10259 Gasket (Air Horn to Air Cleaner), and 4533 Breather Tube.
- NOTE 18—Use P90871 Cup, 4107-A Nut (4), 4832 Stud (Recoil Mounting, 4), 90872 Screen. These parts and the P13516 Recoil are available in Kit No. P91866.