

S E R I E S
VS-100-1000
 G E M

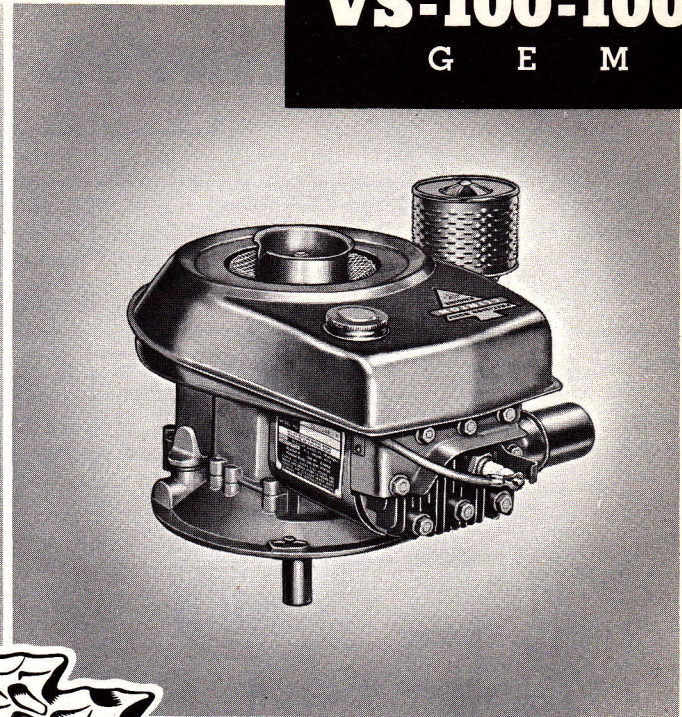

A Wide Range of Models are Made By

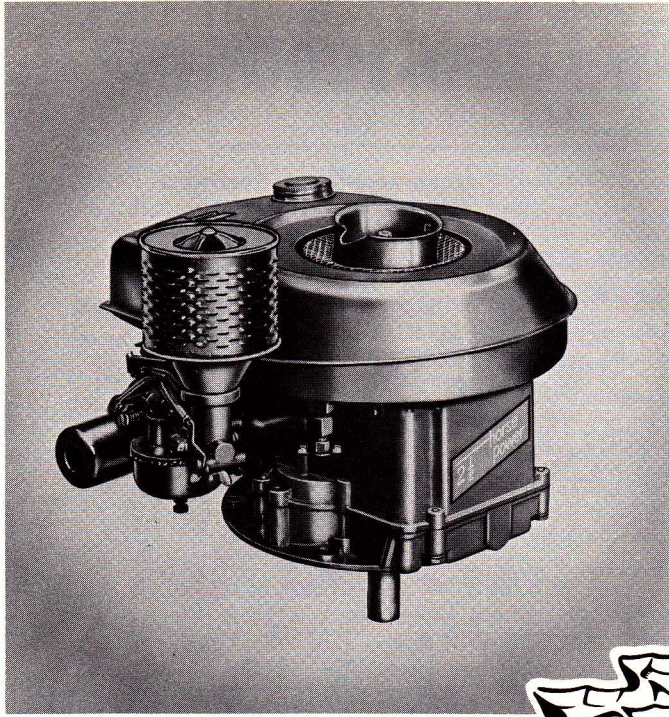
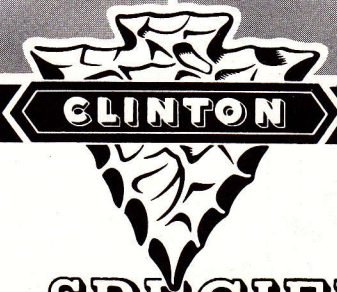

For Farm, Home and Industrial Use.

VS-100-1000	H.P.	R.P.M.
	1.45-----	2200
	2.0-----	2800
	2.5-----	3600

GENERAL SPECIFICATIONS

Model	Type	Description	Starter	Weight
VS-100-1000	Air Cooled	Vertical Shaft	Rope or Recoil	19 lbs.

BORE: 2 $\frac{3}{8}$ "

STROKE: 1 $\frac{5}{8}$ "

TYPE: Single cylinder, L-Head, air-cooled.

AIR-COOLED: Large capacity, curved vane blower cast integral with flywheel. Air passes through deep fins to maintain correct operating temperature.

PISTON DISPLACEMENT: 7.2 cubic in.

IGNITION: Very high voltage, built-in fly-wheel magneto for faster starting. Moisture and dust proof with fully enclosed ignition points.

SPARK PLUG: 14 m.m.

LUBRICATION: Splash-type. Oil drainage permitted from either side of the base.

CARBURETOR: Full float feed with idle and high speed adjustment.

GOVERNOR: Adjustable, air velocity type.

MAIN BEARING: Bronze.

CRANKSHAFT: Arma steel, induction heat-treated. Counterweights and cam gear drive integral with shaft.

CONNECTING ROD: I-Beam, aluminum alloy with extra large bearings.

PISTON: Aluminum alloy. Clinton-engineered for efficient combustion.

PISTON RINGS: Two compression and one oil control. Treated surfaces.

VALVES: Forged steel. Exhaust valve provided with heat-resistant alloy head.

VALVE SEATS: Alloy inserts.

VALVE TAPPETS: Hardened and ground.

CYLINDER AND CRANKCASE: Die cast cylinder block and crankcase with large amount of cooling area for cool operation. A close-grained cast iron liner is die cast in block.

CYLINDER HEAD: Aluminum, removable with extra deep cooling fins.

OIL FILLER: Conveniently located for easy check of oil level and for filling.

AIR FILTER: Dry type.

FUEL TANK: Two-quart capacity with gasoline strainer and shut-off.

OIL RESERVOIR: One-pint capacity.

DIRECTION OF ROTATION: Counter-clockwise, viewed from power take-off shaft side.

FINISH: Heat-resistant, red enamel. Other colors available upon request.

STANDARD EQUIPMENT

Standard equipment includes: Down-draft oil bath air cleaner, dust and moisture-proof, high voltage, flywheel magneto, float feed carburetor and fuel tank, muffler, blower housing screen, rope starter.

SPECIAL EQUIPMENT

Special equipment includes: Remote governor controls, throttle control cables and stop, recoil starter.



WORLD'S LARGEST MANUFACTURER OF A COMPLETE LINE OF AIR-COOLED GASOLINE ENGINES

CLINTON ENGINES PROVIDE POWER

FOR FARM • HOME • INDUSTRIAL EQUIPMENT

Printed in U.S.A.

CLINTON

S E R I E S
VS-100-1000
G E M

BASIC
TYPE

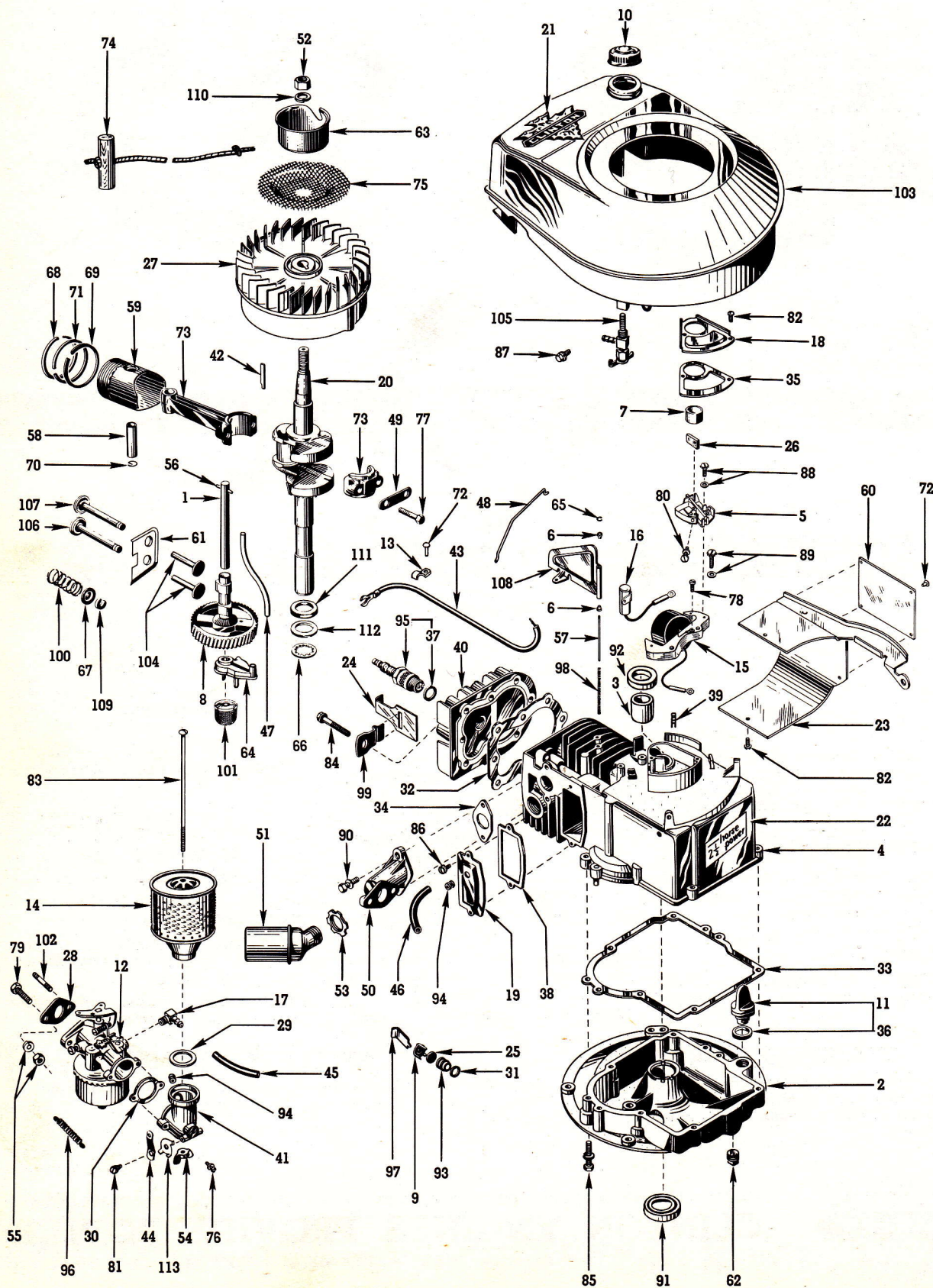

CLINTON

S	E	R	I	E	S
VS-100-1000					
G E M					

**BASIC
TYPE**
SEC. II, DIV. VS-100-1000
PARTS CATALOG
 Revised February, 1957
 Supersedes April, 1956

There are five Basic Types of the VS-100-1000 Engine covered by this Basic Parts List. These types are as follows: Serial Number Suffix "A"—referred to as "Type A"; Serial Number Suffix "B"—referred to as "Type B"; Serial Number Suffix "C"—referred to as "Type C"; Serial Number Suffix "D"—referred to as "Type D"; Serial Number Suffix "E"—referred to as "Type E."

NOTE: See page (a) on "How to Identify Your Clinton Engine."

BASIC PARTS LIST

Ref. No.	PART DESCRIPTION	Part No.	Quantity
1	AXLE ASSEMBLY — Camshaft (includes pin)-----	10310-A	1
2	BASE ASSEMBLY — Engine-----	10000-A	1
	NOTE: Assembly includes Ref. No. 91.		
3	BEARING — Main (Sleeve)-----	10380	1
4	BLOCK ASSEMBLY — Cylinder-----	10205-A	1
	NOTE: Assembly includes Ref. Nos. 3, 92.		
5	BREAKER POINTS ASSEMBLY-----	P5543	1
	NOTE: Assembly includes Ref. Nos. 26, 78, 80.		
	BREATHER ASSEMBLY-----	6330	1
	NOTE: Assembly includes Ref. Nos. 9, 25, 31, 93, 97.		
6	BUSHING — Air Vane-----	7239	2
7	CAM — Magneto Breaker-----	5707	1
8	CAMSHAFT ASSEMBLY-----	10008-A	1
9	CAP — Breather-----	7151	1
10	CAP & GASKET ASSEMBLY — Fuel-----	4517-A	1
11	CAP & GASKET ASSEMBLY — Oil Filler-----	5095-1	1
12	CARBURETOR ASSEMBLY — Used on Types A and B-----	C14090	1
	CARBURETOR ASSEMBLY — Used on Type C-----	C14087	1
	CARBURETOR ASSEMBLY — Used on Type D-----	14008	1
	CARBURETOR ASSEMBLY — Used on Type E-----	14004	1
	(For Complete Identification of Carburetors, Refer to Sec. III, Div. A, Page 2)		
13	CLAMP — Magneto Hi-Tension Lead-----	10344	1
14	CLEANER ASSEMBLY — Air-----	4546-A	1
	NOTE: See Sec. III, Div. F, for Component Parts.		
15	COIL ASSEMBLY — Magneto (With Laminations)-----	P5593-B	1
	COIL — Magneto (Without Laminations)-----	P5593-A	1
16	CONDENSER — Magneto-----	P5599-A	1
17	CONNECTOR — 90°, Flexible Fuel Line (Carburetor)-----	5052	1
18	COVER — Dust, Magneto Breaker Points-----	10382	1
19	COVER — Valve Chamber-----	10323	1
20	CRANKSHAFT-----	10100	1
21	DECAL — Arrowhead-----	3579	1
22	DECAL — Horsepower-----	10010	1
23	DEFLECTOR ASSEMBLY — Air, Cylinder-----	10006-A	1
24	DEVICE — Ignition Shorting (Spark Plug)-----	10368	1
25	DISC — Breather-----	7152	1
26	FELT — Lubrication, Cam Follower-----	P5504	1
27	FLYWHEEL ASSEMBLY-----	5597-A	1
28	GASKET — Paper (Carburetor to Manifold)-----	7168	1
29	GASKET — Air Cleaner (Element to Cup)-----	4515	1
30	GASKET — Air Horn to Carburetor-----	3990	1
31	GASKET — Breather-----	7153	1
32	GASKET — Cylinder Head-----	10253	1
33	GASKET — Engine Base-----	10254	1
34	GASKET — Asbestos (Manifold to Block)-----	7149	1
35	GASKET — Cover, Dust (Breaker Points)-----	10250	1
36	GASKET — Oil Filler Cup-----	3297	1
37	GASKET — Spark Plug-----	3115	1
38	GASKET — Valve Chamber Cover-----	10251	1
	GASKET KIT — Engine Overhaul-----	6329	1
39	GROMMET — Magneto (Breaker Lead Wire)-----	10367	1
40	HEAD — Cylinder-----	10011	1

CLINTON

S E R I E S
VS-100-1000
 G E M

**BASIC
 TYPE**

BASIC PARTS LIST (Continued)

Ref. No.	PART DESCRIPTION	Part No.	Quantity
41	HORN — Air	10350	1
42	KEY — Flywheel	10339	1
43	LEAD — Hi-Tension, Magneto	P2055	1
44	LEVER — Speed Adjusting	4441	1
45	LINE — Flexible, Fuel	6316	1
46	LINE — Flexible, Breather Tube	10352	1
47	LINE — Oil Distributor (Oil Pump)	10390	1
48	LINK — Carburetor to Air Vane	10020	1
49	LOCK — Double, Connecting Rod Screw	10318	1
50	MANIFOLD — Carburetor	6411	1
51	MUFFLER	3639	1
52	NUT — Hex., 7/16-20 (Starter Pulley)	3250	1
53	NUT — Lock, Muffler	4425	1
54	NUT — Wing (Air Cleaner)	7044	1
55	NUT & LOCKWASHER ASSEMBLY — 1/4-28 Hex. (Carb. Mtg.)	3255-A	2
56	PIN — Camshaft Axle	10392	1
57	PIN — Pivot, Air Vane Governor	7238	1
58	PIN — Wrist	6024	1
59	PISTON — Standard	10001	1
	PISTON ASSEMBLY — Standard	10001-A	1
	NOTE: Assembly includes Ref. Nos. 58, 59, 68, 69, 70, 71.		
	NOTE: Piston Assemblies are available in the following oversizes: .005, .010, .020, .030 and .040. Order by Part Number and specify oversize.		
60	PLATE — Name (Air Deflector)	6530	1
61	PLATE — Valve Spring Retainer	10013	1
62	PLUG — 3/8 N.P.T. (Oil Drain)	5627	1
63	PULLEY — Starter	3299	1
64	PUMP ASSEMBLY — Oil	10385-A	1
65	RETAINER — Air Vane	4430	1
66	RETAINER — Self-Locking, Power Take-Off (Dust Seal)	7452	1
67	RETAINER — Valve Spring	3028	2
68	RING — Compression, Standard	6026	1
69	RING — Oil, Standard	6006	1
70	RING — Retainer, Wrist Pin	6034	2
71	RING — Scraper, Standard	6027	1
	RING SET — Standard	10023	1
	NOTE: Ring Sets are also available in the following oversizes: .005, .010, .020, .030 and .040. Order by Part Number and specify oversize.		
72	RIVET — Tubular (4—Name Plate) (2—Flywheel Shield) (1—Clamp, Hi-Tension Lead)	5460	7
73	ROD ASSEMBLY — Connecting	10002-A	1
	NOTE: Assembly includes Ref. Nos. 49, 76.		
74	ROPE ASSEMBLY — Starter	4266	1
75	SCREEN — Revolving	7187	1
76	SCREW — R.H.M., #8-32 x 11/16 (Air Horn to Carburetor)	5677	2
77	SCREW — H.H.C., 1/4-28 x 1 1/8 (Connecting Rod Cap)	5635	2
78	SCREW — P.H.S.T., #6-32 x 1/4 (Coil to Laminations)	5641	1
79	SCREW — H.H.C., 1/4-28 x 7/8 (Carburetor to Manifold)	5650	1
80	SCREW — F.H.M., 6-32 x 1/4 (Breaker Points Terminal)	5664	1
81	SCREW — Shoulder, 10-32 x 5/16 (Speed Adj. Lever)	4440	1
82	SCREW — H.H.C., #8-32 x 5/16 (2—Deflector to Block) (2—Breaker Points Cover)	5644	4
83	SCREW — R.H.M., #10-24 x 6 1/4 (Air Cleaner)	5636	1
84	SCREW & L'WASHER ASS'Y — H.H.C., 5/16-18 x 1 1/8 (4—Tank Bracket, 4—Cylinder Head)	5654	8
85	SCREW & L'WASHER ASS'Y — H.H.C., 1/4-20 x 1 1/4 (Base to Block)	5613-G	7

CLINTON

S	E	R	I	E	S
VS-100-1000					
G E M					

**BASIC
TYPE**

SEC. II, DIV. VS-100-1000
PARTS CATALOG
Revised February, 1957
Supersedes April, 1956

BASIC PARTS LIST (Continued)

Ref. No.	PART DESCRIPTION	Part No.	Quantity
86	SCREW & L'WASHER ASS'Y — H.H.C., #10-24 x ½ (Valve Chamber Cover)	5645-A	2
87	SCREW & L'WASHER ASS'Y — H.H.C., ¼-20 x ⅝ (Tank to Block)	3632-G	2
88	SCREW & L'WASHER ASS'Y — R.H.M., 8-32 x ⅜ (Breaker Points to Block)	5444-F	1
89	SCREW & L'WASHER ASS'Y — P.H.S.T., #10-24 x 1 (Laminations to Block)	5682-A	2
90	SCREW & L'WASHER ASS'Y — H.H.C., ¼-20 x ⅝ (Manifold to Block)	3294-G	2
91	SEAL — Oil (Engine Base)	4429	1
92	SEAL — Oil (Block)	10012	1
93	SEAT — Breather	4438	1
94	SLEEVE — Connector, Breather Line	10353	2
95	SPARK PLUG AND GASKET ASSEMBLY	16303-A	1
96	SPRING — Air Governor	10336	1
97	SPRING — Breather Hold-Down	10381	1
98	SPRING — Compression (Air Vane)	10005	1
99	SPRING — Ignition Shorting Clip	10369	1
100	SPRING — Valve	3068	2
101	STRAINER — Oil Pump (Discontinued after Serial No. 3887370)	10389	1
102	STUD — Carburetor to Manifold	6155	1
103	TANK ASSEMBLY — Fuel	10370-D	1
NOTE: Assembly includes Ref. No. 10.			
104	TAPPET — Valve	10009	2
105	VALVE — Fuel Shut-Off, Flexible Line	5051	1
106	VALVE — Exhaust	10301	1
107	VALVE — Intake	10302	1
108	VANE — Air Governor	10393	1
109	WASHER — "C," Valve Keeper	3291	2
110	WASHER — Lock, 7/16 (Starter Pulley)	3275	1
111	WASHER — Felt (Power Take-Off, Dust Seal)	7443	1
112	WASHER — Flat, Steel (Power Take-Off, Dust Seal)	7444	1
113	WASHER — Spring Tension (Throttle Lever)	10305	1



DIMENSIONAL SPECIFICATIONS AND POWER DATA

Detailed prints and engineering counsel are available. Specifications and Dimensions are subject to change without notice.

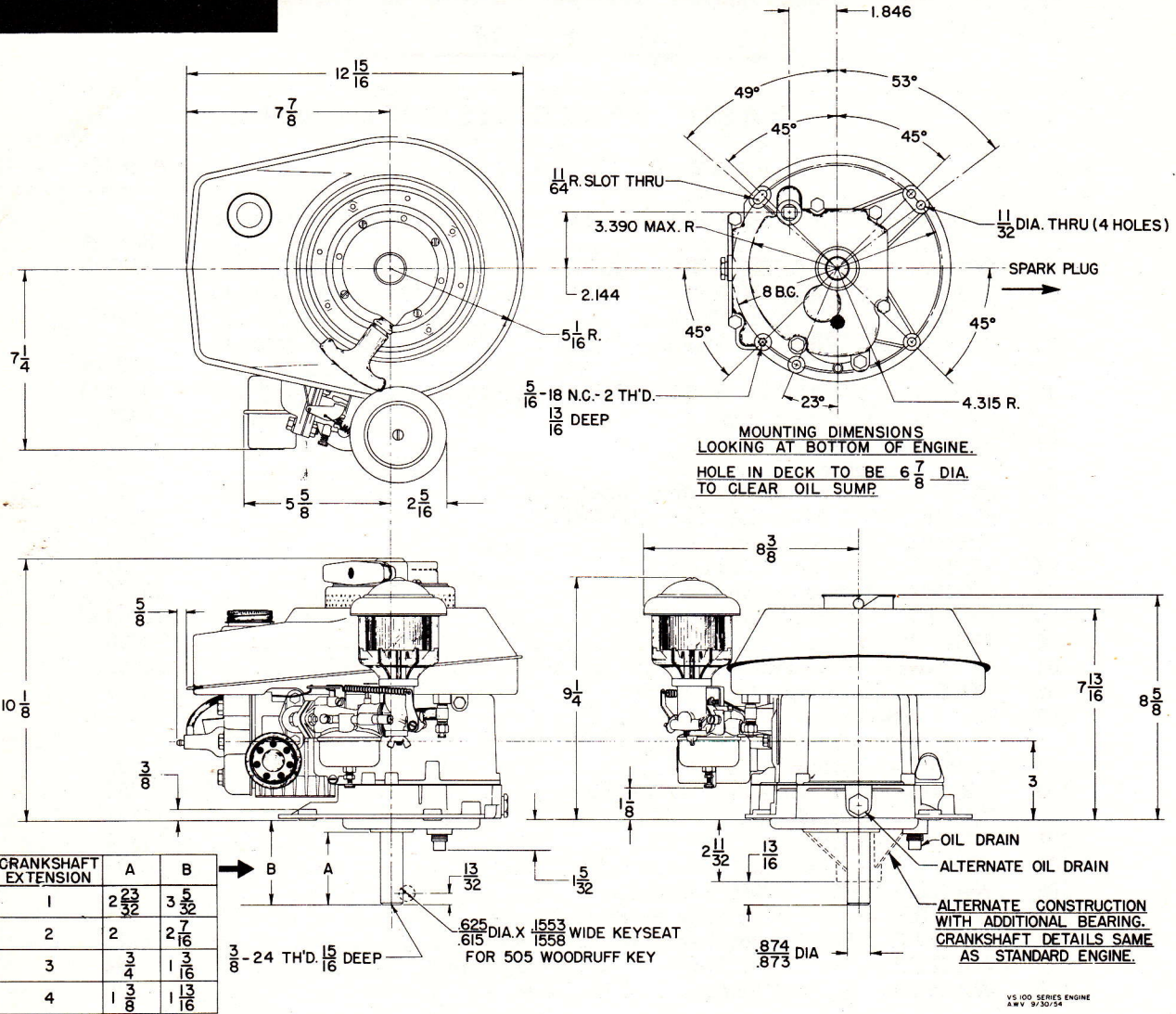

POWER DATA

The performance and power analysis figures for the Clinton Engine series show the rated Brake Horse Power developed from test-run engines. The standard engine equipped with standard air cleaner and muffler was used, in every case, for these tests and the figures have been corrected for barometer at sea level and temperature of 60° F. Production engines when shipped will develop not less than 85% of rated B.H.P.

Production engines, after run-in to reduce friction will develop not less than 95% of the rated B.H.P.

Engine power will decrease 3% for each 1,000 feet above sea level, and 1% for each 10° F. above standard temperature of 60° F.

Unless otherwise specified, governors are set to operate at 3,000 R.P.M. without load. Complete details of installations requiring continuous operation at other than recommended speeds should be referred to the factory for approval.

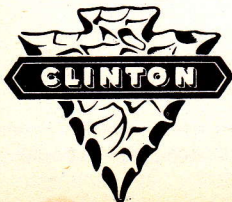
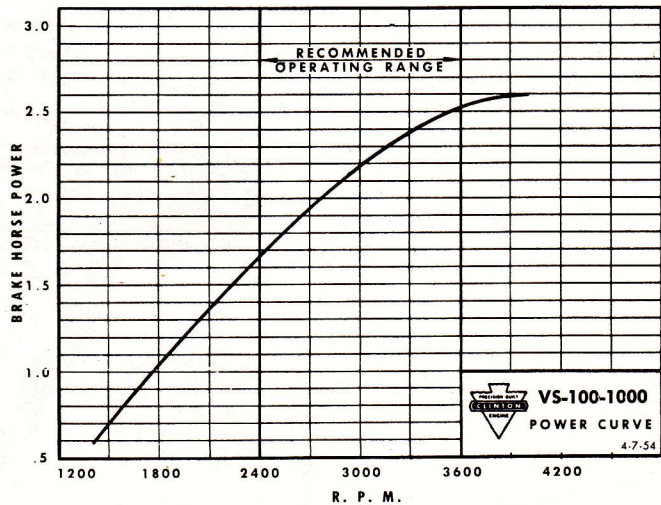

CABLE ADDRESS: ENGINES U. S. A.

ENGINE DIVISION OF **CLINTON MACHINE CO.**

MAQUOKETA, IOWA

CLINTON

S	E	R	I	E	S
VS-100-1000					
G E M					

**MODEL
VARIATIONS**
**SEC. II, DIV. VS-100-1000
PARTS CATALOG**
 Revised May, 1957
 Supersedes Sept., 1956

The adaptation of Clinton Engines to a wide variety of uses results in what is known as "Model Variations." Following is the complete list of all Models produced up to issue date (shown above). Opposite each Engine Model listed are the Part Numbers and/or Assembly Numbers for the Series used IN ADDITION TO or IN PLACE OF the parts illustrated and shown on the Basic Parts List preceding this Model Variation List. Refer to other sections of this Manual when Assembly Numbers are given to find the Parts List for these assemblies.

See page (a) on "How to Identify Your Clinton Engine." Use the preceding Basic Parts List except as shown below.

MODEL VARIATIONS OF VS-100-1000 SERIES

ENGINE MODEL —See page (a), "How to Identify Your Clinton Engine."	FOOTNOTES (Check page four).	BASE—ENGINE (Part Numbers Shown). Refer to Sec. IV, Div. A for further information.	CONTROL GROUP (Control Group Illustration Numbers Shown). Refer to Sec. III, Div. D for Parts List.	CONTROL CABLE LENGTH —Replacement cable is furnished in 72" length ONLY, cut to length shown.	CRANKSHAFT (Part Numbers Shown). Refer to Sec. IV, Div. B for details and further information.	STARTER—RECOIL . Refer to Sec. III, Div. H for Parts List.
HOUSING ASSEMBLY — BLOWER (Part Numbers Shown). Refer to Basic Parts List for corresponding part.						
VS-100-1100					10101	
VS-100-1110	Note 12	10050-A				
VS-100-1112	Note 12	10050-A				
VS-100-1117			SK550	72"		
VS-100-1120	No Variation—Use Basic Parts List					
VS-100-1124					10101	Yes 10313-B
VS-100-1127	Notes 4, 5 & 15	10053-A			10107	Yes 10313-B
VS-100-1140	Note 12	10050-A	SK550	72"		
VS-100-1152	Note 12	10050-A				Yes 10313-B
VS-100-1155						Yes 10313-B
VS-100-1158					10101	
VS-100-1161			SK550		10103	
VS-100-1165			SK553			
VS-100-1167	Note 5				10108	
VS-100-1168					10109	
VS-100-1177	Notes 4 & 5	10052	SK550	72"		
VS-100-1189			SK550		10101	
VS-100-1216	Note 1				10101	Yes 10313-B
VS-100-1220	Notes 9, 12 & 14	10050-A			10116	
VS-100-1222			SK550			
VS-100-1223			SK550			Yes 10313-B
VS-100-1226						Yes 10313-B
VS-100-1228	Note 1		SK550	72"		
VS-100-1231	Notes 10 & 13		SK550		10101	Yes 10313-B
VS-100-1233	Note 12	10050-A				Yes 10313-B
VS-100-1238	Notes 5 & 12	10050-A				
VS-100-1239			SK553			Yes 10313-B
VS-100-1242	Note 5				10108	Yes 10313-B
VS-100-1244	Note 10		SK550		10103	Yes 10313-B
VS-100-1248	Note 12	10050-A			10119	Yes 10313-B
VS-100-1249			SK553			Yes 10313-B
VS-100-1250						Yes 10313-B
VS-100-1251						Yes 10313-B
VS-100-1252						Yes 10313-B

CLINTON

S E R I E S
VS-100-1000
G E M

**MODEL
VARIATIONS**

MODEL VARIATIONS OF VS-100-1000 SERIES (Cont.)

ENGINE MODEL	FOOTNOTES	BASE—ENGINE	CONTROL GROUP	CONTROL CABLE LENGTH	CRANKSHAFT	STARTER—RECOIL	HOUSING ASSEMBLY—BLOWER
VS-100-1254	Notes 5 & 12	10050-A				Yes	10313-B
VS-100-1255	Notes 10 & 11		SK553			Yes	10313-B
VS-100-1256					10105	Yes	10313-B
VS-100-1257	Note 12	10050-A				Yes	10313-B
VS-100-1259	Note 12	10050-A	SK550	72"		Yes	10313-B
VS-100-1260	Note 4	10052	SK550			Yes	10313-B
VS-100-1261	No Variation—Use Basic Parts List						
VS-100-1262						Yes	10313-B
VS-100-1263	Note 4	10052	SK553			Yes	10313-B
VS-100-1266			SK550	54"	10103	Yes	10313-B
VS-100-1269	Note 5					Yes	10313-B
VS-100-1270	Note 5		SK550	72"		Yes	10313-B
VS-100-1271	Note 12	10050-A	SK553	46¼"	10106	Yes	10313-B
VS-100-1272					10103	Yes	10313-B
VS-100-1273	Notes 4 & 5	10056	SK553		10122	Yes	10313-B
VS-100-1274	Note 4	10056	SK553		10121	Yes	10313-B
VS-100-1275	Note 7						
VS-100-1276	Notes 10 & 12				10102	Yes	10313-B
VS-100-1277					10119	Yes	10313-B
VS-100-1278					10119	Yes	10313-B
VS-100-1279					10109	Yes	10313-B
VS-100-1280			SK553			Yes	10313-B
VS-100-1281	Notes 4 & 5	10056	SK553		10122	Yes	10313-B
VS-100-1282					10101	Yes	10313-B
VS-100-1283			SK550			Yes	10313-B
VS-100-1284			SK550		10101	Yes	10313-B
VS-100-1285			SK550		10103	Yes	10313-B
VS-100-1286	Notes 5 & 12	10050-A	SK550	72"		Yes	10313-B
VS-100-1287	Notes 5 & 12	10050-A	SK550			Yes	10313-B
VS-100-1288	Note 5		SK553		10110	Yes	10313-B
VS-100-1289	Note 1		SK550	72"		Yes	10313-B
VS-100-1290	Notes 5 & 12	10050-A	SK550	72"			
VS-100-1291	Notes 5 & 12	10050-A	SK550	72"		Yes	10313-B
VS-100-1294	Note 9					Yes	10313-B
VS-100-1295			SK553			Yes	10313-B
VS-100-1297						Yes	10313-B
VS-100-1298						Yes	10313-B
VS-100-1299						Yes	10313-B
VS-100-1300	Note 10		SK550			Yes	10313-B
VS-100-1301	Note 4	10052	SK550		10106	Yes	10313-B
VS-100-1302	Note 4	10052	SK550		10107	Yes	10313-B
VS-100-1303	Note 4	10052	SK550		10109	Yes	10313-B
VS-100-1304	Note 4	10052	SK550		10101	Yes	10313-B
VS-100-1305	Note 14					Yes	10313-B
VS-100-1307	Note 7					Yes	10313-B
VS-100-1308	Notes 10 & 12				10102		

CLINTON

S	E	R	I	E	S
VS-100-1000					
G E M					

**MODEL
VARIATIONS**
 SEC. II DIV. VS-100-1000
 PARTS CATALOG
 Revised May, 1957
 Supersedes Sept., 1956

MODEL VARIATIONS OF VS-100-1000 SERIES (Cont.)

ENGINE MODEL	FOOTNOTES	BASE— ENGINE	CONTROL GROUP	CONTROL CABLE LENGTH	CRANKSHAFT	STARTER— RECOIL	HOUSING ASSEMBLY— BLOWER
VS-100-1309						Yes	10313-B
VS-100-1310			SK553		10101		
VS-100-1311			SK550		10104	Yes	10313-B
VS-100-1312			SK550			Yes	10313-B
VS-100-1313	Note 9					Yes	10313-B
VS-100-1314	No Variation—Use Basic Parts List						
VS-100-1315						Yes	10313-B
VS-100-1316	Note 5				10101	Yes	10313-B
VS-100-1317	No Variation—Use Basic Parts List						
VS-100-1318						Yes	10313-B
VS-100-1319	Notes 4, 12, 13, 14	10052	SK550		10102		
VS-100-1320	Notes 9, 10, 11		SK553			Yes	10313-B
VS-100-1321			SK553				
VS-100-1322	Notes 9 & 12	10050-A			10116		
VS-100-1323					10101	Yes	10313-B
VS-100-1324	Notes 4 & 12	10054-A	SK550		10116	Yes	10313-B
VS-100-1325			SK550			Yes	10313-B
VS-100-1326						Yes	10313-B
VS-100-1327			SK553			Yes	10313-B
VS-100-1328			SK553			Yes	10313-B
VS-100-1329	Note 7					Yes	10313-B
VS-100-1330	Note 14					Yes	10313-B
VS-100-1331						Yes	10313-B
VS-100-1332			SK550	54"	10103	Yes	10313-B
VS-100-1333					10103	Yes	10313-B
VS-100-1334					10101	Yes	10313-B
VS-100-1335	Notes 10 & 13		SK550		10101	Yes	10313-B
VS-100-1336	Notes 4 & 5	10056	SK553		10122	Yes	10313-B
VS-100-1337	Notes 5 & 12	10050-A			10106	Yes	10313-B
VS-100-1338						Yes	10313-B
VS-100-1339	Notes 9, 10, 11		SK553			Yes	10313-B
VS-100-1340						Yes	10313-B
VS-100-1341	Note 5				10101	Yes	10313-B
VS-100-1342	Notes 4 & 5	10052	SK550	72"		Yes	10313-B
VS-100-1343			SK553			Yes	10313-B
VS-100-1344						Yes	10313-B
VS-100-1345	Note 4	10052	SK550		10103	Yes	10313-B
VS-100-1346			SK550		10101	Yes	10313-B
VS-100-1347			SK550	72"		Yes	10313-B
VS-100-1348			SK550			Yes	10313-B
VS-100-1349	Note 12	10050-A				Yes	10313-B
VS-100-1350	Notes 5 & 12	10050-A	SK550			Yes	10313-B
VS-100-1351					10109	Yes	10313-B
VS-100-1352	Note 12	10050-A	SK550	72"			
VS-100-1353	No Variation—Use Basic Parts List						
VS-100-1354			SK553				

CLINTON

S E R I E S
VS-100-1000
G E M

**MODEL
VARIATIONS**

MODEL VARIATIONS OF VS-100-1000 SERIES (Cont.)

ENGINE MODEL	FOOTNOTES	BASE-ENGINE	CONTROL GROUP	CONTROL CABLE LENGTH	CRANKSHAFT	STARTER-RECOIL	HOUSING ASSEMBLY-BLOWER
VS-100-1355			SK550				
VS-100-1356						Yes	10313-B
VS-100-1357	Note 10				10101	Yes	10313-B
VS-100-1358	Notes 7 & 10					Yes	10313-B
VS-100-1359	Note 12	10050-A	SK550			Yes	10313-B
VS-100-1360	Notes 4 & 12	10054-A	SK550	72"		Yes	10313-B
VS-100-1361						Yes	10313-B
VS-100-1362						Yes	10313-B
VS-100-1363	Note 5				10106	Yes	10313-B
VS-100-1364	Note 10					Yes	10313-B
VS-100-1365			SK553			Yes	10313-B
VS-100-1366	Note 9				10123	Yes	10313-B
VS-100-1367	Note 14					Yes	10313-B
VS-100-1368	Note 9				10101		
VS-100-1369	Note 9				10101	Yes	10313-B
VS-100-1370						Yes	10313-B
VS-100-1371					10101	Yes	10313-B
VS-100-1372	Notes 4 & 15	10053-A			10107	Yes	10313-B
VS-100-1373	Notes 9, 12, 16		SK553		10150	Yes	10313-B
VS-100-1374			SK550		10101	Yes	10313-B
VS-100-1375						Yes	10313-B
VS-100-1376			SK553		10103	Yes	10313-B
VS-100-1377	Note 1		SK550			Yes	10313-B
VS-100-1378					10101	Yes	10313-B
VS-100-1379	Note 4	10052				Yes	10313-B
VS-100-1380	Note 4	10056	SK553		10121	Yes	10313-B
VS-100-1381	Note 4	10056	SK553		10121	Yes	10313-B
VS-100-1382	Note 4	10056	SK553		10121	Yes	10313-B
VS-100-1383			SK553		10121	Yes	10313-B
VS-100-1384			SK553			Yes	10313-B
VS-100-1385	Note 18				10116	Yes	10313-B
VS-100-1386	Note 5				10110	Yes	10313-B
VS-100-1387	Note 12		SK550	72"		Yes	10313-B
VS-100-1388			SK550		10101	Yes	10313-B
VS-100-1389	Note 14		SK550			Yes	10313-B
VS-100-1390	Note 17						
VS-100-1391	Note 10					Yes	10313-B
VS-100-1392			SK553			Yes	10313-B
VS-100-1393	Note 4	10052	SK550		10116	Yes	10313-B
VS-100-1394	Note 4	10052					
VS-100-1395	Note 14					Yes	10313-B
VS-100-1396			SK550		10103	Yes	10313-B
VS-100-1397						Yes	10313-B
VS-100-1398	Note 10		SK550		10101	Yes	10313-B
VS-100-1399						Yes	10313-B
VS-100-1400						Yes	10313-B

CLINTON

S E R I E S
VS-100-1000
G E M

**MODEL
VARIATIONS**
**SEC. II, DIV. VS-100-1000
PARTS CATALOG**
 Revised May, 1957
 Supersedes Sept., 1956

MODEL VARIATIONS OF VS-100-1000 SERIES (Cont.)

ENGINE MODEL	FOOTNOTES	BASE— ENGINE	CONTROL GROUP	CONTROL CABLE LENGTH	CRANKSHAFT	STARTER— RECOIL	HOUSING ASSEMBLY— BLOWER
VS-100-1401	Note 10		SK550			Yes	10313-B
VS-100-1402			SK553		10103	Yes	10313-B
VS-100-1403	Note 9		SK553		10103	Yes	10313-B
VS-100-1404			SK553		10124	Yes	10313-B
VS-100-1405	Note 4	10052	SK553				10313-B

NOTE 1—Elbow, Street (90°) #7274 must be used.

NOTE 2—Lockwasher #5488 to be installed between air cleaner and air horn. Nut, Wing #7044 to be installed on top of air cleaner cover.

NOTE 3—Deflector Assembly #10006-D used.

NOTE 4—Plugs #5649 and #5655 used.

NOTE 5—Muffler #4500 used in lieu of #3639.

NOTE 6—Gasket, Manifold #6002 used in lieu of #7149.

NOTE 7—Manifold, Intake #10311 and Lever, Speed Control #7465 used.

NOTE 8—Pulley, Starter #4882 used on this model.

NOTE 9—Wire Assembly—Ignition Shorting #5567-A, Grommet #5566, Terminal #2228 and Screw #5644 used as additional parts.

NOTE 10—Muffler #6342 used in lieu of #3639.

NOTE 11—Air Cleaner Assembly #6331 used in lieu of #4512-A.

NOTE 12—Use #4558 Protector.

NOTE 13—Use #5711-A Flywheel.

NOTE 14—Use #4512-A Air Cleaner Assembly.

NOTE 15—Use #10337 Spring, Governor.

NOTE 16—8.5:1 Speed Reducer—Refer to Sec. III, Div. L, page 4.

NOTE 17—Use 110 Volt Starter—Refer to Sec. III, Div. N.

NOTE 18—Wire Assembly—Ignition Shorting #5567-A, Grommet #10336, Terminal #2228 and Screw #5644 used as additional parts.

NOTE 19—Use #2324-A Muffler.

NOTE 20—Use #2129-A Muffler.