

**SEC. II. DIV. VS-1100
PARTS CATALOG**
 Revised March, 1957
 Supersedes Sept. 1956

CLINTON

**S E R I E S
VS-1100
LONG LIFE**

**BASIC
TYPE**

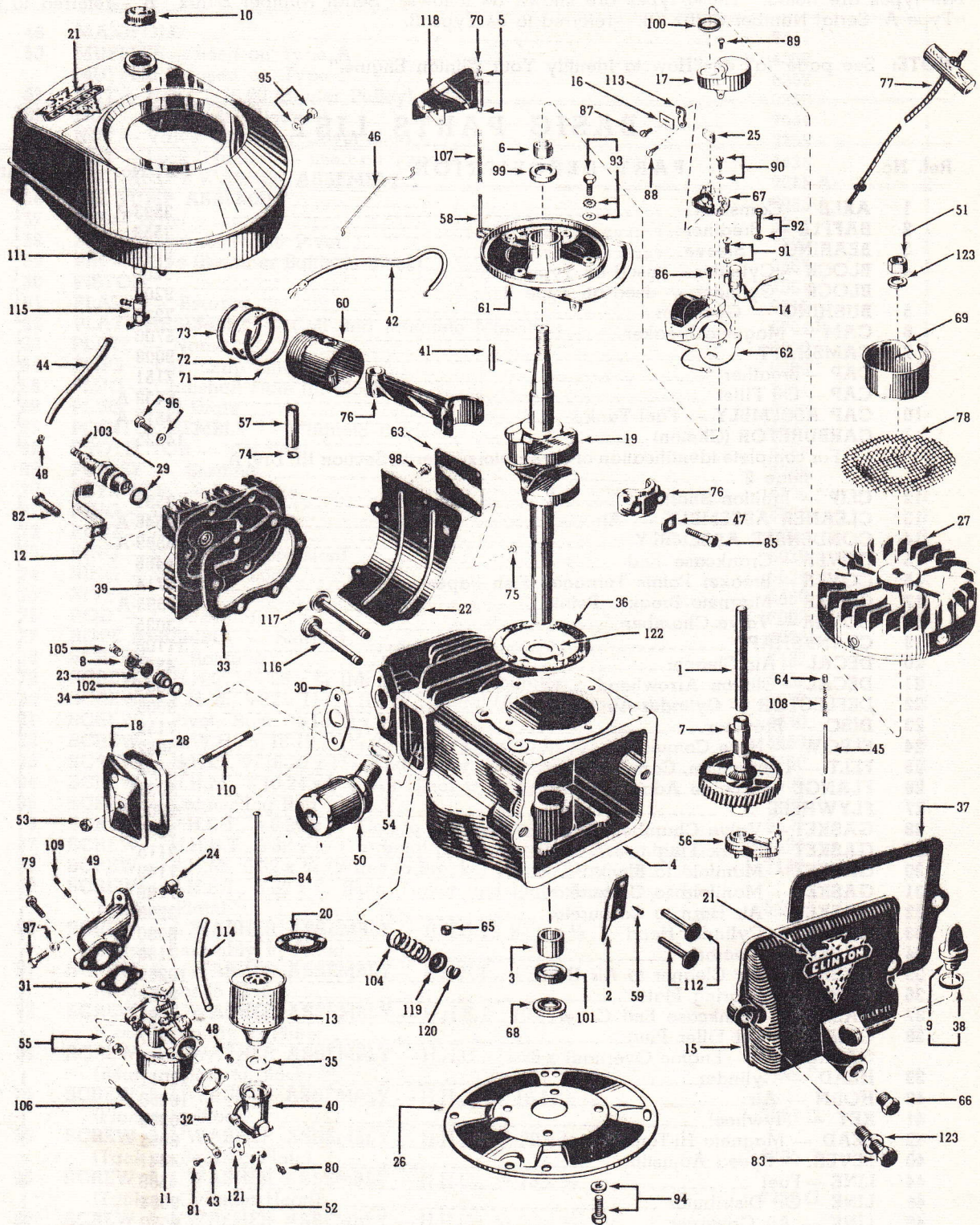

CLINTON

S	E	R	I	E	S
VS-1100					
LONG LIFE					

TYPE
BASICSEC. II, DIV. VS-1100
PARTS CATALOG
Revised March, 1957
Supersedes Sept. 1956

There are two Basic Types of VS-1100 Series engine covered by this Basic Parts List. Parts not used on all types are noted. These types are shown as follows: Serial Number Suffix "A"—referred to as Type A; Serial Number Suffix "B"—referred to as Type B.

NOTE: See page "a" on "How to Identify Your Clinton Engine."

BASIC PARTS LIST

Ref. No.	PART DESCRIPTION	Part No.	Quantity
1	AXLE — Camshaft	3593-A	1
2	BAFFLE — Breather	3559	1
3	BEARING — Sleeve	9016	1
4	BLOCK — Cylinder — used on Type A	9200	1
	BLOCK — Cylinder — used on Type B	9202	1
5	BUSHING — Governor	7239	2
6	CAM — Magneto Breaker	5703	1
7	CAMSHAFT	9008	1
8	CAP — Breather	7151	1
9	CAP — Oil Filler	6438-A	1
10	CAP ASSEMBLY — Fuel Tank	4517-A	1
11	CARBURETOR (Clinton)	14025	1
	For complete identification of carburetors, refer to Section III, Div. A, page 2.		
12	CLIP — Ignition Shorting	3599	1
13	CLEANER ASSEMBLY — Air	4546-A	1
14	CONDENSER ASSEMBLY	P5589-A	1
15	COVER — Crankcase End	4466	1
16	COVER — Breaker Points Terminal (Fish Paper)	5714	1
17	COVER — Magneto Breaker Points	P5595-A	1
18	COVER — Valve Chamber	3035	1
19	CRANKSHAFT	11100	1
20	DECAL — Air Cleaner	4561	1
21	DECAL — Clinton Arrowhead	4564	1
22	DEFLECTOR — Cylinder Air	9006	1
23	DISC — Breather	7152	1
24	ELBOW — Hose Connecting	5052	1
25	FELT — Lubrication, Cam Follower	P5504	1
26	FLANGE — Engine Adapter	9031	1
27	FLYWHEEL	9000	1
28	GASKET — Valve Chamber Cover to Block	3057	1
29	GASKET — Spark Plug	3115	1
30	GASKET — Manifold to Block	7149	1
31	GASKET — Manifold to Carburetor	7168	1
32	GASKET — Air Horn to Carburetor	3990	1
33	GASKET — Cylinder Head	6030	1
34	GASKET — Breather	7153	1
35	GASKET — Air Cleaner to Air Horn	10259	1
36	GASKET — Bearing Plate	3056	1
37	GASKET — Crankcase End Cover	4465	1
38	GASKET — Oil Filler Plug	3297	1
	GASKET KIT — Engine Overhaul	6355	1
39	HEAD — Cylinder	12011	1
40	HORN — Air	10350	1
41	KEY — Flywheel	10339	1
42	LEAD — Magneto Hi-Tension	9055	1
43	LEVER — Speed Adjusting	4441	1
44	LINE — Fuel	4586	1
45	LINE — Oil Distributor	9084	1
46	LINK — Air Governor	9020	1
47	LOCK — Connecting Rod Screw	3027	2
48	MANDREL	10353	2

CLINTON

S E R I E S
VS-1100
LONG LIFE

TYPE
BASIC

BASIC PARTS LIST (Continued)

Ref. No.	PART DESCRIPTION	Part No.	Quantity
49	MANIFOLD	6411	1
50	MUFFLER — used on Type A	4500	1
	MUFFLER — used on Type B	6352	1
51	NUT — Hex., 7/16-20 (Starter Pulley)	3250	1
52	NUT — Wing (Air Cleaner)	7044	1
53	NUT — Valve Chamber Cover Stud	3255	1
54	NUT — Lock (Muffler) — used on Type A	4425	1
55	NUT AND L'WASHER ASSEMBLY	3255-A	2
56	OIL PUMP ASSEMBLY	9085-A	1
57	PIN — Wrist	6024	1
58	PIN — Governor Vane Pivot	7238	1
59	PIN — Drive (Breather Baffle to Block)	3569	1
60	PISTON	31001	1
61	PLATE — Bearing	9015	1
62	PLATE ASSEMBLY — Coil and Magneto Mounting	5704-B	1
63	PLATE — Name	6530	1
64	PLUG — Oil Pump Line	9028	1
65	PLUG — Camshaft Hole (In Block)	3281	1
66	PLUG — Oil Drain	3289	1
67	POINT ASSEMBLY — Magneto Breaker	P5543	1
68	PROTECTOR — Oil Seal	4588	1
69	PULLEY — Starting	3299	1
70	RETAINER — Air Vane	4430	1
71	RING — Piston (Oil)	6006	1
72	RING — Piston (Scraper)	6027	1
73	RING — Piston (Compression)	6026	1
74	RING — Wrist Pin Lock	6034	2
75	RIVET	5469	4
76	ROD — Connecting	12002-A	1
77	ROPE ASSEMBLY — Starting	4266	1
78	SCREEN — Rotating	7187	1
79	SCREW — H.H.C., 1/4-28 x 3/4 (Manifold to Carburetor)	5650	1
80	SCREW — F.H.M., 8-32 x 11/16 (Lock Thread) (Air Horn to Carburetor)	5677	2
81	SCREW — Pivot, Spec. #10-32 x 1/4	4440	1
82	SCREW — H.W.H., 5/16-18 x 1 1/4 (Cylinder Head to Block)	5652	6
83	SCREW — H.H.C., 7/16-20 x 1 1/4 (End Cover to Block)	5400	2
84	SCREW — R.H.M., #10-24 x 6 1/4 (Air Cleaner to Air Horn)	5636	1
85	SCREW — Connecting Rod	5635	2
86	SCREW — P.H.S.T., #6-32 x 1/4 (Coil to Lamination)	5641	1
87	SCREW — H.H.S.T., 6-32 x 1/2 (Terminal to Breaker Point Assembly)	5664	1
88	SCREW — R.H.M., 6-32 x 1/4 (Wires to Breaker Points Terminal)	7143	1
89	SCREW — R.H.S.T., 6-32 x 3/8 (Point Cover and Plate Assembly to Bearing Plate)	5405	2
90	SCREW & L'WASHER ASSEMBLY — R.H.S.T., 8-32 x 3/8 (Points Assembly to Plate)	5409-F	1
91	SCREW & L'WASHER ASSEMBLY — R.H.S.T., 8-32 x 3/8 (Condenser to Plate)	5674-F	1
92	SCREW & L'WASHER ASSEMBLY — H.H.S.T., 10-24 x 1 (Coil Assembly to Plate)	5682-A	2
93	SCREW & L'WASHER ASSEMBLY — H.H.C., 1/4-28 x 3/4 (Bearing Plate to Block)	5448-F	4
94	SCREW & L'WASHER ASSEMBLY — H.H.C., 5/16-18 x 1/2 (Flange to Block)	3221-G	4
95	SCREW & L'WASHER ASSEMBLY — H.H.C., 1/4-20 x 1/2 (Tank to Bearing Plate)	3205-G	2
96	SCREW & L'WASHER ASSEMBLY — H.H.C., 1/4-28 x 5/8 (Tank to Cylinder Head)	7236-G	2
97	SCREW & L'WASHER ASSEMBLY — H.H.C., 1/4-28 x 3/4 (Manifold to Block)	3230-G	2

CLINTON

S	E	R	I	E	S
VS-1100					
LONG LIFE					

**BASIC
TYPE**

SEC. II, DIV. VS-1100
PARTS CATALOG
Revised March, 1957
Supersedes Sept. 1956

BASIC PARTS LIST (Continued)

Ref. No.	PART DESCRIPTION	Part No.	Quantity
98	SCREW & L'WASHER ASSEMBLY — R.H.M., 10-32 x 3/8 (Deflector to Head).....	3222-A	2
99	SEAL — Oil (Bearing Plate).....	3136	1
100	SEAL — Breaker Point Cover.....	5596	1
101	SEAL — Oil (Block).....	9029	1
102	SEAT — Breather.....	4438	1
103	SPARK PLUG ASSEMBLY.....	3568-A	1
104	SPRING — Valve.....	3068	2
105	SPRING — Breather Hold-Down.....	7154	1
106	SPRING — Air Governor.....	10336	1
107	SPRING — Compression.....	10005	1
108	SPRING — Oil Distributor Line.....	9083	1
109	STUD.....	6155	1
110	STUD — Valve Chamber Cover.....	5680	1
111	TANK ASSEMBLY — Fuel.....	10370-G	1
112	TAPPET — Valve.....	3034	2
113	TERMINAL — Breaker Point.....	5713	1
114	TUBE — Breather.....	10352	1
115	VALVE — Fuel Shut-Off.....	5051	1
116	VALVE — Exhaust.....	3031-1	1
117	VALVE — Intake.....	3032-1	1
118	VANE — Air Governor.....	10393	1
119	WASHER — Retainer (Valve Spring).....	3028	2
120	WASHER — "C" (Valve Keeper).....	3291	2
121	WASHER — Spring Tension.....	10305	1
122	WASHER — Thrust.....	9050	1
123	WASHER — Lock (1—Starter Pulley; 2—End Cover to Block).....	3275	3

CLINTON

SERIES VS-1100 LONG LIFE

MODEL VARIATIONS

SEC. II, DIV. VS-1100
PARTS CATALOG
Revised January, 1959
Supersedes May, 1957

MODEL VARIATIONS OF VS-1100 SERIES

The adaptation of Clinton Engines to a wide variety of uses results in what is known as "Model Variations." Following is the complete list of all Models produced up to issue date (shown above). Opposite each Engine Model listed are the Part Numbers and/or Assembly Numbers for the Series used IN ADDITION TO or IN PLACE OF the parts illustrated and shown on the Basic Parts List preceding this Model Variations List. Refer to other sections of this Manual when Assembly Numbers are given to find the Parts List for these assemblies.

See page (a) on "How to Identify Your Clinton Engine." Use the preceding Basic Parts List except as shown below.

ENGINE MODEL — See page (a), "How to Identify Your Clinton Engine."	FOOTNOTES (Check page two).	BLOCK ASSEMBLY — CYLINDER (Part Numbers Shown). Refer to Illustrated Basic Parts List for corresponding part.	CONTROL GROUP (Control Group Illustration Numbers Shown). Refer to Sec. III, Div. D for Parts List.	CONTROL CABLE LENGTH — Replacement cable is furnished in 72" length ONLY, cut to length shown.	CRANKSHAFT (Part Numbers Shown). Refer to Sec. IV, Div. B for details and further information.	STARTER—RECOIL (Assembly Numbers Shown). Refer to Sec. III, Div. H for Parts List.	HOUSING ASSEMBLY — BLOWER (Part Numbers Shown). Refer to Illustrated Basic Parts List for corresponding part.
VS-1100-103			SK-550				
VS-1100-104			SK-550				
VS-1100-105						Yes	10370-H
VS-1100-106	3		SK-553			Yes	10370-H
VS-1100-107	No Variation, Use Basic Parts List					Yes	10370-H
VS-1100-108			SK-550	72"			
VS-1100-109	7, 15, 16		SK-562		11125	Yes	10370-H
VS-1100-110			SK-550		11127	Yes	10370-H
VS-1100-111						Yes	10370-H
VS-1100-112			SK-553			Yes	10370-H
VS-1100-113	1		SK-550		11107	Yes	10370-H
VS-1100-114	1		SK-553		11124	Yes	10370-H
VS-1100-115	2, 6		SK-550		11107	Yes	10370-H
VS-1100-116	No Variation, Use Basic Parts List						
VS-1100-117						Yes	10370-H
VS-1100-118	5, 8, 9, 10	9201			11126	Yes	10370-H
VS-1100-119	2, 11		SK-550			Yes	10370-H
VS-1100-120			SK-550			Yes	10370-H
VS-1100-121	1, 7, 15, 16		SK-562		11129	Yes	10370-H
VS-1100-122			SK-550	72"			10370-H
VS-1100-123	4						
VS-1100-124	1				11128	Yes	10370-H
VS-1100-125	1		SK-553		11107	Yes	10370-H
VS-1100-126	5, 8, 9, 10, 17	9201			11126	Yes	10370-H
VS-1100-127			SK-550		11101		
VS-1100-128			SK-550		11101	Yes	10370-H
VS-1100-129	5, 10		SK-552		11123	Yes	10370-H
VS-1100-130	5					Yes	10370-H
VS-1100-131	2, 12		SK-550	72"		Yes	10370-H
VS-1100-132	2, 4, 12		SK-550	72"			10370-H
VS-1100-133	2, 12		SK-550	72"		Yes	10370-H
VS-1100-134			SK-550	72"		Yes	10370-H
VS-1100-135	5		SK-550	72"		Yes	10370-H
VS-1100-136			SK-550	72"	11102	Yes	10370-H

CLINTON



MODEL
 VARIATIONS

MODEL VARIATIONS OF VS-1100 SERIES (Cont.)

ENGINE MODEL	FOOTNOTES	BLOCK ASSEMBLY—CYLINDER	CONTROL GROUP	CONTROL CABLE LENGTH	CRANKSHAFT	STARTER—RECOIL	HOUSING ASSEMBLY—BLOWER
VS-1100-137	13, 14		SK-552		11104	Yes	10370-H
VS-1100-138	1, 6, 18					Yes	10370-H
VS-1100-139	5		SK-550		11101	Yes	10370-H
VS-1100-140	1	9200	SK-550	72"		Yes	10370-H
VS-1100-142	No Variation, Use Basic Parts List						
VS-1100-143	5		SK-550			Yes	10370-H

NOTE 1—Use #4500 Muffler.

NOTE 2—Use #3639 Muffler.

NOTE 3—Use #10354 Breather Tube, #7938 Valve Chamber Cover, #5681 Screw and #7039 Nut.

NOTE 4—Use #C6344 110 Volt Electric Starter. See Sec. VIII, Div. N.

NOTE 5—Use #5530-D Shorting Wire Assembly, #5566 Grommet and #5644 Screw.

NOTE 6—Use #7474 Elbow.

NOTE 7—Use #4557-A Air Cleaner.

NOTE 8—Use #12062-A Muffler, #4419 Elbow and #4592 Elbow.

NOTE 9—Use #3994 Valve Insert with #3031-3 Valve (Exh.) as intake valve.

NOTE 10—Use #4181 Spark Plug Cover.

NOTE 11—Use #5649 Oil Drain Plug.

NOTE 12—Use #7274 Elbow.

NOTE 13—Use #9087 End Cover, #9088 Drain Pipe, #5694 Plug and #9032 Adapter Flange.

NOTE 14—Use #4512-A Air Cleaner and #5636 Screw.

NOTE 15—Use #14045 Carburetor, #7938 Valve Chamber Cover and #10354 Breather Tube.

NOTE 16—Use #4938 Starting Pulley.

NOTE 17—Use #14046 Carburetor, #14317 Bracket, #14318 Link, #14319 Lever Extension, #3288 Washer, #9037 Spring and #3222-F Screw and L washer.

NOTE 18—Use #9065 Speed Adjusting Lever.