

S E R I E S
VS-200-4000
 P A N T H E R

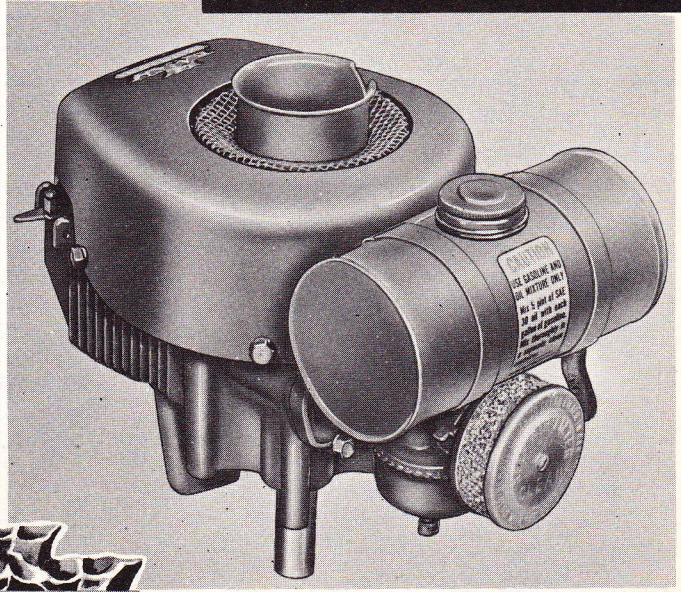

A Wide Range of Models are Made By **CLINTON ENGINES** For Farm, Home and Industrial Use.

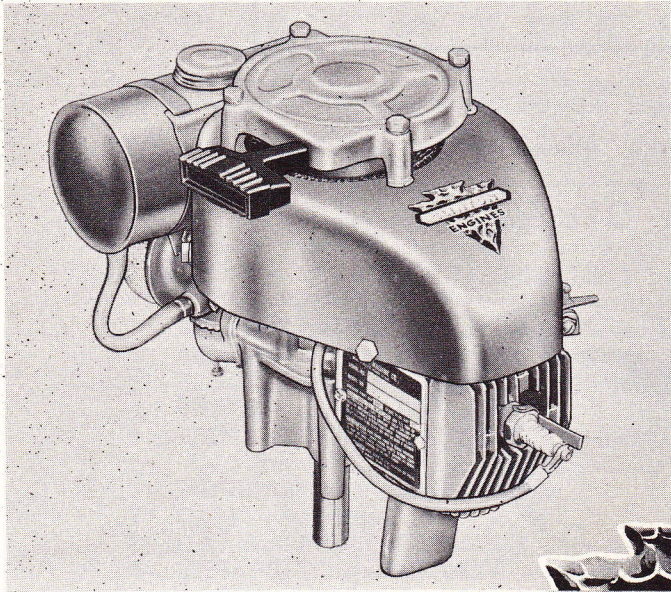
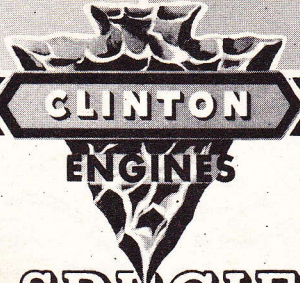

	H.P.	R.P.M.
VS-200-4000	1.3	2200
	1.75	2800
	2.25	3800

GENERAL SPECIFICATIONS

Model	Type	Description	Starter	Weight
VS-200-4000	Air-Cooled	Vertical Shaft	Rope	14 lbs.
VS-200-4000	Air-Cooled	Vertical Shaft	Recoil	15½ lbs.

BORE: 2½"

STROKE: 1⅝"

TYPE: Single cylinder, vertical shaft, air-cooled.

AIR COOLED: Powerful flywheel blower forces strong air blast through deep cooling fins on cylinder and cylinder head to maintain correct operating temperature.

PISTON DISPLACEMENT: 5.76 cu. inches.

IGNITION: Very high voltage, built-in flywheel magneto for faster starting. Moisture and dust-proof with fully enclosed ignition points. Positive safety ON-OFF device on spark plug.

SPARK PLUG: 14 mm.

LUBRICATION: Lubricating oil carried in fuel to all moving parts.

CARBURETOR: Full float feed with high speed adjustment.

GOVERNOR: Adjustable pneumatic type.

MAIN BEARINGS: Bronze.

CRANKSHAFT: Ductile iron, has counterweights integral with shaft. Bearing surfaces superfinished.

CONNECTING ROD: I-beam aluminum alloy with bronze crank pin and wrist pin bearings.

PISTON: Aluminum alloy, Clinton-engineered for efficient combustion.

PISTON RINGS: Two compression rings.

CYLINDER AND CRANKCASE: One-piece die cast cylinder block and crankcase with large amount of cooling area for cool operation. A close-grained cast iron liner is die cast in block.

CYLINDER HEAD: Integral with cylinder casting.

AIR CLEANER: Metallic mesh dry type.

FUEL TANK: One-quart capacity.

DIRECTION OF ROTATION: Counter-clockwise, viewed from power take-off shaft side.

FINISH: Red heat-resisting enamel. Other colors available upon request.

STANDARD EQUIPMENT

Standard equipment includes: Cast iron cylinder liner, replaceable bearing, air cleaner, specially designed dust and moisture-proof high voltage flywheel magneto, fuel tank, splash-proof gas tank cap, muffler, blower housing screen, rope starter. Safety stop device, remote throttle cable mounting.

SPECIAL EQUIPMENT

Special equipment includes: Remote throttle cable and controls, recoil starter, shorting terminal for remote stop hookup, 8-inch circle mounting adapter plate, deluxe muffler, special paint finishes, resistor spark plug, special crankshaft extensions, gas tank shroud, impulse starter. (Quotations available on request.)



WORLD'S LARGEST MANUFACTURER OF A COMPLETE LINE OF AIR-COOLED GASOLINE ENGINES

CLINTON ENGINES PROVIDE POWER

FOR FARM • HOME • INDUSTRIAL EQUIPMENT

PRINTED IN U.S.A.

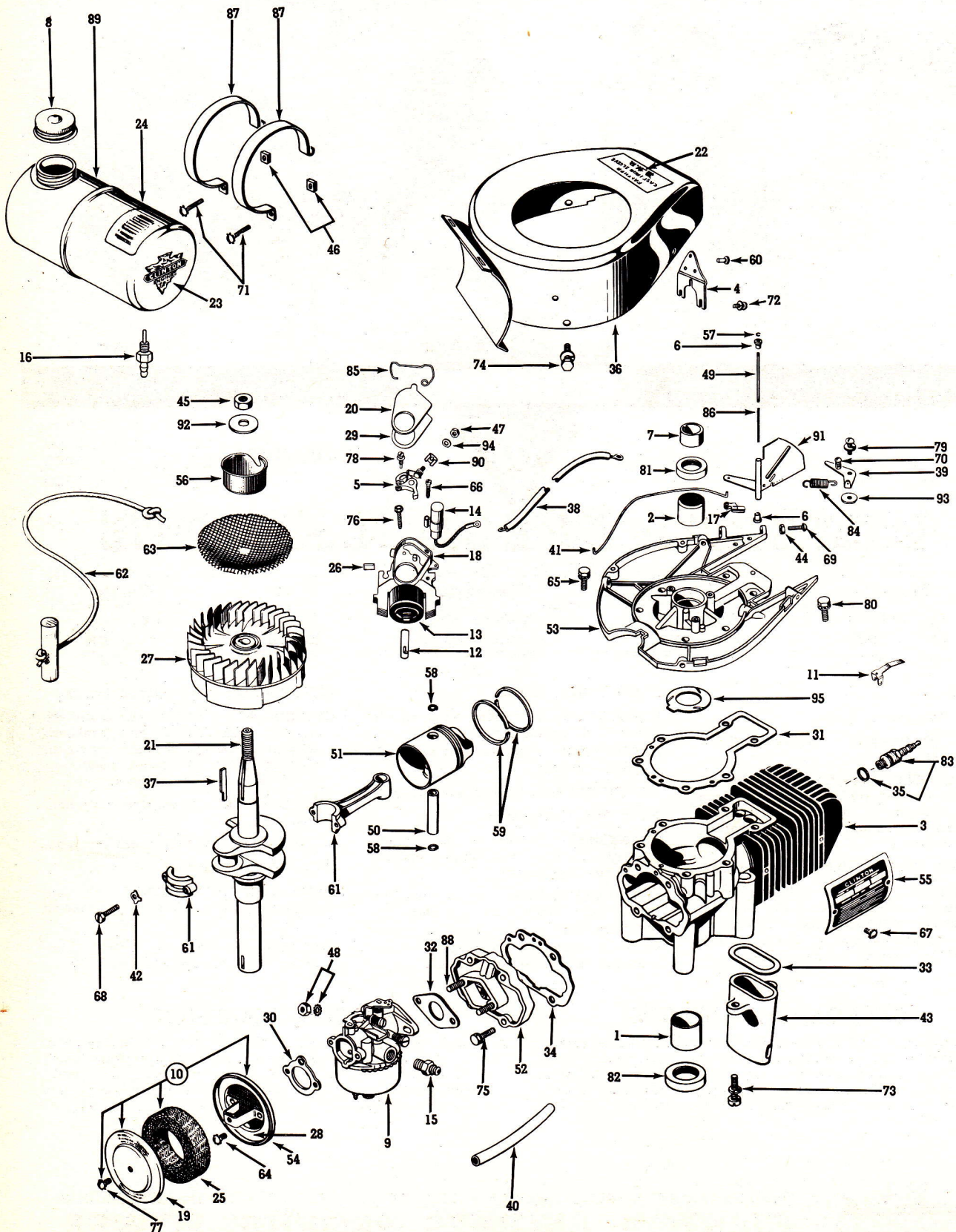

CLINTON

S	E	R	I	E	S	
VS-200-4000						
P	A	N	T	H	E	R

**BASIC
TYPE**SEC. II, DIV. VS-200-4000
PARTS CATALOG
Issued December, 1959

There is one Basic Type of the VS-200-4000 Series Engine covered by this Basic Parts List.

NOTE: See page "a" on "How to Identify Your Clinton Engine."**BASIC PARTS LIST**

Ref. No.	PART DESCRIPTION	Part No.	Quan.
1	BEARING — Main Sleeve (Block Assembly) -----	9016	1
2	BEARING — Sleeve (Bearing Plate) -----	2059	1
3	BLOCK ASSEMBLY — Cylinder (Includes Ref. Nos. 1 & 82)-----	2484-A	1
4	BRACE — Blower Housing -----	2127	1
5	BREAKER POINTS ASSEMBLY — Includes Ref. Nos. 26, 47, 78 and 94 -----	P5735	1
6	BUSHING — Air Vane -----	7239	2
7	CAM — Breaker Points -----	5751	1
8	CAP & GASKET ASSEMBLY — Fuel -----	4517-A	1
9	CARBURETOR ASSEMBLY — Clinton -----	14069	1
	For complete identification of carburetors, refer to Section III, Div. A, Page 2.		
10	CLEANER ASSEMBLY — Air (Includes Ref. Nos. 19, 25, 28, 54, 64 and 77) -----	2000-A	1
11	CLIP — Ignition Shorting -----	3499	1
12	CLIP — Coil Holding -----	P5734	1
13	COIL — Magneto (Without Laminations) -----	P5733-A	1
14	CONDENSER — Magneto -----	P5589-A	1
15	CONNECTOR — Fuel Line (Flexible) (Carburetor) -----	5053	1
16	CONNECTOR — Fuel Line (Tank) -----	5055	1
17	CONNECTOR — Governor Link to Air Vane -----	2226	1
18	CORE & BREAKER BOX ASS'Y — Includes Ref. No. 12 -----	P5732	1
19	COVER — Air Cleaner -----	2003	1
20	COVER — Dust, Magneto Breaker Points -----	P5743	1
21	CRANKSHAFT -----	2370-1	1
22	DECAL — Horsepower -----	90597	2
23	DECAL — Arrowhead -----	90559	1
24	DECAL — Instruction, Fuel Mixture -----	2098	1
25	ELEMENT — Air Cleaner -----	2132	1
26	FELT — Lubrication, Cam Follower -----	P5742	1
27	FLYWHEEL ASSEMBLY -----	5753-A	1
28	GASKET — Air Cleaner to Mounting Plate -----	21056	1
29	GASKET — Breaker Points Cover -----	P5744	1
30	GASKET — Air Cleaner to Carburetor -----	31445	1
31	GASKET — Bearing Plate (Standard, .030 thick) -----	2039	1
	NOTE: Gaskets are also available in the following thicknesses: .025 and .035. Order by Part Number and specify thickness.		
32	GASKET — Carburetor to Reed Plate -----	2096	1
33	GASKET — Muffler to Block -----	2069	1
34	GASKET — Reed Plate to Block -----	2344	1
35	GASKET — Spark Plug -----	3115	1
	GASKET KIT — Engine Overhaul -----	91558	1
	NOTE: Kit contains all necessary Gaskets and Oil Seals.		
36	HOUSING — Blower and Bracket Assembly -----	90587-F	1
37	KEY — Flywheel -----	10339	1
38	LEAD — High Tension Magneto -----	P2055	1
39	LEVER & SCREW ASSEMBLY — Throttle Control -----	2043-A	1
40	LINE — Fuel (Flexible) -----	6316	1
41	LINK — Air Governor -----	90569	1
42	LOCK — Connecting Rod Cap -----	2027	2
	MAGNETO ASSEMBLY — Includes Ref. Nos. 5, 12, 13, 14, 18, 20, 26, 29, 47, 66, 76, 78, 85, 90 and 94 -----	P5731	1
43	MUFFLER -----	2082	1
44	NUT — Hexagon, #8-32 (Speed Control Adjusting) -----	5522	1
45	NUT — Hexagon, ½-20 (Starter Pulley) -----	5942	1

CLINTON

S E R I E S
VS-200-4000
P A N T H E R

**BASIC
TYPE**

BASIC PARTS LIST (Continued)

Ref. No.	PART DESCRIPTION	Part No.	Quan.
46	NUT — Fuel Tank Straps	3253	2
47	NUT — Terminal Condenser Lead	5740	1
48	NUT & L'WASHER ASS'Y — Carburetor to Reed Plate	3255-A	2
49	PIN — Pivot, Air Vane	7238	1
50	PIN — Wrist	2428	1
51	PISTON — Standard	90364	1
	PISTON ASSEMBLY — Standard	90364-A	1
	NOTE: Piston and Piston Assemblies are available in the following oversizes: .050, .010 and .020. Order by Part Number and specify oversize.		
	NOTE: Piston Assembly includes Ref. Nos. 50, 51, 58 & 59.		
52	PLATE — Reed Valve Assembly (Includes Reed Valves and Stops)	90467-A	1
53	PLATE — Bearing	2312-A	1
	NOTE: Bearing Plate includes Ref. Nos. 2 and 81.		
54	PLATE ASSEMBLY — Air Cleaner Mounting	21055-A	1
55	PLATE — Name	2363	1
56	PULLEY — Starter	12397	1
57	RETAINER — Air Vane	4430	1
58	RETAINER — Wrist Pin	3030	1
59	RING — Piston, Standard	2408	2
	RING SET — Piston — Standard	2486	1
	NOTE: Ring Sets are also available in the following oversizes: .005, .010, .020. Order by Part Number and specify oversize.		
60	RIVET — Tubular (Brace to Housing)	5460	3
61	ROD ASSEMBLY — Connecting	2422-A	1
62	ROPE ASSEMBLY — Starting	4266	1
63	SCREEN — Rotating	90092	1
64	SCREW — H.H.C., 8-32 x 7/16 (Air Cleaner Mounting)	5812	2
65	SCREW — H.H.C., 1/4-20 x 3/4 (Bearing Plate to Block)	5446	2
66	SCREW — R.H.S.T., 16-32 x 13/16 (Condenser to Plate)	5741	1
67	SCREW — H.H.S.T., 8-32 x 3/8 (Name Plate to Block)	5644	2
68	SCREW — H.H.S.T., 10-24 x 3/4 (Connecting Rod Cap)	5429	2
69	SCREW — R.H.M., 8-32 x 7/8 (Speed Control Adjusting)	3240	1
70	SCREW — H.H.M., 8-32 x 1/4 (Throttle Lever)	5681	1
71	SCREW & L'WASHER ASS'Y — R.H.M., 10-24 x 1 (Fuel Tank Straps)	5421-A	2
72	SCREW & L'WASHER ASS'Y — R.H.S.T., 8-32 x 1/2 (Brace to Block)	5443-A	3
73	SCREW & L'WASHER ASS'Y — F.H.M., 1/4-20 x 3/4 (Muffler to Block)	5679-G	2
74	SCREW & L'WASHER ASS'Y — H.H.C., 1/4-20 x 1/2 (Blower Housing to Plate)	3205-G	4
75	SCREW & L'WASHER ASS'Y — H.H.C., 1/4-20 x 7/8 (Reed Plate to Block)	3294-G	4
76	SCREW & L'WASHER ASS'Y — R.H.S.T., 10-24 x 1 (Magneto Plate to Bearing Plate)	5682-A	2
77	SCREW & L'WASHER ASS'Y — R.H.S.T., 8-32 x 3/8 (Air Cleaner Cover to Mounting Plate)	5457-A	1
78	SCREW & L'WASHER ASS'Y — Breaker Points to Breaker Box	5737	1
79	SCREW & L'WASHER ASS'Y — R.H.S.T., 8-32 x 1/2 (Speed Control Lever)	5443-D	1
80	SCREW & L'WASHER ASS'Y — H.H.C., 1/4-20 x 3/4 (Bearing Plate to Block)	5446-F	4
81	SEAL — Oil (Bearing Plate)	7254	1
82	SEAL — Oil (Power Take-Off)	4429	1
83	SPARK PLUG & GASKET ASSEMBLY	K90617-A	1

CLINTON

S E R I E S
VS-200-4000
P A N T H E R

BASIC
TYPE

SEC. II, DIV. VS-200-4000
PARTS CATALOG
Issued December, 1959

BASIC PARTS LIST (Continued)

Ref. No.	PART DESCRIPTION	Part No.	Quan.
84	SPRING — Air Governor -----	2448	1
85	SPRING — Breaker Box Cover -----	P5745	1
86	SPRING — Compression (Air Vane) -----	10005	1
87	STRAP — Fuel Tank -----	90455	2
88	STUD — Carburetor Mounting -----	90422	2
89	TANK ASSEMBLY — Fuel (Includes Ref. No. 8) -----	7461-A	1
90	TERMINAL — Jamtite Breaker Points -----	P5738	1
91	VANE & LEVER ASSEMBLY — Air Governor -----	2323	1
92	WASHER — Starter Pulley -----	5941	1
93	WASHER — Spring Tension (Throttle Control) -----	2077	1
94	WASHER — Terminal Condenser Lead -----	5739	1
95	WASHER — Thrust (Crankshaft) -----	2026	1

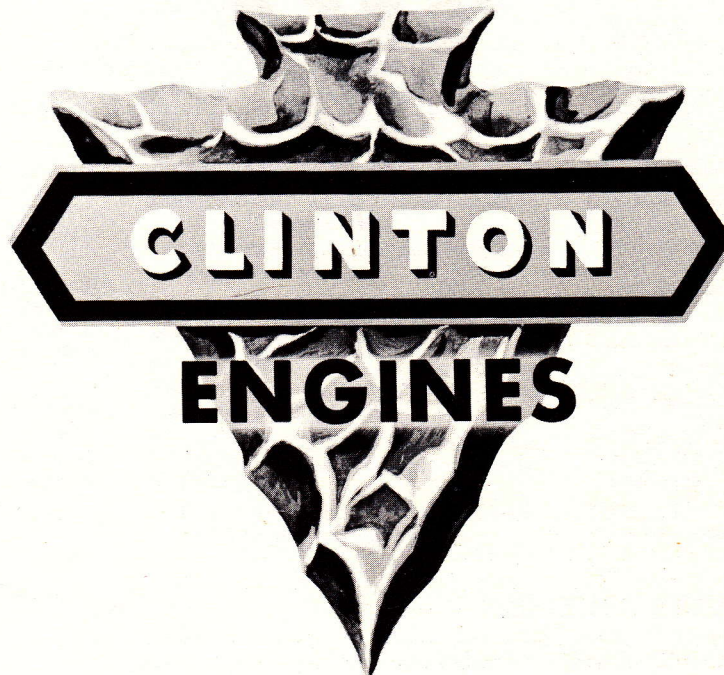

CLINTON

S	E	R	I	E	S	
VS-200-4000						
P	A	N	T	H	E	R

**MODEL
VARIATIONS**
**SEC. II, DIV. VS-200-4000
PARTS CATALOG**
 Revised June, 1960
 Supersedes Feb., 1960

MODEL VARIATIONS OF VS-200-4000 SERIES

The adaptation of Clinton Engines to a wide variety of uses results in what is known as "Model Variations." Following is the complete list of all Models produced up to issue date (shown above). Opposite each Engine Model listed are the Part Numbers and/or Assembly Numbers for the Series used IN ADDITION TO or IN PLACE OF the parts illustrated and shown on the Basic Parts List preceding this Model Variations List. Refer to other sections of this Manual when Assembly Numbers are given to find the Parts List for these assemblies.

See page (a) on "How to Identify Your Clinton Engine." Use the preceding Basic Parts List except as shown below.

ENGINE MODEL—See page (a), "How to Identify Your Clinton Engine."

FOOTNOTES (Check page two).

BASE—ENGINE (Part Numbers Shown). Refer to Sec. IV, Div. A for further information.

BLOCK ASSEMBLY — CYLINDER (Part Number Shown). Refer to Illustrated Basic Parts List for corresponding part.

CRANKSHAFT (Part Numbers Shown). Refer to Sec. IV, Div. B for details and further information.

BEARING—MAIN (Part Numbers Shown). Refer to Illustrated Basic Parts List for corresponding part.

CONTROL GROUP (Control Group Illustration Numbers Shown). Refer to Sec. III, Div. D for Parts List.

CONTROL CABLE LENGTH — Replacement cable is furnished in 72" length ONLY, cut to length shown.

PLATE ASSEMBLY — BEARING (Part Numbers Shown). Refer to Illustrated Basic Parts List for corresponding part.

MUFFLER OR MANFOLD (Part Numbers Shown). Refer to Illustrated Basic Parts List for corresponding part.

STARTER—RECOIL OR IMPULSE. Refer to Sec. III, Div. H for Parts List.

HOUSING ASSEMBLY — BLOWER (Part Numbers Shown). Refer to Basic Parts List for corresponding part.

REDUCTION GEAR (Assy. Nos. Shown). Refer to Sec. III, Div. C for Parts List.

MOUNTING POSITION — "Clock" position shows mounting of reduction unit in relation to Crankshaft.

VS-200-4100	Note 1		
VS-200-4101	Note 1		
VS-200-4102	NO VARIATION—USE BASIC PARTS LIST		
VS-200-4103			P90996 90587-A
VS-200-4104	Note 2		MC91538 91113-A
VS-200-4105		2260	
VS-200-4106			P90996 90587-A
VS-200-4107	Note 1		
VS-200-4108		2260	P90996 90587-A
VS-200-4109		2260	
VS-200-4110			P90996 90587-A
VS-200-4111	NO VARIATION—USE BASIC PARTS LIST		
VS-200-4112		2371-1	
VS-200-4113		2376-1	P90996 90587-A
VS-200-4114		2371-1	
VS-200-4115		2371-1	P90996 90587-A
VS-200-4116		2296	
VS-200-4117		2296	
VS-200-4118			P90996 90587-A
VS-200-4119	Note 1		
VS-200-4120		2296	P90996 90587-A
VS-200-4121		2296	P90996 90587-A
VS-200-4122	Note 1		P90996 90587-A
VS-200-4123	Note 3		P90996 90587-A
VS-200-4124			P90996 90587-A
VS-200-4125			P90996 90587-A
VS-200-4126	Note 1		P90996 90587-A
VS-200-4127	Note 1		P90996 90587-A
VS-200-4128		2375-1	
VS-200-4129			72"
VS-200-4130	Note 1		
VS-200-4131	Note 1		P90996 90587-A
VS-200-4132	Note 1		P90996 90587-A
VS-200-4133	Note 1		
VS-200-4134	Note 1		P90996 90587-A
VS-200-4135	Note 1		
VS-200-4136	Note 1		P90996 90587-A
VS-200-4137	Notes 3 & 4		
VS-200-4138	Notes 3 & 4		P90996 90587-A
VS-200-4139	Notes 3 & 4		

CLINTON

S E R I E S
VS-200-4000
 P A N T H E R

MODEL
 VARIATIONS

MODEL VARIATIONS OF VS-200-4000 SERIES (Cont.)

ENGINE MODEL	FOOTNOTES	BASE—ENGINE	BLOCK ASSEMBLY—CYLINDER	CRANKSHAFT	BEARING—MAIN	CONTROL GROUP	CONTROL CABLE LENGTH	PLATE ASSEMBLY—BEARING	MUFFLER OR MANIFOLD	STARTER—RECOIL	HOUSING ASSEMBLY—BLOWER	REDUCTION GEAR	MOUNTING POSITION
VS-200-4140	Notes 3 & 4									P90996	90587-A		
VS-200-4141	Note 1						72"			P90996	90587-A		
VS-200-4142	Note 1												
VS-200-4143	NO VARIATION—USE BASIC PARTS LIST												
VS-200-4144			2375-1							P90996	90587-A		
VS-200-4145	NO VARIATION—USE BASIC PARTS LIST												
VS-200-4146	Note 5								2220-A-R				
VS-200-4147			2375-1							P90996	90587-A		
VS-200-4148	Note 5						72"		2220-A-R	P90996	90587-A		

NOTE 1—Use 2431 Flange and 3217-G Screw & L'Washer Assembly (4).

NOTE 2—Use C13534 Impulse Starter, C91119 Cup, 90872 Screen, 4107-A Nuts (4). If original position is not required use the 90587-A Housing.

NOTE 3—Use 5752-A Flywheel Assembly.

NOTE 4—Use 90466-A Manifold Assembly that includes the following: 90466 Manifold, 90460 Gasket (Manifold Cover), 90461 Cover, 5872-A Screw & L'Washer Assembly (3), 5446 Screw (2).

NOTE 5—Use 91338 Bracket (Muffler), 5838-A Screw & L'Washer Assembly.