

S E R I E S
VS-100
 G E M

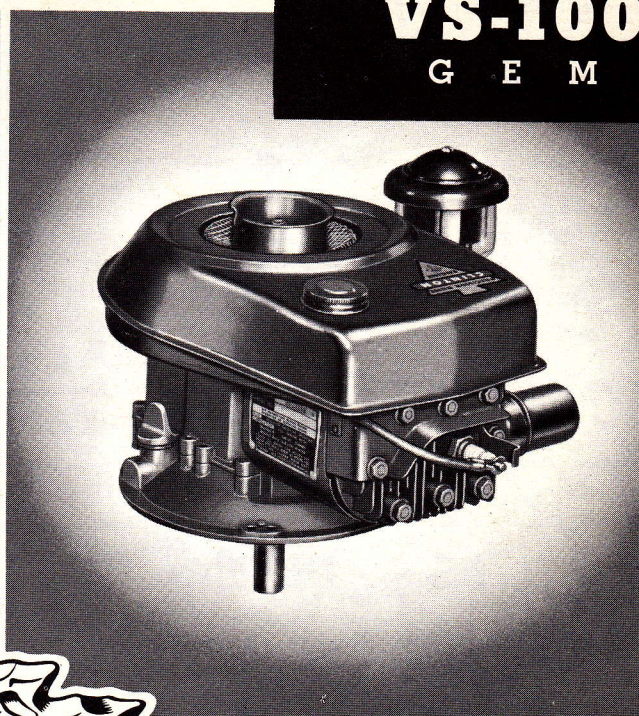

A Wide Range of Models are Made By

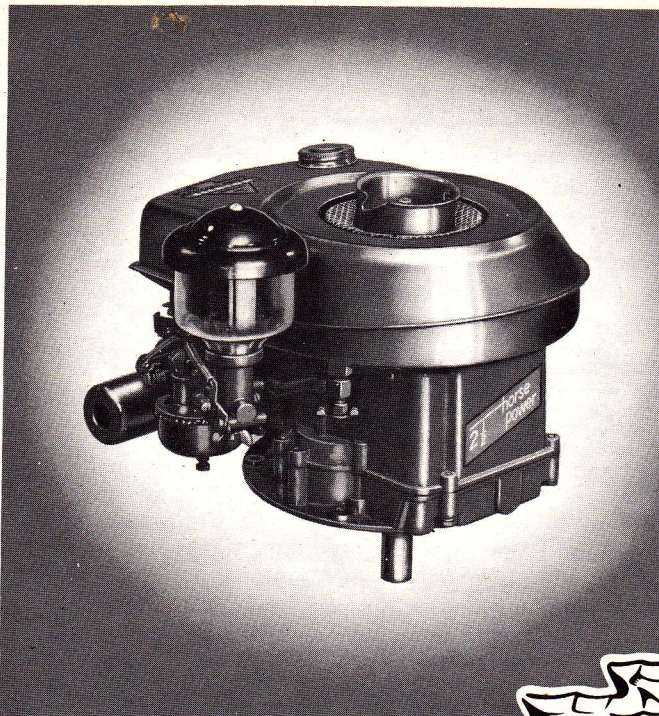
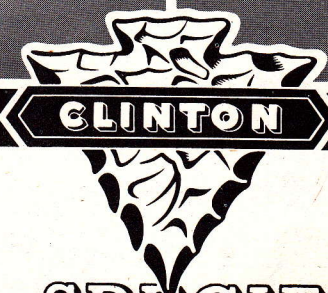

For Farm, Home and Industrial Use.

	H.P.	R.P.M.
VS-100	1.45	2200
	2.0	2800
	2.5	3600

GENERAL SPECIFICATIONS

Model	Type	Description	Starter	Weight
VS-100	Air Cooled	Vertical Shaft	Rope or Recoil	19 lbs.

BORE: 2 3/8"

STROKE: 1 5/8"

TYPE: Single cylinder, L-Head, air-cooled.

AIR-COOLED: Large capacity, curved vane blower cast integral with fly-wheel. Air passes through deep fins to maintain correct operating temperature.

PISTON DISPLACEMENT: 7.2 cubic in.

IGNITION: Very high voltage, built-in fly-wheel magneto for faster starting. Moisture and dust proof with fully enclosed ignition points.

SPARK PLUG: 14 m.m.

LUBRICATION: Automotive type oil pump.

CARBURETOR: Full float feed with idle and high speed adjustment.

GOVERNOR: Adjustable, air velocity type.

MAIN BEARINGS: Bronze and aluminum.

CRANKSHAFT: Arma steel, induction heat-treated. Counterweights and cam gear drive integral with shaft.

CONNECTING ROD: I-Beam, aluminum alloy with extra large bearings.

PISTON: Aluminum alloy, Clinton-engineered for efficient combustion.

PISTON RINGS: Two compression and one oil control. Treated surfaces.

VALVES: Forged steel. Exhaust valve provided with heat-resistant alloy head.

VALVE SEATS: Alloy inserts.

VALVE TAPPETS: Hardened and ground.

CYLINDER AND CRANKCASE: Die cast cylinder block and crankcase with large amount of cooling area for cool operation. A close-grained cast iron liner is die cast in block.

CYLINDER HEAD: Aluminum, removable with extra deep cooling fins.

OIL FILLER: Conveniently located for easy check of oil level and for filling.

AIR CLEANER: Visible oil bath type.

FUEL TANK: 1 1/2-quart capacity, with gasoline strainer and shut-off.

OIL RESERVOIR: One-pint capacity.

DIRECTION OF ROTATION: Counter-clockwise, viewed from power take-off shaft side.

FINISH: Heat-resistant dark green enamel. Other colors available upon request.

STANDARD EQUIPMENT

Standard equipment includes: Down-draft oil bath air cleaner, dust and moisture-proof, high voltage, flywheel magneto, float feed carburetor and fuel tank, muffler, blower housing screen, crankshaft machined to accommodate clutch and blade assembly, rope starter.

SPECIAL EQUIPMENT

Special equipment includes: Remote governor controls, throttle control cables and stop, ignition shielding, other crankshaft extensions, recoil starter.

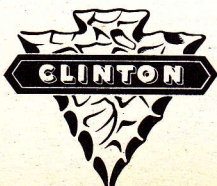

WORLD'S LARGEST MANUFACTURER OF A COMPLETE LINE OF AIR-COOLED GASOLINE ENGINES

CLINTON ENGINES PROVIDE POWER

FOR FARM • HOME • INDUSTRIAL EQUIPMENT

Printed in U.S.A.

CLINTON

S E R I E S
VS-100
G E M

BASIC
TYPES

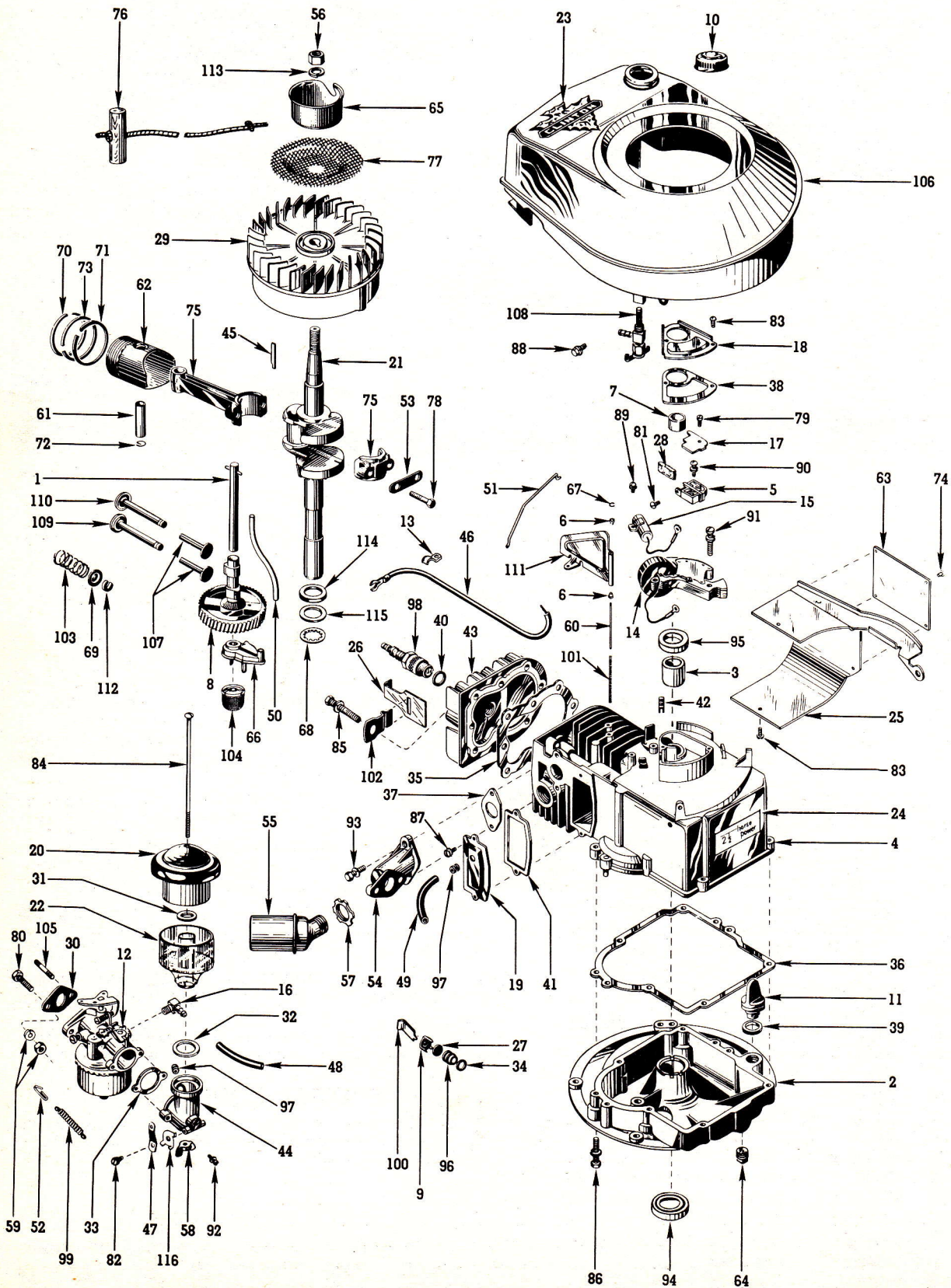

CLINTON

S	E	R	I	E	S
VS-100					
G	E	M			

**BASIC
TYPES**

SEC. II, DIV. VS-100
PARTS CATALOG
Revised February, 1957
Supersedes April, 1956

There are five Basic Types of the VS-100 Engines covered by this Basic Parts List. Parts not used on all Types are noted. These "Types" are shown as follows: Serial Number Suffix "A"—referred to as "Type A"; Serial Number Suffix "B"—referred to as "Type B"; Serial Number Suffix "C"—referred to as "Type C"; Serial Number Suffix "D"—referred to as "Type D"; Serial Number Suffix "E"—referred to as "Type E."

NOTE: See page (a) on "How to Identify Your Clinton Engine."

BASIC PARTS LIST — ALL TYPES

Ref. No.	PART DESCRIPTION	Part No.	Quantity
1	AXLE ASSEMBLY — Camshaft (includes pin)-----	10310-A	1
2	BASE ASSEMBLY — Engine-----	10000-A	1
	NOTE: Assembly includes Ref. No. 94.		
3	BEARING — Main (Sleeve)-----	10380	1
4	BLOCK ASSEMBLY — Cylinder-----	10200-A	1
	NOTE: Assembly includes Ref. Nos. 3, 95.		
5	BREAKER POINTS ASSEMBLY-----	P5543	1
	NOTE: Assembly includes Ref. Nos. 17, 28, 79, 81.		
	BREATHER ASSEMBLY-----	6330	1
	NOTE: Assembly includes Ref. Nos. 9, 27, 34, 96, 100.		
6	BUSHING — Air Vane-----	7239	2
7	CAM — Magneto Breaker-----	10316	1
8	CAMSHAFT ASSEMBLY-----	10008-A	1
9	CAP — Breather-----	7151	1
10	CAP & GASKET ASSEMBLY — Fuel-----	4517-A	1
11	CAP & GASKET ASSEMBLY — Oil Filler-----	5095-1	1
12	CARBURETOR ASSEMBLY — Clinton — used on Type A-----	14004	1
	CARBURETOR ASSEMBLY — used on Type B-----	C14097	1
	CARBURETOR ASSEMBLY — Clinton — used on Type C-----	14008	1
	CARBURETOR ASSEMBLY — used on Type D-----	C14090	1
	CARBURETOR ASSEMBLY — used on Type E-----	C14087	1
	(For Complete Identification of Carburetors, Refer to Sec. III, Div. A, Page 2)		
13	CLAMP — Magneto Hi-Tension Lead-----	10344	1
	CLEANER ASSEMBLY — Air-----	4512-A	1
	NOTE: Assembly includes Ref. Nos. 20, 22, 31.		
	NOTE: See Sec. III, Div. F, for Component Parts.		
14	COIL ASSEMBLY — Magneto (With Laminations)-----	P5545	1
	COIL — Magneto (Without Laminations)-----	P5538	1
15	CONDENSER — Magneto-----	P7219-1	1
16	CONNECTOR — 90°, Flexible Fuel Line (Carburetor)-----	5052	1
17	COVER — Breaker Points Assembly-----	P5544	1
18	COVER — Dust, Magneto Breaker Points-----	10382	1
19	COVER — Valve Chamber-----	10323	1
20	COVER AND ELEMENT — Air Cleaner-----	4512	1
21	CRANKSHAFT-----	10100	1
22	CUP — Air Cleaner, Lower-----	4513	1
23	DECAL — Arrowhead-----	3579	1
24	DECAL — Horsepower-----	10010	1
25	DEFLECTOR ASSEMBLY — Air, Cylinder-----	10006-A	1
26	DEVICE — Ignition Shorting (Spark Plug)-----	10368	1
27	DISC — Breather-----	7152	1
28	FELT — Lubrication, Cam Follower-----	P5504	1
29	FLYWHEEL ASSEMBLY-----	2070-1A	1
30	GASKET — Paper (Carburetor to Manifold)-----	7168	1
31	GASKET — Air Cleaner (Element to Cup)-----	4515	1
32	GASKET — Air Horn to Air Cleaner-----	10259	1
33	GASKET — Air Horn to Carburetor-----	3990	1
34	GASKET — Breather-----	7153	1
35	GASKET — Cylinder Head-----	10253	1
36	GASKET — Engine Base-----	10254	1

CLINTON



BASIC
TYPES

BASIC PARTS LIST — ALL TYPES (Continued)

Ref. No.	PART DESCRIPTION	Part No.	Quantity
37	GASKET — Asbestos (Manifold to Block).....	7149	1
38	GASKET — Cover, Dust (Breaker Points).....	10250	1
39	GASKET — Oil Filler Cap	3297	1
40	GASKET — Spark Plug	3115	1
41	GASKET — Valve Chamber Cover	10251	1
	GASKET KIT — Engine Overhaul.....	6329	1
42	GROMMETT — Magneto (Breaker Lead Wire).....	10367	1
43	HEAD — Cylinder.....	10011	1
44	HORN — Air.....	10350	1
45	KEY — Flywheel.....	10339	1
46	LEAD — Hi-Tension, Magneto.....	P2055	1
47	LEVER — Speed Adjusting.....	4441	1
48	LINE — Flexible, Fuel	6316	1
49	LINE — Flexible, Breather Tube.....	10352	1
50	LINE — Oil Distributor (Oil Pump).....	10390	1
51	LINK — Carburetor to Air Vane.....	10020	1
52	LINK — Governor Spring	7259	1
53	LOCK — Double, Connecting Rod Screw.....	10318	1
54	MANIFOLD — Carburetor.....	6411	1
55	MUFFLER	3639	1
56	NUT — Hex., 7/16-20 (Starter Pulley).....	3250	1
57	NUT — Lock, Muffler	4425	1
58	NUT — Wing (Air Cleaner).....	7044	1
59	NUT & LOCKWASHER ASSEMBLY — ¼-28 Hex. (Carb. Mtg.).....	3255-A	2
60	PIN — Pivot, Air Vane Governor.....	7238	1
61	PIN — Wrist	6024	1
62	PISTON — Standard.....	10001	1
	PISTON ASSEMBLY — Standard.....	10001-A	1
	NOTE: Assembly includes Ref. Nos. 61, 62, 70, 71, 72, 73.		
	NOTE: Piston Assemblies are available in the following oversizes: .005, .010, .020, .030 and .040. Order by Part Number and specify oversize.		
63	PLATE — Name (Air Deflector).....	6530	1
64	PLUG — ¾ N.P.T. (Oil Drain).....	5627	1
65	PULLEY — Starter.....	3299	1
66	PUMP ASSEMBLY — Oil.....	10385-A	1
67	RETAINER — Air Vane	4430	1
68	RETAINER — Self-Locking, Power Take-Off (Dust Seal).....	7452	1
69	RETAINER — Valve Spring	3028	2
70	RING — Compression, Standard	6026	1
71	RING — Oil, Standard	6006	1
72	RING — Retainer, Wrist Pin	6034	2
73	RING — Scraper, Standard	6027	1
	RING SET — Standard.....	10023	1
	NOTE: Ring Sets are also available in the following oversizes: .005, .010, .020, .030 and .040. Order by Part Number and specify oversize.		
74	RIVET — Tubular (4—Name Plate) (2—Flywheel Shield) (1—Clamp, Hi-Tension Lead)	5460	7
75	ROD ASSEMBLY — Connecting.....	10002-A	1
	NOTE: Assembly includes Ref. Nos. 53, 78.		
76	ROPE ASSEMBLY — Starter.....	4266	1
77	SCREEN — Revolving.....	7187	1
78	SCREW — H.H.C., ¼-28 x 1½ (Connecting Rod Cap).....	5635	2
79	SCREW — P.H.S.T., #6-32 x ¾ (Cover, Breaker Points).....	5617	1
80	SCREW — H.H.C., ¼-28 x 7/8 (Carburetor to Manifold).....	5650	1
81	SCREW — F.H.M., 6-32 x ¼ (Breaker Points Terminal).....	5423	1
82	SCREW — Shoulder, 10-32 x 5/16 (Speed Adj. Lever).....	4440	1

CLINTON

S	E	R	I	E	S
VS-100					
G	E	M			

**BASIC
TYPES**

SEC. II, DIV. VS-100
PARTS CATALOG
Revised February, 1957
Supersedes April, 1956

BASIC PARTS LIST — ALL TYPES (Continued)

Ref. No.	PART DESCRIPTION	Part No.	Quantity
83	SCREW — H.H.C., #8-32 x 5/16 (2—Deflector to Block) (2—Breaker Points Cover) -----	5644	4
84	SCREW — R.H.M., #10-24 x 6¼ (Air Cleaner) -----	5636	1
85	SCREW & L'WASHER ASS'Y — H.H.C., 5/16-18 x 1½ (4—Tank Bracket, 4—Cylinder Head) -----	5654	8
86	SCREW & L'WASHER ASS'Y — H.H.C., ¼-20 x 1¼ (Base to Block) -----	5613-G	7
87	SCREW & L'WASHER ASS'Y — H.H.C., #10-24 x ½ (Valve Chamber Cover) -----	5645-A	2
88	SCREW & L'WASHER ASS'Y — H.H.C., ¼-20 x ⅝ (Tank to Block) -----	3632-G	2
89	SCREW & L'WASHER ASS'Y — H.H.C., 8-32 x 5/16 (Condenser to Block) -----	5644-A	1
90	SCREW & L'WASHER ASS'Y — R.H.M., 8-32 x ⅜ (Breaker Points to Block) -----	5444-F	1
91	SCREW & L'WASHER ASS'Y — P.H.S.T., #10-24 x 1 (Laminations to Block) -----	5430-A	2
92	SCREW & L'WASHER ASS'Y — R.H.M., #8-32 x ¾ (Air Horn to Carburetor) -----	7113-A	2
93	SCREW & L'WASHER ASS'Y — H.H.C., ¼-20 x ⅞ (Manifold to Block) -----	3294-G	2
94	SEAL — Oil (Engine Base) -----	4429	1
95	SEAL — Oil (Block) -----	10012	1
96	SEAT — Breather -----	4438	1
97	SLEEVE — Connector, Breather Line -----	10353	2
98	SPARK PLUG AND GASKET ASSEMBLY -----	16303-A	1
99	SPRING — Air Governor -----	10336	1
100	SPRING — Breather Hold-Down -----	10381	1
101	SPRING — Compression (Air Vane) -----	10005	1
102	SPRING — Ignition Shorting Clip -----	10369	1
103	SPRING — Valve -----	3068	2
104	STRAINER — Oil Pump -----	10389	1
105	STUD — Carburetor to Manifold -----	6155	1
106	TANK ASSEMBLY — Fuel -----	10370-D	1
	NOTE: Assembly includes Ref. No. 10.		
107	TAPPET — Valve -----	10009	2
108	VALVE — Fuel Shut-Off, Flexible Line -----	5051	1
109	VALVE — Exhaust -----	10301	1
110	VALVE — Intake -----	10302	1
111	VANE — Air Governor -----	10393	1
112	WASHER — "C," Valve Keeper -----	3291	2
113	WASHER — Lock, 7/16 (Starter Pulley) -----	3275	1
114	WASHER — Felt (Power Take-Off, Dust Seal) -----	7443	1
115	WASHER — Flat, Steel (Power Take-Off, Dust Seal) -----	7444	1
116	WASHER — Spring Tension (Throttle Lever) -----	10305	1



DIMENSIONAL SPECIFICATIONS AND POWER DATA

Detailed prints and engineering counsel are available. Specifications and Dimensions are subject to change without notice.

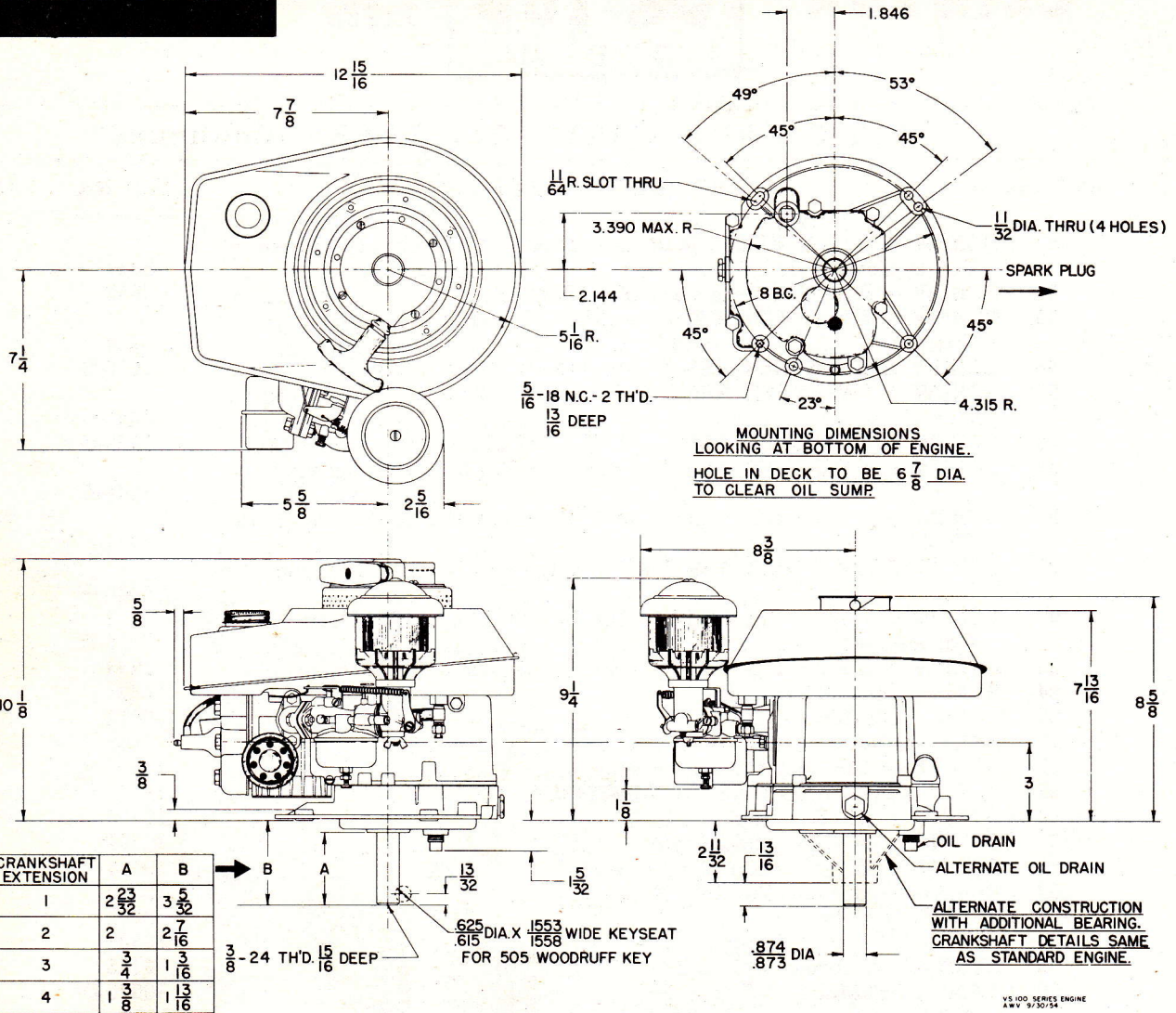

POWER DATA

The performance and power analysis figures for the Clinton Engine series show the rated Brake Horse Power developed from test-run engines. The standard engine equipped with standard air cleaner and muffler was used, in every case, for these tests and the figures have been corrected for barometer at sea level and temperature of 60° F. Production engines when shipped will develop not less than 85% of rated B.H.P.

Production engines, after run-in to reduce friction will develop not less than 95% of the rated B.H.P.

Engine power will decrease 3% for each 1,000 feet above sea level, and 1% for each 10° F. above standard temperature of 60° F.

Unless otherwise specified, governors are set to operate at 3,000 R.P.M. without load. Complete details of installations requiring continuous operation at other than recommended speeds should be referred to the factory for approval.

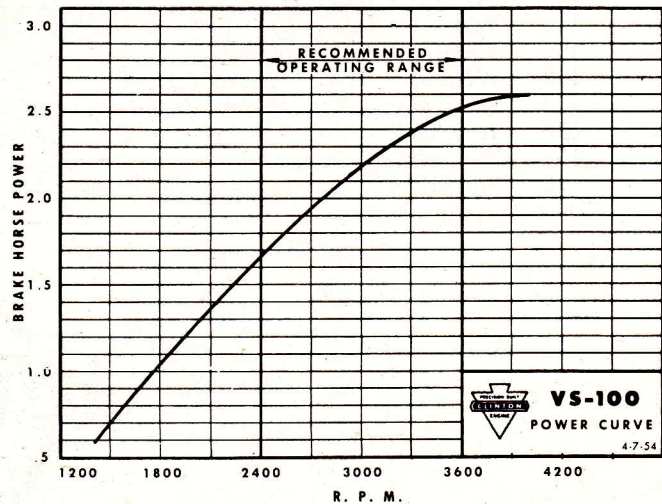

CABLE ADDRESS: ENGINES U. S. A.



ENGINE DIVISION OF **CLINTON MACHINE CO.**

MAQUOKETA, IOWA

CLINTON

S E R I E S VS-100 G E M

MODEL VARIATIONS

SEC. II, DIV. VS-100
PARTS CATALOG
Revised May, 1956
Supersedes Dec., 1955

MODEL VARIATIONS OF VS-100 SERIES

The adaptation of Clinton Engines to a wide variety of uses results in what is known as "Model Variations." Following is the complete list of all Models produced up to issue date (shown above). Opposite each Engine Model listed are the Part Numbers and/or Assembly Numbers for the Series used IN ADDITION TO or IN PLACE OF the parts illustrated and shown on the Basic Parts List preceding this Model Variations List. Refer to other sections of this Manual when Assembly Numbers are given to find the Parts List for these assemblies.

See page (a) on "How to Identify Your Clinton Engine." Use the preceding Basic Parts List except as shown below.

ENGINE MODEL—See Page (a), "How to Identify Your Clinton Engine."	FOOTNOTES (Check on page four).	BASE—ENGINE (Part Numbers Shown). Refer to Sec. IV, Div. A for further information.	CONTROL GROUP (Control Group Illustration numbers shown). Refer to Sec. III, Div. D for Parts List.	CONTROL CABLE LENGTH, replacement cable is furnished in 72" length ONLY, cut to length shown.	CRANKSHAFT (Part Numbers Shown). Refer to Sec. IV, Div. B for details and further information.	STARTER—RECOIL (Assembly Numbers Shown). Refer to Sec. III, Div. H for Parts Lists.	HOUSING ASSEMBLY—BLOWER (Part Numbers Shown). Refer to Basic Parts List for corresponding part.
VS-100-100						10101	
VS-100-101						10102	
VS-100-102						10103	
VS-100-103	Note 1					10101	C-6323 10313-B
VS-100-104	No Variation, use Basic Parts List						
VS-100-105						10101	C-6323 10313-B
VS-100-106						10102	C-6323 10313-B
VS-100-107						10103	C-6323 10313-B
VS-100-108							C-6323 10313-B
VS-100-109	Notes 2 & 7	10051-B				C-6322	10313-B
VS-100-110		10050-B					
VS-100-111						C-6323	10313-B
VS-100-112		10050-B					
VS-100-113			SK550	72"			
VS-100-114			SK550	72"	10102	C-6323	10313-B
VS-100-115			SK550		10103		
VS-100-116			SK550				
VS-100-117			SK550	72"			
VS-100-118			SK550	72"		C-6323	10313-B
VS-100-119	Note 3						
VS-100-120	Note 3						
VS-100-121	Notes 2 & 8				10101		10313-B
VS-100-122			SK550		10101		
VS-100-123			SK550	72"	10101	C-6323	10313-B
VS-100-124					10101	C-6322	10313-B
VS-100-125	Note 4	10052-B	SK553		10104	C-6322	10313-B
VS-100-126			SK550	72"		C-6323	10313-B
VS-100-127	Notes 4 & 5	10053-B			10107	C-6322	10313-B
VS-100-128	Note 5					C-6323	10313-B
VS-100-129					10103	C-6323	10313-B
VS-100-130	Note 6	10050-B	SK554	46 1/4"	10106	C-6323	10313-B
VS-100-131		10050-B			10105	C-6323	10313-B
VS-100-132		10050-B	SK550				
VS-100-133		10050-B	SK550	72"		C-6323	10313-B
VS-100-134	Note 5					C-6323	10313-B

CLINTON

S E R I E S
VS-100
G E M

MODEL
VARIATIONS

MODEL VARIATIONS OF VS-100 SERIES (Cont.)

ENGINE MODEL	FOOTNOTES	BASE—ENGINE	CONTROL GROUP	CONTROL CABLE LENGTH	CRANKSHAFT	STARTER—RECOIL	HOUSING ASSEMBLY— BLOWER
VS-100-136	Note 1				10101	C-6323	10313-B
VS-100-137	Note 5	10050-B					
VS-100-138		10050-B	SK550	72"		C-6323	10313-B
VS-100-139			SK550	72"	10103	C-6323	10313-B
VS-100-140		10050-B	SK550	72"			
VS-100-141	No Variation, use Basic Parts List						
VS-100-142			SK550			C-6323	10313-B
VS-100-143						C-6323	10313-B
VS-100-144	Note 9	10050-B	SK550	72"		C-6323	10313-B
VS-100-145			SK553				
VS-100-146	Note 9		SK550	54"	10101	C-6323	10313-B
VS-100-147	Note 1	10051-B	SK553				
VS-100-148	Note 5		SK550			C-6323	10313-B
VS-100-149						C-6322	10313-B
VS-100-150		10050-B	SK553	46¼"	10106	C-6323	10313-B
VS-100-152		10050-B				C-6322	10313-B
VS-100-153					10103		
VS-100-154					10103	C-6323	10313-B
VS-100-155						C-6322	10313-B
VS-100-156	Note 1	10050-B	SK550	72"			
VS-100-157	Note 1						
VS-100-158					10101		
VS-100-159	Note 9					C-6323	10313-B
VS-100-160		10050-B				C-6323	10313-B
VS-100-161			SK550		10103		
VS-100-162	Note 5						
VS-100-163	Note 1						
VS-100-164						C-6323	10313-B
VS-100-165			SK553				
VS-100-166	Note 5					C-6323	10313-B
VS-100-167	Note 5				10108		
VS-100-168					10109		
VS-100-169					10109	C-6323	10313-B
VS-100-170			SK550			C-6323	10313-B
VS-100-171			SK550	40"			
VS-100-172			SK550	54"	10101	C-6323	10313-B
VS-100-173	Note 5						
VS-100-174	Note 1	10050-B	SK550	72"			
VS-100-175	Note 1	10050-B	SK550	72"		C-6323	10313-B
VS-100-176			SK553		10110	C-6323	10313-B
VS-100-177	Note 5		SK550	72"			
VS-100-178						C-6322	10313-B
VS-100-179			SK550				
VS-100-180	Note 5						

CLINTON

S	E	R	I	E	S
VS-100					
G	E	M			

**MODEL
VARIATIONS**
**SEC. II, DIV. VS-100
PARTS CATALOG**
 Revised May, 1956
 Supersedes Dec., 1955
MODEL VARIATIONS OF VS-100 SERIES (Cont.)

	ENGINE MODEL—See Page (a), "How to Identify Your Clinton Engine."	FOOTNOTES (Check on page five).	BASE—ENGINE (Part Numbers Shown). Refer to Sec. IV, Div. A for further information.	CONTROL GROUP (Control Group Illustration numbers shown). Refer to Sec. III, Div. D for Parts List.	CONTROL CABLE LENGTH, replacement cable is furnished in 72" length ONLY, cut to length shown.	CRANKSHAFT (Part Numbers Shown). Refer to Sec. IV, Div. B for details and further information.	STARTER—RECOIL (Assembly Numbers Shown). Refer to Sec. III, Div. H for Parts Lists.	HOUSING ASSEMBLY—BLOWER (Part Numbers Shown). Refer to Basic Parts List for corresponding part.
VS-100-181	Note 5			SK550	72"		C-6323	10313-B
VS-100-182	Note 5		10050-B					
VS-100-183	Note 5		10050-B				C-6322	10313-B
VS-100-184				SK550	72"	10102		
VS-100-185						10102	C-6323	10313-B
VS-100-186				SK552		10104	C-6323	10313-B
VS-100-187				SK550	40"	10101	C-6323	10313-B
VS-100-188	Note 5							
VS-100-189				SK550		10101		
VS-100-190	No Variation, use Basic Parts List							
VS-100-191	Note 5		10050-B				C-6323	10313-B
VS-100-192	Notes 4 & 5		10052-B	SK550	72"		C-6323	10313-B
VS-100-193	Note 5					10101		
VS-100-194	Note 1						C-6323	10313-B
VS-100-195						10101		
VS-100-196	Notes 4 & 5		10054-B				C-6323	10313-B
VS-100-197				SK550	72"	10103	C-6323	10313-B
VS-100-198				SK553		10113		
VS-100-199				SK550		10101		
VS-100-200	Note 1					10101	C-6323	10313-B
VS-100-201							C-6323	10313-B
VS-100-202				SK553	72"	10114	C-6323	10313-B
VS-100-203	Note 9						C-6341	10313-B
VS-100-204			10050-B				C-6323	10313-B
VS-100-205	Note 5		10050-B	SK553				
VS-100-206				SK550			C-6323	10313-B
VS-100-207	Note 5			SK553				
VS-100-208	Note 1					10101	C-6341	10313-B
VS-100-209				SK550	40"	10101	C-6341	10313-B
VS-100-210				SK550		10101	C-6323	10313-B
VS-100-211				SK550			C-6323	10313-B
VS-100-212			10050-B	SK550			C-6323	10313-B
VS-100-213							C-6323	10313-B
VS-100-214	Notes 4 & 5		10052-B	SK550			C-6341	10313-B
VS-100-215	Note 5			SK553		10110	C-6323	10313-B
VS-100-216	Note 1					10101	C-6341	10313-B
VS-100-217	Note 1					10101	C-6341	10313-B
VS-100-218								
VS-100-219	Note 5		10050-B	SK550			C-6323	10313-B
VS-100-220	Note 5		10050-B	SK550		10116	C-6323	10313-B

CLINTON

S E R I E S
VS-100
G E M

MODEL
VARIATIONS

MODEL VARIATIONS OF VS-100 SERIES (Cont.)

ENGINE MODEL	FOOTNOTES	BASE—ENGINE	CONTROL GROUP	CONTROL CABLE LENGTH	CRANKSHAFT	STARTER—RECOIL	HOUSING ASSEMBLY — BLOWER
VS-100-221		10051-B	SK550	46¼"	10106	C-6323	10313-B
VS-100-222			SK550				
VS-100-223			SK550			C-6341	10313-B
VS-100-224			SK554		10103	C-6323	10313-B
VS-100-225	No Variation, use Basic Parts List						
VS-100-226						C-6341	10313-B
VS-100-227			SK550	72"	10101		
VS-100-228	Note 1		SK550	72"			
VS-100-229	No Variation, use Basic Parts List						
VS-100-230	Note 4		SK550	72"		C-6323	10313-B
VS-100-231	Note 10	10052-B	SK550	72"	10101	C-6341	10313-B
VS-100-232	No Variation, use Basic Parts List						
VS-100-233		10054-B				C-6341	10313-B
VS-100-234	Note 5	10054-B			10106	C-6323	10313-B
VS-100-235					10118	C-6341	10313-B
VS-100-236					10103	C-6323	10313-B
VS-100-237						C-6341	10313-B
VS-100-238	Note 5	10054-B					
VS-100-239			SK553			C-6341	10313-B
VS-100-240	Note 1				10101	C-6323	10313-B
VS-100-241			SK550			C-6323	10313-B
VS-100-242	Note 5				10108	C-6341	10313-B
VS-100-243	Note 4	10053-B	SK550				
VS-100-244	Note 10		SK550		10103	C-6341	10313-B
VS-100-245			SK550	54"	10103	C-6323	10313-B
VS-100-246					10118		
VS-100-247	No Variation, use Basic Parts List						
VS-100-248		10054-B			10119	C-6341	10313-B
VS-100-249			SK554			C-6341	10313-B
VS-100-250						C-6341	10313-B
VS-100-251						C-6341	10313-B
VS-100-252						C-6341	10313-B
VS-100-253			SK550	72"		C-6341	10313-B
VS-100-254	Note 5	10054-B			10106	C-6341	10313-B
VS-100-255	Notes 10 & 11		SK554			C-6341	10313-B
VS-100-256					10105	C-6341	10313-B
VS-100-257		10054-B				C-6341	10313-B
VS-100-258		10054-B	SK550			C-6341	10313-B
VS-100-259		10054-B	SK550	72"		C-6341	10313-B
VS-100-260	Note 4	10053-A	SK550			C-6341	10313-B
VS-100-261	No Variation, use Basic Parts List						
VS-100-262						C-6341	10313-B
VS-100-263	Note 4	10053-B	SK554			C-6341	10313-B

CLINTON

S	E	R	I	E	S
VS-100					
G E M					

MODEL VARIATIONS

SEC. II, DIV. VS-100
PARTS CATALOG
Revised May, 1956
Supersedes Dec., 1955

MODEL VARIATIONS OF VS-100 SERIES (Cont.)

ENGINE MODEL—See Page (a), "How to Identify Your Clinton Engine."	FOOTNOTES (Check on page five).	BASE—ENGINE (Part Numbers Shown). Refer to Sec. IV, Div. A for further information.	CONTROL GROUP (Control Group Illustration numbers shown). Refer to Sec. III, Div. D for Parts List.	CONTROL CABLE LENGTH—Replacement cable is furnished in 72" length ONLY, cut to length shown.	CRANKSHAFT (Part Numbers Shown). Refer to Sec. IV, Div. B for details and further information.	STARTER—RECOIL (Assembly Numbers Shown). Refer to Sec. III, Div. H for Parts Lists.	HOUSING ASSEMBLY—BLOWER (Part Numbers Shown). Refer to Basic Parts List for corresponding part.
VS-100-264	Notes 4 & 5	10053-B					
VS-100-265			SK552		10103	C-6341	10313-B
VS-100-266			SK550	54"	10103	C-6341	10313-B
VS-100-267					10103	C-6341	10313-B
VS-100-268					10103	C-6341	10313-B
VS-100-269	Note 5					C-6341	10313-B
VS-100-270	Note 5		SK550	72"		C-6341	10313-B
VS-100-271		10050-B	SK553	46 $\frac{1}{4}$ "	10106	C-6322	10313-B
VS-100-272					10103	C-6322	10313-B
VS-100-273	Notes 4 & 5	10056-A	SK553		10122	C-6322	10313-B
VS-100-274	Note 4	10056-A	SK553		10121	C-6322	10313-B
VS-100-275	No Variation, use Basic Parts List						
VS-100-276					10102	C-6322	10313-B
VS-100-277					10119	C-6322	10313-B
VS-100-278					10119	C-6322	10313-B
VS-100-279					10109	C-6322	10313-B
VS-100-280			SK553			C-6322	10313-B
VS-100-281	Notes 4 & 5	10056-A	SK553		10122	C-6322	10313-B
VS-100-282					10101	C-6322	10313-B
VS-100-283			SK550			C-6322	10313-B
VS-100-284			SK550		10101	C-6322	10313-B
VS-100-285			SK550		10103	C-6322	10313-B
VS-100-286	Note 5	10050-B	SK550	72"		C-6322	10313-B
VS-100-287	Note 5	10050-B	SK550			C-6322	10313-B
VS-100-288	Note 5		SK553		10110	C-6322	10313-B
VS-100-289	Note 1		SK550	72"		C-6322	10313-B
VS-100-290	Note 5	10050-B	SK550	72"			
VS-100-291	Note 5	10050-B	SK550	72"		C-6322	10313-B
VS-100-292	No Variation, use Basic Parts List						
VS-100-293	Note 4	10052-A				C-6322	10313-B
VS-100-294	Note 9					C-6322	10313-B
VS-100-295			SK553			C-6322	10313-B
VS-100-296	Note 4	10052-A	SK553				
VS-100-297						C-6322	10313-B
VS-100-298						C-6322	10313-B
VS-100-299						C-6322	10313-B
VS-100-300	Note 10		SK550			C-6322	10313-B
VS-100-305						C-6322	10313-B
VS-100-306		10050-B	SK550	72"		C-6322	10313-B

CLINTON

S E R I E S
VS-100
 G E M

VARIATIONS
 MODEL

MODEL VARIATIONS OF VS-100 SERIES (Cont.)

ENGINE MODEL	FOOTNOTES	BASE—ENGINE	CONTROL GROUP	CONTROL CABLE LENGTH	CRANKSHAFT	STARTER—RECOIL	HOUSING ASSEMBLY— BLOWER
VS-100-307						C-6322	10313-B
VS-100-308	Note 10				10102		
VS-100-309						C-6322	10313-B
VS-100-312			SK550			C-6322	10313-B
VS-100-313	Note 9					C-6322	10313-B
VS-100-315						C-6322	10313-B

NOTE 1—Elbow, Street (90°) #7274 must be used.

NOTE 2—Lockwasher #5488 to be installed between air cleaner and air horn. Nut, Wing #7044 to be installed on top of air cleaner cover.

NOTE 3—Deflector assembly #10006-D used.

NOTE 4—Plugs #5649 and #5655 used.

NOTE 5—Muffler #4500 used in lieu of #3639.

NOTE 6—Gasket, Manifold #6002 used in lieu of #7149.

NOTE 7—Manifold, Intake #10311 and Lever, Speed Control #7465 used.

NOTE 8—Pulley, Starter #4882 used on this model.

NOTE 9—Wire Assembly—Ignition Shorting #5567-A, Grommet #5566, Terminal #2228 and Screw #5644 used as additional parts.

NOTE 10—Muffler #6342 used in lieu of #3639.

NOTE 11—Air Cleaner Assembly #6331 used in lieu of #4512-A.

NOTE 12—Use #4558 Protector.

NOTE 13—Use #5711-A Flywheel.

NOTE 14—Use #4512-A Air Cleaner Assembly.