

S E R I E S
VS-400
2 - C Y C L E

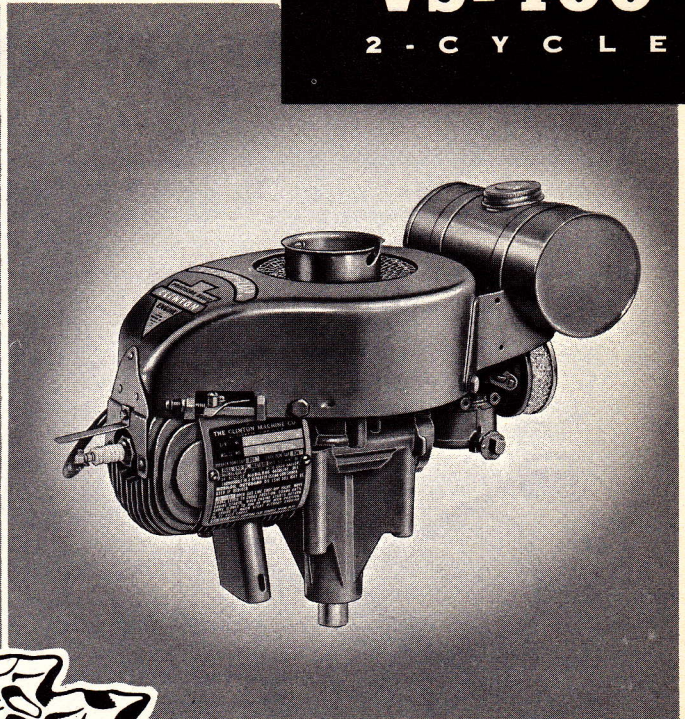
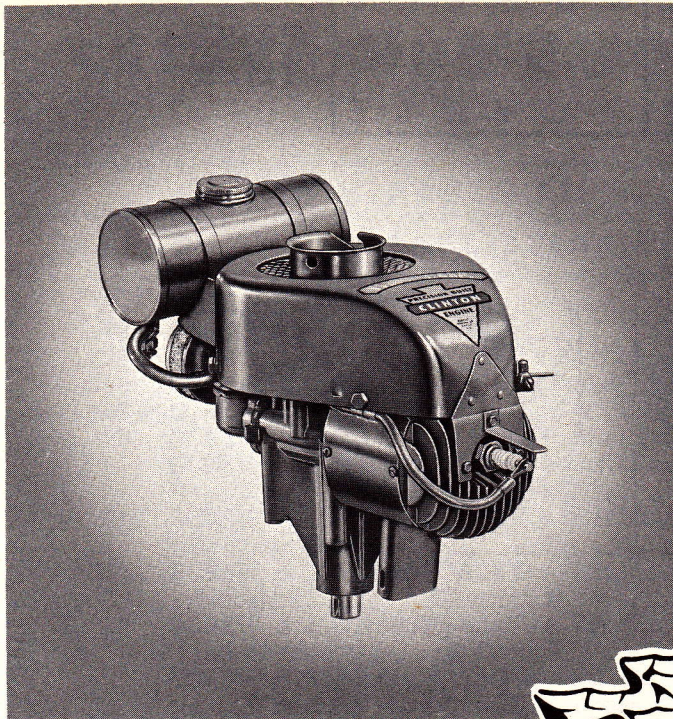

A Wide Range of Models are Made By

CLINTON

For Farm, Home and Industrial Use.

VS-400

	H.P.	R.P.M.
	1.3.....	2000
	1.9.....	2800
	2.5.....	3600

GENERAL SPECIFICATIONS

Model	Type	Description	Starter	Weight
VS-400	2-Cycle Air Cooled	Vertical Shaft	Rope or Recoil	15 $\frac{3}{4}$

TYPE: 2-cycle, single cylinder, vertical shaft, air cooled.

AIR COOLED: Powerful flywheel blower forces strong air blast through deep cooling fins on cylinder and cylinder head to maintain correct operating temperature.

BORE: 2 $\frac{1}{8}$ "

STROKE: 1 $\frac{5}{8}$ "

PISTON DISPLACEMENT: 5.76 cubic inches.

IGNITION: Patented high tension, built-in flywheel magneto, moisture and dust proof, covered points.

SPARK PLUG: 14 mm.

LUBRICATION: Lubricating oil carried in fuel to all moving parts.

CARBURETION: Float-feed carburetor with dial speed adjustment and gasoline strainer with shut-off.

GOVERNOR: Adjustable, air-velocity type completely enclosed and statically balanced.

MAIN BEARINGS: Two large surface bearings on power-take-off side designed to withstand extra stress. One needle bearing on flywheel side.

CRANKSHAFT: Arma steel, induction heat treated, has counter-weights integral with shaft. Bearing surface superfinished. Extra large diameter crankshaft extension.

CONNECTING ROD: I-beam aluminum alloy, with bronze insert crank pin and wrist pin.

PISTON: Aluminum alloy Clinton-engineered for efficient combustion.

PISTON RINGS: Two compression rings, pinned to prevent rotation.

CYLINDER AND CRANKCASE: One-piece die cast cylinder block and crankcase with large amount of cooling area for cool operation. A close-grained cast iron liner is die cast in block.

CYLINDER HEAD: Integral with cylinder casting.

AIR CLEANER: Metallic mesh type.

FUEL TANK: One quart capacity.

DIRECTION OF ROTATION: (viewed from power-take-off side) Counter-clockwise.

FINISH: Dark green or red heat-resisting enamel. Other colors upon special order.

STANDARD EQUIPMENT

Standard equipment includes: Air cleaner, specially designed dust and moisture-proof high-tension flywheel magneto, fuel tank, muffler, blower housing screen.

SPECIAL EQUIPMENT

Special equipment available includes: Recoil starter, remote governor controls, remote stop control and any color finish.



MANUFACTURED IN A WIDE RANGE OF 2-CYCLE AND 4-CYCLE MODELS

CLINTON ENGINES PROVIDE POWER

FOR FARM • HOME • INDUSTRIAL EQUIPMENT

PRINTED IN U.S.A.

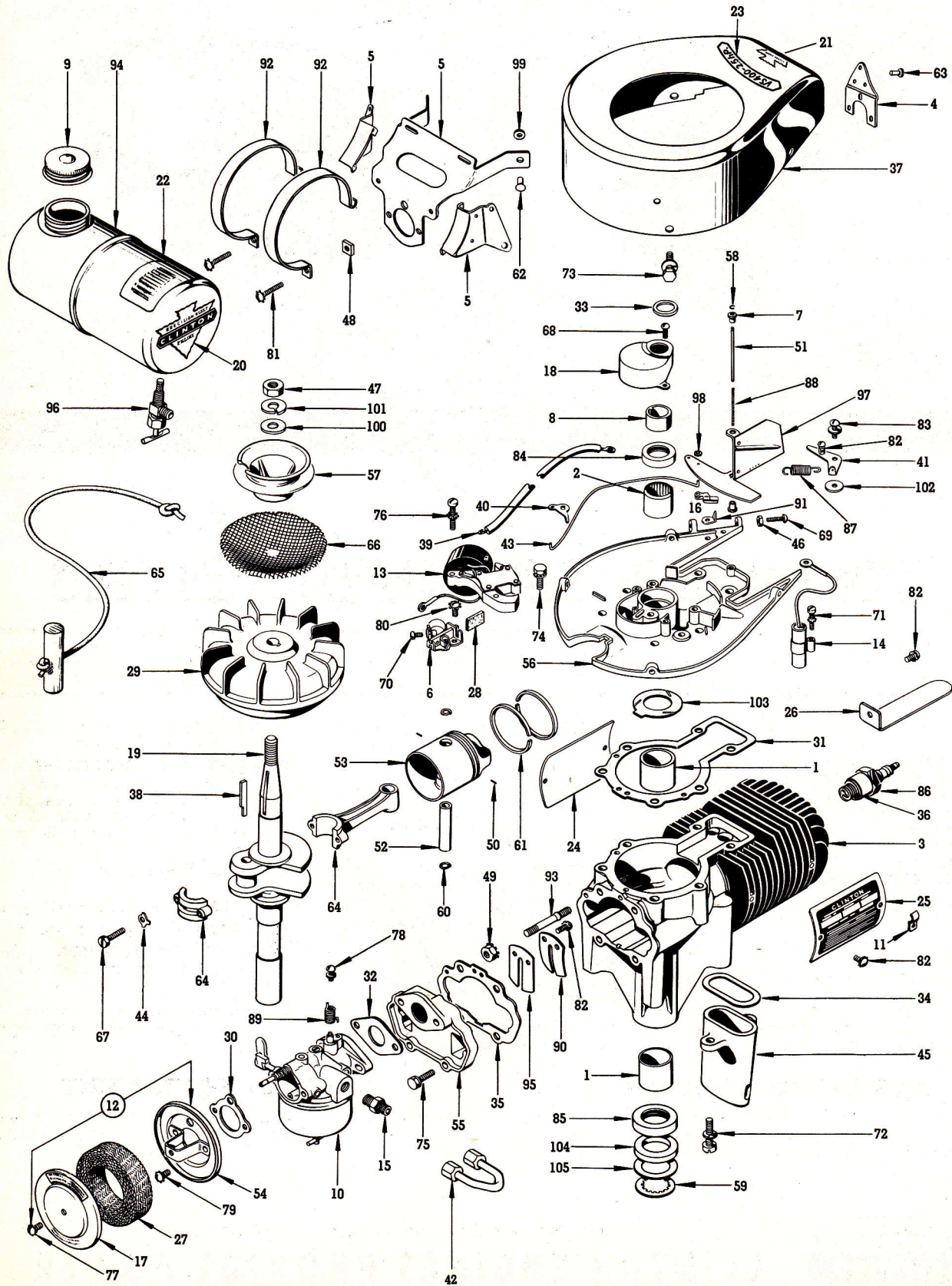

CLINTON

S E R I E S
VS-400
2 - C Y C L E

**BASIC
TYPES**
**SEC. II, DIV. VS-400
PARTS CATALOG**
 Revised July, 1955
 Supersedes Sept., 1954

There are five Basic Types of the VS-400 Engines covered by this Basic Parts List. Parts not used on all Types are noted. These "TYPES" are shown as follows: SERIAL NUMBER SUFFIX "A"—referred to as "TYPE A." SERIAL NUMBER SUFFIX "B"—referred to as "TYPE B." SERIAL NUMBER SUFFIX "C"—referred to as "TYPE C." Etc.

Check for Model Variations following this Basic Parts List.

NOTE: See page (a) on "How to Identify Your Clinton Engine."

BASIC PARTS LIST — ALL TYPES

Fig. 1 Ref. No.	PART DESCRIPTION	Part No.	Quantity
1	BEARING — Main, Sleeve (Block Assembly Cylinder).....	2058	2
2	BEARING — Needle (Bearing Plate)—used on Types A, B & C....	2502	1
	BEARING — Sleeve (Bearing Plate)—used on Types D & E.....	2509	1
3	BLOCK ASSEMBLY — Cylinder.....	2420-A	1
	NOTE: Block Assembly includes Ref. No. 1.		
4	BRACE — Blower Housing to Block — used on Types B, C, D & E...	2127	1
5	BRACKET — Fuel Tank — used on Type A.....	2052	1
	BRACKET — Fuel Tank, Left Hand — used on Types B, C, D & E...	2133	1
	BRACKET — Fuel Tank, Right Hand — used on Types B, C, D & E...	2134	1
6	BREAKER POINTS ASSEMBLY — Magneto.....	P5532	1
	NOTE: Breaker Points Assembly includes Ref. No. 70.		
7	BUSHING — Air Vane.....	7239	2
8	CAM — Breaker Points.....	5105	1
9	CAP AND GASKET ASSEMBLY—Fuel—used on Type A.....	7440	1
	CAP AND GASKET ASSEMBLY—Fuel—used on Types B, C, D & E...	4517-A	1
10	CARBURETOR ASSEMBLY — (Clinton) — used on Type E.....	14001	1
	CARBURETOR ASSEMBLY — (Carter) — used on Type A.....	C2478	1
	CARBURETOR ASSEMBLY — (Carter) — used on Types B, C & D...	C2478-1	1
11	CLAMP — High Tension Lead (Deflector Name Plate).....	C3410	1
12	CLEANER ASSEMBLY — Air.....	2000-A	1
	NOTE: Cleaner Assembly includes Ref. Nos. 17, 27, 54 and 77.		
13	COIL ASSEMBLY — Magneto (With Laminations)— used on Types A & B.....	P5531	1
	COIL ASSEMBLY — Magneto (With Laminations)— used on Types C, D & E.....	P5545	1
	COIL — Magneto (Without Laminations)—used on Types A & B...	P5539	1
	COIL — Magneto (Without Laminations)—used on Types C, D & E...	P5538	1
14	CONDENSER — Magneto.....	P2053	1
15	CONNECTOR — Flexible Fuel Line (Carburetor).....	5053	1
16	CONNECTOR — Governor Link (Link to Air Vane)— used on Types B, C, D & E.....	2226	1
17	COVER — Air Cleaner.....	2003	1
18	COVER — Breaker Points.....	2060	1
19	CRANKSHAFT.....	2041	1
20	DECAL — Arrowhead "2 Cycle" — used on Type A.....	2080	3
21	DECAL — Arrowhead — used on Types B, C, D & E.....	3579	1
22	DECAL — Instruction, Fuel Mixture.....	2098	1
23	DECAL — Horse Power (2.5).....	2414	1
24	DEFLECTOR — Air, Cylinder.....	2037	1
25	DEFLECTOR — Air and Name Plate Assembly, Cylinder.....	2106	1
26	DEVICE — Ignition Shorting Clip.....	2054	1
27	ELEMENT — Air Cleaner — used on Type A.....	2002	1
	ELEMENT — Air Cleaner — used on Types B, C, D & E.....	2132	1
	ENGINE REPAIR KIT.....	6310	1
28	FELT — Lubrication, Cam Follower.....	P5504	1
29	FLYWHEEL ASSEMBLY (Sold as an Assembly only).....	2070-1A	1
30	GASKET — Air Cleaner (1—Bracket to Air Cleaner, 1—Carburetor to Tank Bracket—used on Type A) (1—Air Cleaner to Carburetor —used on Types B, C, D & E).....	2075	2
31	GASKET — Bearing Plate (Standard, .030 thick).....	2039	1
	NOTE: Gaskets are also available in the following thicknesses: .025, .030 and .035. Order by Part No. and specify thickness.		

CLINTON

S E R I E S
VS-400
2 - C Y C L E

**BASIC
TYPES**

BASIC PARTS LIST — ALL TYPES (Continued)

Fig. 1 Ref. No.	PART DESCRIPTION	Part No.	Quantity
32	GASKET — Carburetor to Reed Plate.....	2096	1
33	GASKET — Crankshaft (Dust Cover to Flywheel).....	7139	1
34	GASKET — Muffler to Block.....	2069	1
35	GASKET — Reed Plate to Block.....	2034	1
36	GASKET — Spark Plug.....	3115	1
	GASKET KIT — Engine Overhaul.....	2203	1
	NOTE: Kit contains all necessary Gaskets and Oil Seals.		
37	HOUSING — Blower and Bracket Assembly—used on Type A.....	2038-E	1
	HOUSING — Blower and Bracket Assembly—used on Types B, C, D & E.....	2139-E	1
	NOTE: Housing Assembly includes Brace and Brackets.		
	HOUSING — Blower and Bracket Assembly (For Recoil Starter).....	2138-B	1
	NOTE: Blower Housing Assembly includes Ref. Nos. 4, 5, 62, 63 and 99.		
38	KEY — Flywheel.....	7244	1
39	LEAD — High Tension, Magneto.....	P2055	1
40	LEVER — Throttle, Governor — used on Type A.....	2050	1
41	LEVER & SCREW ASSEMBLY—Throttle Control—Types B, C, D & E.....	2043-B	1
42	LINE — Fuel, Flexible.....	6316	1
43	LINK — Air Governor.....	2046	1
44	LOCK — Connecting Rod Screw.....	2027	2
45	MUFFLER.....	2082	1
46	NUT — Hexagon, 8-32 (Speed Control Adjusting).....	5522	1
47	NUT — Hexagon, 7/16-20 (Starter Pulley).....	3250	1
48	NUT — Square, 10-24 (Tank Straps to Bracket)—used on Type A.....	3253	2
49	NUT & L'WASHER ASSY. — Hexagon, 1/4-28 (Carburetor to Reed Plate).....	3255-A	2
50	PIN — Drive (Ring Retainer).....	2099	2
51	PIN — Pivot, Air Vane.....	2047	1
52	PIN — Wrist.....	2428	1
53	PISTON — Standard.....	2430	1
	PISTON ASSEMBLY — Standard.....	2430-A	1
	NOTE: Piston and Piston Assemblies are also available in the following oversizes: .005, .010 and .020. Order by Part Number and specify oversize.		
	NOTE: Piston Assembly includes Ref. Nos. 50, 52, 53, 60 and 61.		
54	PLATE — Air Cleaner Mounting — used on Types A, B, C & D.....	2000	1
	PLATE — Air Cleaner Mounting — used on Type E.....	2001-B	1
55	PLATE — Reed Valve Assembly.....	2033-A	1
	NOTE: Reed Valve Plate Assembly includes Ref. Nos. 82, 90 & 95.		
56	PLATE — Bearing — used on Types A, B and C.....	2015-A	1
	PLATE — Bearing — used on Types D and E.....	2012-A	1
	NOTE: Bearing Plate includes Ref. Nos. 2 and 84.		
	PLATE ASSEMBLY — Bearing & Magneto—used on Types A, B, C.....	C2015-B	1
	PLATE ASSEMBLY — Bearing & Magneto—used on Types D & E.....	C2012-B	1
	NOTE: Bearing & Magneto Plate Assembly includes Ref. Nos. 6, 13, 14, 28, 39, 56, 70, 71 and 80.		
57	PULLEY — Starter.....	3299	1
58	RETAINER — Air Vane.....	4430	1
59	RETAINER — Self-Locking (Power Take-Off).....	7452	1
60	RETAINER — Wrist Pin.....	3030	2
61	RING — Piston, Standard.....	2408	2
	RING SET — Piston, Standard.....	2486	1
	NOTE: Rings are also available in the following oversizes: .005, .010 and .020. Order by Part No. and specify oversize.		
62	RIVET — Tubular, 3/16 x 9/32 (Bracket to Housing).....	3619	2
63	RIVET — Tubular (Brace to Blower Housing)—used on Types B, C, D & E.....	5460	3
64	ROD ASSEMBLY — Connecting.....	2422-A	1
	NOTE: Rod Assembly includes Ref. Nos. 44 and 67.		

CLINTON

S	E	R	I	E	S
VS-400					
2 - C Y C L E					

**BASIC
TYPES**
**SEC. II, DIV. VS-400
PARTS CATALOG**
 Revised July, 1955
 Supersedes Sept., 1954
BASIC PARTS LIST — ALL TYPES (Continued)

Fig. 1 Ref. No.	PART DESCRIPTION	Part No.	Quantity
65	ROPE ASSEMBLY — Starter	4266	1
66	SCREEN — Revolving	7187	1
67	SCREW — H.H. Slotted, 10-24 x 3/4 (Connecting Rod Cap)	5429	2
68	SCREW — O.H.S.T., 6-32 x 3/8 (Breaker Cover to Bearing Plate)	5416	2
69	SCREW — R.H.M., 8-32 x 7/8 (Speed Control Adjusting)	3240	1
70	SCREW — R.H.S.T., 6-32 x 1/2 (Breaker Points Terminal)	5664	1
	SCREW — H.H. Slotted, 8-32 x 3/8 (Deflector and Nameplate to Block) —used on Types B, C, D and E	5644	4
71	SCREW & L'WASHER ASSY. — F.H.M., 8-32 x 3/8 (Condenser to Bearing Plate)	3239-F	1
72	SCREW & L'WASHER ASSY. — F.H.M., 1/4-20 x 3/4 (Muffler to Block)	5439-G	2
73	SCREW & L'WASHER ASSY. — H.H.C., 1/4-20 x 1/2 (Blower Hous- ing to Plate)—used on Type A	3205-G	4
	SCREW & L'WASHER ASSY. — H.H.C., 1/4-20 x 3/8 (Blower Hous- ing to Bearing Plate)—used on Types B, C, D & E	3632-G	4
74	SCREW & L'WASHER ASSY. — H.H.C., 1/4-20 x 3/4 (Bearing Plate to Block)	5446-F	6
75	SCREW & L'WASHER ASSY. — H.H.C., 1/4-20 x 7/8 (Reed Plate to Block)	3294-G	2
76	SCREW & L'WASHER ASSY. — P.H.S.T., 10-24 x 1 (Lamination to Bearing Plate)	5430-A	2
77	SCREW & L'WASHER ASSY. — B.H.M., 8-32 x 3/8 (Air Cleaner Cover to Mounting Plate)	5457-A	1
78	SCREW & L'WASHER ASSY. — R.H.M., 8-32 x 1/4 (Lever to Carbu- retor)—used on Type A	7143-A	1
79	SCREW & L'WASHER ASSY. — R.H.M., 8-32 x 9/16 (Mounting Plate to Carburetor)—used on Type A	3326-A	2
	SCREW & L'WASHER ASSY. — F.H.M., 8-32 x 7/16 (Mounting Plate to Carburetor)—used on Types B, C, D & E	5456-A	2
80	SCREW & L'WASHER ASSY. — R.H.M., 8-32 x 3/8 (Breaker Points to Bearing Plate)	5444-F	1
81	SCREW & L'WASHER ASSY. — R.H.M., 10-24 x 1 (Fuel Tank Straps)—used on Type A	5421-A	2
	SCREW & L'WASHER ASSY. — R.H.M., 10-24 x 1 1/4 (Fuel Tank Straps)—used on Types B, C, D & E	5422-A	2
82	SCREW & L'WASHER ASSY. — R.H.S.T., 8-32 x 1/2 (3—Shorting Clip and Brace to Block)—used on Types B and C	5443-A	3
	SCREW & L'WASHER ASSY. — R.H.S.T., 8-32 x 3/8 (4—Deflector and Nameplate to Block, 2—Reed Assembly to Reed Plate)— used on Type A	5409-A	6
	SCREW & L'WASHER ASSY. — R.H.S.T., 8-32 x 5/16 (Shorting Clip Assembly)—used on Type A (Throttle Lever Stop)—used on Types B and C	5438-A	1
	SCREW & L'WASHER ASSY. — H.H.C., 8-32 x 1/2 (Reed Assembly to Reed Plate)—used on Types B, C, D & E	5644-A	2
83	SCREW & WASHER ASSY. — H.H.C., 8-32 x 3/8 (Speed Control Lever)	5443-D	1
84	SEAL — Oil (Bearing Plate)	7254	1
85	SEAL — Oil (Power Take-Off)	4429	1
	SEAL — Oil (Power Take-Off)	2121	1
	NOTE: 2121 Seal replaces 4429 Seal, 7452 Retainer, 7443 Felt Washer and 7444 Washer.		
86	SPARK PLUG AND GASKET ASSEMBLY	2168-A	1
87	SPRING — Air Governor	2448	1
88	SPRING — Compression (Air Vane)	2400	1
89	SPRING — Governor Throttle Backlash — used on Type A	2111	1
90	STOP — Reed Valve	2036	1
91	STOP — Throttle Lever — used on Type A	4448	1

CLINTON

S E R I E S
VS-400
 2 - C Y C L E

**BASIC
 TYPES**

BASIC PARTS LIST — ALL TYPES (Continued)

Fig. 1 Ref. No.	PART DESCRIPTION	Part No.	Quantity
92	STRAP — Fuel Tank — used on Type A.....	2051	2
	STRAP — Fuel Tank — used on Types B, C, D & E.....	2435	2
93	STUD — Carburetor and Reed Plate Assembly Mounting.....	2063	2
94	TANK ASSEMBLY — Fuel — used on Type A.....	7461-A	1
	TANK ASSEMBLY — Fuel — used on Types B, C, D & E.....	3481-A	1
	NOTE: Tank Assembly includes Ref. No. 9.		
95	VALVE — Reed.....	2035	1
96	VALVE — Fuel, Shut-Off, Flexible Line.....	5051	1
97	VANE AND LEVER ASSEMBLY — Air Governor.....	2045-A	1
98	WASHER — (Air Governor Link).....	2049	2
99	WASHER — Flat, #10 (Bracket to Housing).....	3279	2
100	WASHER — Flat, 7/16 (Starter Pulley).....	5482	1
101	WASHER — Lock, 7/16 (Starter Pulley).....	3275	1
	WASHER — Lock (Throttle Lever Stop to Bearing Plate) — used on Types B & C.....	5481	1
102	WASHER — Spring Tension (Throttle Control).....	2077	1
103	WASHER — Thrust, Bronze (Crankshaft).....	2464	1
104	WASHER — Felt (Power Take-Off).....	7443	1
105	WASHER — Flat Steel (Power Take-Off).....	7444	1

AVAILABLE OVERHAUL KITS

Engine Model	Description	Kit No.
All Types	Gasket Overhaul Kit	2203
All Types	Engine Overhaul Kit	6310
Types A, B, C & D	Carburetor Repair Kit (Carter)	C6315
Type E	Carburetor Repair Kit (Clinton)	14237



CLINTON

SERIES VS-400 PANTHER

MODEL VARIATIONS

SEC. II, DIV. VS-400
PARTS CATALOG
Revised December, 1955
Supersedes March, 1955

MODEL VARIATIONS OF VS-400 SERIES

The adaptation of Clinton Engines to a wide variety of uses results in what is known as "Model Variations." Following is the complete list of all Models produced up to issue date (shown above). Opposite each Engine Model listed are the Part Numbers and/or Assembly Numbers for the Series used IN ADDITION TO or IN PLACE OF the parts illustrated and shown on the Basic Parts List preceding this Model Variations List. Refer to other sections of this Manual when Assembly Numbers are given to find the Parts List for these assemblies.

See page (a) on "How to Identify Your Clinton Engine." Use the preceding Basic Parts List except as shown below.

ENGINE MODEL—See Page (a), "How to Identify Your Clinton Engine."	FOOTNOTES (Check page three).	CRANKSHAFT (Part Numbers Shown). Refer to Sec. IV, Div. B for details and further information.	CONTROL GROUP (Control Group Illustration Numbers Shown). Refer to Sec. III, Div. D for Parts List.	CONTROL CABLE LENGTH, replacement cable is furnished in 72" length ONLY, cut to length shown.	PLATE ASSEMBLY — BEARING (Part Numbers Shown). Refer to Illustrated Basic Parts List for corresponding part.	STARTER—RECOIL (Assembly Numbers Shown). Refer to Sec. III, Div. H for Parts Lists.	MUFFLER OR MANIFOLD (Parts Numbers Shown). Refer to Illustrated Basic Parts List for corresponding part.
VS-400-AOB			3855-56	72"			
VS-400-AOC	No Variation, use Basic Parts List						
VS-400-AOD	No Variation, use Basic Parts List						
VS-400-AOE			3855-56	72"			
VS-400-AOF		2401					
VS-400-AOG	Note 2						2118
VS-400-AOH	Note 6						2220-A
VS-400-AOJ	Note 1				2016-A		
VS-400-AOK	Note 6		3855-56	72"			2220-A
VS-400-AORA						C6314	
VS-400-AORB						C6314	
VS-400-AORC						C6314	
VS-400-AORD			3855-56	72"		C6314	
VS-400-AORE			3855-56	72"		C6314	
VS-400-AORF	Notes 1, 2 & 4		3855-56	72"	2016-A	C6314	2118
VS-400-AORG						C6314	
VS-400-AORH		2401				C6314	
VS-400-AOSA						C6323	
VS-400-AOSB						C6323	
VS-400-AOSC						C6323	
VS-400-AOSD			3855-56	72"		C6323	
VS-400-AOSE	Notes 1 & 2		3855-56	72"	2016-A		2118
VS-400-AOSF						C6323	
VS-400-AOSG		2401				C6323	
VS-400-AOSH	Note 6		3855-56	72"		C6323	2220-A
VS-400-AOSJ						C6323	2136
VS-400-BOA	Note 6						
VS-400-BOB	Note 5						
VS-400-BOC	Notes 5 & 6						2220-A
VS-400-BOD	Note 5		3855-56	72"			
VS-400-BORA	Note 6					C6314	
VS-400-BORB	Note 6					C6314	
VS-400-BOSA	Note 5					C6323	
VS-400-BOSB	Note 5		3855-56	72"		C6323	
VS-400-BOSC	Note 5					C6323	

CLINTON

S E R I E S
VS-400
P A N T H E R

MODEL
VARIATIONS

MODEL VARIATIONS OF VS-400 SERIES (Cont.)

ENGINE MODEL	FOOTNOTES	CRANKSHAFT	CONTROL GROUP	CONTROL CABLE LENGTH	PLATE ASSEMBLY—BEARING	STARTER—RECOIL	HOUSING ASSEMBLY—BLOWER	MUFFLER OR MANIFOLD
VS-400-100	No Variation, use Basic Parts List							
VS-400-101	No Variation, use Basic Parts List							
VS-400-102						C6323	2140-A	
VS-400-103						C6323	2140-A	
VS-400-104	Note 5							
VS-400-105	Note 5					C6323	2140-A	
VS-400-106			3855-56	72"				
VS-400-107					2013-A	C6323	2140-A	
VS-400-108	Notes 5 & 7							
VS-400-109			3855-56	72"		C6323	2140-A	
VS-400-110	Note 6							2220-A
VS-400-111	Notes 5 & 6							2220-A
VS-400-112	Note 5		3855-56	72"				
VS-400-113	No Variation, use Basic Parts List							
VS-400-114						C6323	2140-A	
VS-400-115		2148						
VS-400-116		2148				C6323	2140-A	
VS-400-117						C6323	2140-A	
VS-400-118						C6323	2140-A	2136
VS-400-119	No Variation, use Basic Parts List							
VS-400-120						C6323	2140-A	
VS-400-121							2140-A	
VS-400-122	Note 5							
VS-400-123	Note 5						2140-A	
VS-400-124						C6323	2140-A	
VS-400-125	Note 5							
VS-400-126	Note 5					C6323	2140-A	
VS-400-127			3855-56					
VS-400-128						C6323	2140-A	
VS-400-129	Note 5					C6323	2140-A	
VS-400-130	Note 5						2140-A	
VS-400-131	Note 6		3855-56			C6323	2140-A	
VS-400-132	Notes 5 & 6					C6323	2140-A	
VS-400-133						C6323	2140-A	
VS-400-134	Note 8				2013-A	C6341	2140-A	
VS-400-135						C6341	2140-A	2136
VS-400-136	Note 9							
VS-400-137		2293						
VS-400-138	Note 8	2293			2013-A	C6341	2140-A	2324-D
VS-400-139	Note 5					C6323	2140-A	
VS-400-140	Note 5					C6323	2140-A	
VS-400-141	Note 8	2293			2013-A	C6341	2140-A	2324-D

CLINTON

**S E R I E S
VS-400
P A N T H E R**

**MODEL
VARIATIONS**

**SEC. II, DIV. VS-400
PARTS CATALOG
Revised December, 1955
Supersedes March, 1955**

MODEL VARIATIONS OF VS-400 SERIES (Cont.)

- NOTE 1—This Engine uses a shut-off switch and the following additional parts are necessary: 3239 Screw; 3288 Washer; 5527 Washer, Shoulder, Fiber; 5528 Washer, Fiber; 3478 Terminal; 5524 Nut; 5526-D Terminal Wire Ass'y.
- NOTE 2—This Assembly consists of the following additional parts: 2119 Shell, Muffler (Inner); 2120 Baffle, Muffler; 2122 Shell, Muffler (Outer); 2126 Gasket, Muffler; (2) 5441-G Screw & L'Washer Assy.
- NOTE 3—Use 5542-A Shorting Wire Ass'y and 5522 Nut.
- NOTE 4—Use 5536-A Shorting Wire Ass'y and 5522 Nut.
- NOTE 5—Use 2131 Base, Engine; four (4) 3217-G Screw & L'Washer Ass'y. See Sec. IV, Div. A.
- NOTE 6—This Assembly consists of the following additional parts: 2220 Muffler Body; 2222 Baffle; (2) 2223 Spacer; 2221 Cover; 2225 Gasket; 2224 Plate, Inspection; (2) 5612-A Screw & L'Washer Ass'y; (2) 5409-A Screw & L'Washer Ass'y.
- NOTE 7—Use #2137 Adapter-Muffler; #5658-G Screw & Lockwasher Assembly; Two (2) #5659 Stud-Muffler mounting; and Two (2) #3265.
- NOTE 8—5526-D Terminal Wire Assembly, 5566 Grommet, C-3475 Terminal, 2228 Terminal, 5644 Screw used in lieu of 2054 Clip—Ignition Shorting. (2) 5659 Stud, (2) 3255-A Nut & L'washer Assembly, and (2) 5498 Washer (Flat) used as additional parts.
- NOTE 9—Use 3576 Connector—Fuel, C3500-A Valve and Filter Assembly, and 5053 Connector—Fuel on this model.