



**CARBURETOR
 IDENTIFICATION**

The illustrations on this page show the various Carburetors and where the Identification Numbers are located on the Carburetor. On some earlier type Carburetors no Casting Identification Numbers are available and in some cases IBM Numbers have not been assigned.

The following four pages (2-A, 2-B, 2-C & 2-D) list three methods of locating the page in Sec. III, Div. A on which the Carburetor Parts List can be found.

- A. The first grouping (First Column of Group on Left) on Pages 2-A, 2-B, 2-C & 2-D is numerical by Clinton Carburetor Part Number. Listed here is the Part Number, the Identification Number, and IBM Number plus page in Sec. III, Div. A where the Carburetor Parts List is shown.
- B. The second grouping (First Column of Center Group) on Pages 2-A, 2-B, 2-C & 2-D is numerical by Carburetor Casting Identification Number (see illustration below) and includes Clinton Part Number, IBM Number and lists Page Number in Sec. III, Div. A where the Carburetor Parts List is shown. This parts list will be under Clinton Part Number (not Identification Number) in most cases, however, certain Carburetors carry only a Identification Number and IBM Number and on these the Carburetors Parts List will be under IBM Number.
- C. The third grouping (First Column of Group on Right) on Pages 2-A, 2-B, 2-C & 2-D is numerical by IBM Number and includes Identification Number, Clinton Part Number and lists Page Number in Sec. III, Div. A where the Carburetor Parts List is shown. The parts list will be under Clinton Part Number (not Identification Number) in most cases, however, certain Carburetors carry only an Identification Number and IBM Number and, on these, the Carburetor Parts List will be under IBM Number.

NOTE: A. The Carburetor cross reference listed on Pages 2-A, 2-B, 2-C & 2-D is listed for all engines in Sec. II of Engine Service Manual. When engine model is known, check Sec. II, Basic Parts List and respective Model Variation for Carburetor Number and the following cross reference for Part List Page. When Carburetor Part Number or Identification Number is known check following cross reference for Parts List Page.

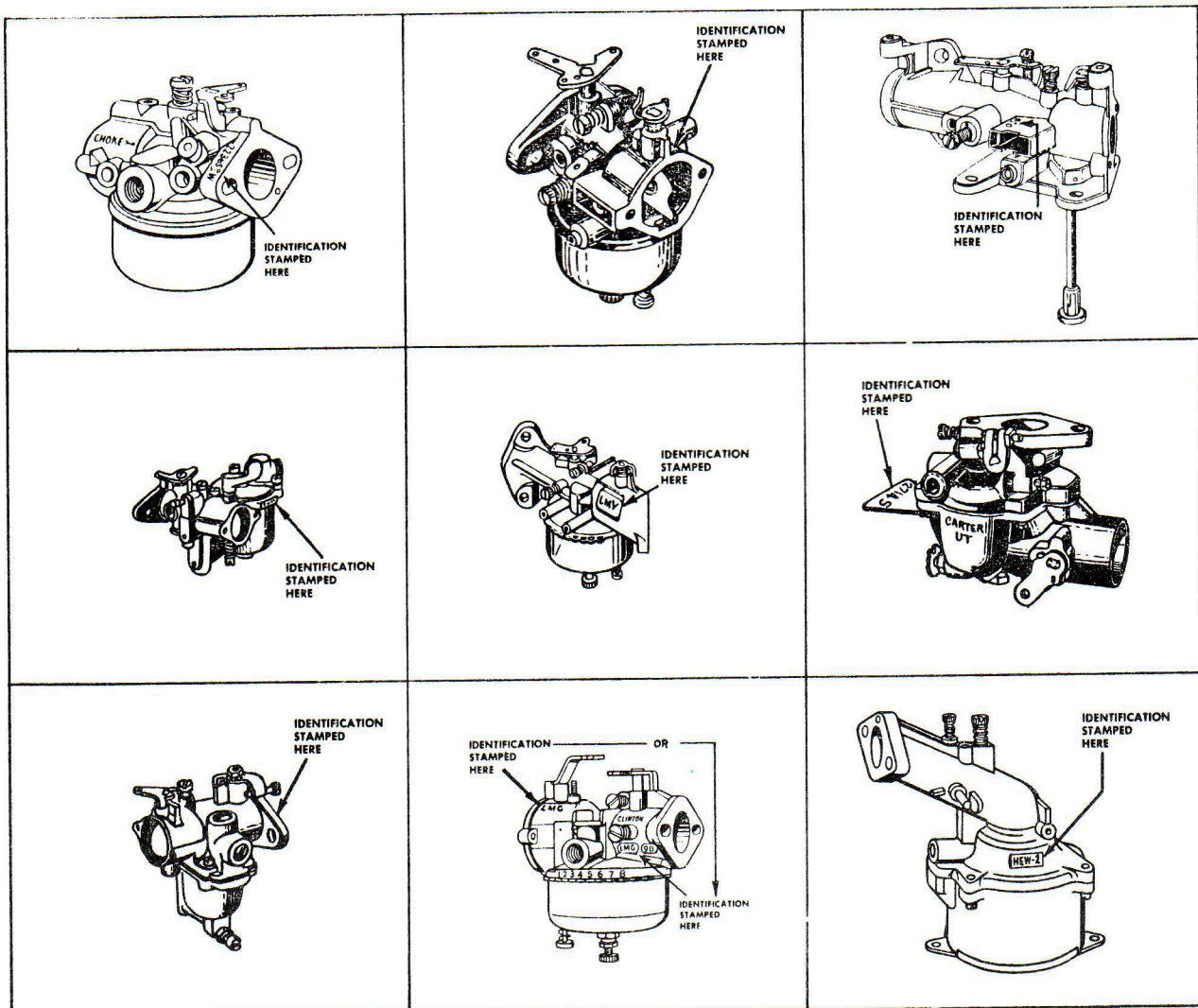

Numerical by Part Number				Numerical by Identification				Numerical by IBM			
Part Number	Identification	IBM Number	Page	Identification	Part Number	IBM Number	Page	IBM Number	Identification	Part Number	Page
2078	N-2003-S		7	LMG-1	14001	39-459-5	32	39-104-5	N-2171-S	2478-1	9
2078-1	N-2029-S	39-250	7	LMV-1	14044	39-123-5	33	39-105	N-2147-S	4446-2	9
2478	N-2087-S		9	HEW-2	14021	39-186-99	20	39-107	N-2020-S	6230-2	9
2478-1	N-2171-S	39-104-5	9	LMG-2	14002	39-460-5	32	39-108-5	LMG-11	14011	32
3300	ML-7-A	39-255	5	LMV-2	14043	39-122-5	33	39-109-5	LMG-12	14012	32
3300	ML-7-B	39-255	5	3-CP	402850	39-659-5	26	39-110-5	LMG-14	14014	32
3900		39-263-5	5	LMG-3	14003	39-461-5	32	39-112-5	LMG-23	14023	32
3924-1			5	HEW-4	14022	39-187-99	20	39-114-5	LMG-24	14024	32
3925	2-176-11	39-266	5	LMG-4		39-769-5	29	39-115-5	LMG-26	14026	32
3965	N-705-S	39-267	7	LMB-4	14004	39-462-5	32	39-116-5	LMG-28	14028	32
4446	N-705-S		7	LMB-5		39-770-5	29	39-117-5	LMG-29	14029	32
4446-2	N-2147-S	39-105	9	LMB-6		39-771-5	29	39-118-5	LMG-31	14031	33
4481			3	ML-7-A	3300	39-255	4 & 5	39-119-5	LMG-32	14032	33
4484-2		39-280-5	3	ML-7-B	3300	39-255	4 & 5	39-122-5	LMV-2	14043	33
4709			3	LMB-7		39-783-5	29	39-123-5	LMV-1	14044	33
4730-1			3	LMB-8		39-782-5	29	39-124-5	LMG-45	14045	33
4730-2			3	LMG-8	14008	39-463-5	32	39-125-5	LMG-46	14046	33
6200	ML-14-A	39-290	5	LMG-9	14009	39-464-5	32	39-126-5	LMG-49	14049	33
6230	N-707-S	39-291	7	LMV-9	14782-A	39-746-5	37	39-129-5	LMG-52	14052	33
				LMG-10	14010	39-465-5	32	39-130-5	LMG-53	14053	33
6230	N-707-SA	39-291	7	LMV-10	14784-A	39-747-5	37	39-131-5	LMG-54	14054	33
6230-2	N-2020-S	39-107	9	LMG-11	14011	39-108-5	32	39-132-5	LMG-59	14059	33
7080-1			3	LMV-11	14786-A	39-749-5	37	39-134-5	LMG-63	14063	33
7080-2		39-554-5	3	LMG-12	14012	39-109-5	32	39-136-5	LMG-69	14069	34
7100		39-534-5	3	LMV-12	14797-A	39-755-5	37	39-137-5	LMG-96	14070	34
7120			3	HL-13-A	401042	39-627-5	24	39-138-5	LMG-71	14071	34
14001	LMG-1	39-459-5	32	LMG-13	14013	39-466-5	32	39-140-5	UT2714S	14074	19
14002	LMG-2	39-460-5	32	ML-14-A	6200	39-290	4 & 5	39-143-5	UT2712S	14078	19
14003	LMG-3	39-461-5	32	LMG-14	14014	39-110-5	32	39-144-5	UT2713S	14079	19
14004	LMG-4	39-462-5	32	15-CS	403686	39-596-5	25	39-145-5	UT2337S	14080	18
14008	LMG-8	39-463-5	32	LMB-17		39-796-5	29	39-146-5	UT2336S	14081	18
14009	LMG-9	39-464-5	32	LMB-18		39-797-5	29	39-147-5	UT2398S	14082	19
14010	LMG-10	39-465-5	32	LMB-19		39-798-5	29	39-150-5	N-2264-S	14094	9
14011	LMG-11	39-108-5	32	LMB-20		39-799-5	29	39-153-5	0153	14101	34
14012	LMG-12	39-109-5	32	LMB-21		39-801-5	29	39-158-5	LMG-67	14267	10
14013	LMG-13	39-466-5	32	LMG-23	14023	39-112-5	32	39-159-5	LMG-68	14268	10
14014	LMG-14	39-110-5	32	LMB-24		39-802-5	29	39-160-5	0160	14345	34
14021	HEW-2	39-186-99	20	LMG-24	14024	39-114-5	32	39-161-5	LMG-82	14355	34
14022	HEW-4	39-187-99	20	LMB-25		39-806-5	29	39-162-5	LMG-89	14356	34
14023	LMG-23	39-112-5	32	LMG-25	14025		32	39-163-5		14357	34
14024	LMG-24	39-114-5	32	LMB-26		39-812-5	29	39-167-5	0167	14543	35
14025	LMG-25		32	LMG-26	14026	39-115-5	32	39-168-5	0168	14557	35
14026	LMG-26	39-115-5	32	LMB-27		39-817-5	29	36-169-5	0169	14560	35
14027	LMG-27	39-468-5	32	LMG-27	14027	39-468-5	32	39-170-5	0170	14561	35
14028	LMG-28	39-116-5	32	LMG-28	14028	39-116-5	32	39-171-5	0171	14562	35
14029	LMG-29	39-117-5	32	LMG-29	14029	39-117-5	32	39-172-5	0172	14564	35
14030	LMG-30	39-469-5	32	LMG-30	14030	39-469-5	32	39-173-5	0173	14565	35
14031	LMG-31	39-118-5	33	LMG-31	14031	39-118-5	33	39-174-5	0174	14568	35
14032	LMG-32	39-119-5	33	LMG-32	14032	39-119-5	33	39-175-5	0175	14569	35
14035		39-188-99	33	HL-44-A	402735	39-657-5	24	39-176-5	0176	14589	39
14043	LMV-2	39-122-5	33	LMG-45	14045	39-124-5	33	39-177-5	0177	14590	35
14044	LMV-1	39-123-5	33	LMG-46	14046	39-125-5	33	39-178-5	0178	14593	35
14045	LMG-45	39-124-5	33	LMG-48	14048	39-470-5	33	39-179-5	0179	14594	35
14046	LMG-46	39-125-5	33	LMG-49	14049	39-126-5	33	39-180-5	0180	14596	35
14048	LMG-48	39-470-5	33	LMG-52	14052	39-129-5	33	39-181-5	0181	14597	36
14049	LMG-49	39-126-5	33	LMG-53	14053	39-130-5	33	39-182-5	0182	14598	36
14052	LMG-52	39-129-5	33	LMG-54	14054	39-131-5	33	39-183-5	0183	14600	36
14053	LMG-53	39-130-5	33	LMG-59	14059	39-132-5	33	39-184-5	LMG-122	14659	37
14054	LMG-54	39-131-5	33	LMG-60	14060	39-471-5	33	39-186-99	HEW-2	14021	20
14055		39-190-99	33	LMG-61	14061	39-472-5	33	39-187-99	HEW-4	14022	20
14057		39-191-99	33	LMG-63	14063	39-134-5	33	39-188-99		14035	33
14059	LMG-59	39-132-5	33	LMG-64	14064	39-473-5	33	39-190-99		14055	33
14060	LMG-60	39-471-5	33	LMG-67	14267	39-158-5	10	39-191-99		14057	33

SEC. III, DIV. A
CARBURETORS

ISSUED JUNE, 1962

Numerical
by Part Number

Numerical by Identification

Numerical by IBM

Part Number	Identification	IBM Number	Page	Identification	Part Number	IBM Number	Page	IBM Number	Identification	Part Number	Page
14061	LMG-61	39-472-5	33	LMG-68	14268	39-159-5	10	39-192-99		14341	34
14063	LMG-63	39-134-5	33	LMG-69	14069	39-136-5	34	39-193-99		14342	34
14064	LMG-64	39-473-5	33	LMG-71	14071	39-138-5	34	39-194-99		14362	34
14069	LMG-69	39-136-5	34	LMG-82	14355	39-161-5	34	39-196-99		14365	34
14070	LMG-96	39-137-5	34	LMG-89	14356	39-162-5	34	39-197-99		14366	34
14071	LMG-71	39-138-5	34	LMG-96	14070	39-137-5	34	39-198-99		14370	34
14074	UT2714S	39-140-5	19	LMG-107	14607	39-399-5	36	39-199-99		14372	34
14078	UT2712S	39-143-5	19	LMG-108	14611	39-403-5	36	39-200-99		14374	34
14079	UT2713S	39-144-5	19	LMG-109	14612	39-404-5	36	39-201-99		14364	34
14080	UT2337S	39-145-5	18	LMG-110	14613	39-405-5	36	39-202-99		14484	34
14081	UT2336S	39-146-5	18	LMG-111	14614	39-406-5	36	39-207-99		14503	35
14082	UT2398S	39-147-5	19	LMG-112	14615	39-407-5	36	39-210-99		14512	35
14085	N-2466-S		9	LMG-113	14616	39-408-5	36	39-211-99		14513	35
14086	N-2449-S		9	LMG-114	14617	39-409-5	36	39-212-99		14515	35
14087	N-2459-S	39-477-5	9	LMG-115	14618	39-410-5	36	39-213-99		14517	35
14088	N-2456-S	39-475-5	9	LMG-116	14619	39-411-5	36	39-236-5	0236	14346	34
14089	N-2457-S	39-479-5	9	LMG-117	14620	39-412-5	36	39-250	N-2029-S	2078-1	7
14090	N-2458-S	39-480-5	9	LMG-118	14621	39-413-5	36	39-255	ML-7-A	3300	5
14093	N-2399-S		9	LMG-119	14622	39-414-5	36	39-255	ML-7-B	3300	5
14094	N-2264-S	39-150-5	9	LMG-120	14623	39-415-5	36	39-263-5	0236	14346	34
14097	N-2236-S		9	LMG-121	14624	39-416-5	36	39-263-5		3900	5
14098	UT2230S		18	LMG-122	14659	39-184-5	37	39-266	2-176-11	3925	5
14099	UT2217S	39-344-5	18	LMG-123	14628	39-420-5	36	39-267	N-705-S	3965	7
14101	0153	39-153-5	34	LMG-124	14629	39-421-5	37	39-280-5		4484-2	3
14267	LMG-67	39-158-5	10	LMG-125	14630	39-422-5	37	39-290	ML-14-A	6200	5
14268	LMG-68	39-159-5	10	LMG-126	14631	39-423-5	37	39-291	N-707-S	6230	7
14341		39-192-99	34	LMG-127	14635	39-427-5	37	39-291	N-707-SA	6230	7
14342		39-193-99	34	LMG-140	403691	39-658-5	38	39-344-5	UT2217S	14099	18
14345	0160	39-160-5	34	LMG-151	14371	39-383-5	38	39-383-5	LMG-151	14371	38
14346	0236	39-236-5	34	LMG-152	14754	39-731-5	38	39-399-5	LMG-107	14607	36
14355	LMG-82	39-161-5	34	0153	14101	39-153-5	34	39-403-5	LMG-108	14611	36
14356	LMG-89	39-162-5	34	LMG-156	14791	39-751-5	38	39-404-5	LMG-109	14612	36
14357		39-163-5	34	0160	14345	39-160-5	34	39-405-5	LMG-110	14613	36
14362		39-194-99	34	LMG-162	39-723-5		37	39-406-5	LMG-111	14614	36
14364		39-201-99	34	LMG-164		39-784-5	38	39-407-5	LMG-112	14615	36
14365		39-196-99	34	LMG-165		39-789-5	38	39-408-5	LMG-113	14616	36
14366		39-197-99	34	0167	14543	39-167-5	35	39-409-5	LMG-114	14617	36
14370		39-198-99	34	0168	14557	39-168-5	35	39-410-5	LMG-115	14618	36
14371	LMG-151	39-383-5	38	0169	14560	39-169-5	35	39-411-5	LMG-116	14619	36
14372		39-199-99	34	0170	14561	39-170-5	35	39-412-5	LMG-117	14620	36
14374		39-200-99	34	LMG-170		39-788-5	38	39-413-5	LMG-118	14621	36
14484		39-202-99	34	0171	14562	39-171-5	35	39-414-5	LMG-119	14622	36
14503		39-207-99	35	0172	14564	39-172-5	35	39-415-5	LMG-120	14623	36
14512		39-210-99	35	LMG-172		39-859-5	38	39-416-5	LMG-121	14624	36
14513		39-211-99	35	0173	14565	39-173-5	35	39-420-5	LMG-123	14628	36
14515		39-212-99	35	0174	14568	39-174-5	35	39-421-5	LMG-124	14629	37
14517		39-213-99	35	0175	14569	39-175-5	35	39-422-5	LMG-125	14630	37
14543	0167	39-167-5	35	0176	14589	39-176-5	35	39-423-5	LMG-126	14631	37
14557	0168	39-168-5	35	0177	14590	39-177-5	35	39-427-5	LMG-127	14635	37
14560	0169	39-169-5	35	0178	14593	39-178-5	35	39-428-5	0428	14636	37
14561	0170	39-170-5	35	0179	14594	39-179-5	35	39-459-5	LMG-1	14001	32
14562	0171	39-171-5	35	0180	14596	39-180-5	35	39-460-5	LMG-2	14002	32
14564	0172	39-172-5	35	0181	14597	39-181-5	36	39-461-5	LMG-3	14003	32
14565	0173	39-173-5	35	0182	14598	39-182-5	36	39-462-5	LMG-4	14004	32
14568	0174	39-174-5	35	0183	14600	39-183-5	36	39-463-5	LMG-8	14008	32
14569	0175	39-175-5	35	0236	14346	39-236-5	34	39-464-5	LMG-9	14009	32
14589	0176	39-176-5	35	0428	14636	39-428-5	37	39-465-5	LMG-10	14010	32
14590	0177	39-177-5	35	0566	14666	39-566-5	37	39-466-5	LMG-13	14013	32
14593	0178	39-178-5	35	0655	14713-A	39-655-5	37	39-468-5	LMG-27	14027	32
14594	0179	39-179-5	35	N-705-S	3965	39-267	7	39-469-5	LMG-30	14030	32
14596	0180	39-180-5	35	N-705-S	4446		7	39-470-5	LMG-48	14048	33
14597	0181	39-181-5	36	N-707-S	6230	39-291	7	39-471-5	LMG-60	14060	33
14598	0182	39-182-5	36	N-707-SA	6230	39-291	7	39-472-5	LMG-61	14061	33
14600	0183	39-183-5	36	0726		39-726-5	27	39-473-5	LMG-64	14064	33

SEC. III, DIV. A
CARBURETORS
ISSUED JUNE, 1962

Numerical by Part Number				Numerical by Identification				Numerical by IBM			
Part Number	Identification	IBM Number	Page	Identification	Part Number	IBM Number	Page	IBM Number	Identification	Part Number	Page
14607	LMG-107	39-399-5	36	0752	14792-A	39-752-5	37	39-475-5	N-2456-S	14088	9
14611	LMG-108	39-403-5	36	0753	14973-A	39-753-5	37	39-477-5	N-2459-S	14087	9
14612	LMG-109	39-404-5	36	0754	14795	39-754-5	37	39-479-5	N-2457-S	14089	9
14613	LMG-110	39-405-5	36	0759	14812	39-759-5	37	39-480-5	N-2458-S	14090	9
14614	LMG-111	39-406-5	36	0762		39-762-5	37	39-534-5		7100	3
14615	LMG-112	39-407-5	36	0763		39-763-5	38	39-554-5		7080-2	3
14616	LMG-113	39-408-5	36	0765		39-765-5	27	39-566-5	0566	14666	37
14617	LMG-114	39-409-5	36	0769		39-769-5	29	39-596-5	15-CS	403686	25
14618	LMG-115	39-410-5	36	0770		39-770-5	29	39-627-5	HL-13-A	401042	24
14619	LMG-116	39-411-5	36	0771		39-771-5	29	39-653-99		14712	37
14620	LMG-117	39-412-5	36	0782		39-782-5	29	39-655-5	0655	14713	37
14621	LMG-118	39-413-5	36	0783		39-783-5	29	39-657-5	HL-44-A	402735	24
14622	LMG-119	39-414-5	36	0790		39-790-5	27	39-658-5	LMG-140	403691	38
14623	LMG-120	39-415-5	36	0791		39-791-5	27	39-659-5	3-CP	402850	26
14624	LMG-121	39-416-5	36	0792		39-792-5	27	39-723-5	LMG-12		37
14628	LMG-123	39-420-5	36	0796		39-796-5	29	39-726-5	0726		27
14629	LMG-124	39-421-5	37	0797		39-797-5	29	39-731-5	LMG-152	14754	38
14630	LMG-125	39-422-5	37	0798		39-798-5	29	39-746-5	LMV-9	14782-A	37
14631	LMG-126	39-423-5	37	0799		39-799-5	29	39-747-5	LMV-10	14784-A	37
14635	LMG-127	39-427-5	37	0801		39-801-5	29	39-749-5	LMV-11	14786-A	37
14636	0428	39-428-5	37	0802		39-802-5	29	39-751-5	LMG-156	14791	38
14659	LMG-122	39-184-5	37	0803		39-803-5	27	39-752-5	0752	14792-A	37
14666	0566	39-566-5	37	0804		39-804-5	27	39-753-5	0753	14793-A	37
14712		39-653-99	37	0806		39-806-5	29	39-754-5	0754	14795	37
14713-A	0655	39-655-5	37	0809		39-809-5	27	39-755-5	LMV-12	14797-A	37
14754	LMG-152	39-731-5	38	0810		39-810-5	27	39-759-5	0759	14812	37
14782-A	LMV-9	39-746-5	37	0812		39-812-5	29	39-762-5	0762		37
14784-A	LMV-10	39-747-5	37	0817		39-817-5	29	39-763-5	0763		38
14786-A	LMV-11	39-749-5	37	0819		39-819-5	27	39-765-5	0765		27
14791	LMG-156	39-751-5	38	0820		39-820-5	27	39-769-5	0769		29
14792-A	0752	39-752-5	38	0857		39-857-5	27	39-769-5	LMB-4		29
14793-A	0753	39-753-5	37	0858		39-858-5	27	39-770-5	0770		29
14795	0754	39-754-5	37	N-2003-S	2078		7	39-770-5	LMB-5		29
14797-A	LMV-12	39-755-5	37	N-2020-S	6230-2	39-107	9	39-771-5	0771		29
14812	0759	39-759-5	37	N-2029-S	2078-1	39-250	7	39-771-5	LMB-6		29
401042	HL-13-A	39-627-5	24	N-2087-S	2478		9	39-782-5	0782		29
402735	HL-44-A	39-657-5	24	N-2171-S	2478-1	39-104-5	9	39-782-5	LMB-8		29
402850	3-CP	39-659-5	26	N-2147-S	4446-2	39-105	9	39-783-5	LMB-7		29
403686	15-CS	39-596-5	25	UT2217S	14099	39-344-5	18	39-783-5	0783		29
403691	LMG-140	39-658-5	38	UT2230S	14098		18	39-784-5	LMG-164		38
				N-2236-S	14097		9	39-788-5	LMG-170		38
				N-2264-S	14094	39-150-5	9	39-789-5	LMG-165		38
				UT2336S	14081	39-146-5	18	39-790-5	0790		27
				UT2337S	14080	39-145-5	18	39-791-5	0791		27
				UT2393S	14082	39-147-5	19	39-792-5	0792		27
				N-2399-S	14093		9	39-796-5	0796		29
				N-2449-S	14086		9	39-796-5	LMB-17		29
				N-2456-S	14088	39-475-5	9	39-797-5	0797		29
				N-2457-S	14089	39-479-5	9	39-797-5	LMB-18		29
				N-2458-S	14090	39-480-5	9	39-798-5	0798		29
				N-2459-S	14087	39-477-5	9	39-798-5	LMB-19		29
				N-2466-S	14085		9	39-799-5	0799		29
				UT2712S	14078	39-143-5	19	39-799-5	LMB-20		29
				UT2713S	14079	39-144-5	19	39-801-5	0801		29
				UT2714S	14074	39-140-5	19	39-801-5	LMB-21		29
								39-802-5	0802		29
				2-176-11	3925	39-266	4 & 5	39-802-5	LMB-24		29
								39-803-5	0803		27
								39-804-5	0804		27
								39-806-5	0806		29
								39-806-5	LMB-25		29
								39-809-5	0809		27
								39-810-5	0810		27
								39-812-5	0812		29

SEC. III, DIV. A
 CARBURETORS
 ISSUED JUNE, 1962

Numerical by Part Number				Numerical by Identification				Numerical by IBM			
Part Number	Identi- fication	IBM Number	Page	Identi- fication	Part Number	IBM Number	Page	IBM Number	Identi- fication	Part Number	Page
								39-812-5	LMB-26		29
								39-817-5	0817		29
								39-817-5	LMB-27		29
								39-819-5	0819		27
								39-820-5	0820		27
								39-857-5	0857		27
								39-858-5	0858		27
								39-859-5	LMG-172		38

PLEASE NOTE:

The Carburetor Parts Lists have been changed as follows:

- A. Bowl Drain Ass'y is listed as a complete assembly only 403826 (149-400). This Assembly is made up of:
 - 1 of Part No. 14225 Stem & Gasket Ass'y
 - 1 of Part No. 14226 Spring-Bowl Drain
 - 1 of Part No. 14206 Retainer-Drain

- B. The Gasket Kit is listed as a complete kit only 14743 (149-407). This kit consists of:
 - 1 of Part No. 14212 Gasket - Bowl
 - 1 of Part No. 14208 Gasket - Float Valve Seat
 - 2 of Part No. 14215 Gasket - Bowl Nut

The individual parts will be supplied as kits only, however, the above listing is to provide the information for combining the individual parts into kits or so that you may mark the part numbers on the illustrated view on Page 31 should you desire to use your stock as individual parts.

IMPORTANT: Please mark reference "R" on Page 31 as Part No. 14227; also mark into heading "R" on Pages 32 - 38 inclusive. The number was left out in cataloging this section.

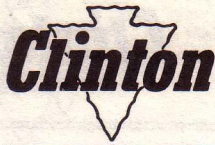

CLINTON ENGINES

SEC. III, DIV. A
SUCTION CARBURETORS
ISSUED JAN., 1954
REVISED JULY, 1966

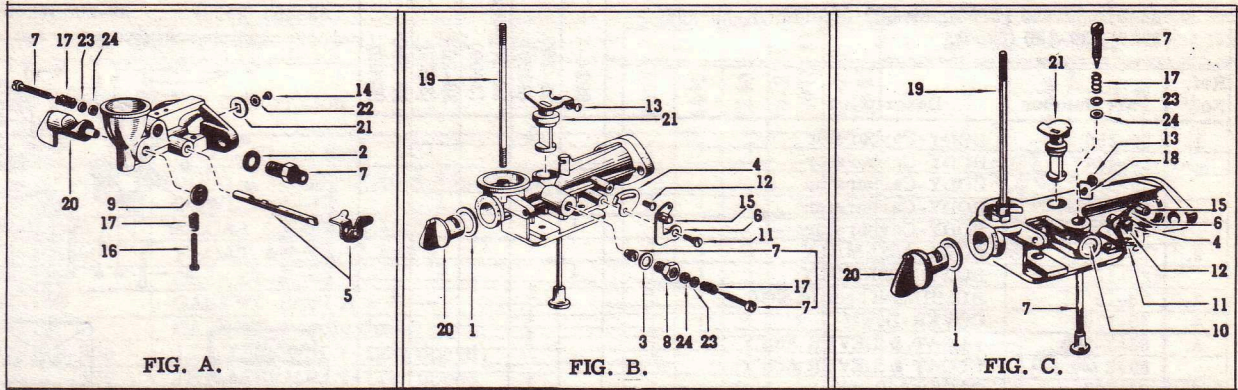

Fig.	Assembly No.	Replaced By Part No.	Used On Engine Model No.	Fig.	Assembly No.	Replaced By Part No.	Used On Engine Model No.
A	7100	*See Note	300 Series below Serial No. 5,000	C	39-554-500		350 Series Type (F)
B	7120	39-554-500	300 & 350 Series Types (A, B & C) with Serial No. above 5,000	B	4481	39-280-500	VS-750 Series Type (A & B)
				C	39-280-500		VS-750 Series Type (C & D)
C	7080-1	39-554-500	350 Series Type (D & E)	B	4709	39-554-500	650 Series Type (A)
				C	4730-1	39-554-500	650 Series Type (B)

4481, 4484, 4709, 4730-2, 39-554-500 (7080-2), 39-330-500 (7100), 7120.									
Ref. No.	Part Number	Description	4481	4484-2	4709	4730-2	39-554-500 7080-2	39-330-500 7100	7120
1.	94-5	GASKET-Choke	1	1	1	1	1		1
2.	94-194	GASKET-Fuel Fitting						1	
3.	304-251	GASKET-Packing	1		1				1
4.	109-12	LEVER-Governor Stop	1	1	1	1	1		1
5.	157-350	LEVER & SHAFT ASS'Y						1	
6.	157-201-500	LEVER ASS'Y-Governor	1	1	1				1
	157-57-500	LEVER ASS'Y-Governor				1	1		
7.	181-29-500	NEEDLE & SEAT ASS'Y	1		1				1
	181-19-500	NEEDLE & SEAT ASS'Y		1		1	1		
	181-26-500	NEEDLE & SEAT ASS'Y						1	
8.	183-110	NUT-Adj. Needle	1		1				1
9.	183-125	NUT-Tinnerman						1	
10.	216-12	PLUG-Expansion		1		1	1		
11.	258-164	SCREW-Control (Shoulder)	1	1	1	1	1		1
12.	258-25	SCREW-Round Head	1	1	1	1	1		1
13.	258-187	SCREW-Round Head	1	1	1	1	1		1
14.	258-480-500	SCREW-Round Head						1	
15.	258-12	SCREW-Round Head	1	1	1	1	1		1
16.	258-105	SCREW-Throttle Stop						1	
17.	263-121	SPRING-Main Adj. Needle						2	
	263-4	SPRING-Main Adj. Needle	1	1	1	1	1		1
18.	263-3	SPRING-Throttle Adj. Screw	1	1	1	1	1		1
19.	24-35	STUD-Air Cleaner	1		1				1
	24-14	STUD-Air Cleaner		1		1	1		
20.	*7110	VALVE-Choke						1	
	910-16	VALVE-Choke	1	1	1	1	1		1
21.	293-69-500	VALVE ASS'Y-Throttle	1		1				1
	293-57-500	VALVE ASS'Y-Throttle					1		
	39-285-500	VALVE ASS'Y-Throttle		1		1			
	39-536	VALVE ASS'Y-Throttle						1	
22.	304-8	WASHER-Lock						1	
23.	304-89	WASHER-Adj. Needle	1	1	1	1	1	1	1
24.	304-130	WASHER-Packing	1	1	1	1	1	1	1

* Note check Valve part number 7110 and Carburetor part number 7100 are not available as replacement parts. When new valve or Carburetor is required, order Carburetor part number 39-554-500 and the following additional parts: Fuel Tank 277-191-500, Governor Link 159-53, Governor Spring 263-57 and (2) Screw 258-170.



3924-1, 39-255 (3300), 39-263-500 (3900), 39-266 (3925), 39-290 (6200).			3924-1	39-255 (3300)	39-263-500 (3900)	39-266 (3925)	39-290 (6200)
Ref. No.	Part Number	Description					
1.	39-256	BODY-Carburetor		1			1
	39-454	BODY-Carburetor					
	39-530	BODY-Carburetor			1		
	39-531	BODY-Carburetor				1	
	39-532	BODY-Carburetor	1				
2.	25-11	BOWL ASSEMBLY			1		
	25-12	BOWL ASSEMBLY	1				1
3.	28-19	BUSHING-Throttle Shaft		2			2
4.	45-126	COVER-Bowl		1			1
5.	82-7-500	FLOAT & LEVER ASS'Y		1			1
	82-8	FLOAT & LEVER ASS'Y	1		1	1	
6.	94-137	GASKET-Bowl		1			1
	94-146	GASKET-Bowl			1		
	94-213	GASKET-Bowl	1				1
7.	94-243	GASKET-Needle Seat		1			1
	304-206	GASKET-Needle Seat	1		1	1	
8.	94-244	GASKET-Packing		1			1
	94-140	GASKET-Packing	1		1	1	
8A.	94-138-500	GASKET KIT		1			1
	94-147-500	GASKET KIT			1		
9.	94-136	GASKET-Main Nozzle		1			1
10.	39-458	GLAND-Packing		1			1
	39-533	GLAND-Packing	1				
11.	157-155	LEVER-Throttle Stop		1			1
	157-178	LEVER-Throttle Stop	1			1	
12.	258-321	NEEDLE-Idle Adj.		1			1
	181-15	NEEDLE-Idle Adj.	1			1	
13.	258-322	NEEDLE-Main Adj.		1			1
	181-13	NEEDLE-Main Adj.			1		
	181-16	NEEDLE-Main Adj.	1			1	
14.	94-139-500	NEEDLE & SEAT ASS'Y		1			1
	293-63	NEEDLE & SEAT ASS'Y	1		1	1	
15.	182-16	NOZZLE-Main		1			
	183-17-500	NOZZLE-Main					1
16.	183-82	NUT		1			1
	183-93	NUT			1		
	183-94	NUT	1			1	
17.	94-140	PACKING		1			1
18.	216-32	PLUG-Drain		1			1
	216-36	PLUG-Drain			1		
19.	216-31	PLUG-Welsh		1			1
19A.	39-915	REPAIR KIT		1			1
20.	258-784-500	SCREW-Idle Adj.		1			1
	258-345	SCREW-Idle Adj.	1			1	
21.	258-336	SCREW-Choke & Throttle Vlv.		2			2
	258-343	SCREW-Choke & Throttle Vlv.	2		2	2	
22.	258-344	SCREW-Body		3			3
	258-342	SCREW-Body			2		
23.	258-784-500	SCREW & L'WASHER		3			3
24.	258-480-500	SCREW & L'WASHER		1			1
25.	263-103	SPRING-Choke Return		1			1
	263-109	SPRING-Choke Return			1		
	263-111	SPRING-Choke Return	1				1
26.	263-102	SPRING-Adj. Needle		2			2
	263-112	SPRING-Adj. Needle	1				1
27.	6-121-500	SHAFT-Throttle		1			1
28.	6-125-500	SHAFT & LEVER ASS'Y-Choke		1			1
	6-138	SHAFT & LEVER ASS'Y-Choke			1		
	157-177-500	SHAFT & LEVER ASS'Y-Choke	1				1
29.	6-137	SHAFT & LEVER ASS'Y-Throttle				1	
	157-179-500	SHAFT & LEVER ASS'Y-Throttle	1				1
30.	203-73	SHAFT-Float		1			1
31.	158-81	TUBE ASSEMBLY-Idle		1			1
32.	39-259	VALVE-Choke		1			1
	215-199	VALVE-Choke			1		
	215-201	VALVE-Choke	1				1
33.	39-257	VALVE-Throttle		1			
	39-258	VALVE-Throttle					1
	215-198	VALVE-Throttle			1		
	215-202	VALVE-Throttle	1				1
34.	304-27	WASHER-Lock	1		1	1	
35.	304-31	WASHER-Lock Choke & Throttle Vlv.	1		1	1	
36.	304-198	WASHER-Lock Clamp Nut	1				1

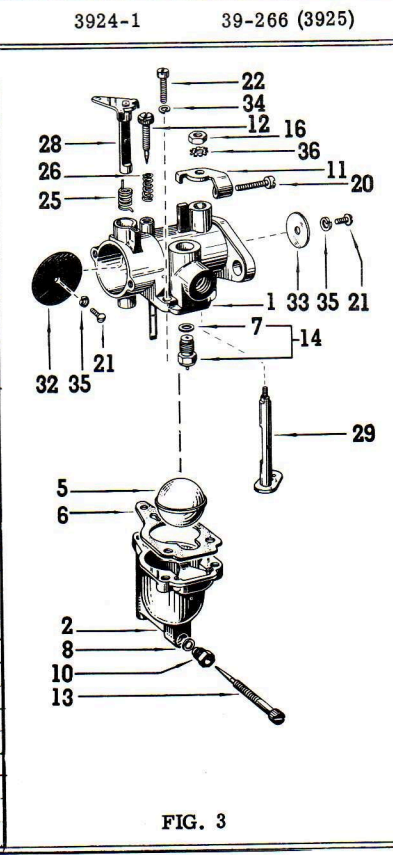
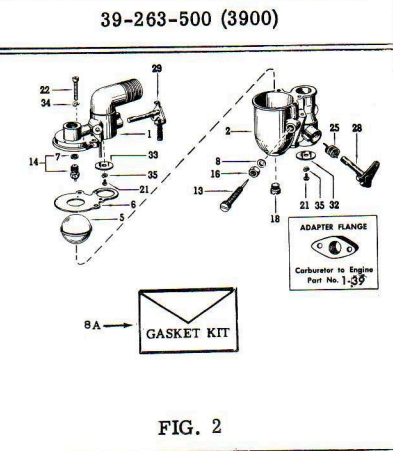
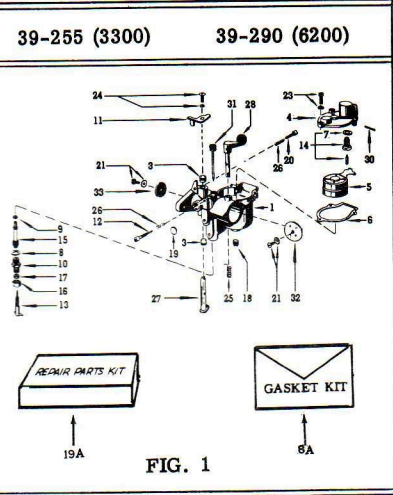



CLINTON ENGINES

SEC. III, DIV. A
 FLOAT CARBURETOR
 ISSUED JAN., 1954
 REVISED JULY, 1966

2078, 4446, 6230, 39-250 (2078-1), 39-267 (3965) →			39-250 (2078-1) & 2078				
Ref. No.	Part Number	Description	2078	4446	6230	39-250 (2078-1)	39-267 (3965)
1.	39-577	BALL-Choke Shaft	1	1	1	1	1
2.		BODY-Carburetor (Not Available)					
3.	25-20	BOWL	1	1	1	1	1
4.	82-9-500	FLOAT & LEVER ASS'Y				1	
	82-10-500	FLOAT & LEVER ASS'Y					1
5.	94-228	GASKET-Bowl	1	1	1	1	1
6.	94-148	GASKET-Bowl Nut	1	1	1	1	1
7.	94-79	GASKET-Needle Seat	1	1	1	1	1
8.	182-19-500	JET ASSEMBLY-Low Speed	1				
	182-21-500	JET ASSEMBLY-Low Speed				1	
9.	182-20-500	JET & HI-SPEED NEEDLE ASS'Y-Idle		1	1		1
	181-21-500	JET & HI-SPEED NEEDLE ASS'Y-Idle					
10.	258-348-500	NEEDLE ASS'Y-Main Adj.	1			1	
11.	258-346	NEEDLE-Idle Adj.	1				
	258-349	NEEDLE-Idle Adj.		1	1		1
	258-352	NEEDLE-Idle Adj.				1	
12.	181-14-500	NEEDLE & SEAT ASS'Y				1	
	181-17-500	NEEDLE & SEAT ASS'Y	1	1	1	1	1
13.	182-22	NOZZLE ASS'Y-Main	1			1	
	182-23	NOZZLE ASS'Y-Main		1	1		1
14.	258-914-500	NUT-Bowl		1	1		1
15.	94-188	PACKING-Hi-Speed Adj. Needle	1			1	
16.	216-39	PLUG-Expansion	1	1	1	1	1
17.	216-38	PLUG		1	1		1
17A.	39-268-500	REPAIR KIT		1	1		1
	39-879-500	REPAIR KIT				1	
18.	258-350	SCREW-Valve Attaching	4	4	4	4	4
19.	258-170	SCREW-Throttle Lever Stop		1	1		1
20.	6-195	SHAFT-Float Hinge	1	1	1	1	1
21.	6-142	SHAFT-Throttle				1	
	6-140	SHAFT-Throttle	1				
22.	157-181-500	SHAFT-Lever Ass'y, Choke	1				
	157-182	SHAFT-Lever Ass'y, Choke			1		
	157-183	SHAFT-Lever Ass'y, Choke		1			1
	157-184-500	SHAFT-Lever Ass'y, Choke				1	
23.	6-141	SHAFT & LEVER ASS'Y-Throttle		1	1		1
24.	263-115	SPRING CHOKE SHAFT	1	1	1	1	1
25.	263-116	SPRING-Hi-Speed Adj. Needle		1	1		1
26.	263-113	SPRING-Idle Adj.	1			1	
	263-114	SPRING-Idle Adj.		1	1		1
27.	263-106	SPRING-Throttle Backlash					
28.	293-66	VALVE-Choke	1	1	1	1	1
29.	293-64	VALVE-Throttle	1			1	
	293-65	VALVE-Throttle		1	1		1

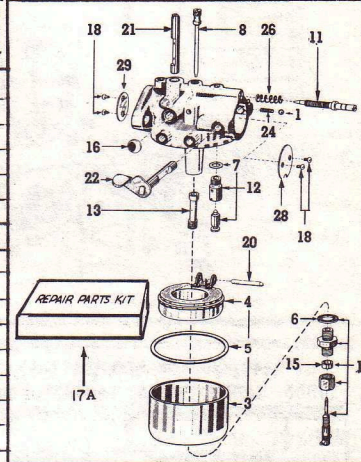

4446 6230 & 39-267 (3965)

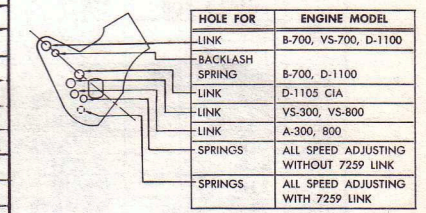
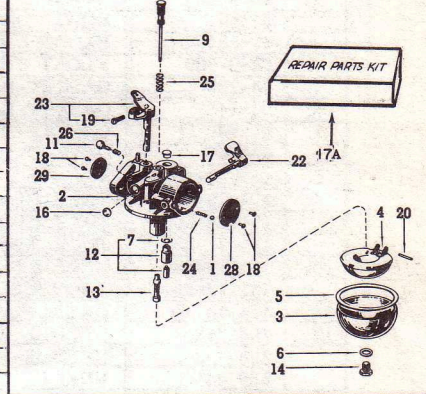

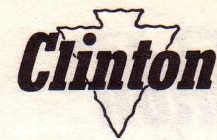

2478, 39-104-500 (2478-1), 39-480-500 (14090)

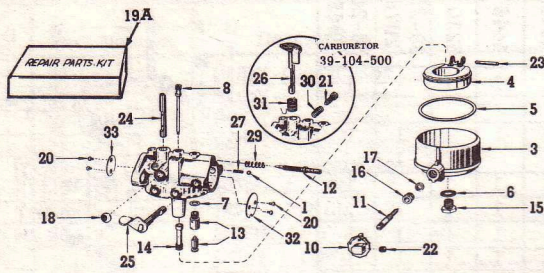

4446-2, 6320-2, 14085, 14086, 14087, 14088,
 14089, 14090, 14093, 14094, 14097.

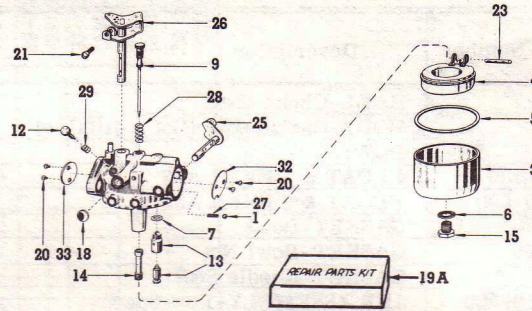

2478, 39-104-500 (2478-1), 4446-2, 6320-2, 14085, 14086, 14087, 14088, 14089, 14090, 14093, 14094, 14097			2478	39-104-500 (2478-1)	4446-2	6320-2	14085	14086	14087	14088	14089	39-480-500 (14090)	14093	14094	14097
1.	39-577	BALL-Choke Shaft	2	2	1	1	1	1	1	1	1	1	1	1	1
3.	25-9	BOWL	1	1							1				
	25-20	BOWL			1	1									
4.	39-584-500	FLOAT & LEVER ASS'Y					1	1	1	1	1	1	1	1	
	82-9-500	FLOAT & LEVER ASS'Y	1	1	1	1									1
5.	94-228	GASKET-Bowl	1	1	1	1	1	1	1	1	1	1	1	1	1
6.	94-148	GASKET-Bowl Nut	1	1	1	1	1	1	1	1	1	1	1	1	1
7.	94-79	GASKET-Needle Seat	1	1	1	1	1	1	1	1	1	1	1	1	1
	94-248	GASKET-Packing Nut									1				
8.	182-21-500	JET ASS'Y-Low Speed	1	1											
9.	182-20-500	JET & HI-SPEED NEEDLE			1	1		1		1					
	181-21-500	JET & HI-SPEED NEEDLE							1			1		1	1
	181-31-500	JET & HI-SPEED NEEDLE					1						1		
10.	121-14-500	KNOB & SCREW ASS'Y-Hi-Speed			1	1		1		1					
	121-27-500	KNOB & SCREW ASS'Y-Hi-Speed									1				
11.	181-12	NEEDLE ASS'Y-Main Adj.	1	1											
12.	258-349	NEEDLE-Idle Adj.			1	1		1		1					
	258-352	NEEDLE-Idle Adj.	1	1							1				
	258-442	NEEDLE-Idle Adj.					1		1			1	1	1	1
13.	181-14-500	NEEDEL & SEAT ASS'Y	1	1	1	1						1	1	1	1
	181-17-500	NEEDLE & SEAT ASS'Y					1	1	1	1	1	1	1		
14.	182-22	NOZZLE ASS'Y	1	1											
	182-23	NOZZLE ASS'Y			1	1						1	1	1	1
15.	258-914-500	NUT-Bowl	1	1	1	1	1	1	1	1	1	1	1	1	1
16.	183-83	NUT-Packing, Hi-Speed Needle	1	1							1				
17.	94-188	PACKING-Hi-Speed Adj. Needle	1	1							1				
18.	216-39	PLUG-Expansion	1	1	1	1	1	1	1	1	1	1	1	1	1
19.	216-57	PLUG									1				
	216-30	PLUG					1	1	1	1		1	1	1	
19A.	39-879-500	REPAIR KIT	1	1											
	39-884	REPAIR KIT						1		1					
	39-887	REPAIR KIT					1		1		1	1	1	1	
	39-914	REPAIR KIT									1	1	1	1	
20.	258-350	SCREW-Valve Attaching	4	4	4	4	4	4	4	4	4	4	4	4	4
	258-329	SCREW-Thr. Lever Stop		1					1		1	1	1	1	1
	258-170	SCREW-Thr. Lever Stop			1	1	1	1		1		1	1		
22.	258-328	SCREW-Set, Hi-Speed	1	1											
23.	6-195	SHAFT-Float Hinge	1	1	1	1	1	1	1	1	1	1	1	1	1
24.	6-140	SHAFT-Throttle	1												
25.	6-123-500	SHAFT-Lever Ass'y, Choke					1							1	
	157-181-500	SHAFT-Lever Ass'y, Choke			1	1									
	157-184-500	SHAFT-Lever Ass'y, Choke	1	1						1	1			1	1
	6-127-500	SHAFT-Lever Ass'y, Choke								1					
26.	6-122-500	SHAFT & LEVER ASS'Y-Throttle			1	1	1	1		1			1		
	6-128-500	SHAFT & LEVER ASS'Y-Throttle		1							1				
	6-202-500	SHAFT & LEVER ASS'Y-Throttle									1				
27.	263-115	SPRING CHOKE SHAFT	1	1	1	1	1	1	1	1	1	1	1	1	1
28.	263-116	SPRING-Hi-Speed Adj. Needle			1	1	1	1	1	1		1	1	1	1
29.	263-113	SPRING-Idle Adj.	1	1							1		1	1	1
	263-114	SPRING-Idle Adj.			1	1	1	1	1	1		1	1	1	1
30.	263-104	SPRING-Thr. Lever Adj. Screw	1						1		1	1	1	1	1
31.	263-106	SPRING-Throttle Backlash	1								1				
32.	293-66	VALVE-Choke	1	1	1	1	1	1	1	1	1	1	1	1	1
33.	293-59	VALVE-Throttle	1	1											
	293-65	VALVE-Throttle			1	1	1	1	1	1	1	1	1	1	1



LMB CARBURETOR

SEC. III, DIV. A
CARBURETORS
ISSUED MARCH, 1962

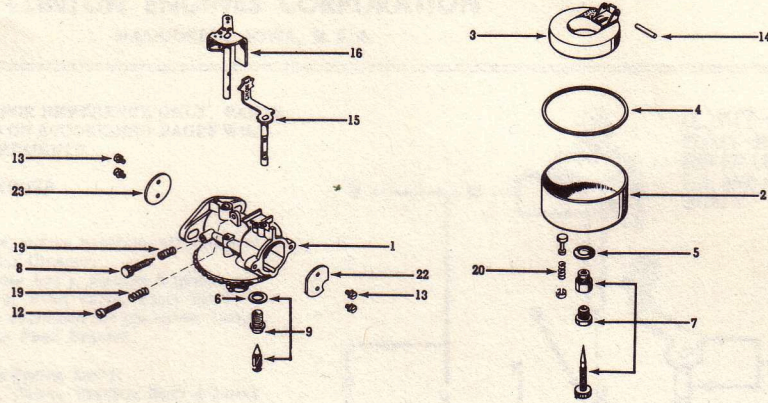

LMB CARBURETOR

Item No.	Description	Old No.	IBM No.	39-769-5 LMB 4	39-770-5 LMB 5	39-771-5 LMB 6	39-782-5 LMB 8	39-783-5 LMB 7	39-796-5 LMB 17	39-797-5 LMB 18	39-798-5 LMB 19	39-799-5 LMB 20	39-801-5 LMB 21	39-802-5 LMB 24	39-806-5 LMB 25	39-812-5 LMB 26	39-817-5 LMB 27
1	BODY ASS'Y-Not Available.....																
2	BOWL ASS'Y-Inc. Item 22.....		25-41-5	1	1	1	1	1	1	1	1	1	1	1	1	1	1
2A	CONNECTOR-Fuel Line-Not Serv.Separately							1									
3	FLOAT & LEVER ASS'Y.....		82-22-5	1	1	1	1	1	1	1	1	1	1	1	1	1	1
4	+*GASKET-Bowl.....		94-528	1	1	1	1	1	1	1	1	1	1	1	1	1	1
5	+*GASKET-Bowl Nut.....	14215	94-227	2	2	2	2	2	2	2	2	2	2	2	2	2	2
5A	+*GASKET-Carb. Mounting (Not Illus.).....		94-515	1	1	1	1		1	1	1	1	1	1	1	1	1
		2096	94-30					1									
6	+*GASKET & FLOAT VALVE SEAT.....	14208	94-229	1	1	1	1	1	1	1	1	1	1	1	1	1	1
7	NEEDLE-Power Adj. -Inc. Item 21.....	14218-A	181-5-5	1	1	1	1	1	1	1	1	1	1	1	1	1	1
8	*NEEDLE-Idle.....	14228	181-2	1	1	1	1	1	1	1	1	1	1	1	1	1	1
9	*NEEDLE & SEAT ASS'Y-Inc. Item 8.....	14211-R	293-76-5	1	1	1	1	1	1	1				1	1	1	1
		14559-AR	293-29-5								1	1					
10	NOZZLE-Serv. Replacement; See Note 1...	14311-1	182-37	1	1	1	1	1	1	1	1	1	1	1	1	1	1
11	"O" RING-Power Needle (Not Illus.).....		94-111	1	1	1	1	1	1	1	1	1	1	1	1	1	1
12	SCREW-10-32 x 5/8 (Throttle Stop).....	5623	258-60	1	1	1	1	1	1	1	1	1	1	1	1	1	1
13	SCREW & L'WASHER-Valve Attaching.....		258-931-5	2	2	2	2	2	2	2	2	2	2	2	2	2	2
14	*SHAFT-Float Hinge.....	14213	6-195	1	1	1	1	1	1	1	1	1	1	1	1	1	1
15	SHAFT & LEVER ASS'Y-Choke.....		6-411-5	1					1						1		
			6-412-5		1	1	1			1	1	1	1	1		1	1
			6-403-5					1									
16	SHAFT & LEVER ASS'Y-Throttle.....		6-410-5	1	1	1	1		1	1	1	1	1	1	1	1	1
			6-402-5					1									
17	SPRING-Choke Return (Not Illus.).....	14354	263-165	1											1		
19	SPRING-Compression.....	14227	263-82	2	2	2	2	2	2	2	2	2	2	2	2	2	2
	(1-Throttle Stop, 1-Idle Needle)																
19A	SPRING-Power Needle (Not Illus.).....		263-319	1	1	1	1	1	1	1	1	1	1	1	1	1	1
20	STEM ASS'Y-Bowl Drain.....	403826	149-400	1	1	1	1	1	1	1	1	1	1	1	1	1	1
22	VALVE-Choke.....	14382	293-15	1					1						1		
			293-152		1	1	1	1		1	1	1	1	1		1	1
23	VALVE-Throttle.....		293-171	1	1	1	1	1	1	1	1	1	1	1	1	1	1
	CARB. REPAIR KIT.....		149-596								1	1			1		
	*Indicate Parts in Kit		149-595	1	1	1	1	1	1	1					1	1	1
	GASKET KIT.....		149-576	1	1	1	1	1	1	1	1	1	1	1	1	1	1
	+Indicate Parts in Kit																
	PLUG KIT-Carburetor Body (Not Illus.)		149-620	1	1	1	1	1	1	1	1	1	1	1	1	1	1

Note 1: When existing Nozzle has been removed from Carburetor replace only with 14311-1 Serv. Replacement Nozzle.



PARTS LIST FOR
LMG & LMV TYPE
CARBURETORS
CLINTON ENGINES CORPORATION
MAQUOKETA, IOWA, U. S. A.

SECTION III, DIV. A
FLOAT CARBURETORS
Issued June 1962

ILLUSTRATION AT RIGHT IS FOR REFERENCE ONLY. PARTS AND/OR QUANTITIES LISTED ON SUCCEEDING PAGES WILL VARY ACCORDING TO REQUIREMENTS.

SERVICE PROCEDURE

Disassemble

1. Remove Carburetor from engine, noting carefully all linkages and connections. Remove the Air Cleaner.
2. Remove Power Adjustment Needle Ass'y, Gasket & Bowl.
3. Remove Float Shaft, Float Ass'y, Float Valve, Float Valve Seat & Gasket. Float should be examined for pin holes, leaks or wear in hinge pin holes on the Float Bracket.
4. Remove Bowl Ring Gasket.
5. Remove Idle Adjusting Needle & Spring Ass'y.
6. Remove Throttle Valve Screws, Valve, Throttle Shaft & Lever Ass'y if necessary.
7. Remove Choke Valve Screws, Valve, Choke Shaft & Lever Ass'y.
8. CAUTION: Do not adjust or remove Main Nozzle unless absolutely necessary for cleaning. Discard Nozzle if removed.
9. Clean Carburetor body and parts in a recommended cleaning solvent. Use as directed. All passages should be blown out with compressed air. Examine all parts for damage or wear and replace where necessary. New Gaskets should be used on every overhaul.
10. Use "REPAIR KIT" overhaul assortment, a new Float Valve Seat & Needle Ass'y for replacement of major parts. Always use a new Gasket Kit when reassembling.
11. CAUTION: Never use compressed air on a Carburetor with Float & Bowl Ass'y assembled.

Re-Assemble

1. If Main Nozzle was removed replace with Service Main Nozzle. DO NOT REINSTALL OLD NOZZLE. Tighten Securely. If torque wrench is available tighten 30 to 40 inch pounds.
2. Install Choke Shaft & Valve. The valve should be installed with the part number or trademark "W" towards the outside with the valve in a closed position.
3. Install Throttle Shaft & Valve. The Valve must be installed with the part number or trademark "W" facing towards the Flange with the Valve in the closed position. The Valve number must be on the Idle Needle side of Carburetor bore. With the Valve Screws loose and the engine speed screw backed out, seat the Valve by tapping gently with a small screwdriver. With the Valve properly located in the closed position, tighten retaining screws.
4. Install Idle Adjusting Needle. Needle should be seated very lightly by turning clockwise and back off (counter-clockwise) 1-1/4 turns as a preliminary setting. Replace with a new Needle if the tapered point shows any wear or damage.
5. Install Float Valve Seat, Gasket & Float Valve. Tighten securely. If torque wrench is available, tighten 40 to 50 inch pounds. This assembly is carefully matched and should any parts become separated, a complete assembly should be re-installed. Any damage or signs of wear to any portion of the assembly should be replaced by a complete new Float Valve and Seat (matched) set.
6. Install Float & Float Shaft. It is advisable on older carburetors to replace the float shaft.
7. FLOAT SETTING: Invert the casting & Float Ass'y. There should be a clearance of 5/32 inch between the outer rim of the casting and the nearest part of the Float at the opposite side from the hinge. If measurement is difficult, the Float should be adjusted to rest lightly on the Float Valve and extend horizontally parallel with the casting rim. The height adjustment can be made by bending the tab resting against the Float Valve. If a screw is provided in place of a tab this may be turned for proper height adjustment. Reverse casting to normal position. The Float would not drop more than 3/16 of an inch. A restricting tab is located in back of the hinge. This may be bent if necessary so that the Float will not drop more than 3/16 of an inch in this position.
8. Install Bowl Ring Gasket to nestle in the groove provided in the casting.
9. Install Bowl using the fiber gaskets on the inner and outer side of the Bowl, fitted to the Bowl Nut.
10. Install Power Adjusting Needle Ass'y with Gaskets in place. Back out the needle before tightening securely. If torque wrench is available, tighten 50 to 60 inch pounds.
11. Seat Power Adjusting Needle very lightly by turning clockwise and back off (counter-clockwise) 1-1/4 turns as a preliminary setting.
12. Using a new Flange Gasket install Carburetor on the engine. Throttle control and governor linkage or any remote controls should be assembled exactly as in the original location. Service the Air Cleaner as directed in the Engine Manual and replace to Carburetor.

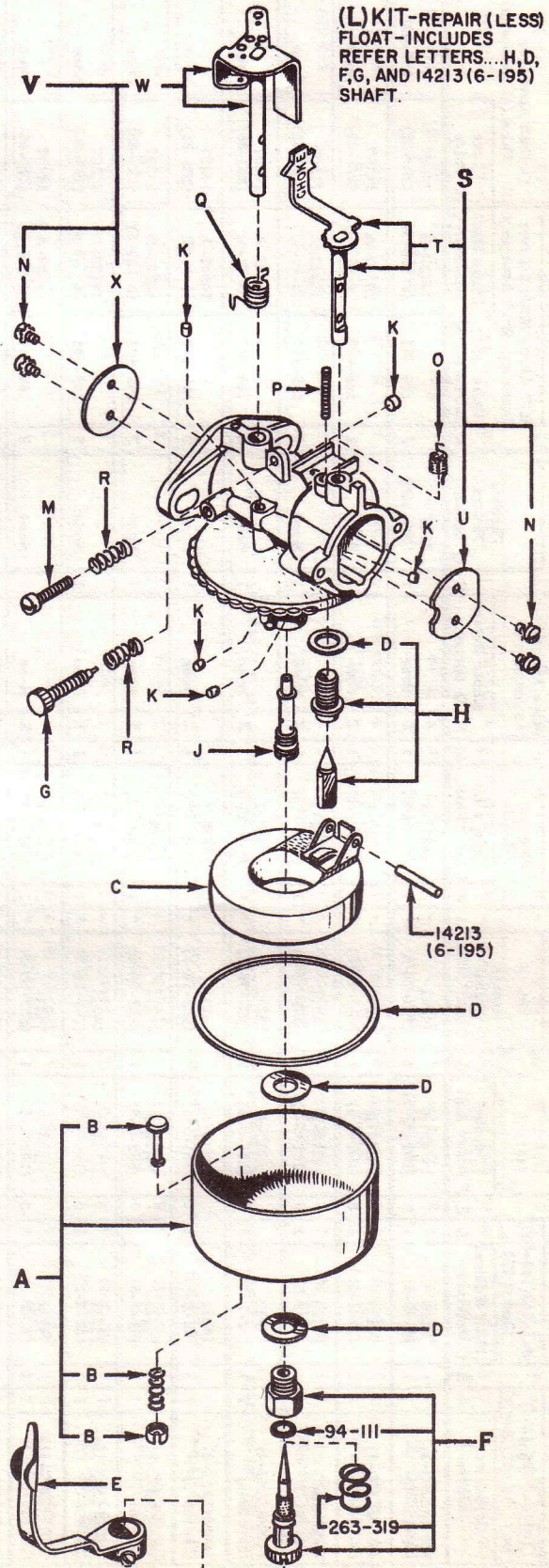



LME CARBURETOR

Sec. III, Div. A
Carburetor
Issued July 1964

Ref. No.	Part No.	Description	39-723-500 LME 7	39-811-500 LME 1	39-831-500 LME 3
1	Not Serviceable	BODY ASS'Y -----			
2	25-16-500	BOWL ASS'Y-Include Ref. 20 -----	1	1	1
3	82-2-500	FLOAT & LEVER ASS'Y -----	1	1	1
4	+ *94-228	GASKET-Bowl -----	1	1	1
5	+ *94-227	GASKET-Bowl Nut -----	2	2	2
6	+ *94-229	GASKET-Float Valve Seat -----	1	1	1
7	*181-5-500	NEEDLE-Power Adjustment -----	1	1	1
8	*181-2	NEEDLE-Idle -----	1	1	1
9	*293-30-500	NEEDLE & SEAT ASS'Y -----	1	1	1
10	182-37	NOZZLE (See Note 1) Not Illustrated -----	1	1	1
11	94-111	"O" RING-Power Needle (Not Illustrated) -----	1	1	1
12	258-60	SCREW-10-32 x 5/8 (Throttle Stop) -----	1	1	1
13	258-61-500	SCREW & L'WASHER-Valve Attaching -----	4	4	4
14	*6-195	SHAFT-Float Hinge -----	1	1	1
15	6-409-500	SHAFT & LEVER ASS'Y-Choke -----	1		
	6-408-500	SHAFT & LEVER ASS'Y-Choke -----		1	
	6-407-500	SHAFT & LEVER ASS'Y-Choke -----			1
16	6-405-500	SHAFT & LEVER ASS'Y-Throttle -----	1	1	1
17	263-165	SPRING-Choke Return (Not Illustrated) -----	1	1	
19	263-82	SPRING-Compression -----	2	2	2
20	39-909	STEM ASS'Y-Bowl Drain -----	1	1	1
22	293-85	VALVE-Choke -----		1	1
	293-152	VALVE-Choke -----	1		
23	293-173	VALVE-Throttle -----	1	1	1
	39-910	KIT-Carburetor Repair (* Indicates Part Used in Repair Kit) -----	1	1	1
	39-938	KIT-Plug -----	1	1	1
	94-585	KIT-Gasket (+ Indicates Parts in Kit) -----	1	1	1

NOTE 1. When Existing Nozzle Has Been Removed from Carburetor, Replace Only with 182-37 Replacement Nozzle.

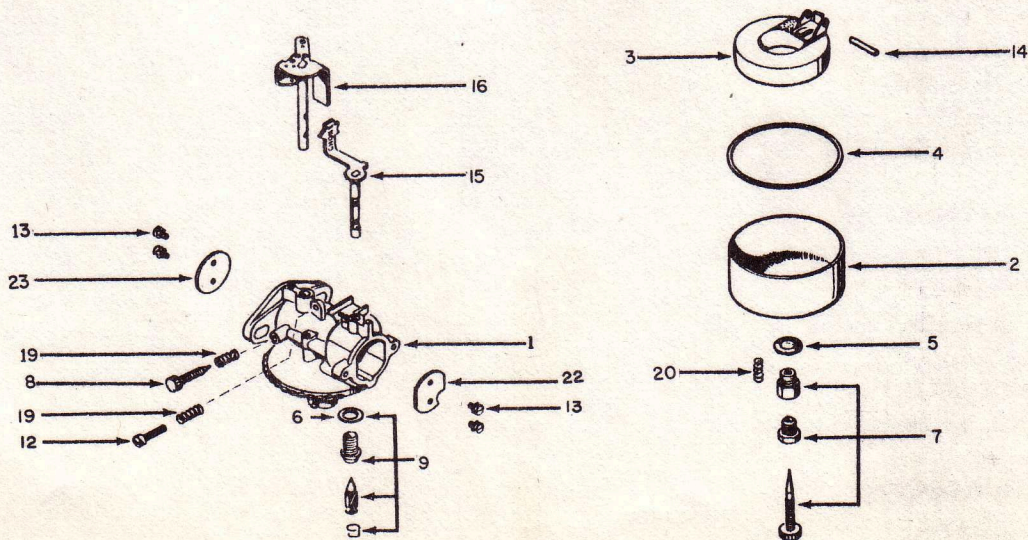



AIR CLEANER

IDENTIFICATION

SECTION IV, DIV. F
AIR CLEANERS
Issued May, 1965

Ref. No.	Part Number	AIR CLEANER COMPONENTS				Type Mounting Required
		Type Air Cleaner	Body	Element	Cover	
1	2-2-500	Oil Bath	2-48	45-34	45-34	Air Horn
1	2-3-500	Oil Bath	2-47	45-34	45-34	Air Horn
1	2-6-500	Oil Bath	25-5	45-33	45-33	Air Horn
1	2-7-500	Oil Bath	2-39	45-36	45-36	Air Horn
1	2-56-500	Oil Bath	2-72	2-56	2-56	Air Horn
1	2-162-500					Air Horn
1	2-165-500	Oil Bath	2-48	45-393	45-393	Air Horn
2	2-69-500	Oil Bath	2-84	2-25	45-155	Air Horn
2	2-82-500	Oil Bath	2-84-500	2-25	45-155	Air Horn
2	2-83-500	Oil Bath	2-84-500	2-25	45-155	Air Horn
2	2-105-500	Oil Bath	2-41	2-25	45-155	Air Horn
3	2-20-500	Oil Bath				Air Horn
4	2-68-500	Oil Bath	2-41	2-25	45-8	Air Horn
4	2-70-500	Oil Bath	2-41	2-25	45-8	Air Horn
5	2-5-990	Oil Bath	2-134-500	2-134-500	2-135	Direct
6	2-186	Dry	2-16	2-26	45-10-500	Direct
6	2-187	Dry	2-17-500	2-26	45-10-500	Direct
6	2-191	Dry	2-102	2-99-990	45-175	Direct
6	2-192	Dry	2-100	2-99-990	45-175	Direct
6	2-193	Dry	2-98	2-99-990	45-175	Direct
7	2-78-500	Dry	2-62	2-65	2-61	Air Horn
8	2-9-500	Paper - Self Contained Can	Down Draft (Small)			Air Horn
8	2-11-500	Paper - Self Contained Can	Up Draft (Small)			Air Horn
8	2-146-500	Paper - Self Contained Can	Down Draft (Large)			Air Horn
9	2-12-500	Paper - Self Contained Can	Vertical			Direct
10	2-35-500	Dry	17-12	2-107	45-11	Direct
10	2-49-500	Oil Wet Mesh	215-139-500	2-96	45-5	Direct
10	2-103-500	Oil Wet Mesh	215-7-500	2-33	45-5	Direct
10	2-104-500	Oil Wet Mesh	215-10	2-33	45-116	Direct
10	2-117-500	Dry	17-36-500	2-113	45-248 45-247	Direct
10	2-130-500	Oil Wet Mesh	215-395-500	2-33	45-293	Direct
10	2-183	Oil Wet Mesh	2-18-500	2-33	45-6	Air Horn
10	2-195	Oil Wet Mesh	215-140-500	2-33	45-5	Direct
11	2-177-500	Oil Wet Foam	2-139	2-175-990	45-337	Direct
11	2-197	Oil Wet Foam	2-138	2-171	45-338	Direct
11	2-198	Oil Wet Foam	2-144	2-175-990	45-337	Direct
11	2-199	Oil Wet Foam	2-139	2-175-990	45-337	Direct
11	2-207-500	Oil Wet Foam	2-181	2-175-990	45-337	Direct
11	2-208-500	Oil Wet Foam	2-144	2-175-990	45-381	Direct
11	2-212-500	Oil Wet Foam	2-144	2-175-990	45-381	Direct
12	2-157-500	Oil Wet Foam	2-157	2-156-990	45-386	Direct
12	2-178-500	Oil Wet Foam	2-137	2-205	45-413	Direct
13	2-200	Oil Wet Foam	2-153	2-154-990	45-383	Direct
13	2-201	Oil Wet Foam	2-155	2-154-990	45-383	Direct
14	2-172-500	Oil Wet Foam	2-173	2-174	45-408	Air Horn
15	2-169-500	Oil Wet Foam	2-170	2-169	45-406	Direct
15	2-215-500	Oil Wet Foam	2-170	2-174	45-408-500	Direct
16	2-176-500	Oil Wet Foam	2-118	2-179-990	45-306	Direct
16	2-202	Oil Wet Foam	2-161	2-160-990	45-391	Direct
16	2-204-500	Oil Wet Foam	2-180	2-171	45-391	Direct
17	2-55	Oil Wet Mesh - Self Contained Can				Direct
18	2-114-500	Dry	2-115	2-116	70-29	Chainsaw
18	2-128-500	Dry		2-128-500	45-257	Chainsaw
18	2-190	Dry	69-199	2-116	45-257	Chainsaw

Check Price List For Parts Availability

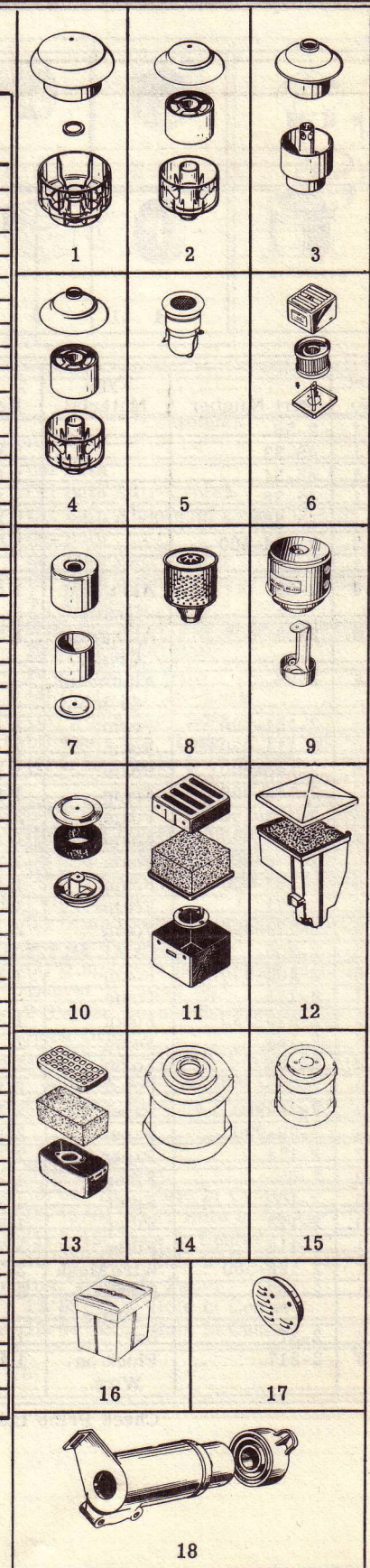



ELEMENT
IDENTIFICATION

SECTION IV, DIV. F
AIR CLEANER
ELEMENTS
Issued May, 1965

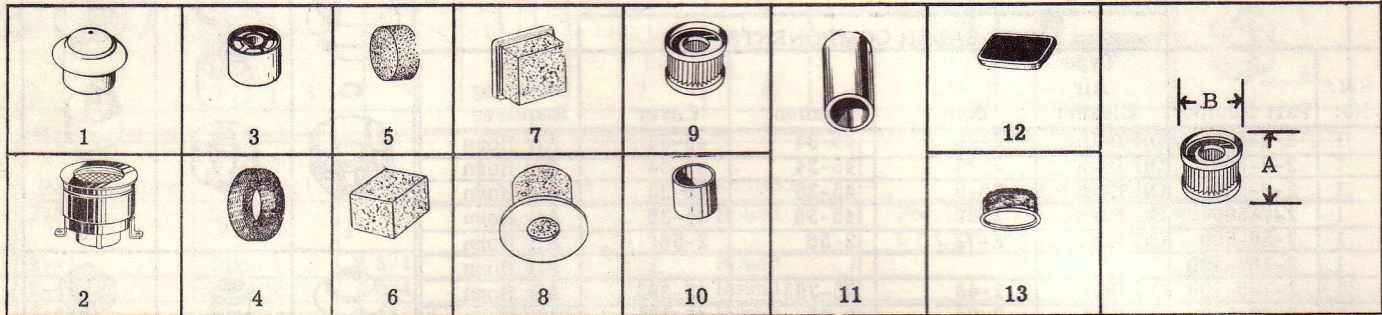

Ref. No.	Part Number	Type Material	A Height	B Diameter	Description	Comments
1	2-56				Round	
1	45-33		2 5/16"	4 7/8"	Round	Oil Bath - Hair Center
1	45-34		2 5/8"	3 45/64"	Round	Oil Bath - Aluminum Crimp Center
1	45-36		3 3/16"	6 5/8"	Round	
1	45-393		2 5/8"	3 11/16"	Round	Oil Bath - Hair Center
2	2-134-500		3 7/16"	4 1/16"	Round	
3	2-25				Round	
4	2-29	Aluminum Crimp	1 5/8"	2 13/16"	Round	
4	2-33	Aluminum Crimp	1 1/32"	2 13/16"	Round	
4	2-96	Aluminum Crimp			Round	
5	2-151-990	Foam	1.00"	2 9/32"	Round	
6	2-111-990	Foam	2.00"	2 3/4"	Square	
6	2-140-990	Foam	1 1/4"	3 1/4"	Square	
6	2-141-990	Foam	1 1/4"	2 1/2"	Square	
6	2-149-990	Foam	2.00"	2 1/2x3 11/16"		
6	2-154-990	Foam	1 11/32"	3 5/8x2 3/32"		
6	2-156-990	Foam	1 3/8"	3 1/4x2 29/32"		
6	2-160-990	Foam	1 1/2"	2 21/32"	Square	
6	2-171	Foam	1 9/16"	2 1/4"	Square	Latex Backing
6	2-179-990	Foam	2.00"	2 1/2"	Square	Latex Backing
6	2-205	SAME AS 2-205-990				
6	2-205-990	Foam	1 39/64"	3 1/4"x2 5/16"		Latex Backing
7	2-136	Foam			Round	Oil Pump Filter
7	2-175-990	Foam	1 3/8"	2 5/16"	Square	Micro-Seal
8	2-169	Foam	2 5/32"	2 13/16"	Round	Micro-Seal
8	2-174	Foam	2 5/32"	2 13/16"	Round	Micro-Seal
9	2-26	Paper	2 1/4"	2 23/32"	Round	
9	2-28-990	Paper	2 1/4"	2 23/32"	Round	
9	2-99-990	Paper	2 1/8"	2 5/8"	Round	Open on one end only
9	2-124	Paper	2 1/8"	2 5/8"	Round	Open on one end only
10	2-65	Fiber	1 3/8"	3.00"	Round	
10	2-107	Fiber	1 3/8"	3.00"	Round	
10	2-113	Fiber	1 3/8"	3 3/4"	Round	
11	2-116	Fiber	3 3/4"	1 1/2"	Round	
11	2-128-500	Wire Mesh	3 7/8"	1 15/32"	Round	Chainsaw
11	2-167	Screen & Paper	3 13/16"	2.00"	Round	Chainsaw
12	2-31	Bat	1/2"	2 3/4"x1 5/8"		Pre-Cleaner
13	2-217	Flock on Wire	1 17/64"	2 1/2"	Round	Plastisol Seal Edge

Check Price List For Parts Availability



AIR CLEANER

SECTION IV, DIV. F
AIR CLEANER
COVERS
Issued May, 1965

COVERS

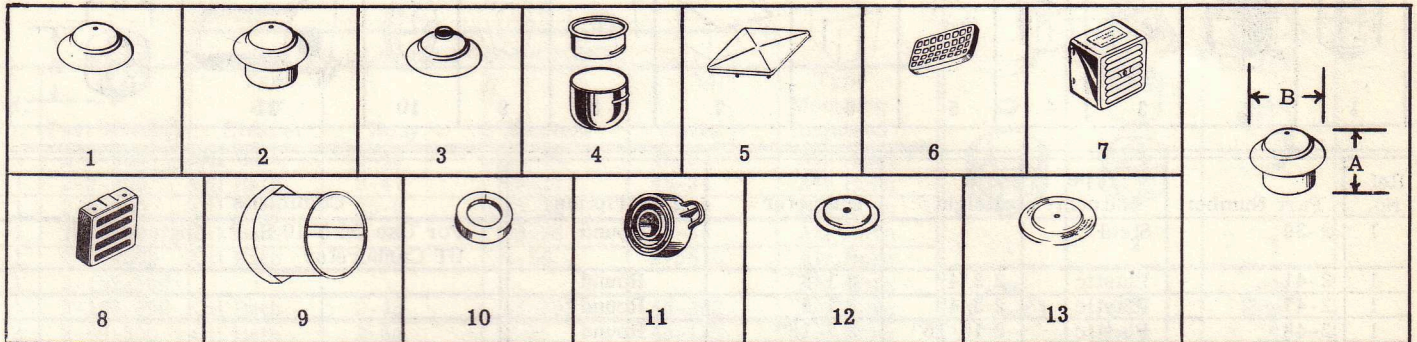

Ref. No.	Part Number	Type Material	A Height	B Diameter	Description	Comments
1	45-155				Round	
2	2-56				Round	Oil Bath
2	45-33		2 15/16"	4 7/8"	Round	Oil Bath Hair Center
2	45-34		2 5/8"	3 45/64"	Round	Oil Bath Aluminum Crimp Center
2	45-36		3 3/16"	6 5/8"	Round	Oil Bath
2	45-393		2 5/8"	3 11/16"	Round	Oil Bath Hair Center
3	2-20		2 7/8"	3 3/4"	Round	Oil Bath Hole In Center For Mounting To Air Horn
3	45-8	Steel			Round	Hole In Center For Mounting To Air Horn
4	2-135	Steel	1 7/16"	3 3/16"	Round	Baffle For Oil Bath
4	25-35		2 7/8"	3.00"	Round	Bowl For Oil Bath
5	45-306	Plastic	3/16"	3 7/64"x2 59/64"		(4) Posts 1 1/16" Long
5	45-386	Plastic	5/8"	3 3/8"	Square	(12) Posts 3/8" Long
5	45-391	Plastic	5/16"	2 7/8"	Square	(4) Posts 5/8" Long
5	45-413	Plastic	13/32"	4.00"x3 19/64"		(4) 5/32" Posts 3/4" Long
6	45-383	Steel	5/16"	3 13/32"x1 7/8"		
7	45-10-500	Steel	1 13/16"	2 7/8"	Square	(1) 7/32" Dia. Hole In Center, (3) 3/4" Holes In Lower Side Installed
7	45-175	Steel	1 51/64"	2 53/64"	Square	(3) 3/4" In Lower Side Installed
8	45-337	Steel	31/64"	2 53/64"	Square	(2) Dimples In Top Side Installed, Louver Pointing Up
8	45-338	Steel	31/64"	2 9/32"	Square	(2) Dimples In Lower Side Installed. Louver Pointing Up
8	45-381	Steel	31/64"	2 53/64"	Square	(2) Dimples In Lower Side Installed. Louver Pointing Up
9	45-406-500	Steel	2 13/16"	3 23/32"	Round	2 Slanted Bosses On Top For Bails To Hook Over
9	45-408-500	Steel	2 13/16"	3 23/32"	Round	13/64" Dia. Hole In Center Of Top
10	70-29	Rubber	29/64"	1 3/4"	Round	Chainsaw Element End Cover
11	45-257	Rubber	45/64"	2 23/64"	Round	Chainsaw Element Housing Cover
12	2-61	Steel	1/8"	2 1/4"	Round	
13	2-63	Steel	2 1/8"	2 1/4"	Round	
13	45-5	Steel	9/32"	2 7/8"	Round	Hole In Center
13	45-6	Aluminum	1 3/16"	3 5/16"	Round	13/64" Dia. Hole In Center
13	45-11	Steel	3/8"	2 15/16"	Round	(1) 13/64" Dia. Hole In Center
13	45-116	Aluminum	17/64"	2 13/16"	Round	(1) 3/16" Hole In Center
13	45-247	Steel	17/64"	3 5/32"	Round	13/64" Dia. Hole In Center. (40) 7/32" Dia. Holes In Face.
13	45-248	Aluminum	3/8"	2 11/16"	Round	13/63" Dia. Hole In Center
13	45-293	Aluminum	1 3/8"	3 7/8"	Round	13/64" Dia. Hole In Center

Check Price List For Parts Availability



AIR CLEANER

BODIES

SECTION IV, DIV. F
AIR CLEANER
BODIES
Issued May, 1965

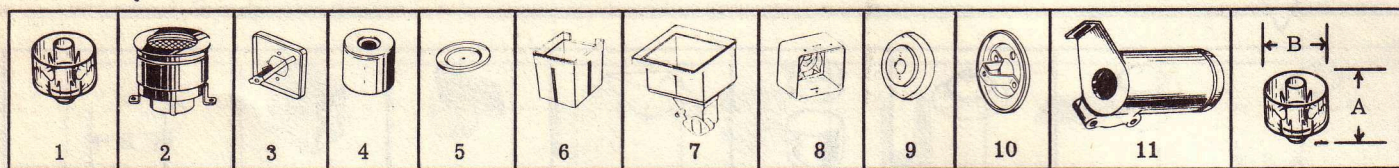

Ref. No.	Part Number	Type Material	A Height	B Diameter	Description	Comments
1	2-39	Steel			Round	For Use On 6-10 H. P. Engines With UT Carburetor
1	2-41	Plastic	2 3/4"	3 1/8"	Round	
1	2-47	Plastic	2 3/4"	3 1/8"	Round	
1	2-48	Plastic	2 15/16"	3 3/16"	Round	
1	2-72				Round	
1	2-84	Plastic	2 15/16"	3 1/8"	Round	
1	25-5	Plastic	2 15/16"	4 1/8"	Round	
2	2-134-500	Steel			Round	HEW Series Carburetor Cleaner
3	2-16-500	Steel	3/4"	2 13/16"	Square	Center Bracket 2 1/4" Long; Mounting Hole Offset To The Left & Below Center
3	2-17-500	Steel	3/4"	2 13/16"	Square	Center Bracket 2 1/4" Long; Mounting Hole Offset To The Right & Below Center
3	2-98	Steel	3/4"	2 13/16"	Square	Properly Installed Mounting Hole Below Center
3	2-100	Steel	3/4"	2 13/16"	Square	Properly Installed Mounting Hole Below Center To The Right
3	2-102	Steel	1 9/16"	2 13/16"	Square	Mounting Extruded 13/16"
3	2-216	Steel	7/16"	2 7/8"	Round	
4	2-62				Round	
5	2-64	Steel	5/32"	2 3/16"	Round	3/16" Dia. Hole 1/4" Off Center
6	2-118	Plastic	3 53/64"	3 7/64x2 59/64"		
6	2-161	Plastic	2 9/16"	2 3/4"	Square	500 Series
6	2-180	Plastic	2 9/16"	2 3/4"	Square	Was Part Number 2-161
7	2-137	Plastic	5 25/32"	3 27/32x3 19/64"		
7	2-157	Plastic	4 11/16"	3 13/64x2 57/64"		Horizontal Long Life, Horizontal Gem
8	2-138	Steel	1 43/64"	2 17/64"	Square	
8	2-139	Steel	1 51/64"	2 13/16"	Square	(2) Cover Holes & Slot At Top: Mounting Hole To The Left & Below Center
8	2-144	Steel	1 51/64"	2 13/16"	Square	(1) Cover Hole & Slot At Top: Mounting Hole Below Center
8	2-153	Steel	1 37/64"	3 13/32 x 1 7/8"		Mounting Holes Not Parallel With Body
8	2-155	Steel	1 37/64"	3 13/32 x 1 7/8"		Mounting Holes Parallel With Body
8	2-181	Steel	1 15/32"	2 13/16"	Square	(2) Cover Holes & Slot At Top Mounting Hole Below Center & Screw Holes Not Parallel
9	2-63	Steel	2 1/8"	2 1/2"	Round	
9	2-170	Steel	3/4"	3 51/64"	Round	Flat Mounting Surface With (2) Mounting Holes
9	2-173	Steel	29/32"	3 51/64"	Round	Extruded For Mounting To Air Horn
10	2-18-500	Steel	1 3/32"	2 13/16"	Round	Center Bracket 2 5/32" Long: For Air Horn Mounting
10	17-12	Steel	1/8"	3 1/16"	Round	Mounting Hole Off Center
10	17-36-500	Steel	1 1/2"	3 1/8"	Round	Mounting Hole Off Center. Mounting Bracket 29/32" Long
10	215-7-500	Steel	1/4"	2 13/16"	Round	Mounting Hole Off Center. Center Bracket 1 5/32" Long
10	215-10	Aluminum	55/64"	2 29/32"	Round	Mounting Hole Off Center. Center Bracket 1 3/4" Long: (3) 49/64" Holes In Rim Of Mounting Plate
10	215-139-500	Steel	19/64"	2 13/16"	Round	Mounting Hole Centered & Covered With Screen. Center Bracket 1 5/32" Long, 2 1/64" Dia. Hole For Carter Carb. Idle Needle
10	215-140-500	Steel	19/64"	2 13/16"	Round	Mounting Hole Centered & Covered With Screen. Center Bracket 1 5/32" Long
10	215-395-500	Steel	19/64"	2 13/16"	Round	Mounting Hole Centered & Covered With Screen. Center Bracket 1 5/32" Long
11	2-115	Magnesium	4 5/64"	2 1/16"	Round	Chainsaw
11	69-199	Magnesium	4.00"	2 1/4"	Round	Chainsaw