



12 VOLT FLYWHEEL-STARTER WITH ALTERNATOR AND RECTIFIER FOR D.C. BATTERY CHARGING OR A.C. LIGHTING COIL ONLY

| Ref. No. | Description | 268-18-500 Magneto | No. Req. |
|----------|--|--------------------|----------|
| 1 | Breaker Points Assembly | 135-7-500 | 1 |
| 2 | Clip-Coil Holding | 81-20 | 1 |
| 3 | Clip-Generator Coil Retaining | 81-164 | 2 |
| 4 | Coil Ass'y-Generating used on D. C. Charging (Inc. Lead Wires) | 135-262 | 1 |
| 5 | Condenser | 135-265-500 | 1 |
| 6 | Coil | 135-13-090 | 1 |
| 7 | Cover-Dust | 45-15 | 1 |
| 8 | Felt-Cam Follower | 94-198 | 1 |
| 9 | Gasket-Dust Cover | 94-241 | 1 |
| 10 | Nut-Shorting Wire To Stator | 183-21 | 2 |
| 11 | Screw | 258-77 | 1 |
| 12 | Screw-Condenser to Plate | 258-299 | 1 |
| 13 | Screw-Points to Plate | 258-297-500 | 1 |
| 14 | Shield | 259-583 | 4 |
| 15 | Spring-Dust Cover | 263-10 | 1 |
| 16 | Terminal-Condenser | 307-230 | 1 |
| 17 | Washer-Terminal Condenser | 304-290 | 1 |
| 19 | Cam-Breaker | * | 1 |
| 20 | Flywheel Ass'y | * | 1 |
| 21 | Housing Ass'y-Blower | * | 1 |
| 22 | Magneto Ass'y-(See Parts List Above) | * | 1 |
| 23 | Nut-Flywheel | * | 1 |
| 24 | Nut-Rectifier Mtg. | 183-39 | 1 |
| 25 | Rectifier | 135-249 | 1 |
| 26 | Plate-Rectifier Mtg. | 215-448 | 1 |
| 27 | Plate-Bearing | * | 1 |
| 28 | Pulley-Starting (For Rope) | * | 1 |
| 29 | Screen-Rotating | * | 1 |
| 31 | Screw & L/W-1/4-20 x 5/8 (Starter Mtg.) | 258-232-500 | 4 |
| 32 | Screw-1/4-28 x 5/16 (Rectifier Mtg. Plate) | 258-882-500 | 1 |
| 33 | Screw & L/W-8-32 x 1/2 (Terminal Strip to Block) | 258-132-500 | 2 |
| 34 | Screw-8-32 x 1-1/4 (Rec. To Plate) | 258-881-500 | 1 |
| 35 | Starter Ass'y-Elec. (See Note) | 264-74-500 | 1 |
| 36 | Terminal Strip | 307-296-500 | 1 |

* These parts are shown for reference only. It is necessary to refer to the basic parts list and model variations.

Note:
Warranty service on the factory installed (264-74-500) Starter is the responsibility of Clinton Engines Corporation and is handled through authorized warranty stations.

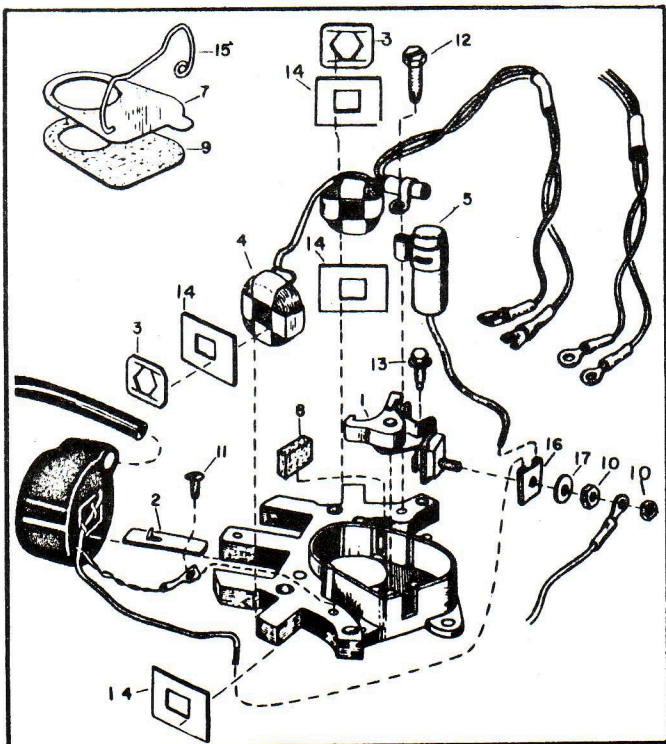
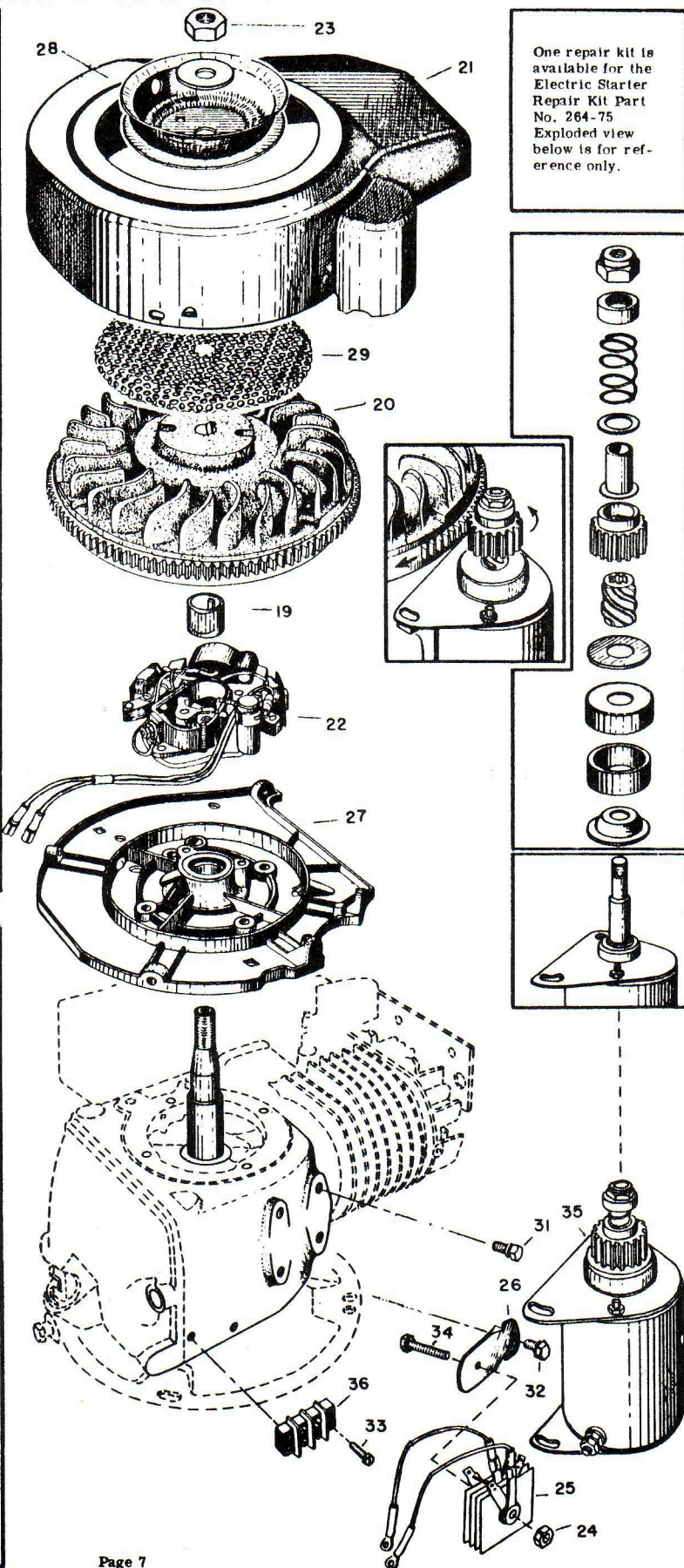

BELOW IS SUGGESTED WIRING DIAGRAM FOR A DC CHARGING CIRCUIT AND AN AC LIGHTING CIRCUIT, DUE TO THE MANY USES THESE ALTERNATORS HAVE, CLINTON SUPPLIES THE PARTS TO THE TERMINAL STRIP ONLY. THE PARTS REQUIRED TO COMPLETE THE WIRING SYSTEM ARE NOT SUPPLIED BY CLINTON AND SHOULD BE ORDERED FROM THE EQUIPMENT MANUFACTURER THAT THE ENGINE IS ADAPTED TO.

SEC. III DIV. N
STARTER GENERATOR
ISSUED OCTOBER, 1963

IMPORTANT--BE SURE ALL TERMINALS ARE CLEAN AND FREE OF PAINT.

