

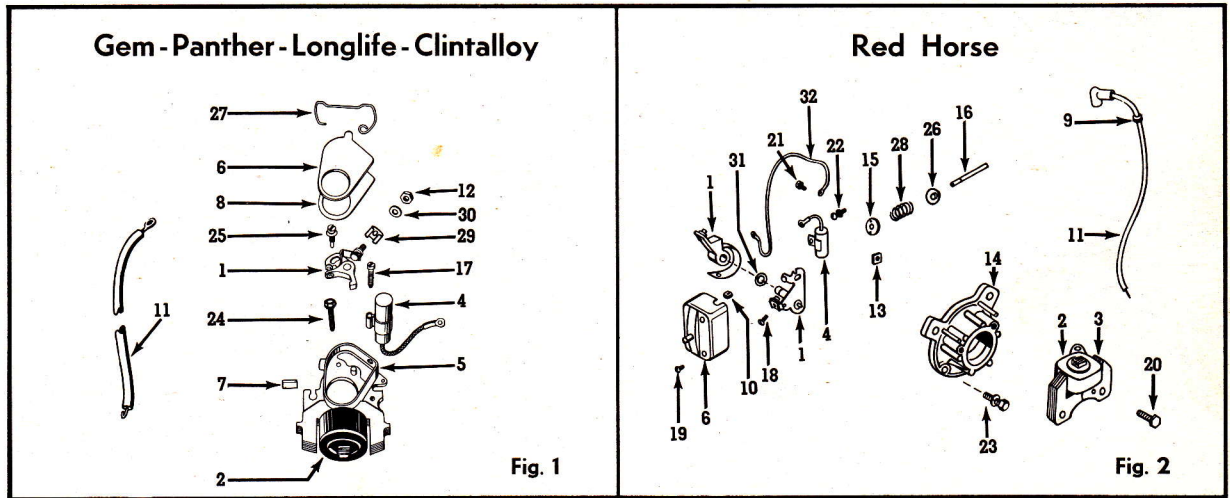

CLINTON ENGINES

SEC. IV, DIV. C
MAGNETOS
Revised Sept. 1959
Supersedes Jan. 1956

MAGNETO IDENTIFICATION



Ref. No.	PART DESCRIPTION	Part No.	Fig. 1	Fig. 2
1	BREAKER POINTS ASSEMBLY	P5735	1	
	BREAKER POINTS ASSEMBLY	P5759		1
2	COIL — Magneto (w/o laminations)	P5733-A	1	
	COIL — Magneto (w/o laminations)	P25313		1
3	COIL — Magneto (w/laminations)	P25313-A		1
4	CONDENSER — Magneto	P5589-A	1	
	CONDENSER — Magneto	P5758		1
5	CORE & BREAKER BOX ASSEMBLY	P5732	1	
6	COVER — Dust, Magneto Breaker Points	P5743	1	
	COVER — Assembly Magneto Breaker Points (w/Shorting Button)	P5762-A		1
7	FELT — Lubrication, Cam Follower	P5742	1	
8	GASKET — Breaker Points Cover	P5744	1	
9	GROMMET — High Tension Lead	3283		1
10	GROMMET — Breaker Ass'y Cover	5767		1
11	LEAD — High Tension, Magneto (Gem, Long Life and Clintalloy)	P5555	1	
	LEAD — High Tension, Magneto (Panther)	P2055	1	
	LEAD — High Tension, Magneto	P25314		1
12	NUT — Terminal Condenser Lead	5740	1	
13	NUT — Breaker Points & Condenser to Bracket	4511		1
14	PLATE ASSEMBLY — Stator	A1600-1000 16613-A		1
		A1690-1000 90270-A		1
		B2500-1000 25066-A		1
		B2590-1000, 2790-1000 25064-A		1
15	RETAINER — Breaker Seal	5761		1
16	ROD BREAKER PUSH	A1600-1000 5756		1
		B2500-1000, 2790-1000 5757		1
17	SCREW — Condenser to Plate	5741	1	
18	SCREW — (1—Condenser & Primary Leads to Points) (1—Coil & Primary Leads to Terminal Not Shown)	5647		2
19	SCREW — Cover to Bracket	5444-A		2
20	SCREW — Laminations to Stator Plate	5640		2
21	SCREW & L'WASHER — Breaker Points to Bracket	5855-G		1
22	SCREW & L'WASHER — Breaker Bracket to Block	5813-A		2
23	SCREW & L'WASHER — Stator Plate to Block	7236-G		4
24	SCREW & L'WASHER — Laminations to Block	5682-A	2	
25	SCREW & L'WASHER — Breaker Points to Breaker Box	5737	1	
26	SEAL — Breaker Actuating Arm	5581		1
27	SPRING — Breaker Box Cover	P5745	1	
28	SPRING — Compression	91038		1
29	TERMINAL — Jamtite Breaker Points	P5738	1	
30	WASHER — Terminal Condenser Lead	5739	1	
31	WASHER — Breaker Points	5489		1
32	WIRE ASSEMBLY — Primary Lead	16329-A		1

CLINTON ENGINES



PHELON

CLINTON

GEM SERIES — PANTHER SERIES

GEM SERIES

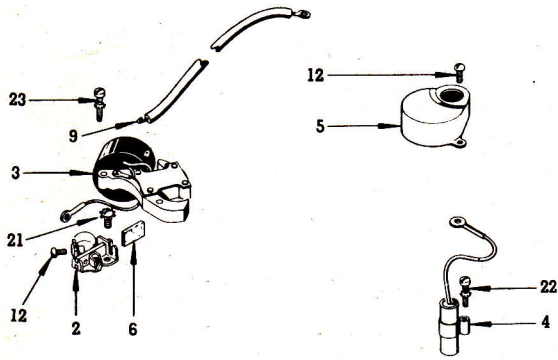

Fig. 1

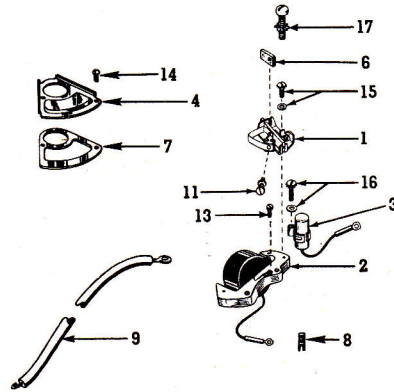

Fig. 2

RED HORSE SERIES (Thru 1200)

PANTHER SERIES — RED HORSE (Thru 1200)

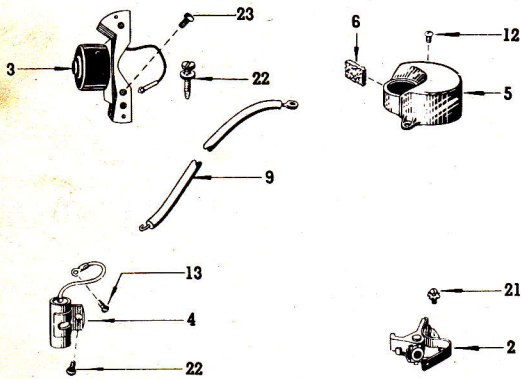

Fig. 3

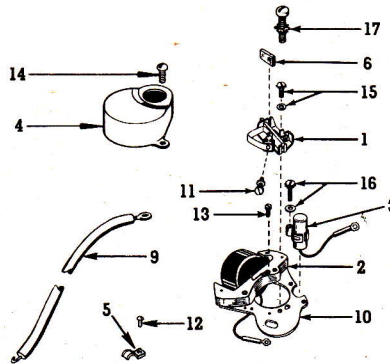

Fig. 4

INDUSTRIAL - RED HORSE SERIES (1600-2500)

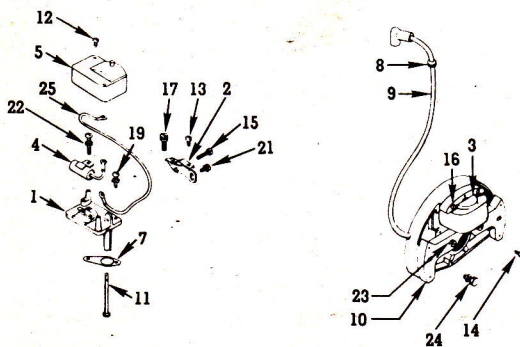

Fig. 5



CLINTON ENGINES

SEC. IV, DIV. C
MAGNETOS
Issued December, 1955

PHELON MAGNETO			Panther	Gem	Red Horse	Red Horse
Ref. No.	PART DESCRIPTION	Part No.	Fig. 1	Fig. 1	Thru 1200 Fig. 3	1600-2500 Fig. 5
1	BASE ASSEMBLY — Breaker	P5546				1
2	BREAKER POINTS ASSEMBLY	P5510			1	
	BREAKER POINTS ASSEMBLY	P5532	1			
	BREAKER POINTS ASSEMBLY	P5543		1		
	BREAKER POINTS ASSEMBLY	P5546				1
3	COIL — (w/lamination)	P5502			1	
	COIL — (w/o lamination)	P5509			1	
	COIL — (w/lamination)	P5531	1	1		
	COIL — (w/o lamination)	P5538	1	1		
	COIL — (w/lamination)	P5563				1
4	CONDENSER	P2053	1			
	CONDENSER	P5549				1
	CONDENSER	P7219		1	1	
5	COVER — Breaker Assembly	2060	1			
	COVER — Breaker Assembly	5062			1	
	COVER — Breaker Assembly	P5548				1
	COVER — Breaker Assembly	10382		1		
6	FELT — Lub., Cam Follower	P5504	1	1	1	
7	GASKET — Breaker Box to Block	16252				1
8	GROMMET — Hi-Tension Lead	3283				1
9	LEAD — Hi-Tension	P2055	1	1		
	LEAD — Hi-Tension	P5521			1	
	LEAD — Hi-Tension	P5565				1
10	PLATE ASSEMBLY — MagStator w/coil and lamination	P5552-A				1
11	ROD — Breaker Push	16015				†1
	ROD — Breaker Push	25015				*1
12	SCREW — Breaker Cover to Plate	5407				2
	SCREW — Breaker Cover to Plate	5416	2		2	
	SCREW — Breaker Cover to Plate	5644		2		
13	SCREW — Breaker Points Terminal	5405	1		1	1
	SCREW — Breaker Points Terminal	5423		1		
14	SCREW — Coil Gr.—Lamin.	5641				1
15	SCREW — Breaker Points Pivot	5514				1
16	SCREW — Coil to Plate	5639				2
17	SCREW — Breaker Points Adjusting	P5638				1
18	SCREW LOCKWASHER — Breaker Base to Block	3211-A				1
19	SCREW LOCKWASHER — Breaker Base & Condenser to Block	5422-A				1
20	SCREW LOCKWASHER — Breaker Points to Plate	3210-A				1
	SCREW LOCKWASHER — Breaker Points to Plate	5407-F	1			
	SCREW LOCKWASHER — Breaker Points to Plate	5444-F		1		
21	SCREW LOCKWASHER — Condenser to Plate	3239-F	1			
	SCREW LOCKWASHER — Condenser to Plate	5415			1	
	SCREW LOCKWASHER — Condenser to Plate	5422-A				1
	SCREW LOCKWASHER — Condenser to Plate	5644-A		1		
22	SCREW LOCKWASHER — Lamination to Plate	5406-B			1	
	SCREW LOCKWASHER — Lamination to Plate	5430-A	1	1		
	SCREW LOCKWASHER — Lamination to Plate	5640				1
23	SCREW LOCKWASHER — Stator Plate to Block	7236-G				4
24	WIRE ASSEMBLY — Breaker Points	16329				1

*Used on 2500 Series only

†Used on 1600 Series only

CLINTON MAGNETO			Panther	Gem	Red Horse
Ref. No.	PARTS DESCRIPTION	Part No.	Fig. 4	Fig. 2	Cast Iron Thru 1200 Fig. 4
1	BREAKER POINTS ASSEMBLY	P5543	1	1	1
2	COIL ASSEMBLY — (w/o lamination)	P5593-A	1	1	1
	COIL ASSEMBLY — (w/lamination)	P5593-B		1	
3	CONDENSER	P5589	1		1
	CONDENSER	P5599		1	
4	COVER ASSEMBLY — Breaker Points	5595-A	1		1
	COVER ASSEMBLY — Breaker Points	10382		1	
5	CLAMP	3410			1
6	FELT — Lubrication, Cam Follower	5504	1	1	1
7	GASKET — Breaker Cover	10250			1
8	GROMMET — Breaker Cover	10367			1
9	LEAD — Hi-Tension	2055	1	1	
	LEAD — Hi-Tension	5555			1
10	PLATE ASSEMBLY — Coil and Lamination	5590-B	1		
	PLATE ASSEMBLY — Coil and Lamination	5704-B			1
11	SCREW — Condenser to Points	5664	1	1	1
12	SCREW — Clamp to Plate	5415			1
13	SCREW — Coil to Lamination	5641	1	1	1
14	SCREW — Breaker Cover to Plate	5405	2		2
	SCREW — Breaker Cover to Plate (1 holds condenser)	5644		2	
15	SCREW & LOCKWASHER — Breaker Hold-Down	5409-F	1		1
	SCREW & LOCKWASHER — Breaker Hold-Down	5444-F		1	
16	SCREW & LOCKWASHER — Condenser to Plate	5674-F	1		1
17	SCREW & LOCKWASHER — Magneto Plate Hold-Down	5430-A	1	1	1

CLINTON ENGINES



Type	Clinton Assy. No.	Scintilla Assy. No.	Application
K1-4	C3402*	—	700 Series, with lighting coil — below Serial Number 199,736
K1-5	C3400*	10-51625	700 Series, without lighting coil — below Serial Number 199,736
K1-12	C3435	10-53140	700 Series, with lighting coil — above Serial Number 199,736 A-1100 and B-1100
K1-16	C3434†	10-53160	700 Series, without lighting coil — above Serial Number 199,736 A-1100 and B-1100
K1-19	C3450†	10-54915	700 Series, A-1100 and B-1100

NOTE: For other style magneto parts (not components of above Assembly Numbers) see illustrated Basic Parts List, Section II.
*Magnetos C3400 and C3402 have provisions for adjustable spark advance when used with bearing plate 3103.
†Magnetos C3434 and C3450 are completely interchangeable.

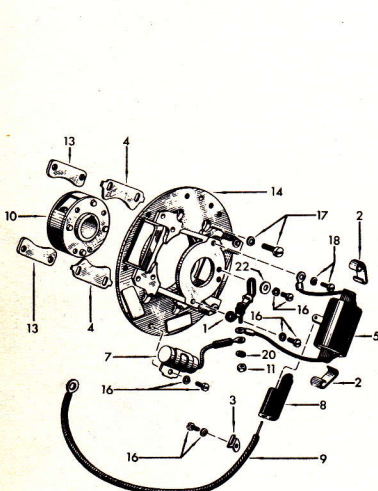

TYPES K1-5 & K1-16

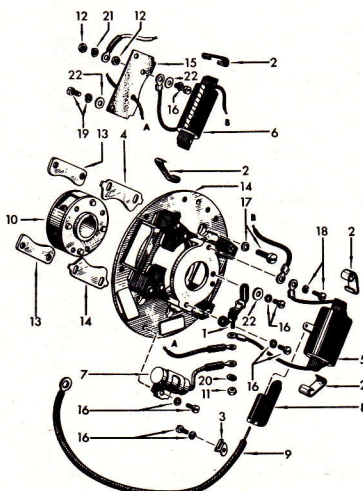

TYPES K1-4 & K1-12

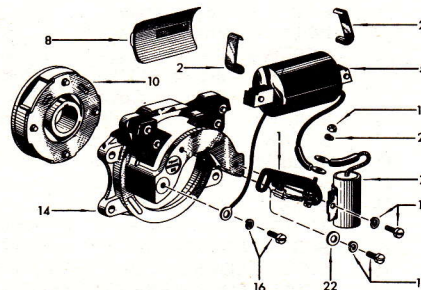

TYPE K1-19

Ref. No.	PART DESCRIPTION	Clinton Part No.	Scintilla Part No.	Quantity				
				K1-4	K1-5	K1-12	K1-16	K1-19
1	BREAKER POINTS ASSEMBLY	C3413	10-52344W	1	1	1	1	1
2	CLAMP — Coil Core	C3409	10-37804	4	2	4	2	2
3	CLAMP — High Tension Lead	C3410	10-37807	1	1	1	1	
4	CLAMP — Magneto Flange	C3414	10-37879	2	2			
5	COIL — Magneto	C3406	10-38222Y	1	1	1	1	1
6	COIL — Lighting	C3422	10-53141	1		1		
7	CONDENSER	C3416	10-58223Y	1	1	1	1	1
8	INSULATOR — Coil	C3408	10-37806	1	1	1	1	
9	LEAD — High Tension	P5521		1	1	1	1	
10	MAGNET — Rotating	C3407	10-38334		1		1	1
	MAGNET — Rotating	C3431	10-53139	1		1		
11	NUT — Hex., No. 4-40	3415	10-38682	1	1	1	1	1
12	NUT — Hex., No. 8-32	3426	10-51637	2		2		
13	PLATE — Locking	C3420	10-37878	2	2			
14	PLATE — Stator	C3403	10-37793Y		1		1	
	PLATE — Stator	C3404	10-37866Y	1		1		
	PLATE — Stator	C3449	10-54914					1
15	PLATE — Terminal	C3423		1		1		
16	SCREW & L'WASHER ASSY.—No. 8-32 x 1/4" long	5413-G	10-51662	5	4	5	4	3
17	SCREW & L'WASHER ASSY.—No. 10-32 x 1/2" long	5412-G	10-51667	4	4			
18	SCREW & L'WASHER ASSY.—No. 8-32 x 1/2" long	3326-G	10-51661	1	1	1	1	
19	SCREW & L'WASHER ASSY.—No. 8-32 x 5/8" long	3326-G	10-51663	2		2		
20	WASHER — Lock	3412	2-194	1		1		
21	WASHER — Lock	3280	10-7501	1		1		
22	WASHER — Plain	3427	10-14268	3	1	3	1	1