



# SERVICE BULLETIN NO. 107

Section VIII, Div. A  
Service Bulletin 107  
Issued May, 1976

\*\*\*\*\*

SUBJECT: RECOIL STARTER CENTER SCREW SIZE CHANGE

The following Recoil Starter Assemblies will be effected:

265-276-500

265-279-500

265-280-500

265-281-500

265-283-500

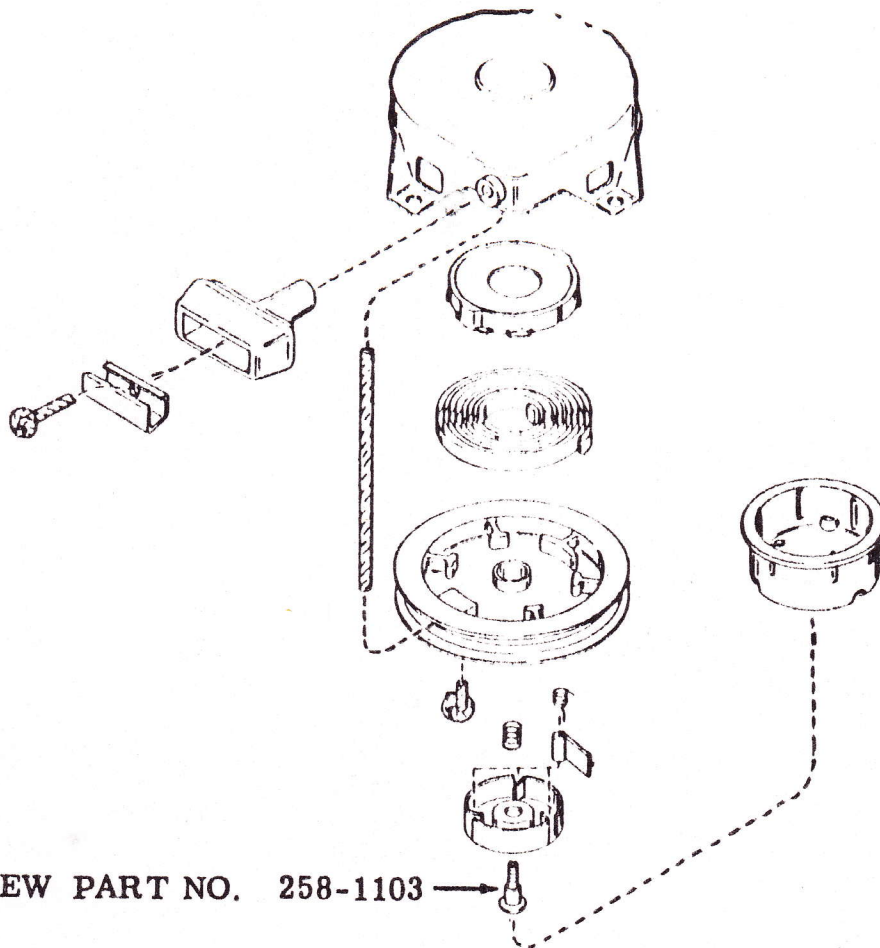

SCREW PART NO. 258-1103

On older model engines using the above Recoil Starters center screw part no. 258-1103 was a #10-32 thread. Later model engines with the above Recoils will be using a screw with a #12-28 thread.

The part number on the screw will not change, and our factory service stock will be changed at once to the #12-28 thread screw.

To service Recoil Starters having the #10-32 screw, it will be necessary to drill out the center hole in the Recoil Starter Housing post with a 13/64 drill.

## CLINTON ENGINES CORPORATION

MAQUOKETA, IOWA

PRINTED IN U.S.A.