



# CLINTON ENGINES

SECTION III, DIV. N  
 Issued March, 1958  
 Revised August, 1965

## BELOW DECK ELECTRIC STARTER

Starter Ass'y No.	Used On	Starter Ass'y No.	Used On
7369 -----	VS 100, VS 2100, VS 3100	7372 -----	VS 1100
7370 -----	VS 1000	7373 -----	VS 400
7371 -----	VS 200	7374 -----	AVS 400, BVS 400

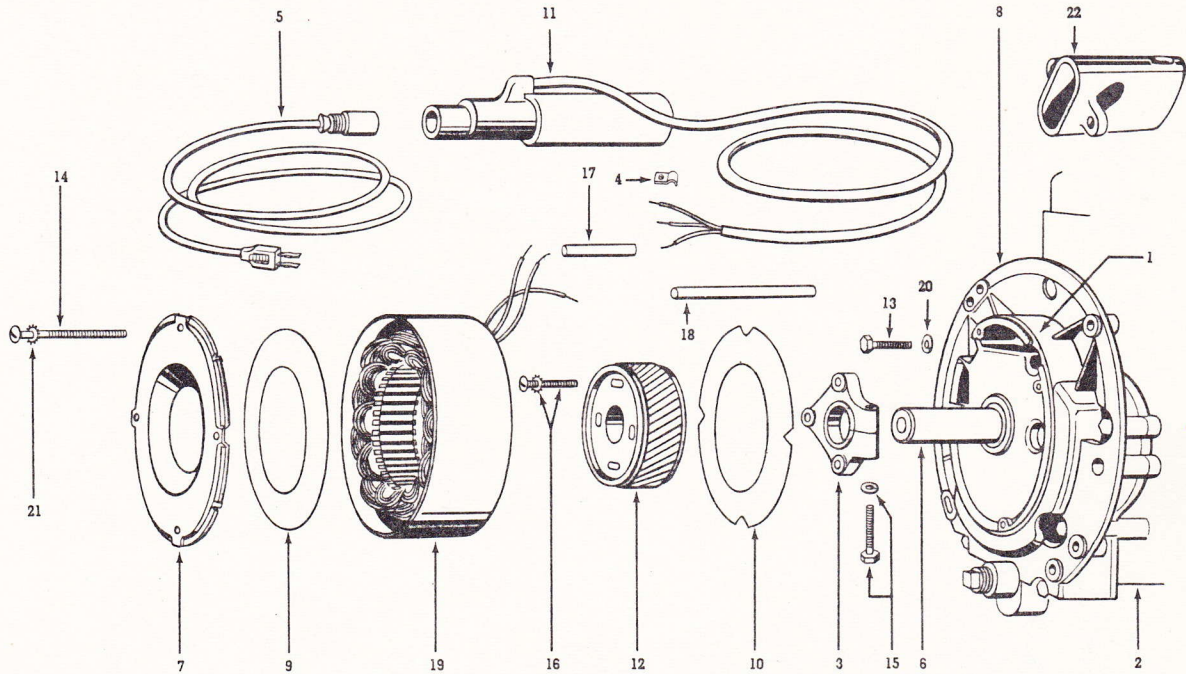

Ref. No.	Part Number	Description	7369	7370	7371	7372	7373	7374
1	18-29	BASE - Engine -----	1					
2	22-60	BLOCK - Cylinder -----					1	1
	22-53	BLOCK - Cylinder -----			1			
3	81-15	CLAMP - Starter Rotor -----	1	1	1	1	1	1
4	81-21	CLAMP - Wire -----	1	1	1	1	1	1
5	307-50	CORD - Extension -----	1	1	1	1	1	1
6	46-96	CRANKSHAFT -----		1				
	46-193	CRANKSHAFT -----				1		
7	45-2	COVER -----	1	1	1	1	1	1
8	1-26	FLANGE - Engine Adapter -----		1		1		
	1-29	FLANGE - Engine Adapter -----			1		1	1
9	94-67	GASKET - Insulator -----			1		1	1
10	94-67	GASKET - Insulator -----	2	2	1	2	1	1
11	307-52-500	HARNESS ASS'Y -----	1	1	1	1	1	1
12	264-15	ROTOR -----	1	1		1		
	264-1	ROTOR -----			1		1	1
13	258-135	SCREW (4) -----			4		4	4
14	258-127	SCREW (4) -----			4		4	4
	258-128	SCREW (4) -----	4	4		4		
15	258-254-500	SCREW & L'WASHER -----	1	1	1	1	1	1
16	258-134-500	SCREW & L'WASHER (3) -----	3	3		3		
	258-244-500	SCREW & L'WASHER (3) -----			3		3	3
17	69-10	SLEEVE - Connector (3) -----	3	3	3	3	3	3
18	158-62	SLEEVE - Insulating -----	1	1	1	1	1	1
19	268-2	STATOR -----	1	1		1		
	268-1	STATOR -----			1		1	1
20	304-19	WASHER (4) -----			4		4	4
21	304-16	WASHER - Lock (4) -----	4	4	4	4	4	4
22	170-15	MUFFLER -----						1

Check Parts Price List For Complete Unit And Individual Parts Availability.